

Project

AEROJET BUILDING E33
OFFICE EXPANSION
EAST CAMDEN,
ARKANSAS

Design Phase

CONSTRUCTION
DOCUMENTS

Revisions

No.	Date	Description

Stamp

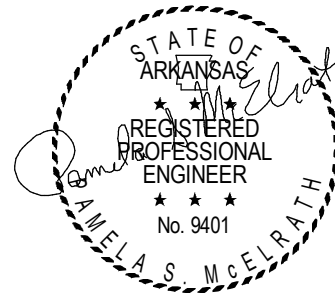
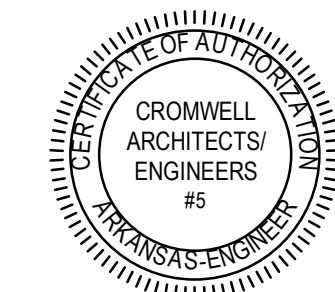

12-19-2024

Notes

- CROMWELL ARCHITECTS ENGINEERS, INC.
ALL RIGHTS RESERVED
- THIS SHEET DESIGNED FOR COLOR PRINTING.
CRITICAL INFORMATION MAY BE LOST WITH
BLACK AND WHITE PRINTING.

Project Number

2024-134

Issue Date

12-19-2024

Sheet Title

ENLARGED SYSTEMS
PLANS

Sheet Number

ET401

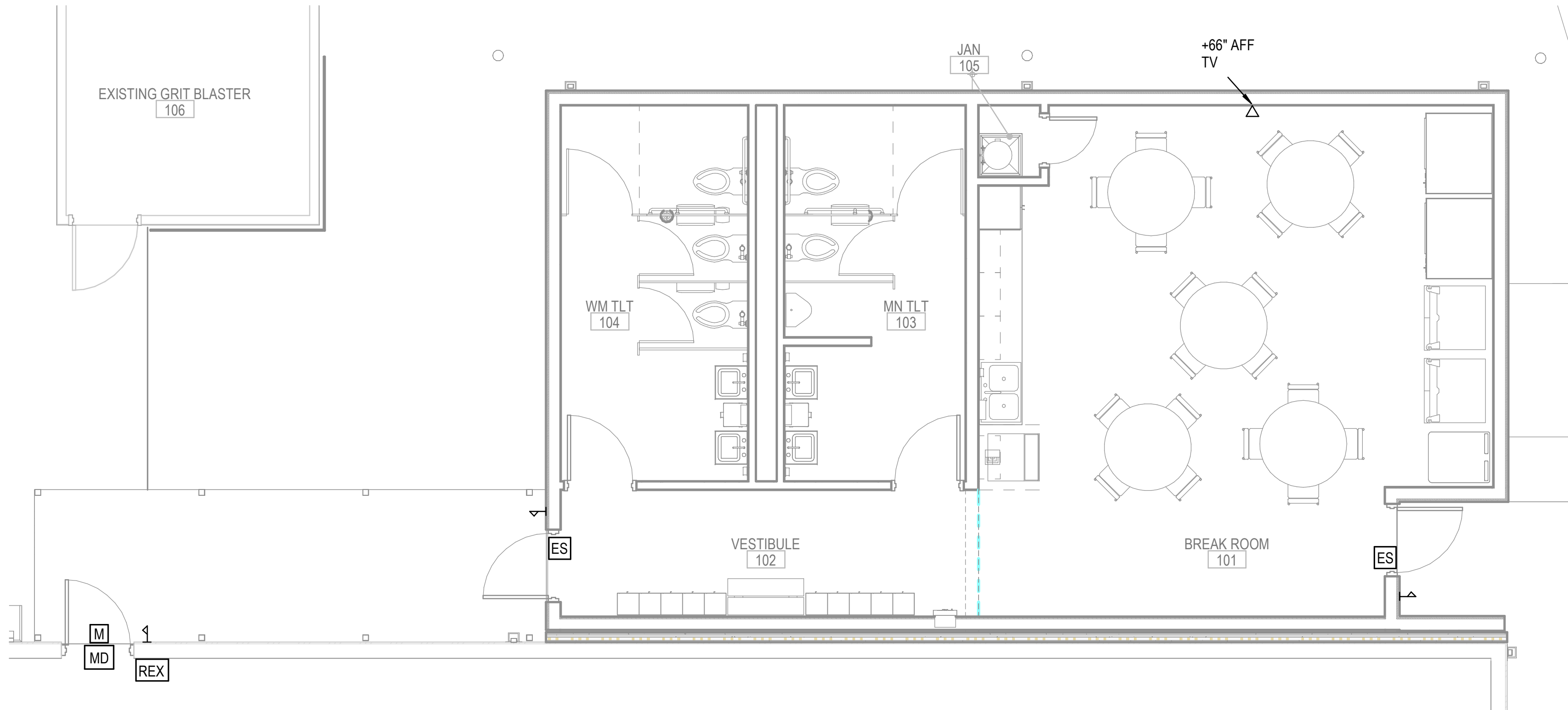

1 SYSTEMS PLAN - AREA A

1/4" = 1'-0"

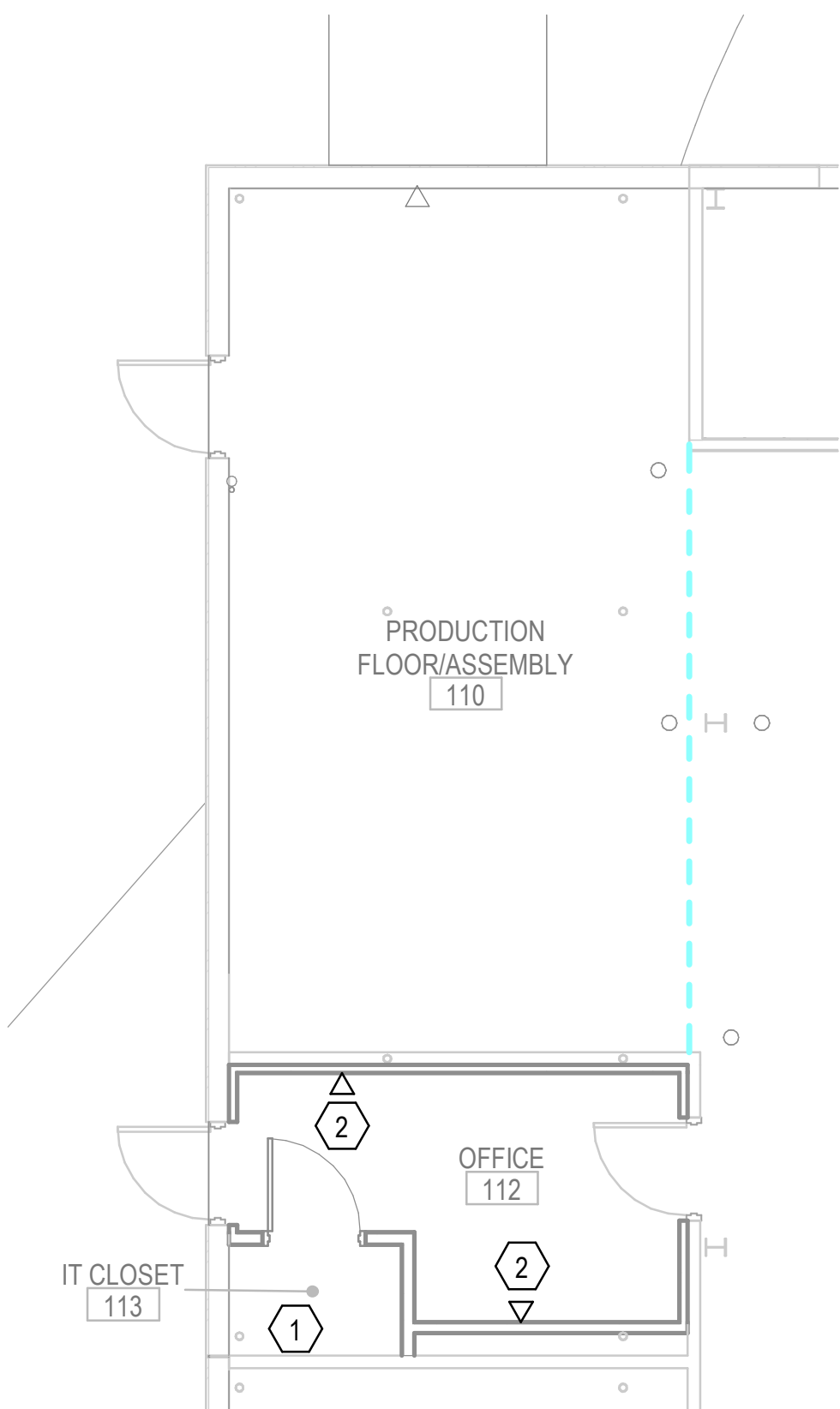
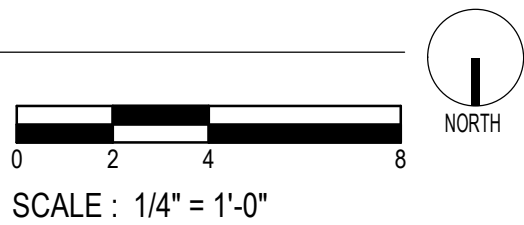

2 SYSTEMS PLAN - AREA C

3/16" = 1'-0"

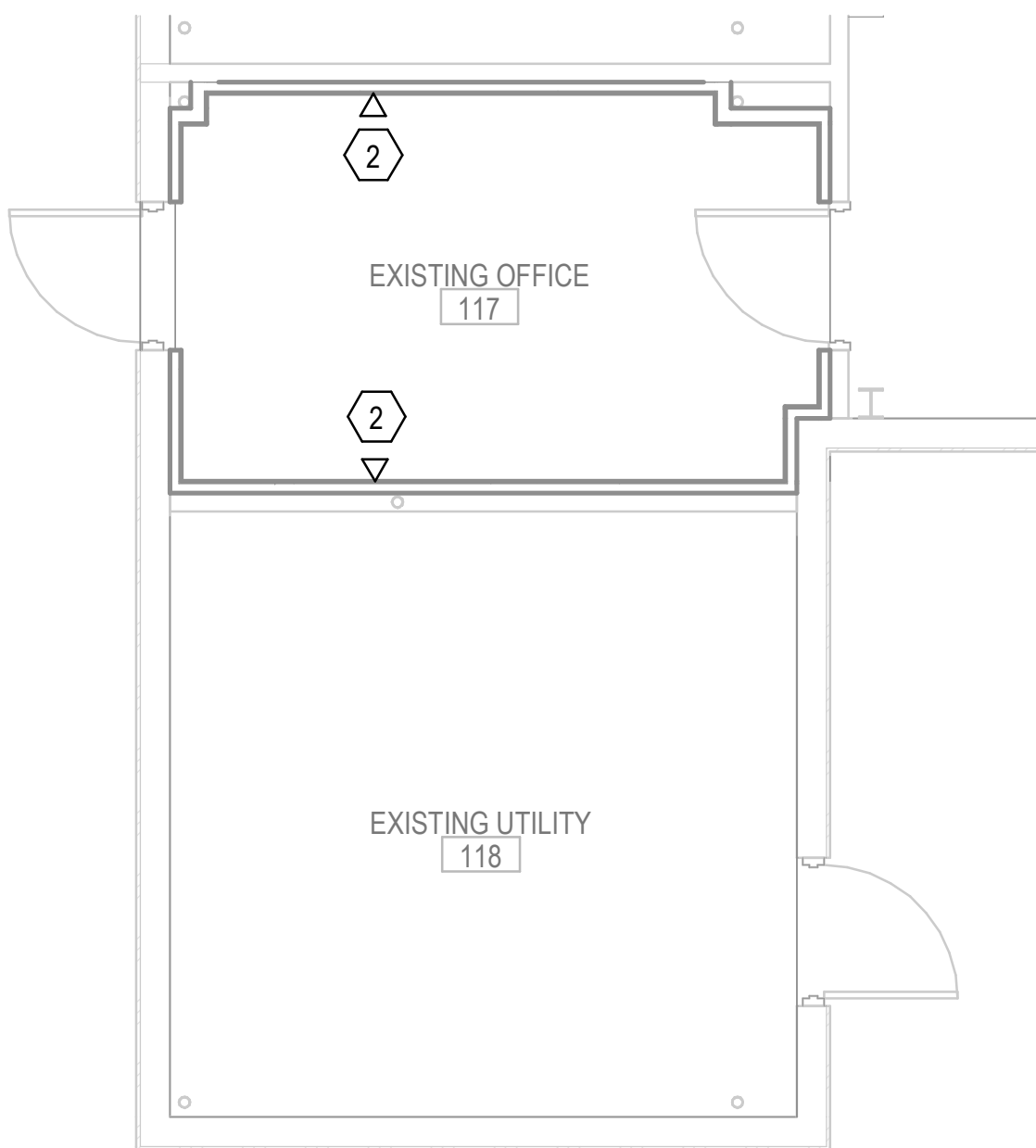
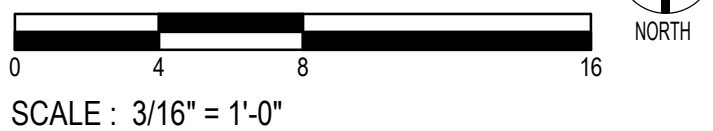

3 SYSTEMS PLAN - AREA D

1/4" = 1'-0"

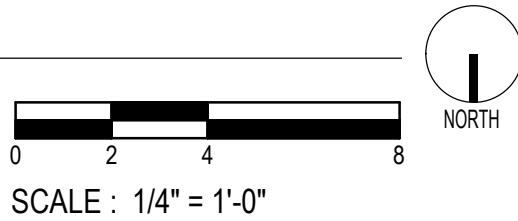

GENERAL NOTES:

- A. FIELD VERIFY EXISTING PATCH PANEL CAPACITY. PROVIDE 24 COPPER PATCH PANEL IF EXISTING PATCH PANEL IS FULL. MATCH NEW PATCH PANEL MANUFACTURER WITH THE MANUFACTURER OF EXISTING IT EQUIPMENT.

KEYED NOTES:

- 1 EXISTING IT RACK. ROUTE DATA CABLING TO EXISTING PATCH PANEL IN IT CABINET. FIELD VERIFY LOCATION OF IT CABINET IN CLOSET.
- 2 ROUTE CAT6 CABLES FROM DATA OUTLET TO PATCH PANEL IN IT CLOSET. THE INTENT IS TO TERMINATE NEW DATA OUTLETS TO EXISTING IT CIRCUITS.

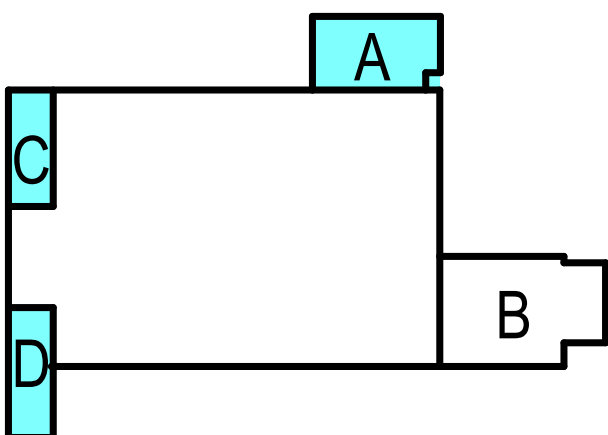

KEY PLAN