

File: L:\2021\21A10111 - LT Fire Suppression Improvements\Drawings\LT_FS_IMP-FA-101.dwg, Last Save: 4/22/2025 5:28 PM, Last saved by: ICrabtree, Last plotted by: Crabtree, lassoc C. (Cooper) Plot Style: AECmono.ctb Plot Scale: 1" = 1' Plot Date: 5/2/2025 1:27 PM Plotter used: AutoCAD PDF (General Documentation).pc3

KEYED NOTES

- 1
- INSTALL NEW SMOKE DETECTOR ABOVE NEW FIRE SUPPRESSION RELEASE PANEL WITH IN DESIGNATED FIRE SUPPRESSION ROOMS. CONNECT SMOKE DETECTORS TO EXISTING FIRE ALARM PANEL.
- 2
- INSTALL NEW FLOW AND TAMPER SWITCHES AT EXISTING FIRE RISER.

DEMOLITION NOTES:

1.
- MAINTAIN AND PROTECT EXISTING SERVICES WHICH TRANSIT THE AREAS AFFECTED BY SELECTIVE DEMOLITION.
2.
- MAINTAIN CIRCUIT CONTINUITY TO ALL EXISTING SYSTEM EQUIPMENT, DEVICES, ETC., TO REMAIN IN USE WHETHER NOTED ON THE PLANS OR NOT. FIELD VERIFY EXISTING ITEMS TO REMAIN IN USE. WIRING FOR EXISTING DEVICES WHICH MUST BE RE-ROUTED OR WHICH ARE PARTIALLY ABANDONED, SHALL BE RECONNECTED TO SERVICE THE REMAINING DEVICES ON THE CIRCUIT.
3.
- THE INTENTION OF THE ELECTRICAL DEMOLITION IS TO DISCONNECT AND REMOVE ALL ELECTRICAL WORK MADE VOID BY THE SCOPE OF THE CONSTRUCTION AND ALTERATION. FIELD VERIFY EXACT MATERIAL QUANTITIES REQUIRED TO BE REMOVED.
4.
- ALL REMOVED MATERIALS, OTHER THAN REMOVED MATERIALS TO BE RELOCATED, OR TURNED OVER TO THE OWNER, SHALL BECOME THE PROPERTY OF THE CONTRACTOR AND SHALL BE REMOVED FROM THE PROJECT SITE.
5.
- COORDINATE ALL DEMOLITION WORK WITH ALL OTHER TRADES.
6.
- FOR EXISTING ELECTRICAL EQUIPMENT TO BE REMOVED, DEMOLISH ALL EQUIPMENT, DEVICES, CIRCUITS, CONDUITS, BOXES, AND OTHER APPURTENANCES AS REQUIRED FOR A COMPLETE REMOVAL.
7.
- IN THE DEMOLITION WORK, REMOVE ALL CABLING ASSOCIATED WITH SYSTEMS BEING REMOVED UNDER THIS PROJECT BACK TO SOURCE. NO CABLE SHALL BE LEFT ABANDONED IN PLACE. REMOVE ALL UNUSED AND EMPTY CONDUIT THAT IS EXPOSED OR WITHIN ACCESSIBLE CEILINGS WHICH IS AFFECTED BY AND IS IN THE AREA OF THE WORK OF THIS CONTRACT.
8.
- WHERE WORK IS TO BE PERFORMED ABOVE EXISTING ACCESSIBLE CEILINGS, CONTRACTOR SHALL BE RESPONSIBLE FOR REMOVING CEILING TIES AND GRID WITHOUT DAMAGE, STORAGE OF EXISTING TILES AND GRID WHILE WORK IS BEING PERFORMED, AND INSTALLATION OF EXISTING GRID AND TILES AFTER WORK IS COMPLETED.

CONSTRUCTION NOTES:

1.
- ALL ELECTRICAL CABLES SHALL BE CLEARLY IDENTIFIED, LABELED, AND TAGGED AT ALL POINTS WHERE THEY ARE AVAILABLE FOR CONNECTIONS OR INSPECTION, INCLUDING, BUT NOT LIMITED TO MANHOLES, HANDHOLES, PULL BOXES, JUNCTION BOXES, AND LIGHT BASES.
2.
- CONDUITS AND DUCTS UNDER PAVED AREAS SHALL BE CONCRETE ENCASED.
3.
- CONDUITS AND DUCTS UNDER NON-PAVED AREAS SHALL BE NON-ENCASED, UNLESS OTHERWISE NOTED.
4.
- DURING CONSTRUCTION, PROTECT ALL EQUIPMENT, DUCTS, CONDUITS, CABLES, ETC. THAT ARE TO REMAIN IN PLACE. WHERE EXISTING ITEMS ARE CUT, BROKEN, OR DAMAGED, THE CONTRACTOR SHALL REPLACE OR REPAIR PROACTIVELY AND EXPEDITIOUSLY THE ITEMS WITH THE SAME TYPE OF ORIGINAL MATERIAL AND CONSTRUCTION OR BETTER AT NO ADDITIONAL COST TO THE OWNER AND TO THE SATISFACTION OF THE OWNER AND ENGINEER.

GENERAL NOTES:

1.
- FIRE ALARM SYSTEM MODIFICATIONS SHALL BE PERFORMED BY JOHNSON CONTROLS INC. UNDER ALLOWANCE PAY ITEM.
2.
- JOHNSTON CONTROLS SHALL UPDATE TRUE SITE WORKSTATION PROGRAM AND GRAPHICS TO INCLUDE NEW EQUIPMENT AND WORK PERFORMED.
3.
- REFER TO ARCHITECTURAL AND FIRE SUPPRESSION PLANS FOR MORE INFORMATION.

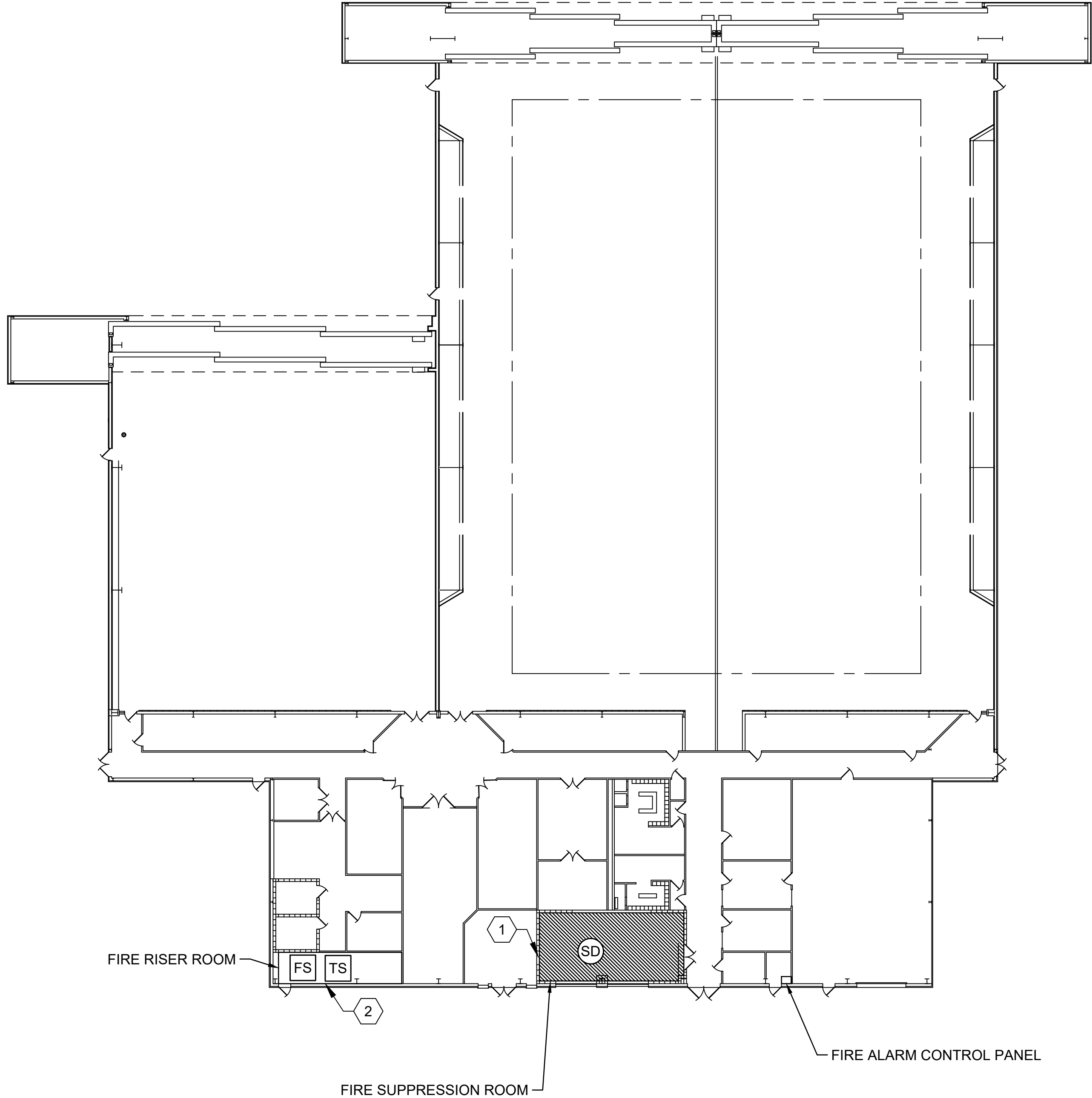

1
EP-609

BUILDING 400
SCALE: 1" = 20'

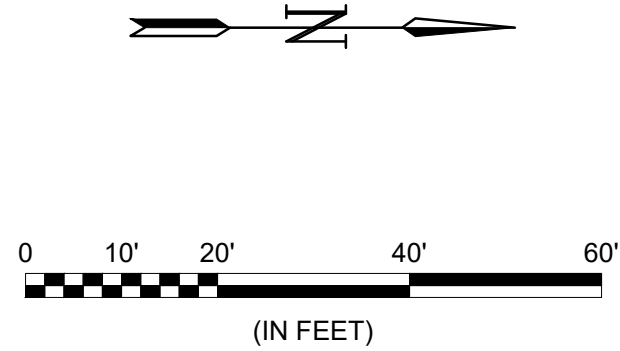

© 2025 GARVER, LLC
THIS DOCUMENT, ALONG WITH THE IDEAS AND DESIGNS CONVEYED HEREIN, SHALL BE CONSIDERED INSTRUMENTS OF PROFESSIONAL SERVICE AND ARE PROPERTY OF GARVER, LLC. ANY USE, REPRODUCTION, OR DISTRIBUTION OF THIS DOCUMENT, ALONG WITH THE IDEAS AND DESIGN CONTAINED HEREIN, IS PROHIBITED UNLESS AUTHORIZED IN WRITING BY GARVER, LLC OR EXPLICITLY ALLOWED IN THE GOVERNING PROFESSIONAL SERVICES AGREEMENT FOR THIS WORK.



Digitally Signed 05/02/2025

BY	
REV	
DATE	
DESCRIPTION	

BILL AND HILLARY CLINTON
NATIONAL AIRPORT
LITTLE ROCK, AR 72206
FIRE SUPPRESSION
IMPROVEMENTS

FIRE ALARM PLAN
BUILDING 400

JOB NO.: 21A10111
DATE: MAY 2025
DESIGNED BY: NAH
DRAWN BY: ICC

BAR IS ONE INCH ON ORIGINAL DRAWING
0 1"
IF NOT ONE INCH ON THIS SHEET, ADJUST SCALES ACCORDINGLY.

DRAWING NUMBER
FA-103