

Quality People. Building Solutions.

Comfort Systems USA (Arkansas), Inc.
P.O. Box 16620
Little Rock, AR 72231
Phone 501-834-3320
Fax 501-834-5416

Date: 10/18/2024
Return Request: 11/1/2024
Project: UAMS (CAMID)
Supplier: Middleton
Manufacturer: Titus
Submittal: Air Outlets & Inlets
Submittal Number: 23 37 00-01
Drawing # and Installation: Mechanical Drawings

ARCHITECT

Clark Kenersen
2020 Baltimore Avenue, Suite 300
Kansas City, MO 64108
816-474-8237

ENGINEER

Clark Kenersen
2020 Baltimore Avenue, Suite 300
Kansas City, MO 64108
816-474-8237

GENERAL CONTRACTOR

CDI Contractors
3000 Cantrell Rd.
Little Rock, AR 72202
501-666-4300

MECHANICAL SUBCONTRACTOR

Comfort Systems USA (Arkansas), Inc.
9924 Landers Rd.
N. Little Rock, AR 72117
501-834-3320

Notes:

CSUSA PROJECT NO.

22-6069

sean@comfortar.com

9924 Landers Rd.
No. Little Rock, AR 72117

MIDDLETON, INC

P.O. BOX 506 BRYANT, AR 72089

TELEPHONE (501) 224-4888

LICENSE # 0225670422

Email: dsingleton@middletoninc.com

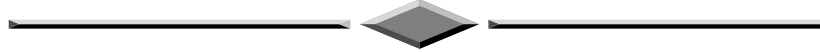

HVAC SUBMITTALS

10-17-24

PROJECT: UAMS Center for Animal Models of Infection & Disease
CONTRACTOR: Comfort Systems

PREPARED BY: David Singleton – **Middleton, Inc.**

CONTENTS

FURNISHED BY: **MIDDLETON, INC.**

Submittal Items 233700 – Air Outlets & Inlets



SUBMITTAL

UAMS Center for Animal Models of Infection & Disease

**Powers of Arkansas
5440 Northshore Drive
North Little Rock, AR 72118**

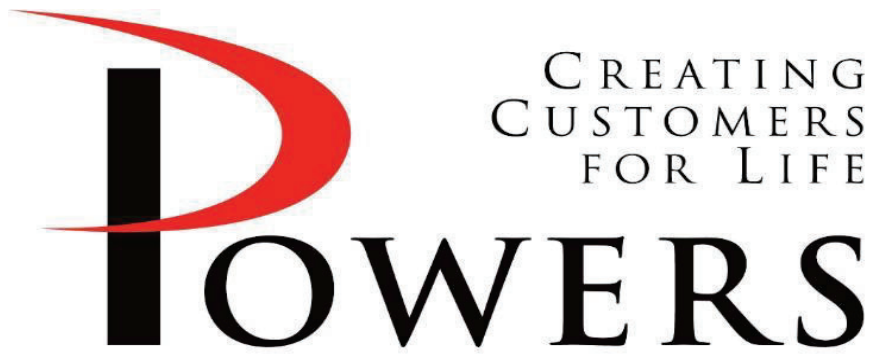

SUBMITTAL

PRODUCT	Air Devices
MANUFACTURER	Titus
JOB NAME	UAMS Center for Animal Models of Infection & Disease
LOCATION	Little Rock, AR
ENGINEER	James R. Beecher
CONTRACTOR	Middleton Inc.
DATE	10/16/2024
SUBMITTED BY	Chris Atwood

5440 Northshore Drive - North Little Rock, Arkansas 72118 - Tel: 501.374.5420 Fax: 501.370.9298

Schedule



Date/Time: 10/16/2024 12:11:45
Job: UAMS Center for Animal Models of Infecti
Project:
Customer:
Sales Person:

Current Version: 2014.0.571
 Modified Version: 2014.0.571

Model	Quantity	Tag	DIM 1	DIM 2	Module	Border	Finish	Pattern	Damper	Accessory 1	Accessory 2	Accessory 3	Comments
OMNI-AA	2	D-1	6" DIAMETER		24X24	3 - LAY-IN	26 - WHITE		D-75 - ROUND NECK-MOUNTED OBD	NONE	NONE	TRM - Rapid Mount Frame-Aluml	
OMNI-AA	40	D-1	8" DIAMETER		24X24	3 - LAY-IN	26 - WHITE		D-75 - ROUND NECK-MOUNTED OBD	NONE	NONE	TRM - Rapid Mount Frame-Aluml	
OMNI-AA	27	D-1	10" DIAMETER		24X24	3 - LAY-IN	26 - WHITE		D-75 - ROUND NECK-MOUNTED OBD	NONE	NONE	TRM - Rapid Mount Frame-Aluml	
OMNI-AA	1	D-3	6" DIAMETER		24X24	3 - LAY-IN	26 - WHITE		0 - NONE	NONE	NONE	TRM - Rapid Mount Frame-Aluml	
OMNI-AA	3	D-3	8" DIAMETER		24X24	3 - LAY-IN	26 - WHITE		0 - NONE	NONE	NONE	TRM - Rapid Mount Frame-Aluml	

Model	Quantity	Tag	Length	Slots/Width	End Border/Module Width/Angle	Border	Finish	Fastening/Throw	Damper/Miter Type	Accessory 1	Accessory 2	Accessory 3	Comments
ML-39	1	D-2 GYP BD	36	2 SLOTS	XX - TWO END BORDERS	2A - CONCEALED MOUNT	26 - WHITE			NONE	NONE	NONE	
ML-39	2	D-2 GYP BD	48	2 SLOTS	XX - TWO END BORDERS	2A - CONCEALED MOUNT	26 - WHITE			NONE	NONE	NONE	

ML-39	5	D-2 GYP BD	60	2 SLOTS	XX - TWO END BORDERS	2A - CONCEALED MOUNT	26 - WHITE			NONE	NONE	NONE
ML-39	2	D-2 GYP BD	96	2 SLOTS	XX - TWO END BORDERS	2A - CONCEALED MOUNT	26 - WHITE			NONE	NONE	NONE
ML-39	4	D-2 GYP BD	120	2 SLOTS	XX - TWO END BORDERS	2A - CONCEALED MOUNT	26 - WHITE			NONE	NONE	NONE
ML-39	1	D-2 GYP BD	240	2 SLOTS	XX - TWO END BORDERS	2A - CONCEALED MOUNT	26 - WHITE			NONE	NONE	NONE
ML-39	1	D-2 LAYIN	47	2 SLOTS	XX - TWO END BORDERS	1B - DUCT MOUNT	26 - WHITE			NONE	NONE	NONE
ML-39	1	D-2 LAYIN	71	2 SLOTS	XX - TWO END BORDERS	1B - DUCT MOUNT	26 - WHITE			NONE	NONE	NONE

Model	Quantity	Tag	Length	Slots	Width/Throw	Plenum Inlet	Module	Border	Finish	Damper	Accessory 1 / Configuration	Accessory 2	Accessory 3	Comments
MPI-39	1	D-2 GYP BD	36 INCHES	2LP - 2 SLOT LOW PROFILE		8 INCH		2A - CONCEALED MOUNT		0 - NONE	XX - TWO END BORDERS	STRAIGHT		
MPI-39	6	D-2 GYP BD	48 INCHES	2LP - 2 SLOT LOW PROFILE		8 INCH		2A - CONCEALED MOUNT		0 - NONE	XX - TWO END BORDERS	STRAIGHT		

MPI-39	17	D-2 GYP BD	60 INCHES	2LP - 2 SLOT LOW PROFILE		8 INCH		2A - CONCEALED MOUNT		0 - NONE	XX - TWO END BORDERS	STRAIGHT	
MPI-39	1	D-2 LAYIN	48 INCHES	2LP - 2 SLOT LOW PROFILE		8 INCH		1B - DUCT MOUNT		0 - NONE	XX - TWO END BORDERS	STRAIGHT	
MPI-39	1	D-2 LAYIN	72 INCHES	2LP - 2 SLOT LOW PROFILE		8 INCH		1B - DUCT MOUNT		0 - NONE	XX - TWO END BORDERS	STRAIGHT	

Model	Quantity	Tag	Size/Length	End Border/# Inlets	Module/Height	Pattern/Width	Border	Finish	Accessory 1	Accessory 2/Plenum	Accessory 3/Corners	Comments
TRITEC-AL	2	D-5	8" DIAMETER		24X24	2 - Hemispherical Pattern (2-way)		26 - WHITE	IP - Insulated Plenum			
TRITEC-AL	1	D-7	8" DIAMETER		24X24	2 - Hemispherical Pattern (2-way)		26 - WHITE	IP - Insulated Plenum			

Model	Quantity	Tag	Size/Length	End Border/# Inlets	Module/Height	Pattern/Width	Border	Finish	Accessory 1	Accessory 2/Plenum	Accessory 3/Corners	Comments
TRITEC-SS	5	D-6	8" DIAMETER		24X24	2 - Hemispherical Pattern (2-way)		26 - WHITE	IP - Insulated Plenum			

Model	Quantity	Tag	DIM 1	DIM 2	Module	Border	Finish	Pattern	Damper	Accessory 1	Accessory 2	Accessory 3	Comments
-------	----------	-----	-------	-------	--------	--------	--------	---------	--------	-------------	-------------	-------------	----------

PAR-AA	3	G-1	6" DIAMETER	NONE	24X24	3 - LAY-IN	26 - WHITE		D-75 - ROUND NECK-MOUNTED OBD	NONE	NONE	TRM - Rapid Mount Frame-Aluml
PAR-AA	9	G-1	8" DIAMETER	NONE	24X24	3 - LAY-IN	26 - WHITE		D-75 - ROUND NECK-MOUNTED OBD	NONE	NONE	TRM - Rapid Mount Frame-Aluml
PAR-AA	15	G-1	10" DIAMETER	NONE	24X24	3 - LAY-IN	26 - WHITE		D-75 - ROUND NECK-MOUNTED OBD	NONE	NONE	TRM - Rapid Mount Frame-Aluml
PAR-AA	6	G-1	12" DIAMETER	NONE	24X24	3 - LAY-IN	26 - WHITE		D-75 - ROUND NECK-MOUNTED OBD	NONE	NONE	TRM - Rapid Mount Frame-Aluml
PAR-AA	4	G-1	14" DIAMETER	NONE	24X24	3 - LAY-IN	26 - WHITE		AG-75 - DUCT MOUNTED ROUND OBD	NONE	NONE	TRM - Rapid Mount Frame-Aluml
PAR-AA	1	G-7	8" DIAMETER	NONE	24X24	3 - LAY-IN	26 - WHITE		D-75 - ROUND NECK-MOUNTED OBD	NONE	NONE	TRM - Rapid Mount Frame-Aluml
PAR-AA	3	G-7	10" DIAMETER	NONE	24X24	3 - LAY-IN	26 - WHITE		D-75 - ROUND NECK-MOUNTED OBD	NONE	NONE	TRM - Rapid Mount Frame-Aluml
PAR-AA	2	G-7	12" DIAMETER	NONE	24X24	3 - LAY-IN	26 - WHITE		D-75 - ROUND NECK-MOUNTED OBD	NONE	NONE	TRM - Rapid Mount Frame-Aluml

Model	Quantity	Tag	Width	Height	Module	Border	Fastening	Finish	Damper	Accessory - 1	Accessory - 2	Accessory - 3	Comments
350RLF1-SS	4	G-2	12	12	00 - None	1 - SURFACE MOUNT		26 - WHITE	T - TOP HINGE		Q - QUARTER TURN		

350RLF1-SS	7	G-2	14	14	00 - None	1 - SURFACE MOUNT		26 - WHITE	T - TOP HINGE		Q - QUARTER TURN	
------------	---	-----	----	----	-----------	-------------------	--	------------	---------------	--	------------------	--

Model	Quantity	Tag	Width	Height	Module	Border	Fastening	Finish	Damper	Accessory - 1	Accessory - 2	Accessory - 3	Comments
350RSF1-SS	2	G-2	16	12		1 - SURFACE MOUNT		26 - WHITE	T - TOP HINGE		Q - QUARTER TURN		
350RSF1-SS	6	G-2	18	14		1 - SURFACE MOUNT		26 - WHITE	T - TOP HINGE		Q - QUARTER TURN		
350RSF1-SS	1	G-2	18	16		1 - SURFACE MOUNT		26 - WHITE	T - TOP HINGE		Q - QUARTER TURN		
350RSF1-SS	1	G-2	20	18		1 - SURFACE MOUNT		26 - WHITE	T - TOP HINGE		Q - QUARTER TURN		

Model	Quantity	Tag	Width	Height	Module	Border	Fastening	Finish	Damper	Accessory - 1	Accessory - 2	Accessory - 3	Comments
350FL	1	G-6	12	8	NONE	1 - SURFACE MOUNT	A - SCREW HOLES	26 - WHITE	AG-15 - STEEL OBD	NONE	NONE	NONE	
350FL	4	G-6	18	8	NONE	1 - SURFACE MOUNT	A - SCREW HOLES	26 - WHITE	AG-15 - STEEL OBD	NONE	NONE	NONE	

Model	Quantity	Tag	Width	Height	Module	Border	Fastening	Finish	Damper	Accessory - 1	Accessory - 2	Accessory - 3	Comments
300FL	7	R-1	18	8	NONE	1 - SURFACE MOUNT	A - SCREW HOLES	26 - WHITE	AG-15 - STEEL OBD	NONE	NONE	NONE	

Model	Quantity	Tag	Width	Height	Module	Border	Fastening	Finish	Damper	Accessory - 1	Accessory - 2	Accessory - 3	Comments
D-75	2	D-5	8" DIAMETER					04 - MILL					
D-75	1	D-7	8" DIAMETER					04 - MILL					

OMNI-AA

Architectural Ceiling Diffusers
 Square Cone • Plaque Face
 Round Neck • Aluminum

Main Product **OMNIAA-1**

OMNI-AA

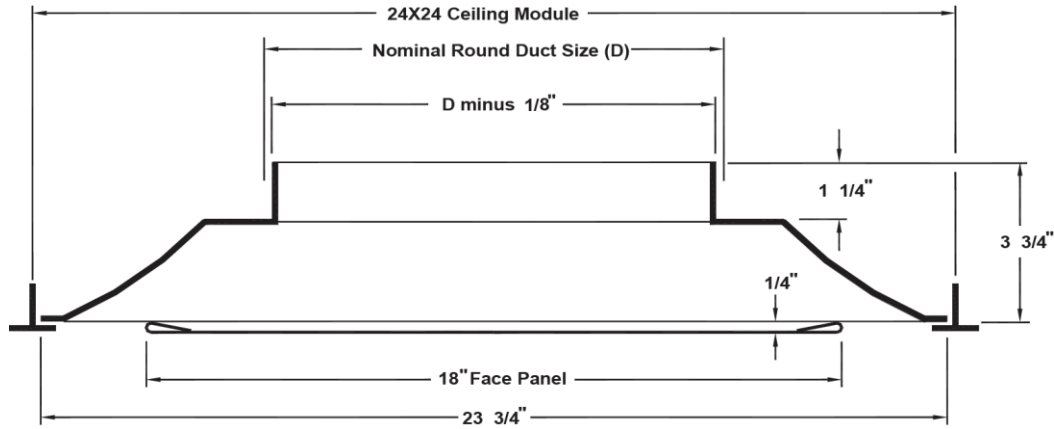

Border Type 3 (Lay-In) Full Face

Nominal Duct Size (D)	Neck Size
6" Dia.	5 7/8" Dia.
8" Dia.	7 7/8" Dia.

Lay-in:

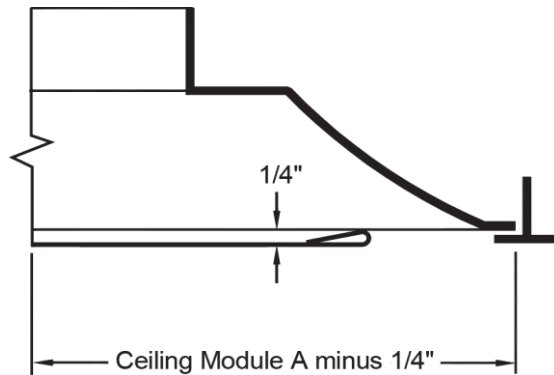

General Description **OMNIAA-1**

- The TITUS OMNI-AA diffuser is designed to satisfy architectural as well as engineering criteria. Its strong, clean, unobtrusive lines harmonize with the ceiling system, without sacrificing performance.
- The curvature of the OMNI-AA backpan works with the formed edges of the face panel to deliver a 360 tight horizontal air pattern, without excessive noise or pressure drop.
- The OMNI-AA diffuser is an excellent choice for variable volume systems. The air pattern remains tight and horizontal for effective room air distribution, even when the air volume varies over a wide range.
- The edges of the face panel are formed to a radius for solid, crisp appearance. The formed edges also stiffen the face panel and assure a straight and level surface.
- The panel can be removed from the backpan for easy installation of the diffuser or for access to the optional damper.

Option Schedule **OMNIAA-1**

ID	Quantity	Tag	DIM 1 NECK SIZE
1	2	D-1	6" DIAMETER
2	40	D-1	8" DIAMETER

MODULE SIZE 24X24
BORDER 3 - LAY-IN
FINISH 26 - WHITE
DAMPER MODEL D-75 - ROUND NECK-MOUNTED OBD

ACCESSORY 1 NONE
ACCESSORY 2 NONE
ACCESSORY 3 TRM - Rapid Mount Frame-AlumI

Accessories **OMNIAA-1**

Installing and Removing Face Panel

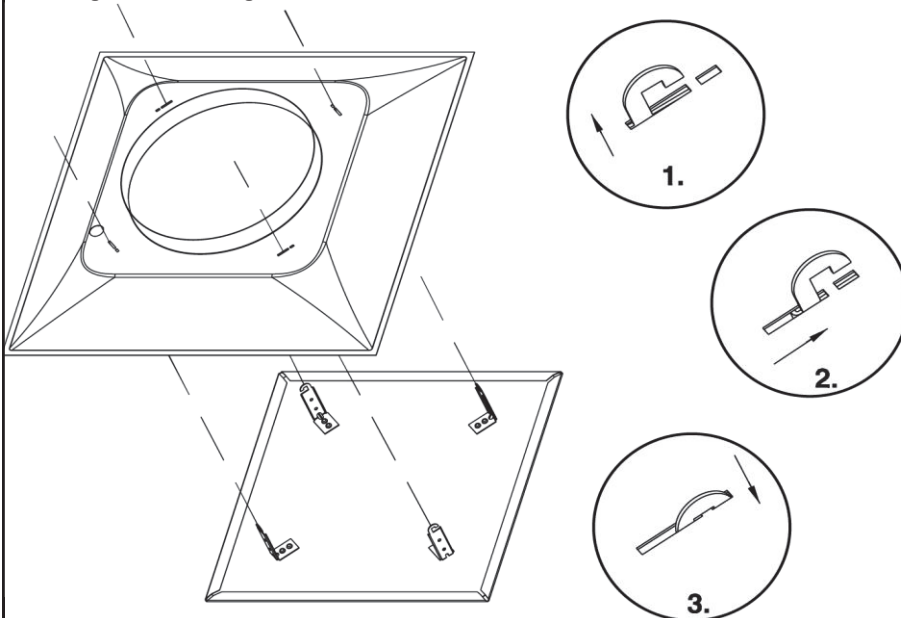

Installing Face Panel

1. Insert the hook brackets into the slots in the backpan.
2. Rotate the face panel clockwise until...
3. the hooks positively engage in the secondary slots in the backpan.

Removing Face Panel

1. Lift the faceplate towards the backpan to disengage the hook brackets from the backpan slots
2. Rotate the faceplate counter-clockwise
3. Lower the faceplate away from the backpan.

Adjusting Optional Damper

1. Remove face panel as above.
2. Use flat blade screwdriver to turn operator shaft at center of damper.
3. Replace face panel.

Accessories (continued) OMNIAA-1

D-75 Opposed Blade Damper

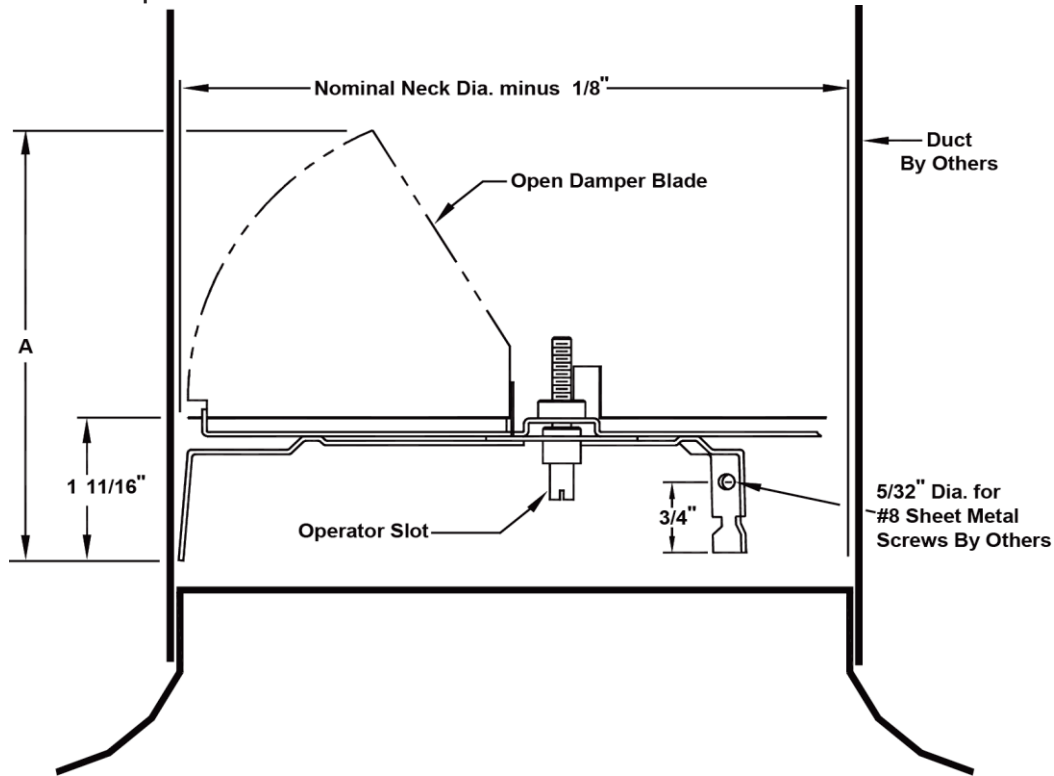

Standard Finish: Mill

- The Opposed Blade Damper is mounted inside the round duct neck.
- Three sets of gang operated blades distribute air evenly through the diffuser.
- Adjustable at screwdriver operator slot.
- Material: Galvanized steel.

TRM - Rapid Mount Frame

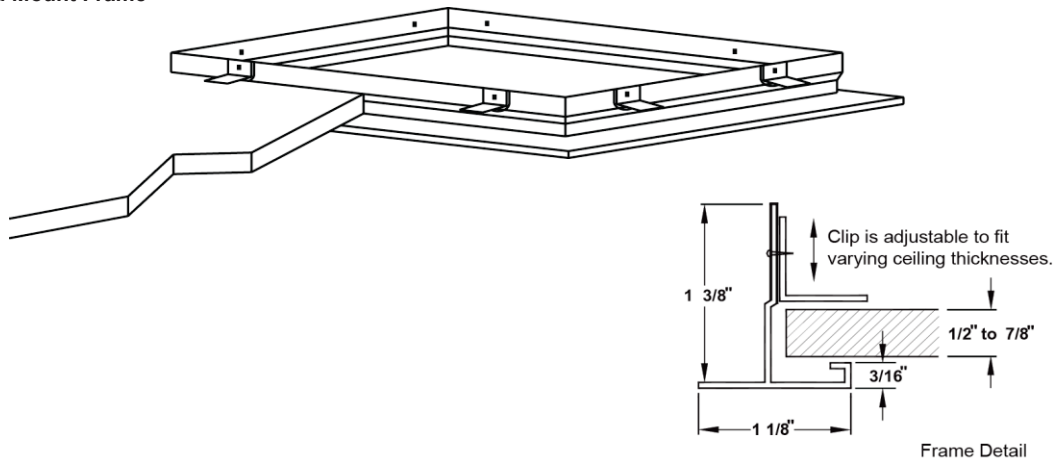

Project UAMS Center for Animal M
Architect
Engineer
Contractor
Designation D-1



Date 10/15/2024
Office Powers of Arkansas
Preparer Chris Atwood
Version 2014.0.571

Accessories (continued)		OMNIAA-1
MODULE SIZE	Cutout	
24X24	24 1/2" X 24 1/2"	

OMNI-AA

Architectural Ceiling Diffusers
 Square Cone • Plaque Face
 Round Neck • Aluminum

Main Product

OMNIAA-1 (2)

OMNI-AA

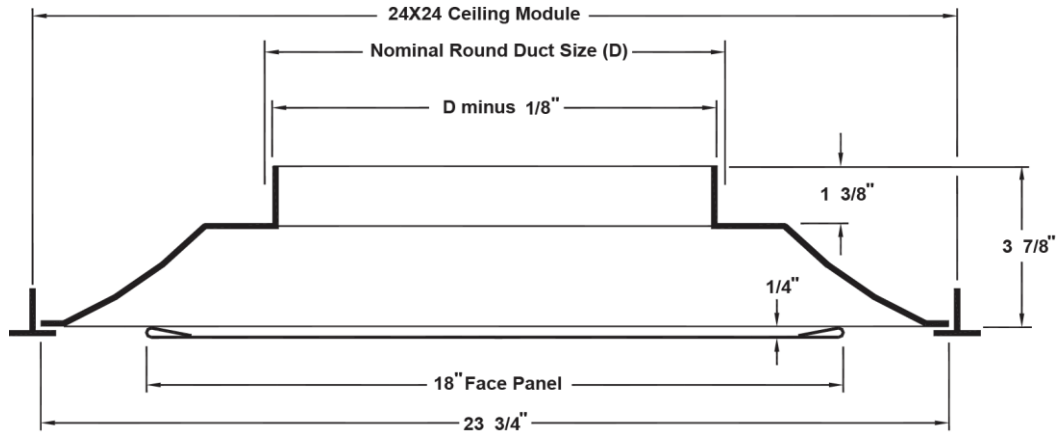

Border Type 3 (Lay-In) Full Face

Nominal Duct Size (D)	Neck Size
10" Dia.	9 7/8" Dia.

Lay-in:

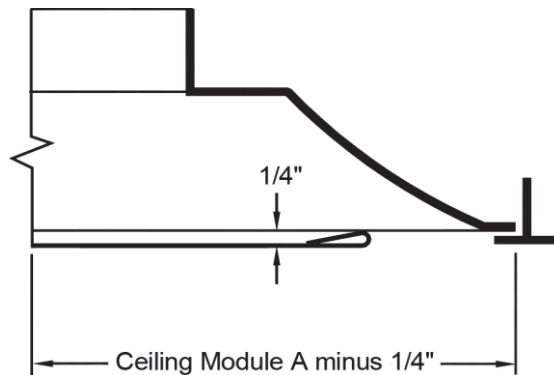

General Description **OMNIAA-1 (2)**

- The TITUS OMNI-AA diffuser is designed to satisfy architectural as well as engineering criteria. Its strong, clean, unobtrusive lines harmonize with the ceiling system, without sacrificing performance.
- The curvature of the OMNI-AA backpan works with the formed edges of the face panel to deliver a 360 tight horizontal air pattern, without excessive noise or pressure drop.
- The OMNI-AA diffuser is an excellent choice for variable volume systems. The air pattern remains tight and horizontal for effective room air distribution, even when the air volume varies over a wide range.
- The edges of the face panel are formed to a radius for solid, crisp appearance. The formed edges also stiffen the face panel and assure a straight and level surface.
- The panel can be removed from the backpan for easy installation of the diffuser or for access to the optional damper.

Option Schedule **OMNIAA-1 (2)**

ID	Quantity	Tag	DIM 1 NECK SIZE
3	27	D-1	10" DIAMETER

MODULE SIZE 24X24
BORDER 3 - LAY-IN
FINISH 26 - WHITE
DAMPER MODEL D-75 - ROUND NECK-MOUNTED OBD

ACCESSORY 1 NONE
ACCESSORY 2 NONE
ACCESSORY 3 TRM - Rapid Mount Frame-AlumI

Accessories **OMNIAA-1 (2)**

Installing and Removing Face Panel

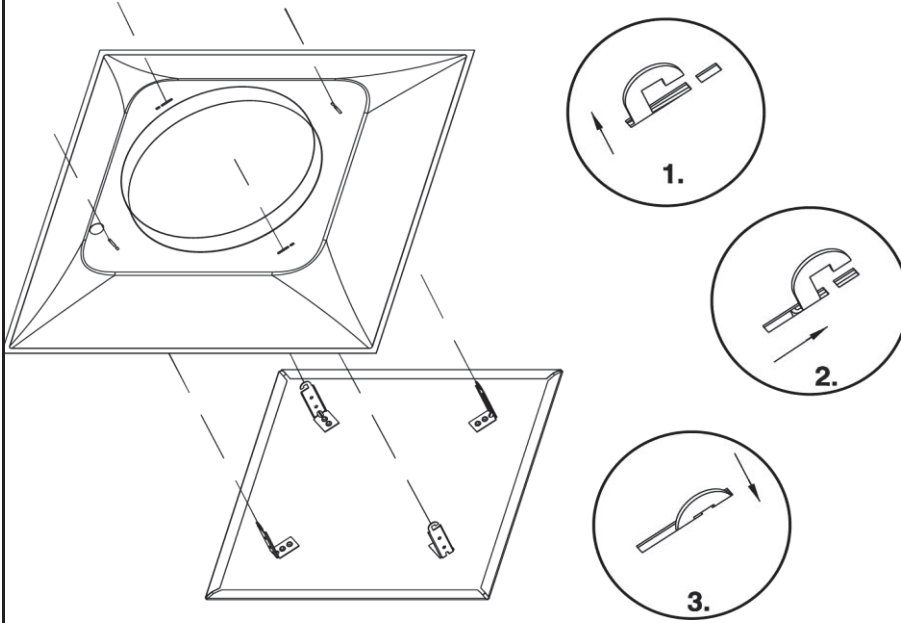

Installing Face Panel

1. Insert the hook brackets into the slots in the backpan.
2. Rotate the face panel clockwise until...
3. the hooks positively engage in the secondary slots in the backpan.

Removing Face Panel

1. Lift the faceplate towards the backpan to disengage the hook brackets from the backpan slots
2. Rotate the faceplate counter-clockwise
3. Lower the faceplate away from the backpan.

Adjusting Optional Damper

1. Remove face panel as above.
2. Use flat blade screwdriver to turn operator shaft at center of damper.
3. Replace face panel.

Accessories (continued) OMNIAA-1 (2)

D-75 Opposed Blade Damper

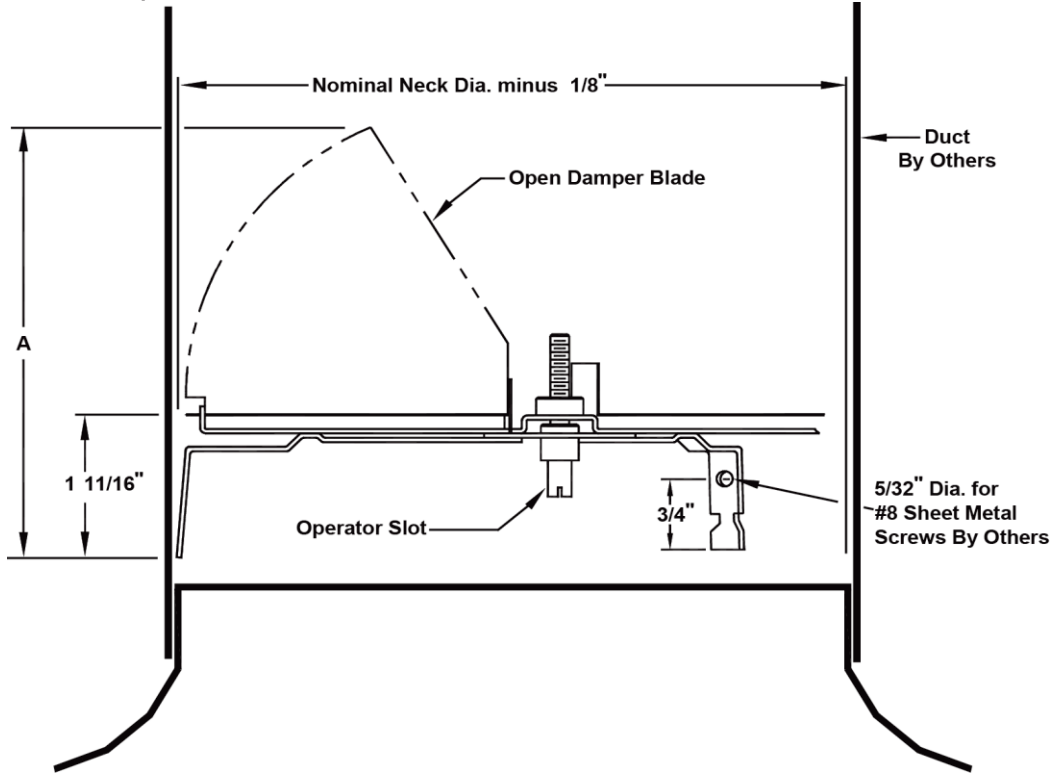

Standard Finish: Mill

- The Opposed Blade Damper is mounted inside the round duct neck.
- Three sets of gang operated blades distribute air evenly through the diffuser.
- Adjustable at screwdriver operator slot.
- Material: Galvanized steel.

TRM - Rapid Mount Frame

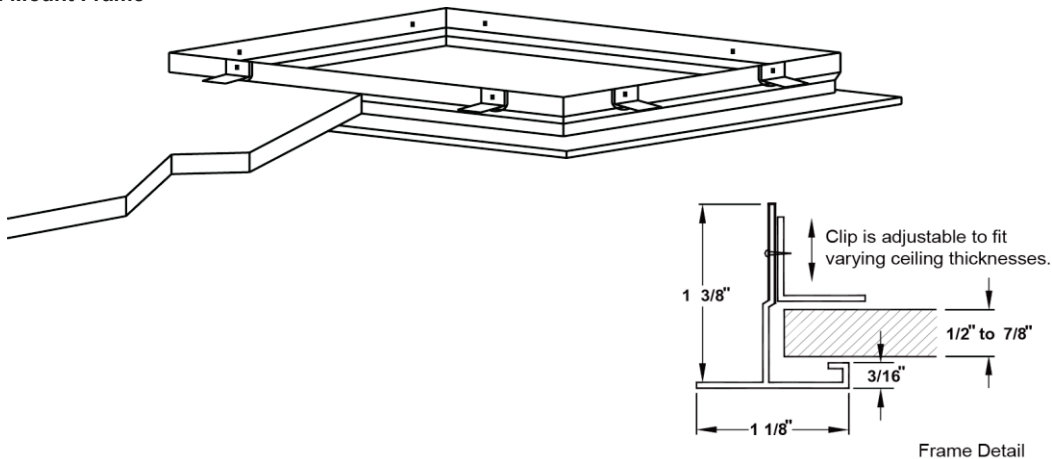

Project UAMS Center for Animal M
Architect
Engineer
Contractor
Designation D-1



Date 10/15/2024
Office Powers of Arkansas
Preparer Chris Atwood
Version 2014.0.571

Accessories (continued)		OMNIAA-1 (2)
MODULE SIZE	Cutout	
24X24	24 1/2" X 24 1/2"	

ML-39

ModuLinear supply diffuser with a 1" slot, Aluminum.

Main Product

ML39-1

ML-39

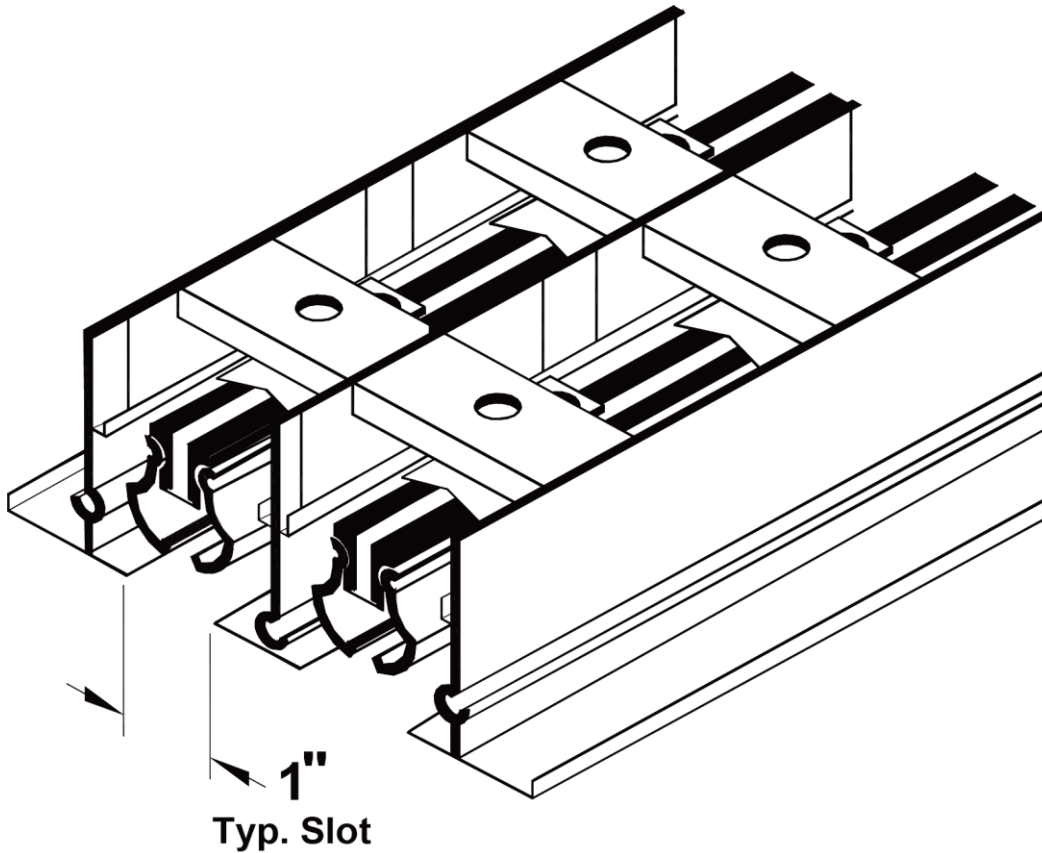

Duct Length	Cutout Width (D')	Neck Length (C)	OA Width (O')	OA Length (O)
36	4 1/4"	34.625	5"	36.75
48	4 1/4"	46.625	5"	48.75
60	4 1/4"	58.625	5"	60.75
96	4 1/4"	94.625	5"	96.75
120	4 1/4"	118.625	5"	120.75
240	4 1/4"	238.625	5"	240.75

Main Product (continued)

ML39-1

XX - End Borders, Supplied
 X-End

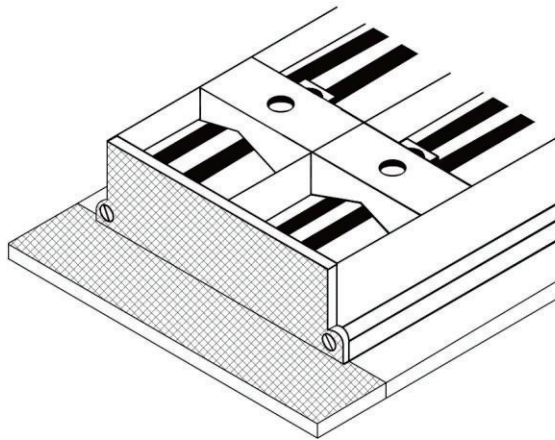
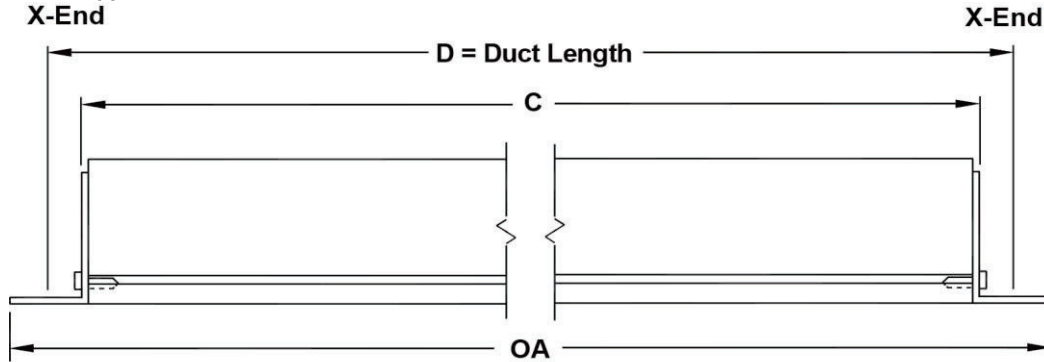

Border Type 2A, 2 slots, ML

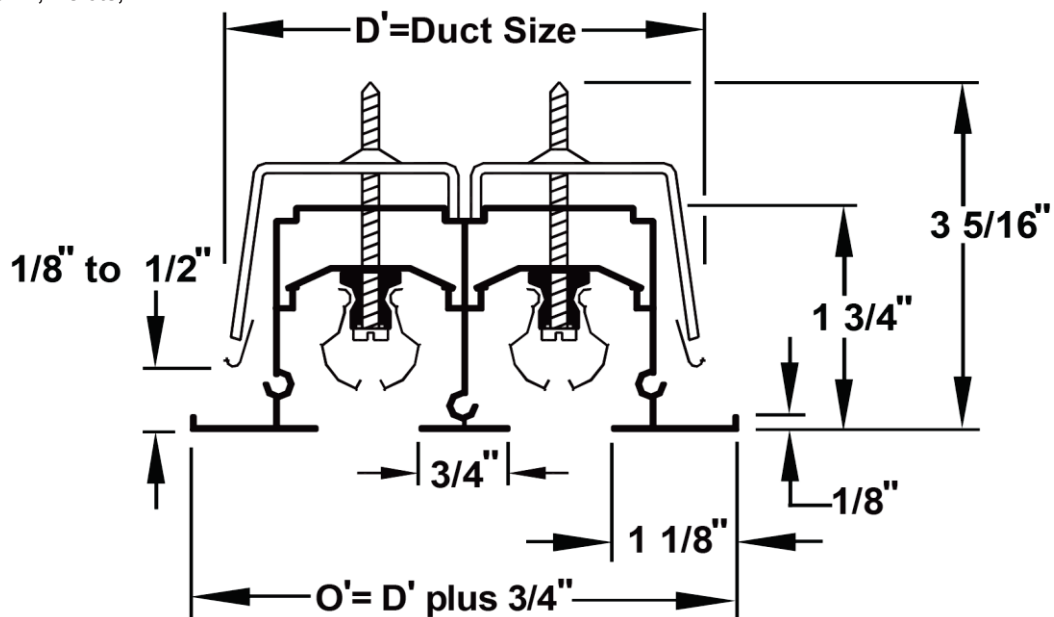

Project UAMS Center for Animal M
Architect
Engineer
Contractor
Designation D-2 (GYP BD)



Date 10/15/2024
Office Powers of Arkansas
Preparer Chris Atwood
Version 2014.0.571

General Description	ML39-1
Standard Finish: • #26 White border, Black pattern controllers. • Standard lengths of diffuser sections are 12", 24", 36", 48", 60" and 72". • Lengths greater than 72" are furnished in multiple sections, the number and size determined by the factory. • Pattern controllers change direction and volume of air flow. Maximum length is 36". • Pattern controllers are furnished in multiple sections for diffuser longer than 36". • Mounting frames are cut to length and assembled in the field. • Material is extruded aluminum with steel pattern controllers.	

Option Schedule				ML39-1
ID	Quantity	Tag	LINEAR LENGTH INCHES	
1	1	D-2 GYP BD	36	
2	2	D-2 GYP BD	48	
3	5	D-2 GYP BD	60	
5	2	D-2 GYP BD	96	
6	4	D-2 GYP BD	120	
7	1	D-2 GYP BD	240	
NO OF SLOTS 2 SLOTS END BORDER XX - TWO END BORDERS ML FRAME & BORDER 2A - CONCEALED MOUNT FINISH 26 - WHITE		ACCESSORY 1 NONE ACCESSORY 2 NONE ACCESSORY 3 NONE		

MPI-39

Insulated plenum for a ModuLinear ML-39.

Main Product

MPI39-1

MPI-39

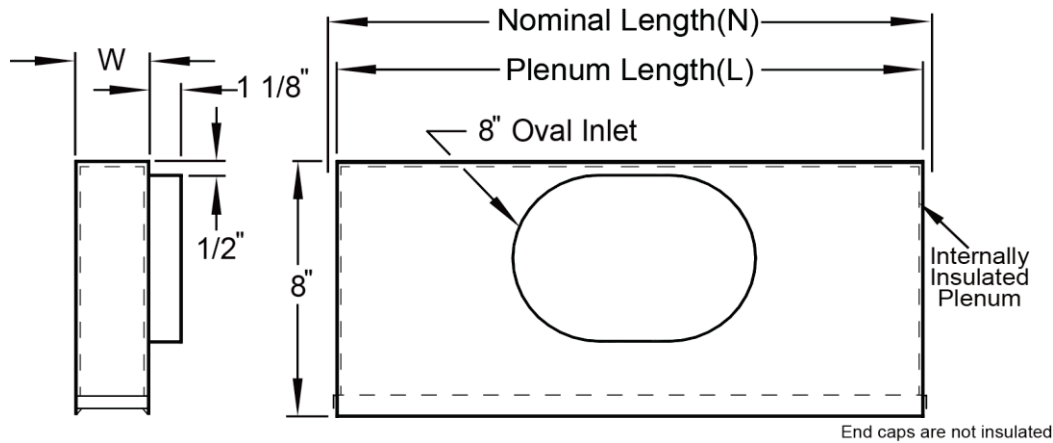

Nominal Plenum Length (N)	Plenum Length (L)	Oval Inlet Width	Oval Inlet Height
36 "	35 1/8"	9 3/8"	5 1/4"
48 "	47 1/8"	9 3/8"	5 1/4"
60 "	59 1/8"	9 3/8"	5 1/4"

Installation Mounting Detail with Two Slots Plenum 39

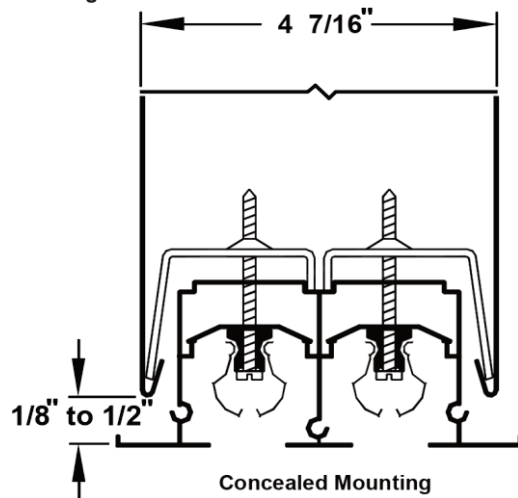

Project UAMS Center for Animal M
Architect
Engineer
Contractor
Designation D-2 PLENUM GYP



Date 10/15/2024
Office Powers of Arkansas
Preparer Chris Atwood
Version 2014.0.571

General Description	MPI39-1
<ul style="list-style-type: none"> • Model MP modulinear plenums are tailored for field attachment to ML or MLR modulinear diffusers. • End caps can be turned up to allow installing the MP on continuous runs of ML diffuser. • Model MP can be used as supply or return. • Material: Steel. 	

Option Schedule				MPI39-1
ID	Quantity	Tag	PLENUM LENGTH	
1	1	D-2 GYP BD	36 INCHES	
2	6	D-2 GYP BD	48 INCHES	
3	17	D-2 GYP BD	60 INCHES	
SLOTS/PLENUM HGT 2LP - 2 SLOT LOW PROFILE PLENUM INLET 8 INCH ML FRAME & BORDER 2A - CONCEALED MOUNT		END BORDER XX - TWO END BORDERS ACCESSORY 2 STRAIGHT		

ML-39

ModuLinear supply diffuser with a 1" slot, Aluminum.

Main Product

ML39-2

ML-39

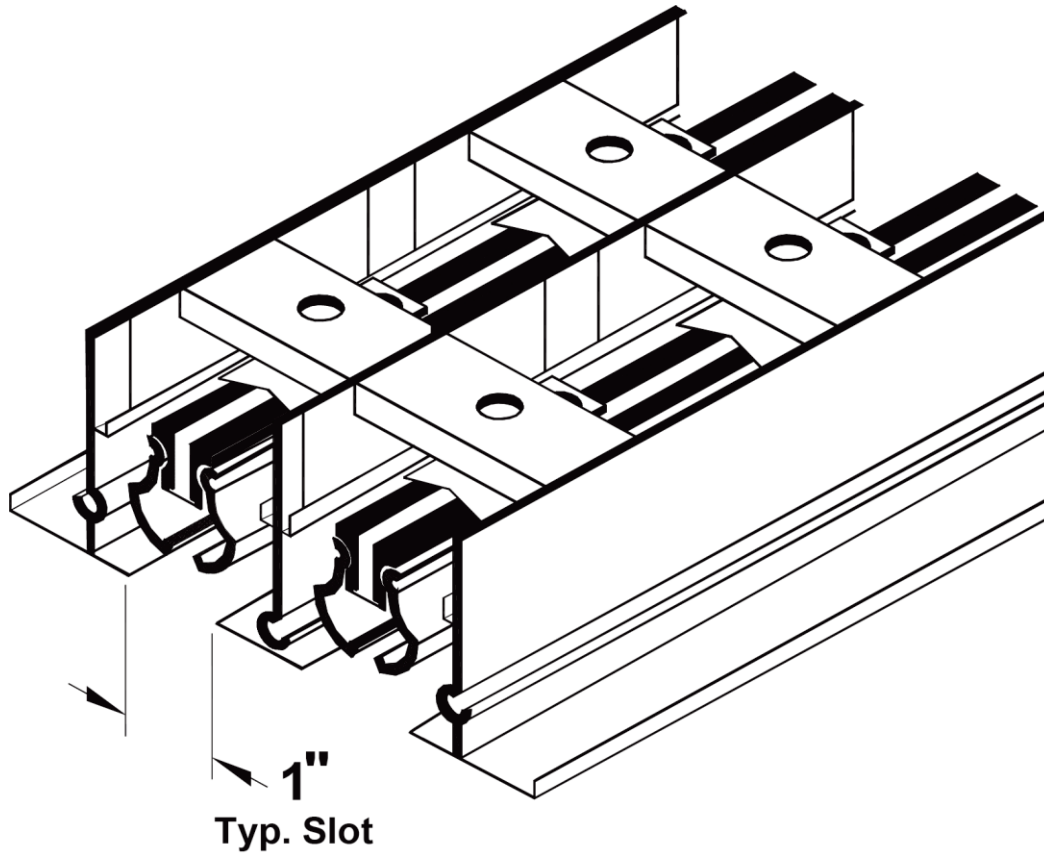

Duct Length	Cutout Width (D')	Neck Length (C)	OA Width (O')	OA Length (O)
47	4 1/8"	45.625	5"	47.75
71	4 1/8"	69.625	5"	71.75

Main Product (continued)

ML39-2

XX - End Borders, Supplied
X-End

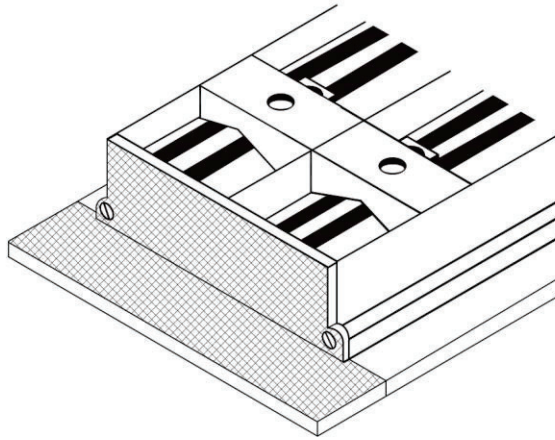
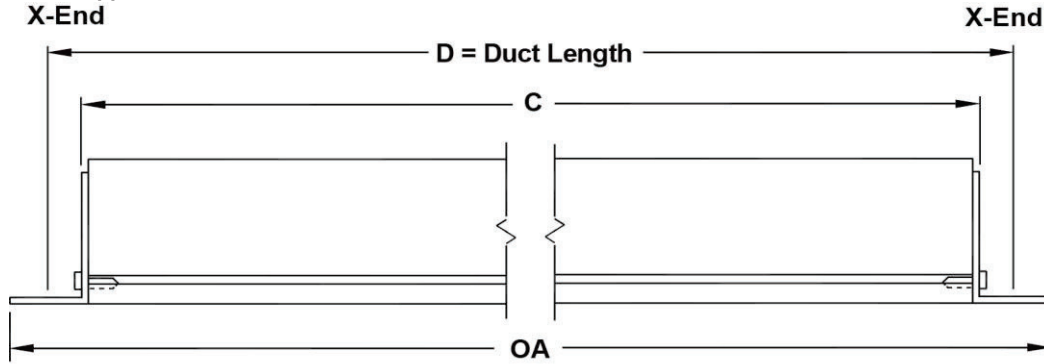

Main Product (continued)

ML39-2

Border Type 1B, 2 slots, ML

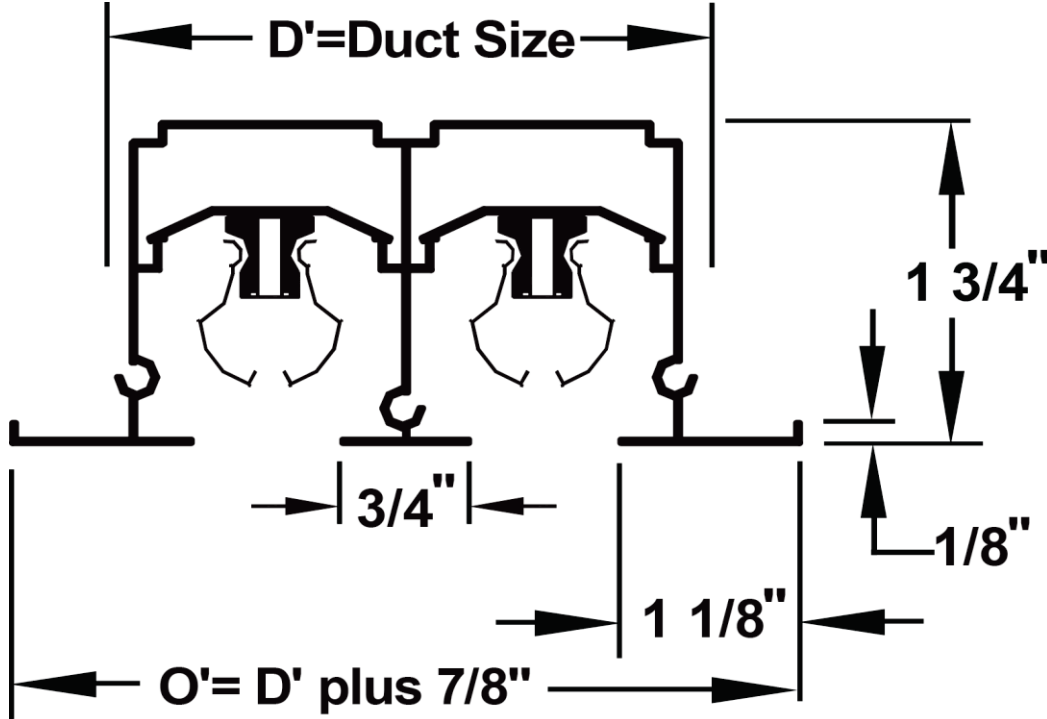

General Description

ML39-2

- Standard Finish: • #26 White border, Black pattern controllers.
- Standard lengths of diffuser sections are 12", 24", 36", 48", 60" and 72".
 - Lengths greater than 72" are furnished in multiple sections, the number and size determined by the factory.
 - Pattern controllers change direction and volume of air flow. Maximum length is 36". • Pattern controllers are furnished in multiple sections for diffuser longer than 36".
 - Mounting frames are cut to length and assembled in the field.
 - Material is extruded aluminum with steel pattern controllers.

Option Schedule

ML39-2

ID	Quantity	Tag	LINEAR LENGTH INCHES
2	1	D-2 LAYIN	47
4	1	D-2 LAYIN	71

NO OF SLOTS 2 SLOTS
END BORDER XX - TWO END BORDERS
ML FRAME & BORDER 1B - DUCT MOUNT
FINISH 26 - WHITE

ACCESSORY 1 NONE
ACCESSORY 2 NONE
ACCESSORY 3 NONE

MPI-39

Insulated plenum for a ModuLinear ML-39.

Main Product MPI39-2

MPI-39

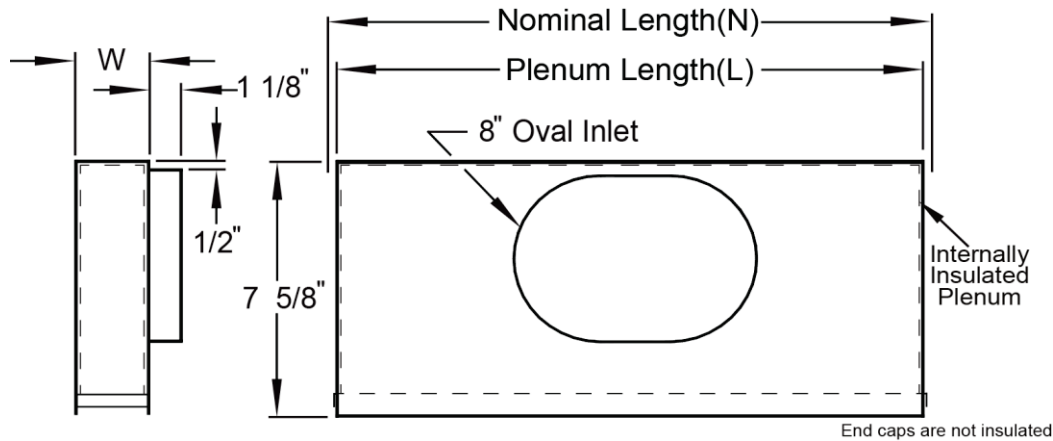

Nominal Plenum Length (N)	Plenum Length (L)	Oval Inlet Width	Oval Inlet Height
48 "	47 1/8"	9 3/8"	5 1/4"
72 "	71 1/8"	9 3/8"	5 1/4"

Installation Mounting Detail with Two Slot Plenum MP(I)-39

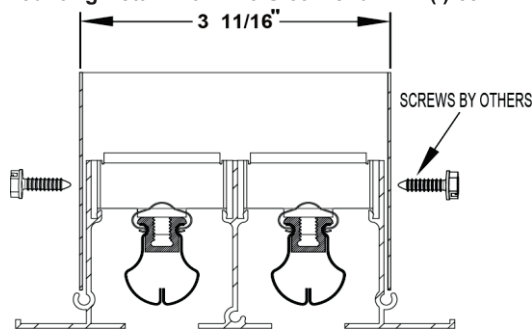

General Description MPI39-2

- Model MP modulinear plenums are tailored for field attachment to ML or MLR modulinear diffusers.
- End caps can be turned up to allow installing the MP on continuous runs of ML diffuser.
- Model MP can be used as supply or return.
- Material: Steel.

Option Schedule MPI39-2

ID	Quantity	Tag	PLENUM LENGTH
2	1	D-2 LAYIN	48 INCHES
4	1	D-2 LAYIN	72 INCHES

Project UAMS Center for Animal Mt
Architect
Engineer
Contractor
Designation D-2 PLENUM LAYIN



Date 10/15/2024
Office Powers of Arkansas
Preparer Chris Atwood
Version 2014.0.571

Option Schedule (continued)	MPI39-2
<p>SLOTS/PLENUM HGT 2LP - 2 SLOT LOW PROFILE PLENUM INLET 8 INCH ML FRAME & BORDER 1B - DUCT MOUNT</p>	<p>END BORDER XX - TWO END BORDERS ACCESSORY 2 STRAIGHT</p>

OMNI-AA

Architectural Ceiling Diffusers
 Square Cone • Plaque Face
 Round Neck • Aluminum

Main Product OMNIAA-2

OMNI-AA

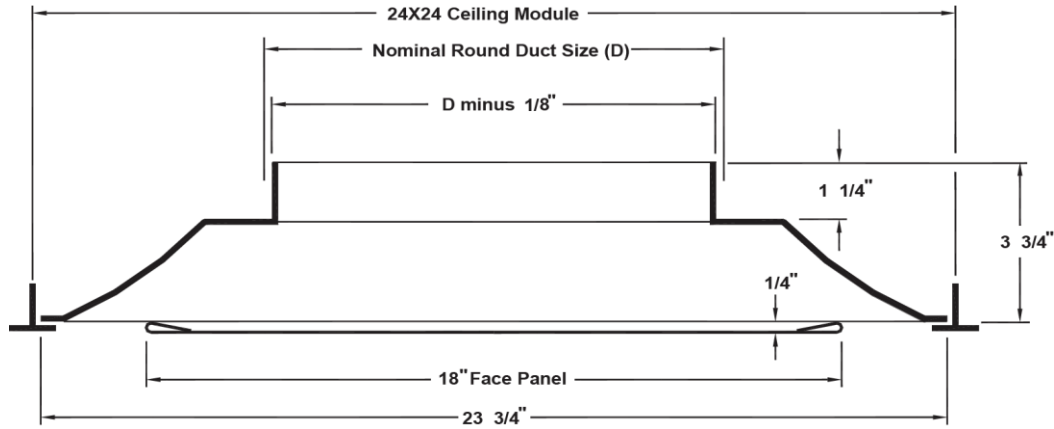

Border Type 3 (Lay-In) Full Face

Nominal Duct Size (D)	Neck Size
6" Dia.	5 7/8" Dia.
8" Dia.	7 7/8" Dia.

Lay-in:

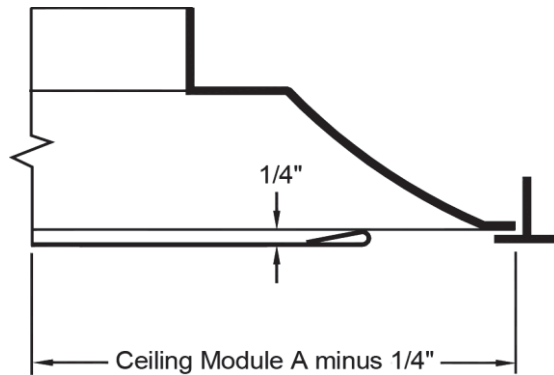

General Description **OMNIAA-2**

- The TITUS OMNI-AA diffuser is designed to satisfy architectural as well as engineering criteria. Its strong, clean, unobtrusive lines harmonize with the ceiling system, without sacrificing performance.
- The curvature of the OMNI-AA backpan works with the formed edges of the face panel to deliver a 360 tight horizontal air pattern, without excessive noise or pressure drop.
- The OMNI-AA diffuser is an excellent choice for variable volume systems. The air pattern remains tight and horizontal for effective room air distribution, even when the air volume varies over a wide range.
- The edges of the face panel are formed to a radius for solid, crisp appearance. The formed edges also stiffen the face panel and assure a straight and level surface.
- The panel can be removed from the backpan for easy installation of the diffuser or for access to the optional damper.

Option Schedule **OMNIAA-2**

ID	Quantity	Tag	DIM 1 NECK SIZE
4	1	D-3	6" DIAMETER
5	3	D-3	8" DIAMETER

MODULE SIZE 24X24
BORDER 3 - LAY-IN
FINISH 26 - WHITE
DAMPER MODEL 0 - NONE

ACCESSORY 1 NONE
ACCESSORY 2 NONE
ACCESSORY 3 TRM - Rapid Mount Frame-AlumI

Accessories **OMNIAA-2**

Installing and Removing Face Panel

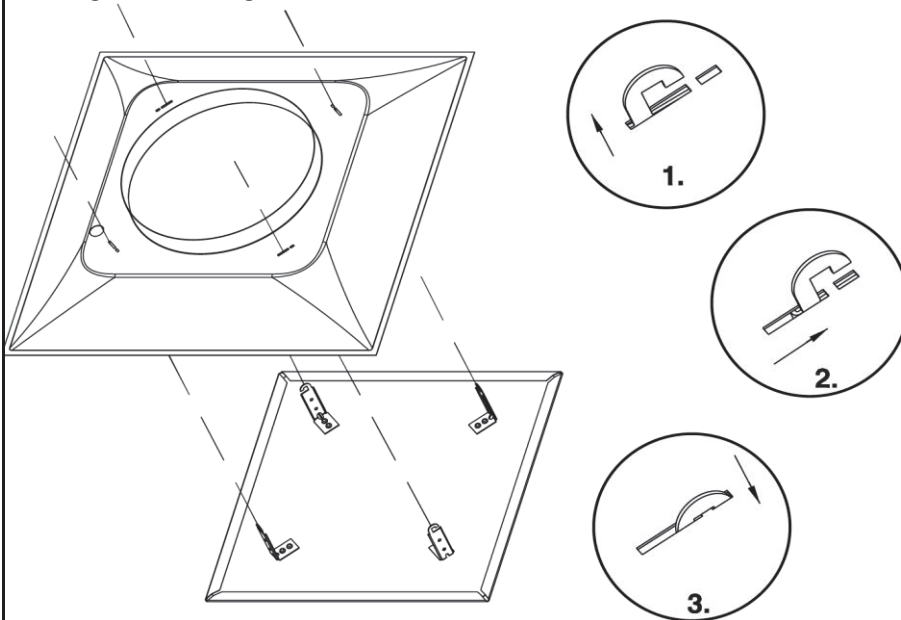

Installing Face Panel

1. Insert the hook brackets into the slots in the backpan.
2. Rotate the face panel clockwise until...
3. the hooks positively engage in the secondary slots in the backpan.

Removing Face Panel

1. Lift the faceplate towards the backpan to disengage the hook brackets from the backpan slots
2. Rotate the faceplate counter-clockwise
3. Lower the faceplate away from the backpan.

Adjusting Optional Damper

1. Remove face panel as above.
2. Use flat blade screwdriver to turn operator shaft at center of damper.
3. Replace face panel.

Accessories (continued) OMNIAA-2

TRM - Rapid Mount Frame

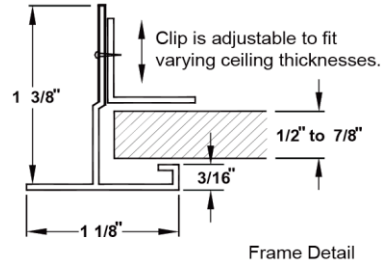
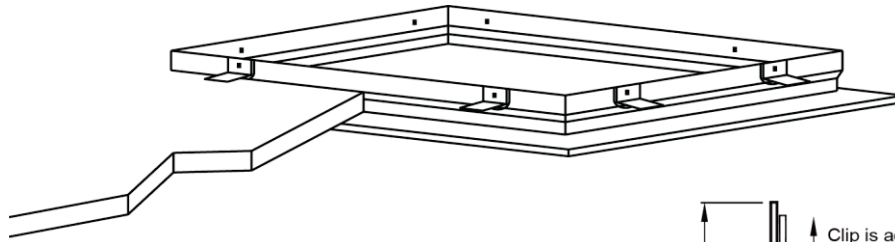

MODULE SIZE	Cutout
24X24	24 1/2" X 24 1/2"

TRITEC-AL

Critical Environment Diffusion
 High Volume • Low Velocity Radial Air Diffusion
 Stainless Steel Face with an Aluminum Back Pan

Main Product

TRITECAL-1

TRITEC-AL

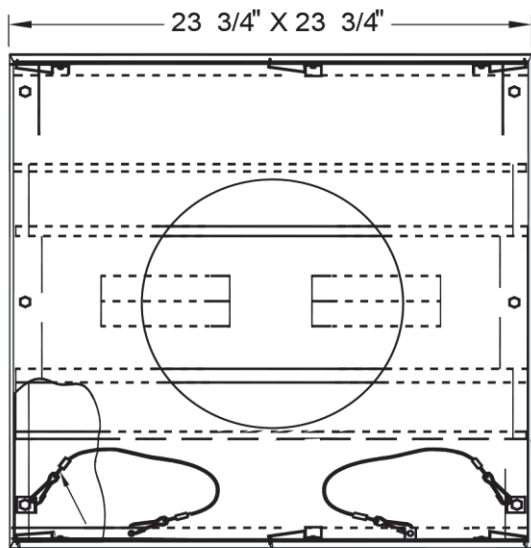

Safety Chain **Top View**

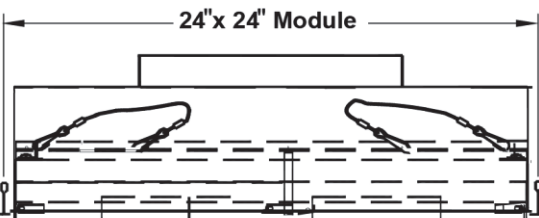

Side View

INLET SIZE
8" DIAMETER

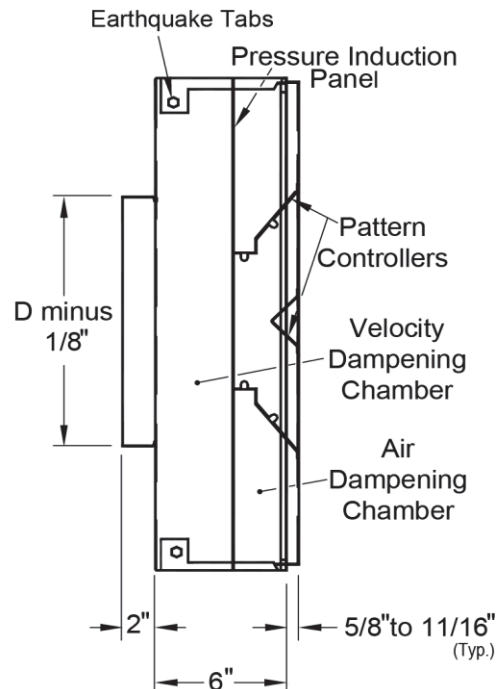

End View

Project UAMS Center for Animal M
Architect
Engineer
Contractor
Designation D-5,D-7



Date 10/15/2024
Office Powers of Arkansas
Preparer Chris Atwood
Version 2014.0.571

General Description **TRITECAL-1**

- TriTec hemispherical face drops below the ceiling 5/8"
- Removable face for sanitizing, (no special tool required to remove the face).
- Aluminum with 304 Stainless Steel face.
- Low velocity Air Flow
- Factory supplied plenum with every unit.
- Standard unit lays into standard TBar ceiling. Optional TRM/TRMS mounting frame available for surface mounting.
- Simple to install and maintain.
- Great for use in fume hood areas.
- Earthquake tabs supplied as standard.
- Safety chain is standard.
- 51% free area perforated face matches industry standard perforated diffuser's appearance.
- 22 gauge backpan.

Option Schedule **TRITECAL-1**

ID	Quantity	Tag
1	2	D-5
4	1	D-7

INLET SIZE 8" DIAMETER
MODULE SIZE 24X24

ACCESSORY 1 IP - Insulated Plenum

Accessories **TRITECAL-1**

Hemispherical (2-way) Pattern

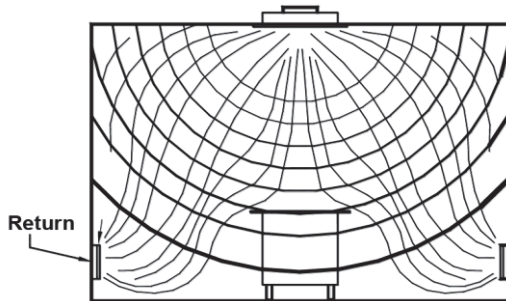

TAG: "D-5", "D-7"

Air Balancing Devices Opposed Blade Damper • Neck Mounted For Round Necks

Models: D-75

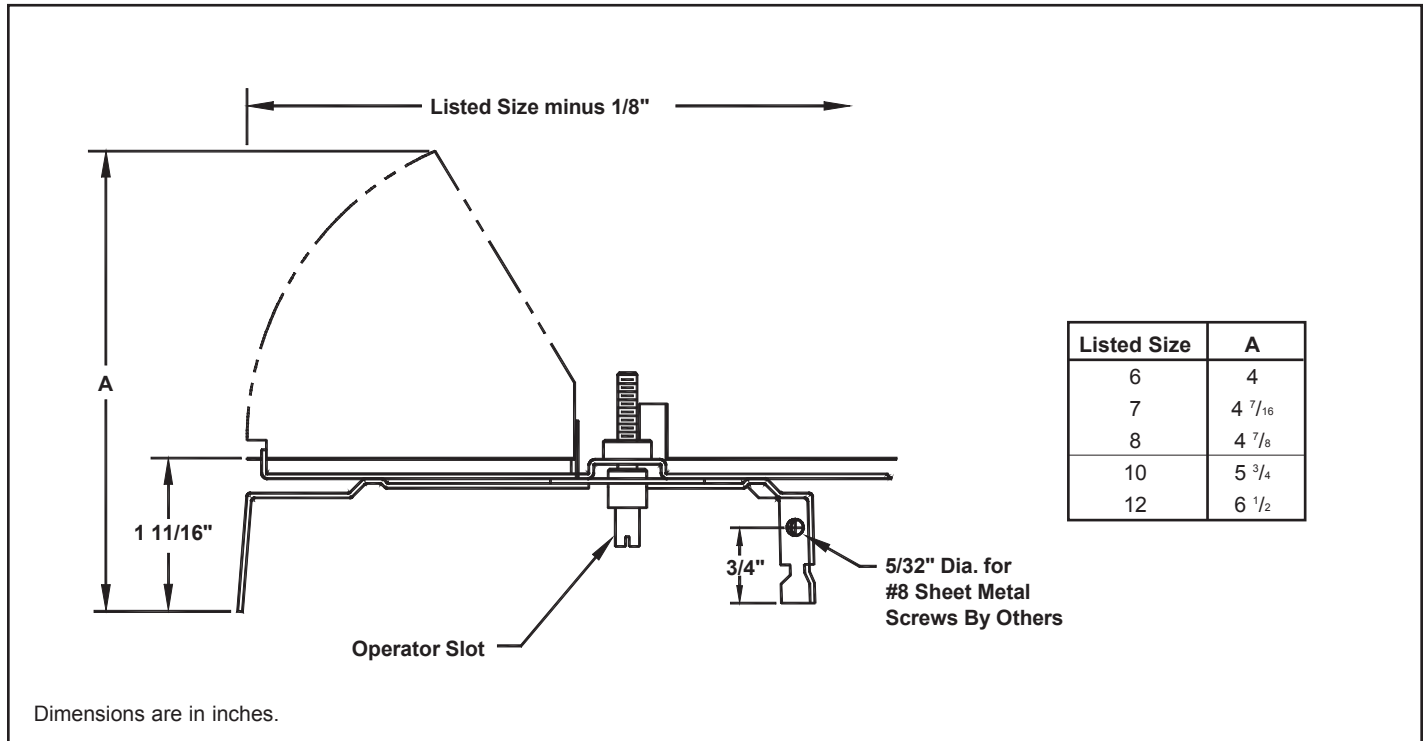

Standard Finish: Mill

General Description

- The TITUS D-75 is a neck mounted opposed blade damper used in round duct applications.
- Three sets of gang operated blades distribute air evenly through the diffuser.
- Adjustable at screwdriver operator slot.
- Material is galvanized steel.

TRITEC-SS

Critical Environment Diffusion
 High Volume • Low Velocity Radial Air Diffusion
 Stainless Steel

Main Product TRITECSS-1

TRITEC-SS

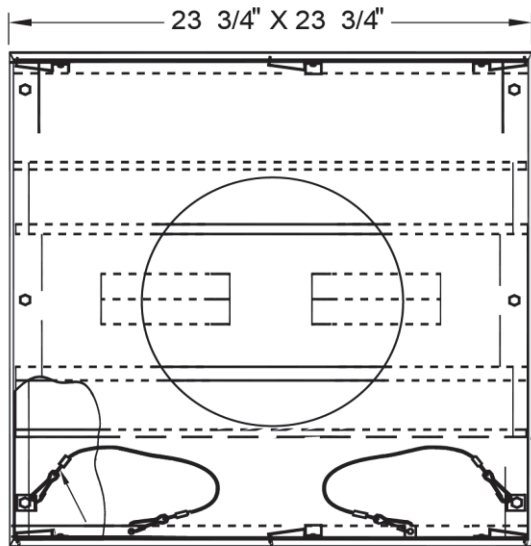

Safety Chain Top View

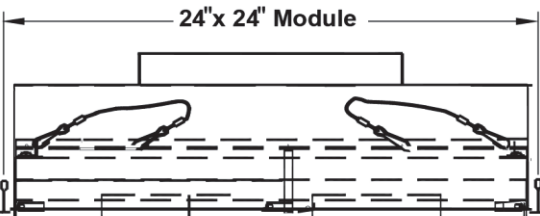

Side View

INLET SIZE
8" DIAMETER

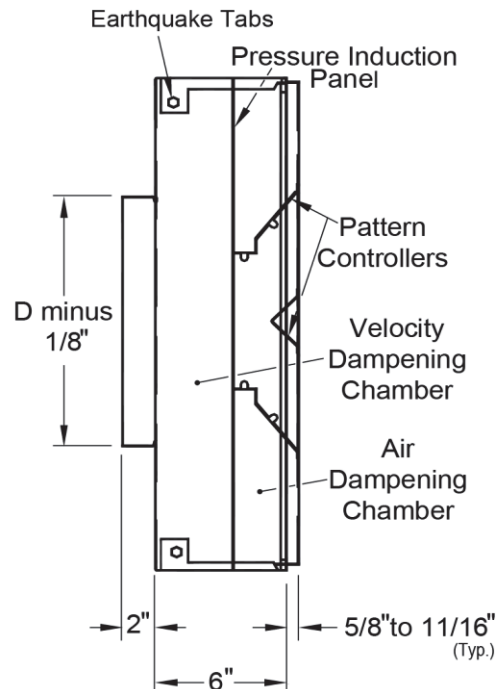

End View

Project UAMS Center for Animal M
 Architect
 Engineer
 Contractor
 Designation D-6



Date 10/15/2024
 Office Powers of Arkansas
 Preparer Chris Atwood
 Version 2014.0.571

General Description TRITECSS-1

- TriTec hemispherical face drops below the ceiling 5/8".
- Removable face for sanitizing, (no special tool required to remove the face).
- 304 Stainless Steel
- Low velocity Air Flow
- Factory supplied plenum with every unit.
- Standard unit lays into standard TBar ceiling. Optional TRM/TRMS mounting frame available for surface mounting.
- Simple to install and maintain.
- Great for use in fume hood areas.
- Earthquake tabs supplied as standard.
- Safety chain is standard.
- 51% free area perforated face matches industry standard perforated diffuser's appearance.
- 22 gauge backpan.

Option Schedule TRITECSS-1

ID	Quantity	Tag
3	5	D-6

INLET SIZE 8" DIAMETER
MODULE SIZE 24X24

ACCESSORY 1 IP - Insulated Plenum

Accessories TRITECSS-1

Hemispherical (2-way) Pattern

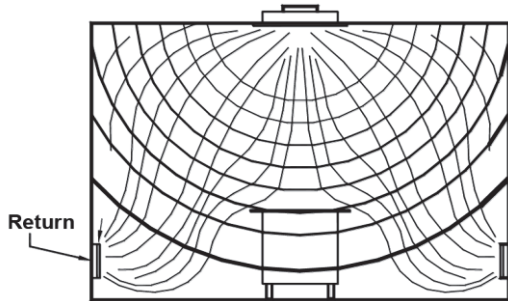

SSRADIALLESS STEEL

RADIAL DAMPER

Job Name: UAMS CAMID
 Tag Name: D-6 Quantity: 5
 Unit Size: 8" DIAMETER

OPTIONS

- 304 Stainless Steel (Standard)
- #2B Mill Finish (Standard)
- 316 Stainless Steel
- #2B Mill Finish
- Neck ϕ Size:
 - 5" 6" 7" 8" 10" 12" 14" 16" 18"
- Screwdriver Operating Mechanism (Standard)
- Remote Cable Operator
- Pre-Mounted into Collar (To be installed into Ductwork)

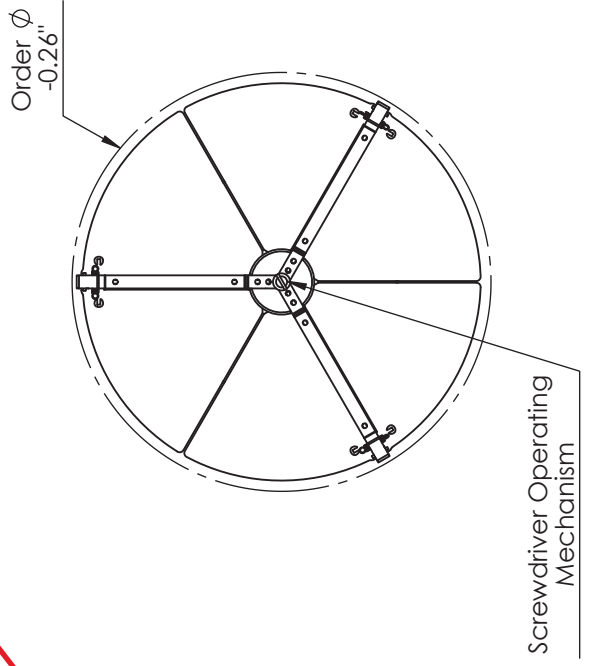
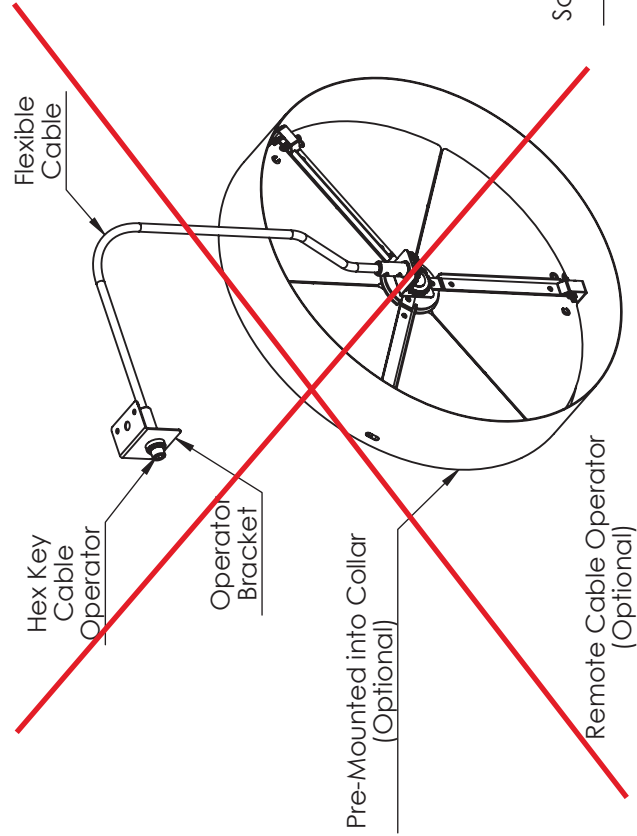
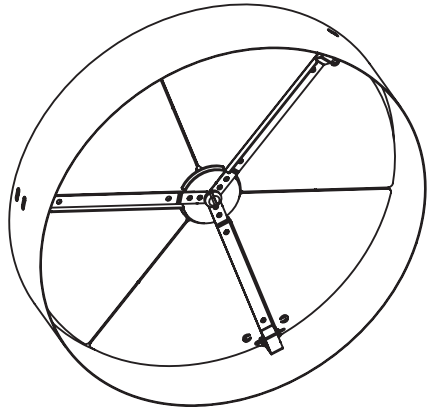

* To maintain AJ Manufacturing's policy of continuous product improvement, we reserve the right to change any information concerning product or pricing without notice or obligation *

DRAWN SLG	JOB NAME ENGINEER	MATERIAL 304SS	FINISH #2B MILL	TAG	QTY	REV # A
						SHT 1/1
CHKD				DRAWING NAME SSRADIAL		SCL 1:5.5
						DO NOT SCALE

8701 Elmwood Ave #400
 Kansas City, MO 64113
 Ph: 816-231-5522 Fx
 800-247-5746 Email: rob
 Please Visit Our Web Site At:

PAR-AA

Perforated Return diffuser, aluminum face with steel backpan.

Main Product **PARAA-1**

PAR-AA

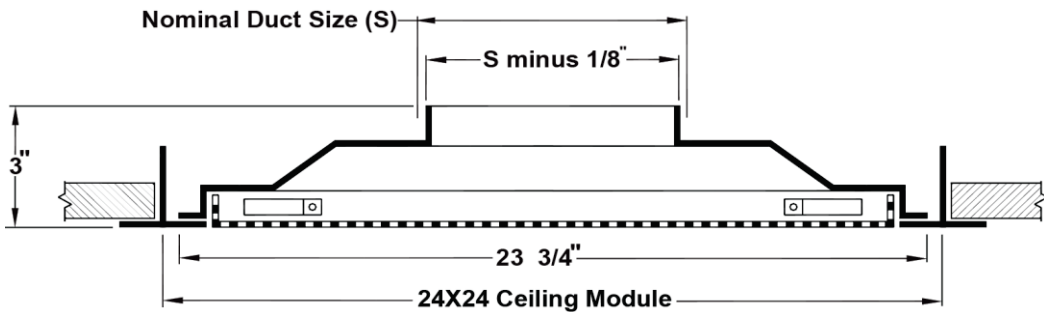

Nom. Neck Size (S)	Neck Size
6" Dia.	5 7/8" Dia.
8" Dia.	7 7/8" Dia.
10" Dia.	9 7/8" Dia.
12" Dia.	11 7/8" Dia.
14" Dia.	13 7/8" Dia.

General Description **PARAA-1**

Standard Finish: #26 White

- Model PAR-AA flush face perforated ceiling diffusers are designed for use as returns to match the Model PAS supply diffusers.
- Can be mounted in a plenum or connected to a return duct.
- Perforated face has 3/16" diameter holes on 1/4" staggered centers.
- Material: Heavy gauge aluminum face, steel backpan and pattern controllers.

Option Schedule **PARAA-1**

ID	Quantity	Tag	DIM 1 NECK SIZE	DIM 2 NECK SIZE
1	3	G-1	6" DIAMETER	NONE
2	9	G-1	8" DIAMETER	NONE
3	15	G-1	10" DIAMETER	NONE
4	6	G-1	12" DIAMETER	NONE

MODULE SIZE 24X24
BORDER 3 - LAY-IN
FINISH 26 - WHITE
DAMPER MODEL D-75 - ROUND NECK-MOUNTED OBD

ACCESSORY 1 NONE
ACCESSORY 2 NONE
ACCESSORY 3 TRM - Rapid Mount Frame-AlumI

ID	Quantity	Tag	DIM 1 NECK SIZE	DIM 2 NECK SIZE
5	4	G-1	14" DIAMETER	NONE

Option Schedule (continued)	PARAA-1
<p>MODULE SIZE 24X24 BORDER 3 - LAY-IN FINISH 26 - WHITE DAMPER MODEL AG-75 - DUCT MOUNTED ROUND OBD</p>	<p>ACCESSORY 1 NONE ACCESSORY 2 NONE ACCESSORY 3 TRM - Rapid Mount Frame-Aluml</p>

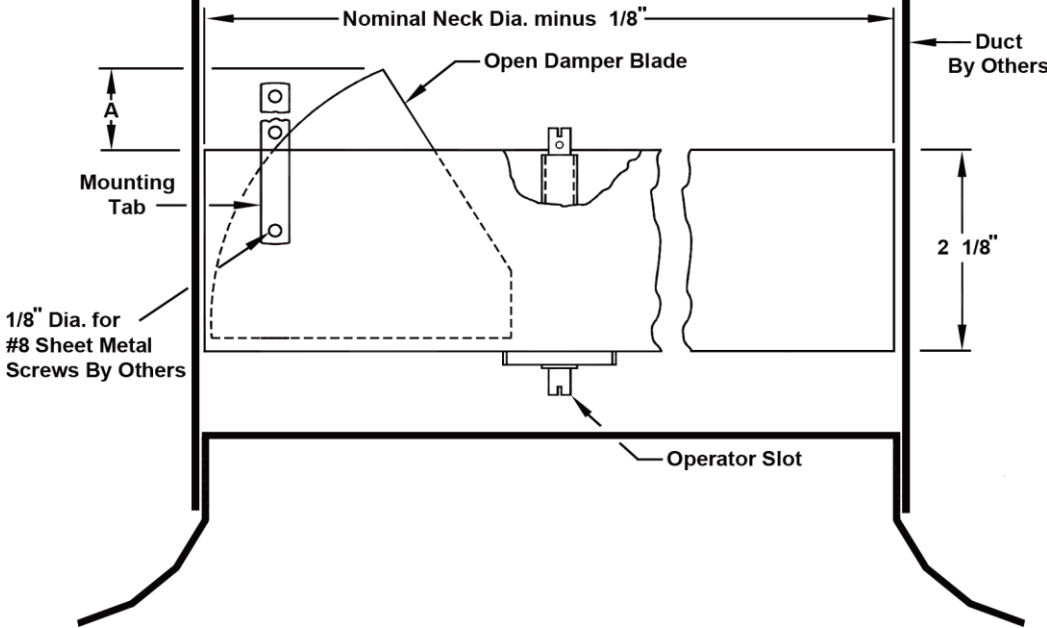
Accessories	PARAA-1
AG-75 Opposed Blade Damper size 14-20	
	
<p>Standard Finish: Mill</p> <ul style="list-style-type: none"> • The Opposed Blade Damper mounts inside of a round duct neck. • Gang operated blades(4) distribute air evenly through the diffuser or duct. Not recommended for flexible duct applications • Adjustable at screwdriver operator slot. • Shipped loose for field installation. • Material: Galvanized steel. 	

Accessories (continued) PARAA-1

D-75 Opposed Blade Damper

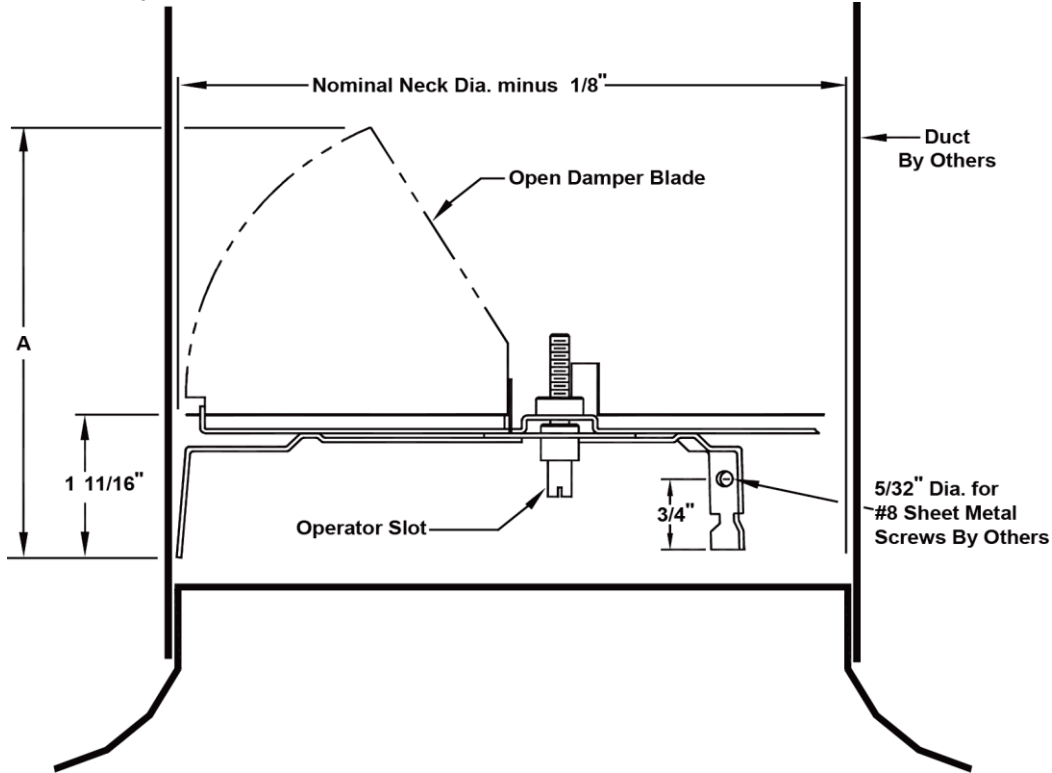

Standard Finish: Mill

- The Opposed Blade Damper is mounted inside the round duct neck.
- Three sets of gang operated blades distribute air evenly through the diffuser.
- Adjustable at screwdriver operator slot.
- Material: Galvanized steel.

TRM - Rapid Mount Frame

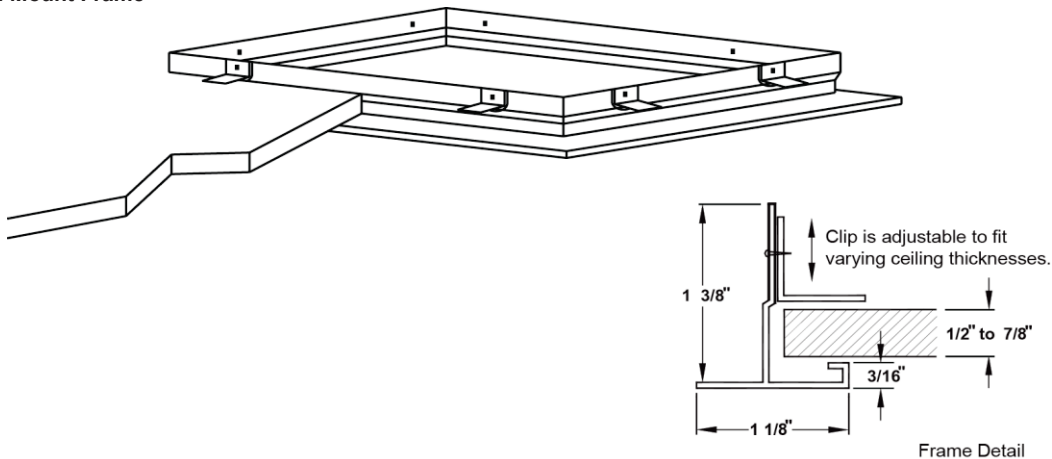

Project UAMS Center for Animal M
Architect
Engineer
Contractor
Designation G-1



Date 10/16/2024
Office Powers of Arkansas
Preparer Chris Atwood
Version 2014.0.571

Accessories (continued)		PARAA-1
MODULE SIZE	Cutout	
24X24	24 1/2" X 24 1/2"	

350RLF1-SS

Louvered Filter Return grille, 45° deflection, 3/4" spacing, blades parallel to long dimension, 1" filter rack, Stainless Steel.

Main Product

350RLF1SS-1

350RLF1-SS

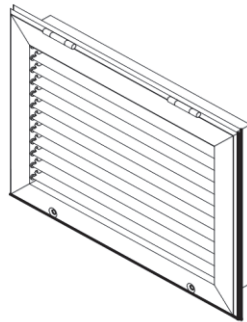
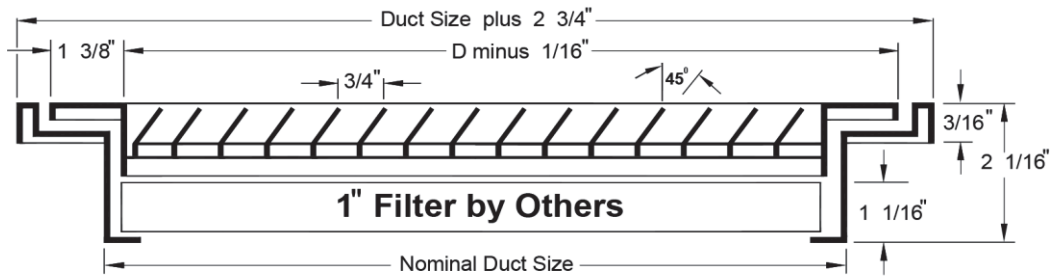

Surface Mount, Border-1 with Knurled-Knob Fastening

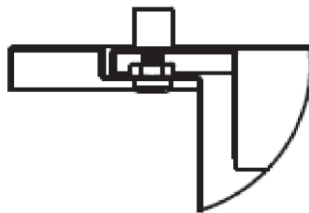

Duct Width	Duct Height	Grille OA Width	Grille OA Height
12	12	14.75	14.75
14	14	16.75	16.75

Surface Mount, Border-1 with Quarter-Turn Fastening

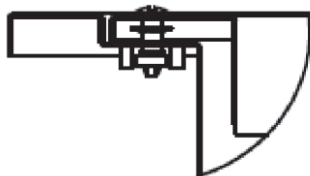

Project UAMS Center for Animal M
 Architect
 Engineer
 Contractor
 Designation G-2



Date 10/15/2024
 Office Powers of Arkansas
 Preparer Chris Atwood
 Version 2014.0.571

Main Product (continued)				350RLF1SS-1
Duct Width	Duct Height	Grille OA Width	Grille OA Height	
12	12	14.75	14.75	
14	14	16.75	16.75	

General Description	350RLF1SS-1
<ul style="list-style-type: none"> • Horizontal louver blades are spaced 3/4" apart. • Blade deflection angle is 35°. • Filter supplied by others. • Common filter sizes for our 1" deep Filter-Frame grille can be purchased from most hardware stores. • Two inch deep Filter-Frames are available. • Easy to use Quarter turn fastening is standard for filter access. • Knurled knob fastening for filter access is optional. • All dimensions are ± 1/16" • Dimensions are the same for border type 1 (surface mount) and border type 3 (lay-in T-bar) • Material: Stainless Steel 	

Option Schedule					350RLF1SS-1
ID	Quantity	Tag	WIDTH IN INCHES	HEIGHT IN INCHES	
1	4	G-2	12	12	
4	7	G-2	14	14	

Material 304- 304 Stainless Steel	HINGE LOCATION T - TOP HINGE
MODULE SIZE 00 - None	DOOR FASTENING Q - QUARTER TURN
BORDER 1 - SURFACE MOUNT	ACCESSORY 2 00 - NONE
FINISH 26 - WHITE	

350RSF1-SS

Louvered Filter Return grille, 45° deflection, 3/4" spacing, blades parallel to short dimension, 1" filter rack, Stainless Steel.

Main Product

350RSF1SS-1

350RSF1-SS

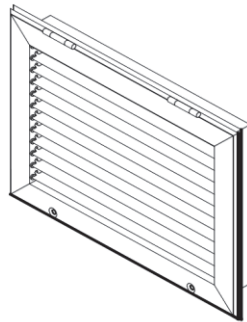
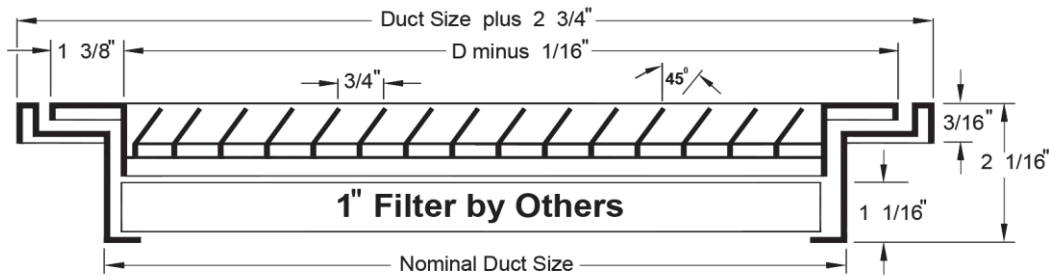

Surface Mount, Border-1 with Knurled-Knob Fastening

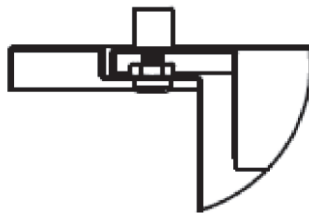

These grilles are built with the blades parallel to the short dimension. When installed, they will be rotated to where the short dimension will be the WIDTH.

Duct Width	Duct Height	Grille OA Width	Grille OA Height
16	12	18.75	14.75
18	14	20.75	16.75
18	16	20.75	18.75
20	18	22.75	20.75

Surface Mount, Border-1 with Quarter-Turn Fastening

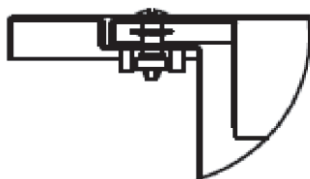

Project UAMS Center for Animal M
 Architect
 Engineer
 Contractor
 Designation G-2



Date 10/15/2024
 Office Powers of Arkansas
 Preparer Chris Atwood
 Version 2014.0.571

Main Product (continued)				350RSF1SS-1
Duct Width	Duct Height	Grille OA Width	Grille OA Height	
16	12	18.75	14.75	
18	14	20.75	16.75	
18	16	20.75	18.75	
20	18	22.75	20.75	

General Description	350RSF1SS-1
<ul style="list-style-type: none"> • Vertical louver blades are spaced 3/4" apart. • Blade deflection angle is 35°. • Filter supplied by others. • Common filter sizes for our 1" deep Filter-Frame grille can be purchased from most hardware stores. • Two inch deep Filter-Frames are available. • Easy to use Quarter turn fastening is standard for filter access. • Knurled knob fastening for filter access is optional. • All dimensions are ± 1/16" • Dimensions are the same for border type 1 (surface mount) and border type 3 (lay-in T-bar) • Material: Stainless Steel 	

Option Schedule					350RSF1SS-1
ID	Quantity	Tag	WIDTH IN INCHES	HEIGHT IN INCHES	
2	2	G-2	16	12	
3	6	G-2	18	14	
5	1	G-2	18	16	
6	1	G-2	20	18	

BORDER 1 - SURFACE MOUNT
FINISH 26 - WHITE

HINGE LOCATION T - TOP HINGE
DOOR FASTENING Q - QUARTER TURN

350FL

Louvered Return Grille, 35° Deflection, 3/4" Spaced Blades, Blades parallel to Duct Width, Aluminum.

Main Product **350FL-1**

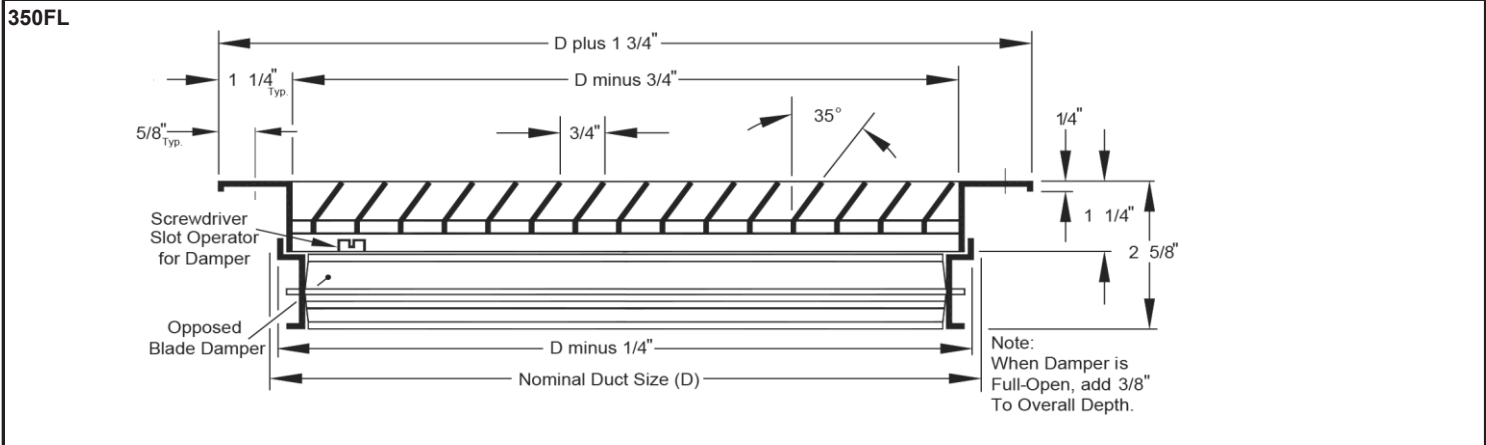

Screw Hole Fastening, Grille Mounting Detail



Duct Width	Duct Height	Grille OA Width	Grille OA Height
12	8	13.75	9.75
18	8	19.75	9.75

General Description **350FL-1**

- Louvers are horizontal to width with 3/4" spacing at a 35 degree deflection
- Optional opposed blade damper has screwdriver adjustment accessible through face of register.
- Odd and fractional sizes are available at additional cost.
- Sizes larger than 48" x 48" are shipped in multiple sections with joining strips for field assembly.
- Screw hole fastening includes #8 x 1 1/4" lg. Phillip's flat head sheet metal screws painted color of grille.
- Wall or duct opening should be duct size ± 1/8".
- All dimensions are ± 1/16"
- Material: Aluminum

Option Schedule **350FL-1**

ID	Quantity	Tag	WIDTH IN INCHES	HEIGHT IN INCHES
2	1	G-6	12	8
3	4	G-6	18	8

Project UAMS Center for Animal M
Architect
Engineer
Contractor
Designation G-6



Date 10/15/2024
Office Powers of Arkansas
Preparer Chris Atwood
Version 2014.0.571

Option Schedule (continued)	350FL-1
MODULE SIZE NONE BORDER 1 - SURFACE MOUNT FINISH 26 - WHITE FASTENING A - SCREW HOLES	DAMPER MODEL AG-15 - STEEL OBD ACCESSORY 1 NONE ACCESSORY 2 NONE ACCESSORY 3 NONE

Accessories 350FL-1

Damper: AG-15 common drawing, see above for selected material and finish

1 1/4"
1 5/8"

PAR-AA

Perforated Return diffuser, aluminum face with steel backpan.

Main Product	PARAA-2
---------------------	----------------

PAR-AA

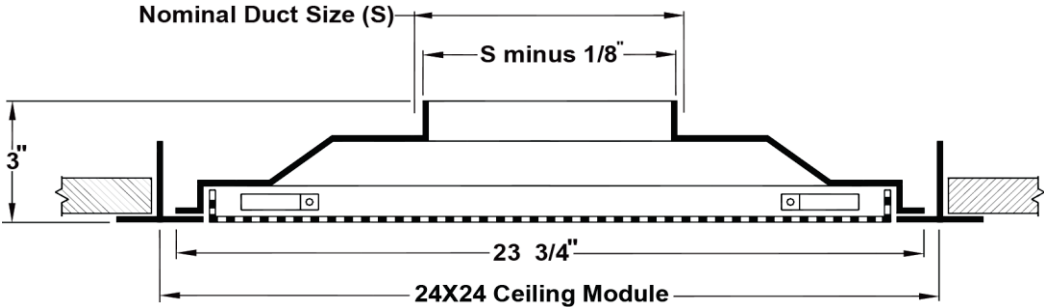

Nom. Neck Size (S)	Neck Size
8" Dia.	7 7/8" Dia.
10" Dia.	9 7/8" Dia.
12" Dia.	11 7/8" Dia.

General Description	PARAA-2
----------------------------	----------------

Standard Finish: #26 White

- Model PAR-AA flush face perforated ceiling diffusers are designed for use as returns to match the Model PAS supply diffusers.
- Can be mounted in a plenum or connected to a return duct.
- Perforated face has 3/16" diameter holes on 1/4" staggered centers.
- Material: Heavy gauge aluminum face, steel backpan and pattern controllers.

Option Schedule	PARAA-2
------------------------	----------------

ID	Quantity	Tag	DIM 1 NECK SIZE	DIM 2 NECK SIZE
6	1	G-7	8" DIAMETER	NONE
7	3	G-7	10" DIAMETER	NONE
8	2	G-7	12" DIAMETER	NONE

<p>MODULE SIZE 24X24 BORDER 3 - LAY-IN FINISH 26 - WHITE DAMPER MODEL D-75 - ROUND NECK-MOUNTED OBD</p>	<p>ACCESSORY 1 NONE ACCESSORY 2 NONE ACCESSORY 3 TRM - Rapid Mount Frame-Alum</p>
--	--

Accessories

PARAA-2

D-75 Opposed Blade Damper

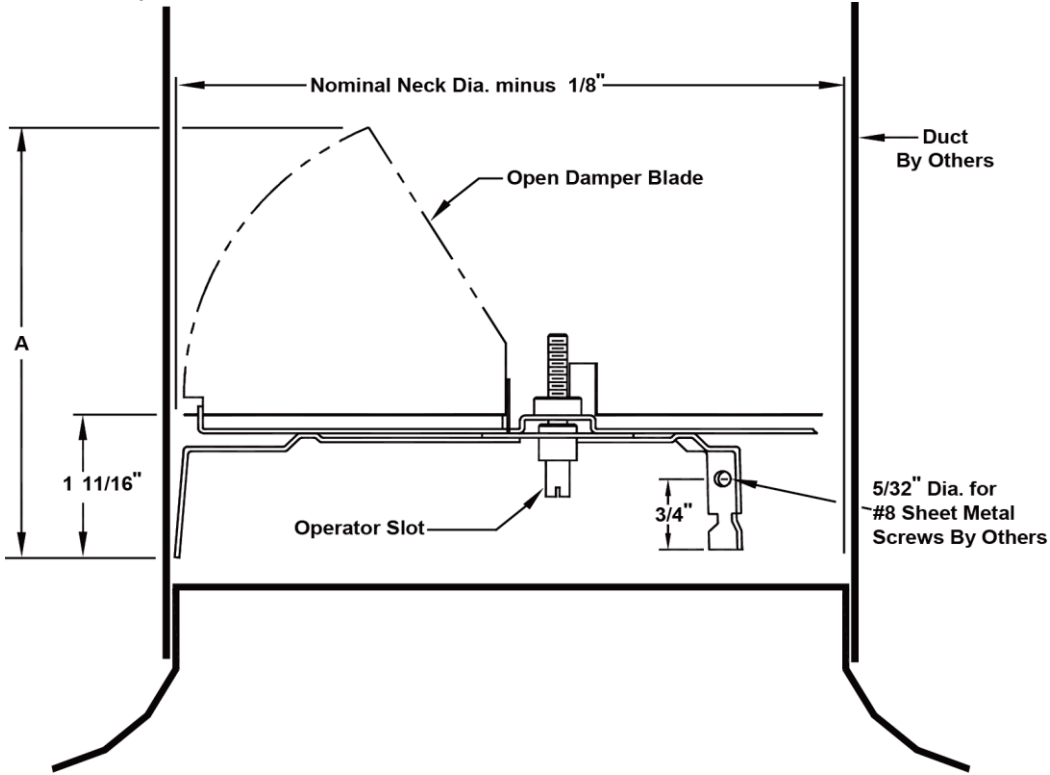

Standard Finish: Mill

- The Opposed Blade Damper is mounted inside the round duct neck.
- Three sets of gang operated blades distribute air evenly through the diffuser.
- Adjustable at screwdriver operator slot.
- Material: Galvanized steel.

TRM - Rapid Mount Frame

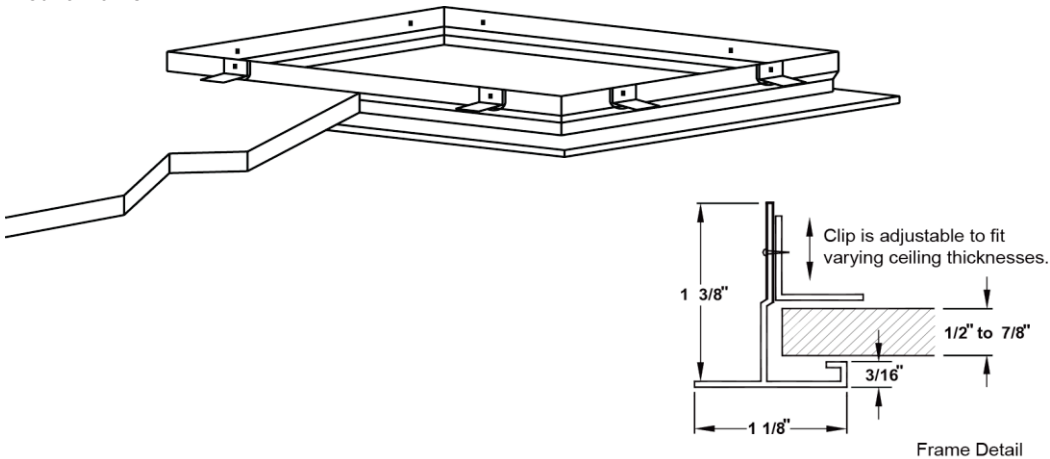

Project UAMS Center for Animal M
Architect
Engineer
Contractor
Designation G-7



Date 10/16/2024
Office Powers of Arkansas
Preparer Chris Atwood
Version 2014.0.571

Accessories (continued)		PARAA-2
MODULE SIZE	Cutout	
24X24	24 1/2" X 24 1/2"	

300FL

Double Deflection Supply Grille, 3/4" Spacing, front blades parallel to long dimension, Aluminum.

Main Product **300FL-1**

300FL

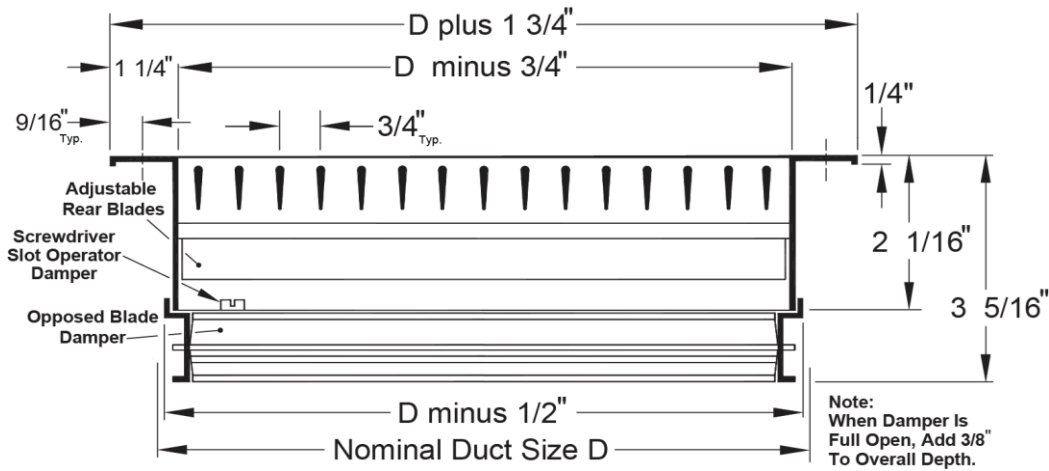

Screw Hole Fastening, Grille Mounting Detail



Duct Width	Duct Height	Grille OA Width	Grille OA Height
18	8	19.75	9.75

General Description **300FL-1**

- Front louvers are horizontal to width.
- Front and rear louvers are individually adjustable.
- Screw hole fastening includes #8 x 1 1/4" lg. Phillip's flat head sheet metal screws painted color of grille.
- Sizes larger than 48" x 48" are shipped in multiple sections with joining strips for field assembly.
- Odd and fractional sizes are available at additional cost.
- Optional opposed blade damper has screwdriver adjustment accessible through face of register.
- Insect and debris screens are not available when dampers are fitted.
- All dimensions are ± 1/16"
- Material: Aluminum

Option Schedule **300FL-1**

ID	Quantity	Tag	WIDTH IN INCHES	HEIGHT IN INCHES
1	7	R-1	18	8

Project UAMS Center for Animal M
 Architect
 Engineer
 Contractor
 Designation R-1



Date 10/15/2024
 Office Powers of Arkansas
 Preparer Chris Atwood
 Version 2014.0.571

Option Schedule (continued)	300FL-1
MODULE SIZE NONE BORDER 1 - SURFACE MOUNT FINISH 26 - WHITE FASTENING A - SCREW HOLES	DAMPER MODEL AG-15 - STEEL OBD ACCESSORY 1 NONE ACCESSORY 2 NONE ACCESSORY 3 NONE

Accessories	300FL-1
Damper: AG-15 common drawing, see above for material and finish	

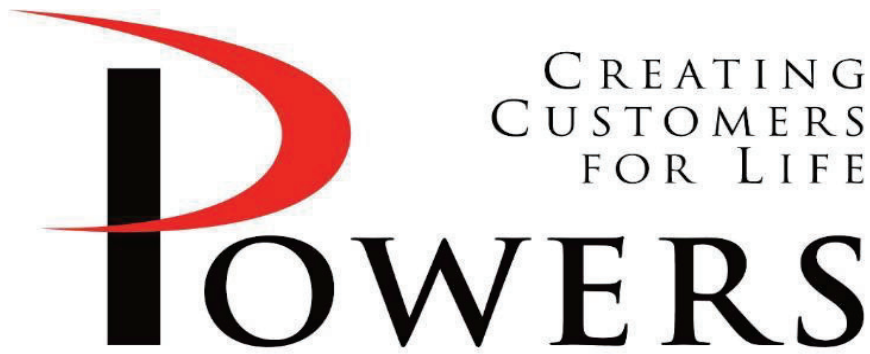

SUBMITTAL

PRODUCT	Stainless Steel Grilles
MANUFACTURER	AJ Manufacturing
JOB NAME	UAMS Center for Animal Models of Infection & Disease
LOCATION	Little Rock, AR
ENGINEER	James R. Beecher
CONTRACTOR	Middleton Inc.
DATE	10/16/2024
SUBMITTED BY	Chris Atwood

5440 Northshore Drive - North Little Rock, Arkansas 72118 - Tel: 501.374.5420 Fax: 501.370.9298

Job Name: UAMS CAMID

Tag Name: D-4 Quantity: 6

Unit Size: 24x24 -- Qty (3) 08" neck, Qty (3) 12" neck

SSPD STAINLESS STEEL

STAINLESS SQUARE PANEL DIFFUSER
SURFACE MOUNT

OPTIONS

- 304 Stainless Steel (Standard)
 - #4 Satin Finish (Standard)
- 316 Stainless Steel
 - #4 Satin Finish
- White Antimicrobial Epoxy Powdercoat Finish
- Other Color: _____
- 4-Way Airflow (Standard)
- 2-Way Airflow
- Butterfly Damper

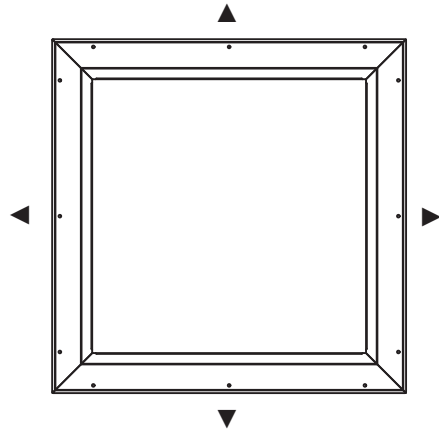
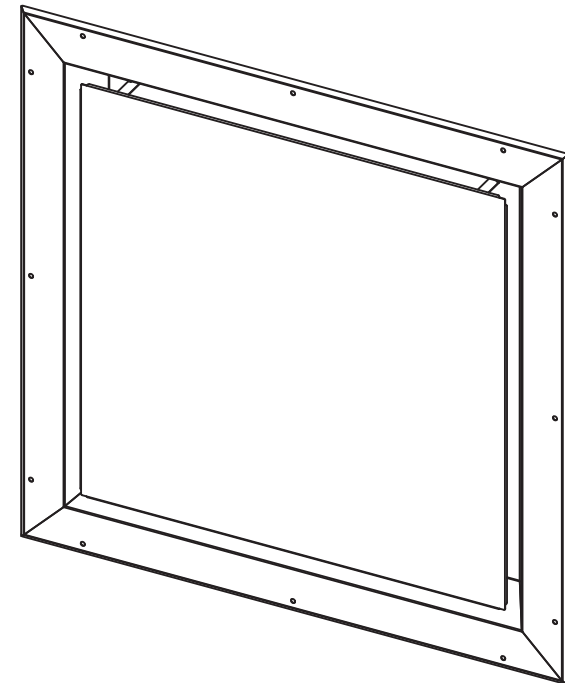

4-Way Airflow (Standard)

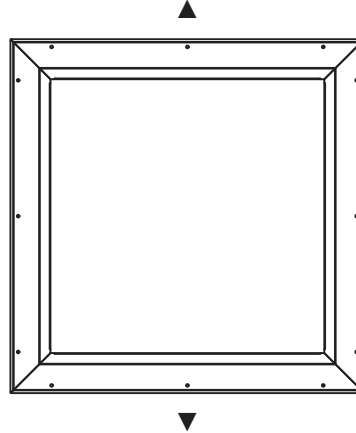

2-Way Airflow

* To maintain AJ Manufacturing's policy of continuous product improvement, we reserve the right to change any information concerning product or pricing without notice or obligation *

8701 Elmwood Ave #400
Kansas City, MO 64127
Ph: 816-231-5522 F
800-247-5746 Email: rot
Please Visit Our Web Site At

DRAWN SLG	MATERIAL 304SS	JOB NAME	TAG	QTY	REV # A
CHKD	FINISH #4 SATIN	ENGINEER	DRAWING NAME SSPD-SURFACE MOUNT		SHT 1/2
					SCL 1:8
					DO NOT SCALE

SSPD STAINLESS STEEL

STAINLESS SQUARE PANEL DIFFUSER SURFACE MOUNT

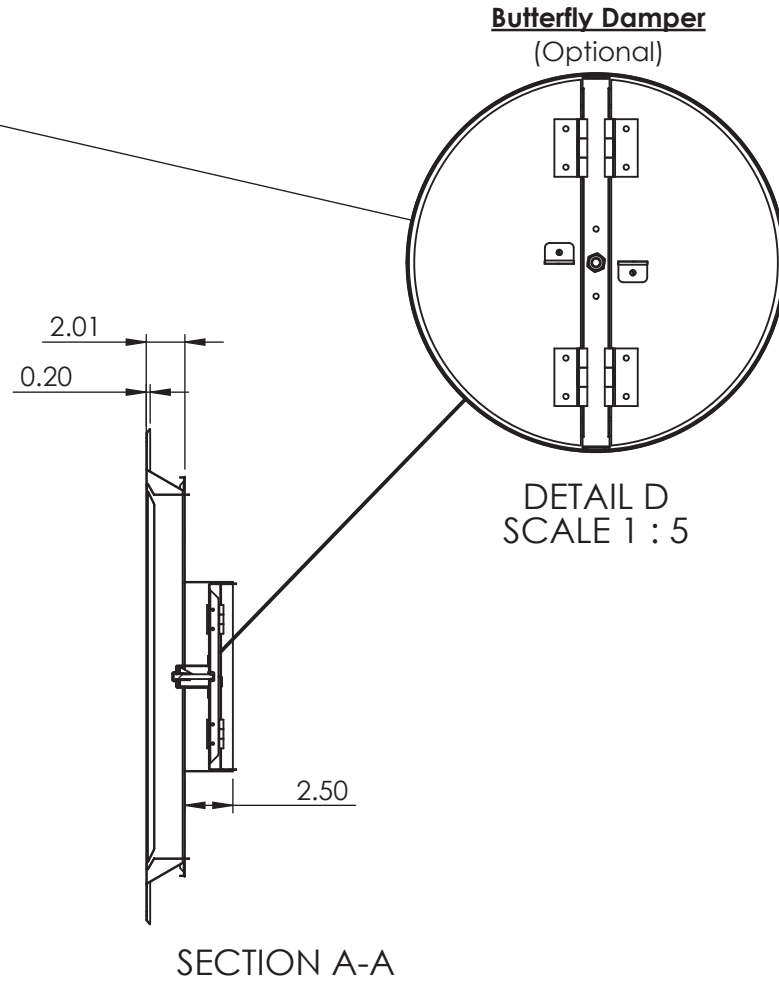
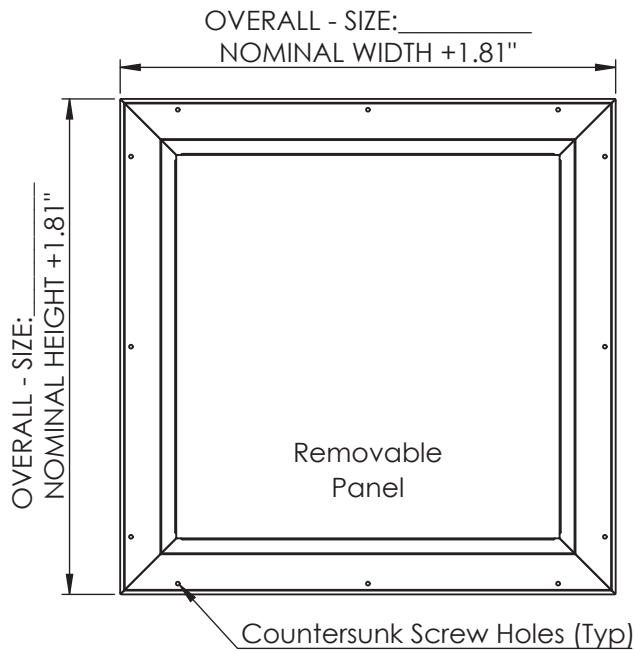
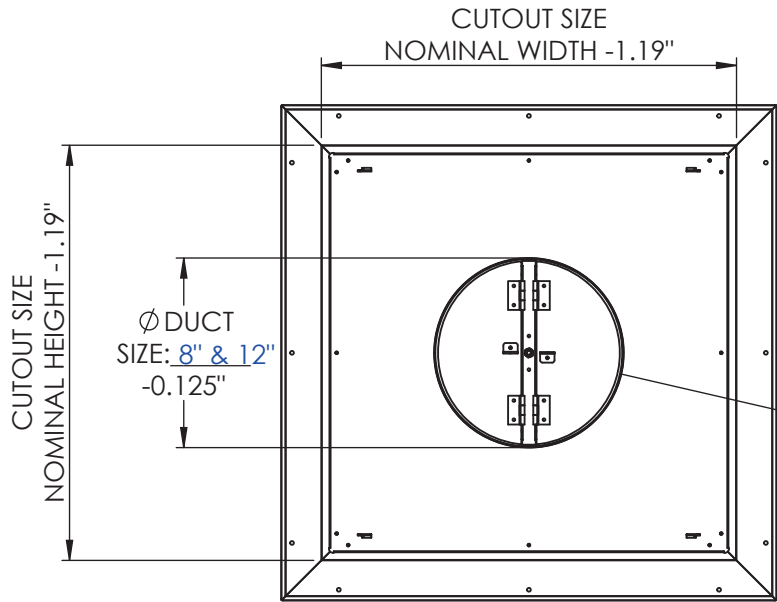

DRAWN SLG	MATERIAL 304SS	JOB NAME	TAG	QTY	REV # A
CHKD	FINISH #4 SATIN	ENGINEER	DRAWING NAME SSPD-SURFACE MOUNT		SHT 2/2
					SCL 1:10
					DO NOT SCALE

Job Name: UAMS CAMID

Tag Name: D-8 Quantity: 1

Unit Size: 24X24 -- Qty (1) 08" neck

SSPD STAINLESS STEEL

STAINLESS SQUARE PANEL DIFFUSER
SURFACE MOUNT

OPTIONS

- 304 Stainless Steel (Standard)
 - #4 Satin Finish (Standard)
- 316 Stainless Steel
 - #4 Satin Finish
- White Antimicrobial Epoxy Powdercoat Finish
- Other Color: _____
- 4-Way Airflow (Standard)
- 2-Way Airflow
- Butterfly Damper

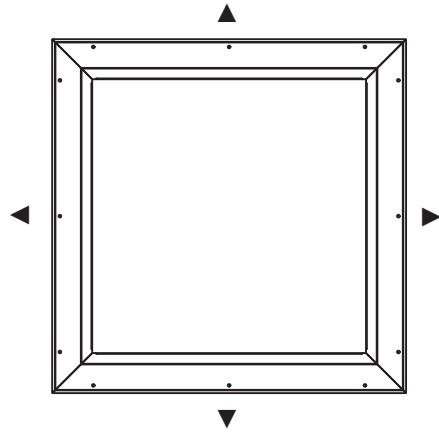
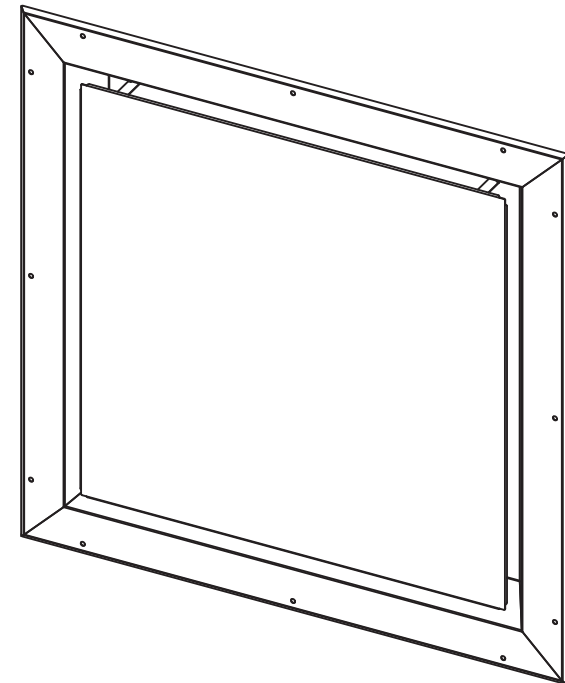

4-Way Airflow (Standard)

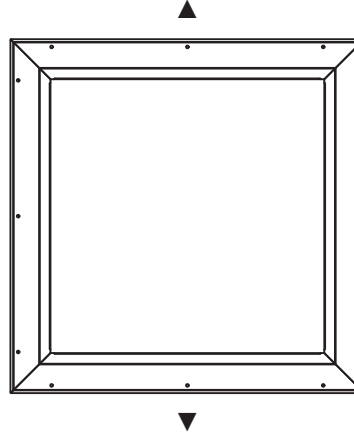

2-Way Airflow

* To maintain AJ Manufacturing's policy of continuous product improvement, we reserve the right to change any information concerning product or pricing without notice or obligation *



8701 Elmwood Ave #400
Kansas City, MO 64127
Ph: 816-231-5522 F
800-247-5746 Email: rot
Please Visit Our Web Site At

DRAWN SLG	MATERIAL 304SS	JOB NAME	TAG	QTY	REV # A
CHKD	FINISH #4 SATIN	ENGINEER	DRAWING NAME SSPD-SURFACE MOUNT		SHT 1/2
					SCL 1:8
					DO NOT SCALE

SSPD STAINLESS STEEL

STAINLESS SQUARE PANEL DIFFUSER SURFACE MOUNT

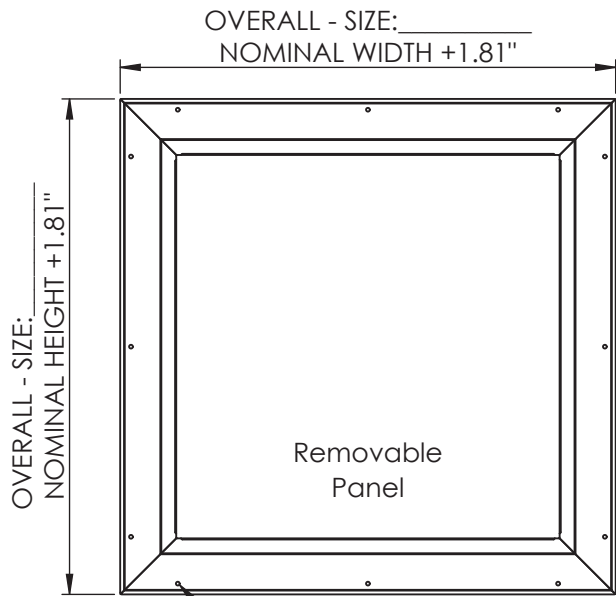
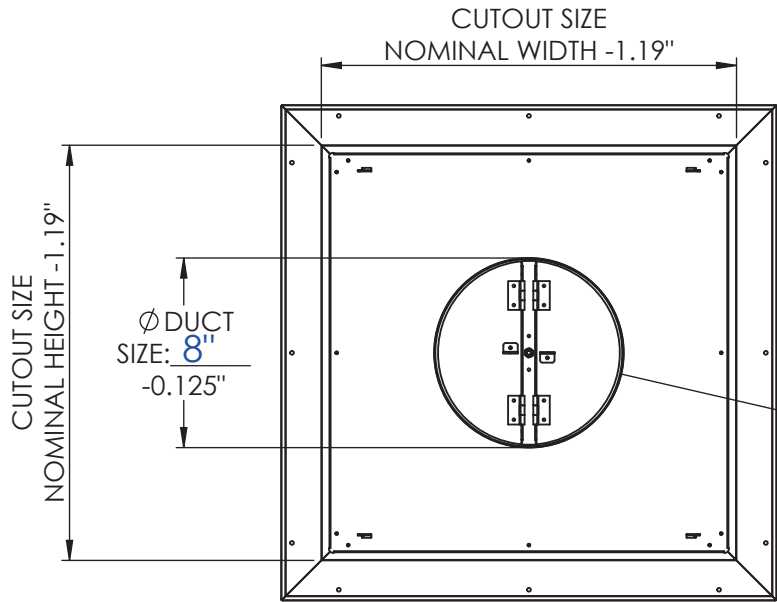

Countersunk Screw Holes (Typ)

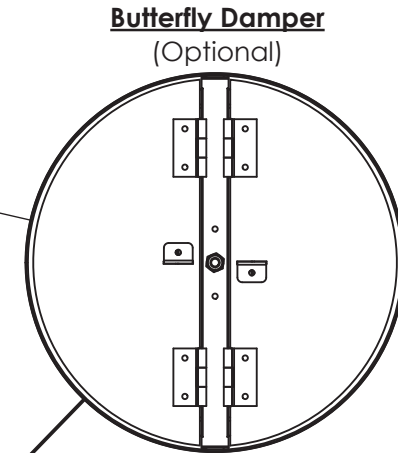

DETAIL D
SCALE 1 : 5

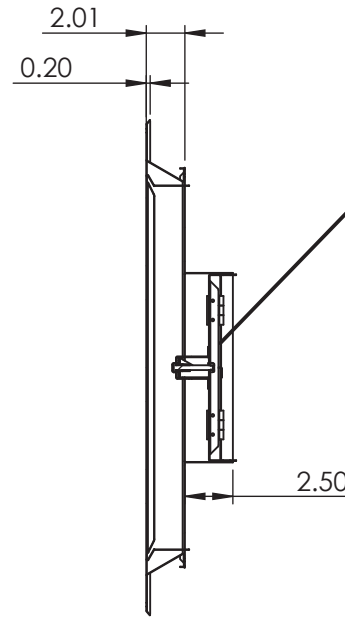

SECTION A-A



8701 Elmwood Ave #400
Kansas City, MO 64127

Ph: 816-231-5522 F
800-247-5746 Email: rot
Please Visit Our Web Site At

DRAWN SLG	MATERIAL 304SS	JOB NAME	TAG	QTY	REV # A
CHKD	FINISH #4 SATIN	ENGINEER	DRAWING NAME SSPD-SURFACE MOUNT		SHT 2/2
					SCL 1:10
					DO NOT SCALE

Job Name: UAMS CAMID

Tag Name: G-3 Quantity: 2

Unit Size: 24x24 -- Qty (2) 08" neck

SSPD STAINLESS STEEL

STAINLESS SQUARE PANEL DIFFUSER
SURFACE MOUNT

OPTIONS

- 304 Stainless Steel (Standard)
 - #4 Satin Finish (Standard)
- 316 Stainless Steel
 - #4 Satin Finish
- White Antimicrobial Epoxy Powdercoat Finish
- Other Color: _____
- 4-Way Airflow (Standard)
- 2-Way Airflow
- Butterfly Damper

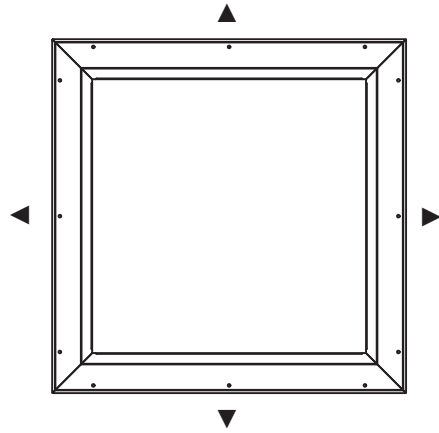
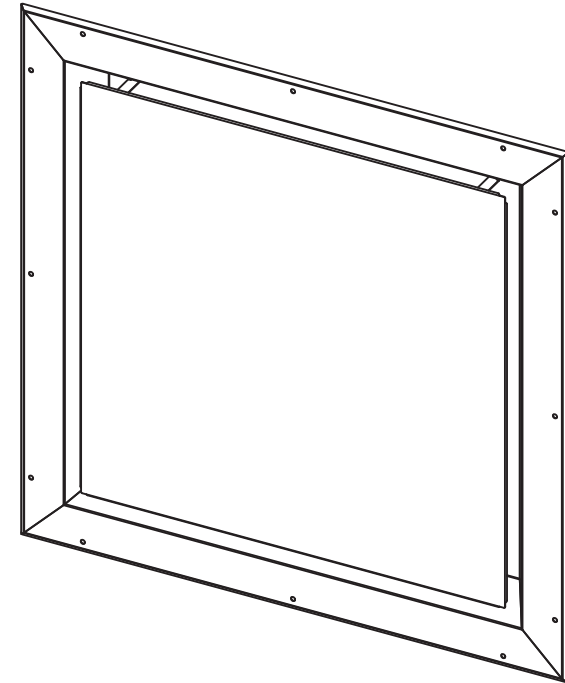

4-Way Airflow (Standard)

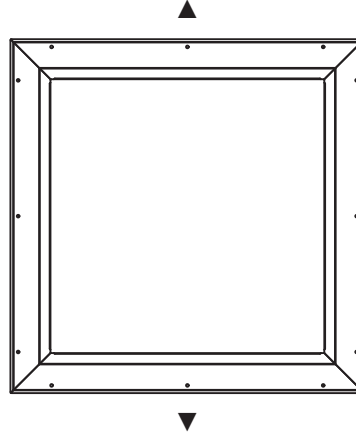

2-Way Airflow

* To maintain AJ Manufacturing's policy of continuous product improvement, we reserve the right to change any information concerning product or pricing without notice or obligation *



DRAWN SLG	MATERIAL 304SS	JOB NAME	TAG	QTY	REV # A
CHKD	FINISH #4 SATIN	ENGINEER	DRAWING NAME SSPD-SURFACE MOUNT		SHT 1/2
					SCL 1:8
					DO NOT SCALE

SSPD STAINLESS STEEL

STAINLESS SQUARE PANEL DIFFUSER SURFACE MOUNT

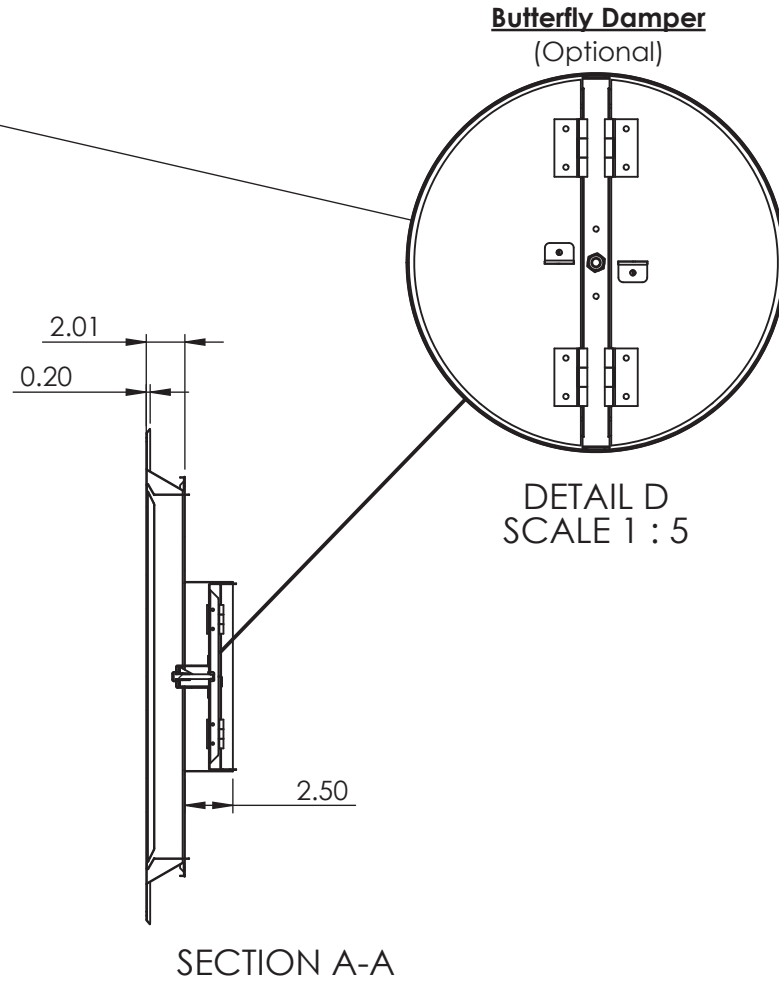
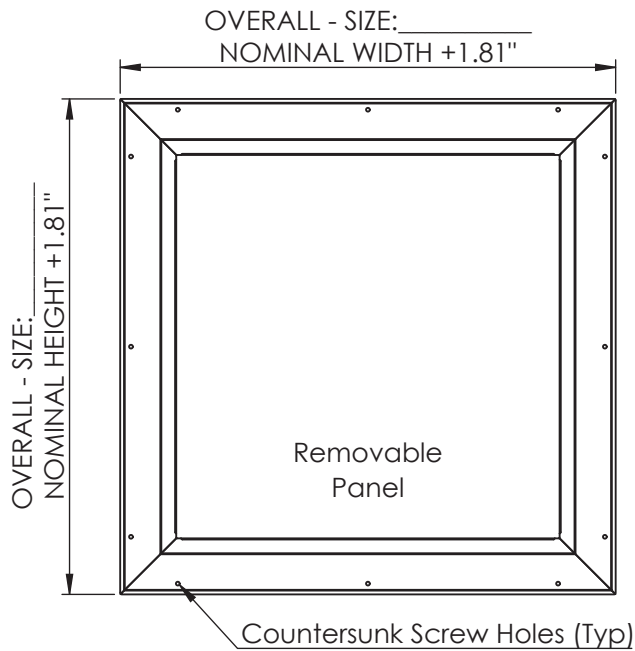
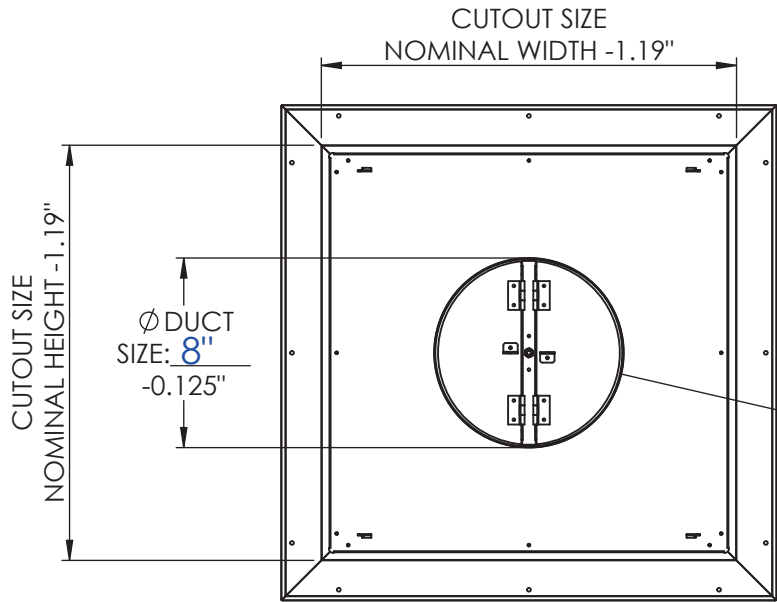

DRAWN SLG	MATERIAL 304SS	JOB NAME	TAG	QTY	REV # A
CHKD	FINISH #4 SATIN	ENGINEER	DRAWING NAME SSPD-SURFACE MOUNT		SHT 2/2
					SCL 1:10
					DO NOT SCALE

Job Name: UAMS CAMID

Tag Name: G-4 Quantity: 6

Unit Size: 12"x12" -- Qty (6) 08" neck

SSPD STAINLESS STEEL

STAINLESS SQUARE PANEL DIFFUSER
SURFACE MOUNT

OPTIONS

- 304 Stainless Steel (Standard)
 - #4 Satin Finish (Standard)
- 316 Stainless Steel
 - #4 Satin Finish
- White Antimicrobial Epoxy Powdercoat Finish
- Other Color: _____
- 4-Way Airflow (Standard)
- 2-Way Airflow
- Butterfly Damper

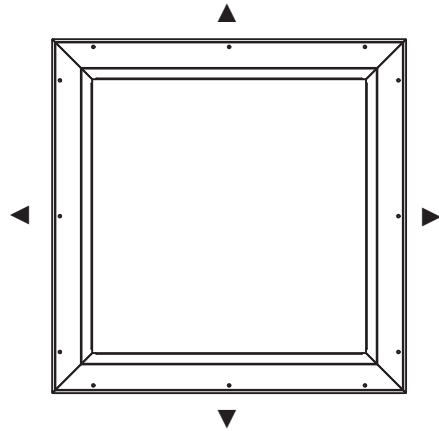
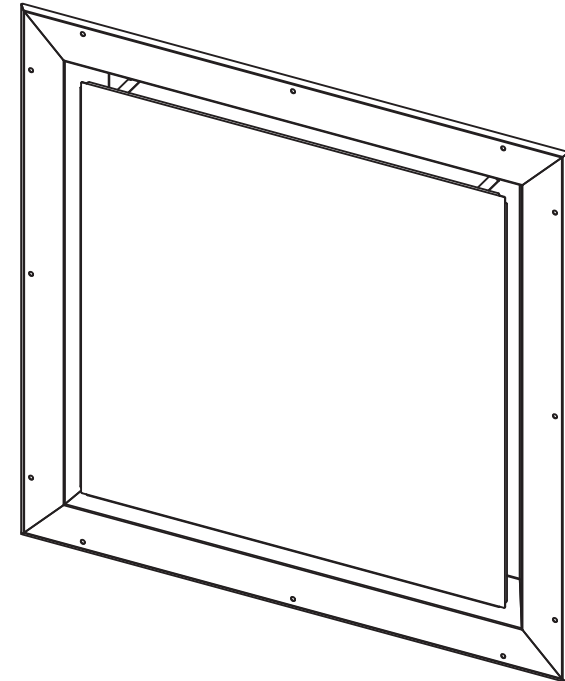

4-Way Airflow
(Standard)

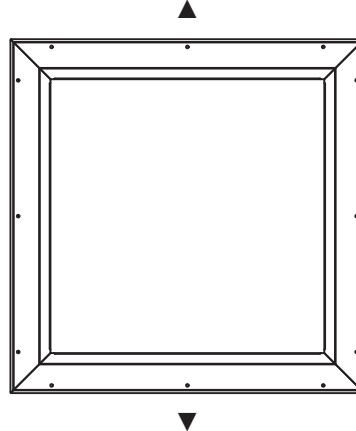

2-Way Airflow

* To maintain AJ Manufacturing's policy of continuous product improvement, we reserve the right to change any information concerning product or pricing without notice or obligation *



DRAWN SLG	MATERIAL 304SS	JOB NAME	TAG	QTY	REV # A
CHKD	FINISH #4 SATIN	ENGINEER	DRAWING NAME SSPD-SURFACE MOUNT		SHT 1/2
					SCL 1:8
					DO NOT SCALE

SSPD STAINLESS STEEL

STAINLESS SQUARE PANEL DIFFUSER SURFACE MOUNT

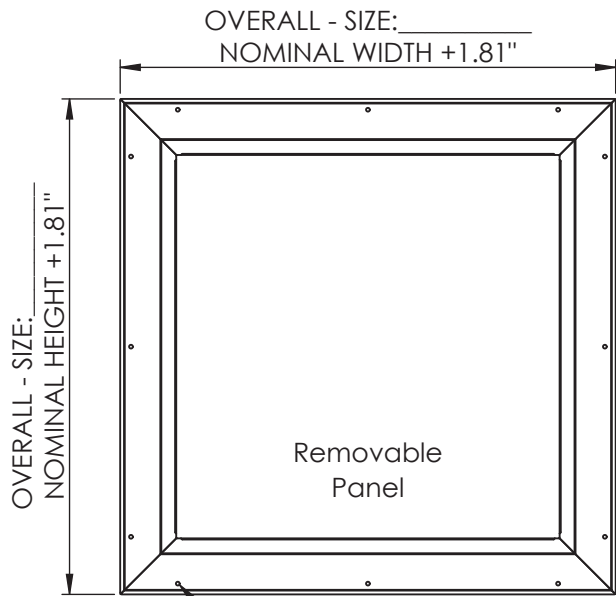
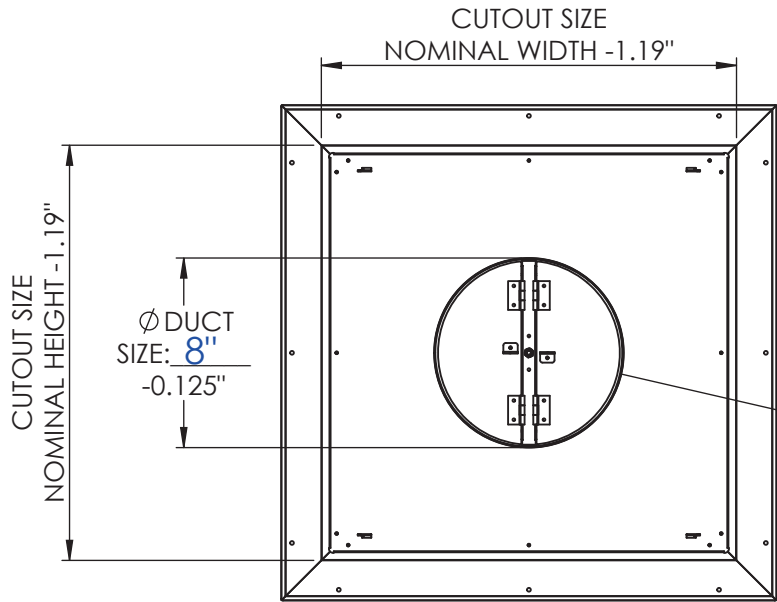

Countersunk Screw Holes (Typ)

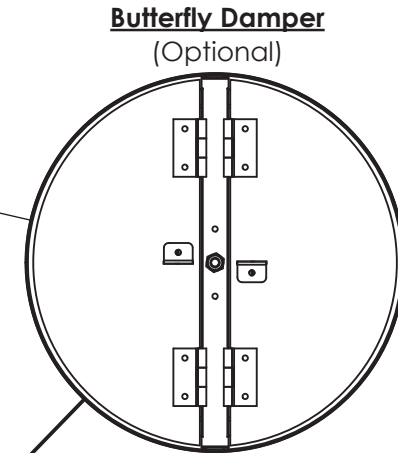

DETAIL D
SCALE 1 : 5

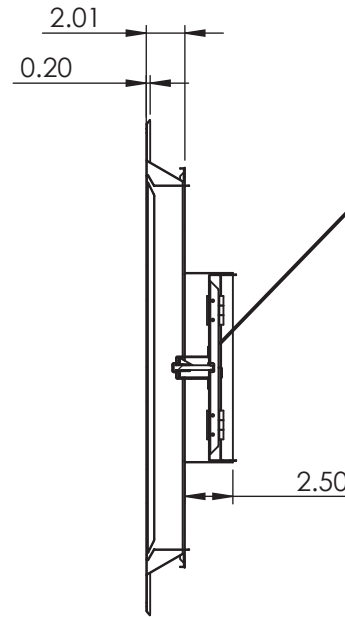

SECTION A-A

DRAWN SLG	MATERIAL 304SS	JOB NAME	TAG	QTY	REV # A
CHKD	FINISH #4 SATIN	ENGINEER	DRAWING NAME SSPD-SURFACE MOUNT		SHT 2/2
					SCL 1:10
					DO NOT SCALE

Job Name: UAMS CAMID
 Tag Name: G-5 Quantity: 16
 Unit Size: Qty (14) 12"x6", Qty (2) 10"x12"

STAINLESS STEEL

SSPERF-R

PERFORATED RETURN GRILLE
 SURFACE MOUNT

OPTIONS

- 304 Stainless Steel (Standard)
 - #4 Satin Finish (Standard)
- 316 Stainless Steel
 - #4 Satin Finish
- White Antimicrobial Epoxy Powdercoat Finish
- Other Color: _____
- Top Inlet - (Select Shape/Size)
- Round Inlet - Size: _____
- Square Inlet - Size: _____
- Rectangle Inlet - Size: _____
 - Flanged
- S-44 Opposed Blade Damper (Damper where indicated)
- Lay-In (No Screw Holes In Face)
 (Order Size=Nominal -2.00")

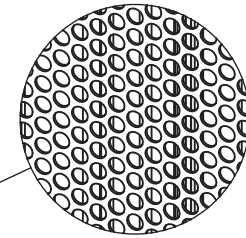
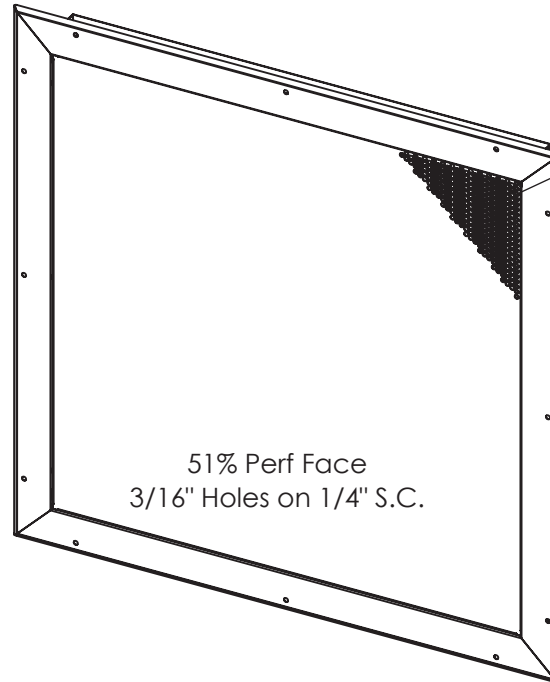

51% Perf Detail

* To maintain AJ Manufacturing's policy of continuous product improvement, we reserve the right to change any information concerning product or pricing without notice or obligation *



8701 Elmwood Ave #400
 Kansas City, MO 64127
 Ph: 816-231-5522 F
 800-247-5746 Email: rot
 Please Visit Our Web Site At

DRAWN SLG	MATERIAL 304SS	JOB NAME	TAG	QTY	REV # A
CHKD	FINISH #4 SATIN	ENGINEER	DRAWING NAME SSPERF-R-SURFACE MT		SHT 1/2
					SCL 1:8
					DO NOT SCALE

STAINLESS STEEL

SSPERF-R PERFORATED RETURN GRILLE SURFACE MOUNT

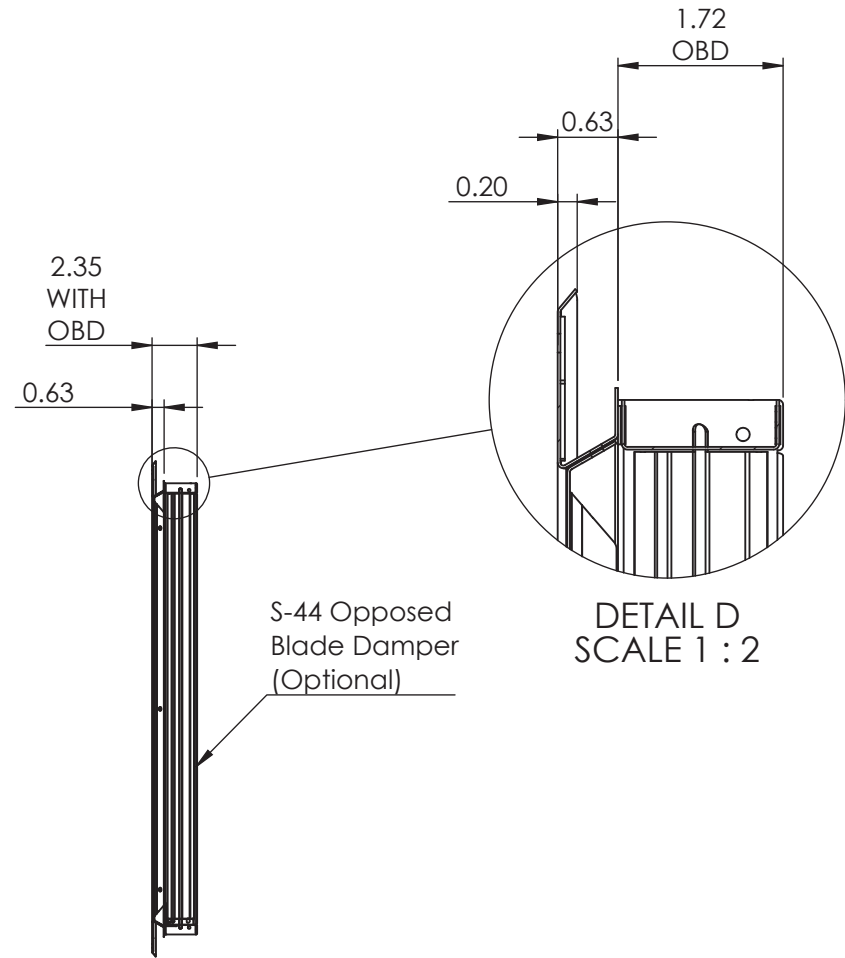
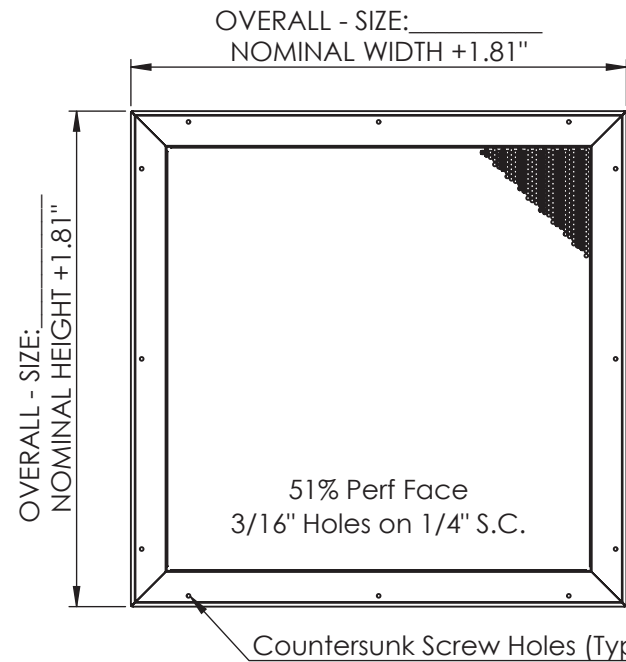
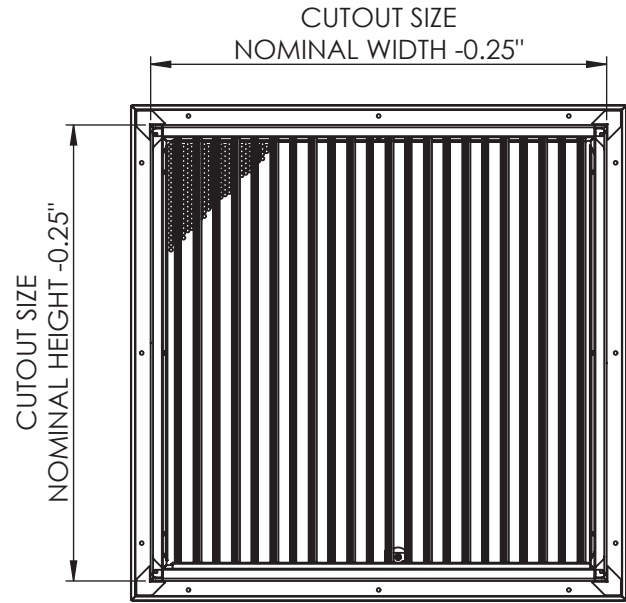

SECTION A-A



8701 Elmwood Ave #400
Kansas City, MO 64127

Ph:816-231-5522 F
800-247-5746 Email:rol
Please Visit Our Web Site At

DRAWN SLG	MATERIAL 304SS	JOB NAME	TAG	QTY	REV # A
CHKD	FINISH #4 SATIN	ENGINEER	DRAWING NAME SSPERF-R-SURFACE MT		SHT 2/2
					SCL 1:10
					DO NOT SCALE

Job Name: UAMS CAMID

Tag Name: G-8 Quantity: 1

Unit Size: 24x24 -- Qty (1) 10" neck

SSPD STAINLESS STEEL

STAINLESS SQUARE PANEL DIFFUSER
SURFACE MOUNT

OPTIONS

- 304 Stainless Steel (Standard)
 - #4 Satin Finish (Standard)
- 316 Stainless Steel
 - #4 Satin Finish
- White Antimicrobial Epoxy Powdercoat Finish
- Other Color: _____
- 4-Way Airflow (Standard)
- 2-Way Airflow
- Butterfly Damper

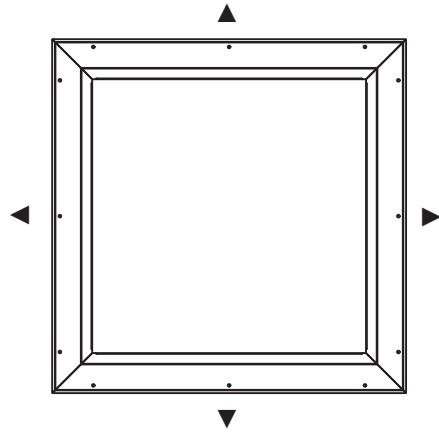
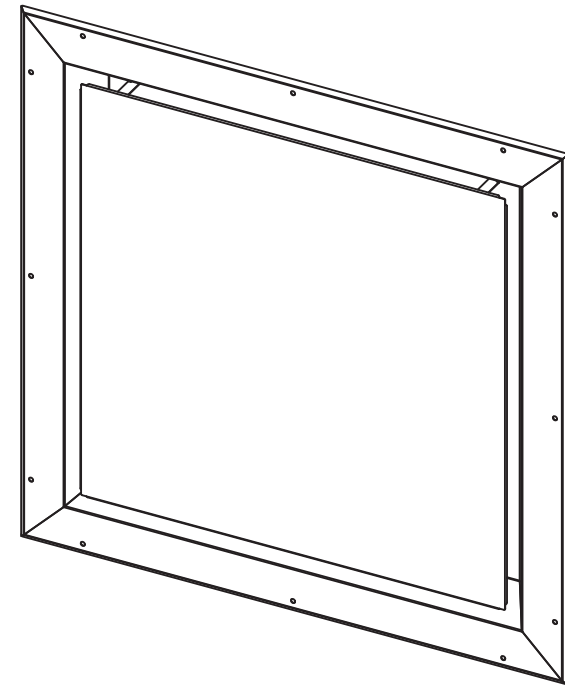

4-Way Airflow (Standard)

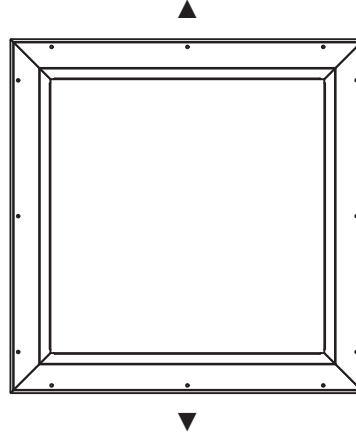

2-Way Airflow

* To maintain AJ Manufacturing's policy of continuous product improvement, we reserve the right to change any information concerning product or pricing without notice or obligation *



DRAWN SLG	MATERIAL 304SS	JOB NAME	TAG	QTY	REV # A
CHKD	FINISH #4 SATIN	ENGINEER	DRAWING NAME SSPD-SURFACE MOUNT		SHT 1/2
					SCL 1:8
					DO NOT SCALE