



Quality People. Building Solutions.

Comfort Systems USA (Arkansas), Inc.
P.O. Box 16620
Little Rock, AR 72231
Phone 501-834-3320
Fax 501-834-5416

Date: 4/21/2022

Return Request: 4/30/2022

Project: JLM VA – Medical Media Relocation

Supplier: Sanders Supply

Manufacturer: Various

Submittal: Plumbing Fixtures

Submittal Number: 22 40 00-01

Drawing # and Installation: Plumbing Drawings

ARCHITECT

Johnson Danforth & Associates
2200 N. Rodney Parham, Suite 210
Little Rock, AR 72212
501-404-4811

ENGINEER

Insight Engineering
201 S. Chester, Suite B
Little Rock, AR 72201
501-237-3077

GENERAL CONTRACTOR

A4 Services Group
15540 Hwy. 5
Cabot, AR 72023
501-581-2989

MECHANICAL SUBCONTRACTOR

Comfort Systems USA (Arkansas), Inc.
9924 Landers Rd.
N. Little Rock, AR 72117
501-834-3320

Notes:

--

CSUSA PROJECT NO.

22-184

jon@comfortar.com

9924 Landers Rd.
No. Little Rock, AR 72117



201 S Chester
Little Rock, AR 72201
501.237.3077



Department of Veterans Affairs
Central Arkansas Veterans Health Care System
☒ Reviewed
☒ No Exceptions Taken
☒ Furnish as Corrected
☐ Revise and Resubmit
☐ Rejected

By: Rick Sellers

Submittal Comment Sheet

- 1. Plumbing Insulation
 - a. Hot water to be 1.5" thick

Project Name: Renovate Medical Media

Project Number:19-030

Date Received:6/2/2022

Date Returned:6/15/2022

Reviewed By: KCK

Comments for 22 13 00 - Plumbing:

- 1. Plumbing Insulation
 - a. ~~Approved~~
- 2. Sanitary Sewer Piping
 - a. Approved
- 3. Plumbing Fixtures
 - a. S-1 – Approved
 - b. WC-1 – Approved
 - c. FD-1 - Approved

End of Comments

THE CONSULTANTS OF RECORD FOR THIS PROJECT HAVE REVIEWED THESE SHOP DRAWINGS. THE CONSULTANTS' COMMENTS AND REVIEW STAMP ARE APPLICABLE FOR THEIR PORTION OF THE WORK. THE REVIEW AND CHECKING OF THE REFERENCED SUBMITTED DOCUMENTS IS FOR GENERAL CONFORMANCE WITH THE DESIGN INTENT OF THE PROJECT AND GENERAL COMPLIANCE WITH THE INFORMATION GIVEN IN THE CONTRACT DOCUMENTS. ANY ACTION SHOWN IS SUBJECT TO THE REQUIREMENTS OF THE PLANS AND SPECIFICATIONS. REVIEW IS NOT CONDUCTED FOR THE PURPOSE OF DETERMINING THE ACCURACY AND COMPLETENESS OF OTHER DETAILS, SUCH AS DIMENSIONS AND QUANTITIES, FOR SUBSTANTIATING INSTRUCTIONS FOR INSTALLATION OR PERFORMANCE OF EQUIPMENT OR SYSTEMS, OR FOR COORDINATION OF THE WORK OF ALL TRADES, ALL OF WHICH REMAIN THE RESPONSIBILITY OF THE CONTRACTOR AS REQUIRED BY THE CONTRACT DOCUMENTS. CONTRACTOR IS RESPONSIBLE FOR ALL QUANTITIES.



Relocate Medical Media

Little Rock, AR

Comfort Systems USA

North Little Rock, AR

Operation & Maintenance

Sanders Supply



Hot Springs, AR

September 12, 2022

Relocate Medical Media

Plumbing Fixture Schedule Index

<u>TAB</u>	<u>Description</u>
S-1	Sink ADA
WC-1	Water Closet ADA
FD-1	Floor Drain

S-1

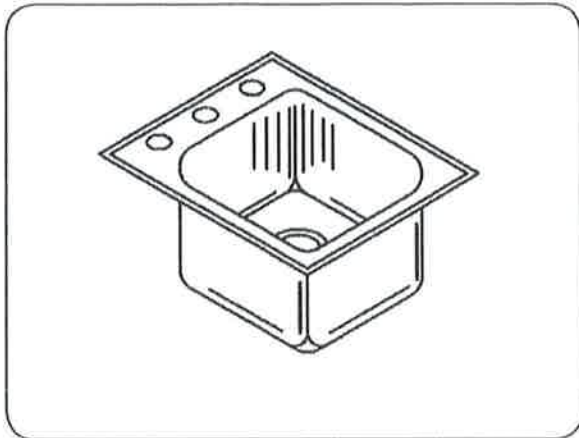

SPECIFICATION

Seamless die-drawn construction of Type 304, 18-8 stainless steel. Interior and top surfaces polished to a non-porous Hand-Blended Just Finish with highlighted bowl rim. Fully coated underside insulated for sound and reduces condensation. Straight-sided compartment with radius corners provides greater capacity. Self-rimming top mount Grip-Rim Plus with stainless steel mounting channels. Conforms to ASME/ANSI A112.19.3M. Certified conformance with ASME A112.19.3/CSA B45.4, Canadian Standards (CSA), Uniform Plumbing Code (UPC) and International Plumbing Code (IPC) and Americans with Disabilities Act(ADA). Drain punch 3-1/2" centered for Just J-35 drain.

☐ **TYPE 316 STAINLESS STEEL** (Check if applicable)

CUTOUT DIMENSIONS		
Model Number	Front-to-Back	Left-to-Right
SL-ADA-1815-A-GR	17-1/4	14-1/4

APPROVED FOR MANUFACTURING	
MODEL NO: SL-ADA-1815-A-GR	QTY: _____
JOB NAME: Relocate Medical Media	
TAG/ITEM: S-1	
CUSTOMER: _____	
SIGNATURE: _____	

JUST MANUFACTURING COMPANY

SL-ADA-1815-A-GR

STYLIST GROUP
LEDGE TYPE - SINGLE BOWL
18 GAUGE

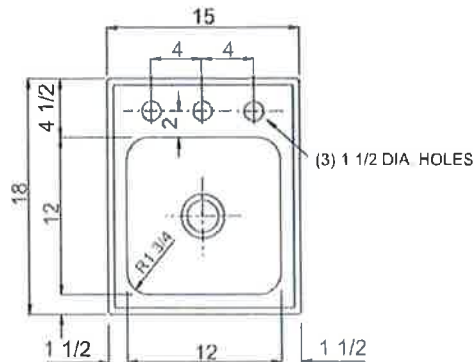

3.84

Gallon
Capacity*

Capacity Matters

Max ID sizing with straight sided bowl configuration (non tapered sides). Tight corner radius design.

*Capacity is based on 6-1/2" Depths

FAUCET PUNCHING - MUST BE SPECIFIED					
<input checked="" type="checkbox"/> (1) Hole Centered					
<input type="checkbox"/> (2) Holes on 4" centers					
<input type="checkbox"/> (3) Holes on 4" centers (illustrated)					
<input type="checkbox"/> Alternate Punching: Faucet Model: _____		Punching Required: _____			

DEPTH - MUST BE SPECIFIED: Please Verify-Not Specied					
<input type="checkbox"/> 4 1/2" DEEP	<input type="checkbox"/> 5" DEEP	<input type="checkbox"/> 5-1/2" DEEP	<input type="checkbox"/> 6" DEEP	<input type="checkbox"/> 6-1/2" DEEP	

DRAIN LOCATION - MUST BE SPECIFIED:				
<input checked="" type="checkbox"/> CENTER	<input type="checkbox"/> CENTER REAR	<input type="checkbox"/> LEFT REAR	<input type="checkbox"/> RIGHT REAR	



NSF

JUST MFG COMPANY CONTINUES TO MAKE QUALITY AND FUNCTIONALITY A MARK OF THE JUST PRODUCT LINE. TO DO SO REQUIRES THAT WE RESERVE THE RIGHT TO CHANGE PRODUCT INFORMATION WITHOUT NOTICE. DIMENSIONS MAY VARY AND ARE SUBJECT TO CHANGE WITHOUT NOTICE. NO RESPONSIBILITY IS ASSUMED FOR USE OF SUPERSEDED OR VOIDED DATA. FOR THE MOST CURRENT AND ACCURATE INFORMATION REGARDING THE COMPLETE LINE OF JUST SINKS, FAUCETS AND DRAINS, CLICK ON THE **SPEC LINE DRAWINGS** LINK ON OUR WEB SITE AT www.justmfg.com

PH: 847-678-5150

FAX: 847-678-6817

9233 KING STREET, FRANKLIN PARK, ILLINOIS, 60131-2111

E-MAIL: custserv@justmfg.com www.justmfg.com

Care and Cleaning Sheet

Maintaining the beauty of Stainless, the easy care way...

Much of the beauty of stainless lies in its long-lasting wear and enduring good looks. Follow these few simple steps, and your stainless products from Just will retain their original beauty for years to come.

An ounce of prevention ...



Forget the pound of cure. Stainless is easily kept stain-free with these simple steps:

- * Since most soaps and detergents contain chlorides, Just recommends frequent rinsing of your stainless sink, preferably after each use.
- * Combine this simple daily treatment with a weekly cleansing with an abrasive cleaner, ideally Bon-Ami or Zud. Unlike porcelain sinks, durable stainless stands up strongly to abrasive cleansers. Remember always to scrub in the direction of the polish lines so that your efforts blend with the surface of your sink. For a less aggressive approach, try cleaning your sink with a paste of baking soda and water. Rinse well and dry. Regularly drying your sink works wonders to prevent water and surface rust marks.
- * Looking for that extra sparkle? Use flour power to polish your sink by applying dry flour when the look you're after is a gleaming finish. Rub the flour in with a soft cloth, and then rinse and dry.
- * Club soda will do the sparkle trick as well. After placing the stopper in your sink, pour some club soda in and rub with a soft cloth. As always, dry with a soft cloth to prevent water spots and surface rust.
- * Add some shine with a few drops of baby oil. Wipe off with paper toweling and repeat for added shine.

Some things are best avoided: A few DONT's for Stainless care...

- * Don't let soap cleansers dry on the sink's surface. Rinse regularly to keep the chlorides found in most cleansers from affecting the natural luster of stainless.
- * Steer clear of steel wool pads. The iron particles that are left behind can lead to rust and corrosion. For hard-to-clean projects, try a ScotchBrite scouring pad when the job at hand requires a little extra effort, again in the direction of the grain.
- Avoid leaving steel and cast iron cookware in your sink for extended periods of time. Iron plus moisture on top of stainless can lead to surface rust and staining.
- * Rubber dish mats, wet sponges and cleaning pads are a no-no for a lengthy stay in your sink. Since they trap water, discoloration and staining can result.
- * Just as you don't use your cutting board to clean the dishes, don't use your sink as a cutting board. Knives and other sharp kitchen instruments will naturally damage the surface of your sink.

JUST MANUFACTURING COMPANY

9233 KING STREET . FRANKLIN PARK . ILLINOIS . 60131-2111

PH: 847-678-5150

FAX: 847-678-6817

E-MAIL: custserv@justmfg.com

www.justmfg.com



JUST MANUFACTURING COMPANY	9233 KING STREET	FRANKLIN PARK	ILLINOIS	60131
PH: 847.678.5150	FAX: 847.678.6817	E-MAIL: CUSTSERV@JUSTMFG.COM	WEBSITE: WWW.JUSTMFG.COM	

JUST LIMITED LIFETIME RESIDENTIAL SINK WARRANTY

JUST MANUFACTURING COMPANY warrants to the original purchaser of a Just stainless steel sink that Just will, at its option, replace or repair, without charge, such product if it fails due to a manufacturing defect for a lifetime of normal residential use. Product replacement does not include transportation cost or labor installation cost. This warranty covers only stainless steel self-rimming drop-in sinks installed in a conventional countertop surface and stainless steel undermount sinks installed in a conventional solid surface countertop and applies to residential installations only. Just reserves the right to examine product in question and its installation prior to replacement.

WASTE FITTINGS AND ACCESSORIES ARE NOT WARRANTED

This warranty applies to sinks purchased after January 1, 2014 as shown on the purchaser's dated receipt. For sinks purchased prior to that date, the applicable warranty at that time will be in effect. The warranty does not cover product failure or damage caused by the use of optional accessories, abusive treatment, misuse, environmental factors, freight damage, normal wear including dents and scratches, improper care and cleaning, use of aggressive and abrasive cleaners, damage due to handling or failure to follow the recommended procedures for installation, care and maintenance.

This warranty does not cover obsolete, discontinued nor display products, whether such items are purchased at discount outlets and/or on-line or sold on clearance or close out.

All incidental or consequential damages are specifically excluded. No additional warranties, express or implied are given, including but not limited to, any implied warranty of merchantability or fitness for a particular purpose.

Some states do not allow the exclusion or limitation of incidental or consequential damages or limitations on how long an implied warranty lasts, so the above limitations or exclusions may not apply to you.

This warranty gives you specific legal rights, and you may also have other rights which vary from state to state.

TO OBTAIN SERVICE UNDER WARRANTY

1. Write to: Just Manufacturing Company
Attn: Customer Service
9233 King Street
Franklin Park, IL 60131
2. Include a letter containing the following information:
 - a. Date of purchase and installation.
 - b. Proof of Purchase (copy of original dated invoice).

- c. Description of nature of defect.
- d. Model number or description of model and/or component part if possible.

JUST MANUFACTURING COMPANY warrants that all parts and finishes of its residential brand faucets are free from defects in materials and workmanship for the life of the product, if purchased after January 1, 2014. This warranty covers the original consumer purchaser of the product only.

For defects in material or workmanship, Just will, at its option, supply replacement parts (or if no longer available a comparable product). Just reserves the right to examine product in question and its installation prior to replacement.

What is not covered:

- 1. Damage caused by accident, negligence, misuse, abuse, improper installation or operation or failure to follow care or installation instructions enclosed with your product.
- 2. Damage occurring during shipment of the product (claims must be presented to the carrier).
- 3. Normal wear and tear.
- 4. Labor charges, costs of removal and reinstallation, and any damages to other property.
- 5. Obsolete, discontinued or display products, whether such items are purchased at discount outlets and/or on-line or sold on clearance/close out.

TO OBTAIN SERVICE UNDER WARRANTY

- 1. Write to: Just Manufacturing Company
 Attn: Customer Service
 9233 King Street
 Franklin Park, IL 60131
- 2. Include a letter containing the following information:
 - a. Date of purchase and installation.
 - b. Proof of Purchase (copy of original dated invoice).
 - c. Description of nature of defect.
 - d. Model number or description of model and/or component part if possible.

COMMERCIAL SINKS AND FAUCETS LIMITED WARRANTY

Just Manufacturing Company warrants its commercial sinks, custom sink tops and countertops, and faucets to be free of defects in workmanship and materials for a period of 7 years from the date of purchase. If item is defective due to faulty materials or workmanship, a new item or like type and size item will be supplied. This warranty does not cover transportation or installation charges. Contact Just Manufacturing Co. Customer Service Department at (847-678-5150) for complete details and conditions. If item is defective due to faulty materials or workmanship, a new item or like type and size item will be supplied.

WASTE FITTINGS AND ACCESSORIES ARE NOT WARRANTED

This warranty does not cover installation charges.

TO OBTAIN SERVICE UNDER WARRANTY

Write to: Just Manufacturing Company
 Attn: Customer Service
 9233 King Street
 Franklin Park, IL 60131

Include a letter containing the following information:

- a) Date of purchase and installation.
- b) Proof of Purchase (copy of original dated invoice).
- c) Description of nature of defect.
- d) Model number or description of model and/or component part if possible.

THIS LIMITED WARRANTY IS EXPRESSLY IN LIEU OF ANY OTHER WARRANTIES, EXPRESSED IMPLIED, ARISING BY LAW OR OTHERWISE, INCLUDING WITHOUT LIMITATION, ANY IMPLIED WARRANTY OF MERCHANTABILITY OR FITNESS FOR A PARTICULAR PURPOSE. THIS LIMITED WARRANTY MAY NOT BE ALTERED, VARIED, OR EXTENDED, EXCEPT BY A WRITTEN INSTRUMENT EXECUTED BY JUST MANUFACTURING COMPANY. THE REMEDY OF REPAIR OR REPLACEMENT AS PROVIDED UNDER THIS LIMITED WARRANTY IS EXCLUSIVE. IN NO EVENT SHALL THE MANUFACTURER BE LIABLE FOR ANY CONSEQUENTIAL OR INCIDENTAL DAMAGES TO ANY PERSON, WHETHER OR NOT OCCASIONED BY NEGLIGENCE OF JUST MANUFACTURING COMPANY, INCLUDING WITHOUT LIMITATION DAMAGES FOR LOSS OF USE, PROPERTY DAMAGE OR OTHER MONETARY LOSS.

Some states do not allow the exclusion or limitation of incidental or consequential damages or limitations on how long an implied warranty lasts, so the above limitations or exclusions may not apply. This warranty gives you specific legal rights and you may also have other rights which vary from state to state.

This warranty covers product installed in the United States and Canada.



BASYS® SENSOR FAUCET
EFX-100-HLP-TEE-CP-0.5GPM-MLM-IR-FCT
(General Model Name: EFX100.000.0000)

CODE NUMBER

3324030

DESCRIPTION

Hardwired Less Plug Power Supply, Back-Check Tee, Polished Chrome Finish, 0.5 gpm, Multi-Laminar Spray, Infrared Sensor, BASYS® Hardwired-Powered Deck-Mounted High Body Faucet.

DETAILS

- Flow Rate: 0.5 gpm (2 Lpm) (0.5GPM)
- Spray Type: Multi-Laminar (MLM)
- Sensor Type: Infrared (IR)
- Mounting Type: Single Hole (1)
- Power Supply: Hardwired Less Plug (HLP)
- Temperature Mixer: Back-Check Tee (TEE)
- Finish: Polished Chrome (CP)
- Factory Default Timeout: 10s
- Factory Default GPC: 0.083

FEATURES

Commercial Grade, ADA Compliant, Electronic, Sensor-Activated, Die-Cast Metal Hand Washing Faucet with the following features:

- One tool service
- All wetted components to be stainless steel, engineered thermoplastic, EPDM, and copper or copper alloy
- Solenoid housed in removable carrier that includes supply strainer
- Integral water supply shut off
- Supply strainer serviceable from above deck
- Vandal resistant spray insert, key housed inside faucet body
- All electronics sealed to IP-67
- Gold plated electrical contacts
- Above deck individual diagnostic indicators for battery life, solenoid condition, and power up mode
- Flexible, high pressure supply hoses, 3/8" compression connections
- Bi-stable magnetic solenoid
- Four (4) "AA" alkaline batteries
- Double infrared sensors with automatic setting feature includes all mounting hardware
- Line purge mode, eliminates stagnant water
- Adjustable time-outs
- Standard Bowed Crown

ELECTRICAL SPECIFICATIONS

- Battery Life: 3 years 8,000 cycles/month
 - Optional power harvesting significantly extends service life
- Sensor Range: 4" - 5" (102 - 127mm)

VIDEOS

- BASYS® Faucet Installation and Features
- Sloan Connect App®

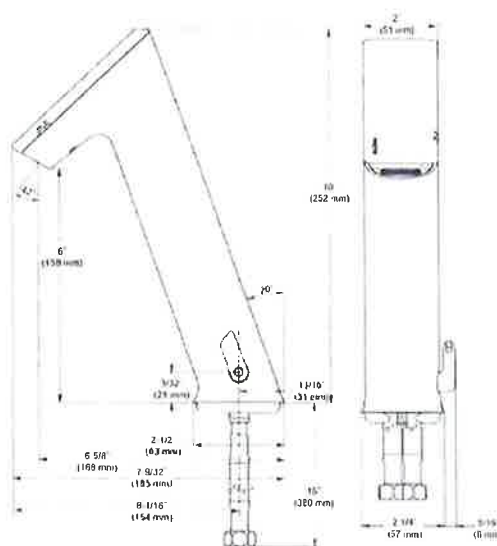

COMPLIANCES & CERTIFICATIONS



(ADA Compliant, ASME A112.18.1 Compliant, CalGreen Compliant, CEC Compliant, cUPC Certified, UPC Certified, UPC Low Lead Compliant, cUPC Low Lead Compliant, EPD, HPD, NYC604.4, Proposition 65, Satisfies LEED Credits, TAS, WELL Building Standard)

RECOMMENDED SPECIFICATION

Sloan BASYS Model No. EFX-100-HLP-CP-0.5GPM-MLM-IR-FCT Infrared Sensor Activated Electronic Handwashing Faucet for pretempered or hot/cold water supplies. Product to have double infrared sensors with automatic setting feature.

Sloan 10500 Seymour Ave, Franklin Park, IL 60131
Phone: 800.982.5839 • Fax: 800.447.8329 • sloan.com



BASYS® SENSOR FAUCET
EFX-100-HLP-TEE-CP-0.5GPM-MLM-IR-FCT
(General Model Name: EFX100.000.0000)

DOWNLOADS

- [EFX 1Xx/2Xx Installation Instructions](#)
- [EFX 1Xx/2Xx \(SP\) Installation Instructions](#)
- [EFX 1Xx/2Xx Caddy Replacement Installation Instructions](#)
- [IR FAQs Repair and Maintenance Guide](#)
- [IR FAQs SP Repair and Maintenance Guide](#)
- [EFX-1XX Repair and Maintenance Guide](#)
- [Trim Plate Guide](#)
- [Faucet Spray Heads Repair and Maintenance Guide](#)
- [Additional Downloads](#)

Solenoid valve housed in removable carrier that closes water supply upon removal eliminating need to access control stops. Solenoid carrier includes strainer for easy above deck service. Thermostatic mixer ordered separately to comply with ASSE 1070 requirements. The product shall be tested and certified to industry standards: ASME A112.18.1M, CSA B125.1, California Health and Safety Code 116875

NOTES

All information contained within this document subject to change without notice.

Looking for other variations of the EFX-100 product? [View the general spec sheet with all options.](#)

[Find a matching soap dispenser for this faucet.](#)

[Find a compatible sink for this faucet.](#)

WARRANTY

3 Year

Sloan 10500 Seymour Ave, Franklin Park, IL 60131
Phone: 800.982.5839 • Fax: 800.447.8329 • [sloan.com](#)



BASYS® SENSOR FAUCET
EFX-100-HLP-TEE-CP-0.5GPM-MLM-IR-FCT
(General Model Name: EFX100.000.0000)

ROUGH-IN

EFX-100.00X.0X1X Faucet
with Single Line Water Supply

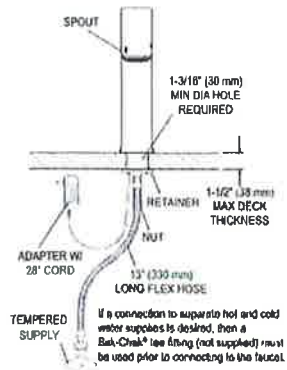

EFX-100.50X.0X1X Faucet
with Hot & Cold Water Supply

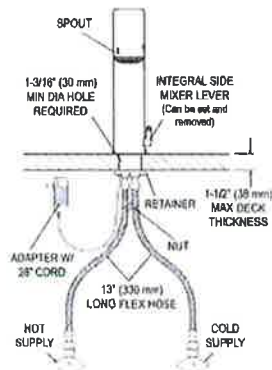

Electrical Connection for up to 6 Faucets
Can combine up to six (6) faucets using one adapter

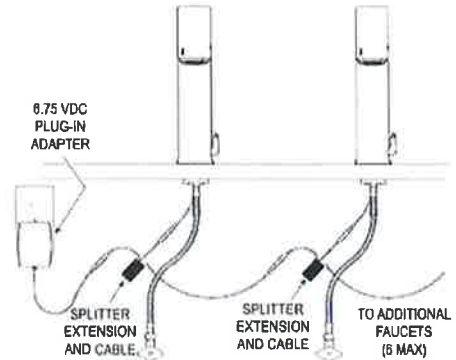

Sloan 10500 Seymour Ave, Franklin Park, IL 60131
Phone: 800.982.5839 • Fax: 800.447.8329 • sloan.com

THESE ARE NO WARRANTIES WHICH EXTEND BEYOND THE DESCRIPTION ON THE FACE HEREOF. IN NO EVENT IS SLOAN VALVE COMPANY RESPONSIBLE FOR ANY CONSEQUENTIAL DAMAGES OF ANY MEASURE WHATSOEVER.

PRIOR TO INSTALLATION

Prior to installing the Sloan BASYS™ Series Faucets, install the items listed below. Also, refer to rough-in illustrations.

- Lavatory/sink
- Drain line
- Hot and cold water supply lines or pre-tempered water supply line

IMPORTANT:

- **ALL PLUMBING SHOULD BE INSTALLED IN ACCORDANCE WITH APPLICABLE CODES AND REGULATIONS.**
- **FLUSH ALL WATER LINES PRIOR TO MAKING CONNECTIONS.**

- **KEEP THREAD SEALANT OUT OF YOUR WATERWAY TO PREVENT COMPONENT PART DAMAGE! DO NOT USE ANY SEALANT ON COMPRESSION FITTINGS.**

Base Plates

When the BASYS™ Faucet is installed on a sink that has three (3) hole punchings, a Base Plate should be used. **Base Plates should be specified at time of ordering.**

EFX-20-A Base Plate for 4" (102 mm) Centerset Sink

EFX-26-A Base Plate for 8" (203 mm) Centerset Sink

TOOLS REQUIRED FOR INSTALLATION

- 2.5 mm allen key for removing crown
- 5/8" open end wrench for U.S. hose fittings
- 3/4" open end wrench for International hose fittings
- 13 mm socket or nut driver for mounting nut

FAUCET ROUGH-IN

SINGLE SUPPLY 0.5 gpm (1.9 Lpm) Max. Flow ‡ Faucets with Single Tempered Water Supply

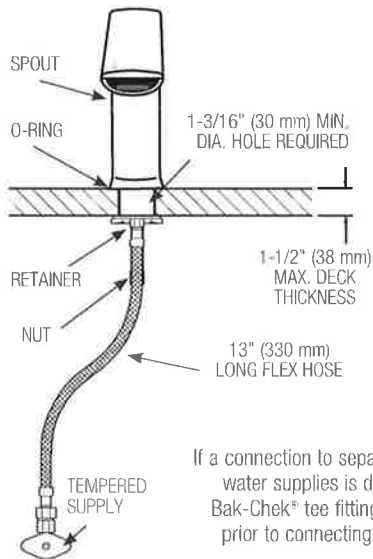

DUAL SUPPLY 0.5 gpm (1.9 Lpm) Max. Flow ‡ Faucets with Hot and Cold Water Supply

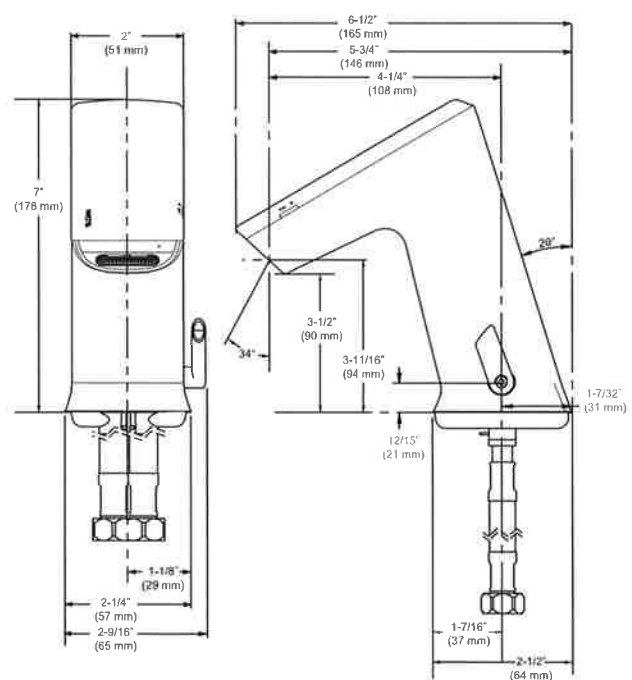
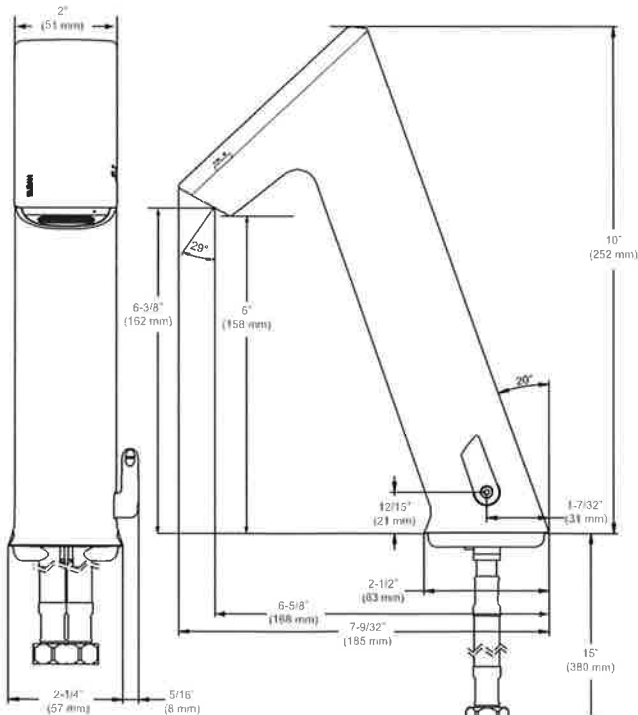
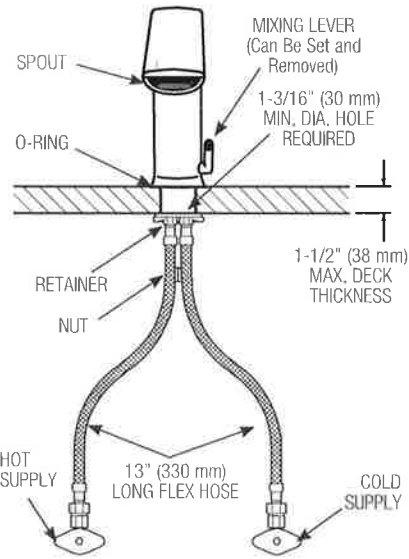

‡ Sloan BASYS™ Series Faucets are available with a 1.5 gpm (5.7 Lpm) Laminar and Aerated Inserts.

1 - INSTALL FAUCET

- A** Remove Nut and faucet retainer.
DO NOT REMOVE the D-shaped gasket from base of faucet.
NOTE: Do not remove sensor label until water is connected

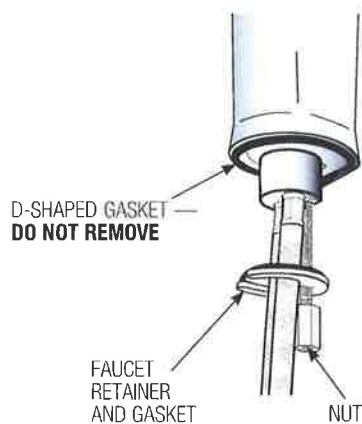

- B** Install Faucet with faucet retainer into the center hole in deck or lavatory — **1-3/16" (30 mm) min. hole required.**
NOTE: If installing the Faucet on a three (3) hole sink, a Base Plate should be installed at this time.

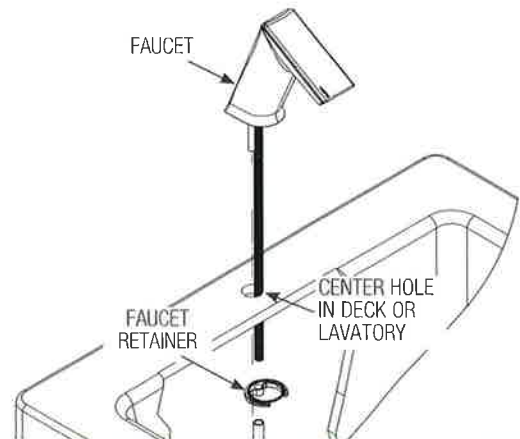

2 - SECURE TO SINK DECK

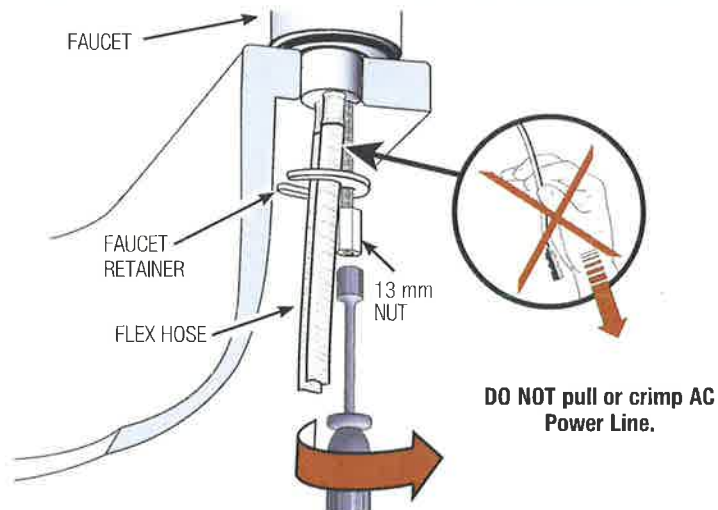

3 - CONNECT TO WATER SUPPLY

- A** **IMPORTANT:** Flush dirt, debris, and sediment from Supply Line(s) before Connecting Flex Hoses.

- B** Install flex hose(s) with gaskets onto supply stops.

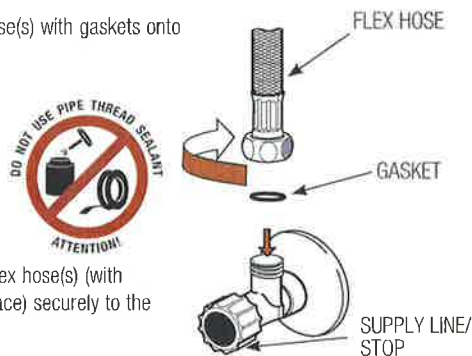

- C** Tighten the flex hose(s) (with gaskets in place) securely to the supply.

- D** **For single supply faucets** — Install flex hose with gasket onto mixing valve and connect check tee or mixing valve to hot and cold water supplies.

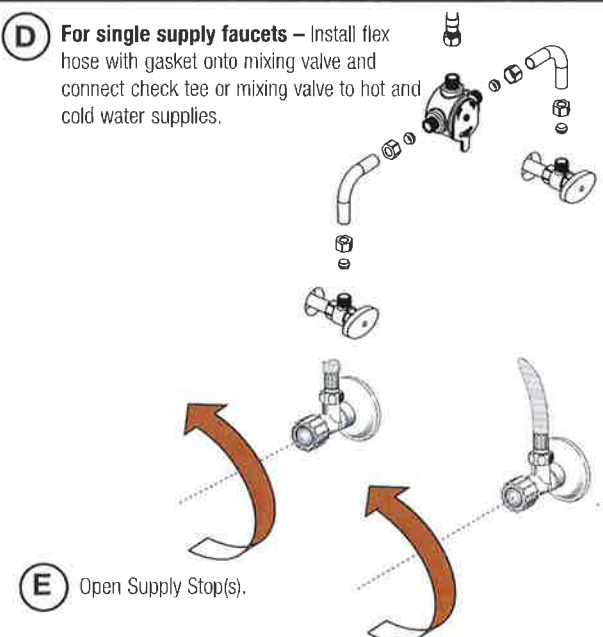

4 - START-UP SEQUENCE

- A** For Hardwire Models, Plug Adapter into receptacle.

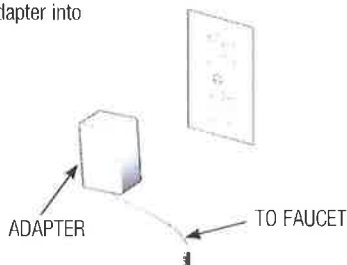

- B** Remove label from sensor window.

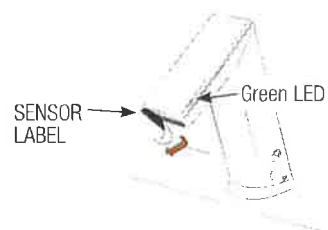

- C** Activate faucet by holding installation instructions approximately 1-1/2" (38 mm) in front of sensor window until RED LED turns on then remove instructions while faucet senses its surroundings. Wait for green LED on side of faucet.



- D** Activate faucet and check for leaks. If faucet does not function, refer to the troubleshooting section.

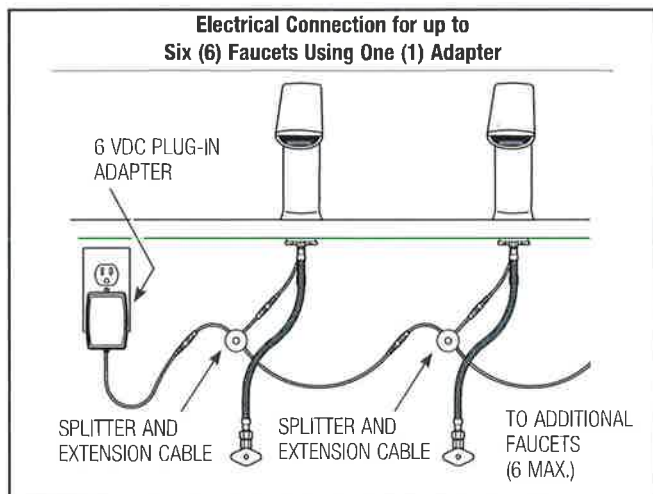

5 - SET AND FIX TEMPERATURE AND ADJUST HOT LIMIT STOP

- A** Adjust lever to set temperature.

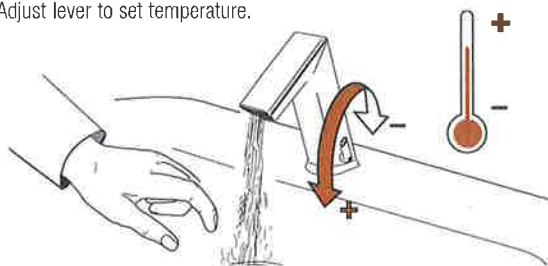

- B** Optional — To fix temperature, set lever to the desired position, then remove lever and plug hole with Cap.

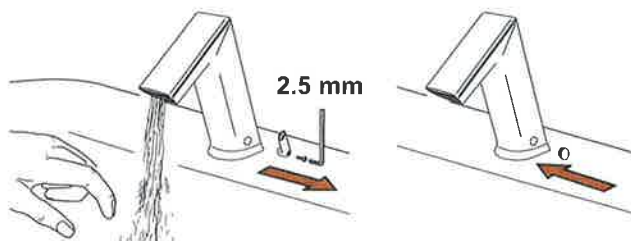

- C** **Optional Hot Limit Stop Adjustment** — To adjust the hot/cold mix (factory set at 50/50) remove the lever. Check to make sure dot is in center position before beginning adjustment.

Faucet may be adjusted in 10° increments.

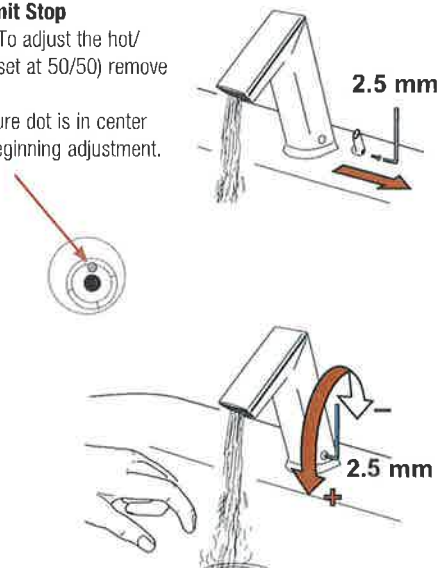

ADDITIONAL FUNCTIONS

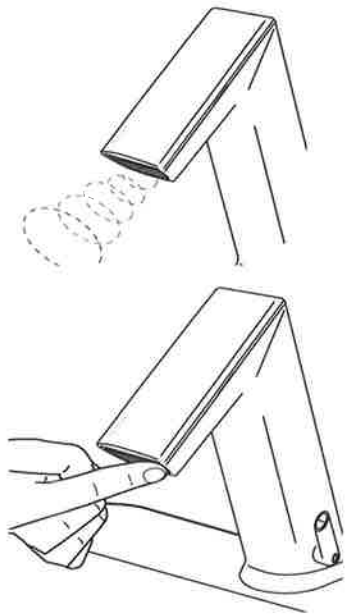

Function	Steps to Activate Function	Default Setting	IR Clic
IR Activation	Cover IR clic approximately for 2 sec. until LED will flash GREEN 1x - then remove finger from IR clic (Active for 5 sec.)	—	—
Cleaning Mode	IR activation; Cover IR clic 2x - confirmation of the function is active by a couple flashes by the LED; to return to normal operation cover IR clic 1x or the faucet will automatically return to normal function after 2 min.	2 min.	—
12/24 Line Purge Feature	See below.	Off	Off 12HR 24HR
Sensor Range Adjustment	See page 6.	6	1-8
Reset Electronics	IR activation; Cover IR clic 2x; LED will flash 5x Cover IR clic 1x for 5 sec. until LED flashes 4x, then remove finger from IR clic Wait for 20 sec. (After 10 sec. water will flow for 6 sec. and automatically adjust to environment)	Manually	—
Security Off	After 90 seconds (max) of hand and/or object within sensor appears permanent, waterflow will stop and will remeasure environment	On	—

Please contact factory for more extensive programming options.

12/24 LINE PURGE FEATURE

This feature will operate the faucet every 12 or 24 hours since last use, if not used to prevent stagnant water conditions.

Default purge duration is two minutes.

Consult factory regarding other timing options.

- A** IR activation (see above). Cover IR clic approximately 24 sec. (ignore LED indications during this period). Release when requested program is reached. (See diagram to right). Programming mode will time out after 2 minutes if no changes are made.

1x 24 sec

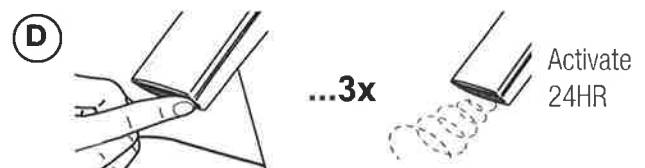
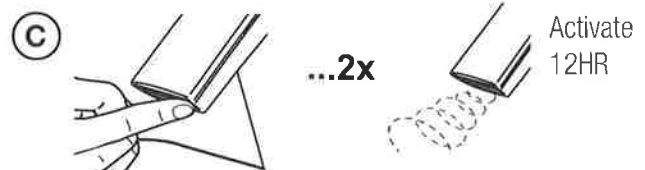
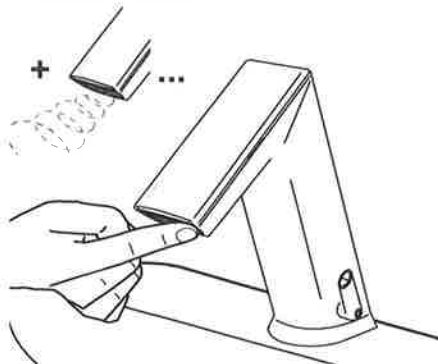

SENSOR RANGE ADJUSTMENT

FACTORY SETTING IS APPROPRIATE FOR THE MAJORITY OF APPLICATIONS AND SHOULD NOT REQUIRE RESETTING UNLESS UNDER EXTREME SITUATIONS: HIGH REFLECTION OR LOW LIGHT.

(A) IR Activation (see page 5). To enter programming mode place finger on IR clic for 2 times then remove. Light on side of crown should blink red to indicate programming mode.

(B) Cover IR clic until LED flashes Red 4 times-hold IR Clic until LED flashes 1 time to 8 times from minimum to maximum range. See diagram below. Release when requested range is reached.

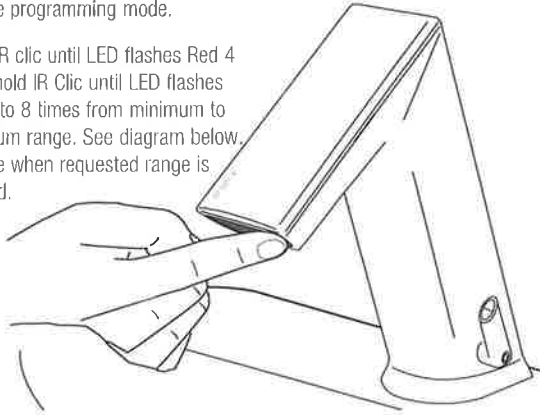

6x - Factory Setting

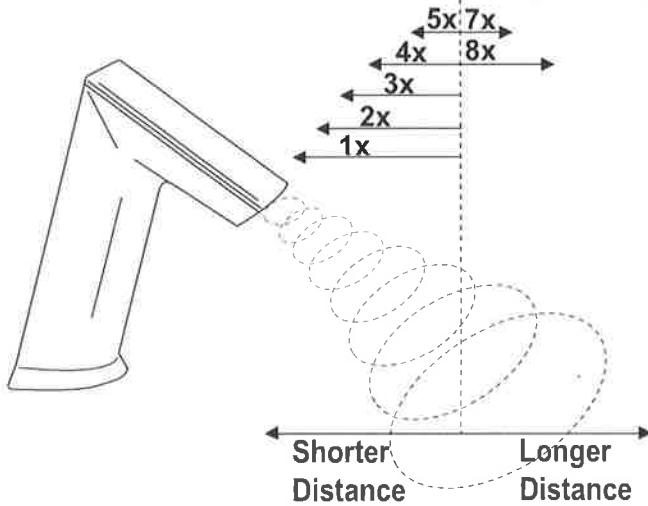

(C)

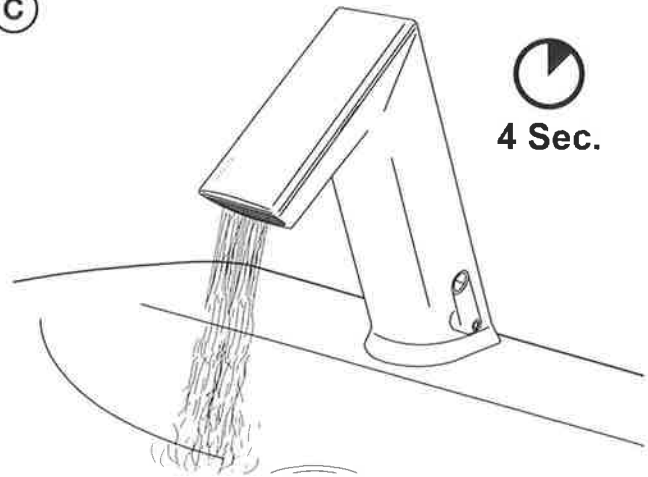

4 Sec.

(D)

Wait, until LED flashes GREEN.

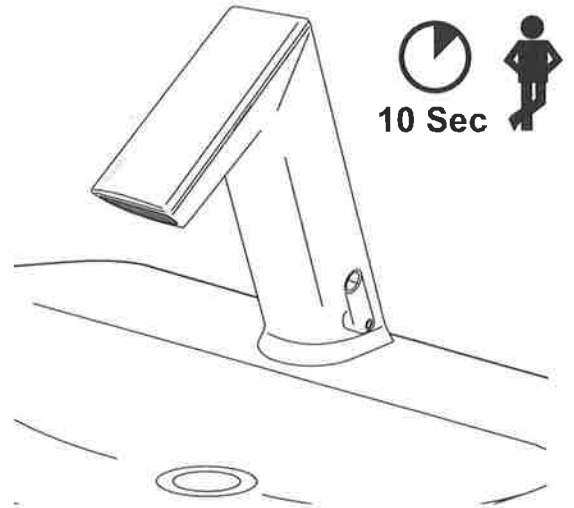

10 Sec

BATTERY REPLACEMENT

NOTE: Replace battery when LED1 indicator flashes red each time faucet is in use or when faucet stops functioning. LED1 is identified by the battery symbol.

NOTE: Turning off water is not necessary.

- A** Remove crown by loosening hex screw located on underside of spout and slide crown down and lift off.
NOTE: Screw is captive within faucet body and will not fall out.

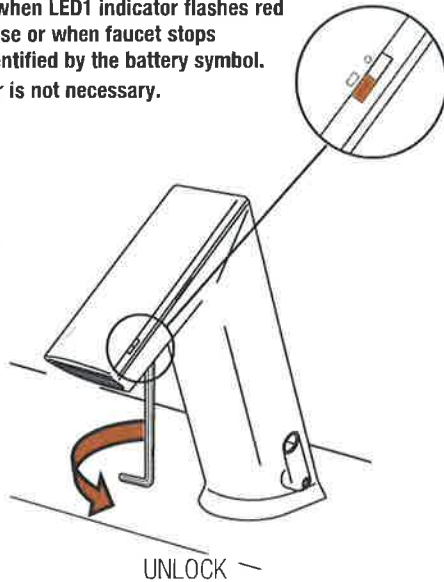

- B** Remove battery pack assembly by lifting out of spout.

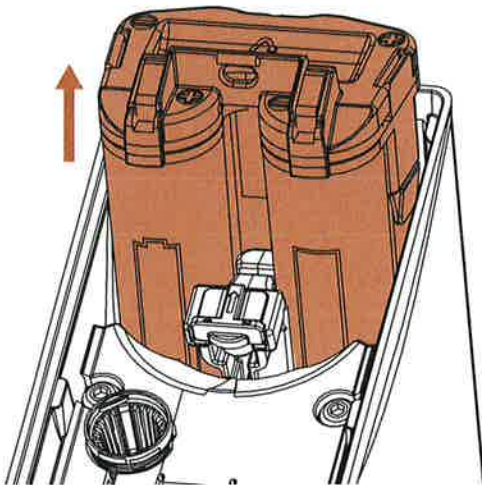

NOTE: Turbine faucet looks slightly different.

- C** Open battery pack assembly by pushing in tabs on side of assembly.

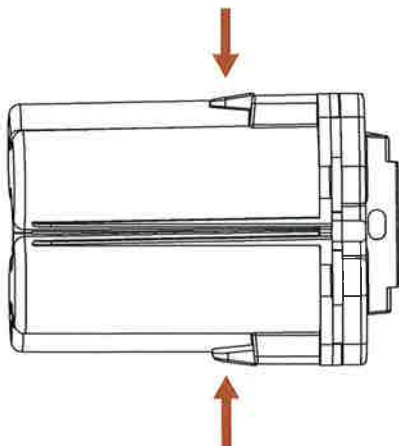

- D** Remove all four (4) AA-cell batteries from battery pack.

- E** Insert four (4) NEW AA-cell batteries into battery pack assembly cartridge.
NOTE: Insure batteries are installed with proper polarity. The cover of the case indicates polarity of batteries. Improper polarity will not harm the faucet. Improper polarity will cause the faucet not to operate.



- F** Replace cover of the battery pack assembly and reinsert assembly into faucet.

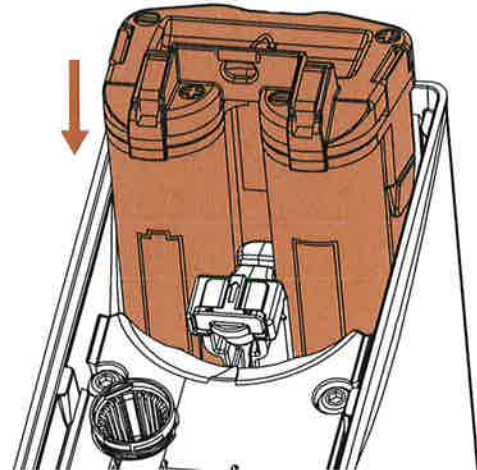

- H** Slide on crown and secure.

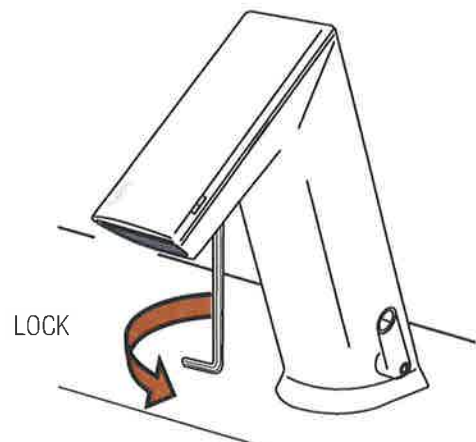

REPLACING THE SOLENOID/FILTER

NOTE: TURNING OFF WATER IS NOT NECESSARY, DUE TO INTEGRATED AUTOMATIC STOP VALVE.

- A** Remove crown by loosening hex screw located on underside of spout and slide crown down and lift off.

NOTE: Screw is captive within faucet body.

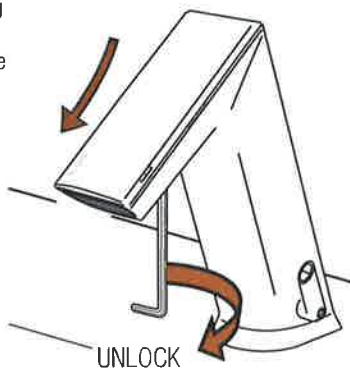

- B** Remove battery pack assembly by lifting out of spout.

SPARE
FILTER
(EXCEPT TURBINE
FAUCET)

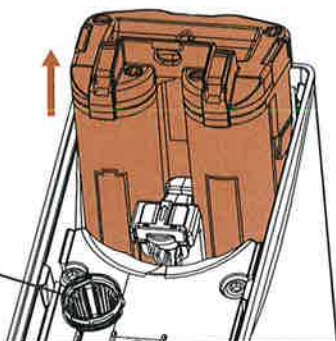

- C** Rotate solenoid assembly counter-clockwise through a 45° angle.



- D** Pull solenoid caddy from faucet.
NOTE: STRAINER CAN BE REMOVED, CLEANED AND REPLACED AT THIS TIME.

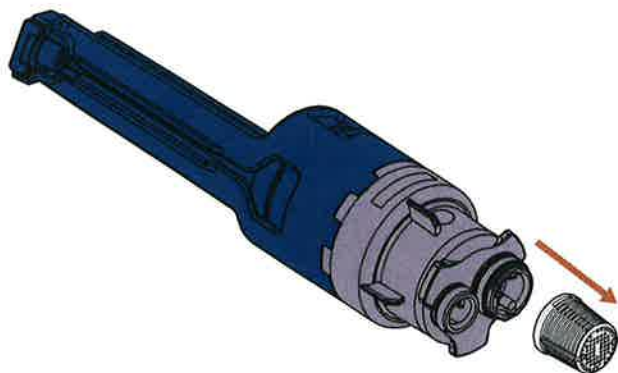

- E** Insert new solenoid caddy at a 45° angle.



- F** Rotate solenoid caddy clockwise to align with arrow, locking the unit and opening water path.

- G** Reinsert battery pack assembly.



- H** Slide on crown and secure.

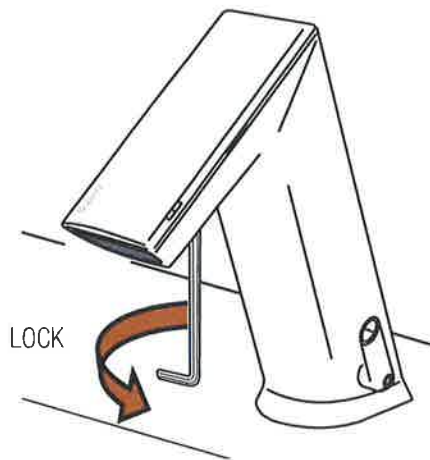

REPLACE SPRAY INSERT

NOTE: TURNING OFF WATER IS NOT NECESSARY, DUE TO INTEGRATED AUTOMATIC STOP VALVE.

- A** Remove crown by loosening hex screw located on underside of spout and slide crown down and lift off.
NOTE: Screw is captive within faucet body.

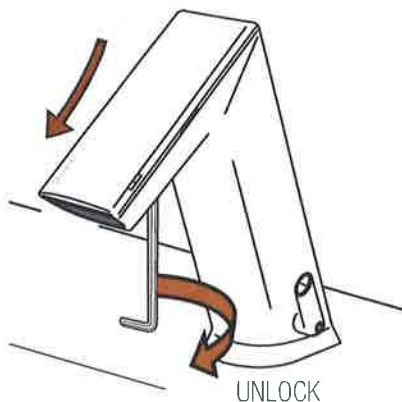

- B** Retrieve spray removal tool located near the spray insert.

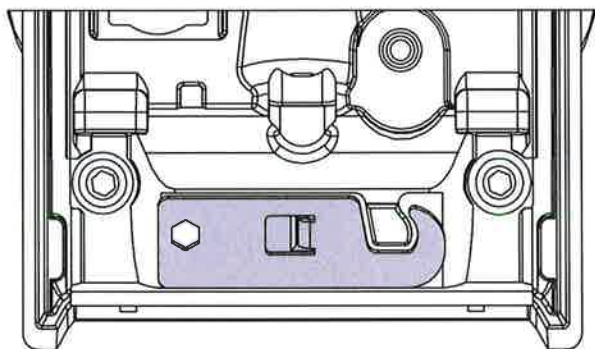

- C** Insert spray removal tool into spray slot by sliding hook end of key between faucet spout and insert. Pull insert out of faucet once hooked.

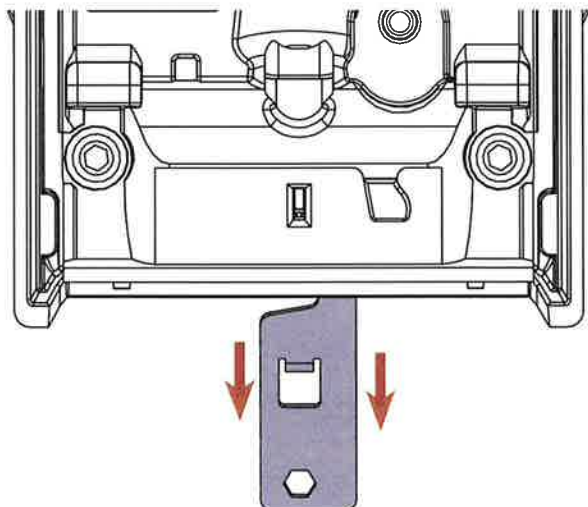

- D** Install new insert.
NOTE: If changing to a different flow rate solenoid caddy must also be changed.

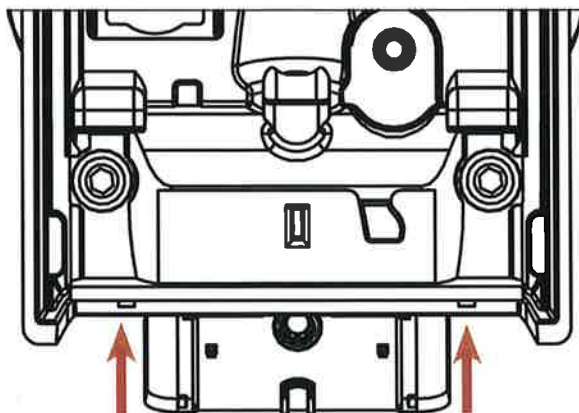

- E** Return spray removal tool to storage location.
NOTE: This can only be done once spray head is installed. This will lock the spray head in place.
NOTE: If spray head is inserted incorrectly – key will not lock in properly. Turn faucet on to push insert out and re-install.

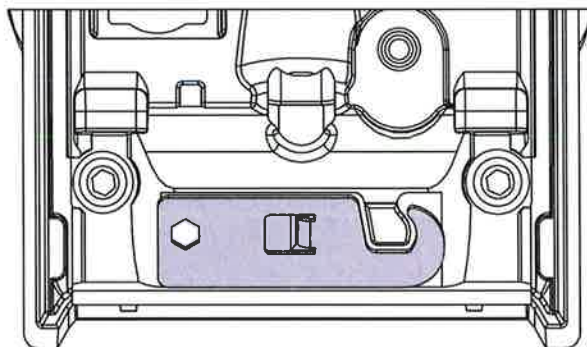

- G** Slide on crown and secure.

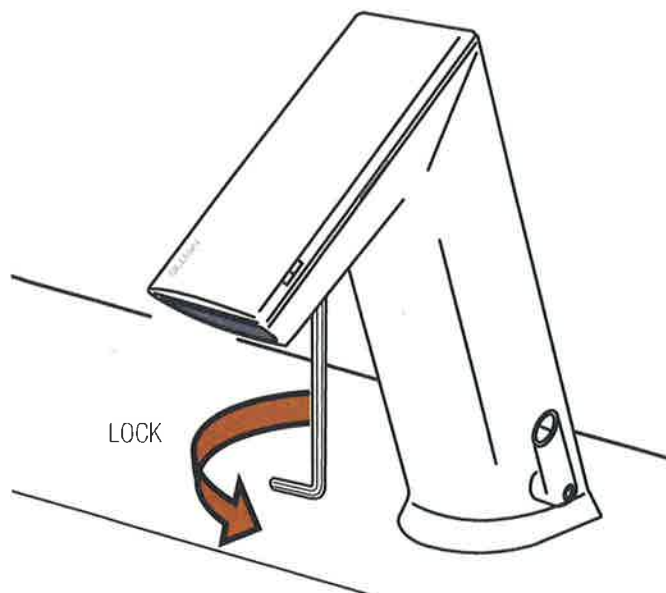

UPGRADE FAUCET FUNCTIONALITY

- A** Remove crown by loosening hex screw located on underside of spout and slide crown down and lift off.

NOTE: Screw is captive within faucet body.

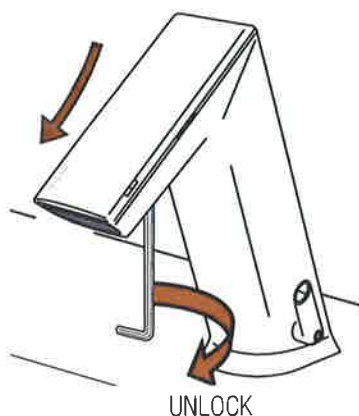

- B** Place new crown on faucet by sliding onto spout and tightening hex screw on underside of spout.

NOTE: All electronics are fully encapsulated in the crown and thus protected from the environment and easy to replace or upgrade.

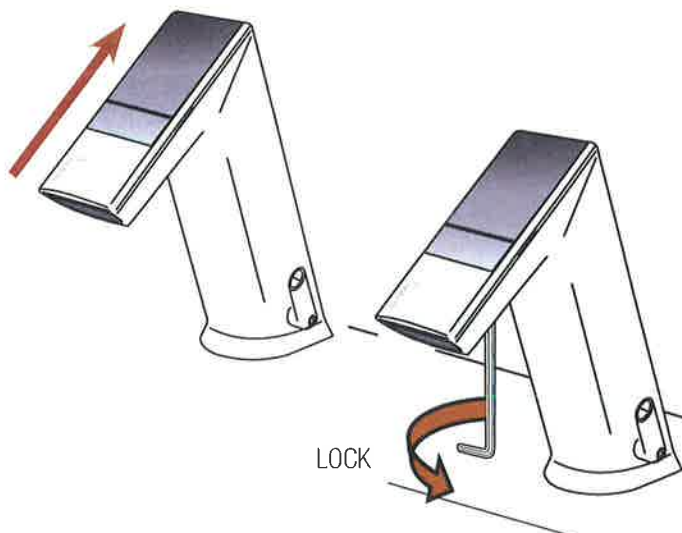

LED DISPLAY DIAGNOSTIC CODES

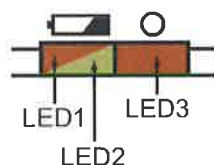

Function	LED1	LED2	LED3	Description 1	Description 2
Start Up Boot	LEDs BLINKING	LEDs BLINKING		LED1 and LED2 alternate blinking	Fast Toggle
Battery Check after Start Up	LEDs ON			LED1 on for 2 sec, if battery greater than 3.5V	
Line Power Check after Start Up			LEDs ON	LED3 on for 2 sec, if line power greater than 3.5V	
IR Adjust Process	LEDs BLINKING			LED1 blinking while IR adjusts	Few seconds
IR Adjust OK		LEDs ON		LED2 on for 2 sec, if adjustment OK	
Battery Low	LEDs BLINKING			LED1 blinks 3x, if battery is less than warning level	Only while in detection mode
Battery Empty	LEDs BLINKING			LED1 double flashes 3x, if battery is less than empty level	Only while in detection mode
Valve Error			LEDs BLINKING	LED3 double flashes 3x, if valve current error; flash after the 3rd error, off after the 3rd good operation	Flashes after the 3rd error, off after the 3rd good operation
IR Activation		LEDs ON		LED2 on for 2 sec, if IR-click has been activated	After 5 sec. automatically back to operating mode
Cleaning Mode	LEDs BLINKING			LED1 4-in-1 flash, if cleaning mode is activated	During "Cleaning Mode" is activated Permanent 4-in-1 flashes

TROUBLESHOOTING GUIDE

- 1. Red LED in spout does not blink 2 sec after battery installation.**
Battery placement incorrect or batteries have been discharged.

Ensure alkaline batteries are installed properly. Check the orientation of each battery matches the positive (+) and negative (-) symbols shown on the battery compartment.

- 2. Faucet does not function.**

Adhesive packaging label affixed over sensor eye.

Remove adhesive label from sensor eye.

- 3. Faucet delivers water in an uncontrolled manner.**

Faucet is not working properly.

Clean sensor window. If continually not working contact Sloan's Tech Support Department.

- 4. Faucet does not deliver any water when sensor is activated.**
Solenoid valve produces an audible "CLICK".

A. Water supply stop(s) closed.

Open water supply stop(s).

B. Strainer is clogged.

Remove, clean, and reinstall strainer. Replace strainer (filter), if needed (refer to page 8)

Solenoid valve DOES NOT produce an audible "CLICK".

A. Batteries low (battery powered models).

Replace batteries (refer to battery replacement on page 7).

B. Power failure (hardwire models).

Check power supply.

- 5. Faucet delivers only a slow flow or dribble when sensor is activated.**
Water supply stop(s) are partially closed.
Completely open water supply stop(s).

- 6. Faucet does not stop delivering water or continues to drip after user is no longer detected.**

Faucet is not working properly.

Clean sensor window. If continually now working contact Sloan's Technical Support Department (see below).

- 7. LED indicator blinks RED when faucet is in use.**

Batteries low (battery powered models).

Replace batteries (refer to battery replacement on page 7).

- 8. The water temperature is too hot or too cold on a faucet connected to hot and cold water supply lines.**

A. Supply stops are not adjusted properly.

Adjust supply stops.

B. For models with integral side mixing valve—Mixing valve is set improperly for the water temperature desired.

Rotate mixing valve handle clockwise to decrease water temperature or counterclockwise to increase water temperature.

C. Inadequate hot water supply.

Adjust supply stops.

When assistance is required, please contact
Sloan Technical Support at:
1-888-SLOAN-14 (1-888-756-2614)

OPERATION

As the user's hands enter the beam's effective sensor range, the beam is reflected back into the sensor receiver and activates the solenoid valve allowing water to flow from the faucet. Water will flow until the hands are removed or until the faucet reaches its automatic time out limit setting, if hands remain in sensor range.

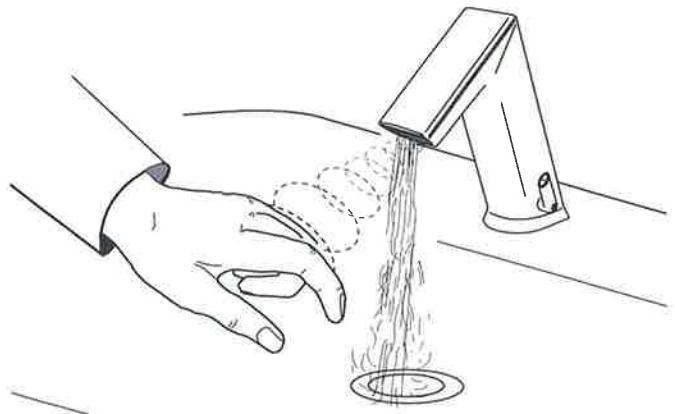

CARE AND CLEANING

DO NOT USE abrasive or chemical cleaners (including chlorine bleach) to clean Faucets that may dull the luster and attack the chrome or special decorative finishes. Use **ONLY** mild soap and water, then wipe dry with clean cloth or towel.

While cleaning the bathroom tile, protect the Faucet from any splattering of cleaner. Acids and cleaning fluids will discolor or remove chrome plating.

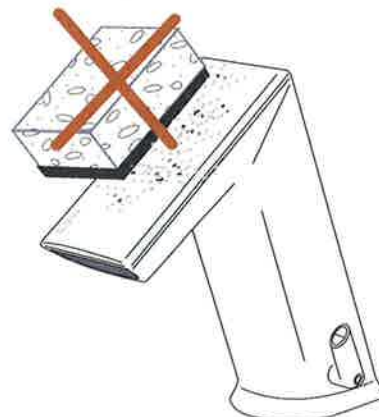

PARTS LIST

Item #	Part #	Description
1	—	Mid Mount Faucet Assembly
—	—	Mid Mount Turbine Faucet Assembly
—	—	Mid Mount Faucet Assembly with Mixer
—	—	Mid Mount Turbine Faucet Assembly with Mixer
—	—	High Mount Faucet Assembly
—	—	High Mount Turbine Faucet Assembly
—	—	High Mount Faucet Assembly with Mixer
—	—	High Mount Turbine Faucet Assembly with Mixer
2	EFX-1002-A	0.5 gpm/1.9 Lpm Multi-Lam Insert (includes insert, o-ring, 2.5 mm allen key and removal tool)
—	EFX-1001-A	1.5 gpm/5.7 Lpm Aerated Stream Insert (includes insert, o-ring, 2.5 mm allen key and removal tool)
—	EFX-1000-A	1.5 gpm/5.7 Lpm Laminar Stream Insert (includes insert, o-ring, 2.5 mm allen key and removal tool)
3A	EFX-15	0.5 gpm/1.9 Lpm Solenoid Valve Caddy Assembly – Mid Mount (Green)
—	EFX-16	1.5 gpm/5.7 Lpm Solenoid Valve Caddy Assembly – Mid Mount (Blue)
3B	EFX-17	0.5 gpm/1.9 Lpm Solenoid Valve Caddy Assembly – High Mount (Green)
—	EFX-18	1.5 gpm/5.7 Lpm Solenoid Valve Caddy Assembly – High Mount (Blue)
4	EFX-19	Strainer (Filter)
5	EFX-7	Battery Pack Assembly
6A	EFX-1-A	Crown Assembly
6B	EFX-3-A	Solar Crown Assembly
6C	EFX-4-A	Solar Crown with LCD Assembly
7	EFX-24	Mixer Handle Assembly
8	EFX-25	Handle Cap
9	EAF-1	Faucet Mounting Kit (Pedestal)
10	EAF-1008	13" (330 mm) Flexible Supply Hoses (2)
11	EFX-26-A	Base Plate for 8" Centerset Sink
12	EFX-20-A	Base Plate for 4" Centerset Sink
13	EAF-11	Plug-in Voltage Adapter (US)
—	EAF-41	Plug-in Voltage Adapter (EU)
—	EAF-39	Plug-in Voltage Adapter (UK)
—	EAF-37	Box Mount Adapter
14	EAF-24-A	11-13/16" (300 mm) Extension Cable
—	EAF-25-A	47-1/4" (1200 mm) Extension Cable
—	EAF-17-A	126" (3200 mm) Extension Cable
15	EAF-23-A	Splitter
16	MIX-60-A	Mechanical, Below Deck Mixing Valve
17	MIX-135-A	Thermostatic, Below Deck Mixing Valve
18	ETF-617-A	Bak-Chek Tee

NOTE: If changing flow rate caddy and spray insert must be changed in conjunction.

Manufactured by Sloan Valve Company under one or more of the following patents:
U.S. Patents. Other Patents Pending. BAK-CHEK®, BASYS™,
Any Application. Any Environment.™

The information contained in this document is subject to change without notice.

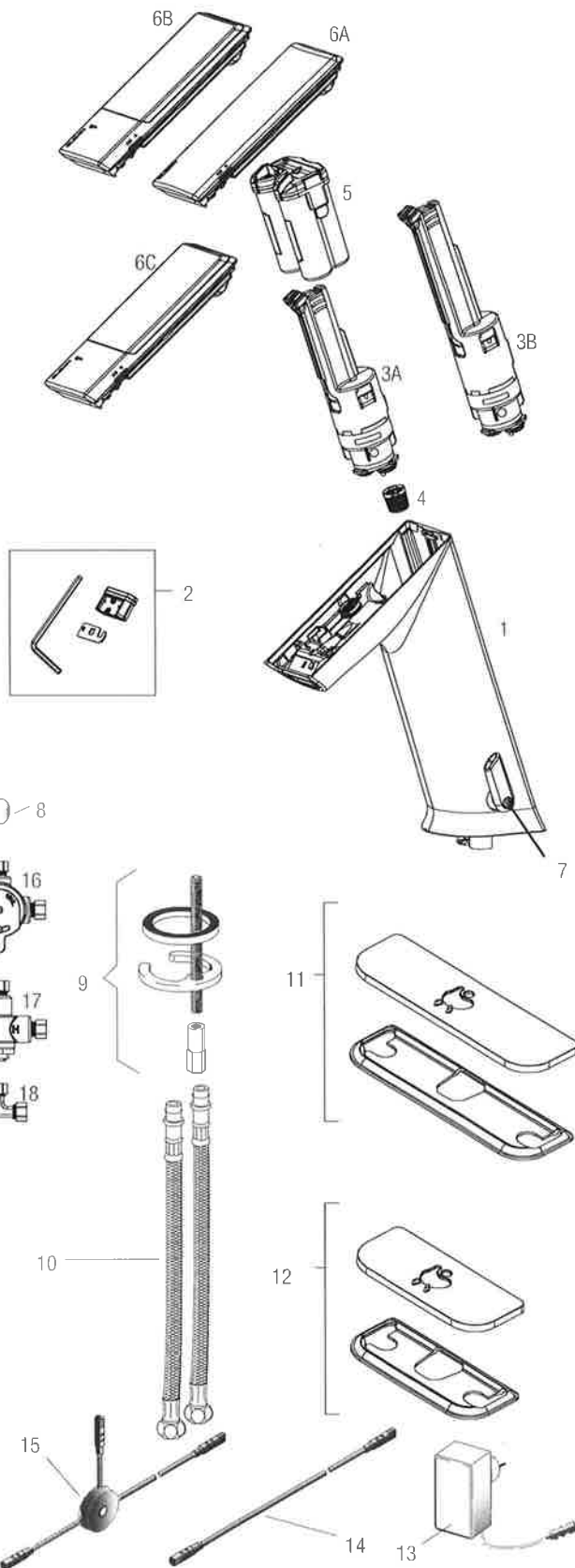

SLOAN • 10500 SEYMOUR AVENUE • FRANKLIN PARK, IL 60131
Phone: 1-800-982-5839 or 1-847-671-4300 • Fax: 1-800-447-8329 or 1-847-671-4380 • www.sloan.com

Active IR FAQs

General Questions

1. **Where is the sensor?**
The sensor is located on the front of the spout just above the water outlet. The unit is self calibrating upon start up and does not require adjustment.
2. **How can I determine if the faucet uses IR sensing or capacitance sensing?**
Cover the raised bump above and to the right of the spray insert. If the green LED below the battery symbol starts blinking within 3-4 seconds, it is IR sensing. If the light does not blink it is capacitance.
3. **Is the sensing range adjustable?**
Yes. The factory range setting is about 4" to 5" from the sensor. There are 8 different range settings for the IR sensing-based faucets from a short range to an extended range. Please refer to the installation instructions for detailed information.
Note: Factory settings are appropriate for a majority of application and should not require adjustment unless under extreme situations.
4. **What do the flashing lights on the spout mean?**
These are the diagnostic indicators for power up, low battery, and solenoid function. The meaning of the codes are described in the installation instructions.
5. **Can the spray insert (aerator) be serviced and/or changed?** Yes.
There are three different types offered. The removal tool is located under the crown and serves a dual purpose of locking the insert in place during use. Otherwise water pressure will force the insert out of the faucet. The removal tool must be used and reinstalled into faucet when change is complete.
6. **What are the three options?**
0.5 gpm (1.9 Lpm) Multi-Laminar Spray, 1.5 gpm (5.7 Lpm) Full Stream Aerated, and 1.5 gpm (5.7 Lpm) Full Stream Laminar
7. **What is the time out setting for the IR? Is it adjustable?**
Time out is 10-seconds. Yes, it is adjustable. Consult factory for run-time options.
8. **Is there a trim plate available? (Single Hole)**
Yes, base plates are available. Units can be specified with either a 4" or 8" trim plate at the time of ordering if needed. Standard installation is single hole pedestal.
9. **I ordered a single supply faucet unit. Can I convert it to a dual supply with the integral water mixing?**
No. The spout and internal components are not interchangeable. A new faucet with the correct connections would need to be ordered.
10. **Can faucet be mounted to any sink surface?**
Yes. Minimum 1 3/16" hole required to mount spout into deck.
11. **Do the units with the mixing valve supplied need back checks installed on the water supply?**
No. The back checks on the "mixing variation" have the back checks integral to the spout assembly.

12. Can I change Crowns?

Yes. You need only order the appropriate "Crown".

13. How long is the water supply from the spout?

13" long; 3/8" compression fittings

Power

14. What is the input voltage of the IR-based sensing faucets?

6.75 VDC

15. What types of power supplies are available?

This will be available in either a battery or line powered variations. The battery unit will use (4) "AA" Alkaline batteries. The plug in units will use a plug in voltage adapter (90-264 VAC 50/60 Hz Input/6.75 VDC Output). Voltage Adapter must be supplied by Sloan. Voltage adapters with region appropriate plug configurations will be available for EU and UK.

16. How long will the batteries last?

The expected battery life is dependent on many variables; the energy density (capacity) of the battery, the number of activations per day (low, med, high traffic), and the water supply pressure (higher pressure requires more power to activate the solenoid valve). Another factor is the efficiency of the electronics. Under worst case conditions of 8,000 cycles per month and high water pressure it is possible to realize a 5 year service life of the batteries.

17. Can I use lithium batteries in this unit?

Yes. It is possible to use "AA" lithium batteries in this faucet.

18. Are there any downsides to using lithium batteries?

The Sloan capacitance faucet electronics have been optimized for the discharge profile of alkaline batteries. Due to the different discharge profiles, there is a possibility that the low battery indicator light provides little or no warning when low battery power level is achieved.

19. Can I convert a battery unit to a plug in / vice-versa?

Yes. You can add an EFX-27 voltage adapter. Hardwire faucets come shipped with AA batteries installed into the battery holder as a backup (standard).

Note that the EFX-31 voltage adapter is not compatible with the Infrared Sensing faucets.

Battery Holder

20. Are the batteries easy to install?

Yes. The battery holder is marked for polarity and the holder only fits into the spout one way. Once the batteries are installed into the holder simply slide the holder into the spout assembly until the batteries are locked into place.

Active IR FAQs

Solenoid Coil

21. The solenoid and/or filter of my IR-based sensing faucet needs to be serviced. Is this easy to do? Do I need to shut the water off to the faucet?

Servicing the solenoid/filters are easy as there is no need to turn the water off to the unit. Simply remove the "Crown" to gain access to the solenoid and battery compartment. Remove the battery holder to gain access to the solenoid caddy. Twist the solenoid caddy (blue or green stem) counter clockwise 45-degrees and pull the caddy assembly straight out of the faucet body. As the solenoid caddy is rotated it will shut off the water supply internally to the spout assembly. Once removed the only serviceable part to the solenoid is the filter. The solenoid itself cannot be serviced. If not working, the solenoid would need to be replaced.

Note: care must be used when ordering new solenoid caddy to ensure proper gpm is supplied.

Note: there is an extra solenoid filter located inside the spout assembly.

Environment/Startup

22. How can I reset the unit?

Simply remove the battery pack on battery powered units. If unable to remove battery pack or for plug in units please refer to the installation instructions to re-initiate start up.

Certifications

23. To what certifications or standards does this faucet comply?

The product shall be tested and certified to industry standards: ASME A112.18.1M, CSA B125.1, California Health and Safety Code 116875 (AB1953-2006), and Vermont Bill S.152. This product meets ADA ANSI/ICC A117.1 requirements.

24. What about ASSE 1070?

Thermostatic mixer ordered separately to comply with ASSE 1070 requirements.

SLOAN HEADQUARTERS • 10500 SEYMOUR AVENUE • FRANKLIN PARK, IL 60131

Phone: 1-800-982-5839 or 1-847-671-4300 • Fax: 1-800-447-8329 or 1-847-671-4380 • www.sloanvalve.com

BASYS® Infrared Sensor Activated

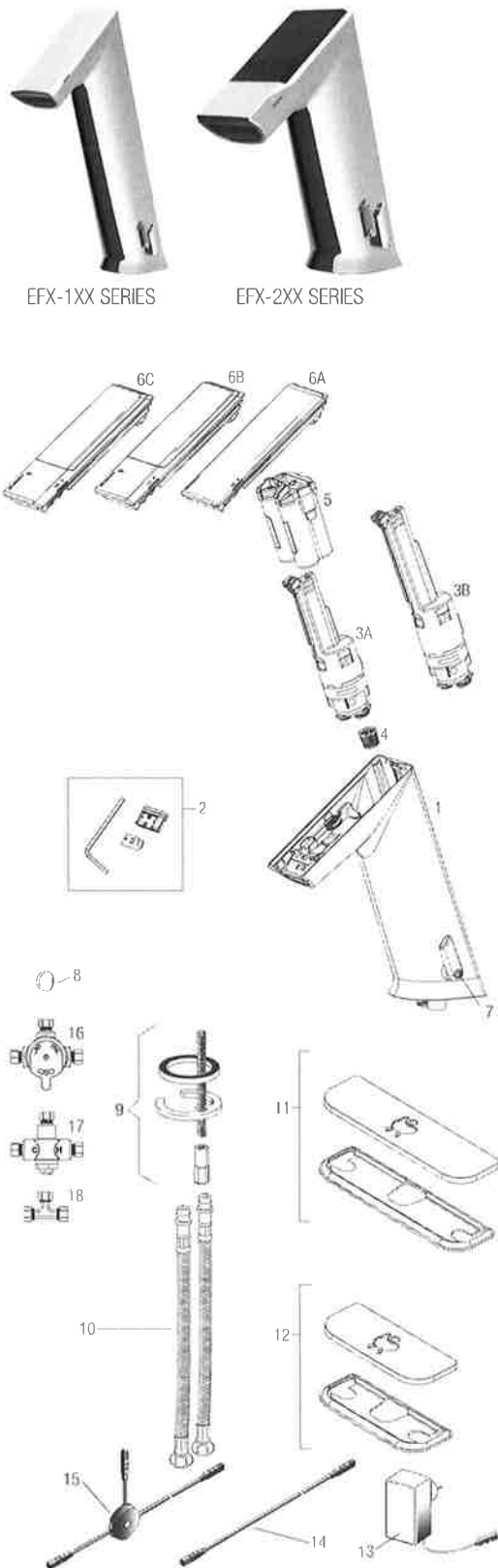

PARTS LIST—BASYS FAUCETS

Item No.	Code No.	Part No.	Description
1.	—	—	Mid Mount Faucet Assembly
—	—	—	Mid Mount Faucet Assembly with Mixer
—	—	—	High Mount Faucet Assembly
—	—	—	High Mount Faucet Assembly with Mixer
2.	3324104	EFX-1002-A	0.5 gpm/1.9 Lpm Multi-Lam Insert (includes insert, o-ring, 2.5 mm allen key and removal tool)
—	3324103	EFX-1001-A	1.5 gpm/5.7 Lpm Aerated Stream Insert (includes insert, o-ring, 2.5 mm allen key and removal tool)
—	3324102	EFX-1000-A	1.5 gpm/5.7 Lpm Laminar Stream Insert (includes insert, o-ring, 2.5 mm allen key and removal tool)
3A.	3324122	EFX-15-A	0.5 gpm/1.9 Lpm Solenoid Valve Caddy Assembly – Mid Mount (Green)
—	3324123	EFX-16-A	1.5 gpm/5.7 Lpm Solenoid Valve Caddy Assembly – Mid Mount (Blue)
3B.	3324124	EFX-17-A	0.5 gpm/1.9 Lpm Solenoid Valve Caddy Assembly – High Mount (Green)
—	3324125	EFX-18-A	1.5 gpm/5.7 Lpm Solenoid Valve Caddy Assembly – High Mount (Blue)
4.	0324019	EFX-19	Strainer (Filter)
5.	3324128	EFX-7-A	Battery Pack Assembly
6A.	3324118	EFX-1-A	Crown Assembly
6B.	3324119	EFX-3-A	Solar Crown Assembly
6C.	3324120	EFX-4-A	Solar Crown with LCD Assembly
7.	—	—	Mixer Handle Assembly
8.	3324134	EFX-25A	Handle Cap Kit (bag of 5)
9.	0335000	EAF-1	Faucet Mounting Kit (Pedestal)
10.	3335023	EAF-1008	13" (330 mm) Flexible Supply Hose (1)
11.	3324101	EFX-26-A	Trim Plate for 8" Centerset Sink
12.	3324100	EFX-20-A	Trim Plate for 4" Centerset Sink
13.	0335009	EAF-11	Plug-in Voltage Adapter (US)
—	0335041	EAF-41	Plug-in Voltage Adapter (EU)
—	0335039	EAF-39	Plug-in Voltage Adapter (UK)
—	0335037	EAF-37	Box Type Voltage Adapter
14.	0335024	EAF-24-A	11-13/16" (300 mm) Extension Cable
—	0335025	EAF-25-A	47-1/4" (1200 mm) Extension Cable
—	0335015	EAF-17-A	126" (3200 mm) Extension Cable
15.	0335023	EAF-23-A	Splitter
16.	3326009	MIX-60-A	Mechanical, Below Deck Mixing Valve
17.	0326045	MIX-135-A	Thermostatic, Below Deck Mixing Valve
18.	3365461	ETF-617-A	Bak-Chek Tee

NOTE: If changing flow rate caddy and spray insert must be changed in conjunction.

— in Item No. column = Not shown in illustration

— in Code No. and Part No. column = Not sold separately

Electrical Connection for up to Six (6) Faucets Using One (1) Adapter

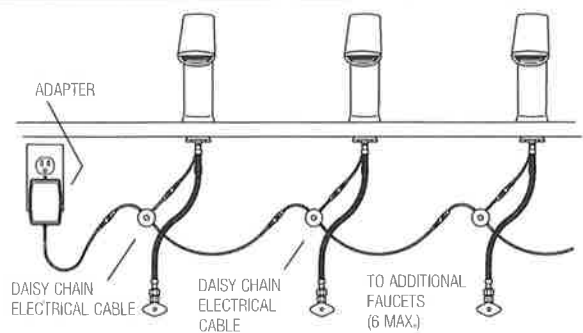

BASYS® Infrared Sensor Activated

OPERATION

As the user's hands enter the beam's effective range, the beam is reflected back into the sensor receiver and activates the solenoid valve allowing water to flow from the faucet. Water will flow until the hands are removed or until the faucet reaches its automatic time out limit setting.

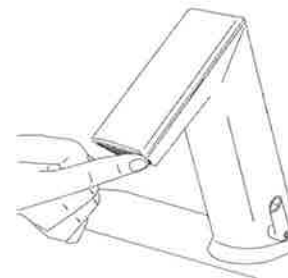

SET AND FIX TEMPERATURE AND ADJUST HOT LIMIT STOP

Adjust lever to set temperature.



Optional — To fix temperature, set lever to the desired position, then remove lever and plug hole with Cap.

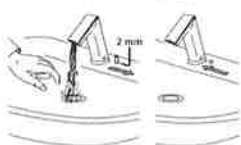

Optional Hot Limit Stop Adjustment — To adjust the hot/cold mix (factory set at 50/50) remove the lever.



Check to make sure dot is in center position before beginning adjustment.



Faucet may be adjusted in 10° increments.



Function	Steps to Activate Function	Default Setting	IR Clic
IR Activation	Cover IR clic approximately for 2 sec. until LED will flash GREEN 1x - then remove finger from IR clic (Active for 5 sec.)	—	—
Cleaning Mode	IR activation; Cover IR clic 2x - confirmation of the function is active by a couple flashes by the LED; to return to normal operation cover IR clic 1x or the faucet will automatically return to normal function after 2 min.	2 min.	—
12/24 Line Purge Feature	See below.	Off	Off 12HR 24HR
Sensor Range Adjustment	See page 123.	6	1-8
Reset Electronics	IR activation; Cover IR clic 2x; LED will flash 5x Cover IR clic 1x for 5 sec. until LED flashes 4x, then remove finger from IR clic Wait for 20 sec. (After 10 sec. water will flow for 6 sec. and automatically adjust to environment)	Manually	—
Security Off	After 90 seconds (max) of hand and/or object within sensor appears permanent, waterflow will stop and will remeasure environment	On	—

Please contact factory for more extensive programming options.

12/24 LINE PURGE FEATURE

This feature will operate the faucet every 12 or 24 hours since last use, if not used to prevent stagnant water conditions.

Default purge duration is two minutes.

Consult factory regarding other timing options.

IR activation (see above). Cover IR clic approximately 24 sec. (ignore LED indications during this period). Release when requested program is reached. (See diagram to right). Programming mode will time out after 2 minutes if no changes are made.

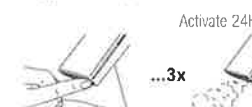

BASYS® Infrared Sensor Activated

SENSOR RANGE ADJUSTMENT

Factory setting is appropriate for the majority of applications and should not require resetting unless under extreme situations.

IR Activation (see previous page). To enter programming mode place finger on IR clic for 2 times then remove. Light on side of crown should blink to indicate programming mode.

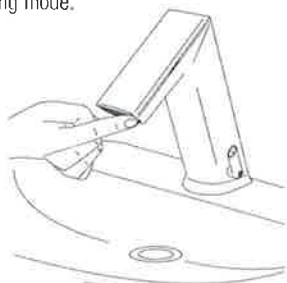

Cover IR clic until LED flashes 4x - hold on until LED flashes 1x to 8x, from minimum to maximum. See diagram below. Release when requested range is reached.

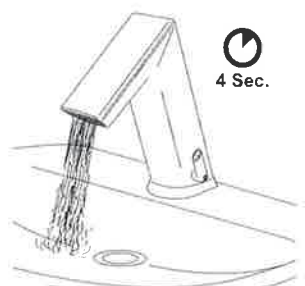
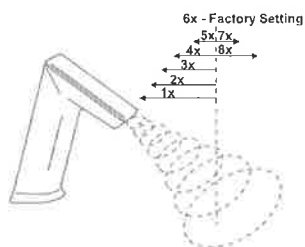

Wait, until LED flashes GREEN.

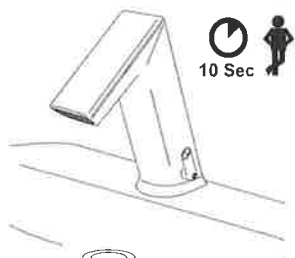

BATTERY REPLACEMENT

NOTE: Replace Battery when LED1 indicator flashes red each time faucet is in use or when faucet stops functioning. LED1 is identified by the battery symbol.

NOTE: Turning off water is not necessary.

Remove crown by loosening hex screw located on underside of spout and slide crown down and lift off.

NOTE: Screw is captive within faucet body and will not fall out.

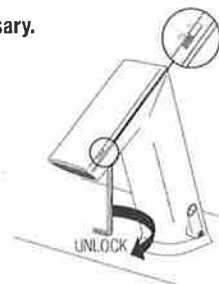

Remove battery pack assembly by lifting out of spout



Open battery pack assembly by pushing in tabs on side of assembly.

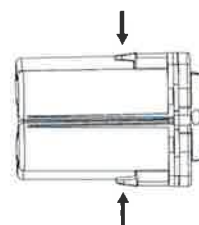

Remove all four (4) AA-cell batteries from battery pack.

Insert four (4) NEW AA-cell batteries into battery pack assembly cartridge.

NOTE: Insure batteries are installed with proper polarity. The cover of the case indicates polarity of batteries. Improper polarity will not harm the faucet. Improper polarity will cause the faucet not to operate.



Replace cover of the battery pack assembly and reinsert assembly into faucet.



Slide on crown and secure.



BASYS® Infrared Sensor Activated

REPLACE SPRAY INSERT

NOTE: Turning off water is not necessary, due to integrated automatic stop valve.

Remove crown by loosening hex screw located on underside of spout and slide crown down and lift off.

NOTE: Screw is captive within faucet body and will NOT fall out.

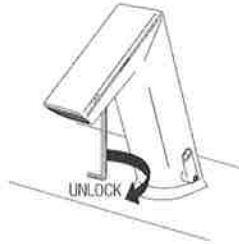

Retrieve spray removal tool located near the spray insert.

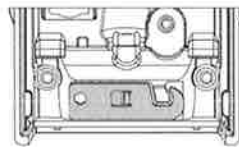

Insert spray removal tool into spray slot by sliding hook end of key between faucet spout and insert. Pull insert out of faucet once hooked.

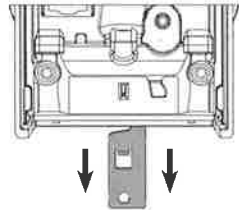

Install new insert.

NOTE: If changing to a different flow rate solenoid caddy must be changed in conjunction.

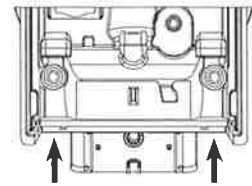

Return spray removal tool to storage location.

NOTE: This can only be done once spray head is installed. This will lock the spray head in place.

NOTE: If spray head is inserted incorrectly – key will not lock in properly. Turn faucet on to push insert out and re-install.

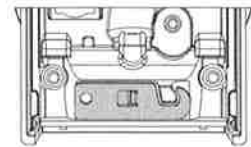

Slide on crown and secure.



BASYS® Infrared Sensor Activated

TROUBLESHOOTING GUIDE

1. Red LED in spout does not blink 2 sec after battery installation.

- A. Battery placement incorrect or batteries have been discharged.
- B. Ensure batteries are installed properly. Check the orientation of each battery matches the positive (+) and negative (–) symbols shown on the battery compartment.

2. Faucet DOES NOT function.

- A. Adhesive packaging label affixed over sensor eye.
- B. Remove adhesive label from sensor eye.

3. Faucet delivers water in an uncontrolled manner.

- A. Faucet is not working properly.
- B. Clean sensor window. If continually now working contact Sloan's Tech Support Department.

4. Faucet DOES NOT deliver any water when sensor is activated.

INDICATOR: Solenoid valve produces an audible "CLICK".

- A. Water supply stop(s) closed.
Open water supply stop(s).
- B. Strainer is clogged.
Remove, clean, and reinstall strainer. Replace strainer, if needed (refer to page 124).

INDICATOR: Solenoid valve DOES NOT produce an audible "CLICK".

- A. Batteries low (battery-powered models).
Replace batteries (refer to battery replacement on page 123).
- B. Power failure (hardwire models).
Check power supply.

5. Faucet delivers only a slow flow or dribble when sensor is activated.

- A. Water supply stop(s) are partially closed.
Completely open water supply stop(s).

6. Faucet DOES NOT stop delivering water or continues to drip after user is no longer detected.

- A. Faucet is not working properly.
- B. Clean sensor window. If continually now working contact Sloan's Technical Support (see below).

7. LED indicator blinks RED when faucet is in use.

- A. Batteries low (battery-powered models).
- B. Replace batteries (refer to battery replacement on page 123).

8. The water temperature is too hot or too cold on a faucet connected to hot and cold water supply lines.

- A. Supply stops are not adjusted properly.
Adjust supply stops.
- B. For models with integral side mixing valve—mixing valve is set improperly for the water temperature desired.
Rotate mixing valve handle clockwise to decrease water temperature or counterclockwise to increase water temperature.
- C. Inadequate hot water supply.
Adjust supply stops.

CARE AND CLEANING

DO NOT USE abrasive or chemical cleaners (including chlorine bleach) to clean Faucets that may dull the luster and attack the chrome or special decorative finishes. Use **ONLY** mild soap and water, then wipe dry with clean cloth or towel.

While cleaning the bathroom tile, protect the Faucet from any splattering of cleaner. Acids and cleaning fluids will discolor or remove chrome plating.

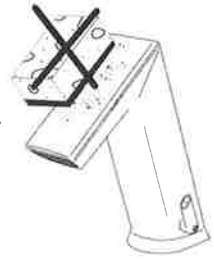

When assistance is required, please contact Sloan Technical Support at: 1-888-SLOAN-14 (1-888-756-2614).

BASYS® Infrared Sensor Activated

UPGRADE FAUCET FUNCTIONALITY

Remove crown by loosening hex screw located on underside of spout and slide crown down and lift off.

NOTE: Screw is captive within faucet body and will NOT fall out.

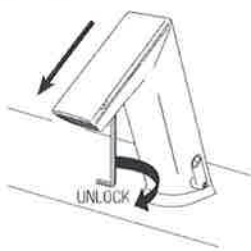

Place new crown on faucet by sliding onto spout and tightening hex screw on underside of spout.

NOTE: All electronics are fully encapsulated in the crown and thus protected from the environment and easy to replace or upgrade.



LED DISPLAY DIAGNOSTIC CODES

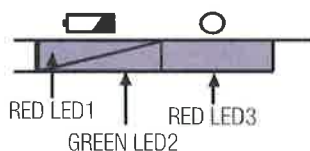

Function	LED1	LED2	LED3	Description 1	Description 2
Start Up Boot	RED	GREEN		LED1 and LED2 alternate blinking	Fast Toggle
Battery Check after Start Up	RED			LED1 on for 2 sec, if battery greater than 3.5V	
Line Power Check after Start Up			RED	LED3 on for 2 sec, if line power greater than 3.5V	
IR Adjust Process	RED			LED1 blinking while IR adjusts	Few seconds
IR Adjust IR		GREEN		LED2 on for 2 sec, if adjustment OK	
Battery Low	RED			LED1 blinks 3x, if battery is less than warning level	Only while in detection mode
Battery Empty	RED			LED1 double flashes 3x, if battery is less than empty level	Only while in detection mode
Valve Error			RED	LED3 double flashes 3x, if valve current error; flash after the 3rd error, off after the 3rd good operation	Flashes after the 3rd error, off after the 3rd good operation
IR Activation		GREEN		LED2 on for 2 sec, if IR-click has been activated	After 5 sec. automatically back to operating mode
Cleaning Mode	RED			LED1 4-in-1 flash, if cleaning mode is activated	During "Cleaning Mode" is activated Permanent 4-in-1 flashes



What's covered.

Choose Sloan craftsmanship with confidence. Learn about our coverage policies.

- ① Need more information? Tell us what you're looking for so we can help. Submit your request (https://www.sloan.com/company/support/contact/simple_contact_form)

PRIOR TO FEBRUARY 17TH, 2022

AFTER FEBRUARY 17TH, 2022

Sloan Limited Warranty on Products Purchased Prior to February 17, 2022

Choose Sloan Valve Company craftsmanship with confidence. Learn about our coverage policies.

What's Covered?

Unless otherwise noted, Sloan Valve Company warrants its products, manufactured and sold for commercial or industrial uses, to be free from defects of material and workmanship for a period of three (3) years (one year for SF, special finish, Programmed Water Technologies "PWT" electronics, and 30 days on PWT software) from the date of first purchase. During this period, Sloan Valve Company will, at its option, repair, replace, or refund the purchase price of any product which fails to conform with this warranty under normal use and service. This shall be the sole and exclusive remedy under this warranty. Products must be returned to Sloan Valve Company, at customer's cost. No claims will be allowed for labor, transportation or other costs. This warranty extends only to persons or organizations that purchase Sloan Valve Company's products directly from Sloan Valve Company for purpose of resale. This warranty does not cover the life of batteries.

What Does This Warranty Not Cover?

Any damage, defect or malfunction caused by abuse, misuse, neglect, vandalism, accident, act of God (e.g., flood, fire, lightning), or other cause beyond the reasonable control of Sloan Valve Company is/are not covered by this warranty. Also, any damage, defect or malfunction resulting from faulty or improper installation of our product, insufficient plumbing water supply below minimum product operating conditions, alteration or modification of the product, use of accessories or attachments not manufactured by Sloan Valve Company,

PRIOR TO FEBRUARY 17TH, 2022

AFTER FEBRUARY 17TH, 2022

Sloan Limited Warranty on Products Purchased on or After February 17, 2022

Sloan® Limited Warranty

Subject to the terms, conditions, limitations and exclusions herein, Sloan Valve Company (“Sloan”) warrants to the first end-user owner (“you” and “your”) of its products (each, a “Sloan Product”) that such Sloan Product (exclusive of Flushmate® products) will be free from defects in materials and workmanship for the applicable period set out in the table below (the “Warranty Period”), commencing on the actual date of purchase by you of such Sloan Product (the “Purchase Date”):

Warranted Product	Applicable Warranty Period		
	Electrical Components	Mechanical Components	Special Finish and Markings
Manual Commercial - Flushometers, shower heads	N/A	3 years	1 year
Electronic Commercial - Flushometers, faucets (Excluding SF Faucet Series), accessories	3 years	3 years	1 year
SF Faucet Series	1 year	1 year	1 year
Vitreous China - water closets, urinals, lavatories	N/A	3 years	N/A
Sloan Xlerator®, Xlerator® ECO-EHD 500 Series	5 years	5 years	1 year
Aer-Dec® Hand Dryers	5 years	5 years	1 year
Optima Air® Hand Dryer-EHD 700 Series	5 years	5 years	1 year
Soap Dispensers – Optima® and Sloan Series	3 years	3 years	1 year
PWT™ – Controllers	3 years	N/A	N/A
PWT™ – MCR – 321A Series Manifold	N/A	1 year	N/A
PWT™ - Management Console	30 days	N/A	N/A
Sinks – Sloan Stone®, Stainless Steel	3 years	3 years	10 years limited solid surface for molded sinks
Sinks – Aer Dec®, Designer Series	N/A	3 years	10 years limited solid surface, quartz and other engineered and natural stone; 1 year limited warranty for laminates
Custom (“make to order”) fixtures, accessories and cabinetry	N/A	1 year	N/A

The Warranty Period will automatically terminate upon its expiration irrespective of whether or when the Sloan Product has been installed and/or put to use. You should keep your dated sales receipt for proof of purchase and claims purposes. If you are unable to produce proof of



a Bead Industries, Inc. company

Warranty, Terms and Return Policies

TERMS: All sales are subject to credit approval. Terms are 2% ten days – net 30.

RETURNED GOODS: Requests for returning purchased items are subject to factory approval.

A Returned Goods Authorization (RGA) must be obtained from the factory prior to any return. Returned merchandise must be in their original cartons, listed in our current List Price Sheet and in clean saleable condition.

Restocking charge:

- Material that was shipped within 18 months of the return request is subject to a 25% restocking charge.
- Material that was shipped more than 18 months of the return request but less than 3 years is subject to a 50% restocking charge.
- Material returned more than 18 months after it was shipped is not subject to any stock rotation agreement.
- Material that was shipped more than 3 years before the return request is not returnable.
- Invoice dates as well as dates on packaging will control.

The restocking charge may be reduced if a new order of equal value is placed at the time the RGA is requested:

- 25% may be reduced to 15%
- 50% may be reduced to 35%

MINIMUM RETURN POLICY:

Return requests less than \$200 net will be charged \$50 processing fee in lieu of any restocking charge.

INVOICE:

We reserve the right to invoice all merchandise at prices in effect at time of shipment.

NO MINIMUM ORDER:

Orders less than \$200 list will be invoiced at list price less 35% (.65 multiplier).

McGuire Manufacturing Co., Inc.

60 grandview court • cheshire • ct • 06410

tel 203-699-1801 • fax 203-699-1813

mcguiremfg.com

customerservice@mcguiremfg.com

FREIGHT:

We will pay freight on shipments within the continental United States when the order (pre-tax) totals more than \$2200 net. We select the method of shipment and carrier when we pay the freight.

Limited Warranty Information

McGuire Manufacturing Co., Inc. (McGuire) warrants its product to be free from defects in material and workmanship for the period indicated below by product type measure from the date of purchase:

ITEM	WARRANTY PERIOD
Brass products	15 years
ProWrap	5 years
Eco P-Traps, Eco Strainers and Valve Strainers	1 year
Stainless Steel products	1 year
Lite Commercial P-Traps	1 year

McGuire's sole responsibility will be to replace, at no additional charge, any product which proves to be defective within the applicable warranty period. Shipping costs for product located outside the continental United States will be the sole responsibility of the customer. Duties and taxes, if levied, shall be the sole responsibility of the customer.

The above Limited Warranty shall not apply if the product has been damaged due to abuse, misuse, improper installation, accident, or other cause not within McGuire's control.

THE ABOVE LIMITED WARRANTY IS THE SOLE AND EXCLUSIVE WARRANTY. ALL OTHER WARRANTIES ARE DISCLAIMED, WHETHER EXPRESSED OR IMPLIED, INCLUDING BUT NOT LIMITED TO, ANY IMPLIED WARRANTIES OF MERCHANTABILITY OR FITNESS FOR A PARTICULAR PURPOSE. IN NO EVENT SHALL MCGUIRE BE RESPONSIBLE OR LIABLE FOR ANY SPECIAL INCIDENTAL, OR CONSEQUENTIAL DAMAGES OR LOSSES ARISING FROM THE USE OF THIS PRODUCT.

McGuire may, at its option, alter the contents of this LIMITED WARRANTY at anytime. These changes will affect products manufactured after the effective date of this policy.

McGuire Manufacturing Co., Inc.

60 grandview court • cheshire • ct • 06410

tel 203-699-1801 • fax 203-699-1813

mcguiremfg.com

customerservice@mcguiremfg.com

WC-1

American Standard

Style That Works Better



**PRIOLO 16-1/2" HEIGHT 1.6 GPF
with EVERCLEAN®**

- Floor mount rear outlet flushometer valve toilet
- Vitreous china
- Low-consumption (6.0 Lpf/1.6 gpf)
- EverClean® surface inhibits the growth of stain- and odor-causing bacteria, mold, and mildew on the surface
- 16-1/2" rim height for accessible application
- Condensation channel
- Elongated bowl
- Powerful direct-fed siphon jet action
- Fully glazed 2-1/8" trapway
- 1-1/2" inlet spud
- 2 bolt caps
- 100% factory flush tested

☐ 3695.016 Elongated bowl only, top spud

☐ 3695.001 Same as above, Universal Bowl

☐ 3697.016 Elongated bowl only, back spud

☐ 3697.001 Same as above, Universal Bowl

☐ 3696.016 Elongated bowl only, top spud with
slotted rim for bedpan holding (White only)

☐ 3696.001 Same as above, Universal Bowl

☐ 3698.016 Elongated bowl only, back spud with
slotted rim for bedpan holding (White only)

Component Parts:

☐ 047007-0070A Inlet spud (furnished with bowl)

☐ 481310-XXX0A Bolt caps with retainers
(furnished with bowl)

Nominal Dimensions:

752 x 356 x 419mm

(29-5/8" x 14" x 16-1/2")

Recommended working pressure—between
25 psi at valve when flushing and 80 psi static

Fixture only, less seat and flush valve

Compliance Certifications -

Meets or Exceeds the Following Specifications:

- ASME A112.19.2-2008/CSA B45.1-08 for Vitreous China Fixtures

**PRIOLO 16-1/2" HEIGHT
1.6 GPF FLUSHOMETER TOILET**
VITREOUS CHINA with EVERCLEAN®



SEE REVERSE FOR ROUGHING-IN DIMENSIONS

To Be Specified:

☐ Color: ☐ White ☐ Bone ☐ Linen

☐ Seat:

☐ American Standard #5901.110 Heavy duty open
front less cover with Everclean® surface

☐ American Standard #5905.110 Extra heavy duty
open front less cover with Everclean® surface

☐ Alternative Seat:

☐ Flushometer Valve:

☐ American Standard Selectronic™ #6065.161.002
DC Power (Top Spud)

☐ American Standard Selectronic™ #6065.261.007
DC Power (Back Spud)

☐ American Standard Selectronic™ #6067.261.007
AC Power (Back Spud)

☐ American Standard Selectronic™ #6068.261.007
Multi AC Power (Back Spud)

☐ Alternative Flushometer Valve



MEETS THE AMERICANS WITH DISABILITIES ACT GUIDELINES
AND ANSI A117.1 REQUIREMENTS FOR ACCESSIBLE AND USABLE
BUILDING FACILITIES - CHECK LOCAL CODES.

EVERCLEAN®

American Standard

Style That Works Better

 **BARRIER FREE**

**PRIOLO 16-1/2" HEIGHT
1.6 GPF FLUSHOMETER TOILET**
VITREOUS CHINA with EVERCLEAN®

3695.016/3696.016

3695.001/3696.001

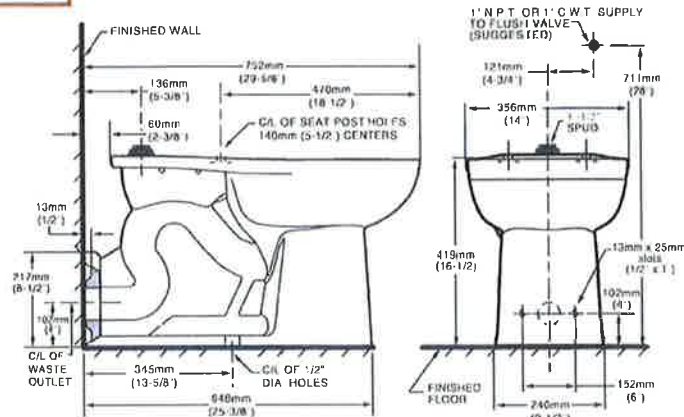

DIMENSIONS (Nominal) NOTE: Distance from floor to closet flange centerline (rough-in) must be 4" (102 mm) with flange surface flush to 1/16" (1.6mm) max. beyond finished wall.

3697.016/3698.016

3697.001

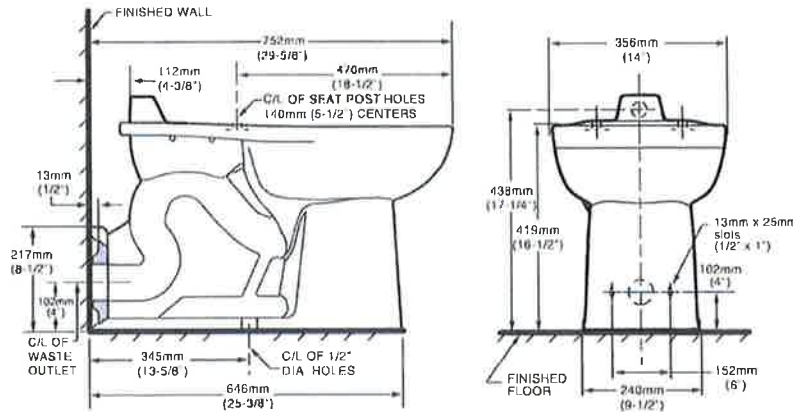

DIMENSIONS (Nominal) NOTE: Distance from floor to closet flange centerline (rough-in) must be 4" (102 mm) with flange surface flush to 1/16" (1.6mm) max. beyond finished wall.

NOTES:

PRODUCTS 3695 AND 3696 SHOWN, 3697 AND 3698.160 SAME AS EXCEPT WITH SLOTTED RIM FOR BED PAN HOLDING. TO COMPLY WITH AREA CODE GOVERNING THE HEIGHT OF VACUUM BREAKER ON THE FLUSHOMETER VALVE, THE PLUMBER MUST VERIFY DIMENSIONS SHOWN FOR SUPPLY ROUGHING. FLUSHOMETER VALVE NOT INCLUDED WITH FIXTURE AND MUST BE ORDERED SEPARATELY. FLUSHOMETER VALVE REQUIREMENTS FOR 12" (305MM) ROUGH-IN: SWEAT EXTENSION NIPPLE IS REQUIRED. REFER TO VALVE MANUFACTURER AND LOCAL CODES.

IMPORTANT: Dimensions of fixtures are nominal and may vary within the range of tolerances established by ANSI Standard A112.19.2. These measurements are subject to change or cancellation. No responsibility is assumed for use of superseded or voided pages.

INSTALLATION INSTRUCTIONS



HET High Efficiency
(1.28gpf/4.8Lpf)

*American
Standard*

PRIOLO FLOOR MOUNT BACK OUTLET ADA FLUSHOMETER ONE PIECE TOILET

Model 3695, 3696, 3697

Thank you for selecting American Standard – the benchmark of fine quality for over 100 years. To ensure this product is installed properly, please read these instructions carefully before you begin. (Certain installations may require professional help.) Also be sure your installation conforms to local codes.

⚠ CAUTION: PRODUCT IS FRAGILE. TWO PEOPLE ARE RECOMMENDED FOR HANDLING TO AVOID BREAKAGE AND POSSIBLE INJURY!

NOTE: Pictures may not exactly define contour of china and components.

NOTE: For proper operation these products require a minimum of 30 psi line pressure.

RECOMMENDED TOOLS AND MATERIALS

Putty Knife
Hacksaw

Regular Screwdriver
Carpenters Level

Adjustable Wrench
Flexible Supply Tube

Sealant
Closet Bolts

Tape Measure

1 REMOVE OLD TOILET

- Close flush valve completely.
 - NOTE: If replacing valve, first shut off main water supply!**
 - Remove old mounting hardware, remove toilet and plug wall waste opening to prevent escaping sewer gases.
 - Remove closet bolts from flange and clean away old wax, putty, etc. base area.
- NOTE: Mounting surface must be clean and perpendicular to the floor before new toilet is installed!**

2 PRIOLO 3695/3696 16-1/2" TOP SPUD

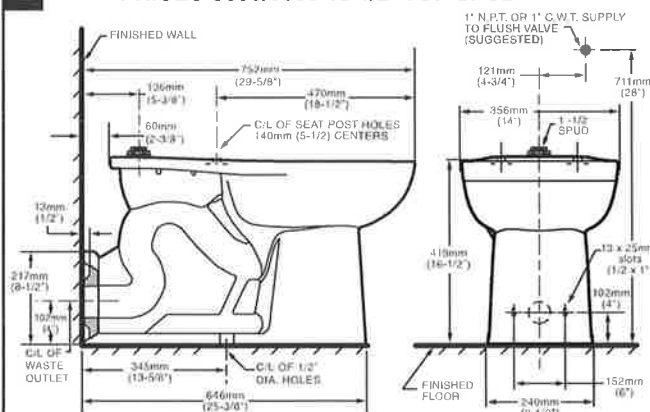

PRIOLO 3697 16-1/2" BACK SPUD

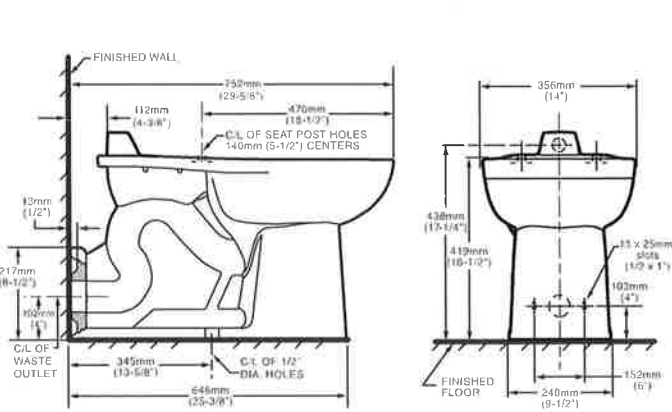

DIMENSIONS (Nominal) NOTE: Distance from floor to closet flange centerline (rough-in) must be 4" (102 mm) with flange surface flush to 1/16" (1.6mm) max. beyond finished wall.

3 INSTALL CLOSET BOLTS

Install closet bolts in flange channel, turn 90°, and slide into place 6" (152 mm) apart and parallel to floor. (Use putty to hold bolts in place if necessary.) Brace under flooring as needed and drill two mounting pilot holes as shown.

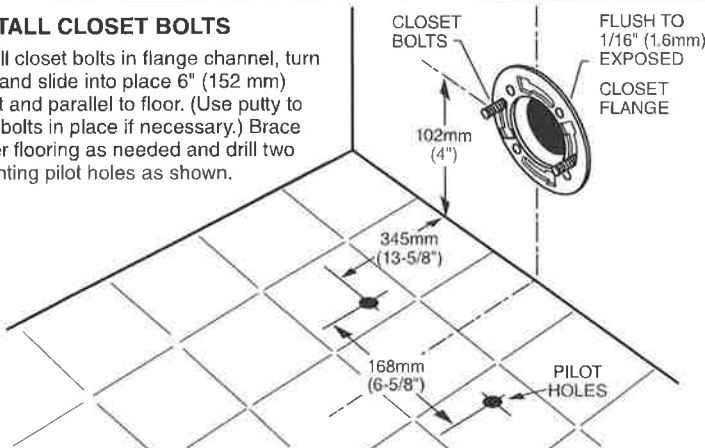

4

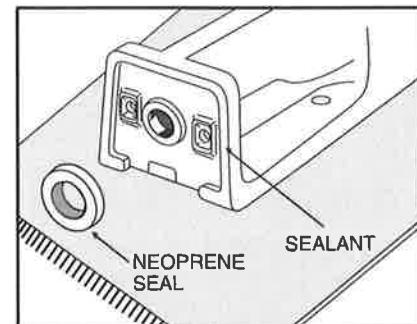

INSTALL NEOPRENE OR GRAPHITE FELT SEAL*

Install seal evenly around waste flange (horn).

Apply a thin bead of sealant around base flange.

***NOTE: Wax seal not recommended for this application.**



Product names listed herein are trademarks of AS America, Inc.
© AS America, Inc. 2015

7301198-100 Rev.B

SAVE FOR FUTURE USE

5

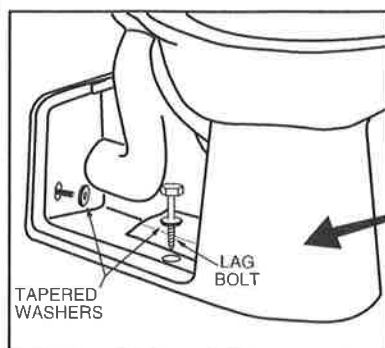

INSTALL TOILET ON FLANGE

- Unplug wall waste opening and slide toilet towards closet flange so bolts project through mounting holes.
- Loosely install retainer tapered washers and nuts. Side of washers marked "THIS SIDE UP" must face you!

6

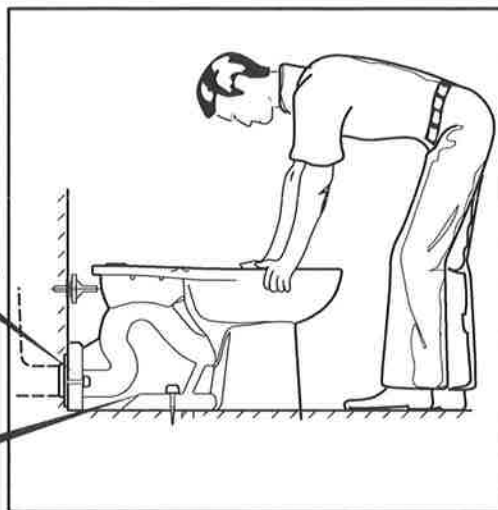
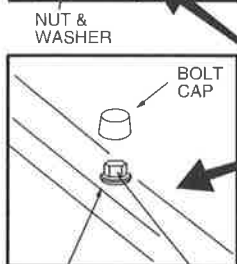
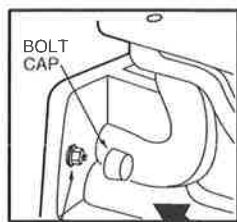

INSTALL TOILET

- Position toilet squarely to wall and, with a rocking motion, push bowl against ring and flange. Alternately tighten nuts until toilet is firmly anchored.

⚠ CAUTION: DO NOT OVERTIGHTEN NUTS OR BASE MAY BE DAMAGED!

- Insert the tapered washers (supplied in the kit) into the lag bolts (not supplied). Insert bolts through mounting holes and tighten into pre-drilled floor openings.
- Install the bolt caps on tapered washers. (If necessary, cut wall bolt length to size before installing caps.)
- Smooth off the bead of sealant around base. Remove excess sealant.

7

INSTALL TOILET SEAT

Install toilet seat in accordance with manufacturer's directions.

8

CARE AND CLEANING

When cleaning your toilet, wash it with mild, soapy water, rinse thoroughly with clear water and dry with a soft cloth. Avoid detergents, disinfectants, or cleaning products in aerosol cans. NEVER use abrasive scouring powders or abrasive pads on your toilet seat. Some bathroom chemicals and cosmetics may damage the seat's finish.

AS AMERICA, INC. ONE-YEAR LIMITED WARRANTY

If inspection of this AS America, Inc. ("American Standard") plumbing product, within one year after its initial purchase, confirms that it is defective in materials or workmanship, American Standard will repair or, at its option, exchange the product for a similar model.

This warranty **does not apply** to local building code compliance. Since local building codes vary considerably, the purchaser of this product should check with a local building or plumbing contractor to insure local code compliance before installation.

This warranty **shall be void** if the product has been moved from its initial place of installation; if it has been subjected to faulty maintenance, abuse, misuse, accident or other damage; if it was not installed in accordance with American Standard's instructions; or if it has been modified in a manner inconsistent with the product as shipped by American Standard.

American Standard's option to repair or exchange the product under this warranty does not cover any labor or other costs of removal or installation, **nor shall American Standard be responsible for any other incidental or consequential damages attributable to a product defect or to the repair or exchange of a defective product, all of which are expressly excluded from this warranty.** (Some states or provinces do not allow the exclusion or limitation of implied warranties, so this exclusion may not apply to you.)

This warranty gives you specific legal rights. You may have other statutory rights that vary from state to state or from province to province, in which case this warranty does not affect such statutory rights.

For service under this warranty, it is suggested that a claim be made through the contractor or dealer from or through whom the product was purchased, or that a service request (including a description of the product model and of the defect) be sent to the following address:

In the United States:
American Standard Inc.
P.O. Box 6820
Piscataway, New Jersey 08855
Attention: Director of Consumer Affairs
For residents of the United States, warranty information may also be obtained by calling the following toll free number: (800) 442-1902
www.americanstandard-us.com

In Canada:
American Standard
5900 Avebury Road
Mississauga, Ontario
Canada L5R 3M3
Toll Free: (800) 387-0369
www.americanstandard.ca

In Mexico:
Customer Service Manager
Ideal Standard, S.A. de C.V.
Via Morelos #330
Col. Santa Clara
Ecatepec 55540 Edo. Mexico
www.americanstandard.com.mx



AquaVantage®

Z6000AV Series

AquaVantage Exposed Flushometer

Installation, Operation, Maintenance and Parts Manual

Patented and Patents Pending



Z6000AV



Z6003AV



AquaVantage Exposed Closet/Urinal Systems

Z6000AV	Z6010AV
Z6000AV-HET	Z6014AV
Z6001AV	Z6017AV
Z6003AV	Z6096AV
Z6003AV-ULF	Z6099AV

NOTICE: READ ENTIRE MANUAL PRIOR TO INSTALLING PRODUCT.

⚠ WARNING: Cancer and Reproductive Harm - www.P65Warnings.ca.gov

⚠ ADVERTENCIA: Cáncer y daño reproductivo - www.P65Warnings.ca.gov

⚠ AVERTISSEMENT: Cancer et effets néfastes sur la reproduction - www.P65Warnings.ca.gov

LIMITED WARRANTY

All goods sold hereunder are warranted to be free from defects in material and factory workmanship for a period of three years from the date of purchase. Decorative finishes warranted for one year. We will replace at no costs goods that prove defective provided we are notified in writing of such defect and the goods are returned to us prepaid at Sanford, NC, with evidence that they have been properly maintained and used in accordance with instructions. We shall not be responsible for any labor charges or any loss, injury or damages whatsoever, including incidental or consequential damages. The sole and exclusive remedy shall be limited to the replacement of the defective goods. Before installation and use, the purchaser shall determine the suitability of the product for his intended use and the purchaser assume all risk and liability whatever in connection therewith. Where permitted by law, the implied warranty of merchantability is expressly excluded. If the products sold hereunder are "consumer products," the implied warranty of merchantability is limited to a period of three years and shall be limited solely to the replacement of the defective goods. All weights stated in our catalogs and listed are approximate and are not guaranteed.

NOTE: The information in this manual is subject to change at any time without notice. Installations may be performed at different times of construction by different individuals. For this reason, these instructions should be left on-site with the facility or maintenance manager.

AquaVantage® Rough-In, Product Specification, Models and Options

ENGINEERING SPECIFICATION: ZURN AquaVantage® 'AV'
Exposed Closet Flush Valve – Exposed, quiet diaphragm type, chrome-plated flushometer valve with a polished exterior. Complete with Zurn's AquaVantage TPE, chlorine resistant, dual seal diaphragm with a clog resistant, triple filtered by-pass. The valve is ADA compliant with a non-hold-open and no-leak handle feature, high back pressure vacuum breaker, one-piece hex coupling nut, adjustable tailpiece, spud coupling, and flange for spud connection. Control stop has internal siphon-guard protection, vandal-resistant stop cap, sweat solder kit, and a cast wall flange with setscrew. Internal seals are made of chlorine resistant materials.

MODELS

Z6000AV – 1-1/2" Water Closet Valve with top spud connection.
 Z6010AV – 1-1/2" Water Closet Valve with back spud connection.
 Z6001AV – 1-1/4" Urinal Valve with top spud connection.
 Z6003AV – 3/4" Urinal Valve with top spud connection.

FLOWS

-FF Full Flow
 3.0 Gal. for Urinal, 4.5 Gal. for Water Closet
 -HET High Efficiency Toilet
 1.28 Gal. for Water Closet
 -WS1 Low Consumption
 1.0 Gal. for Urinal, 1.6 Gal. for Water Closet
 -ULF Ultra Low Flow
 0.125 Gal. for Urinal

OPTIONS

—-BG BioCare Handle
 —-H Handle on Front of Flush Valve
 —-L 1" [25] Metal Push Button
 —-L3 3" [76] Metal Push Button
 —-YJ Split Ring Pipe Support
 —-YK Solid Ring Pipe Support
 —-YO Bumper on Stop Angle
 —-1 16" Rough-In
 —-2 24" Rough-In
 —- Other

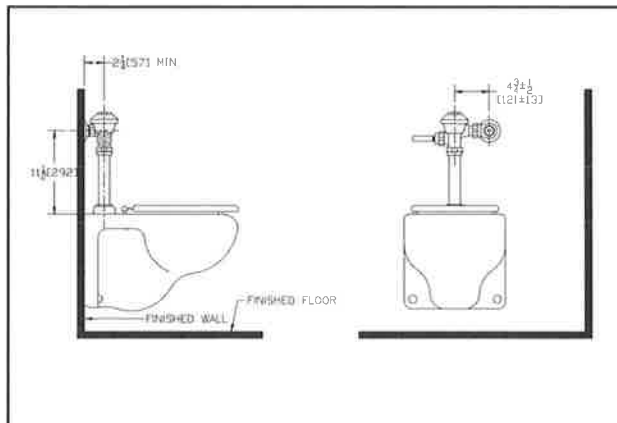

Models: Z6000AV, Z6000AV-1, Z6000AV-2, Z6000AV-3,
 -HET (High Efficiency) 1.28 Gal.
 -WS1 (Water Saver) 1.6 Gal. Low Consumption

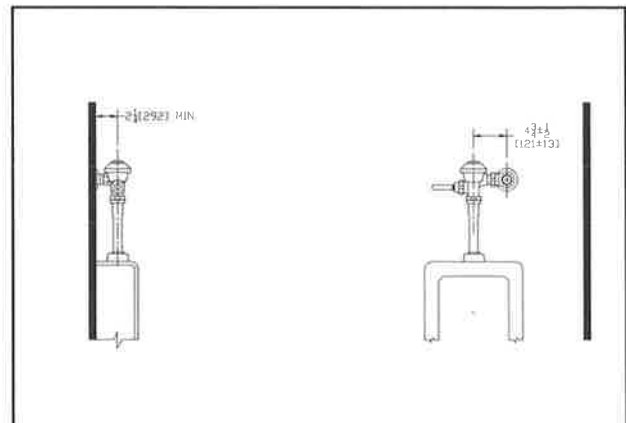

Models: Z6001AV (1-1/4" urinal flush valve)
 Z6003AV (3/4" urinal flush valve)
 -WS1 (Water Saver) 1.0 Gal. Low Consumption
 -ULF (Ultra Low Flow) 0.125 Gal.

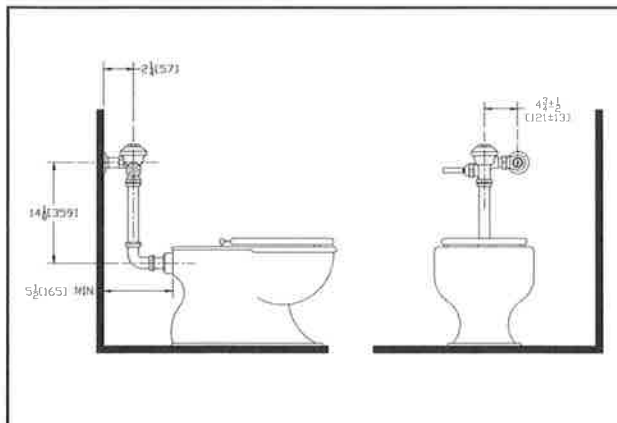

Models: Z6010AV, Z6010AV-1, Z6010AV-2,
 -HET (High Efficiency) 1.28 Gal.
 -WS1 (Water Saver) 1.6 Gal. Low Consumption

Sweat Solder Adaptor Installation Instructions

Important:

- All plumbing is to be installed according to state and local codes and regulations.
- Water supply lines need to allow proper water flow for each fixture.
- Flush all lines of any **debris** before making connections.
- Do not use pipe sealant or plumbing grease on any fitting other than the control stop inlet.

The Aquaflush valve is designed to operate under various water pressures with a recommended range between 10 and 100 psi (69 to 689 kPa). Each Zurn valve is tested for proper performance at the factory before being shipped. Consult the product pages of the catalog for available flow options.

Most low consumption fixtures (1.28 and 1.6 gallon) require a minimum of 25 psi running pressure through the valve to obtain proper evacuation. Please be sure to consult fixture manufacturer on minimum running water supply requirements for proper evacuation.

When installing your quality Zurn valve it is recommended that to protect the polished finish you do not use a toothed wrench. This will cause gouges and scratches on your valve.

STEP NO. 1

Measure distance from finished wall to center line of fixture spud; cut water supply pipe $1\frac{1}{4}$ " shorter than this measurement. Chamfer O.D. and I.D.

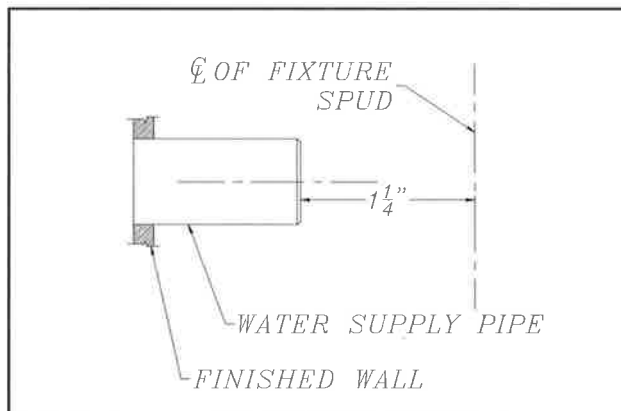

STEP NO. 2

Slide threaded adaptor onto supply pipe until shoulder stops on end of pipe. Then sweat-solder the adaptor to water supply pipe.

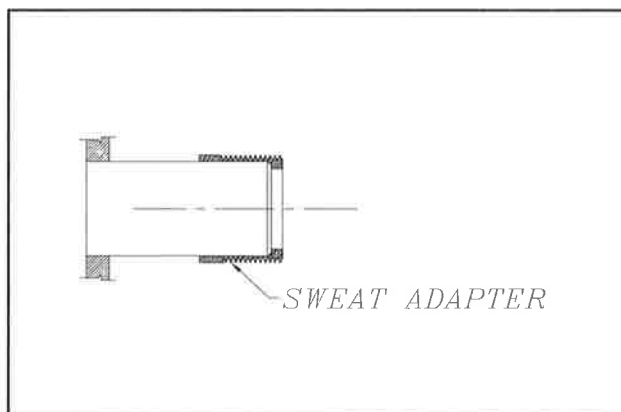

STEP NO. 3

Measure from finished wall to first thread of adaptor for length of chrome tube. Cut chrome tube this length 'x'.

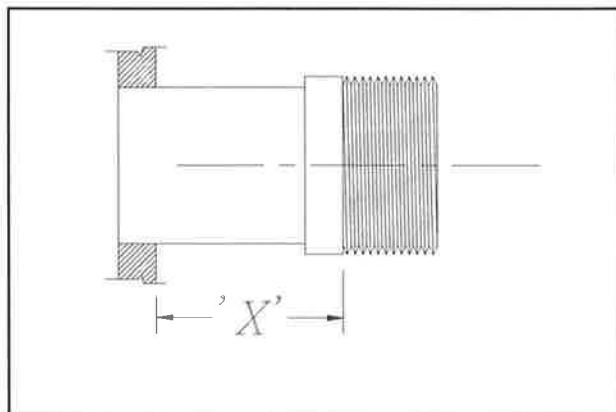

STEP NO. 4

Slide wall escutcheon over chrome tube and slide both chrome tube and wall escutcheon over supply pipe pushing the wall escutcheon all the way to the wall.

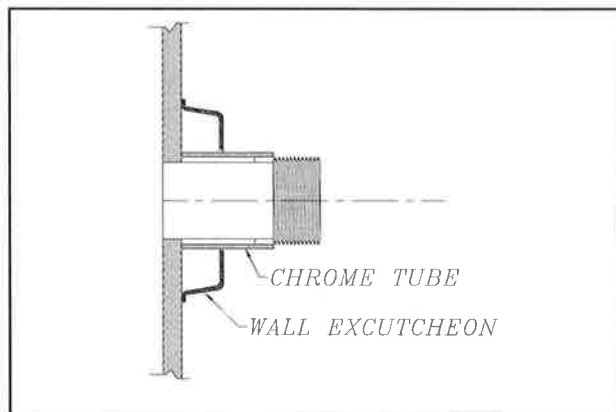

STEP NO. 5

Screw control stop onto water supply water adaptor.

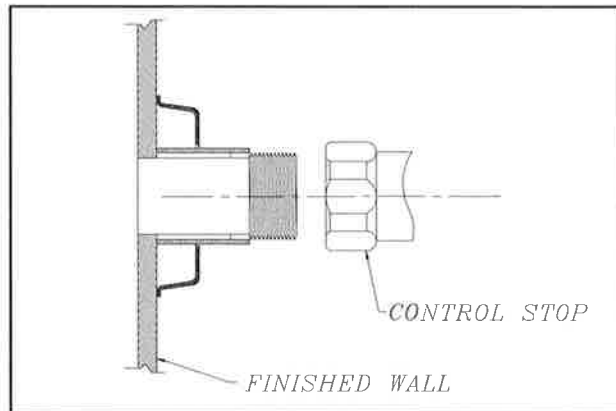

AquaVantage® Installation Instructions

1. Install stop valve assembly using proper size supply escutcheon and sweat solder adapter kit if applicable (see 1). Thread sealing compounds should be used on male NPT threads only.

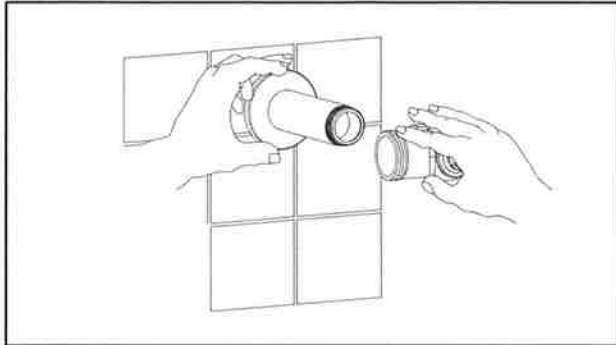

3. Insert the flush valve tailpiece into the stop valve and hand tighten the lock nut to the stop valve. Plumb the entire unit (see 3).

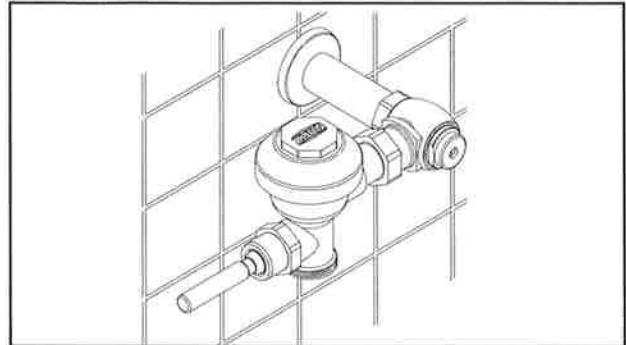

2. Prior to inserting the flush valve tailpiece into stop valve, be certain that the O-ring seal is located in O-ring seal groove at the end of the tailpiece and the locking nut and locking snap ring are located as shown below (see 2). Care should be taken not to damage the O-ring when inserting the tailpiece into the stop valve. If lubrication is needed, wetting the O-ring with water will be sufficient.

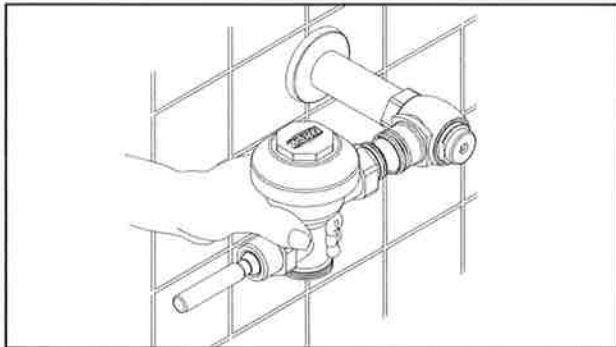

4. Determine the length of vacuum breaker tube required to join the flush valve and fixture spud. Cut the vacuum breaker tube, if required, to this length (see 4a). Assemble the vacuum breaker tube assembly and spud nut assembly to the flush valve and fixture spud (see 4b).

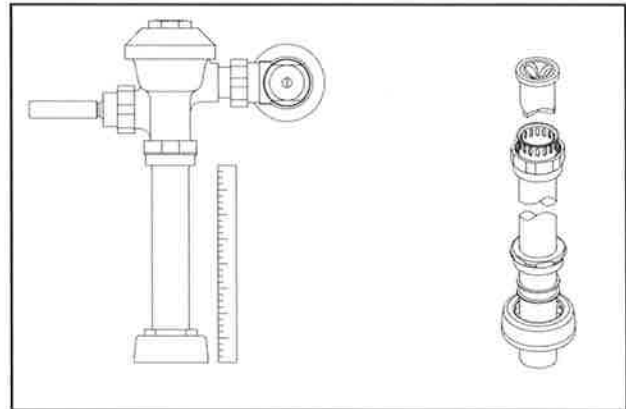

5. Hand tighten spud nut and vacuum breaker tube nut to fixture and flush valve. Adjust the valve assembly for plumb. Tighten fixture spud nut, vacuum breaker tube nut and lock nut with a wrench.

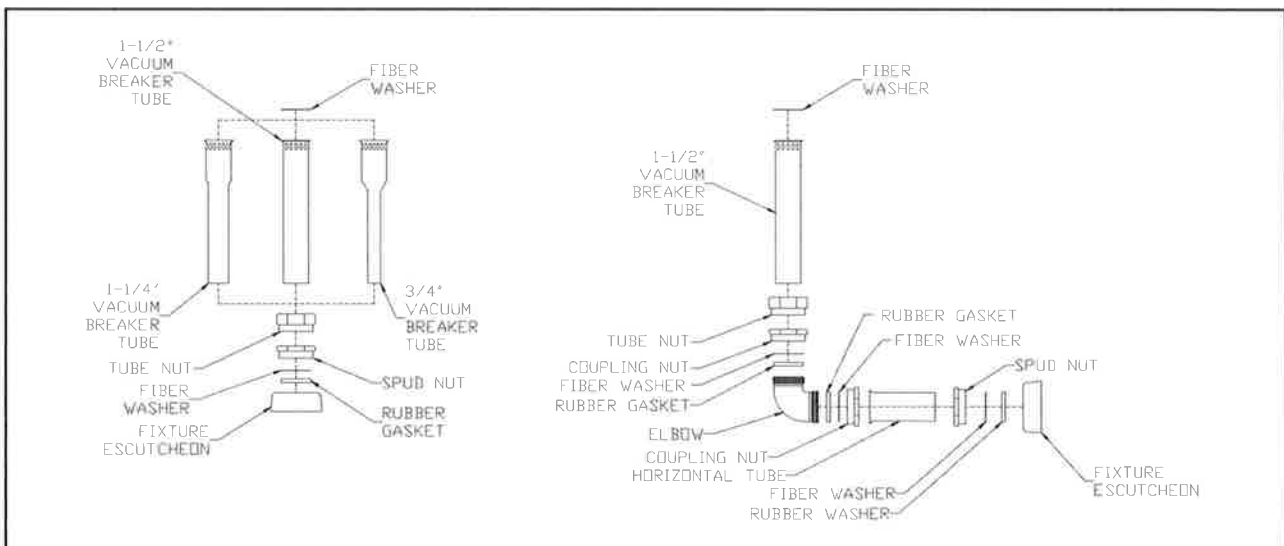

AquaVantage® Installation Instructions

6. When all flush valves are connected to the fixtures and water pressure is available, it is recommended that the supply piping be flushed to remove dirt, pipe chips, etc. from system. Before the water is turned on, be sure all stop valves to the flush valves are closed off tight. The stop valves can be opened and closed by using the adjusting screw located at the center of the stop valve cap, behind the stop snap cap screw cover if already installed (see 6a). Stop valve adjustments can only be made by using the adjusting screw. **It is not necessary to remove the stop valve cap when making adjustments. If for any reason it becomes necessary to remove the stop valve cap, be certain the water is shut off at the main supply valve.**

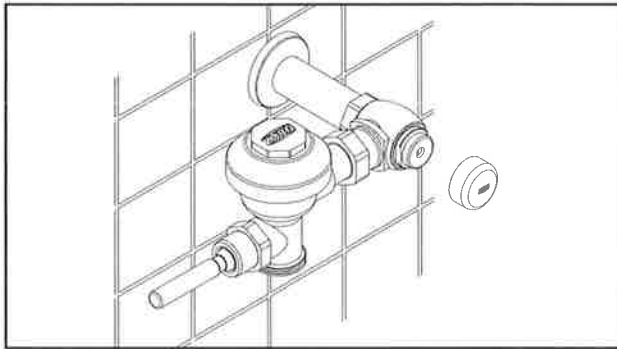
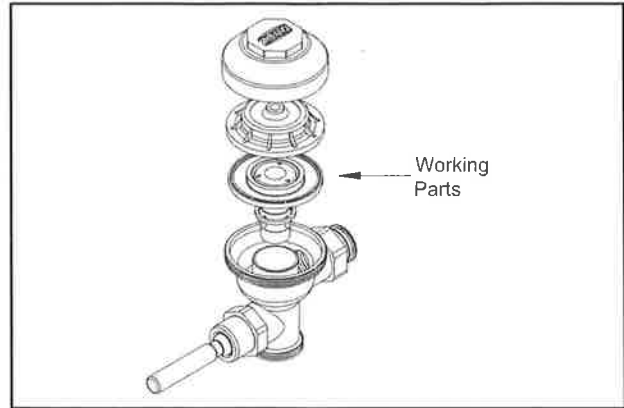

7. The Aquaflush flush valves are preset for fixture volume as marked on the valve cartons. The valve does not require regulation for variation in water pressure within its operating range. To set the flush valve for proper operation, gradually adjust the stop valve open, using the adjusting screw, while actuating the valve until the rate of water flow into the fixture is not excessive, yet is sufficient enough to adequately evacuate the waste. The final setting for urinals should be such that the fixture will not overflow when the valve is actuated in succession. The stop snap cap screw cover should be secured after final adjustments have been made.

Use the following procedure to flush out the supply piping:

- A. Remove the main valve body cover.
- B. Remove the working parts from the flush valve (shown in 6b).
- C. Replace the main valve body cover and plastic cover without reinstalling the working parts.
- D. Open the stop valve by using the stop adjusting screw, and flush out all debris from pipe and connections.
- E. Shut stop, open cover, replace the working parts, replace and tighten cover.

This procedure should also be followed when the system has been drained for some time, as occurs in athletic fields, recreation parks, etc.

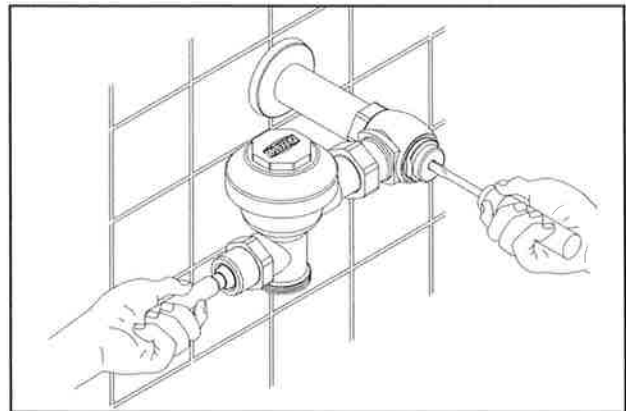

AquaVantage® Repair Kits

Part Identification

1. Handle Nut
2. Handle
3. Actuator Rod
4. Handle O-Ring
5. Handle Spring
6. Handle Seal Retainer
7. Handle Seal
8. Handle Gasket
9. Valve Body Cover
10. Plastic Wrap
11. Trip Mechanism
12. Diaphragm Assembly
13. Valve Body
14. Vacuum Breaker Insert
15. Vacuum Breaker Duckbill
16. Vacuum Breaker Tube
17. Vacuum Breaker Tube Nut
18. Spud Nut
19. Spud Friction Washer
20. Spud Sleeve
21. Spud Escutcheon
22. Tailpiece
23. Snap Ring
24. Tailpiece O-Ring
25. Locking Nut
26. Setscrew for Cast Wall Escutcheon
27. Cast Wall Escutcheon
28. Supply Cover Tube
29. Sweat Solder Adapter
30. Stop Body
31. Piston Seal
32. Piston Seal
33. Stop Spring
34. Guide O-Ring
35. Piston Guide
36. Guide Holder
37. Adjusting Screw
38. Stop Cap
39. Snap Cap Screw Cover
40. Vandal-Resistant Control Stop Cover
41. Setscrew for Control Stop Cover

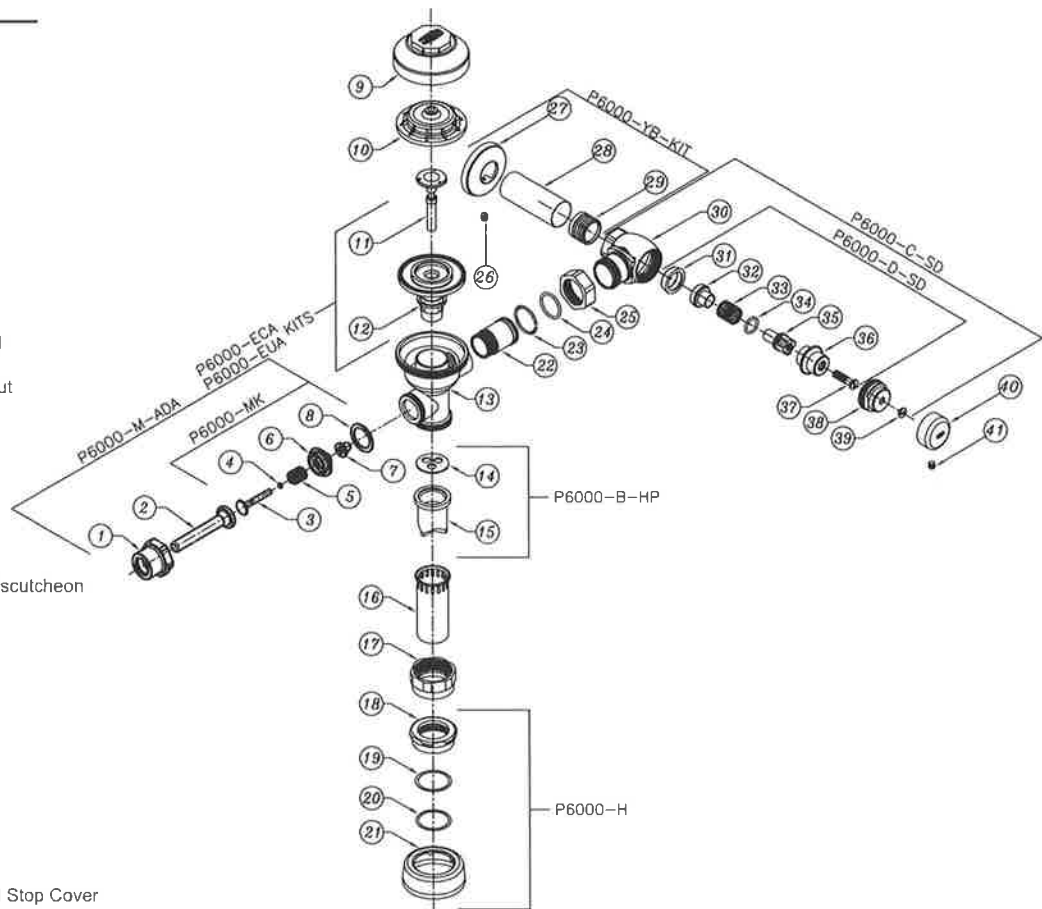

Covers and Repair Kits	Product No.
Outside Cover - CP - Item 9	P6000-LL
Inside Cover - Item 10	P6000-L
HET Water Closet Kit - 1.28 gal. flush (PL Only)	P6000-ECA-HET
ULF Urinal Kit - 0.125 gal. flush (PL Only)	P6000-EUA-ULF
Low Consumption Closet Kit - 1.6 gal. flush	P6000-ECA-WS1
Water Saving Closet Kit - 3.5 gal. flush	P6000-ECA-WS
Full Flow Closet Kit - 4.5 gal. flush	P6000-ECA-FF
Low Consumption Urinal Kit - 1.0 gal. flush	P6000-EUA-WS1
Water Saving Urinal Kit - 1.5 gal. flush	P6000-EUA-WS
Full Flow Urinal Kit - 3.0 gal. flush	P6000-EUA-FF

Repair Parts - Inside Parts	Product No.
Urinal Relief Valve - Item 11	P6000-EU13
Closet Relief Valve - Item 11	P6000-EC13

AquaVantage Rebuild Kits	Product No.
Closet and Urinal Rebuild Kits Include Items 3-8, 11, 12, 24, 28-34	P6000-EC-WS-RK P6000-EC-WS1-RK P6000-EU-WS-RK P6000-EU-WS1-RK

Handle Assembly and Repair Kits	Product No.
ADA Handle Assembly (Side) Includes Items 1-8	P6000-M-ADA
Handle Repair Kit (Side) Includes Items 4-8	P6000-MK
Handle Seal Includes Item 8	P6000-M9
Handle Gasket Includes Item 9	P6000-M10
Repair Kit for Front Operation - Exposed Includes Items 4-9	P6000-MHK
Handle Assembly (Front) Includes Items 2-9	P6000-MH

Control Stop Repair Kit and Parts	Product No.
Control Stop Repair Kit for 1" and 3/4"	P6000-D-SD
Includes Items 31-37	
Seal Seat for 1" and 3/4", Includes Item 31	P6000-D42
VP Control Stop Repair Kit for 1" and 3/4", Includes Items 30-39	P6000-C-SD
Sweat Solder Connection with Cast Wall Flange, Includes Items 26-29	P6000-YB

Adjustable Tailpieces	Product No.
Adjustable Tailpiece for Standard Flush Valve Includes Items 22-25	P6000-J1
Tailpiece Coupling Assembly Includes Items 23-25	P6000-K
Tailpiece Locking Ring Includes Item 23	P6000-C30
Tailpiece O-Ring Includes Item 24	P6000-C31
Coupling Nut Includes Item 25	P6000-C32

Flush Connections and Spud Coupling Kits	Product No.
Flush Tube Assembly for Flush Valves Includes Items 14-16. Specify diameter and length.	P6000-A-HP
Vacuum Breaker Repair Kit Includes Items 14-15	P6000-B-HP
Spud Coupling Assembly Includes Items 18-21. Specify size.	P6000-H

AquaVantage® Trouble Shooting Guide

Problem	Cause*	Corrective Action*
Valve will not operate.	1.) Stop valve is closed. 2.) Supply valve is closed.	1.) Open stop valve. 2.) Open supply valve.
Insufficient volume of water to adequately siphon fixture.	"1.) Stop valve is not open enough. 2.) Urinal trip mechanism installed in wrong kit, urinal for closet. 3.) Insufficient volume or pressure at supply.	1.) Open stop valve for desired volume of water. 2.) Replace urinal part with proper closet valve part. 3.) If gauges are not available to measure supply pressure or volume of water at the valve, completely remove the working parts and open the stop valve to allow water to pass through the empty valve. If the supply is adequate to siphon the fixture, the guide ring (#16) may be removed from the guide assembly to provide additional flow (see page 5). Should this prove unsatisfactory, steps should be taken to increase the pressure and/or supply.
Flush valve shuts off too quickly.	1.) Damaged or punctured diaphragm. 2.) Enlarged by-pass orifice. "	1.) Install new P6000-EUR or P6000-ECR replacement kit to remedy the problem. (#12 thru #17) 2.) Install new P6000-EUR or P6000-ECR replacement kit to remedy the problem. (#12 thru #17) "
Valve is short flushing.	1.) Diaphragm kit is not matched to the fixture. 2.) Urinal trip mechanism (black #12) is in the closet flush valve.	"1.) Install the proper P6000-EUR or P6000-ECR replacement kit to remedy the problem. (#12 thru #17) 2.) Install closet trip mechanism (white #12).
Valve is flushing too long or not shutting off.	1.) Trip mechanism not seating properly due to foreign material between trip mechanism and retainer disc. 2.) By-pass orifice is plugged or partially plugged. 3.) Line pressure is not adequate to force trip mechanism to seal. 4.) Cracked cover. (#11)	1.) Disassemble parts and rinse thoroughly. 2.) Examine by-pass orifice and clean if necessary being certain not to enlarge orifice opening. 3.) Pressure is inadequate or has dropped below minimum operating range. Steps should be taken to increase the line pressure. 4.) Replace cover with new one.
Water splashes out of fixture.	1.) Supply volume is more than is necessary. 2.) Lime accumulation on vortex or spreader holes of fixture.	1.) Adjust downward on control stop. 2.) Remove the lime build up.
Flush is not considered quiet.	1.) Control stop may not be adjusted for quiet operation. 2.) Fixture may be contributing to noise. 3.) Piping system may be source of noise.	1.) Adjust the control stop for quiet operation keeping in mind the fixture evacuation requirements. 2.) Check noise created by fixture by placing a cover over the bowl opening to separate valve noise from bowl noise. If it is deter-mined the fixture is too noisy consult with fixture manufacturer. 3.) High pressure in the system can sometimes be controlled by the stop valve. Other sources of noise may be the absence of air chambers and shock arrestors, loose pipes, improper size pipes, etc. In these cases the building engineer should be consulted.
Handle assembly leaking.	1.) Handle assembly is not tight.	1.) Tighten handle assembly.
Water drips from chrome cap.	1.) P6000-L inside plastic cap is cracked.	1.) Replace P6000-L plastic cap.

Care of Chrome Plated Surfaces

The suggested cleaning of chrome plated surfaces is simply to clean them with mild soap and water, then dry. Commercial cleaning compounds are never recommended.

Seasonal Use

Valves used in installations subject to shut down because of cold and freezing conditions should be maintained in the following manner. After the main supply has been shut off and the water drained from the system, remove the stop valve cap and stop valve internals to allow the water to drain from the flush valve itself.

*See previous page for numerical references.



ZURN INDUSTRIES, LLC COMMERCIAL BRASS OPERATION, 5900 ELWIN BUCHANAN DRIVE, SANFORD, NC, U.S.A. 27330
PHONE: 1-800-997-3876 FAX: 919/775-3541 www.zurn.com
ZURN INDUSTRIES LIMITED 3544 NASHUA DRIVE, MISSISSAUGA, ONTARIO L4V 1L2 PHONE: 905/405-8272 FAX: 905/405-1292

[READ MORE](#)



[Representative Listing](#)

[Product Spec Sheets](#)

[Spec Catalog](#)

[Features & Benefits Videos](#)

[Installation Videos](#)

[**Warranty**](#)

[Contact Us](#)

Warranty

Warranty Statement

All products are guaranteed against defects in material and workmanship for a period of one (1) year from date of purchase.

This guarantee does not apply to any compression molded wood, solid wood, decorator, or economy residential plastic toilet seats used in nonresidential installations, including hotels and motels.

This guarantee does not apply to any toilet seats which are modified in any way or used on any type of installation or unit other than conventional water closets. We assume no liability for toilet seats modified or installed on anything other than conventional water closets.

TOILETSEATS.COM

Copyright © 2022 Toiletseats.com All rights reserved.

FD-1

WATTS STANDARD LIMITED WARRANTY

Watts (the "Company") warrants each product to be free from defects in material and workmanship under normal usage for a period of one year from the date of original shipment. In the event of such defects within the warranty period, the Company will, at its option, replace or recondition the product without charge.

THE WARRANTY SET FORTH HEREIN IS GIVEN EXPRESSLY AND IS THE ONLY WARRANTY GIVEN BY THE COMPANY WITH RESPECT TO THE PRODUCT. THE COMPANY MAKES NO OTHER WARRANTIES, EXPRESS OR IMPLIED. THE COMPANY HEREBY SPECIFICALLY DISCLAIMS ALL OTHER WARRANTIES, EXPRESS OR IMPLIED, INCLUDING BUT NOT LIMITED TO THE IMPLIED WARRANTIES OF MERCHANTABILITY AND FITNESS FOR A PARTICULAR PURPOSE.

The remedy described in the first paragraph of this warranty shall constitute the sole and exclusive remedy for breach of warranty, and the Company shall not be responsible for any incidental, special or consequential damages, including without limitation, lost profits or the cost of repairing or replacing other property which is damaged if this product does not work properly, other costs resulting from labor charges, delays, vandalism, negligence, fouling caused by foreign material, damage from adverse water conditions, chemical, or any other circumstances over which the Company has no control. This warranty shall be invalidated by any abuse, misuse, misapplication, improper installation or improper maintenance or alteration of the product

Some States do not allow limitations on how long an implied warranty lasts, and some States do not allow the exclusion or limitation of incidental or consequential damages. Therefore the above limitations may not apply to you. This Limited Warranty gives you specific legal rights, and you may have other rights that vary from State to State. You should consult applicable state laws to determine your rights. SO FAR AS IS CONSISTENT WITH APPLICABLE STATE LAW, ANY IMPLIED WARRANTIES THAT MAY NOT BE DISCLAIMED, INCLUDING THE IMPLIED WARRANTIES OF MERCHANTABILITY AND FITNESS FOR A PARTICULAR PURPOSE, ARE LIMITED IN DURATION TO ONE YEAR FROM THE DATE OF ORIGINAL SHIPMENT.



Effective: July 2, 2018

This warranty applies to all products purchased after this date

USA: T: (978) 689-6066 • F: (978) 975-8350 • Watts.com
Canada: T: (905) 332-4090 • F: (905) 332-7068 • Watts.ca
Latin America: T: (52) 55 4122 0138 • Watts.com/LatinAmerica

Relocate Medical Media

Little Rock, AR

Comfort Systems USA

North Little Rock, AR

Plumbing Submittals

Sanders Supply



Hot Springs, AR

April 7, 2022

Relocate Medical Media

Plumbing Fixture Schedule Index

<u>TAB</u>	<u>Description</u>
S-1	Sink ADA
WC-1	Water Closet ADA
FD-1	Floor Drain

S-1

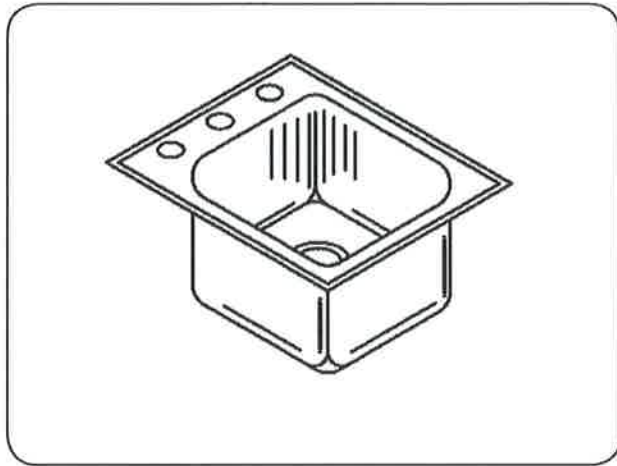

SPECIFICATION

Seamless die-drawn construction of Type 304, 18-8 stainless steel. Interior and top surfaces polished to a non-porous Hand-Blended Just Finish with highlighted bowl rim. Fully coated underside insulated for sound and reduces condensation. Straight-sided compartment with radius corners provides greater capacity. Self-rimming top mount Grip-Rim Plus with stainless steel mounting channels. Conforms to ASME/ANSI A112.19.3M. Certified conformance with ASME A112.19.3/CSA B45.4, Canadian Standards (CSA), Uniform Plumbing Code (UPC) and International Plumbing Code (IPC) and Americans with Disabilities Act(ADA). Drain punch 3-1/2" centered for Just J-35 drain.

☐ **TYPE 316 STAINLESS STEEL** (Check if applicable)

CUTOUT DIMENSIONS		
Model Number	Front-to-Back	Left-to-Right
SL-ADA-1815-A-GR	17-1/4	14-1/4

APPROVED FOR MANUFACTURING	
MODEL NO.: SL-ADA-1815-A-GR	QTY: _____
JOB NAME: Relocate Medical Media	_____
TAG/ITEM: S-1	_____
CUSTOMER: _____	_____
SIGNATURE: _____	_____

JUST MANUFACTURING COMPANY

PH: 847-678-5150

FAX: 847-678-6817

9233 KING STREET . FRANKLIN PARK . ILLINOIS . 60131-2111

E-MAIL: custserv@justmfg.com . www.justmfg.com

SL-ADA-1815-A-GR

STYLIST GROUP LEDGE TYPE - SINGLE BOWL 18 GAUGE

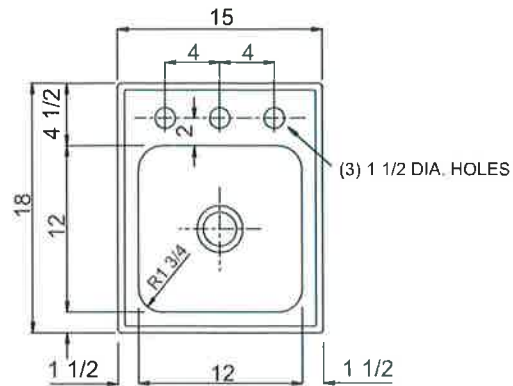

3.84

Gallon
Capacity*

Capacity Matters

Max ID sizing with straight sided bowl configuration (non tapered sides). Tight corner radius design.

*Capacity is based on 6-1/2" Depths

FAUCET PUNCHING - MUST BE SPECIFIED

- ☒ (1) Hole Centered
☐ (2) Holes on 4" centers
☐ (3) Holes on 4" centers (illustrated)

☐ Alternate Punching:
Faucet Model: _____

Punching Required: _____

DEPTH - MUST BE SPECIFIED: Please Verify-Not Specied

- ☐ 4 1/2" DEEP ☐ 5" DEEP ☐ 5-1/2" DEEP ☐ 6" DEEP ☐ 6-1/2" DEEP

DRAIN LOCATION - MUST BE SPECIFIED:

- ☒ CENTER ☐ CENTER REAR ☐ LEFT REAR ☐ RIGHT REAR



JUST MFG COMPANY CONTINUES TO MAKE QUALITY AND FUNCTIONALITY A MARK OF THE JUST PRODUCT LINE. TO DO SO REQUIRES THAT WE RESERVE THE RIGHT TO CHANGE PRODUCT INFORMATION WITHOUT NOTICE. DIMENSIONS MAY VARY AND ARE SUBJECT TO CHANGE WITHOUT NOTICE. NO RESPONSIBILITY IS ASSUMED FOR USE OF SUPERSEDED OR VOIDED DATA. FOR THE MOST CURRENT AND ACCURATE INFORMATION REGARDING THE COMPLETE LINE OF JUST SINKS, FAUCETS AND DRAINS, CLICK ON THE **SPEC LINE DRAWINGS** LINK ON OUR WEB SITE AT www.justmfg.com



BASYS® SENSOR FAUCET
EFX-100-HLP-TEE-CP-0.5GPM-MLM-IR-FCT
(General Model Name: EFX100.000.0000)

CODE NUMBER

3324030

DESCRIPTION

Hardwired Less Plug Power Supply, Back-Check Tee, Polished Chrome Finish, 0.5 gpm, Multi-Laminar Spray, Infrared Sensor, BASYS® Hardwired-Powered Deck-Mounted High Body Faucet.

DETAILS

- Flow Rate: 0.5 gpm (2 Lpm) (0.5GPM)
- Spray Type: Multi-Laminar (MLM)
- Sensor Type: Infrared (IR)
- Mounting Type: Single Hole ()
- Power Supply: Hardwired Less Plug (HLP)
- Temperature Mixer: Back-Check Tee (TEE)
- Finish: Polished Chrome (CP)
- Factory Default Timeout: 10s
- Factory Default GPC: 0.083

FEATURES

Commercial Grade, ADA Compliant, Electronic, Sensor-Activated, Die-Cast Metal Hand Washing Faucet with the following features:

- One tool service
- All wetted components to be stainless steel, engineered thermoplastic, EPDM, and copper or copper alloy
- Solenoid housed in removable carrier that includes supply strainer
- Integral water supply shut off
- Supply strainer serviceable from above deck
- Vandal resistant spray insert, key housed inside faucet body
- All electronics sealed to IP-67
- Gold plated electrical contacts
- Above deck individual diagnostic indicators for battery life, solenoid condition, and power up mode
- Flexible, high pressure supply hoses, 3/8" compression connections
- Bi-stable magnetic solenoid
- Four (4) "AA" alkaline batteries
- Double infrared sensors with automatic setting feature Includes all mounting hardware
- Line purge mode, eliminates stagnant water
- Adjustable time-outs
- Standard Bowed Crown

ELECTRICAL SPECIFICATIONS

- Battery Life: 3 years 8,000 cycles/month
 - Optional power harvesting significantly extends service life
- Sensor Range: 4"-5" (102-127mm)

VIDEOS

- ▶ BASYS® Faucet Installation and Features
- ▶ Sloan Connect App®

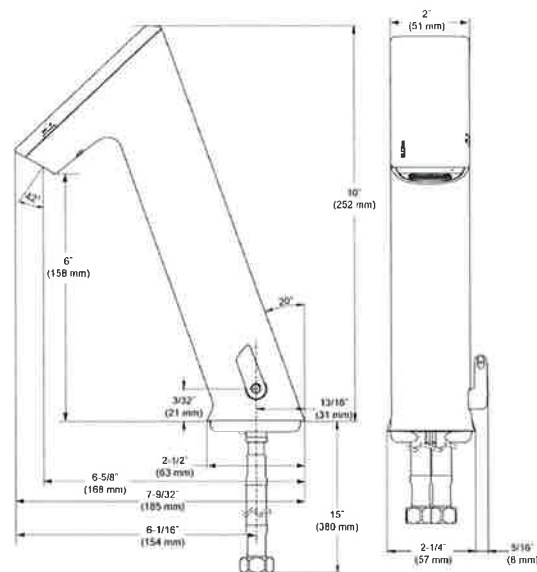

COMPLIANCES & CERTIFICATIONS



(ADA Compliant, ASME A112.18.1 Compliant, CalGreen Compliant, CEC Compliant, cUPC Certified, UPC Certified, UPC Low Lead Compliant, cUPC Low Lead Compliant, EPD, HPD, NYC604.4, Proposition 65, Satisfies LEED Credits, TAS, WELL Building Standard)

RECOMMENDED SPECIFICATION

Sloan BASYS Model No. EFX-100-HLP-CP-0.5GPM-MLM-IR-FCT Infrared Sensor Activated Electronic Handwashing Faucet for pretempered or hot/cold water supplies. Product to have double infrared sensors with automatic setting feature.

Sloan 10500 Seymour Ave, Franklin Park, IL 60131
Phone: 800.982.5839 • Fax: 800.447.8329 • sloan.com



BASYS® SENSOR FAUCET
EFX-100-HLP-TEE-CP-0.5GPM-MLM-IR-FCT
(General Model Name: EFX100.000.0000)

DOWNLOADS

- [EFX 1Xx/2Xx Installation Instructions](#)
- [EFX 1Xx/2Xx \(SP\) Installation Instructions](#)
- [EFX 1Xx/2Xx Caddy Replacement Installation Instructions](#)
- [IR FAQs Repair and Maintenance Guide](#)
- [IR FAQs SP Repair and Maintenance Guide](#)
- [EFX-1XX Repair and Maintenance Guide](#)
- [Trim Plate Guide](#)
- [Faucet Spray Heads Repair and Maintenance Guide](#)
- [Additional Downloads](#)

Solenoid valve housed in removable carrier that closes water supply upon removal eliminating need to access control stops. Solenoid carrier includes strainer for easy above deck service. Thermostatic mixer ordered separately to comply with ASSE 1070 requirements. The product shall be tested and certified to industry standards: ASME A112.18.1M, CSA B125.1, California Health and Safety Code 116875

NOTES

All information contained within this document subject to change without notice.

Looking for other variations of the EFX-100 product? [View the general spec sheet with all options.](#)

[Find a matching soap dispenser](#) for this faucet.

[Find a compatible sink](#) for this faucet.

WARRANTY

3 Year

Sloan 10500 Seymour Ave, Franklin Park, IL 60131
Phone: 800.982.5839 • Fax: 800.447.8329 • sloan.com



BASYS® SENSOR FAUCET
EFX-100-HLP-TEE-CP-0.5GPM-MLM-IR-FCT
(General Model Name: EFX100.000.0000)

ROUGH-IN

EFX-100.00X.0X1X Faucet
with Single Line Water Supply

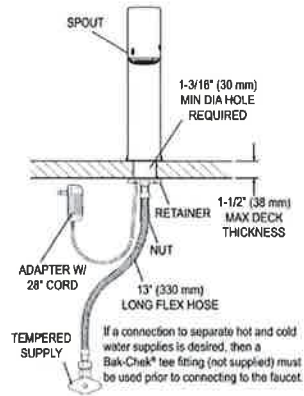

EFX-100.50X.0X1X Faucet
with Hot & Cold Water Supply

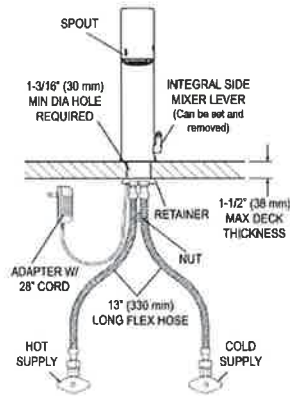

Electrical Connection for up to 6 Faucets
Can combine up to six (6) faucets using one adapter

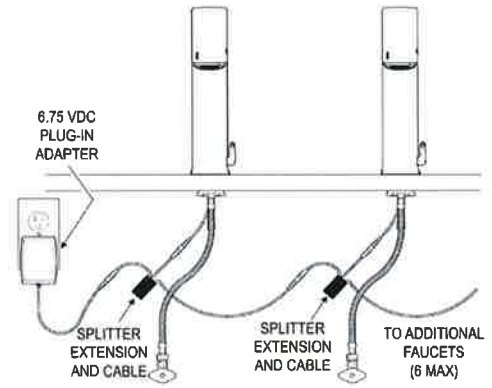

Sloan 10500 Seymour Ave, Franklin Park, IL 60131
Phone: 800.982.5839 • Fax: 800.447.8329 • sloan.com



McGuire Manufacturing Co., Inc.

60 Grandview Court
P.O. Box 746 ♣ Cheshire, CT 06410
203-699-1801 ♣ Fax: 203-699-1813
www.mcguiremfg.com

PRODUCT SPECIFICATION

Part No.

152

Wide Top Sink
Strainer

Job Name:

Submittal Number:

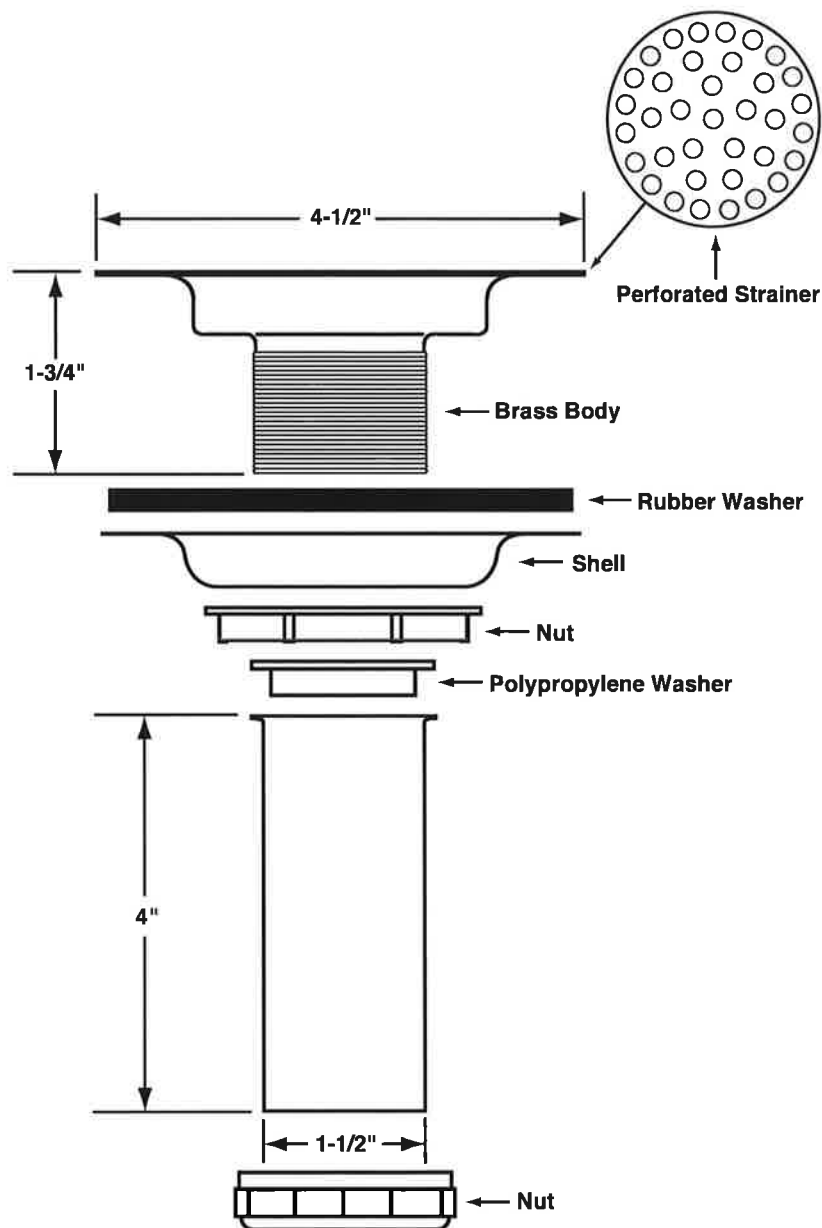

See options and accessories section for details on product variations.

Specifications:

Wrought Brass Chrome Plated Wide Top Sink Strainer with 1-1/2" x 4" seamless brass tailpiece.
Fits sink thickness up to 3/4 inch.



McGuire Manufacturing Co., Inc.
 60 Grandview Court
 P.O. Box 746 ♣ Cheshire, CT 06410
 203-699-1801 ♣ Fax: 203-699-1813
 www.mcguiremfg.com

PRODUCT SPECIFICATION

Part No.

8872CBECO, C8872CECO
 8912CBECO, **C8912CECO**,
 8912CNCBECO, 8912C18BECO

**Cast Body P-Trap With
 or Without Cleanout**

Job Name:

Submittal Number:

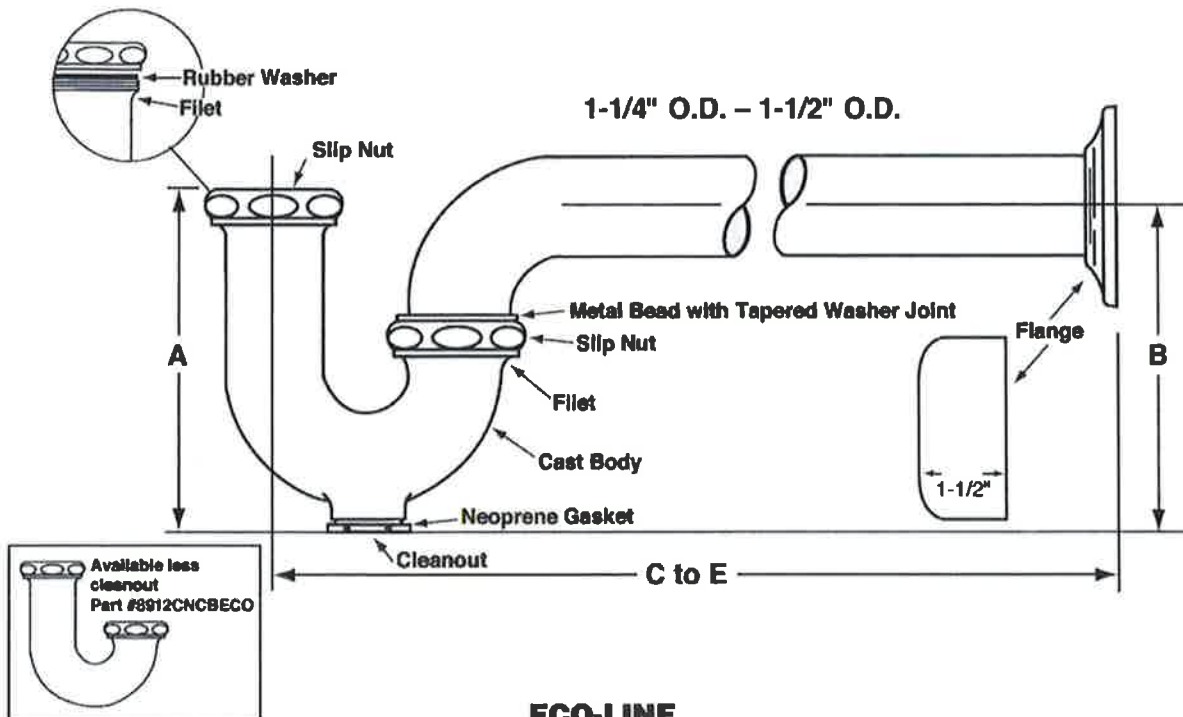

ECO-LINE

ROUGHING MEASUREMENTS

MODEL NO.	TRAP DIMENSIONS		A	B	C to E	FLANGE	SLIP NUT
	INLET	OUTLET					
8872CBECO	1-1/4"	1-1/4"	5"	4-1/2"	11"	Box	Brass
C8872CECO	1-1/4"	1-1/4"	5"	4-1/2"	10"	Shallow	Zinc
8912CBECO	1-1/2", 1-1/4"	1-1/2"	5"	4-1/2"	12"	Box	Brass
C8912CECO	1-1/2"	1-1/2"	5"	4-1/2"	10-1/2"	Shallow	Zinc
8912CNCBECO	1-1/2", 1-1/4"	1-1/2"	5"	4-1/2"	12"	Box	Brass
8912C18BECO	1-1/2", 1-1/4"	1-1/2"	5"	4-1/2"	18"	Box	Brass

**FED SPEC W.W.P. 541
 CAST BRASS P-TRAP
 MINIMUM SEAL 2"**

See options and accessories section for details on product variations.



Specifications:

Chrome plated P-Trap shall be cast brass body, with or without cleanout, with 17 gauge seamless tubular wall bend and flange.

**McGuire Manufacturing Co., Inc.**

60 Grandview Court
P.O. Box 746 • Cheshire, CT 06410
203-699-1801 • Fax: 203-699-1813
www.mcguiremfg.com

PRODUCT SPECIFICATION**Part No.**

LF2165, **LF2165LK**,
LF2167, LF2167LK

Lavatory Supply
1/2" I.P.S. x O.D.

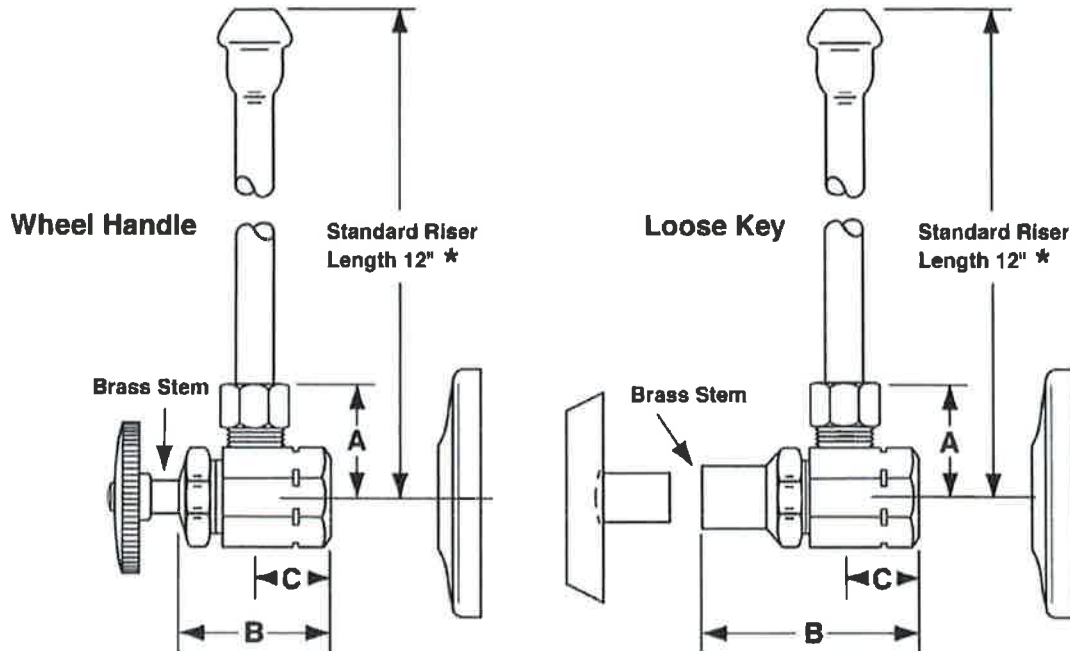
Job Name:**Submittal Number:**

NO.	DESCRIPTION	ROUGHING MEASUREMENTS		
		A	B	C
LF2165	1/2" I.P.S. x 3/8" O.D.	1-3/16"	1-1/2"	3/4"
➤ LF2165LK	1/2" I.P.S. x 3/8" O.D.	1-3/16"	2-1/4"	3/4"
LF2167	1/2" I.P.S. x 1/2" O.D.	1-3/16"	1-1/2"	3/4"
LF2167LK	1/2" I.P.S. x 1/2" O.D.	1-3/16"	2-1/4"	3/4"

LK designates Loose Key

* See options and accessories section for details on product variations.

**Specifications:**

Supply kit shall include low lead chrome plated brass supply stop valves with full turn brass stem, no plastic, (12, 15, 20) inch chrome plated risers and (shallow, deep, bell) (steel, brass) or (forged brass with set screw) flange. Inlet shall be (3/8, 1/2) inch (IPS, compression). Outlet shall be (3/8, 1/2) inch compression. Supply kit shall be McGuire _____. Supply kit shall be low lead certified by recognized authority and bear manufacturer and testing mark.

WC-1

American Standard

Style That Works Better



**PRIOLO 16-1/2" HEIGHT 1.6 GPF
with EVERCLEAN®**

- Floor mount rear outlet flushometer valve toilet
- Vitreous china
- Low-consumption (6.0 Lpf/1.6 gpf)
- EverClean® surface inhibits the growth of stain- and odor-causing bacteria, mold, and mildew on the surface
- 16-1/2" rim height for accessible application
- Condensation channel
- Elongated bowl
- Powerful direct-fed siphon jet action
- Fully glazed 2-1/8" trapway
- 1-1/2" inlet spud
- 2 bolt caps
- 100% factory flush tested

- ➔ ☐ ~~3695.016 Elongated bowl only, top spud~~
- ☐ **3695.001** Same as above, Universal Bowl
- ☐ ~~3697.016 Elongated bowl only, back spud~~
- ☐ **3697.001** Same as above, Universal Bowl
- ☐ **3696.016** Elongated bowl only, top spud with slotted rim for bedpan holding (White only)
- ☐ **3696.001** Same as above, Universal Bowl
- ☐ **3698.016** Elongated bowl only, back spud with slotted rim for bedpan holding (White only)

Component Parts:

- ☐ **047007-0070A** Inlet spud (furnished with bowl)
- ☐ **481310-XXX0A** Bolt caps with retainers (furnished with bowl)

Nominal Dimensions:

752 x 356 x 419mm
(29-5/8" x 14" x 16-1/2")

Recommended working pressure—between
25 psi at valve when flushing and 80 psi static

Fixture only, less seat and flush valve

Compliance Certifications -

Meets or Exceeds the Following Specifications:

- ASME A112.19.2-2008/CSA B45.1-08 for Vitreous China Fixtures

**PRIOLO 16-1/2" HEIGHT
1.6 GPF FLUSHOMETER TOILET**
VITREOUS CHINA with EVERCLEAN®



SEE REVERSE FOR ROUGHING-IN DIMENSIONS

To Be Specified:

- ☐ Color: ☐ White ☐ Bone ☐ Linen
- ☐ Seat:
- ☐ American Standard #5901.110 Heavy duty open front less cover with Everclean® surface
 - ☐ American Standard #5905.110 Extra heavy duty open front less cover with Everclean® surface
- ☐ Alternative Seat:
- ☐ Flushometer Valve:
- ☐ American Standard Selectronic™ #6065.161.002 DC Power (Top Spud)
 - ☐ American Standard Selectronic™ #6065.261.007 DC Power (Back Spud)
 - ☐ American Standard Selectronic™ #6067.261.007 AC Power (Back Spud)
 - ☐ American Standard Selectronic™ #6068.261.007 Multi AC Power (Back Spud)
- ☐ Alternative Flushometer Valve



MEETS THE AMERICANS WITH DISABILITIES ACT GUIDELINES
AND ANSI A117.1 REQUIREMENTS FOR ACCESSIBLE AND USABLE
BUILDING FACILITIES - CHECK LOCAL CODES.

EVERCLEAN®
Surface

PRIOLO 16-1/2" HEIGHT
1.6 GPF FLUSHOMETER TOILET
VITREOUS CHINA with EVERCLEAN®

3695.016/3696.016

3695.001/3696.001

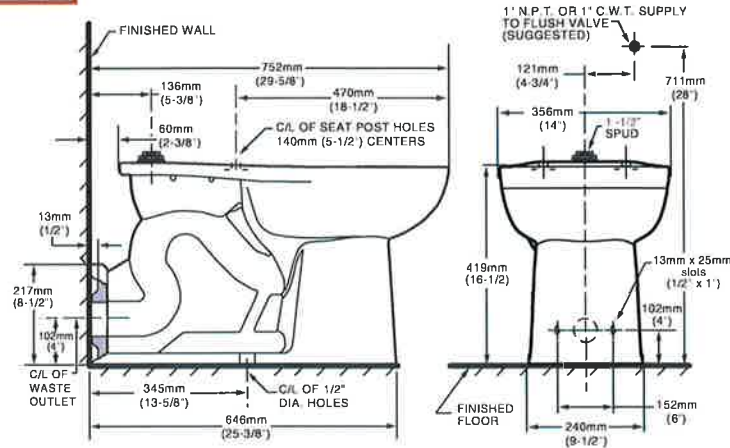

DIMENSIONS (Nominal) NOTE: Distance from floor to closet flange centerline (rough-in) must be 4" (102 mm) with flange surface flush to 1/16" (1.6mm) max. beyond finished wall.

3697.016/3698.016

3697.001

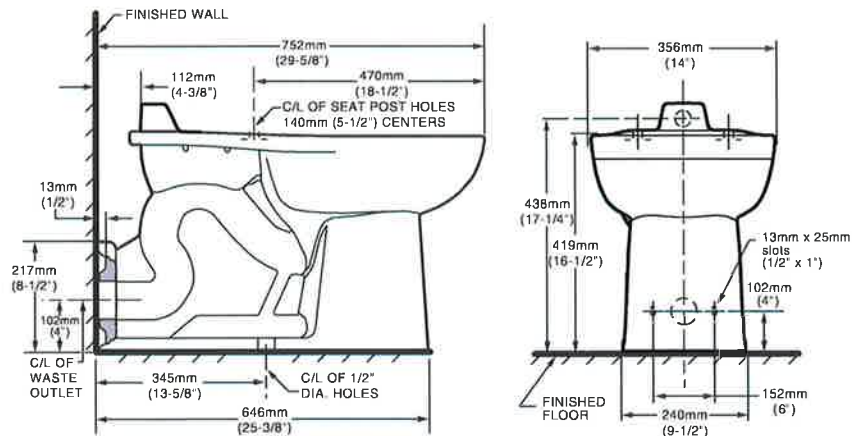

DIMENSIONS (Nominal) NOTE: Distance from floor to closet flange centerline (rough-in) must be 4" (102 mm) with flange surface flush to 1/16" (1.6mm) max. beyond finished wall.

NOTES:

NOTES:
 PRODUCTS 3695 AND 3696 SHOWN, 3697 AND 3698.160 SAME AS EXCEPT WITH SLOTTED RIM FOR BED PAN HOLDING.
 TO COMPLY WITH AREA CODE GOVERNING THE HEIGHT OF VACUUM BREAKER ON THE FLUSHMETER VALVE, THE PLUMBER MUST VERIFY DIMENSIONS SHOWN FOR SUPPLY ROUGHING.
 FLUSHMETER VALVE NOT INCLUDED WITH FIXTURE AND MUST BE ORDERED SEPARATELY. FLUSHMETER VALVE REQUIREMENTS FOR 12" (305MM) ROUGH-IN: SWEAT EXTENSION NIPPLE IS REQUIRED. REFER TO VALVE MANUFACTURER AND LOCAL CODES.

IMPORTANT: Dimensions of fixtures are nominal and may vary within the range of tolerances established by ANSI Standard A112.19.2. These measurements are subject to change or cancellation. No responsibility is assumed for use of superseded or voided pages.



AquaVantage® AV Model

TAG WC-1

Z6000AV

Exposed Flush Valve for Water Closets

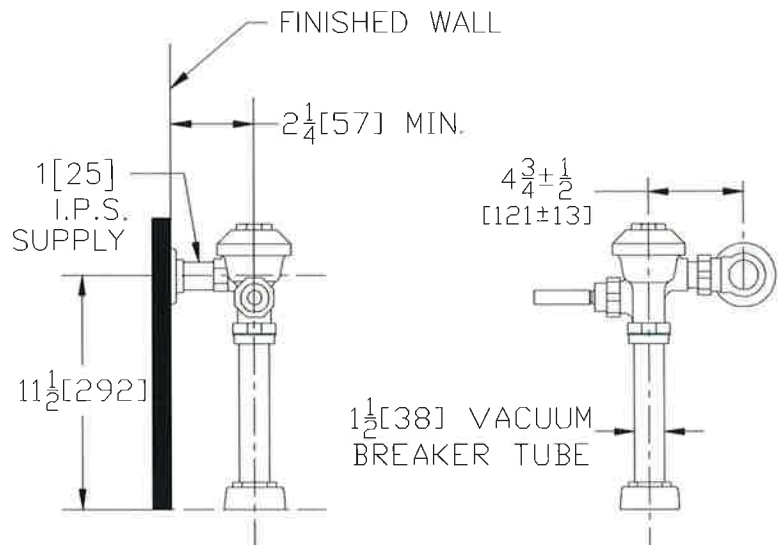

Flow Options

- ☐ **-ONE*** 1.1 gpf High Efficiency Flush
☒ **-HET*** 1.20 gpf High Efficiency Flush
☐ **-WS1** 1.6 gpf Low Consumption Flush
☒ **-Standard** 3.5 gpf
☐ **-FF** 4.5 gpf Full Flush

Suffix Options (Check/Specify Appropriate Options)

- ___ **-BG** BioCare Handle
___ **-H** Handle on Front of Flush Valve
___ **-L** 1" [25] Metal Push Button
___ **-L3** 3" [76] Metal Push Button
___ **-YJ** Split Ring Pipe Support
___ **-YK** Solid Ring Pipe Support
___ **-YO** Bumper on Angle Stop
___ Other



*This product should be used with a WaterSense labeled counterpart with a compatible flush volume to ensure that the entire system meets the requirements for water efficiency and performance.

ENGINEERING SPECIFICATION: ZURN Z6000AV AquaVantage® 'AV' Exposed Closet Flush Valve - Exposed, quiet diaphragm-type, chrome plated flushometer valve with a polished exterior. Complete with Zurn's AquaVantage® TPE, chloramine resistant, dual seal diaphragm with a clog resistant, triple filtered by-pass. The valve is ADA compliant with a non-hold open and no leak handle feature, high back pressure vacuum breaker, one piece hex coupling nut, adjustable tailpiece, spud coupling and flange for top spud connection. Control stop has internal siphon-guard protection, vandal resistant stop cap, sweat solder kit, and a cast wall flange with set screw. Internal seals are made of chloramine resistant materials.

Architectural/Engineering Approval

The information contained in this document is subject to change without notice.

ZURN INDUSTRIES, LLC. ♦ COMMERCIAL BRASS OPERATION ♦ 5900 ELWIN BUCHANAN DRIVE ♦ SANFORD NC 27330

Phone: 1-800-997-3876 ♦ Fax: 919-775-3541 ♦ World Wide Web: www.zurn.com

In Canada: ZURN INDUSTRIES LIMITED ♦ 7900 Goreway Drive Unit 10 ♦ Brampton, Ontario L6T5W6 ♦ Phone: 905-405-8272 Fax: 905-405-1292

AquaVantage® is a registered trademark of Zurn Industries, LLC.

Rev. E
Dwg. No. 63276

Date: 4/27/2017
Product No. Z6000AV



295CT / 295SSCT

COMMERCIAL HEAVY-DUTY
PLASTIC TOILET SEAT

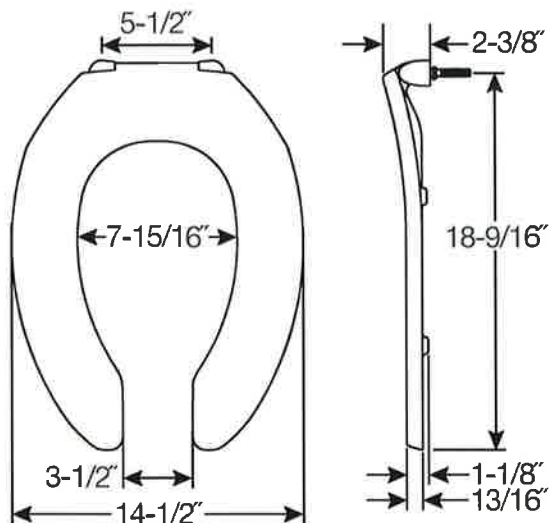

FEATURES:

- **STA-TITE®**
Commercial Fastening System™
Eliminates callbacks for loosened seats

SPECIFICATIONS:

Size: Elongated

Material: Plastic

Style: Open Front less Cover

Ring Bumpers: Four

Hinges: Plastic Non Self-Sustaining Check Hinges (295CT) or
Self-Sustaining Check Hinges (295SSCT) with Non-Corroding
300 Series Stainless Steel Posts and Pintles

Hardware: STA-TITE® Commercial Fastening System™

Codes & Standards:



Complies with
IAPMO/ANSI Z124.5
Performance Standards
Heavy-Duty Commercial



Proudly Made in the USA

Church Seat Co., Sheboygan Falls, WI 53085

ToiletSeats.com

ph: 800.233.7328

fx: 800.292.3647

Church Seat Co. reserves the right to make revisions without notice to product specifications.

5/20" 8 08703,2356

Eco-Friendly



FD-1

For Commercial Applications

Job Name **Relocate Medical Media**
 Job Location **LR**
 Engineer **Insight**
 Approval _____
 Tag **FD-1**

Contractor **Comfort Systems USA**
 Approval _____
 Contractor's P.O. No. _____
 Representative **Sanders Supply**

FD-100-A

Floor Drain With Round Strainer

Specification

Watts FD-100-A epoxy coated cast iron floor drain with anchor flange, reversible clamping collar with primary and secondary weepholes, adjustable round heel proof nickel bronze strainer, and no hub (standard) outlet.

Pipe Sizing (Select One)		
Suffix	Description	
2	2" (51) Pipe Size	<input type="checkbox"/>
3	3" (76) Pipe Size	<input type="checkbox"/>
4	4" (102) Pipe Size	<input type="checkbox"/>
6	6" (152) Pipe Size (No Hub Only)	<input type="checkbox"/>

Outlet Type (Select One)		
Suffix	Description	
NH	No Hub (MJ)	<input type="checkbox"/>
P	Push On	<input checked="" type="checkbox"/>
T	Threaded Outlet	<input type="checkbox"/>
X	Inside Caulk	<input type="checkbox"/>

Strainer (Select One)		
Suffix	Description	
A5	5" (127) Dia., Nickel Bronze	<input checked="" type="checkbox"/>
A6	6" (152) Dia., Nickel Bronze	<input type="checkbox"/>
A7	7" (178) Dia., Nickel Bronze	<input type="checkbox"/>
A8	8" (203) Dia., Nickel Bronze	<input type="checkbox"/>
A10	10" (254) Dia., Nickel Bronze	<input type="checkbox"/>

Options (Select One)		
Suffix	Description	
-5	Sediment Bucket	<input type="checkbox"/>
-6	Vandal Proof	<input type="checkbox"/>
-7	Trap Primer Tapping	<input checked="" type="checkbox"/>
-8	Backwater Valve (2, 3, 4" Only)	<input type="checkbox"/>
-13	Galvanized Body	<input type="checkbox"/>
-15	Strainer Extension (DD-50)	<input type="checkbox"/>
-F4-50	4" Round Cast Iron Funnel	<input type="checkbox"/>
-F4-1	4" Round Nickel Bronze Funnel	<input type="checkbox"/>
-F6-1	6" Round Nickel Bronze Funnel	<input type="checkbox"/>
-G-50	4x9" Oval Cast Iron Funnel	<input type="checkbox"/>
-G-1	4x9" Oval Nickel Bronze Funnel	<input type="checkbox"/>
-SO	Side Outlet	<input type="checkbox"/>

Strainer Size				
Str. Dia.	Min.	Max.	Load Rating	Free Area Sq. In.
5" (127)	13/16" (21)	3 1/4" (83)	*MD	8
6" (152)	7/8" (22)	3 3/8" (86)	*MD	9
7" (178)	11/16" (17)	3 1/4" (83)	*MD	12
8" (203)	7/8" (22)	3 1/4" (83)	*MD	18
10" (254)	1 1/4" (32)	3 1/4" (83)	*MD	28

Chart B						
Pipe Size	Std. No Hub	P Push On	T Female Thread	X Inside Caulk	60/61 PVC/ABS	
2" (52)	3 5/8" (92)	4 1/4" (108)	4 1/4" (108)	4 1/2" (114)	4" (102)	
3" (76)	3 5/8" (92)	4 1/4" (108)	4 1/4" (108)	4 1/2" (114)	4" (102)	
4" (102)	3 5/8" (92)	4 1/4" (108)	4 1/4" (108)	4 1/2" (114)	4" (102)	
6" (152)	3 1/2" (89)					

Optional Body Material		
Suffix	Description	
-60	PVC Body w/Socket Outlet	<input type="checkbox"/>
-61	ABS Body w/Socket Outlet	<input type="checkbox"/>

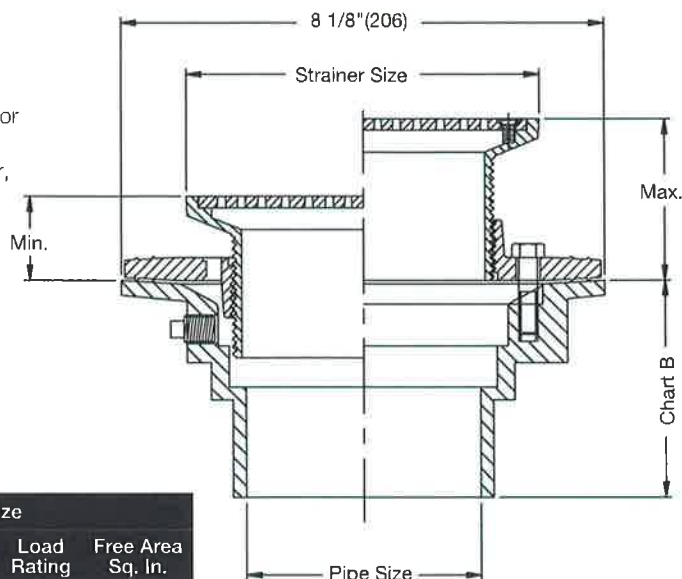

Please refer to watts.com for BAA information on specific models.

NOTICE

The information contained herein is not intended to replace the full product installation and safety information available or the experience of a trained product installer. You are required to thoroughly read all installation instructions and product safety information before beginning the installation of this product.

Watts product specifications in U.S. customary units and metric are approximate and are provided for reference only. For precise measurements, please contact Watts Technical Service. Watts reserves the right to change or modify product design, construction, specifications, or materials without prior notice and without incurring any obligation to make such changes and modifications on Watts products previously or subsequently sold.



USA: T: (800) 338-2581 • F: (828) 248-3929 • Watts.com

Canada: T: (888) 208-8927 • F: (888) 479-2887 • Watts.ca

Latin America: T: (52) 55-4122-0138 • Watts.com