

DETAIL C201
N.T.S.

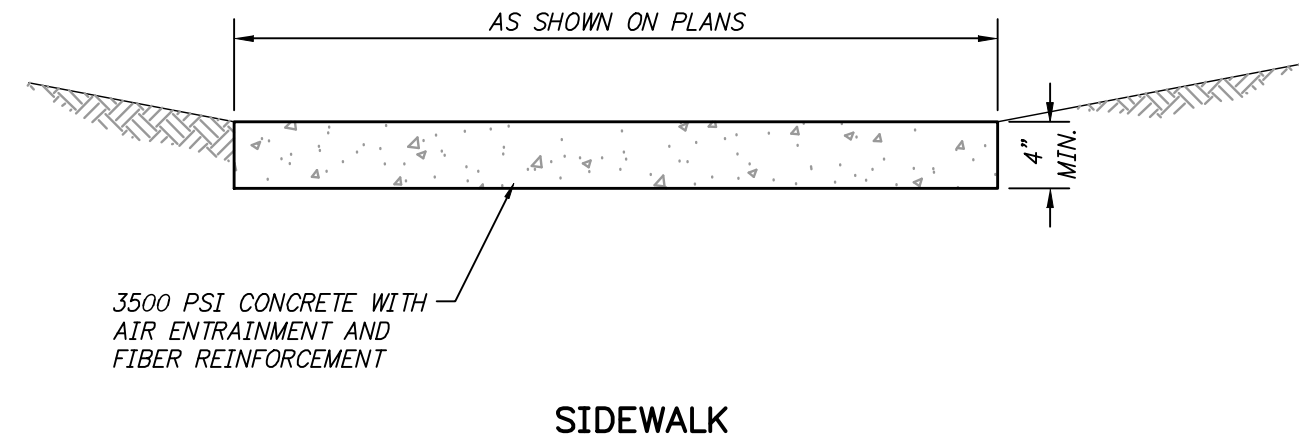

DETAIL C202
N.T.S.

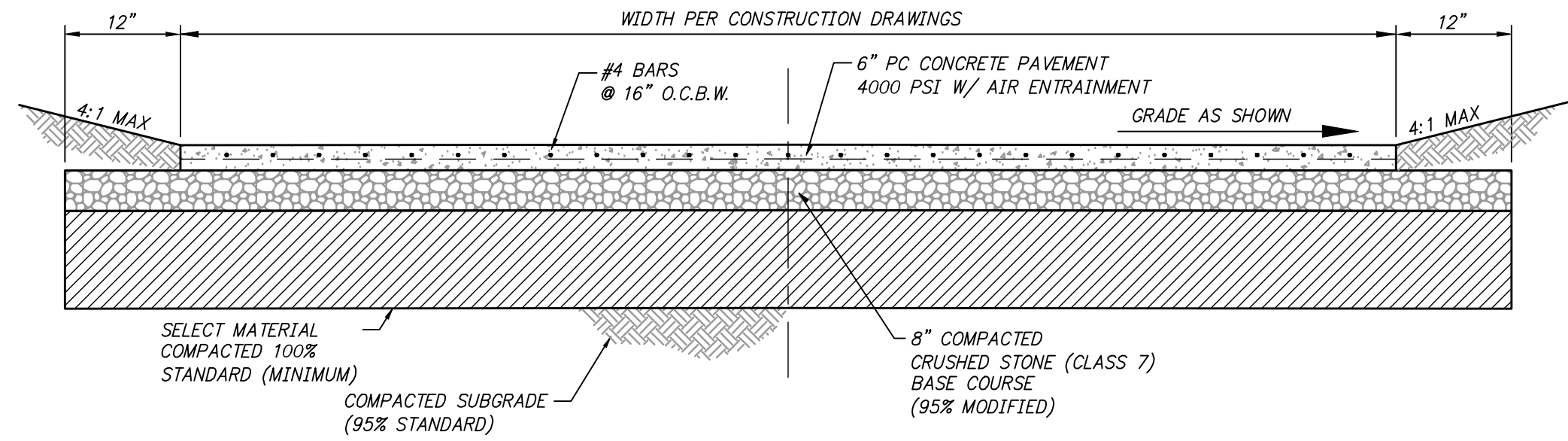

DETAIL C203
N.T.S.

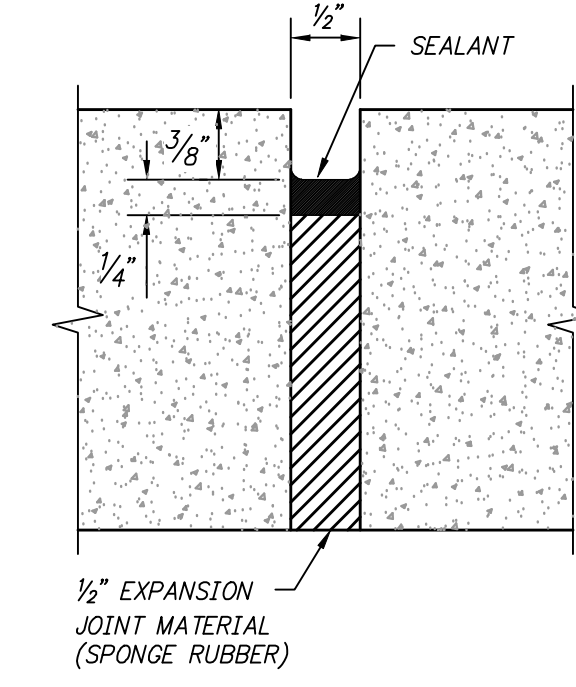

DETAIL C204
N.T.S.

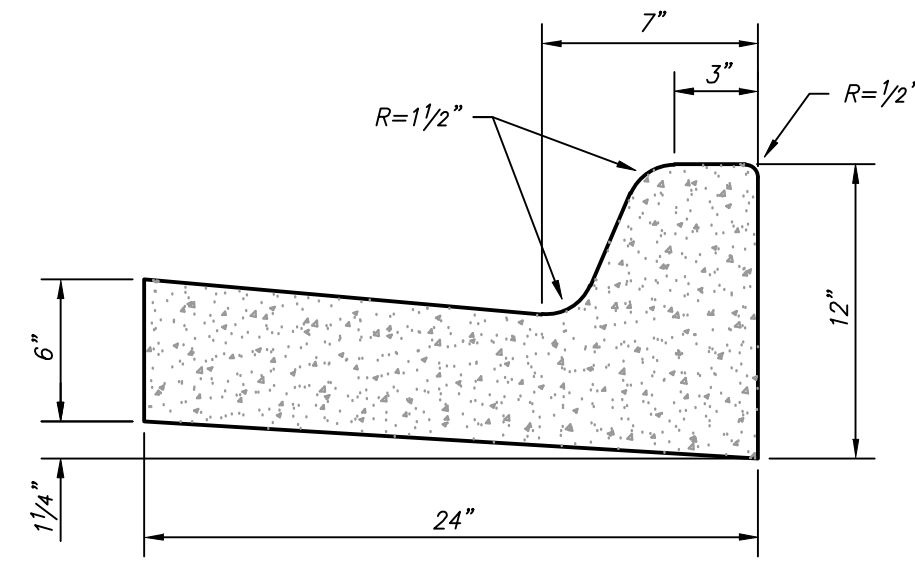

SECTION C205
N.T.S.

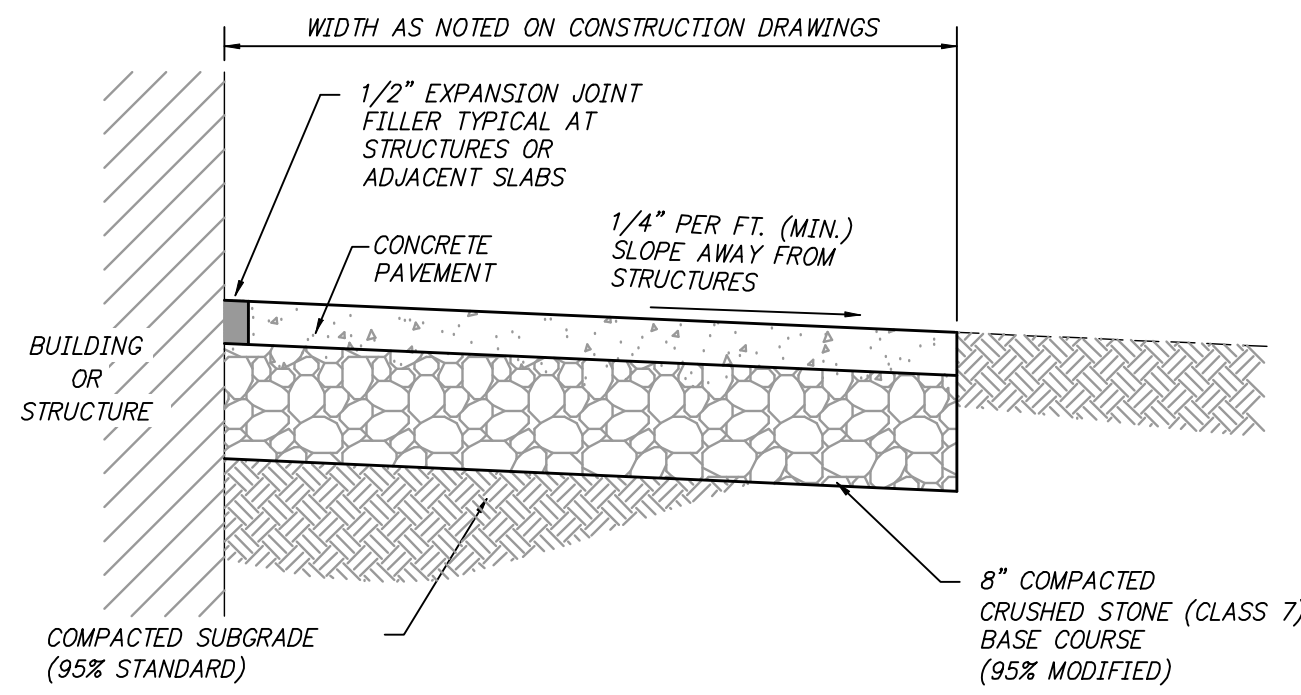

DETAIL C206
N.T.S.

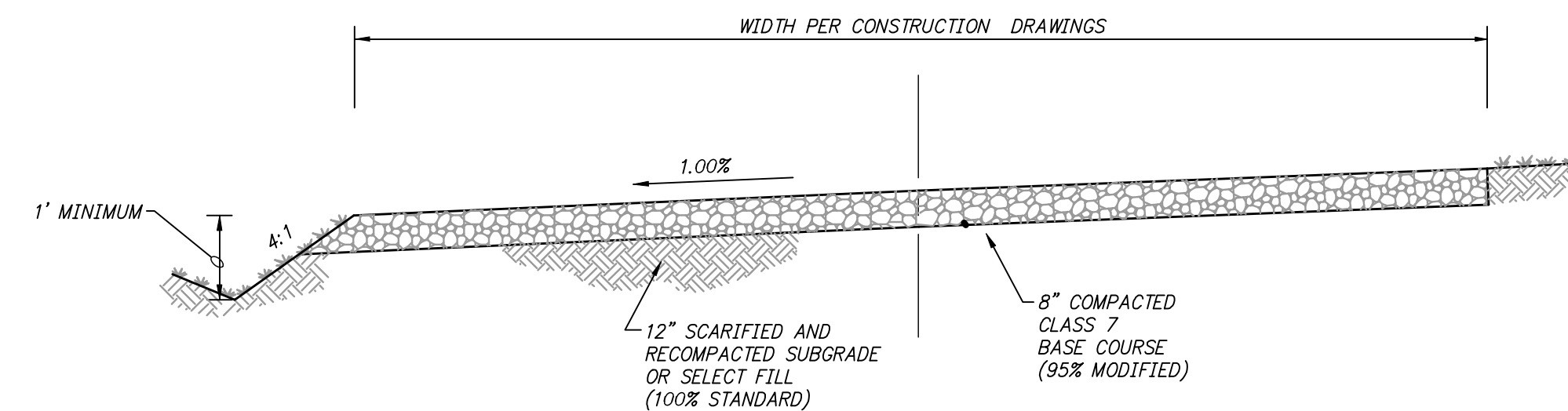

DETAIL C207
N.T.S.

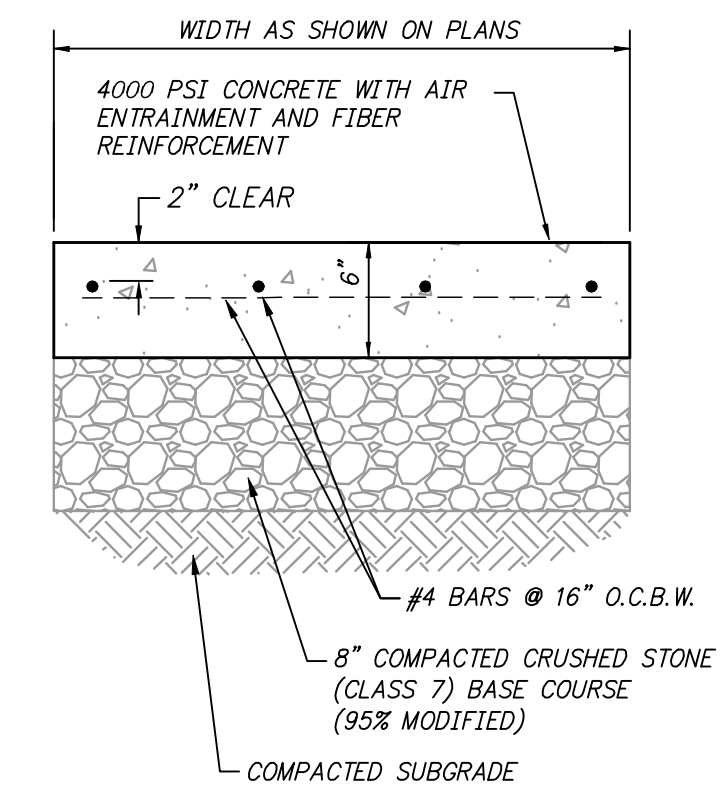

DETAIL C208
N.T.S.

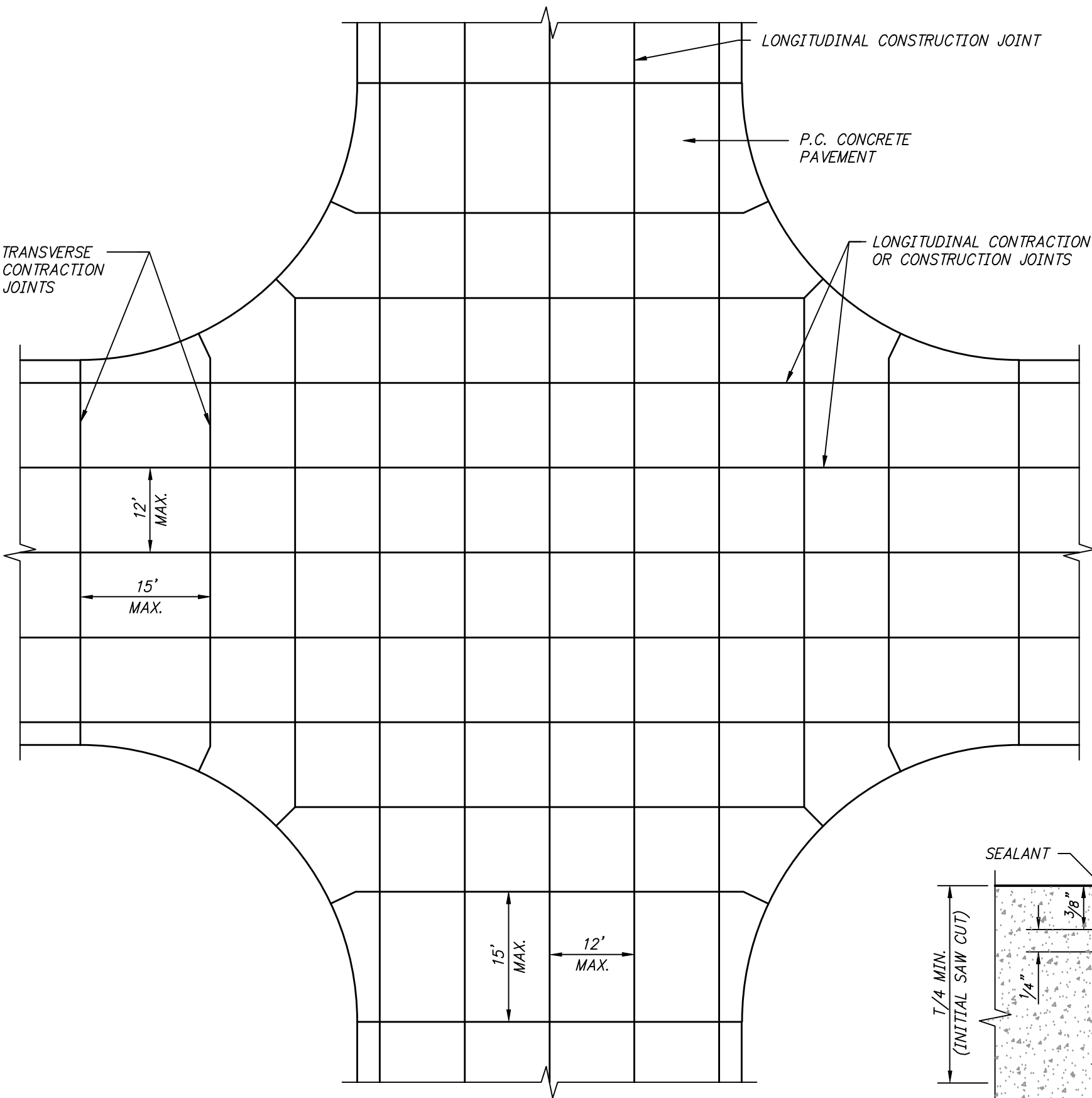

DETAIL C209
N.T.S.

NOTES:

1. JOINTS SHALL BE UNIFORM AND NOT DEVIATE MORE THAN 1/2" FROM THE PLANNED ALIGNMENT WITHIN ANY 24 FOOT SEGMENT.
2. TRANSVERSE CONSTRUCTION JOINT SHALL NOT BE CONSTRUCTED WITHIN 10 FEET OF AN EXPANSION JOINT, CONTRACTION JOINT, OR PLACE OF WEAKNESS.
3. DOWEL AND TIE BARS SHALL BE ALIGNED VERTICALLY AND HORIZONTALLY WITHIN 3 DEGREES OF TRUE ALIGNMENT IN ALL DIRECTIONS, AND PROVIDE A MINIMUM EMBEDMENT LENGTH OF 6 INCHES ON EITHER SIDE OF THE JOINT.
4. SPECIAL ATTENTION SHALL BE GIVEN TO JOINTS AROUND MANHOLES AND WATER VALVES AS DIRECTED BY THE ENGINEER.
5. WHENEVER POSSIBLE, INTERSECTION OF JOINTS SHALL BE AT 90°, BUT NOT LESS THAN 60° OR GREATER THAN 140°. OFFSETTING OF JOINTS SHALL NOT BE ALLOWED.
6. CONCRETE PAVEMENT PLACED ALONG PROPOSED CURB AND GUTTER SHALL HAVE A LONGITUDINAL CONSTRUCTION JOINT IF CURB IS NOT PLACED INTEGRALLY WITH PAVEMENT.
7. SUBMIT A JOINTING PLAN FOR ENGINEER'S APPROVAL PRIOR TO COMMENCING WORK.

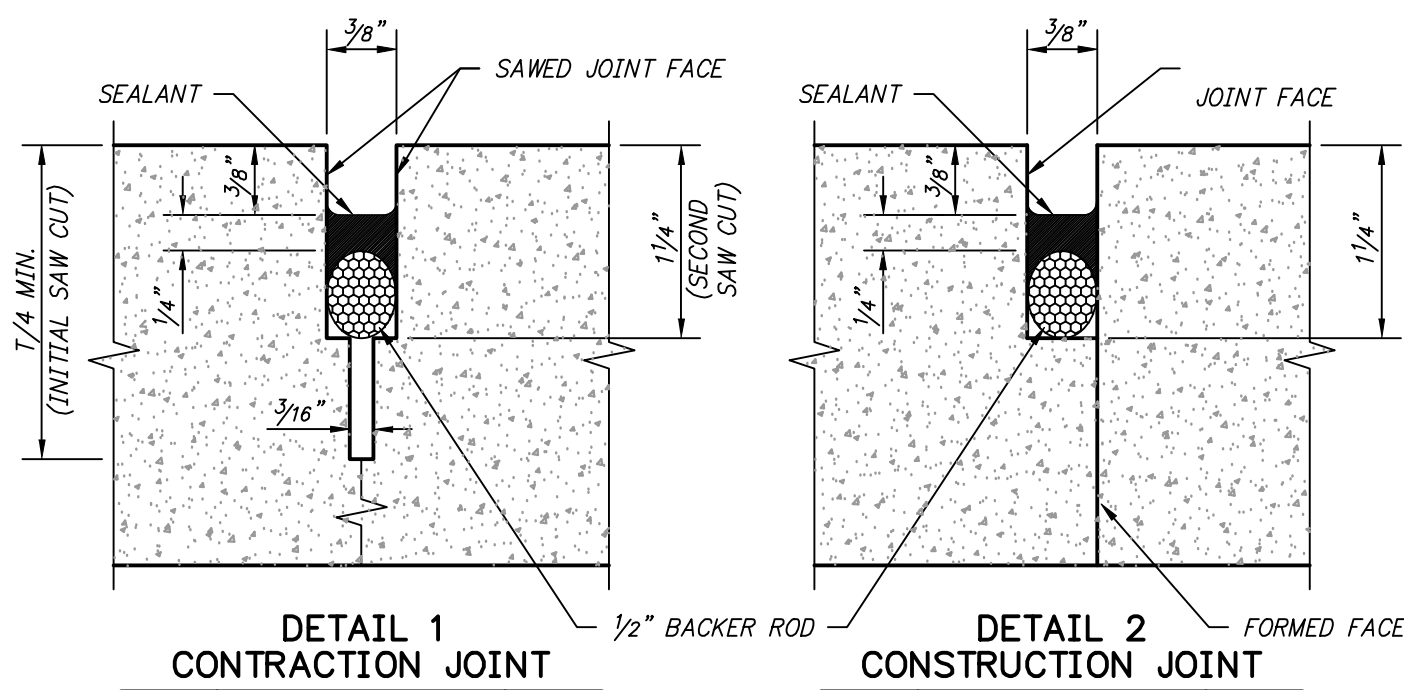

DETAIL 1 CONTRACTION JOINT
DETAIL 2 CONSTRUCTION JOINT

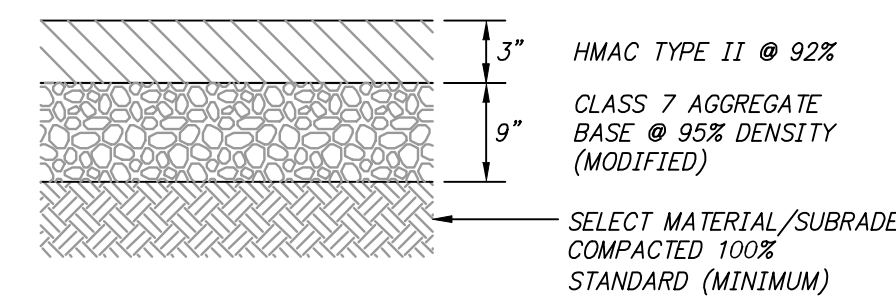

DETAIL C210
N.T.S.

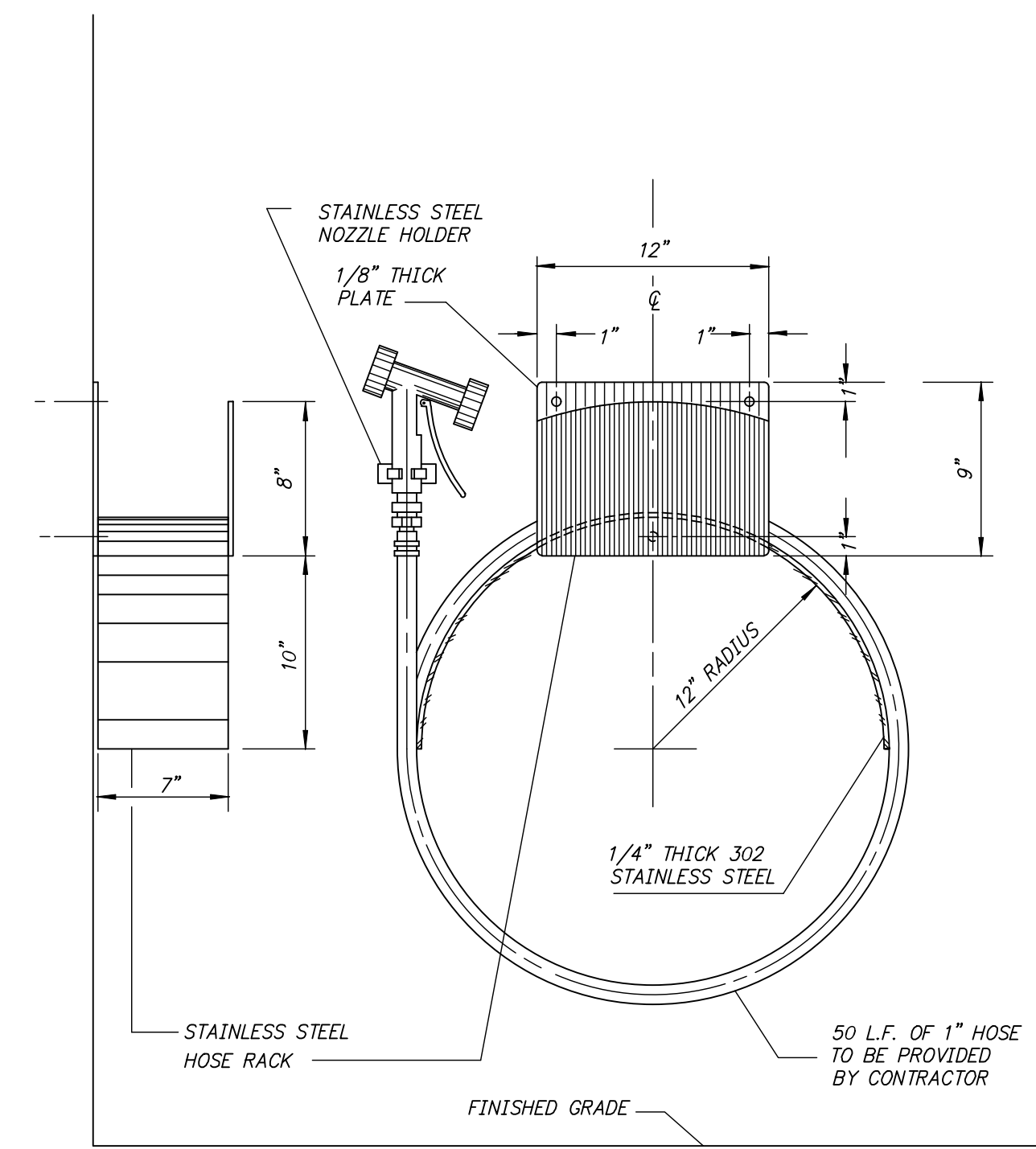

DETAIL C211
N.T.S.

Z:\20\2020043 ROGERS SOLIDS HANDLING IMPROVEMENTS, PH. 2\DRAWINGS\CONSTRUCTION DRAWINGS\WIP\CZ-02.DWG. 8/26/2024 11:10 AM. MATT WEIR. LAYOUT

ONE INCH AT FULL SIZE IF NOT ONE INCH SCALE ACCORDINGLY

DATE	REVISION



HAWKINS WEIR ENGINEERS, INC.
BLACK & VEATCH

ROGERS, ARKANSAS
ROGERS POLLUTION CONTROL FACILITY (PCF)
SOLIDS HANDLING IMPROVEMENTS, PHASE II
CIVIL DETAILS II
FOR: ROGERS WATER UTILITIES

DATE: AUGUST 2024
SCALE: AS SHOWN
DESIGNED BY: JDS
DRAWN BY: MAW
HWEI NO.: 2020043
FILENAME: CZ-02

SHEET NO. CZ-2