

Z:\20\2020043 ROGERS SOLIDS HANDLING IMPROVEMENTS, PH. 2\DRAWINGS\CONSTRUCTION DRAWINGS\WMP\C-02.DWG, 8/26/2024 11:05 AM, MATT WEIR, LAYOUT

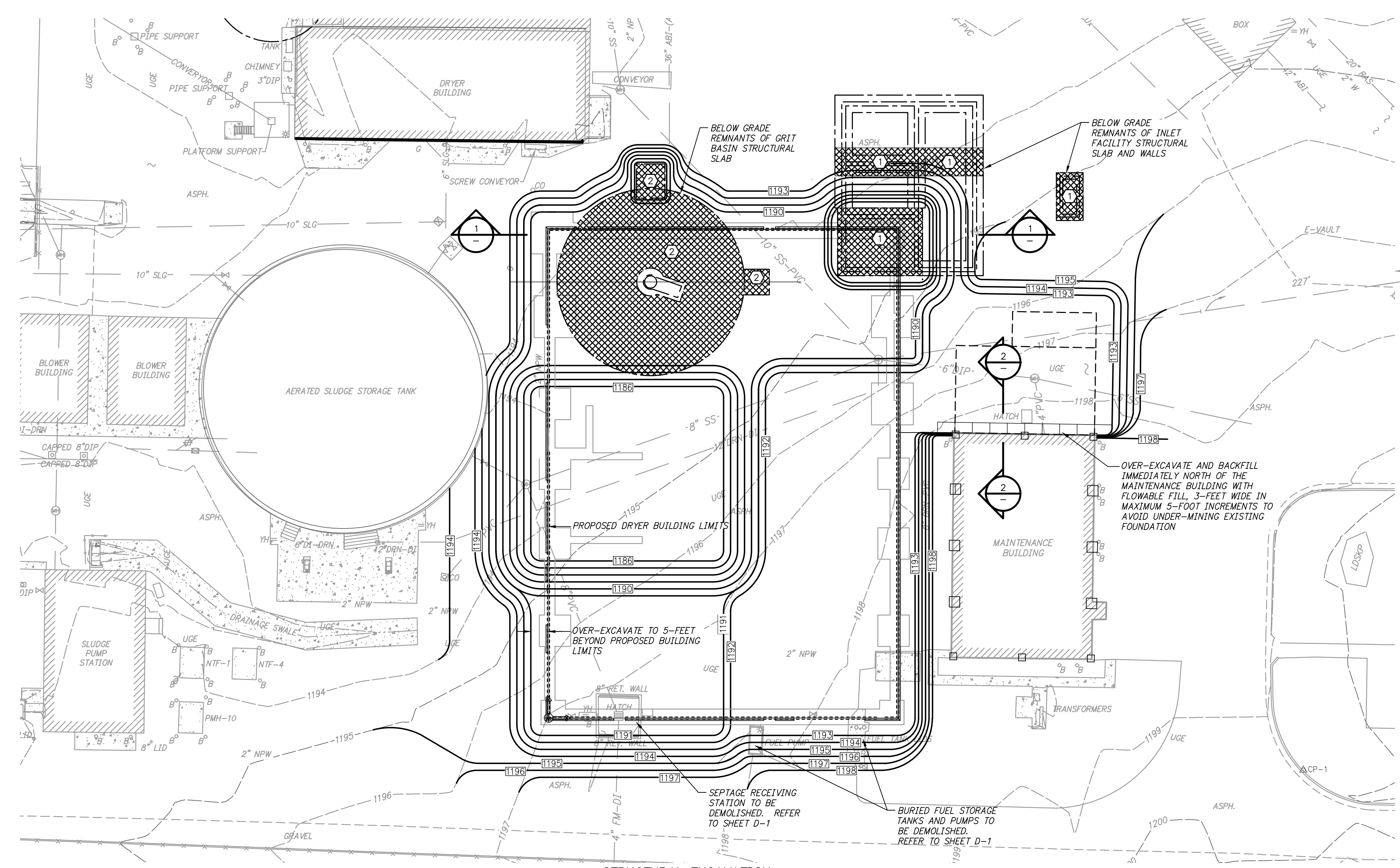

**STRUCTURAL EXCAVATION  
SITE PLAN  
DETAIL**  
1"=20'

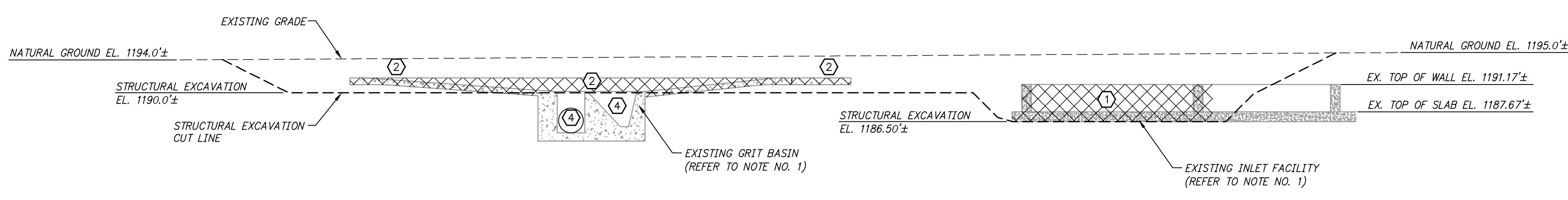

**STRUCTURAL EXCAVATION  
SECTION**  
1"=10'

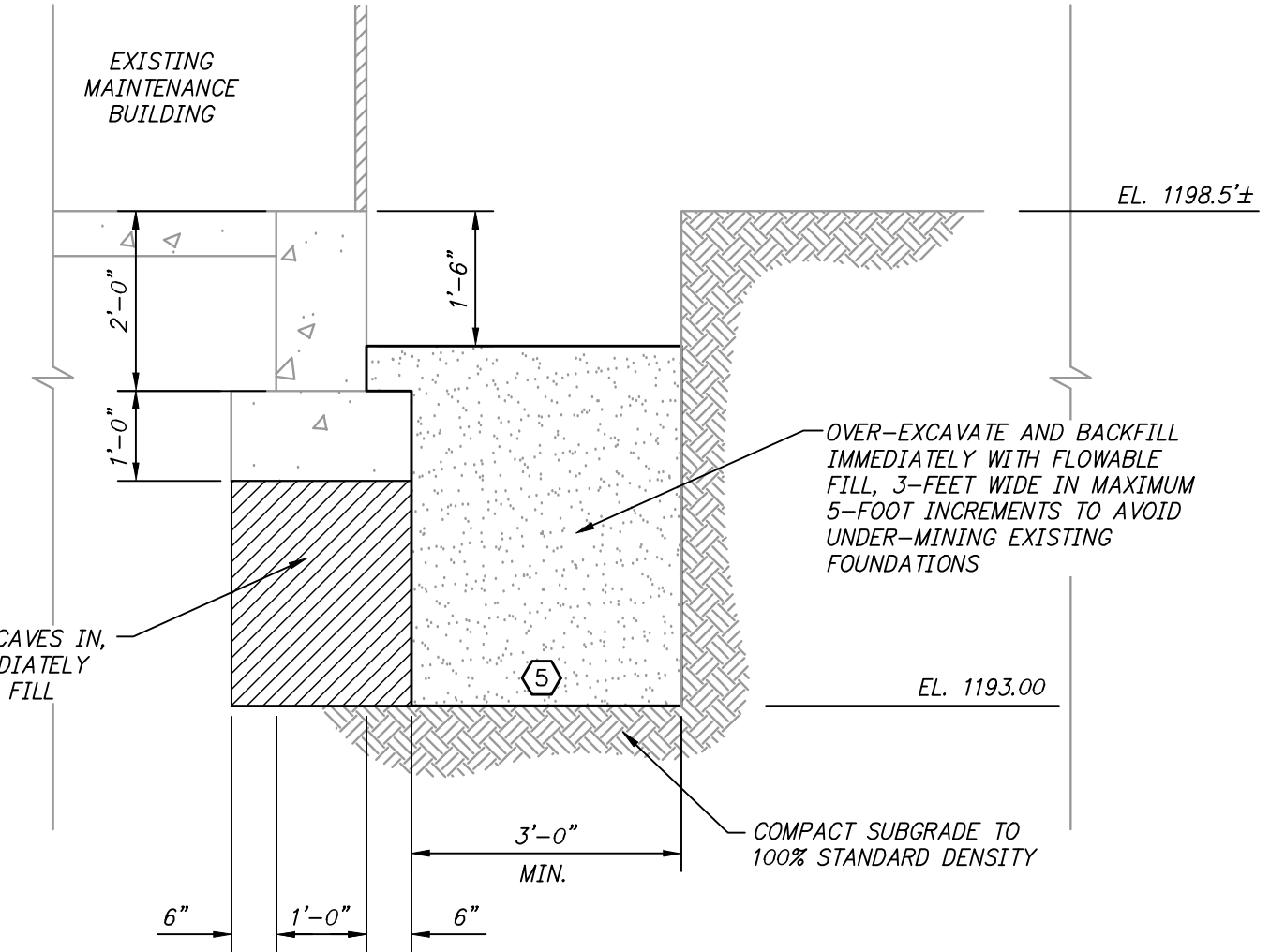

**STRUCTURAL EXCAVATION  
SECTION**  
2  
N.T.S.

**NOTES:**

1. THE PARTIALLY DEMOLISHED AND ABANDONED GRIT BASIN AND INLET FACILITY LOCATIONS ARE BASED ON RECORD DRAWINGS AND MAY NOT BE IN THE EXACT LOCATION SHOWN.
2. CONTRACTOR SHALL EXCAVATE TO THE ELEVATIONS SHOWN AND TO AN EXTENT 5-FOOT BEYOND THE PROPOSED BUILDING LIMITS.
3. REFER TO ROGERS WATER UTILITIES WASTEWATER TREATMENT PLANT EXPANSION PLANS DATED MARCH 8, 2007 FOR ADDITIONAL DETAIL REGARDING THE REMAINING BELOW GRADE INLET FACILITY AND GRIT BASIN STRUCTURES. THESE RECORD DRAWINGS ARE AVAILABLE FROM THE OWNER.

**KEYED NOTES:**

- 1 CONTRACTOR SHALL COMPLETELY DEMOLISH, REMOVE, AND DISPOSE OF THE REMAINING WALLS AND FOUNDATION OF THE INLET FACILITY TO THE EXTENTS SHOWN.
- 2 CONTRACTOR SHALL COMPLETELY DEMOLISH, REMOVE, AND DISPOSE OF THE REMAINING CONCRETE SLAB OF THE GRIT BASIN TO THE EXTENTS SHOWN ON THE DRAWING.
- 3 CONTRACTOR SHALL COORDINATE WITH GEOTECHNICAL ENGINEER, GTS, INC., TO INSPECT THE SUBGRADE PRIOR TO PLACING THE BRIDGE LIFT. CONTRACTOR SHALL BE RESPONSIBLE FOR PAYING GEOTECHNICAL ENGINEER FOR THIS SUBGRADE INSPECTION.
- 4 CONTRACTOR SHALL FILL THE SLUDGE SUMPS AND CENTER PIER OF THE GRIT BASIN WITH CONCRETE.
- 5 CONTRACTOR SHALL COORDINATE WITH GEOTECHNICAL ENGINEER, GTS, INC., TO INSPECT THE OVER-EXCAVATION AND BACKFILL WITH FLOWABLE FILL. THIS 3-FOOT WIDE TRENCH ALONG THE LIMITS OF THE MAINTENANCE BUILDING FOUNDATION. OVER-EXCAVATION SHALL BE PERFORMED IN 5-FOOT SEGMENTS, MAXIMUM. CONTRACTOR SHALL BE RESPONSIBLE FOR PAYING GEOTECHNICAL ENGINEER FOR THESE INSPECTIONS.

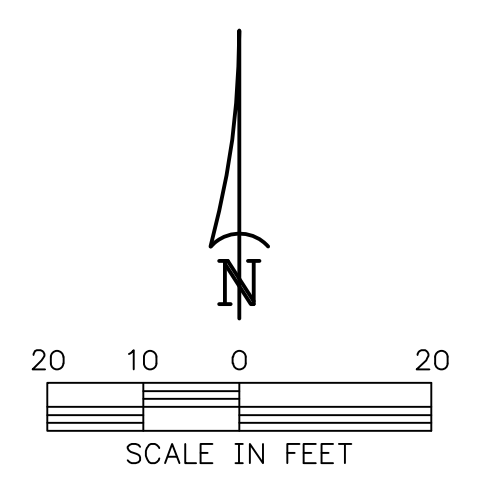

ONE INCH AT FULL SIZE IF NOT ONE INCH SCALE ACCORDINGLY

DATE	REVISION



**HAWKINS WEIR ENGINEERS, INC.**  
**BLACK & VEATCH**

ROGERS, ARKANSAS  
 ROGERS POLLUTION CONTROL FACILITY (PCF) SOLIDS HANDLING IMPROVEMENTS, PHASE II  
 STRUCTURAL EXCAVATION PLAN  
 FOR: ROGERS WATER UTILITIES

DATE: AUGUST 2024  
 SCALE: 1"=20'  
 DESIGNED BY: BDP  
 DRAWN BY: JFN  
 HWEL NO.: 2020043  
 FILENAME: C-02

SHEET NO.  
**C-2**