

- NOTES:**
- CONTRACTOR TO ASCERTAIN LOCATION AND DEPTH OF ALL UTILITIES PRIOR TO EXCAVATION AND BE RESPONSIBLE FOR ANY DAMAGE RESULTING FROM PLANTING OPERATIONS.
 - ALL LANDSCAPE BEDS ARE TO BE MULCHED AFTER PLANTING WITH A LAYER OF FINELY SHREDDED MULCH TO A THICKNESS OF 75 COMPACTED.
 - ALL LANDSCAPE BEDS ARE TO BE PREPARED WITH A 10-10-10 SLOW RELEASE FERTILIZER (OSMOCOTE OR EQUIVALENT) TILLED IN TO A DEPTH OF 150 AS SPECIFIED.
 - ALL LANDSCAPE BEDS ARE TO BE PREPARED WITH A 12:2 RATIO OF TOPSOIL TO COMPOST MATERIAL OVER EXCAVATED, (EXISTING SOILS ARE TO BE REMOVED.) ALL SOD AREAS ARE TO RECEIVE 100 OF TOPSOIL.
 - ALL LANDSCAPE BEDS ARE TO BE BERMED AT 150-200 HIGHER AT CENTER OF BED THAN AT THE EDGES TO PROVIDE GOOD DRAINAGE.
 - ALL LANDSCAPE BEDS ARE TO DRAIN EXCESS WATER AWAY FROM BUILDINGS.
 - ALL LANDSCAPE BEDS THAT ADJUT SODDED AREAS ARE TO BE BORDERED BY STEEL EDGING. STEEL EDGING SHALL PROTRUDE APPROX. 50 ABOVE FINISH GRADE.
 - FINISH GRADE FOR PLANTING BEDS SHALL BE 25 BELOW THE TOP OF ADJACENT PAVEMENT, CURBS, AND STEEL EDGING TO ACCOMMODATE MULCH UNLESS OTHERWISE NOTED.
 - ALL AREAS WITHIN THE LIMITS OF CONSTRUCTION NOT DESIGNATED AS PAVING OR PLANTING BEDS ARE TO BE PLANTED WITH IMPROVED U-3 BERMUDA SOD.
 - ALL DECIDUOUS LANDSCAPE TREES ARE TO BE PRUNED SO THAT A MINIMUM 1.25 GAP EXISTS BETWEEN THE GROUND AND THE LOWEST BRANCHES OF THE TREE.
 - NO SUBSTITUTIONS WILL BE ALLOWED WITHOUT APPROVAL BY THE CONTRACTING OFFICER.
 - SELECTION AND PLACEMENT OF PLANT MATERIALS WITHIN 10 OF THE BUILDING SHALL NOT ALLOW FOR CONCEALMENT FROM OBSERVATION OF EXPLOSIVE DEVICES 150MM GREATER IN HEIGHT
 - EROSION CONTROL DEVICES MAY BE REMOVED AFTER THEY HAVE SERVED THEIR USEFUL PURPOSE BUT NOT BEFORE THE UPSLOPE AREA HAS BEEN PERMANENTLY STABILIZED.

PLANT SPACING IS TO BE AS SET IN PLANT LEGEND

PREPARE BED AS PER WRITTEN SPECIFICATION

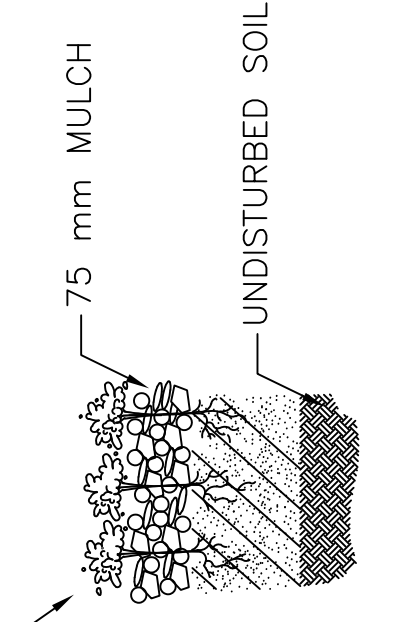

2 GROUNDCOVER DETAIL
L101|L101 SCALE: N.T.S.

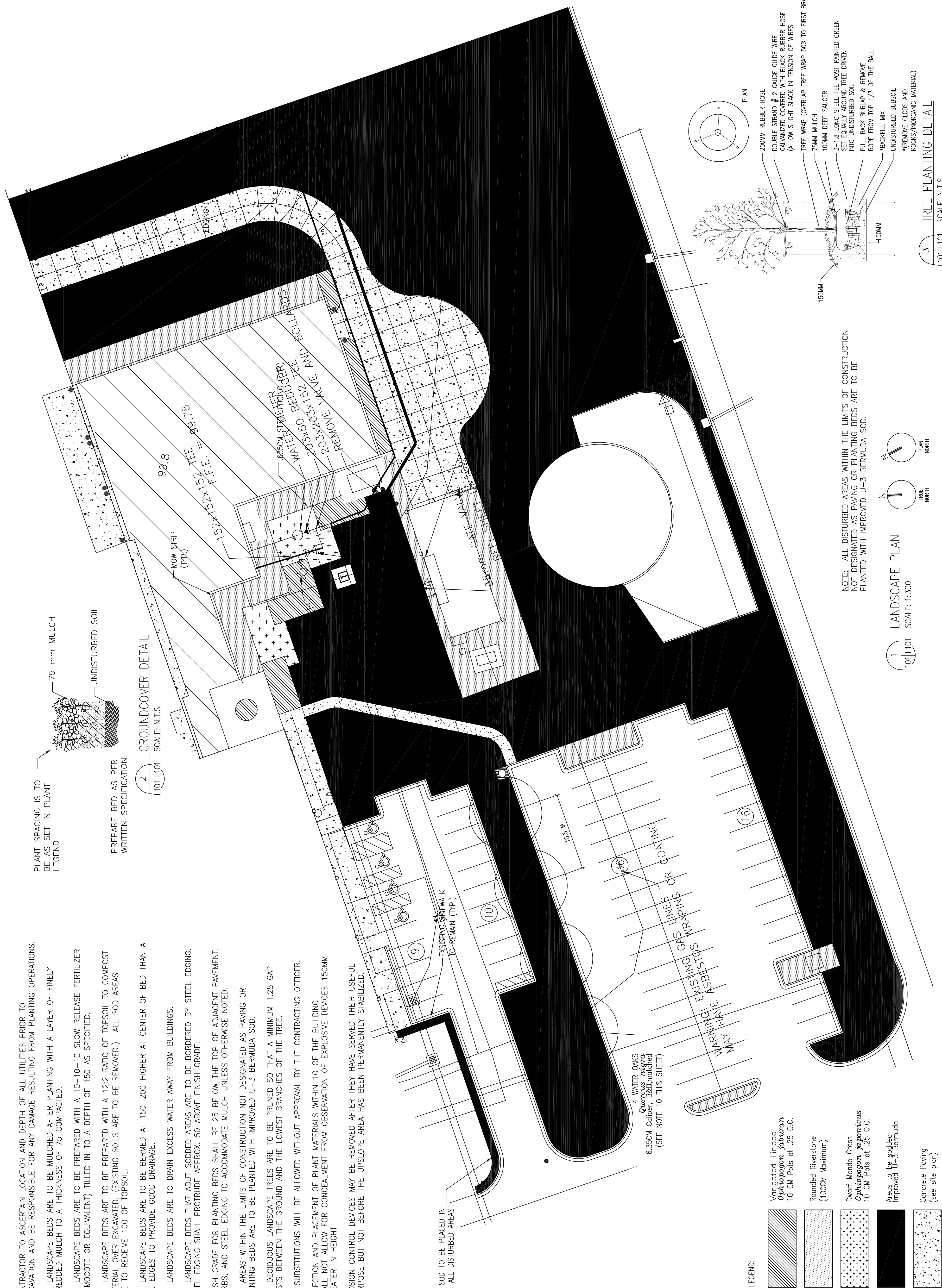

LEGEND:

	Variegated Liriope <i>Ophiopogon variegatus</i> 10 CM Pots at .25 O.C.
	Rounded Riverstone (100CM Maximum)
	Dwarf Mondo Grass <i>Ophiopogon japonicus</i> 10 CM Pots at .25 O.C.
	Areas to be sodded Improved U-3 Bermuda
	Concrete Paving (see site plan)

NOTE: ALL DISTURBED AREAS WITHIN THE LIMITS OF CONSTRUCTION NOT DESIGNATED AS PAVING OR PLANTING BEDS ARE TO BE PLANTED WITH IMPROVED U-3 BERMUDA SOD.

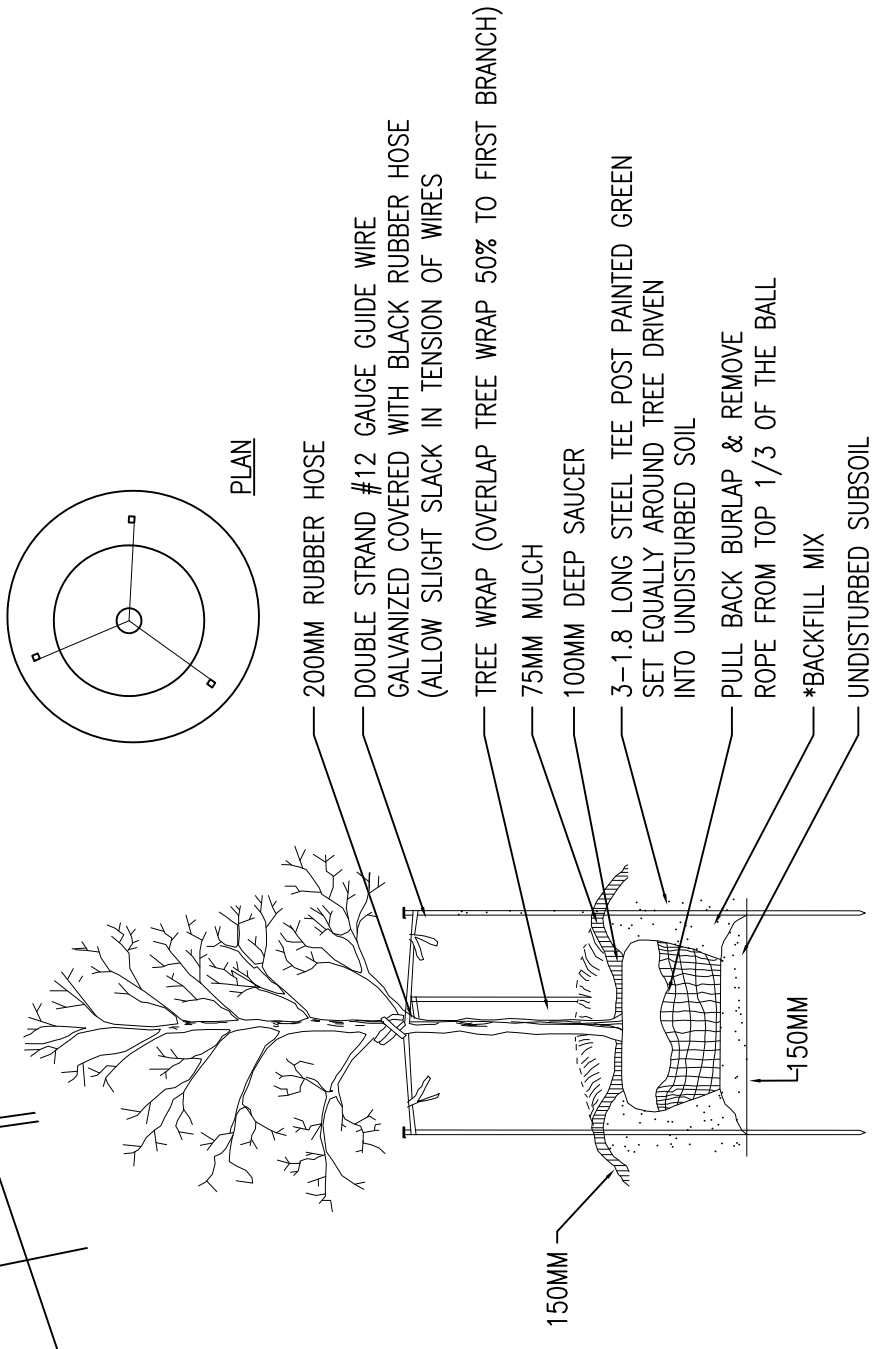
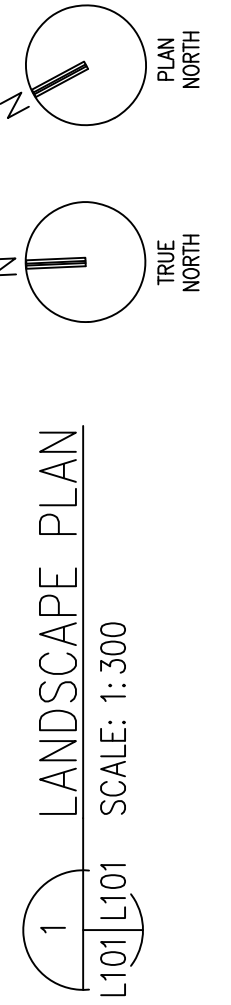

Rev	Description	Date	Appr.	Mark	Direction

Designed by:	HMT
Drawn by:	HMT
Reviewed by:	
Checked by:	
Dwg. Code:	
File Name:	151001L-101
Submitted by:	Alkins Benham, Inc.
Contract No.:	DMC01-03-R-0021
Contract Date:	

DEPARTMENT OF THE ARMY
 LITTLE ROCK DISTRICT
 LITTLE ROCK, ARKANSAS
 (918) 492-1600
 www.alkinsbenham.com
 a member of the Alkins group of companies

ADAL C-130U AIRCRAFT FUSELAGE TRAINER
 LRAF, LITTLE ROCK AR
 Project No. MWK 043005
 LANDSCAPE PLAN AND DETAILS

Sheet Reference Number:
 L-101
 Sheet 17 of 91