

LITTLE ROCK A.F.B.
ARKANSAS

FPM

804 West Curtis Drive, Suite H
Midwest City, OK 73110
phone: 405.869.9212
fax: 405.869.9222
www.fpm-group.com

RECORD
DRAWINGS
MARCH 2007

KEYED NOTES:

- EXISTING LAVATORY, FAUCET, DRAIN TRAP AND ALL EXPOSED PIPING SHALL BE REPLACED WITH NEW.
SHUT-OFF VALVES FOR 1/2" CW & HW SHALL BE INSTALLED BELOW LAVATORY
- EXISTING WATER CLOSET, FLUSH VALVE AND ALL EXPOSED PIPING SHALL BE REPLACED WITH NEW.
- EXISTING MOP BASIN, FAUCET, DRAIN TRAP AND ALL EXPOSED PIPING SHALL BE REPLACED WITH NEW.
- PROVIDE NEW LAVATORY, FAUCET AND DRAIN TRAP. CONNECT TO EXISTING CW, HW, SANITARY AND VENT PIPING AS INDICATED ON THE ENLARGED PLAN. LOCATION AND SIZE OF ALL EXISTING PIPING SHALL BE VERIFIED IN THE FIELD.
- PROVIDE NEW WATER CLOSET AND FLUSH VALVE. CONNECT TO EXISTING CW, SANITARY AND VENT PIPING AS INDICATED ON THE ENLARGED PLAN. LOCATION AND SIZE OF ALL EXISTING PIPING SHALL BE VERIFIED IN THE FIELD.
- PROVIDE NEW URINAL AND FLUSH VALVE. CONNECT TO EXISTING CW, SANITARY AND VENT PIPING AS INDICATED ON THE ENLARGED PLAN. LOCATION AND SIZE OF ALL EXISTING PIPING SHALL BE VERIFIED IN THE FIELD.
- EXISTING WATER FOUNTAIN AND ALL EXPOSED PIPING SHALL BE REPLACED WITH NEW.
- EXISTING SINK, FAUCET, DRAIN TRAP AND ALL EXPOSED PIPING SHALL BE REPLACED WITH NEW.
PROVIDE EYE/FACE WASH ON THE COUNTER (CLOSE TO SINK) AND CONNECT TO 1/2" CW WITH SHUT-OFF VALVE.
SHUT-OFF VALVES FOR 1/2" CW & HW SHALL BE INSTALLED BELOW SINK.
- PROVIDE NEW SINK, FAUCET AND DRAIN TRAP. CONNECT TO EXISTING CW, HW, SANITARY AND VENT PIPING AS INDICATED ON THE ENLARGED PLAN. LOCATION AND SIZE OF ALL EXISTING PIPING SHALL BE VERIFIED IN THE FIELD.
- PROVIDE NEW MOP BASIN, FAUCET AND DRAIN TRAP. CONNECT TO EXISTING CW, HW, SANITARY AND VENT PIPING AS INDICATED ON THE ENLARGED PLAN. LOCATION AND SIZE OF ALL EXISTING PIPING SHALL BE VERIFIED IN THE FIELD.
- EXISTING MEDICAL GAS (OXYGEN) CONTROL VALVE SHALL BE REPLACED BY NEW RECESSED TYPE.
- EXISTING SINK, FAUCET, DRAIN TRAP AND ALL EXPOSED PIPING SHALL BE REPLACED WITH NEW.
SHUT-OFF VALVES FOR 1/2" CW & HW SHALL BE INSTALLED BELOW SINK.
- INSTALL NEW OXYGEN OUTLET AND CONNECT TO OXYGEN GAS CONTROL VALVE.
- INSTALL NEW OXYGEN MEDICAL GAS CONTROL VALVE RECESSED TYPE AND CONNECT TO EXISTING OXYGEN MAIN PIPE. LOCATION OF OXYGEN MAIN PIPE SHALL BE VERIFIED IN THE FIELD.
- REMOVE EXISTING MEDICAL GAS (OXYGEN) CONTROL VALVE AND CAP EXISTING PIPING BACK TO MAIN ABOVE CEILING.

GENERAL NOTES

- ALL LAVATORY P-TRAPS AND ANGLE VALVE ASSEMBLIES SHALL BE COVERED WITH WHITE MOLDED ANTI MICROBIAL TRIGER, INC. OR EQUAL UNDER SINK PIPE COVERS.
COVERS SHALL HAVE:
- INTERNAL TRIM FEATURE FOR SQUARE, CLEAN TRIMMING
- INTERNAL RIBS
- BUILT-IN CONCEALED FASTENERS.
(DO NOT USE CABLE-TIES FASTENER)

PLUMBING FIXTURE SCHEDULE

TAG	JSN	NSN	DESCRIPTION	PLUMBING CONNECTIONS				MOUNTING TYPE	F.U. WASTE/WATER	FURNISHED BY
				CW	HW	SAN	V			
WC-1	P9050	4510	TOILET, WALL HUNG, SIPHON JET, 1.6 GALLONS PER FLUSH, TOP SPUD FLUSH VALVE, SEAT W/ OPEN FRONT & CHECK HINGE	1"	-	4"	2"	WALL	3 - PRIVATE 4 - PUBLIC	CONTRACTOR
UR-1	P8150	4510	URINAL, WALL HUNG, SIPHON JET, FLUSHING 1 GALLON PER FLUSH VITREOUS CHINA, FLUSH VALVE	3/4"	-	2"	1-1/2"	WALL	2	CONTRACTOR
LAV-1	P3100	4510	LAVATORY, VITREOUS CHINA, W/CHICAGO FAUCET NO. 895-317GN2FCCP 1.60 GPM MAX FLOW RATE @ 60 PSI OR APPROVED EQUAL FAUCET AND TRAP	1/2"	1/2"	1-1/4"	1-1/2"	WALL	1	CONTRACTOR
SK-1	CS010	6530	CORIAN MODEL 809, 10-7/16"x12-7/16"x6-1/2", CHICAGO FAUCET NO. 201-AGNBAE3-317CP PRESSURE COMPENSATING 2.2 GPM OR APPROVED EQUAL, 8" CENTERS, 8" SPOUT, 4" BLADE HANDLE, LAMINAR FLOW	1/2"	1/2"	1 1/2"	1-1/2"	COUNTERTOP	2	CONTRACTOR
SK-2	CS200	6530	CORIAN MODEL 871, 21"x15-3/4"x7-3/8", CHICAGO FAUCET NO. 201-AGNBAE3-317CP PRESSURE COMPENSATING 2.2 GPM OR APPROVED EQUAL 8" CENTERS, 8" SPOUT, LAMINAR FLOW, 4" BLADE HANDLE.	1/2"	1/2"	1-1/2"	1-1/2"	COUNTERTOP	2	CONTRACTOR
SK-3	CS150		CORIAN MODEL 859, 10-7/16"x12-7/16"x6-1/2", CHICAGO FAUCET NO. 201-AGNBAE3-317CP PRESSURE COMPENSATING 2.2 GPM OR APPROVED EQUAL, 8" CENTERS, 8" SPOUT, LAMINAR FLOW, 4" BLADE HANDLE.	1/2"	1/2"	1-1/2"	1-1/2"	COUNTERTOP	2	CONTRACTOR
SK-4	CS140		CORIAN MODEL 805, 10-7/16"x12-7/16"x6-1/2", CHICAGO FAUCET NO. 201-AGNBAE3-317CP PRESSURE COMPENSATING 2.2 GPM OR APPROVED EQUAL, 8" CENTERS, 8" SPOUT, LAMINAR FLOW, 4" BLADE HANDLE.	1/2"	1/2"	1-1/2"	1-1/2"	COUNTERTOP	2	CONTRACTOR
EWC-1	R2201	4110	WATER FOUNTAIN, CRS, 2-LEVEL, COMBINATION HANDICAP, 2-LEVEL DISPENSER.	1/2"	-	1 1/4"	1 1/4"	WALL	1/2	CONTRACTOR
MB-1	P4700	4510	MOP BASIN, MOLDED STONE, 10x36x24	1/2"	1/2"	3"	1-1/2"	FLOOR	2	CONTRACTOR
FD-1			FLOOR DRAIN - SEE SPECS	-	-	3"	1 1/2"		2	CONTRACTOR
FCO			FLOOR CLEANOUT - SEE SPECS	-	-	-	-			CONTRACTOR
WCO			WALL CLEANOUT - SEE SPECS	-	-	-	-			CONTRACTOR
EEW			EMERGENCY EYE/FACE WASH	1/2"	-	-	-	COUNTERTOP		CONTRACTOR

1 SANITARY PLAN

SCALE: 1/8" = 1'-0"

KEYPLAN
N.T.S.

0 4' 8' 16'

SCALE

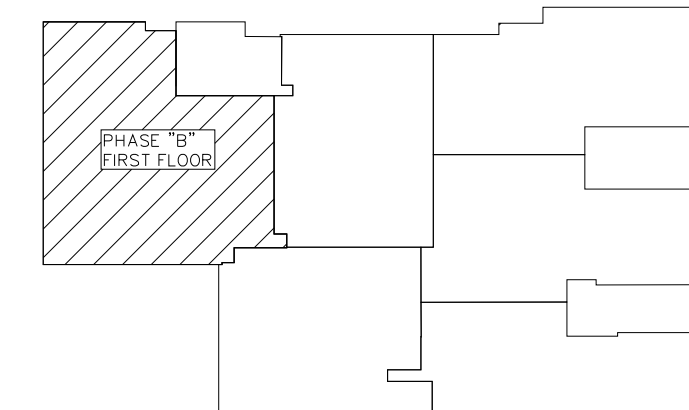
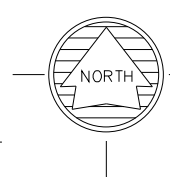

PROJECT TITLE

REPAIR MEDICAL CENTER PH B
LITTLE ROCK AFB, ARKANSAS

DRAWN BY

RJR/MJG

TECH REVIEWER

OD

DESIGNED BY

OD

DATE

1-21-08

SCALE

1/8"=1'-0"

SHEET TITLE

SANITARY PLAN
AS-BUILT

LEAD DESIGNER

AM

PROJECT NUMBER

NKAK 05-8004A

SHEET

P1.11

27 OF 39