

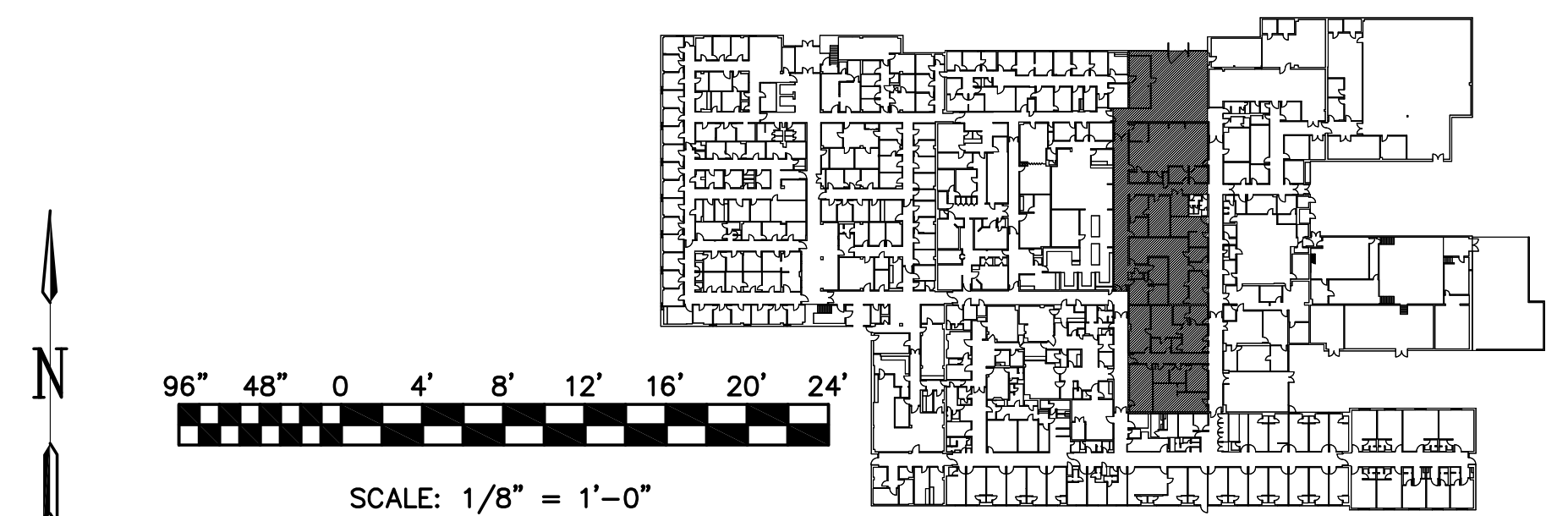

- KEYED NOTES:**
- EXISTING CONDUITS AND JUNCTION BOXES EXIST ABOVE THE LAY IN CEILING ALONG THE CORRIDOR EAST WALL. RAISE AND RELOCATE EXISTING ITEMS AS REQUIRED TO MAKE ROOM FOR NEW RECESSED INDIRECT LIGHT FIXTURES ALONG CORRIDOR.
 - INSTALL NEW FLANGE KIT FOR MOUNTING FIXTURE WITHIN GYPSUM BOARD CEILING AS INDICATED ON DRAWINGS.
 - EXTEND LIGHTING CIRCUIT TO LIGHTED SIGNAGE.
 - INSTALL NEW FIXTURE TYPE "L" 7' ABOVE FINISHED FLOOR.



2 ELECTRICAL LIGHTING INSTALLATION PARTIAL PLAN
E-202 SCALE: 1/8" = 1'-0"



1
E-202 ELECTRICAL LIGHTING INSTALLATION PARTIAL PLAN
SCALE: 1/8" = 1'-0"



LITTLE ROCK A.F.B.
ARKANSAS



1010 Battery St.
Little Rock, AR
72202

501-376-3633

www.GarverUSA.com

CROMWELL
ARCHITECTS ENGINEERS

101 SOUTH SPRING ST
LITTLE ROCK AR 72201
TELEPHONE 501-372-2900
FACSIMILE 501-372-0482

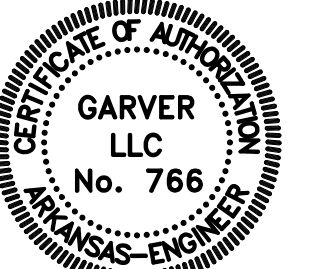
[illegible]

REPAIR & RENOVATE MED. CLINIC PH IV A
LITTLE ROCK AIR FORCE BASE
JACKSONVILLE, ARKANSAS

ELECTRICAL LIGHTING INSTALLATION PLAN

DRAWN BY MCL	LEAD DESIGNER ECF
TECH REVIEWER ECF	PROJECT NUMBER NKAK 06-8006 4A
DESIGNED BY ECF	SHEET
DATE 13 MAY 2009	E-202
SCALE AS SHOWN	
	45 OF 51