



LITTLE ROCK A.F.B.
ARKANSAS

DEMOLITION LEGEND

- EXISTING WALLS/PARTITIONS TO REMAIN
- EXISTING WALLS/PARTITIONS BEING REMOVED
- EXISTING OUTLETS AND ASSOCIATED WIRING TO REMAIN
- EXISTING OUTLETS AND ASSOCIATED WIRING TO BE REMOVED
- NEW WIRING REQUIRED TO MAINTAIN CONTINUITY OF EXISTING CIRCUITS BROKEN BY OUTLET REMOVAL

DRAWING NOTES:

- REMOVE EXISTING RECEPTACLES AND ASSOCIATED OUTLET BOXES AND WIRING, WHICH ARE LOCATED IN WALLS/PARTITIONS BEING REMOVED, AS SHOWN ON PLAN.
- PROVIDE NEW JUNCTION BOXES AND "JUMPER" WIRING TO MAINTAIN CONTINUITY OF EXISTING CIRCUITS BROKEN BY RECEPTACLE REMOVAL, WHETHER SHOWN ON PLANS OR NOT.
- THE BRANCH CIRCUIT WIRING SHOWN HAS BEEN COPIED FROM VARIOUS AS-BUILT DRAWINGS AND HAS NOT BEEN VERIFIED.

KEY NOTES

- REMOVE BOOSTER PUMP, SWITCH AND ALL ASSOCIATED WIRING BACK TO SOURCE PANEL.
- PANEL B TO BE REPLACED AND "FLIPPED" TO THE OTHER SIDE OF WALL. SEE DRAWING E1.21.
- PANEL EE9 TO BE REPLACED AND RELOCATED. SEE DRAWING E1.21. PROVIDE TEMPORARY FEED TO PANEL EE8, WHICH IS FED BY A 3P70A CKT. BKR. IN EE8, UNTIL RELOCATION IS COMPLETED.
- EXISTING X-RAY PANEL "Z" AND ADJACENT MAIN CIRCUIT BREAKER TO REMAIN.
- REMOVE EXISTING X-RAY PANEL. PRESERVE EXISTING UNDERFLOOR FEEDER AND SPARE CONDUIT FOR REROUTING TO NEW J-BOX LOCATION (SEE DWG E1.21)
- REMOVE ENCL. CKT. BKR. AND CUT FEEDER BACK, ABOVE HUNG CEILING. PRESERVE FEEDER FOR EXTENSION TO NEW CKT. BKR. (SEE E1.21)

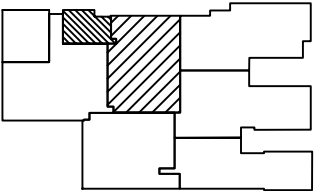

1 POWER DEMOLITION PLAN
SCALE: 1/8" = 1'-0"

PROJECT TITLE
REPAIR MEDICAL CENTER PH 3
LITTLE ROCK AFB, ARKANSAS

SHEET TITLE
POWER DEMOLITION PLAN

DRAWN BY RJR	LEAD DESIGNER KF
TECH REVIEWER KF	PROJECT NUMBER NKAK 06-8001
DESIGNED BY KF	SHEET E0.21
DATE 8-11-06	
SCALE 1/8"=1'-0"	30 OF 37