

LITTLE ROCK A.F.B.
ARKANSAS

FPM

804 West Curtis Drive, Suite H
Midwest City, OK 73110
phone: 405.869.9212
fax: 405.869.9222
www.fpm-group.com

RECORD
DRAWINGS
MARCH 2007

DEMOLITION LEGEND

- EXISTING WALLS/PARTITIONS TO REMAIN
- EXISTING WALLS/PARTITIONS BEING REMOVED
- EXISTING LIGHT FIXTURES TO BE REMOVED
- EXISTING LIGHT FIXTURES TO BE REMOVED

DRAWING NOTES:

- REMOVE ALL EXISTING LIGHT FIXTURES SHOWN ON PLAN. SELECT FIXTURE MAY BE TEMPORARILY RETAINED FOR CONSTRUCTION LIGHTING, WITH TEMPORARILY SUPPORTS ADDED (CEILING GRID IS BEING REMOVED).
- REMOVE FIXTURE "WHIPS" BACK TO FIRST JUNCTION BOX. RETAIN HOME RUN WIRING IN CONDUIT FOR CONNECTION TO NEW FIXTURES BEING INSTALLED.
- RETAIN EXISTING SWITCHES IN THE WALLS/PARTITIONS NOT BEING REMOVED, EXCEPT AS OTHERWISE NOTED ON PLAN. REMOVE SWITCH AND ASSOCIATED WIRING BACK TO FIRST JUNCTION BOX IN THE WALLS/PARTITIONS THAT ARE BEING REMOVED.

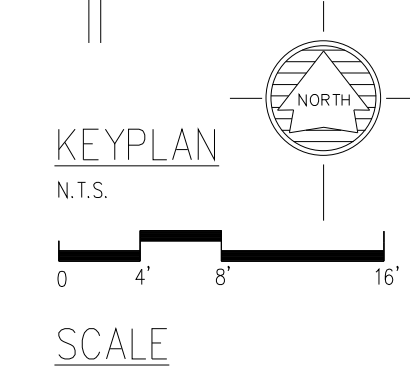
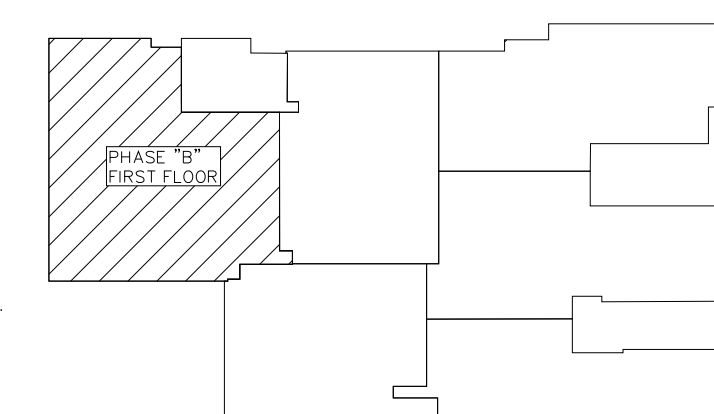
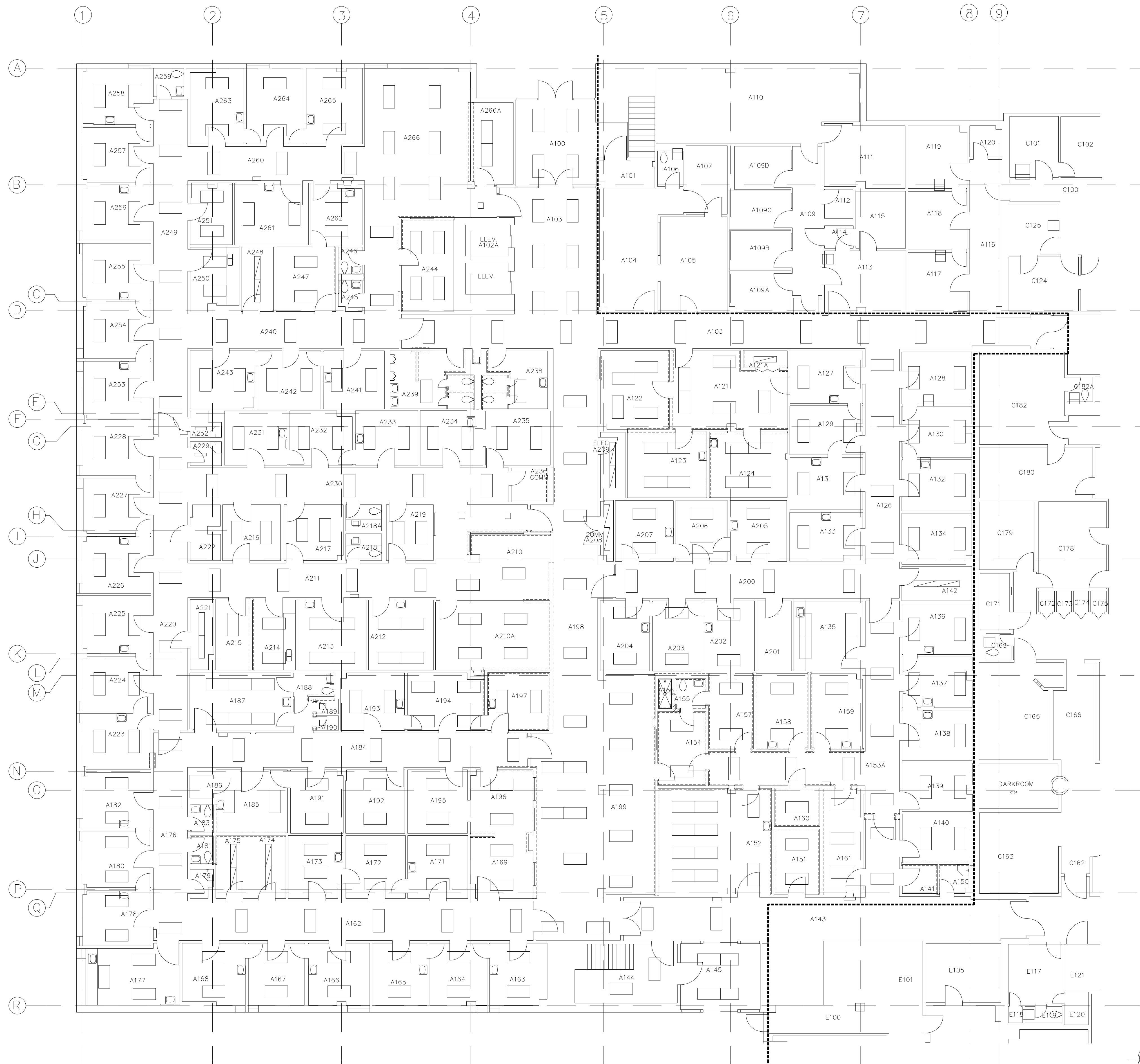

1 LIGHTING DEMOLITION PLAN
SCALE: 1/8" = 1'-0"

No.	Revision/Issue	Date	BY	APP'D

PROJECT TITLE REPAIR MEDICAL CENTER PH B LITTLE ROCK AFB, ARKANSAS		SHEET TITLE LIGHTING DEMOLITION PLAN	
DRAWN BY RJR	LEAD DESIGNER AM	DATE 1-21-08	
TECH REVIEWER KF	PROJECT NUMBER NKAK 05-8004A	SCALE 1/8"=1'-0"	
DESIGNED BY KF	SHEET E0.11	31 OF 39	