

LITTLE ROCK A.F.B.  
ARKANSAS

# FPM

804 West Curtis Drive, Suite H  
Midwest City, OK 73110  
phone: 405.869.9212  
fax: 405.869.9222  
www.fpm-group.com

RECORD  
DRAWINGS  
MARCH 2007

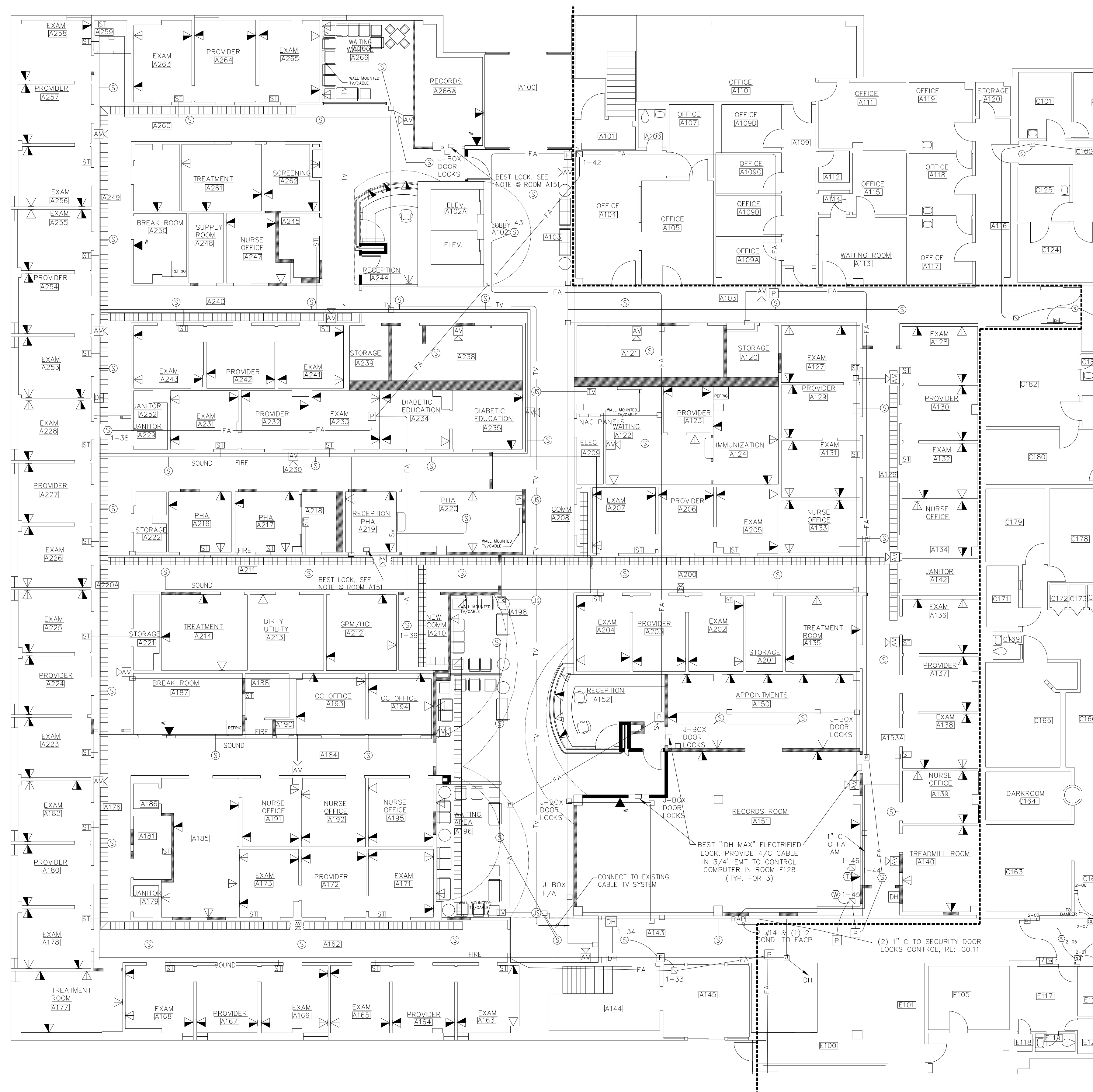

## NOTES:

1. SEE DRAWING E0.00 FOR SYMBOL LEGEND.
2. ALL COM. OUTLETS TO BE INSTALLED IN 2 1/2" DEEP, SINGLE GANG "OLD WORK" BOXES WITH 1" TYPE ENT CONDUIT STUBBED UP 6" ABOVE HUNG CEILING.
3. ALL CABLE TRAY FOR COM. WIRING TO BE CENTER SPINE TYPE OR DOUBLE TIER WALL MOUNTED TYPE, WHICHEVER IS EASIER TO WORK AROUND EXISTING OBSTRUCTIONS.
4. PROVIDE A CAT 6 CABLE WITH BLUE OUTER COVERING FROM EVERY "LAN" COM. OUTLET TO PATCH PANEL IN ROOM A210. PROVIDE A CAT 6 CABLE WHITE OUTER COVERING FROM EVERY "TEL" COM. OUTLET TO PATCH PANEL IN ROOM A208. ALL COM. WIRE TO BE ROUTED ALONG NEW CABLE TRAY INASMUCH AS POSSIBLE.
5. ALL P.A. SPEAKERS TO BE WIRED TO EXISTING P.A. AMPLIFIER. PROVIDE LOCAL VOLUME CONTROLS ONLY AS SHOWN ON PLANS.
6. SEE DETAIL 2 ON DWG E2.01 FOR EXACT LOCATION OF CABLE TV OUTLETS.
7. FIRE ALARM AUDIO/VISUAL DEVICES IN TWO LARGE TOILETS TO BE ADJUSTED FOR MINIMUM VOLUME.
8. ADJUST TAPS ON ALL PA SPEAKER TRANSFORMERS TO PROVIDE UNIFORM VOLUME THROUGHOUT SPACE.

1 SYSTEMS PLAN

SCALE: 1/8" = 1'-0"

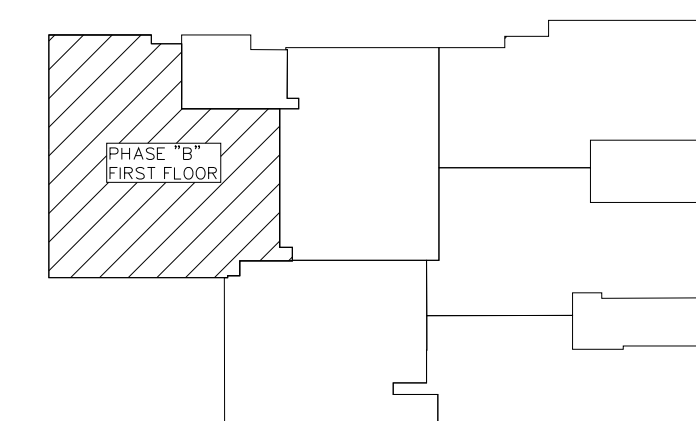
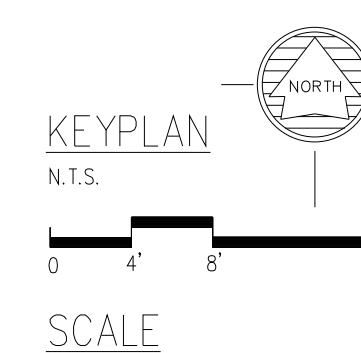

PROJECT TITLE  
REPAIR MEDICAL CENTER PH B  
LITTLE ROCK AFB, ARKANSAS

SHEET TITLE  
SYSTEMS PLAN

DRAWN BY RJR	LEAD DESIGNER AM
TECH REVIEWER KF	PROJECT NUMBER NKAK 05-8004A
DESIGNED BY KF	SHEET
DATE 1-21-08	E1.31
SCALE 1/8"=1"	36 OF 39