

REVISIONS	AS-BUILT	ISSUED FOR BID	DATE	APPROVED	SYMBOL	AMENDMENT DESCRIPTION
1	8/01/2005	10/01/2003				

DESIGNED BY: DATE: 10/10/2003	PROJECT NO: 61503
DRAWN BY:	CHECKED BY: DRAWING CODE:
REVIEWED BY: SOLICITATION NUMBER:	

U.S. ARMY ENGINEERING AND SUPPORT CENTER  
CORPS OF ENGINEERS  
HUNTSVILLE, ALABAMA

EARTHTECH  
2010 Huntsville, AL - 2008 - 800-838-874-008

RENOVATE CLINIC  
BUILDING 1090  
LITTLE ROCK AFB, ARKANSAS

**SOUTH WALL WINDOW  
REPLACEMENT ALT. #5**

**AS-BUILT**

SHEET  
REFERENCE  
NUMBER:  
**A5.31**  
SHEET X OF XX

## 1 EXISTING SOUTH ELEVATION - BUILDING 1090

SCALE 1/8"=1'-0"

### GENERAL NOTES

1. THE SOUTH ELEVATION OF BUILDING 1090 IS SHOWN ONLY IN THE PORTION IN WHICH WORK IS BEING DONE. COLUMN LINES CORRESPOND TO THE PLANS FOR REFERENCE.
2. SEE SHEET A5.30 FOR BASE BID WORK ON SOUTH ELEVATION.
3. THE DOOR / WINDOW PANEL BETWEEN COLUMN LINES 14 AND 15 WILL BE REPLACED AS SHOWN ON A5.30 FOR BASE BID. FOR ALTERNATE #5 WINDOWS SHALL BE PER 3/A5.31. IF ACCEPTED, ALTERNATE #5 WILL SUPERCEED THE GLASS TYPES AND CONSTRUCTUION INSTRUCTIONS FOR THE WINDOW PANELS.

## 2 WINDOWS REPLACED ON SOUTH ELEVATION - BUILDING 1090 (ALTERNATE #5)

SCALE 1/8"=1'-0"

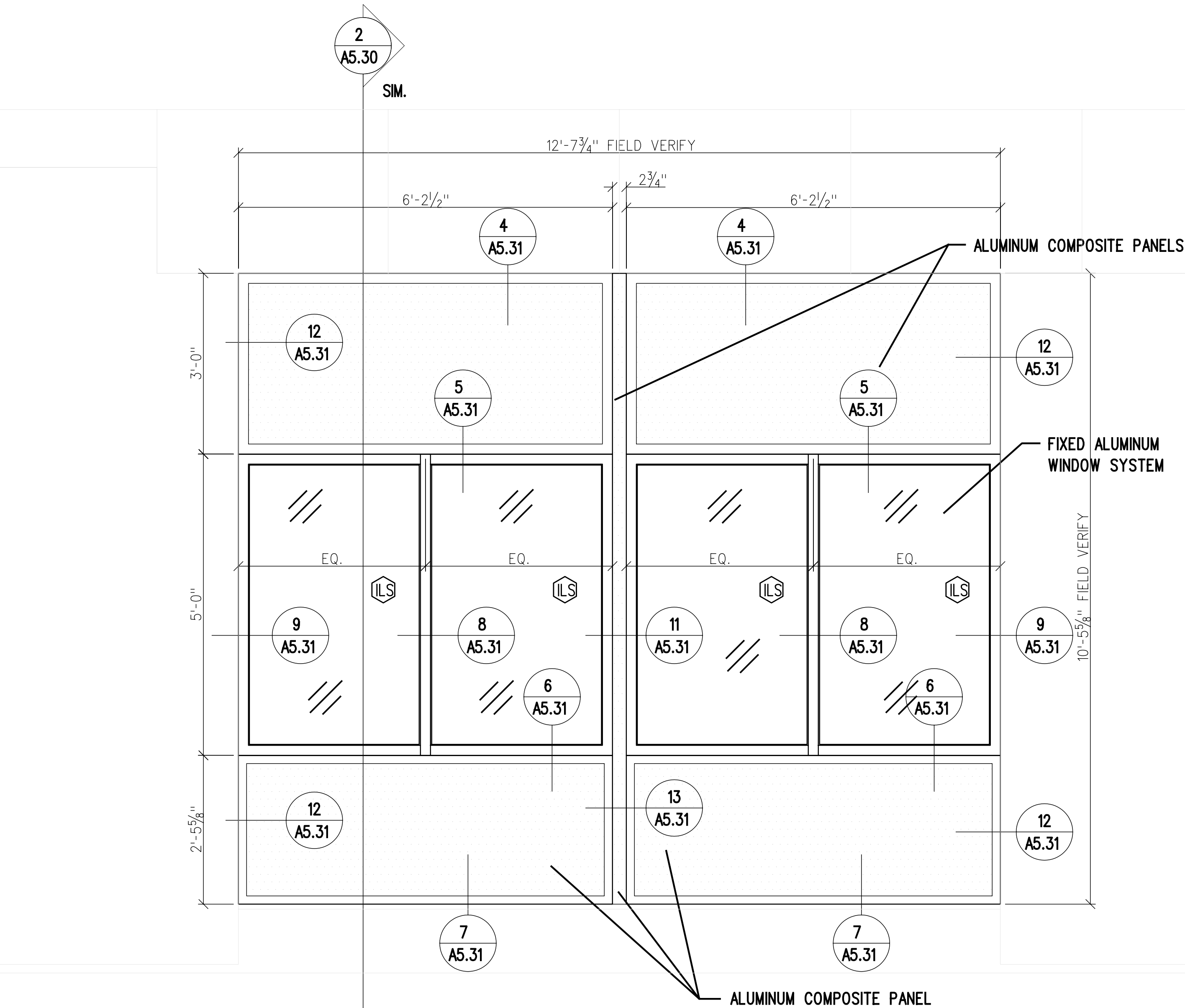

## 3 REPLACEMENT CURTAIN WALL

ILS INDICATES GLASS TYPE

SCALE 3/4"=1'-0"

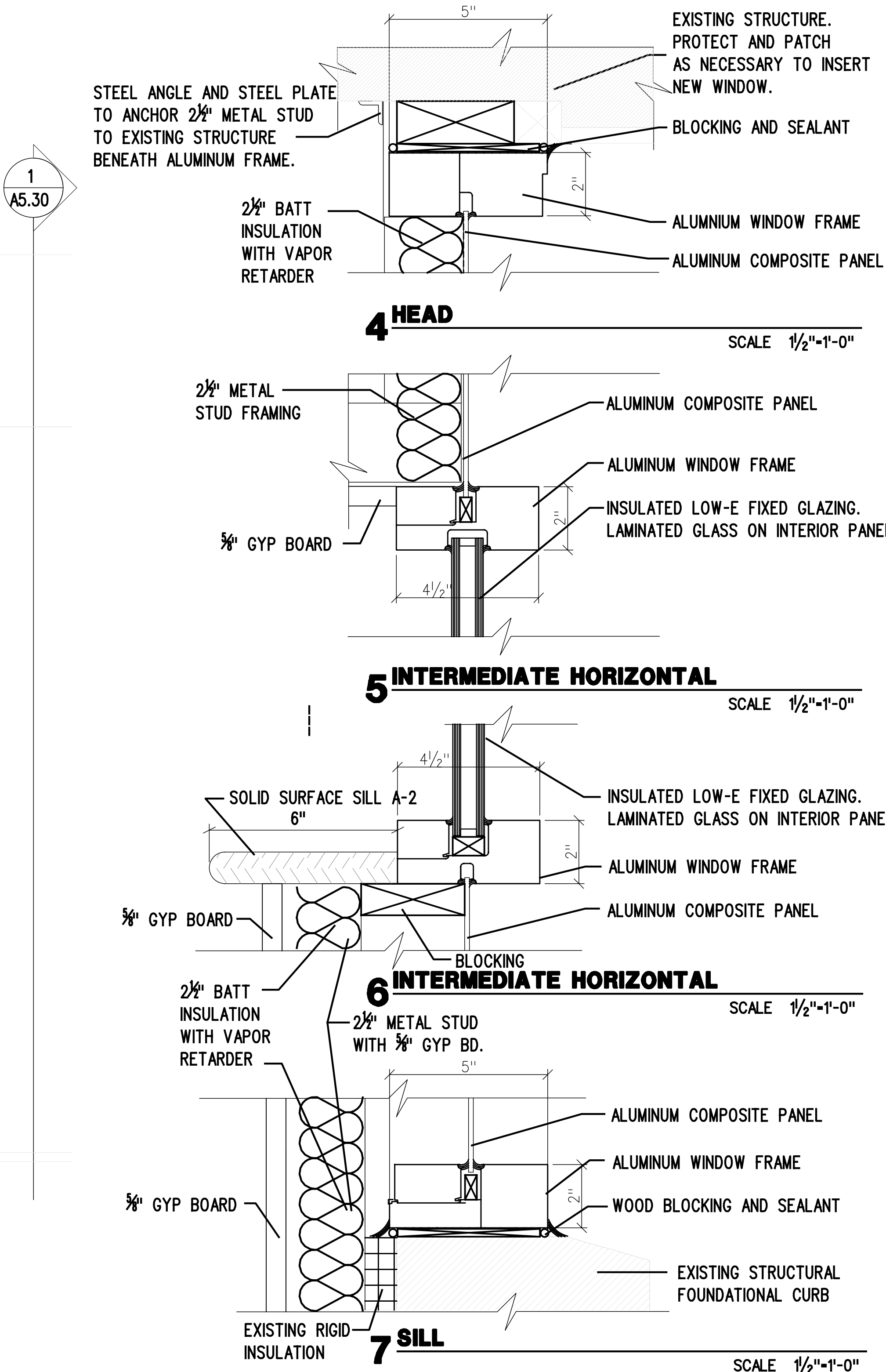

## 8 INTERMEDIATE MULLION

SCALE 1/2"=1'-0"

## 9 JAMB

SCALE 1/2"=1'-0"

## 10 CENTER POST MULLION

SCALE 3/4"=1'-0"

## 11 CENTER POST MULLION AT WALL

SCALE 3/4"=1'-0"

## 12 JAMB

SCALE 1/2"=1'-0"

## 13 CENTER POST MULLION

SCALE 3/4"=1'-0"