

ROOM NO.	ROOM NAME	FLOOR	BASE	WALL								CEILING			REMARKS
				NORTH		EAST		SOUTH		WEST		MATERIAL	FINISH	HEIGHT	
				MATERIAL	FINISH	MATERIAL	FINISH	MATERIAL	FINISH	MATERIAL	FINISH				
A240	CORRIDOR	CPT-1	R	GYP.	*P-2/P-3	GYP.		GYP.	VWC	GYP.	VWC	AP-1		9'-0"	REFER TO A4.20 FOR FINISH LOCATION
A240	STORAGE	VT	R	GYP.	P-1	GYP.	P-1	GYP.	P-1	GYP.	P-1	AP-1		8'-0"	
A241	EXAM ROOM	VT	R	GYP.	P-1	GYP.	P-2	GYP.	P-2	GYP.	P-1	AP-1		8'-0"	
A242	PROVIDER	CPT-2	R	GYP.	P-2	GYP.	P-1	GYP.	P-1	GYP.	P-2	AP-1		8'-0"	
A243	EXAM ROOM	VT	R	GYP.	P-1	GYP.	P-2	GYP.	P-2	GYP.	P-1	AP-1		8'-0"	
A244	RECEPTION	CPT-3	R	GYP.	P-2	GYP.	P-2	GYP.	P-2	GYP.	P-2	ACP-1		8'-0"	
A245	TOILET	CFT-1	CTB	CT-WS/GYP.	CT1,2,3/P-1E	CT-WS/GYP.	CT1,2,3/P-1E	CT-WS/GYP.	CT1,2,3/P-1E	CT-WS/GYP.	CT1,2,3/P-1E	GYP	P-1E	8'-0"	
A247	NURSE OFFICE	CPT-2	R	GYP.	P-2	GYP.	P-1	GYP.	P-1	GYP.	P-2	AP-1		8'-0"	
A248	SUPPLY ROOM	VT	R	GYP.	P-1	GYP.	P-1	GYP.	P-1	GYP.	P-1	AP-1		8'-0"	
A249	CORRIDOR	CPT-1	R	GYP.	VWC	GYP.	*VWC/P-3	GYP.	VWC	GYP.	VWC	AP-1		9'-0"	REFER TO A4.20 FOR FINISH LOCATION
A250	BREAK ROOM	CPT-1	R	GYP.	VWC	GYP.	VWC	GYP.	VWC	GYP.	VWC	AP-1		8'-0"	
A251	OFFICE	CPT-2	R	GYP.	P-2	GYP.	P-1	GYP.	P-1	GYP.	P-2	AP-1		8'-0"	
A252	NOT USED														
A253	EXAM ROOM	VT	R	GYP.	P-1	GYP.	P-2	GYP.	P-2	GYP.	P-1	AP-1		9'-0"	
A254	PROVIDER	CPT-2	R	GYP.	P-2	GYP.	P-1	GYP.	P-1	GYP.	P-2	AP-1		9'-0"	EXISTING CEILING HEIGHTS @ 9'-0" A.F.F.
A255	EXAM ROOM	VT	R	GYP.	P-1	GYP.	P-2	GYP.	P-2	GYP.	P-1	AP-1		9'-0"	EXISTING CEILING HEIGHTS @ 9'-0" A.F.F.
A256	EXAM ROOM	VT	R	GYP.	P-1	GYP.	P-2	GYP.	P-2	GYP.	P-1	AP-1		9'-0"	EXISTING CEILING HEIGHTS @ 9'-0" A.F.F.
A257	PROVIDER	CPT-2	R	GYP.	P-2	GYP.	P-1	GYP.	P-1	GYP.	P-2	AP-1		9'-0"	EXISTING CEILING HEIGHTS @ 9'-0" A.F.F.
A258	EXAM ROOM	VT	R	GYP.	P-1	GYP.	P-2	GYP.	P-2	GYP.	P-1	AP-1		9'-0"	EXISTING CEILING HEIGHTS @ 9'-0" A.F.F.
A259	TOILET	CFT-1	CTB	CT-WS/GYP.	CT1,2,3/P-1E	CT-WS/GYP.	CT1,2,3/P-1E	CT-WS/GYP.	CT1,2,3/P-1E	CT-WS/GYP.	CT1,2,3/P-1E	GYP	P-1E	8'-0"	
A260	CORRIDOR	CPT-1	R	GYP.	VWC	GYP.	VWC	GYP.	P-3	GYP.	VWC	AP-1		9'-0"	
A261	TREATMENT ROOM	SV	IV	GYP.	P-2	GYP.	P-2	GYP.	P-1	GYP.	P-1	AP-2		9'-0"	
A262	SCREENING ROOM	VT	R	GYP.	P-1	GYP.	P-1	GYP.	P-1	GYP.	P-1	AP-1		8'-0"	
A263	EXAM ROOM	VT	R	GYP.	P-1	GYP.	P-2	GYP.	P-2	GYP.	P-1	AP-1		9'-0"	EXISTING CEILING HEIGHTS @ 9'-0" A.F.F.
A264	PROVIDER	CPT-2	R	GYP.	P-2	GYP.	P-1	GYP.	P-1	GYP.	P-2	AP-1		9'-0"	EXISTING CEILING HEIGHTS @ 9'-0" A.F.F.
A265	EXAM ROOM	VT	R	GYP.	P-1	GYP.	P-2	GYP.	P-2	GYP.	P-1	AP-1		9'-0"	EXISTING CEILING HEIGHTS @ 9'-0" A.F.F.
A266	WAITING AREA	CPT-1	R	GYP.	P-4	GYP.	VWC	GYP./DP-1	P-4	GYP.	P-3	AP-1		9'-0"	EXISTING CEILING HEIGHTS @ 9'-0" A.F.F.
A266A	RECORDS	CPT-1	R	GYP.	VWC	GYP.	VWC	GYP.	VWC	GYP.	VWC	AP-1		9'-0"	EXISTING CEILING HEIGHTS @ 9'-0" A.F.F.

GENERAL NOTES

- ALL THRESHOLDS AT RESTROOMS BETWEEN FLOOR TILE AND CARPETING SHALL BE 2" WIDE, WITH DOUBLE BEVELED EDGES. REFER TO DIVISION 09300 FOR COLOR AND TYPE.
- REFER TO A4.20 FOR CARPET PATTERN CLARIFICATIONS AND DIMENSIONS.
- REFER TO A2.11 REFLECTED CEILING PLANS FOR CLARIFICATIONS AND DIMENSIONS OF CEILINGS.
- REFER TO A3.20 INTERIOR TOILET ROOM ELEVATIONS FOR CLARIFICATIONS OF CERAMIC TILE WALL PATTERNS.

FINISH LEGEND

FLOOR	CPT-1	MOHAWK COMMERCIAL, ELITE CHOICE MC031, COLOR: 503 KING'S BLUE, 12' ROLLED GOODS
	CPT-2	MOHAWK COMMERCIAL, CLASSIC IMAGE MC031, COLOR: 503 KING'S BLUE, 12' ROLLED GOODS
	CPT-3	DURKAN COMMERCIAL, LA BOUCLE, COLOR: 555 KOHL
WALL	SV	MANNINGTON, BIOSPEC, COLOR: 15140 COOL BEIGE
	VT	TOLI, SOLID VINYL TILE, LINOTESTA, COLOR: 516
	CFT-1	DAL-TILE, NATURAL HUES, QH08 CINDER, 6" X 6", #36 FINISH
	WM	MOHAWK COMMERCIAL, LUXOR MODULAR TILE, COLOR: 266 CHARCOAL
	P-1	SHERWIN WILLIAMS, 7071SW GRAY SCREEN
	P-1E	SHERWIN WILLIAMS, SW7071 GRAY SCREEN, EPOXY FINISH
	P-2	SHERWIN WILLIAMS, SW6100 PRACTICAL BEIGE
	P-3	SHERWIN WILLIAMS, SW6204 SEA SALT
	P-4	SHERWIN WILLIAMS, SW6387 COMPATIBLE CREAM
	VWC	D.L. COUCH, SOURCE ONE, MELANGE, 2VNG-25 PEBBLE BEACH
	CT-1	DAL-TILE, Q182 SUEDE GRAY, 6" X 6", SEMI-GLOSS FINISH
	CT-2	NOT USED
	CT-3	DAL-TILE, K-189 NAVY, 6" X 6", SEMI-GLOSS FINISH
BASE	R	ARMSTRONG, 02 IRON, 4" COVED
	IV	INTEGRAL MANNINGTON, BIOSPEC, 15112 STERLING BLUE
	CTB	DAL-TILE, NATURAL HUES, BLUE, 6" X 6", COVED BASE
CEILING	AP-1	ACOUSTICAL PANEL 2' X 2'
	AP-2	ACOUSTICAL PANEL 2' X 2', FOR WET AREAS
	P-1	SHERWIN WILLIAMS, SW7071 GRAY SCREEN, LRV 61%, SATIN FINISH
MILLWORK	QTZ	DUPONT, ZODIAG, QUARTZ SURFACING, ECLIPSE BLUE
	A-1	DUPONT, CORIAN, OYSTER
	A-2	DUPONT, CORIAN, PEARL GRAY
	PL-1	PIONITE, SAGE CORAL, AV781, SUEDE FINISH
	PL-2	PIONITE, MILLWORK CHERRY, WC-431-H HI BRITE FINISH
	PL-3	PIONITE, BEIGE LINEN, AT301, SUEDE FINISH
	WD-1	STAINED WOOD VENEER TO MATCH PIONITE, MILLWORK CHERRY WC-4314-H
EXISTING	EX	EXISTING CONDITION
WAINSCOT	WS	FOR HEIGHTS REFER TO A3.20 INTERIOR TOILET ROOM ELEVATIONS

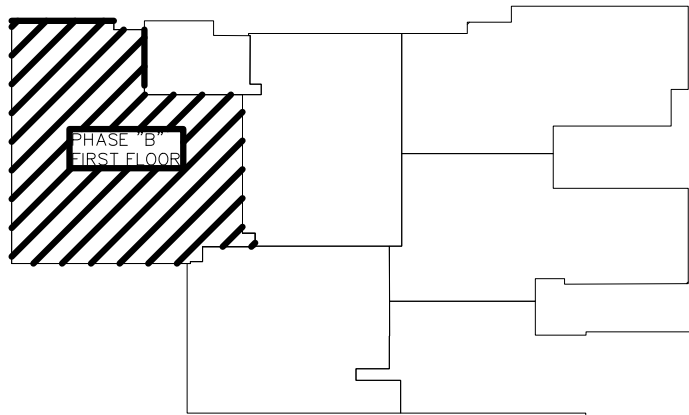
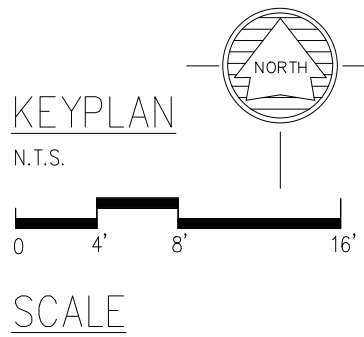

LITTLE ROCK A.F.B.
ARKANSAS

FPM

804 West Curtis Drive, Suite H
Midwest City, OK 73110
phone: 405.869.9212
fax: 405.869.9222
www.fpm-group.com

RECORD
DRAWINGS
MARCH 2007

									APP'D
									BY
									Date
									Revision/Issue
									No.

PROJECT TITLE REPAIR MEDICAL CENTER PH B LITTLE ROCK AFB, ARKANSAS		SHEET TITLE FINISH SCHEDULE	
DRAWN BY GP	LEAD DESIGNER AM		
TECH REVIEWER GP	PROJECT NUMBER NKAK 05-8004A		
DESIGNED BY GP	SHEET		
DATE 1-21-08	A4.12		
SCALE N/A	13 OF 39		