

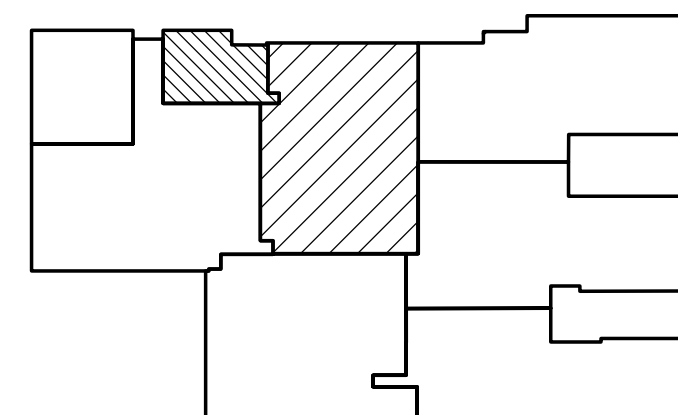

1. SOLID LINES INDICATE NEW CONSTRUCTION.
2. PROVIDE IN WALL BLOCKING IN ACCORDANCE WITH SPECIFICATIONS AND EQUIPMENT REQUIREMENTS.
3. CONTRACTORS SHALL FIELD VERIFY ALL EXISTING CONDITIONS AND REPORT ANY DISCREPANCIES TO THE GOVERNMENT REPRESENTATIVE.
4. METAL STUD PARTITIONS ARE DIMENSIONED TO CENTERLINE OF WALL. MASONRY PARTITIONS ARE DIMENSIONED TO FACE OF WALL EXCEPT WHERE CORRIDORS ARE DESIGNATED AS DISTANCE "CLEAR."
5. DESIGN AND INSTALLATION OF STRUCTURAL SYSTEM FOR XRAY MACHINE IN ROOMS C160 AND C167 TO BE PROVIDED BY STRUT SERVICES GROUP OR APPROVED EQUAL.
6. WALLS TO BE WALL TYPE 1B UNLESS NOTED OTHERWISE. REFER TO A5.10 FOR WALL TYPES.
7. CIRCLED AREAS INDICATE AREAS THAT HAVE BEEN ENLARGED. SEE REFERENCED DETAILS.
8. WHEN 2 DIFFERENT WALL TYPES APPEAR ADJACENT TO EACH OTHER, THE FINISHED WALL SURFACES MUST LINE UP.
9. ALL ROOF PENETRATIONS SHALL BE PROPERLY FLASHED BY A TAMKO APPROVED CONTRACTOR SO AS TO NOT VOID WARRANTY.
10. WHERE A RATING HAS BEEN GIVEN TO AN EXISTING WALL, ALL PENETRATIONS (EXISTING OR NEW) MUST BE SEALED AND PROPERLY FIREPROOFED PER RATING REQUIREMENT.
11. FOR COMPLETE FIRE CODE INFORMATION SEE A0.11 LIFE SAFETY PLAN.
12. REPLACE ALL EXISTING DOORS AND HARDWARE WITH NEW PER DOOR SCHEDULE. INSTALL NEW FRAMES WHERE INDICATED ON DRAWINGS. REFER TO SHEET A4.30 FOR DOOR SCHEDULE.
13. VERIFY PLUMBING FIXTURE DIMENSIONS WITH MANUFACTURER. REFER TO PLUMBING DIVISION FOR FURTHER INFORMATION.
14. FOR PLACEMENT OF PLUMBING FIXTURES REFER TO A0.10 TYPICAL MOUNTING HEIGHTS.
15. REMOVE EXISTING CAULK ON ALL EXTERIOR SIDE OF WINDOWS. CLEAN SURFACE TO RECEIVE NEW WATER PROOF CAULK PER MANUFACTURERS INSTRUCTIONS.
16. INSTALL NEW FLOOR COVERING, COVE BASE , WALL COVERING, CEILING GRID AND ACOUSTICAL CEILING PANELS PER FINISH SCHEDULE.
17. INTERIOR SIGNAGE TO BE PROVIDED UNDER SEPARATE CONTRACT.

KEYED NOTES:

- ① INSTALL NEW SINK, AND PLUMBING ACCESSORIES ⑥ NEW LOCATION.
- ② INSTALL NEW SINK, AND PLUMBING ACCESSORIES IN EXISTING SINK LOCATION.
- ③ INSTALL NEW MILLWORK
- ④ INSTALL NEW PRIVACY CURTAIN
- ⑤ INSTALL NEW PLUMBING FIXTURES AND ACCESSORIES.
- ⑥ NOT USED
- ⑦ INSTALL NEW DOOR FRAME AT NEW OR EXISTING LOCATION AS SHOWN.
- ⑧ SPECIMEN PASS-THRU CABINET.
- ⑨ NOT USED
- ⑩ NOT USED
- ⑪ INSTALL NEW COUNTERTOP.
- ⑫ INSTALL NEW ADA ACCESSIBLE DRINKING FOUNTAIN R2201 AND STANDARD HEIGHT DRINKING FOUNTAIN. SEE A0.10 FOR MOUNTING HEIGHTS.
- ⑬ INSTALL NEW FLOOR MOP SINK P4700 AND MOP HEADER WITH SHELF A5135 .
- ⑭ INSTALL NEW EMERGENCY SHOWER/EYE WASH AREA.
- ⑮ INSTALL ADA FOLDING PADDED SEAT. TOP OF SEAT TO BE AT 17"—20" A.F.F. INSTALL 24"x60" MIRROR ⑥ PULL SIDE OF DOOR A1080 . SEE SPEC SEC 10800.
- ⑯ INSTALL ADA FOLDING PADDED SEAT. TOP OF SEAT TO BE AT 17"—20" A.F.F. SEE SPEC SEC 10800.



AS BUILTS

[illegible]REPAIR MEDICAL CENTER PH 3
LITTLE ROCK AFB, ARKANSAS

SHEET TITLE

LEAD DESIGNER
AM

PROJECT NUMBER	NKAK 06-8001
----------------	--------------

	SHEET
--	--------------

DATE 8-11-06

SCALE
1/8" = 1'-0"

A1.11

8 of 37

1 FLOOR PLAN

SCALE: 1/8" = 1'-0"