

1 DEMOLITION PLAN -- AREA "A" -- RE-FILL PHARMACY, LOGISTICS, HOUSEKEEPING
1/8"=1'-0"

NOTE: EXISTING ROOM NUMBERS ARE SHOWN HERE FOR REFERENCE ONLY.

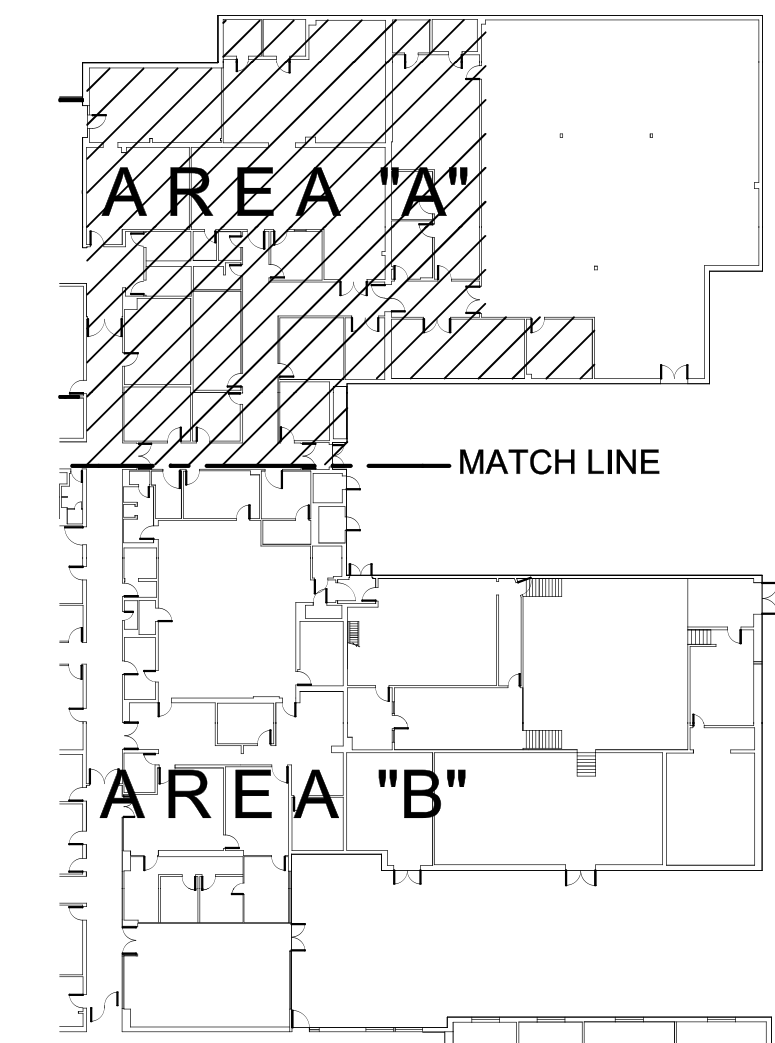

2 KEY PLAN
N.T.S.

WALL LEGEND

- EXISTING TO REMAIN
- EXISTING TO BE REMOVED

GENERAL DEMOLITION NOTES:

- REMOVE EXISTING FLOORING IN ALL AREAS OF RENOVATION (EXCEPT MECH/ELECT RMS) UNLESS OTHERWISE NOTED. SOME AREAS OF HOUSEKEEPING MAY HAVE QUARRY TILE FLOORING. CONTRACTOR SHALL FIELD VERIFY PRIOR TO BIDDING. REFER TO PROJECT MANUAL FOR LIST OF ALL MATERIALS TO BE RECYCLED.
- REMOVE EXISTING GYPSUM BOARD OR ACOUSTIC TILE & GRID CEILING IN ALL AREAS OF RENOVATION (EXCEPT MECH/ELECT RMS) UNLESS OTHERWISE NOTED. EXISTING SPRINKLER HEADS SHALL REMAIN & BE MODIFIED AS REQUIRED. SEE FIRE PROTECTION PLANS.
- CONTRACTOR SHALL SAWCUT & REMOVE PORTIONS OF EXISTING SLAB FOR NEW PLUMBING. SEE PLUMBING DRAWINGS.
- CONTRACTOR SHALL REMOVE & SALVAGE FOR GOVERNMENT ALL CLOCKS, CAMERAS, PROJECTORS, DISPLAY CASES, EMBLEMS AND SIMILAR DEVICES IN AREAS OF CONSTRUCTION. COORDINATE AREAS OF STORAGE WITH FACILITY MANAGER.
- CONTRACTOR SHALL BE RESPONSIBLE FOR ALL EXISTING CONDITIONS IN AREAS OF RENOVATION. CONTRACTOR SHALL FIELD VERIFY ALL EXISTING DIMENSIONS & CONDITIONS PRIOR TO BID. CONTRACTOR SHALL PROTECT ALL EXISTING ITEMS TO REMAIN FROM DAMAGE DURING CONSTRUCTION ACTIVITIES.
- GOVERNMENT SHALL REMOVE AND RE-INSTALL ALL MOBILE EQUIPMENT, SUCH AS COPIERS, COMPUTERS AND BATTERY CHARGERS, PRIOR TO START OF DEMOLITION. GOVERNMENT SHALL ALSO REMOVE & RE-INSTALL ALL PRODUCTS, SUCH AS MEDICAL DRUGS AND OFFICE SUPPLIES, PRIOR TO THE START OF DEMOLITION.

KEYED DEMOLITION NOTES:

- REMOVE EXISTING WALL IN ITS ENTIRETY.
- REMOVE PORTION OF EXISTING WALL FOR NEW DOOR, WINDOW OR OPENING. REMOVE ALL FASTENERS & FILL ALL HOLES IN WALLS TO REMAIN. PATCH SURFACES WITH LIKE MATERIALS & TEXTURE. PREPARE SURFACES TO RECEIVE NEW FINISH.
- REMOVE EXISTING PLUMBING FIXTURE AND/OR ACCESSORIES. PATCH & REPAIR WALL AS NECESSARY WITH LIKE MATERIALS & TEXTURE TO RECEIVE NEW FIXTURE OR FINISH AS INDICATED.
- REMOVE EXISTING DOOR FRAME, DOOR & HARDWARE.
- REMOVE EXISTING CONCEALED STOREFRONT, STUDS & GYP BD IN ITS ENTIRETY.
- REMOVE EXISTING MILLWORK.
- REMOVE EXISTING GLAZING & FRAME.
- EXISTING CEILING TO REMAIN. PATCH AS REQUIRED WITH LIKE MATERIALS.
- EXISTING FLOORING TO REMAIN. PATCH AS REQUIRED WITH LIKE MATERIALS. PREP PAINTED FLOORS FOR NEW PAINT WHERE OCCURS. SEE FINISH SCHEDULE.
- EXISTING DOOR FRAME, DOOR & HARDWARE TO REMAIN. PREPARE NEW DOOR & FRAME TO RECEIVE NEW FINISH. (INTERIOR SIDE ONLY WHERE EXTERIOR DOOR OCCURS)
- REMOVE EXISTING MEDICAL GAS. EXISTING MEDICAL AIR SHALL REMAIN. SEE PLUMBING PLANS.
- REMOVE EXISTING MILLWORK & SALVAGE TO GOVERNMENT. PATCH & PREPARE EXISTING CONCRETE FLOOR FOR NEW SEALER.
- REMOVE EXISTING RECESSED FIRE EXTINGUISHER/HOSE CABINET. PREPARE OPENING TO RECEIVE NEW RECESSED FIRE EXTINGUISHER CABINET.
- CONTRACTOR SHALL REMOVE EXISTING SLIDING MOBILE FILES & FLOOR/TRACK SYSTEM IN ITS ENTIRETY.
- EXISTING MED GAS SHUT OFF VALVE TO BE REMOVED. SEE PLUMBING PLANS FOR ADDITIONAL INFORMATION.
- REMOVE EXISTING RFP WAINSCOT & CRASH RAIL. REMOVE VWC WHERE OCCURS. PATCH WALL WITH LIKE MATERIALS & TEXTURE. PREPARE SURFACE TO RECEIVE NEW FINISH.
- REMOVE EXISTING HANDRAIL WHERE OCCURS. EXISTING BRICK VENEER SHALL REMAIN.
- SALVAGE EXISTING MODULAR WORK STATIONS TO GOVERNMENT.
- REMOVE EXISTING RECESSED OVERHEAD COILING FIRE DOOR.
- REMOVE EXISTING STORAGE SHELVES. RELOCATE TO NEW ROOM D-102 AND RE-INSTALL. COORDINATE EXACT LOCATION WITH FACILITY MANAGER.
- REMOVE IN ITS ENTIRETY THE EXISTING WALL AT JAMB & HEAD WHERE DOOR/FRAME IS REMOVED. REMOVE HOLD OPENS WHERE OCCUR & PATCH WALL WITH LIKE MATERIALS & TEXTURE. PREPARE SURFACE TO RECEIVE NEW FINISH.
- FILL HOLE IN EXISTING FLOOR WITH LIKE MATERIALS AND PREPARE AREA TO RECEIVE NEW FLOORING.
- NOT USED.
- REMOVE EXISTING H.M. DOOR FRAME. PATCH JAMB & HEAD WITH LIKE MATERIALS & TEXTURE. PREPARE SURFACE TO RECEIVE NEW FINISH. SEE SCHEDULE.



LITTLE ROCK A.F.B.
ARKANSAS

GARVER ENGINEERS

1010 BATTERY STREET
LITTLE ROCK, ARKANSAS 72202
www.garverengineers.com
(501) 376-3633

CROMWELL

ARCHITECTS ENGINEERS
101 SOUTH SPRING ST
LITTLE ROCK AR 72201
TELEPHONE 501-372-2900
FACSIMILE 501-372-0482

						As P'd
						BY
						Date
						Revision/Issue
						No.

PROJECT TITLE
REPAIR & RENOVATE MEDICAL CLINIC PH IV
LITTLE ROCK AIR FORCE BASE
JACKSONVILLE, ARKANSAS
100% SUBMITTAL

DEMOLITION PLAN-AREA "A"

RE-FILL PHARMACY, LOGISTICS, HOUSEKEEPING

DRAWN BY P.J.L.	LEAD DESIGNER K. TAYLOR
REVIEWER P.J.L.	PROJECT NUMBER NKA#06-8006-4
DESIGNED BY P. LEDFORD	SHEET
DATE JULY 1, 2008	A-101-D
SCALE AS NOTED	3 OF 50