

## CODE ANALYSIS/ PROJECT DESCRIPTION

- ① EXISTING FIRE EXTINGUISHER / CABINETS TO REMAIN- SHOWN FOR CODE COMPLIANCE ONLY - NOT NEW WORK
- ② EXISTING FIRE RATINGS TO REMAIN - SHOWN FOR CODE COMPLIANCE ONLY
- ③ EXISTING CONSTRUCTION. ELEVATOR ASSEMBLY AND RATING(S) ARE LEFT AS-IS.
- ④ NEW, ONE HOUR FIRE RATED PARTITION - THIS AREA ONLY.  
ALIGN NEW PARTITION WITH FACE OF CORRIDOR WALL.
- ⑤ MAINTAIN EXISTING 2 HOUR FIRE RATING
- ⑥ FIRE ANNUNCIATOR PANEL
- ⑦ EXISTING FIRE EXIT SIGN

LITTLE ROCK AIR FORCE BASE - BUILDING 1090		OUTPATIENT CLINIC RENOVATIONS		YES	
NAME OF FACILITY		PROJECT NAME/DESCRIPTION		NEW	REN/ADDITION
TERRY PARKER		501 987 5569		SCOTT HANSCHKE	319 354 4700
FACILITY RPK		PHONE NUMBER		PROJECT ARCHITECT	
2000 INTERNATIONAL BUILDING CODE		Little Rock Air Force Base		ASSISTANT FIRE CHIEF JOE WILLET	
BUILDING CODE USED/YR		MUNICIPALITY		CODE REVIEWER	
<input type="checkbox"/> Narrative included		<input checked="" type="checkbox"/> Code Compliance Drawings included		Occupancy Classification/Group B - BUSINESS	
LOCAL CODE INFORMATION		SEE BELOW FOR LOCAL INFORMATION		N.F.P.A. INFORMATION	
Type - IA		Type - IIA		BUSINESS	
Construction Type		Code Name/Year		Construction Type	
Number of Stories 2		Project Area		5,000 SFT = 1 Room N 10,000 SFT = 2 Rooms N 15,000 SFT = 3 Rooms N 20,000 SFT = 4 Rooms N 25,000 SFT = 5 Rooms N 30,000 SFT = 6 Rooms N 35,000 SFT = 7 Rooms N 40,000 SFT = 8 Rooms N 45,000 SFT = 9 Rooms N 50,000 SFT = 10 Rooms N 55,000 SFT = 11 Rooms N 60,000 SFT = 12 Rooms N 65,000 SFT = 13 Rooms N 70,000 SFT = 14 Rooms N 75,000 SFT = 15 Rooms N 80,000 SFT = 16 Rooms N 85,000 SFT = 17 Rooms N 90,000 SFT = 18 Rooms N 95,000 SFT = 19 Rooms N 100,000 SFT = 20 Rooms N 105,000 SFT = 21 Rooms N 110,000 SFT = 22 Rooms N 115,000 SFT = 23 Rooms N 120,000 SFT = 24 Rooms N 125,000 SFT = 25 Rooms N 130,000 SFT = 26 Rooms N 135,000 SFT = 27 Rooms N 140,000 SFT = 28 Rooms N 145,000 SFT = 29 Rooms N 150,000 SFT = 30 Rooms N 155,000 SFT = 31 Rooms N 160,000 SFT = 32 Rooms N 165,000 SFT = 33 Rooms N 170,000 SFT = 34 Rooms N 175,000 SFT = 35 Rooms N 180,000 SFT = 36 Rooms N 185,000 SFT = 37 Rooms N 190,000 SFT = 38 Rooms N 195,000 SFT = 39 Rooms N 200,000 SFT = 40 Rooms N 205,000 SFT = 41 Rooms N 210,000 SFT = 42 Rooms N 215,000 SFT = 43 Rooms N 220,000 SFT = 44 Rooms N 225,000 SFT = 45 Rooms N 230,000 SFT = 46 Rooms N 235,000 SFT = 47 Rooms N 240,000 SFT = 48 Rooms N 245,000 SFT = 49 Rooms N 250,000 SFT = 50 Rooms N 255,000 SFT = 51 Rooms N 260,000 SFT = 52 Rooms N 265,000 SFT = 53 Rooms N 270,000 SFT = 54 Rooms N 275,000 SFT = 55 Rooms N 280,000 SFT = 56 Rooms N 285,000 SFT = 57 Rooms N 290,000 SFT = 58 Rooms N 295,000 SFT = 59 Rooms N 300,000 SFT = 60 Rooms N 305,000 SFT = 61 Rooms N 310,000 SFT = 62 Rooms N 315,000 SFT = 63 Rooms N 320,000 SFT = 64 Rooms N 325,000 SFT = 65 Rooms N 330,000 SFT = 66 Rooms N 335,000 SFT = 67 Rooms N 340,000 SFT = 68 Rooms N 345,000 SFT = 69 Rooms N 350,000 SFT = 70 Rooms N 355,000 SFT = 71 Rooms N 360,000 SFT = 72 Rooms N 365,000 SFT = 73 Rooms N 370,000 SFT = 74 Rooms N 375,000 SFT = 75 Rooms N 380,000 SFT = 76 Rooms N 385,000 SFT = 77 Rooms N 390,000 SFT = 78 Rooms N 395,000 SFT = 79 Rooms N 400,000 SFT = 80 Rooms N 405,000 SFT = 81 Rooms N 410,000 SFT = 82 Rooms N 415,000 SFT = 83 Rooms N 420,000 SFT = 84 Rooms N 425,000 SFT = 85 Rooms N 430,000 SFT = 86 Rooms N 435,000 SFT = 87 Rooms N 440,000 SFT = 88 Rooms N 445,000 SFT = 89 Rooms N 450,000 SFT = 90 Rooms N 455,000 SFT = 91 Rooms N 460,000 SFT = 92 Rooms N 465,000 SFT = 93 Rooms N 470,000 SFT = 94 Rooms N 475,000 SFT = 95 Rooms N 480,000 SFT = 96 Rooms N 485,000 SFT = 97 Rooms N 490,000 SFT = 98 Rooms N 495,000 SFT = 99 Rooms N 500,000 SFT = 100 Rooms N 505,000 SFT = 101 Rooms N 510,000 SFT = 102 Rooms N 515,000 SFT = 103 Rooms N 520,000 SFT = 104 Rooms N 525,000 SFT = 105 Rooms N 530,000 SFT = 106 Rooms N 535,000 SFT = 107 Rooms N 540,000 SFT = 108 Rooms N 545,000 SFT = 109 Rooms N 550,000 SFT = 110 Rooms N 555,000 SFT = 111 Rooms N 560,000 SFT = 112 Rooms N 565,000 SFT = 113 Rooms N 570,000 SFT = 114 Rooms N 575,000 SFT = 115 Rooms N 580,000 SFT = 116 Rooms N 585,000 SFT = 117 Rooms N 590,000 SFT = 118 Rooms N 595,000 SFT = 119 Rooms N 600,000 SFT = 120 Rooms N 605,000 SFT = 121 Rooms N 610,000 SFT = 122 Rooms N 615,000 SFT = 123 Rooms N 620,000 SFT = 124 Rooms N 625,000 SFT = 125 Rooms N 630,000 SFT = 126 Rooms N 635,000 SFT = 127 Rooms N 640,000 SFT = 128 Rooms N 645,000 SFT = 129 Rooms N 650,000 SFT = 130 Rooms N 655,000 SFT = 131 Rooms N 660,000 SFT = 132 Rooms N 665,000 SFT = 133 Rooms N 670,000 SFT = 134 Rooms N 675,000 SFT = 135 Rooms N 680,000 SFT = 136 Rooms N 685,000 SFT = 137 Rooms N 690,000 SFT = 138 Rooms N 695,000 SFT = 139 Rooms N 700,000 SFT = 140 Rooms N 705,000 SFT = 141 Rooms N 710,000 SFT = 142 Rooms N 715,000 SFT = 143 Rooms N 720,000 SFT = 144 Rooms N 725,000 SFT = 145 Rooms N 730,000 SFT = 146 Rooms N 735,000 SFT = 147 Rooms N 740,000 SFT = 148 Rooms N 745,000 SFT = 149 Rooms N 750,000 SFT = 150 Rooms N 755,000 SFT = 151 Rooms N 760,000 SFT = 152 Rooms N 765,000 SFT = 153 Rooms N 770,000 SFT = 154 Rooms N 775,000 SFT = 155 Rooms N 780,000 SFT = 156 Rooms N 785,000 SFT = 157 Rooms N 790,000 SFT = 158 Rooms N 795,000 SFT = 159 Rooms N 800,000 SFT = 160 Rooms N 805,000 SFT = 161 Rooms N 810,000 SFT = 162 Rooms N 815,000 SFT = 163 Rooms N 820,000 SFT = 164 Rooms N 825,000 SFT = 165 Rooms N 830,000 SFT = 166 Rooms N 835,000 SFT = 167 Rooms N 840,000 SFT = 168 Rooms N 845,000 SFT = 169 Rooms N 850,000 SFT = 170 Rooms N 855,000 SFT = 171 Rooms N 860,000 SFT = 172 Rooms N 865,000 SFT = 173 Rooms N 870,000 SFT = 174 Rooms N 875	

ADDITIONAL INFORMATION:  
ADDITIONAL LOCAL CODE INFORMATION:  
DoD: UFC GENERAL REQUIREMENTS FOR BUILDINGS  
DoD: UFC MINIMUM ANTITERRORISM STANDARDS FOR BUILDINGS  
DoD: UFC ENERGY CONSERVATION

SPRINKLER SYSTEM ☒ Full ☐ Partial ☐ None

EXITS AND EXIT COMPONENTS

Travel Distances  
☒ Maximum Room/Suite to Corridor NA' NA' ☐ Maximum Room/Suite to Exit 186' 5'

Number of Stairs 2 Enclosure Rating NA  
 Corridor Widths 5' 0' Door Widths VARIES'

FIRE WALLS

Rating	U.L. Assembly Number
1 Hour Fire	U465
1 Hour Fire/Smoke	NOT REQUIRED
2 Hour Fire	U411/U906
3 Hour Fire	NOT REQUIRED

FIRE ALARM SYSTEM — EXISTING

☐ Direct F.D. Connection ☒ Non-coded ☒ Supervisory ☒ Central Remote Station ☒ Analog / Addressable

☒ Emergency POWER ☐ UPS ☐ Alternative 750KW Diesel generator + Interim battery power

FINISH MATERIALS

Classification: CLASS 1 Flame Spread: 0-25

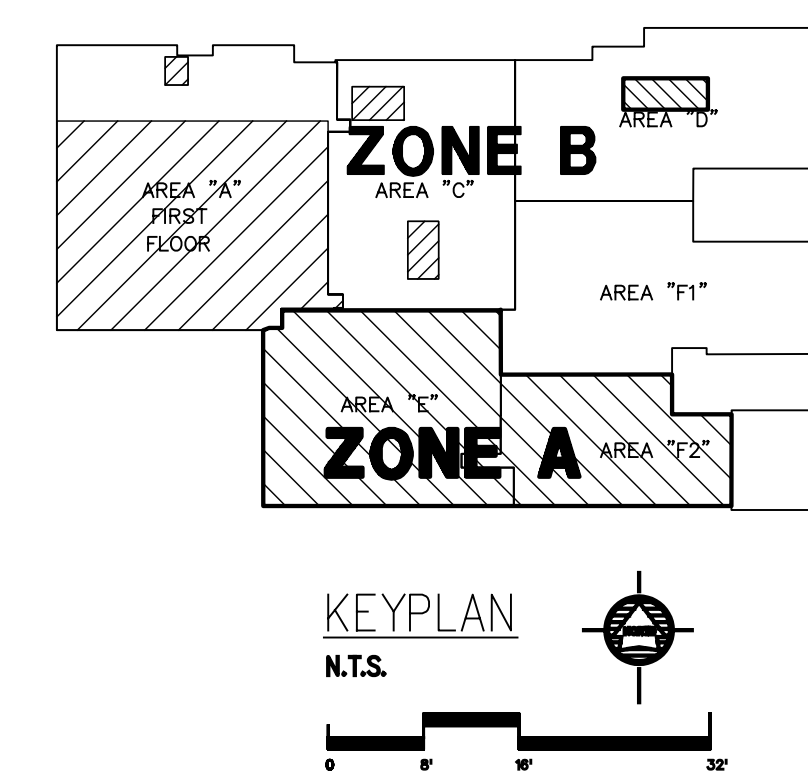

B. CODE COMPLIANCE PLANS INDICATE THE CONFORMANCE OF NEW REMODELED CONSTRUCTION TO APPLICABLE CODE REQUIREMENTS FOR FIRE WALLS AND SMOKE ZONES. WHERE NEW AND REMODELED CONSTRUCTION OCCURS, AS INDICATED IN THE ARCHITECTURAL DRAWINGS, PARTITION FIRE AND SMOKE RATINGS MEET APPLICABLE CODE REQUIREMENTS FOR NEW CONSTRUCTION AS INDICATED IN CODE COMPLIANCE PLANS.

C. GOVERNING CODES  
2000 INTERNATIONAL BUILDING CODE  
2000 NFPA 101 W/ 2002 SUPPLEMENT

D. ALL WOOD BLOCKING SHALL BE FIRE RETARDANT TREATED.

E. ALL FLOOR FINISHES SHALL BE CLASS I, IN ACCORDANCE WITH NFPA 253.

F. ALL WALL AND CEILING FINISHES SHALL BE CLASS 'A' OR 'B' IN ACCORDANCE WITH NFPA 255.

G. ALL DOORS SHALL BE UNLOCKABLE / KEYLESS IN THE DIRECTION OF EGRESS TRAVEL.

H. WITHIN PROJECT AREA, SEAL EXISTING OR NEW PENETRATIONS AND CLOSE UP ALL WALL AND SLAB OPENINGS WEATHER EXISTING OR LEFT BY THE REMOVAL OF ITEMS PENETRATING EXISTING OR NEW CONSTRUCTION. FOR FIRE RATED ASSEMBLIES, USE UL TESTED FIRESTOPPING SYSTEMS ASSEMBLIES APPLICABLE TO THE GIVEN FLOOR CONDITIONS THAT EQUAL THE FIRE RATING OF EXISTING OR NEW CONSTRUCTION.

J. ELEVATOR shaft WALLS WILL MAINTAIN 1 HOUR FIRE RATING. ASSISTANT FIRE CHIEF JOE WILCOX DETERMINED THAT THERE WOULD BE NO ADDITIONS OR ALTERATIONS REQUIRED TO THE CURRENT ELEVATORS.