

- SHEET NOTES**
1. INSTALL NEW CHILLED WATER PUMPS, B-FLY VALVE, TRIPLE DUTY VALVE, FLEX CONN., STRAINER AND SUCTION DIFFUSER. SEE DRAWING M-800 FOR PUMPS INFORMATION.
 2. INSTALL NEW CHILLED WATER PIPING AS SHOWN.
 3. TRIM IMPELLER ON TOWER WATER PUMPS TO 10.125". BALANCE PUMPS TO 600 GPM @ 40 FEET OF HEAD.
 4. INSTALL NEW CHILLERS ON EXISTING CONCRETE PADS.
 5. INSTALL NEW PIPING FROM CHILLER TO NEW ISOLATION VALVE. RE-USE EXISTING CONTROL VALVE & FLOW METER.
 6. GROUT NEW CHILLED WATER PUMPS
 7. LASER ALIGN NEW CHILLED WATER PUMPS AND ALSO EXISTING CONDENSER WATER PUMPS.
 8. REPLACE EXISTING TOWER FILL WITH EXACT REPLACEMENT FROM TOWER MANUFACTURER.

GENERAL NOTE:
INSTALL NEW FOAMGLASS INSULATION WITH 30 MIL PVC JACKETING ON ALL NEW CHILLED WATER PIPING. FIBERGLASS IS NO LONGER ACCEPTABLE.

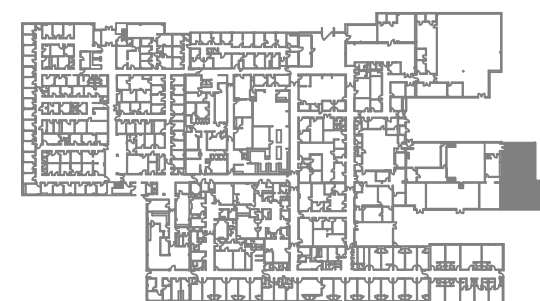

KEY PLAN

1 CHILLED WATER PLAN
SCALE: 1/4" = 1'-0"

CAD Filename: All Drawings.dwg	
ORIGINAL SHEET SIZE: D SIZE 36x24	DATE REVISED
ADDITIONS AND REVISIONS	
35% DESIGN DRAWINGS	10/04/2013
65% DESIGN DRAWINGS	11/27/2013
65% DESIGN DRAWINGS - REVISION Δ	1/10/2014
100% DESIGN DRAWINGS	2/21/2014

KROESCHELL ENGINEERING Co. 3222 KENNICOTT AVE. ARLINGTON HEIGHTS, IL 60004 (312) 649-7980 / FAX: (312) 337-1944 KROESCHELL.COM	dkjv Donley-Kirin Joint Venture 515 DOVER RD. ROCKVILLE, MD 20850 (301) 315-7456 / FAX: (240) 453-8722 DONLEYKIRIN.COM
--	--

PROPOSED MECH ROOM PLAN 19TH MEDICAL SUPPORT GROUP JACKSONVILLE, AR REPAIR OF BUILDING INFRASTRUCTURE SYSTEMS		
DRAWN BY CHECKED BY APPROVED BY SCALE DATE	JWT BJK — SEE PAGE OCTOBER 2013	JOB No. 14554
		Sheet No. M-300

NOTICE: THIS IS THE PERSONAL PROPERTY OF KROESCHELL ENGINEERING CO.
AND ALL USE IS FORBIDDEN EXCEPT UPON WRITTEN CONSENT.