

SHEET NOTES:

1. ALL DARK AND DASHED FIXTURES, EQUIPMENT, PIPING AND ASSOCIATED SUPPORTS ARE TO BE REMOVED IN ITS ENTIRETY AND EXISTING PENETRATIONS PATCHED. PIPING SHOWN LIGHTLY IS TO REMAIN.
2. DISCONNECT AND REMOVE ALL EXISTING PIPING AND EQUIPMENT UNLESS NOTED OTHERWISE.

KEYNOTES: #

1. DISCONNECT AND REMOVE EXISTING ELEVATOR SUMP PUMP & ASSOCIATED CONTROLLER.
2. DISCONNECT AND REMOVE EXISTING SYPHON DRAIN PIPING.
3. DISCONNECT AND REMOVE EXISTING PLUMBING FIXTURES AND ASSOCIATED PIPING TO SOURCE.
4. DISCONNECT EXISTING FLOOR DRAIN BODY AND PATCH FLOOR TO MATCH EXISTING.
5. DISCONNECT AND REMOVE EXISTING FIRE WATER SERVICE PIPING AND PATCH WALL PENETRATION.
6. DISCONNECT AND REMOVE EXISTING 2" DOMESTIC WATER SERVICE AND PATCH WALL PENETRATION.
7. DISCONNECT AND REMOVE EXISTING BACKFLOW PREVENTER.
8. DISCONNECT AND REMOVE EXISTING PUMP DISCHARGE PIPING TO EXISTING PUMPS. EXISTING PUMPS ARE TO REMAIN.
9. EXISTING PIPING TO REMAIN.

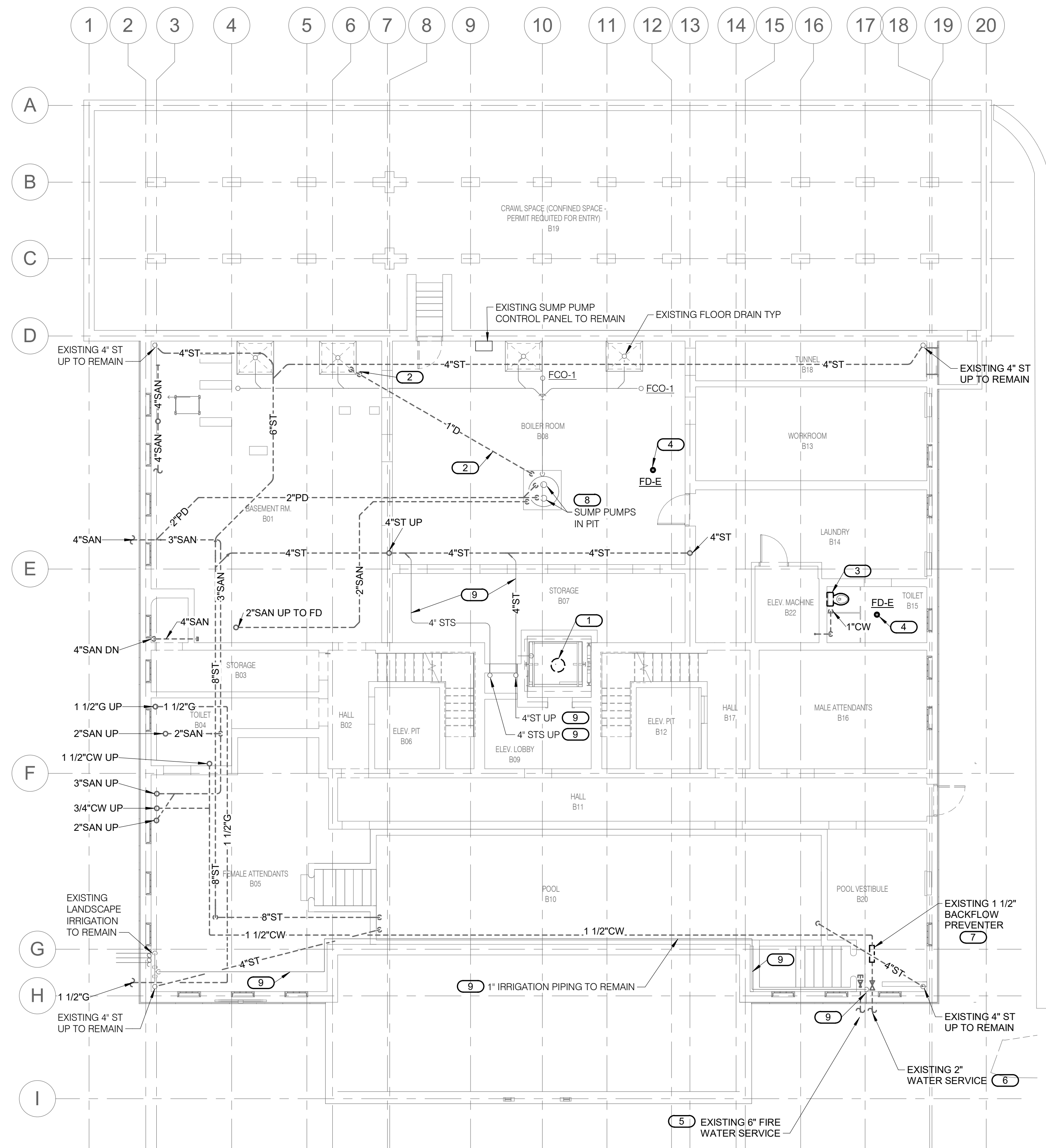

1
PX1.0 BASEMENT PLUMBING DEMOLITION PLAN
1/8" = 1'-0"

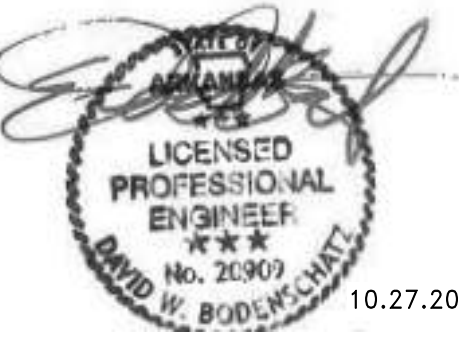
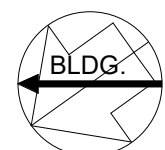
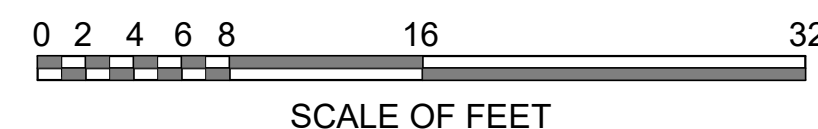

10.27.2023

A/E FIRMS PRIME/ARCH: STRATA ARCHITECTURE 1703 OAK STREET, SUITE 100 KANSAS CITY, MO T: 816.449.0900 MEP/ENG: IMEG CORP. 1400 BALTIMORE STREET, SUITE 300 KANSAS CITY, MO T: 816.842.8437	DESIGNED: SGB	SUB SHEET NO. 01 PX1.0	TITLE OF SHEET MAURICE BATHHOUSE BASEMENT PLUMBING DEMOLITION PLAN REHABILITATE BATHHOUSES HOT SPRINGS NATIONAL PARK	DRAWING NO. 626 180065
	CADD: WMM			PMIS/PKG NO. 318674
	TECH. REVIEW: SGB			SHEET 122 OF 286
	DATE: 10.27.2023			