

**SHEET NOTES:**

1. REFER TO SHEET E0.0 AND E0.1 FOR GENERAL NOTES AND SYMBOLS.
2. REFER TO MECHANICAL PLANS FOR ALL MECHANICAL EQUIPMENT LOCATIONS.
3. ALL POWER CIRCUITS ON THIS SHEET SHALL BE CONNECTED TO PANEL MLB, UNLESS NOTED OTHERWISE.
4. ALL POWER, SECURITY AND LOW-VOLTAGE WIRING SHALL BE INSTALLED IN CONDUIT.

**KEYNOTES:** (#)

1. ADDRESSABLE MOTION / INTRUSION SENSOR THAT RELAYS SIGNAL TO SECURITY SYSTEM.
2. EXISTING EXHAUST FAN TO BE RE-CIRCUITED TO PANEL 'MLB'.
3. FURNISH AND INSTALL NEW STANDALONE NETWORK SWITCH FOR DATA CONNECTIONS ON 1ST FLOOR.
4. THERMOSTAT AND HUMIDISTAT SERVING DEHUMIDIFIER FURNISHED AND INSTALLED BY M.C.E.C. SHALL INSTALL LOW-VOLTAGE WIRING FROM THERMOSTAT AND HUMIDISTAT TO DEHUMIDIFIER IN BASEMENT RM B01. COORDINATE WITH M.C.
5. TELECOMMUNICATIONS GROUND BUSBAR (TGB), MOUNT AT 6'-6" AFF.

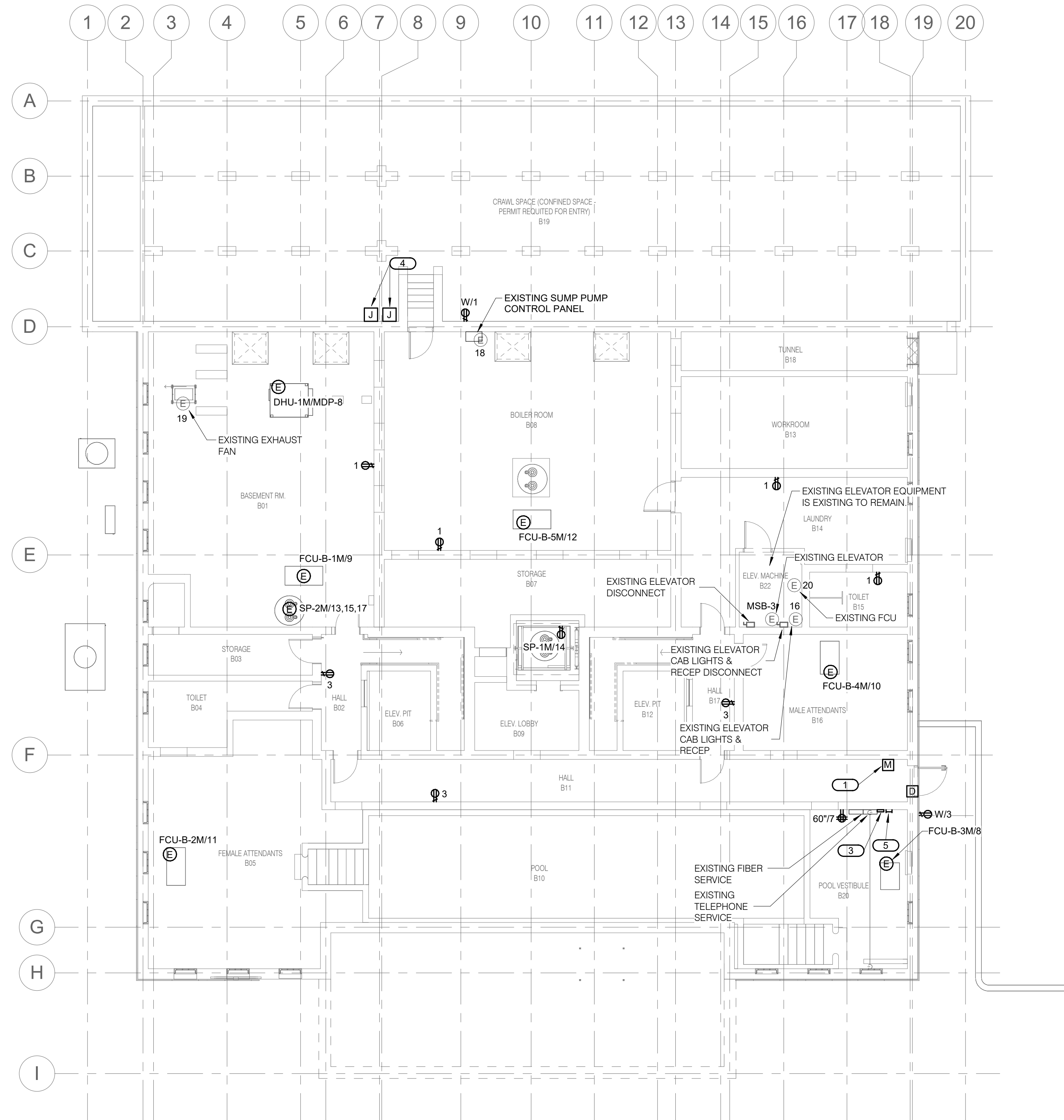

**1**  
**EP1.0** BASEMENT POWER PLAN  
1/8" = 1'-0"

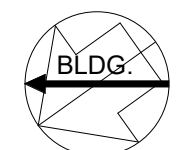
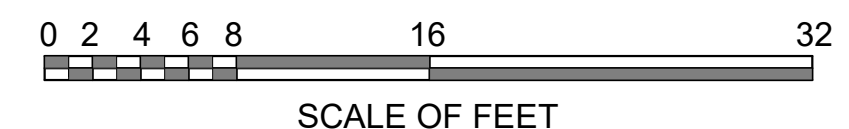

10.27.2023

A/E FIRMS PRIME/ARCH: <b>STRATA ARCHITECTURE</b> 1703 OAK STREET, SUITE 100 KANSAS CITY, MO T: 816.474.0900  MEP/ENG: <b>IMEG CORP.</b> 1400 BALTIMORE STREET, SUITE 300 KANSAS CITY, MO T: 816.842.8437	DESIGNED: PIP	SUB SHEET NO.  <b>01</b> <b>EP1.0</b>	TITLE OF SHEET <b>MAURICE BATHHOUSE</b> <b>BASEMENT POWER PLAN</b>  REHABILITATE BATHHOUSES HOT SPRINGS NATIONAL PARK	DRAWING NO. <b>626</b> <b>180065</b>
	CADD: WMM			PMIS/PKG NO. 318674
	TECH. REVIEW: PIP			SHEET 176 OF 286
	DATE: 10.27.2023			

10/27/2023 1:13:50 PM