

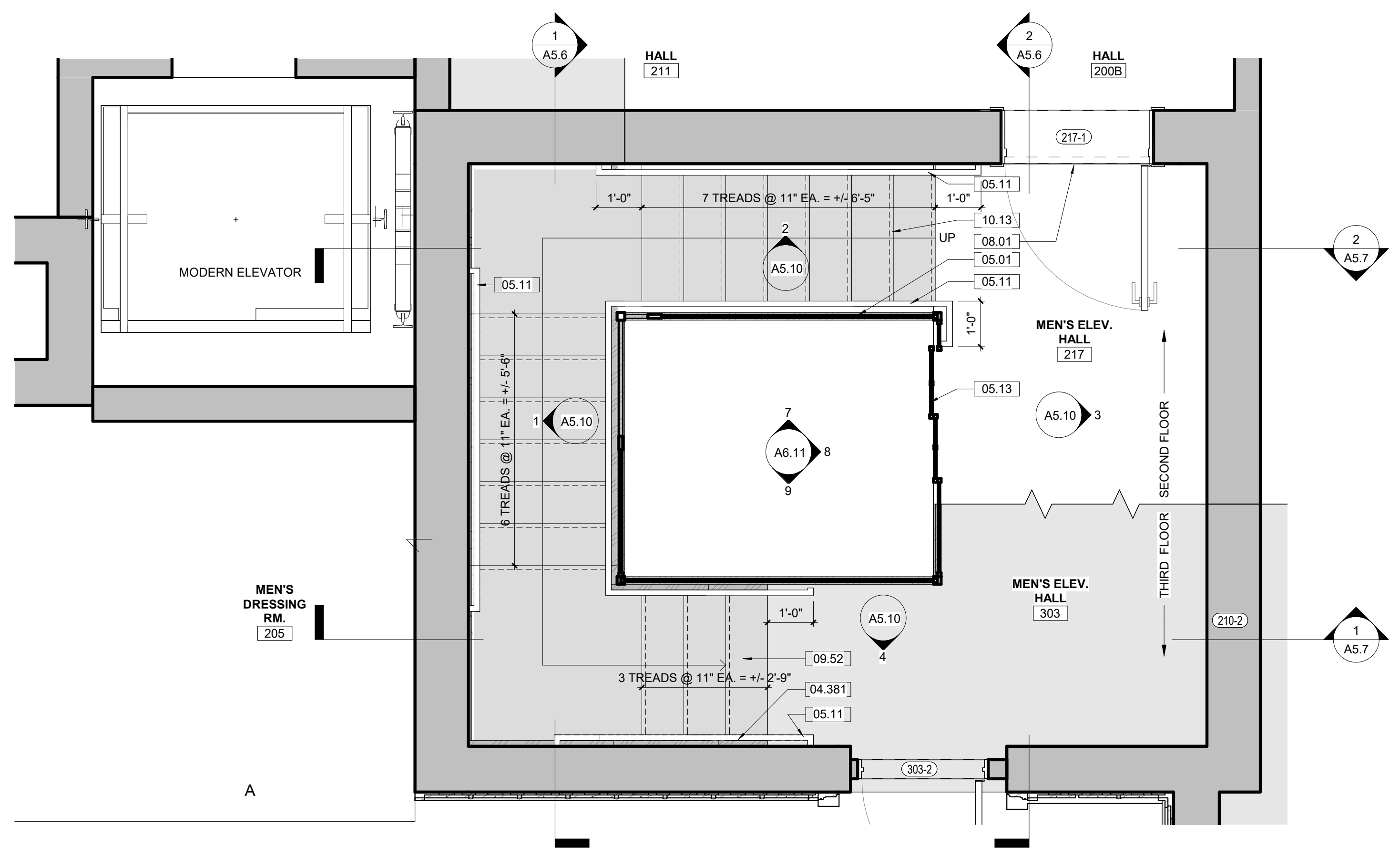

05.12
05.13
05.00

1
A5.3 Photo Detail - Men's Elevator Hall 303 - Top Landing Looking Northeast



2
A5.3 Enlarged Plan - South Stairs and Elevator Second Floor Plan
1/2" = 1'-0" SCALE (A)

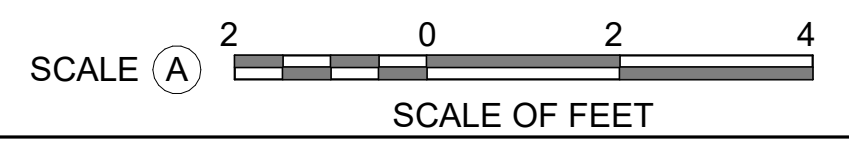

- GENERAL NOTES - TREATMENT:**
- A. DO NOT SCALE FROM THE DRAWINGS. ALL DIMENSIONS ARE APPROXIMATE. ACTUAL FIELD VERIFIED DIMENSIONS SHALL BE OBTAINED BY THE GENERAL CONTRACTOR OR THE APPLICABLE SUB-CONTRACTORS BEFORE SUBMITTING SHOP DRAWINGS, ORDERING MATERIALS, OR THE COMMENCEMENT OF CONSTRUCTION.
 - B. THE GENERAL CONTRACTOR IS RESPONSIBLE FOR VERIFYING EXISTING CONDITIONS, IDENTIFYING ADDITIONAL TREATMENT WORK THAT MAY BE REQUIRED FOR THE INSTALLATION OF NEW WORK.
 - C. THE CONTRACTOR SHALL FIELD VERIFY EXISTING CONDITIONS PRIOR TO COMMENCING ANY WORK. EXISTING CONDITIONS INCLUDE UTILITY LOCATIONS, EXISTING STRUCTURE LOCATIONS, AND EXISTING FIELD DIMENSIONS. THE ARCHITECT SHALL BE NOTIFIED OF ANY DISCREPANCIES DETRIMENTAL TO THE PROPER EXECUTION OF NEW WORK.

KEYNOTES

04.381	040323 - STAIR 217: INFILL SECTION OF BRICK WALL WHERE BRICK IS MISSING ON WEST SIDE (6 SF).
05.00	055213, 099123 - NORTH/SOUTH STAIRS: STRIP AND REPAINT EXISTING HISTORIC ELEVATOR CAGE TO REMAIN (ALL LEVELS - BASEMENT THROUGH 3RD FLOOR), PAINT WITH COLOR FROM HISTORIC PAINT ANALYSIS. MAKE REPAIRS TO ELEVATOR CAGE FOR SAFETY, REFERENCE VERTICAL CIRCULATION INTERIOR ELEVATION. REFER TO MATERIALS TEST REPORT FOR LEAD PAINT TESTING.
05.01	055213, 099123 - NORTH/SOUTH STAIRS: INSTALL METAL SUPPORT AT EXISTING ELEVATOR CAGE TO SUPPORT ANCHORING ON NEW HANDRAIL BRACKETS. PREP, PRIME, AND PAINT.
05.11	055213, 099123 - NORTH/SOUTH STAIR: INSTALL NEW ABAAS COMPLIANT STEEL HANDRAIL AT ALL LEVELS - BASEMENT THROUGH 3RD FLOOR. PREP, PRIME AND PAINT IN THE FIELD. ALL ANCHORS TO BE STAINLESS STEEL.
05.12	099123 - REPLACE DAMAGED METAL MESH IN KIND. NEW MESH SHOULD SPAN FROM METAL FRAME TO METAL FRAME (A FULL SHEET). NEW MESH TO MATCH EXISTING IN SPACING, MATERIAL, AND GAUGE. PREP, PRIME, AND PAINT. REUSE EXISTING FRAME. ATTACH PANEL MESH PANEL TO MATCH EXISTING ATTACHMENT.
05.13	EXISTING ELEVATOR DOOR AT ALL FLOORS IS TO BE SECURED AND WELDED SHUT.
08.01	081113, 081433, 087100 - REFERENCE FLOOR PLANS, THE DOOR SCHEDULE, AND SPECIFICATIONS FOR WORK REQUIRED FOR DOORS.
09.52	SOUTH STAIRS: CLEAN ALL MARBLE TREADS AND LANDINGS (1 LS) BASIS OF DESIGN PROSOCO LIQUID MARBLE CLEANER, OR EQUAL, PER THE MANUFACTURERS INSTRUCTIONS. REMOVE STAINING AND SOILING FROM MARBLE.
10.13	ADD ABA TEXTURED LOW VISION ANTI-SLIP TAPE ALONG TREAD EDGE, TYPICAL FOR ALL INTERIOR STAIRS.



A/E FIRMS
PRIME/ARCH:
STRATA ARCHITECTURE
1701 OAK STREET,
SUITE 100
KANSAS CITY, MO
T. 816.474.0900

DESIGNED:
CA/AG
CADD:
CA/ZA/EM
TECH. REVIEW:
AG
DATE:
10.27.2023

SUB SHEET NO.
**01
A5.3**

TITLE OF SHEET
MAURICE BATHHOUSE
VERTICAL CIRCULATION

REHABILITATE BATHHOUSES
HOT SPRINGS NATIONAL PARK

DRAWING NO.
**128
182951**
PMIS/PKG NO.
318915
SHEET
67 OF 286