

UTILITY NOTES

1. THE LOCATION AND/OR ELEVATION OF EXISTING UTILITIES AS SHOWN ON THESE PLANS IS BASED ON RECORDS OF THE VARIOUS UTILITY COMPANIES AND, WHERE POSSIBLE, MEASUREMENTS TAKEN IN THE FIELD. THE INFORMATION IS NOT TO BE RELIED UPON AS BEING EXACT OR COMPLETE. THE CONTRACTOR MUST CONTACT THE APPROPRIATE UTILITY COMPANIES AT LEAST 72 HOURS BEFORE ANY EXCAVATION TO REQUEST EXACT FIELD LOCATION OF EXISTING UTILITIES WITHIN THE WORK ZONE.
2. CONTRACTOR SHALL NOTIFY THE UTILITY AUTHORITIES' INSPECTORS 72 HOURS BEFORE CONNECTING TO ANY EXISTING FACILITIES. CONTRACTOR SHALL COORDINATE AND SCHEDULE TIE-INS/CONNECTIONS WITH ALL UTILITY COMPANIES.
3. ALL UNDERGROUND LINES SHALL BE INSTALLED, INSPECTED, AND APPROVED PRIOR TO BACKFILLING.
4. ALL NECESSARY INSPECTIONS AND/OR CERTIFICATIONS REQUIRED BY CODES AND/OR UTILITY COMPANIES SHALL BE PERFORMED PRIOR TO ANNOUNCED BUILDING POSSESSION AND THE FINAL CONNECTION OF SERVICE.
5. GENERAL CONTRACTOR IS TO COORDINATE WITH APPROPRIATE UTILITY COMPANIES PRIOR TO CONSTRUCTION, ADJUSTMENT, OR RELOCATION OF EXISTING UTILITIES.
6. THRUST BLOCKING SHALL BE PROVIDED AT ALL BENDS, TEES, FITTINGS AND FIRE HYDRANTS.
7. DIMENSIONS SHOWN ARE TO CENTERLINE OF PIPE OR FITTING.
8. MINIMUM HORIZONTAL SEPARATION BETWEEN WATERLINES AND SANITARY/STORM SEWERS SHALL BE AT LEAST TEN FEET. WHERE WATERLINES CROSS SANITARY SEWERS THE WATERLINE SHALL BE PLACED ABOVE THE SEWER WITH A MINIMUM VERTICAL SEPARATION, OUTSIDE-TO-OUTSIDE, OF 18". IF IT IS NOT POSSIBLE TO CONFORM TO THESE DIMENSIONS OR DEFINED PLACEMENT, THE WATERLINE SHALL BE PLACED BELOW THE SEWER AND ENCASED IN WATERTIGHT PIPE WITH SEALED WATERTIGHT ENDS EXTENDING AT LEAST TEN FEET EITHER SIDE OF THE CROSSING. A MINIMUM VERTICAL SEPARATION, OUTSIDE TO OUTSIDE, OF 18" SHALL BE MAINTAINED IF THE WATERLINE IS PLACED BELOW THE SEWER.
9. THE CONTRACTOR SHALL INCLUDE IN THE BID PRICE ALL MATERIAL AND LABOR ASSOCIATED WITH THE TESTING OF THE WATER AND SEWER LINES REQUIRED BY THE LOCAL AND/OR STATE AGENCIES.
10. TOPS OF EXISTING MANHOLES SHALL BE RAISED AS NECESSARY TO BE FLUSH WITH FINISHED PAVEMENT ELEVATIONS, AND MANHOLES IN UNPAVED AREAS TO BE 2" ABOVE FINISHED GROUND ELEVATIONS WITH WATER TIGHT LIDS.
11. ALL TRENCHING, PIPE LAYING, AND BACKFILLING SHALL BE IN ACCORDANCE WITH FEDERAL REGULATIONS.
12. REFER TO BUILDING PLANS FOR SITE LIGHTING AND ELECTRICAL PLAN.
13. ALL MATERIALS, CONSTRUCTION, AND INSPECTION FOR WATER AND SANITARY SEWER LINES SHALL BE PER THE SPECIFICATIONS OF THE APPROPRIATE AGENCY.
14. THE CONTRACTOR SHALL COORDINATE WITH THE FIRE DEPARTMENT AND THE WATER COMPANY TO PLAN THE IMPROVEMENTS TO THE WATER MAINS AND TO ENSURE ADEQUATE FIRE PROTECTION IS CONSTANTLY AVAILABLE TO THE SITE THROUGHOUT THE PROJECT. CONTRACTOR WILL BE RESPONSIBLE FOR ARRANGING ANY REQUIRED WATER MAIN SHUT-OFFS WITH THE WATER COMPANY DURING CONSTRUCTION. ALL COSTS ASSOCIATED WITH WATERMAIN SHUT-OFFS WILL BE THE RESPONSIBILITY OF THE CONTRACTOR; NO ADDITIONAL COMPENSATION WILL BE PROVIDED.
15. DAMAGE TO ALL EXISTING FACILITIES DESIGNATED TO REMAIN WILL BE REPLACED AT CONTRACTOR'S EXPENSE.
16. CONTRACTOR SHALL REFER TO ARCHITECTURAL PLANS FOR EXACT LOCATIONS AND DIMENSIONS OF VESTIBULES, SLOPE PAVING, SIDEWALKS, EXIT PORCHES, TRUCK DOCKS, PRECISE BUILDING DIMENSIONS, AND EXACT UTILITY ENTRANCE LOCATIONS.
17. GENERAL CONTRACTOR SHALL BE RESPONSIBLE FOR ALL TAP AND TIE ON FEES REQUIRED AS WELL AS COSTS OF UNDERGROUND SERVICE CONNECTIONS TO THE BUILDING.
18. GENERAL CONTRACTOR SHALL PROVIDE ALL CONDUITS AS SHOWN ON THE PLANS, VERIFY LOCATION OF UTILITY TIE-INS, AND PROVIDE NYLON PULL CORDS INSIDE THE CONDUIT.
19. THE CONTRACTOR SHALL INCLUDE IN BID PRICE THE DAILY RECORD KEEPING OF THE RECORD CONDITION OF ALL OF THE UNDERGROUND UTILITIES, CONSTRUCTION STAKE-OUT, PREPARATION OF THE NECESSARY/REQUIRED WATER AND SEWER RECORD DRAWINGS TO BE SUBMITTED, AND ALL OTHER INFORMATION REQUIRED FOR OBTAINING PERMITS AND RELEASE OF BONDS.
20. **ENERGIZED ELECTRICAL LINE SAFETY, WARNINGS, AND ADVANCED NOTICES:** ALL OWNERS, GENERAL CONTRACTORS, AND SUBCONTRACTORS ASSOCIATED WITH THIS PROJECT SHALL BE RESPONSIBLE FOR FAMILIARIZING THEMSELVES WITH, COMPLYING WITH, AND THE ENFORCEMENT OF ARKANSAS CODES AR ST § 11-5-307 AND § AR ST 11-5-308, AND ANY OTHER CURRENT STATE CODES PERTAINING TO ADVANCE NOTICE REQUIREMENTS AND FOR SAFETY OF ALL PERSONNEL, INCLUDING THE GENERAL PUBLIC, PERTAINING TO ANY WORK, MOVEMENT, AND ACTIVITY IN CLOSE PROXIMITY TO ANY ENERGIZED ELECTRICAL LINE.

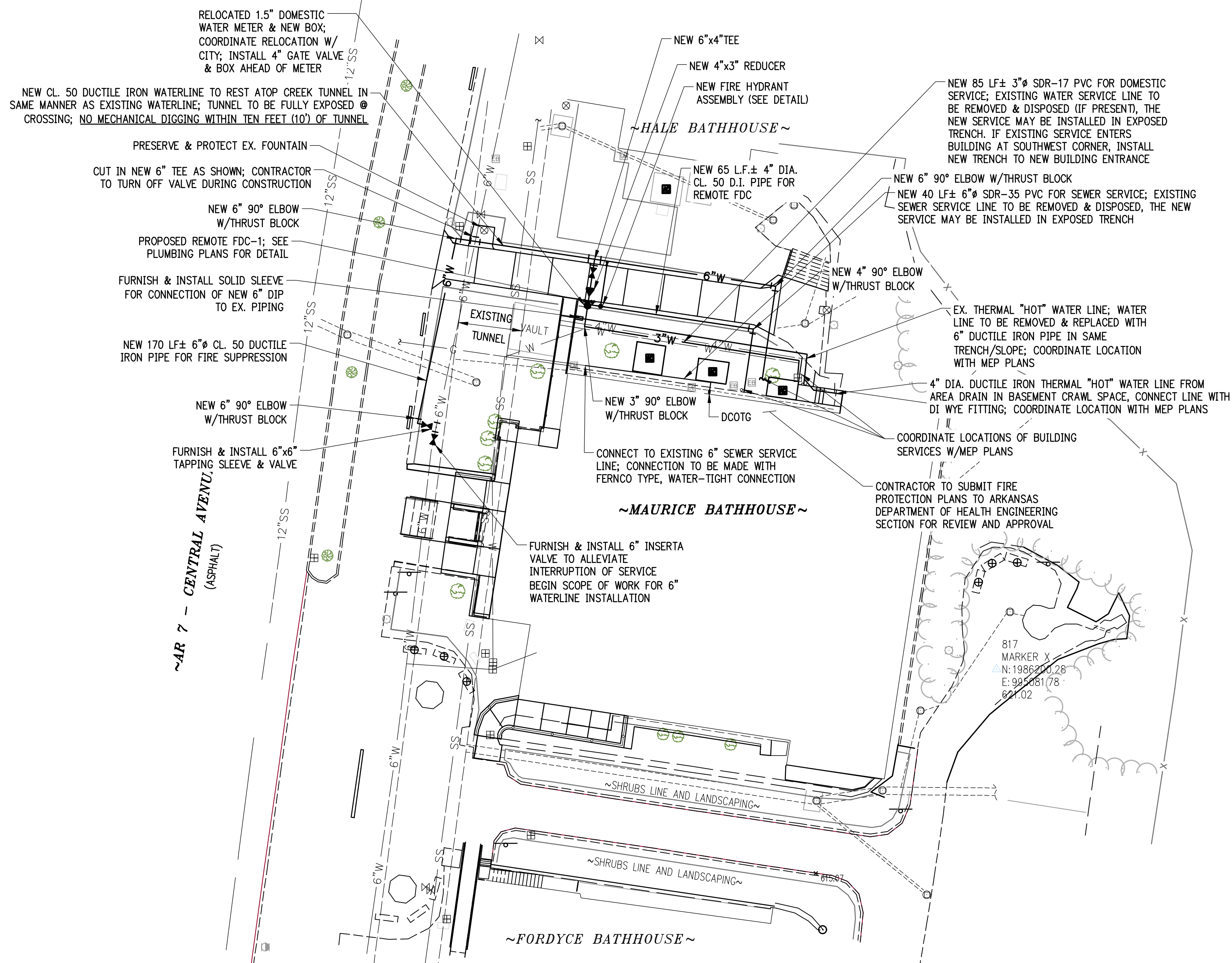

A/E FIRMS	DESIGNED:	SUB SHEET NO.
PRIME/ARCH: STRATA ARCHITECTURE 1501 GALE STREET SUITE 100 KANSAS CITY, MO 64104-4900	MB	01
CRAFTON TULL & ASSOCIATES, INC. 101 SPRING AR 71913 P.O. BOX 787286	CADD: RJ	C1.5
	TECH. REVIEW: MB	
	DATE: 10.27.2023	

TITLE OF SHEET	DRAWING NO.
MAURICE BATHHOUSE	128
PROPOSED UTILITY PLAN	182951
REHABILITATE BATHHOUSES HOT SPRINGS NATIONAL PARK	PMIS/PKG NO. 318915
	SHEET 9 OF 286

Arkansas One Call

 Know what's below.
 Call before you dig.