

**EROSION CONTROL NOTES**

1. CONTRACTOR SHALL BE RESPONSIBLE FOR IMPLEMENTING, MAINTAINING AND COMPLYING WITH THE STORMWATER POLLUTION PREVENTION PLAN (SWPPP) DATED OCTOBER 2023 AND PREPARED BY CRAFTON, TULL & ASSOCIATES.
2. CITY OF HOT SPRINGS STORMWATER PERMIT WILL NOT BE REQUIRED.
3. SITE INSPECTIONS MUST BE MADE AT LEAST ONCE EVERY 7 DAYS AND WITHIN 24 HOURS OF THE END OF A STORM EVENT 0.25" OR GREATER. THE SWPPP MAILBOX IS LOCATED AT THE RESERVE STREET ENTRANCE TO THE LIBBEY BATHHOUSE.
4. CONTRACTOR TO COORDINATE WITH OWNER FOR TEMPORARY CONCRETE WASHOUT LOCATION.

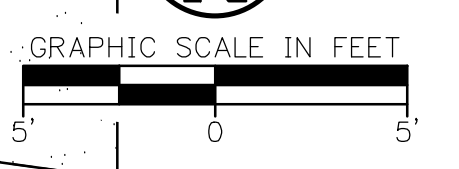
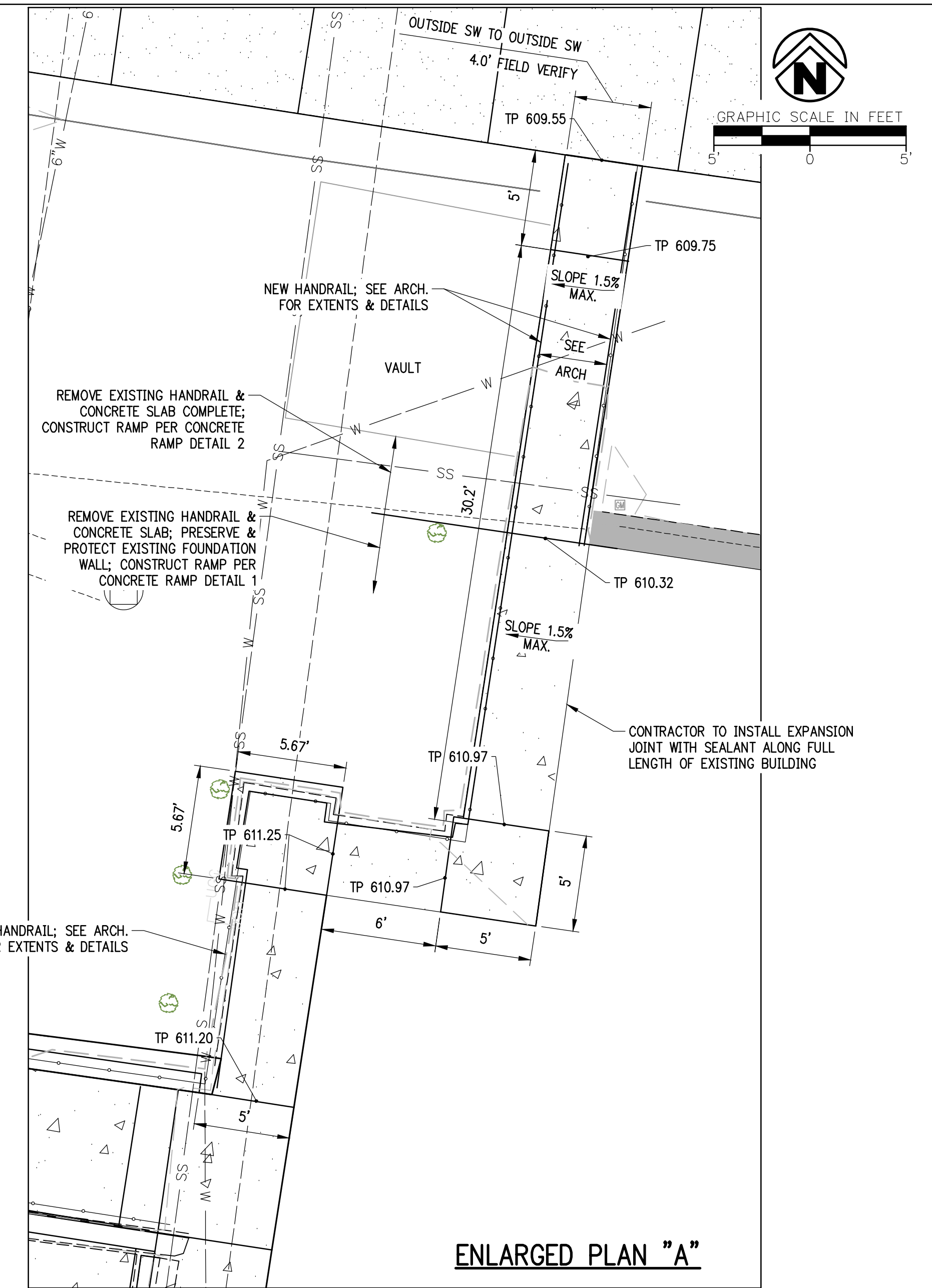
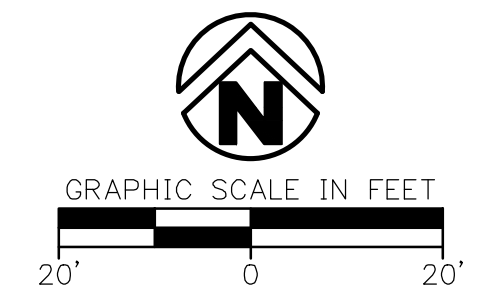

**GRADING AND DRAINAGE NOTES**

1. THE DESIGN, INSPECTION, AND CERTIFICATION OF ANY RETAINING WALL SHOWN OR REFERENCED HEREIN, INCLUDING BUT NOT LIMITED TO, SEGMENTAL RETAINING WALLS, MASS GRAVITY WALLS, GABION WALLS, ETC., GREATER THAN FORTY-EIGHT INCHES IN HEIGHT, SHALL BE BY OTHERS. ANY RETAINING WALL DATA SHOWN OR REFERENCED HEREIN SHALL BE FOR COORDINATION OF THE WALL LOCATION AND ELEVATIONS ONLY.
2. THE CONTRACTING OFFICER REPRESENTATIVE SHALL BE SOLELY RESPONSIBLE FOR OBTAINING AND PROVIDING SEPARATE AND INDEPENDENT RETAINING WALL DESIGNS, INSPECTIONS, AND CERTIFICATIONS BY A REGISTERED PROFESSIONAL ENGINEER. THIS SHALL ALSO APPLY TO ANY ASSOCIATED AND NECESSARY PUBLIC SAFETY DEVICES INCLUDING, BUT NOT LIMITED TO, PEDESTRIAN SAFETY RAILS.
3. THE LOCATION AND/OR ELEVATION OF EXISTING UTILITIES AS SHOWN ON THESE PLANS IS BASED ON RECORDS OF THE VARIOUS UTILITY COMPANIES, AND WHERE POSSIBLE, MEASUREMENTS TAKEN IN THE FIELD. THE INFORMATION IS NOT TO BE RELIED ON AS BEING EXACT OR COMPLETE. THE CONTRACTOR MUST CONTACT THE APPROPRIATE UTILITY COMPANIES AT LEAST 72 HOURS BEFORE ANY EXCAVATION TO REQUEST EXACT FIELD LOCATION OF EXISTING UTILITIES ON SITE OR IN RIGHT-OF-WAY. ALL UTILITIES MUST BE LOCATED PRIOR TO GRADING START.
4. ALL WORK SHALL BE DONE IN STRICT ACCORDANCE WITH THE PROJECT SPECIFICATIONS.
5. ALL CUT OR FILL SLOPES SHALL BE A MAX 3:1 SLOPE OR FLATTER UNLESS OTHERWISE NOTED.
6. IF ANY EXISTING STRUCTURES TO REMAIN ARE DAMAGED DURING CONSTRUCTION, IT SHALL BE THE CONTRACTOR'S RESPONSIBILITY TO REPAIR AND/OR REPLACE THE EXISTING STRUCTURE AS NECESSARY TO RETURN IT TO EXISTING CONDITION OR BETTER.
7. ALL STORM SEWER PIPE CONNECTIONS TO STRUCTURES SHALL BE GROUTED TO ASSURE CONNECTION AT STRUCTURE IS WATERTIGHT. ALL STORM SEWER STRUCTURES SHALL HAVE A SMOOTH UNIFORM POURED MORTAR INVERT FROM INVERT IN TO INVERT OUT.
8. ALL DRAINAGE STRUCTURES AND STORM SEWER PIPES SHALL MEET HEAVY DUTY TRAFFIC (H20) LOADING AND BE INSTALLED ACCORDINGLY WHEN IN PAVED AND TRAFFIC AREAS.
9. ALL STORM SEWER MANHOLES IN PAVED AREAS SHALL BE FLUSH WITH THE PAVEMENT AND SHALL HAVE TRAFFIC BEARING RINGS AND COVERS. MANHOLES IN UNPAVED AREAS SHALL BE 1" ABOVE FINISH GRADE. LIDS SHALL BE LABELED PER JURISDICTIONAL SPECIFICATIONS.
10. SITE GRADING SHALL NOT PROCEED UNTIL APPROPRIATE EROSION AND SEDIMENT CONTROL MEASURES HAVE BEEN INSTALLED. THE CONTRACTOR SHALL ADHERE TO ALL TERMS AND CONDITIONS AS OUTLINED IN THE GENERAL NPDES PERMIT AND THE SWPPP FOR STORMWATER DISCHARGE ASSOCIATED WITH CONSTRUCTION ACTIVITIES.
11. ALL UNSURFACED AREAS DISTURBED BY GRADING OPERATION SHALL RECEIVE 4 INCHES OF TOPSOIL TO FINAL GRADE. REFER TO THE LANDSCAPE PLAN.
12. TOPOGRAPHIC INFORMATION TAKEN FROM A TOPOGRAPHIC SURVEY BY LAND SURVEYORS. IF CONTRACTOR DOES NOT ACCEPT EXISTING TOPOGRAPHY AS SHOWN ON PLANS, CONTACT CONTRACTING OFFICER REPRESENTATIVE IMMEDIATELY.
13. THE CONTRACTOR SHALL ASSURE POSITIVE DRAINAGE AWAY FROM BUILDINGS FOR ALL NATURAL AND PAVED AREAS THROUGHOUT ALL PHASES OF CONSTRUCTION.
14. CONTRACTOR SHALL REFER TO ARCHITECTURAL PLANS FOR EXACT LOCATIONS AND DIMENSIONS OF VESTIBULES, SLOPE PAVING, SIDEWALKS, EXIT PORCHES, TRUCK DOCKS, PRECISE BUILDING DIMENSIONS AND EXACT UTILITY ENTRANCE LOCATIONS.
15. THE EARTHWORK FOR ALL BUILDING FOUNDATIONS AND SLABS SHALL BE IN ACCORDANCE WITH ARCHITECTURAL BUILDING PLANS AND SPECIFICATIONS.
16. EXISTING DRAINAGE STRUCTURES TO BE INSPECTED AND REPAIRED AS NEEDED, AND EXISTING PIPES TO BE CLEANED OUT TO REMOVE ALL SILT AND DEBRIS.
17. CONTRACTOR SHALL ADJUST AND/OR CUT EXISTING PAVEMENT AS NECESSARY TO ASSURE A SMOOTH FIT AND CONTINUOUS GRADE.
18. CONTRACTOR SHALL MAINTAIN ALL EXISTING PARKING, SIDEWALKS, DRIVES, ETC. CLEAR AND FREE FROM ANY CONSTRUCTION ACTIVITY AND/OR MATERIAL TO ENSURE EASY AND SAFE PEDESTRIAN AND VEHICULAR TRAFFIC TO AND FROM THE SITE.
19. IF WET AREAS ARE ENCOUNTERED ON-SITE THE CONTRACTOR SHALL COORDINATE WITH THE GEOTECHNICAL ENGINEER FOR THE DESIGN AND REPLACEMENT OF A FRENCH DRAIN SYSTEM.

**GRADING PLAN SPOT ELEVATIONS**

FG	FINISHED GRADE
TW	TOP WALL
BW	BOTTOM WALL
E	FLOW LINE
TC	TOP CURB
G	GUTTER
SW	SIDEWALK
TP	TOP PAVEMENT
X	EXISTING GRADE

Arkansas One Call



Know what's below.  
Call before you dig.

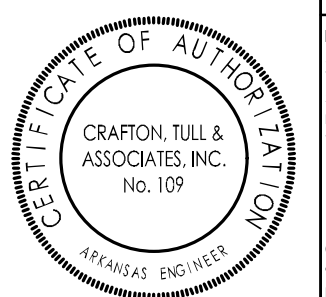
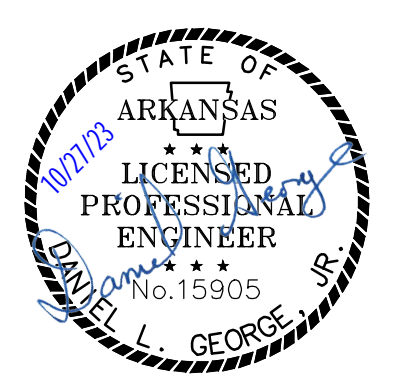

A/E FIRMS PRIME/ARCH: STRATA ARCHITECTURE 1511 GARDEN STREET SUITE 100 KANSAS CITY, MO 64108-4400	DESIGNED: MB	SUB SHEET NO. <b>01</b>	TITLE OF SHEET <b>MAURICE BATHHOUSE</b>	DRAWING NO. <b>128</b>
DATE: 10.27.2023	CADD: RU	<b>C1.3</b>	<b>PROPOSED GRADING &amp; DRAINAGE PLAN</b>	PMIS/PKG NO. 318915
	TECH. REVIEW: MB		<b>REHABILITATE BATHHOUSES</b>	SHEET 7 OF 286
			<b>HOT SPRINGS NATIONAL PARK</b>	

