

**LEGEND (CONSTRUCT)**

SYMBOLS	LINEWORK
•	EASEMENT
✱	CURB
⊙	INTERMEDIATE CONTOUR 1206
⊙	INDEX CONTOUR 1205
⊙	SANITARY SEWER CLEANOUT
⊙	SANITARY SEWER LINE SS
⊙	GAS METER
⊙	GAS VALVE
⊙	GAS LINE G
⊙	STORM SEWER PIPE
⊙	STRUCTURE NUMBER
⊙	WATER VALVE
⊙	WATER LINE W
⊙	UGT
⊙	UNDERGROUND TELEPHONE UGE
⊙	UNDERGROUND ELECTRIC OHE
⊙	OVERHEAD ELECTRIC FO
⊙	FIBER OPTIC
⊙	UNDERGROUND TELEVISION OHTV
⊙	OVERHEAD TELEVISION OHTV
⊙	CHAIN LINK FENCE
⊙	WOOD FENCE
⊙	BARBED WIRE FENCE
⊙	BUILDING SET BACK
⊙	RIGHT OF WAY
⊙	PROPERTY LINE
⊙	ROAD CENTERLINE

**LEGEND (EXISTING SYMBOLS)**

SYMBOLS	LINEWORK
○	EASEMENT
✱	CURB
⊙	INTERMEDIATE CONTOUR 1206
⊙	INDEX CONTOUR 1205
⊙	SANITARY SEWER CLEANOUT
⊙	SANITARY SEWER LINE SS
⊙	GAS METER
⊙	GAS VALVE
⊙	GAS LINE G
⊙	STORM SEWER PIPE
⊙	STRUCTURE NUMBER
⊙	WATER VALVE
⊙	WATER LINE W
⊙	UGT
⊙	UNDERGROUND TELEPHONE UGE
⊙	UNDERGROUND ELECTRIC OHE
⊙	OVERHEAD ELECTRIC FO
⊙	FIBER OPTIC
⊙	UNDERGROUND TELEVISION OHTV
⊙	OVERHEAD TELEVISION OHTV
⊙	CHAIN LINK FENCE
⊙	WOOD FENCE
⊙	BARBED WIRE FENCE
⊙	BUILDING SET BACK
⊙	RIGHT OF WAY
⊙	PROPERTY LINE
⊙	ROAD CENTERLINE

**GENERAL NOTES**

- THE DESIGN, INSPECTION, AND CERTIFICATION OF ANY RETAINING WALL SHOWN OR REFERENCED HEREIN, INCLUDING BUT NOT LIMITED TO, SEGMENTAL RETAINING WALLS, MASS GRAVITY WALLS, GABION WALLS, ETC., GREATER THAN FORTY-EIGHT INCHES IN HEIGHT, SHALL BE BY THE STRUCTURAL ENGINEER. ANY RETAINING WALL DATA SHOWN OR REFERENCED HEREIN SHALL BE ONLY FOR COORDINATION OF THE WALL LOCATION AND ELEVATIONS.
- THE EXISTENCE AND LOCATION OF ANY UNDERGROUND UTILITY PIPES OR STRUCTURES SHOWN ON THESE DRAWINGS IS BASED ON A SEARCH OF THE AVAILABLE RECORDS. TO THE BEST OF OUR KNOWLEDGE THERE ARE NO EXISTING UTILITIES EXCEPT AS SHOWN ON THESE DRAWINGS. THE GOVERNMENT, NOR THE AE TEAM ASSUMES NO RESPONSIBILITY REGARDING THE ACCURACY OF THE DEPICTED LOCATION(S) OF THE UNDERGROUND FACILITIES ON THESE DRAWINGS. CONTRACTOR IS RESPONSIBLE FOR THE LOCATION AND PROTECTION OF ANY OTHER FACILITIES NOT SHOWN ON THESE DRAWINGS. CONTRACTOR SHALL VERIFY LOCATION OF ALL FACILITIES BEFORE BEGINNING WORK.
- IN ACCORDANCE WITH GENERALLY ACCEPTED CONSTRUCTION PRACTICES, THE CONTRACTOR WILL BE SOLELY AND COMPLETELY RESPONSIBLE FOR CONDITIONS OF THE JOB SITE INCLUDING SAFETY OF ALL PERSONS AND PROPERTY DURING PERFORMANCE OF THE WORK. THIS REQUIREMENT WILL APPLY CONTINUOUSLY AND NOT BE LIMITED TO NORMAL WORKING HOURS. THE DUTY OF THE ENGINEER TO CONDUCT CONSTRUCTION REVIEW OF THE CONTRACTOR'S PERFORMANCE IS NOT INTENDED TO INCLUDE REVIEW OF THE ADEQUACY OF THE CONTRACTOR'S SAFETY MEASURES IN OR NEAR THE CONSTRUCTION SITE.
- CONTRACTOR SHALL NOT CAUSE ANY LONG-TERM INCONVENIENCE TO THE PUBLIC, ADJACENT PROPERTY OWNERS, PEDESTRIANS, ETC. DURING CONSTRUCTION OF THIS PROJECT. CONTRACTOR SHALL PROVIDE ACCESS TO ALL ADJACENT PROPERTIES AT ALL TIMES DURING CONSTRUCTION.
- CONTRACTOR SHALL CONTACT THE CONTRACTING OFFICER REPRESENTATIVE FOR CLARIFICATION IF A DISCREPANCY OR INCONSISTENCY IS IDENTIFIED IN THE PLANS OR SPECIFICATIONS.
- CONTRACTOR IS RESPONSIBLE FOR THE DESIGN AND IMPLEMENTATION OF ALL SHEETING, SHORING, AND SPECIAL EXCAVATION MEASURES REQUIRED

- ON THE PROJECT WHICH ARE NECESSARY TO CONFORM TO OSHA, FEDERAL, STATE AND LOCAL REGULATIONS.
- ENGINEER OF RECORD SHALL OBSERVE THE TESTING OF THE WATER & SEWER MAINS. BEYOND THAT SCOPE, THE CONTRACTING OFFICER REPRESENTATIVE (COR) IS RESPONSIBLE FOR CONSTRUCTION ADMINISTRATION OR OBSERVATION SERVICES FOR THE WORK INDICATED ON THESE DRAWINGS. THEREFORE, AE TEAM ASSUMES NO RESPONSIBILITY FOR THE INTERPRETATION, COORDINATION, OR ADMINISTRATION OF THESE DOCUMENTS AND/OR DEVIATIONS THEREOF. FURTHERMORE, THE AE TEAM WILL NOT BE RESPONSIBLE FOR ANY EFFECTS THAT ANY CHANGES TO THESE DOCUMENTS MAY HAVE ON ANY RELATED TRADES, CONSTRUCTION SEQUENCES, OR OPERATION OF THE COMPLETED PROJECT EXCEPT AS SPECIFICALLY NOTED IN THE AGREEMENT BETWEEN AE TEAM AND THE GOVERNMENT.
- ENERGIZED ELECTRICAL LINE SAFETY, WARNINGS, AND ADVANCED NOTICES:** ALL OWNERS, GENERAL CONTRACTORS, AND SUBCONTRACTORS ASSOCIATED WITH THIS PROJECT SHALL BE RESPONSIBLE FOR FAMILIARIZING THEMSELVES WITH, COMPLYING WITH, AND THE ENFORCEMENT OF ARKANSAS CODES AR ST § 11-5-307 AND § AR ST 11-5-308 AND ANY OTHER CURRENT STATE CODES PERTAINING TO ADVANCE NOTICE REQUIREMENTS AND FOR SAFETY OF ALL PERSONNEL, INCLUDING THE GENERAL PUBLIC, PERTAINING TO ANY WORK, MOVEMENT, AND ACTIVITY IN CLOSE PROXIMITY TO ANY ENERGIZED ELECTRICAL LINE.

**SITE NOTES**

- THE DESIGN, INSPECTION, AND CERTIFICATION OF ANY RETAINING WALL SHOWN OR REFERENCED HEREIN, INCLUDING BUT NOT LIMITED TO, SEGMENTAL RETAINING WALLS, MASS GRAVITY WALLS, GABION WALLS, ETC., GREATER THAN FORTY-EIGHT INCHES IN HEIGHT, SHALL BE BY OTHERS. ANY RETAINING WALL DATA SHOWN OR REFERENCED HEREIN SHALL BE FOR COORDINATION OF THE WALL LOCATION AND ELEVATIONS ONLY.
- ALL WORK AND MATERIALS SHALL COMPLY WITH ALL CITY/COUNTY/STATE/FEDERAL REGULATIONS AND CODES AND OSHA STANDARDS.
- CONTRACTOR SHALL REFER TO ARCHITECTURAL PLANS FOR EXACT LOCATIONS AND DIMENSIONS OF VESTIBULES, SLOPE PAVING, SIDEWALKS, EXIT PORCHES, TRUCK DOCKS, PRECISE BUILDING DIMENSIONS AND EXACT UTILITY ENTRANCE LOCATIONS.
- ALL CURB DIMENSIONS AND RADII ARE TO BACK OF CURB UNLESS OTHERWISE NOTED.
- ALL PAVEMENT MARKINGS DIMENSIONS BACK OF CURB UNLESS OTHERWISE NOTED.
- ALL WORK SHALL BE DONE IN STRICT ACCORDANCE WITH THE PROJECT SPECIFICATIONS.
- ALL CURB/SIDEWALK/HANDICAP RAMP DESIGNS SHALL CONFORM TO ABA STANDARDS OR LOCAL RESTRICTIVE CODES, WHICHEVER IS MORE RESTRICTIVE.
- CONTRACTOR SHALL ENSURE ALL NECESSARY PERMITS ARE OBTAINED PRIOR TO CONSTRUCTION START.
- CONTRACTOR SHALL MATCH NEW CURB AND CUTTER, CONCRETE, AND PAVEMENT TO EXISTING IN GRADE AND ALIGNMENT.
- CONTRACTOR SHALL MAINTAIN ALL EXISTING PARKING, SIDEWALKS, DRIVES, ETC. CLEAR AND FREE FROM ANY CONSTRUCTION ACTIVITY AND/OR MATERIAL TO ENSURE EASY AND SAFE PEDESTRIAN AND VEHICULAR TRAFFIC TO AND FROM THE SITE.

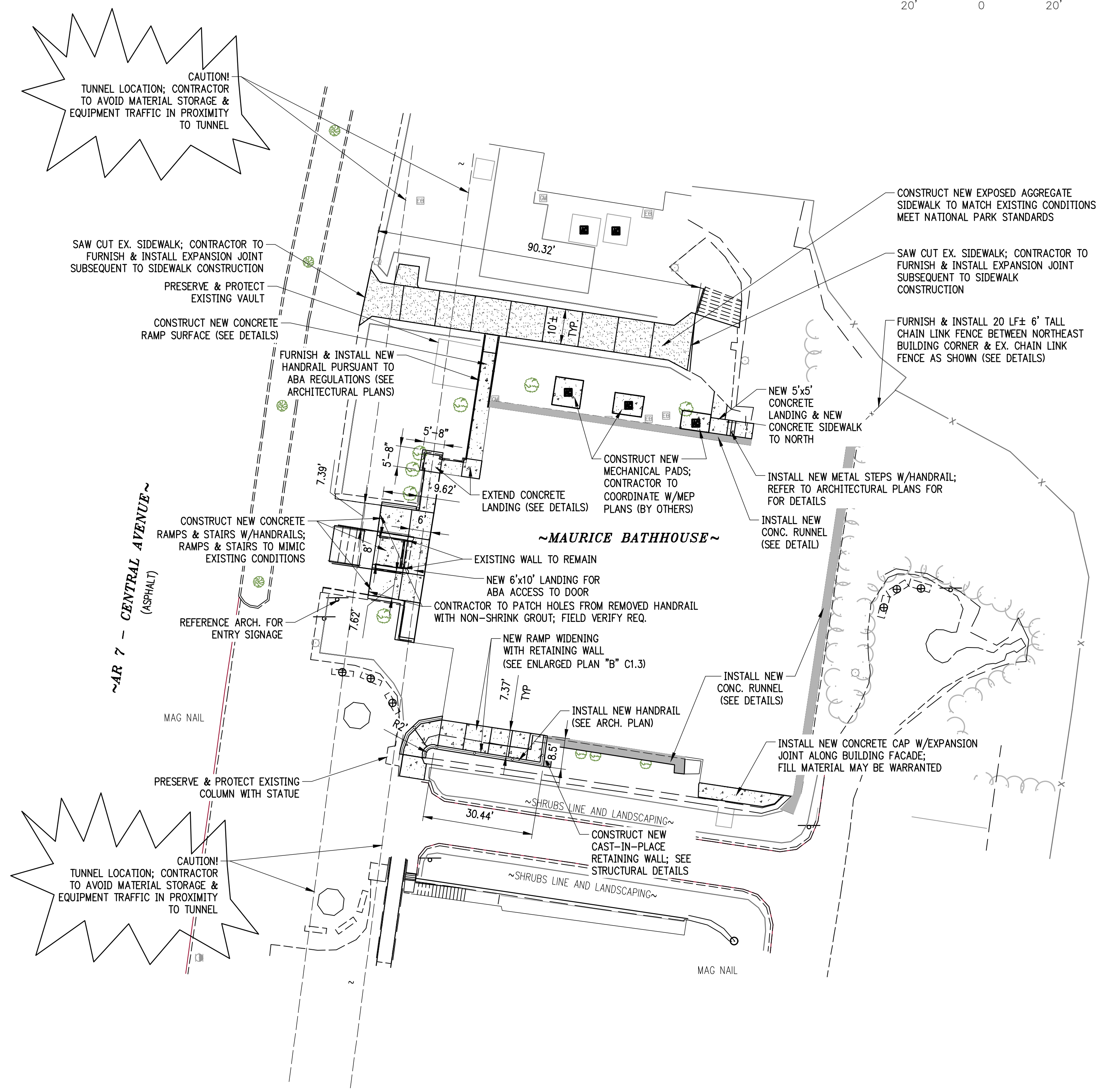

CAUTION! TUNNEL LOCATION; CONTRACTOR TO AVOID MATERIAL STORAGE & EQUIPMENT TRAFFIC IN PROXIMITY TO TUNNEL

CAUTION! TUNNEL LOCATION; CONTRACTOR TO AVOID MATERIAL STORAGE & EQUIPMENT TRAFFIC IN PROXIMITY TO TUNNEL

Arkansas One Call



Know what's below.  
Call before you dig.

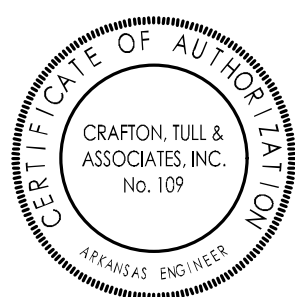
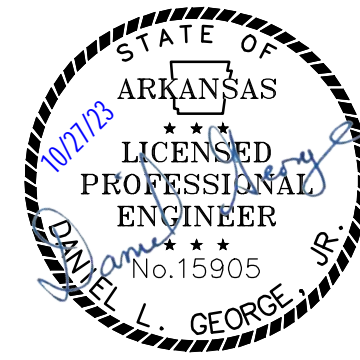

A/E FIRMS PRIME/ARCH: STRATA ARCHITECTURE 1701 GINA STREET SUITE 100 KANSAS CITY, MO 64114-4740	DESIGNED: MB	SUB SHEET NO. <b>01</b> <b>C1.1</b>	TITLE OF SHEET MAURICE BATHHOUSE	DRAWING NO. <b>128</b> <b>182951</b>
CADD: RU	TECH. REVIEW: MB		PROPOSED SITE PLAN	PMIS/PKG NO. 318915
DATE: 10.27.2023			REHABILITATE BATHHOUSES HOT SPRINGS NATIONAL PARK	SHEET 5 OF 286