

SHEET NOTES

MASTER KEYNOTE LIST FOR REPAIRS	
KEY	REPAIR DESCRIPTION
C-1	SLAB ON GRADE REPLACEMENT, SEE DETAIL 1 ON S5.2.
C-2	INFILL SMALL OPENING IN CONCRETE SLAB, LESS THAN 6" DIAMETER, SEE DETAIL 2 ON S5.2.
C-3	INFILL OPENING IN CONCRETE SLAB, 6" TO 24" SQUARE, SEE DETAILS 3 & 4 ON S5.2.
C-4	SPALL, DELAMINATION, OR INADEQUATE COVER AT CONCRETE SLAB/WALL. REFER TO DETAILS 5,6, & 7 ON S5.2 FOR EXPOSURE AND CONDITION OF STEEL REINFORCEMENT.
C-5	CRACK REPAIR, SEE DETAILS 1 & 2 ON S5.3 BASED ON CRACK SIZE.
C-6	SPALL, DELAMINATION, OR INADEQUATE COVER AT CONCRETE BEAM. REFER TO DETAIL 4 ON S5.3 FOR EXPOSURE AND CONDITION OF STEEL REINFORCEMENT.
C-7	FULL BAY CONCRETE SLAB REPLACEMENT, SEE DETAIL 3 & 5 ON S5.3.
S-1	REPLACEMENT OF POSITIVE STEEL ROOF RAFTER ATTACHMENT.

1. QUANTITY DENOTES NUMBER OF INSTANCES, SQUARE FOOTAGE (SF), OR LINEAR FOOTAGE (LF) OF REPAIR DEPENDENT UPON REPAIR TYPE. SEE REPAIR QUANTITIES ON S5.1 FOR TOTAL REPAIR AMOUNTS.
2. CONTRACTOR SHALL VERIFY ALL CONDITIONS IN FIELD AND SHALL EXPOSE REPAIR AREAS DOWN TO SOUND CONCRETE PRIOR TO REPAIR INSTALLATION.
3. CONTRACTOR SHALL COORDINATE REPAIR WORK WITH MEANS AND METHODS AND SEQUENCE OF OTHER RENOVATION WORK/TRADES.
4. FLOOR FRAMING REPAIRS SHOWN ON PLAN ARE INTENDED TO BE UNDERSIDE REPAIRS PERFORMED FROM THE LEVEL BELOW, TYPICAL UNLESS NOTED OTHERWISE. CARE SHOULD BE TAKEN TO MINIMIZE IMPACT TO NEARBY FRAMING ELEMENTS OR WALLS BELOW. WALL REPAIRS SHOWN ON PLAN ARE INTENDED TO BE PERFORMED FROM THE LEVEL THAT IT IS INDICATED.
5. EACH KEYNOTE LEADER REPRESENTS AN INDIVIDUAL INSTANCE OF REPAIR WITH THE QUANTITY INDICATED. FOR EXAMPLE:

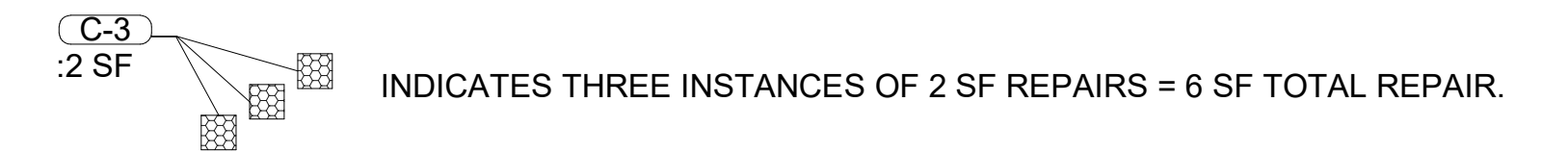

6. REFER TO DETAILS ON S5.X SERIES SHEETS FOR APPLICABLE DETAILS.
7. ALL REPAIR AREAS ARE BASED ON LIMITED VISUAL OBSERVATION. UNIT PRICING SHALL BE PROVIDED FOR EACH REPAIR TYPE AND FINAL QUANTITIES RECONCILED WITH TABLE OF S5.1. COTR SHALL REVIEW GENERAL EXTENTS AND QUANTITIES OF REPAIRS WITH CONTRACTOR IN THE FIELD PRIOR TO REPAIR.

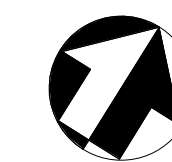
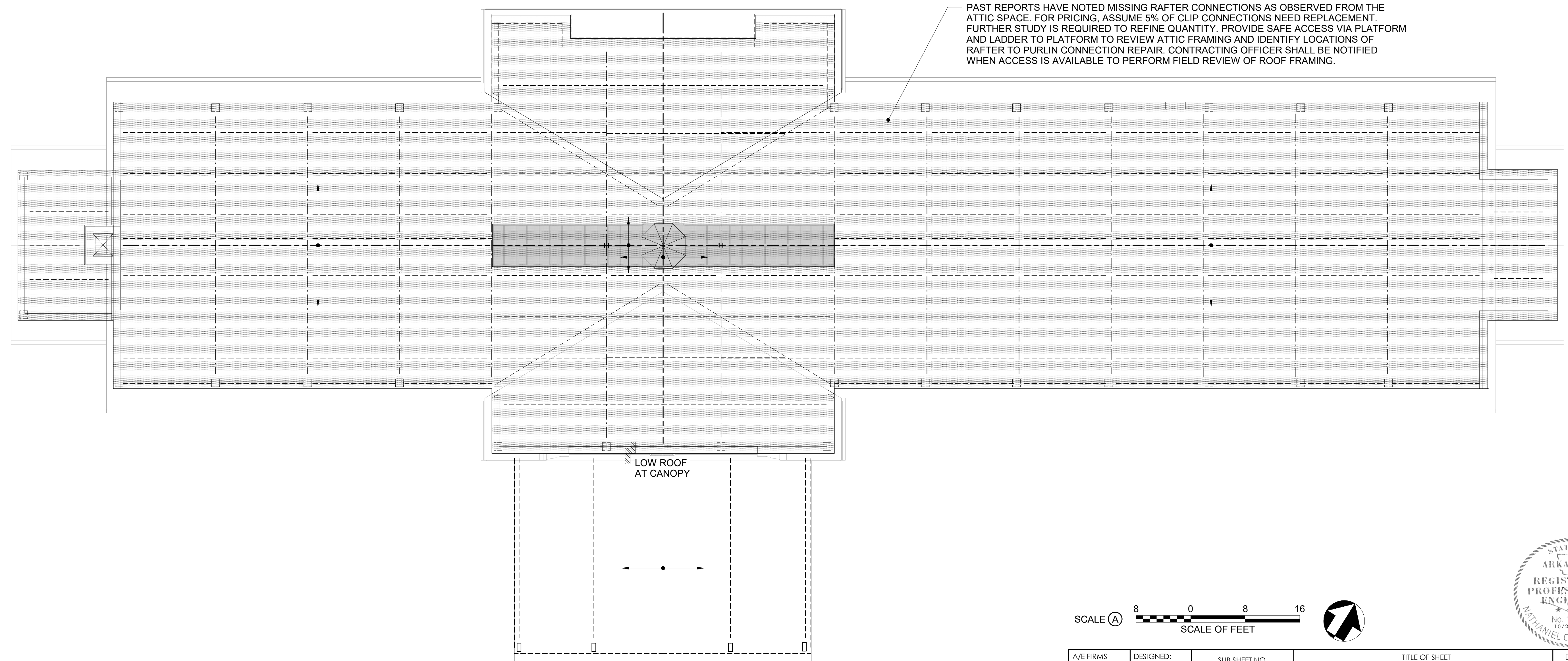

1 ROOF REPAIR PLAN
S1.6 1/8" - 1'-0" SCALE (A)

A/E FIRMS ARCH: QUINN EVANS 219 1/2 N. MAIN STREET ANN ARBOR, MI T: 734.663.5888 ENG: SIMAN 211 N. 4TH AVE. ANN ARBOR, MI T: 734.900.2460	DESIGNED: KH	SUB SHEET NO. 02 S1.6	TITLE OF SHEET LIBBEY BATHHOUSE ROOF REPAIR PLAN	DRAWING NO. 128
	CADD: CM		PMIS/PKG NO. 318915	
	TECH. REVIEW: NH		REHABILITATE BATHHOUSES HOT SPRINGS NATIONAL PARK	220 OF 286
	DATE: 10.27.2023			