

8 1/107 HM DOOR FRAME - HEAD AT EXISTING TRANSOM
3" = 1'-0" REFERRED FROM:

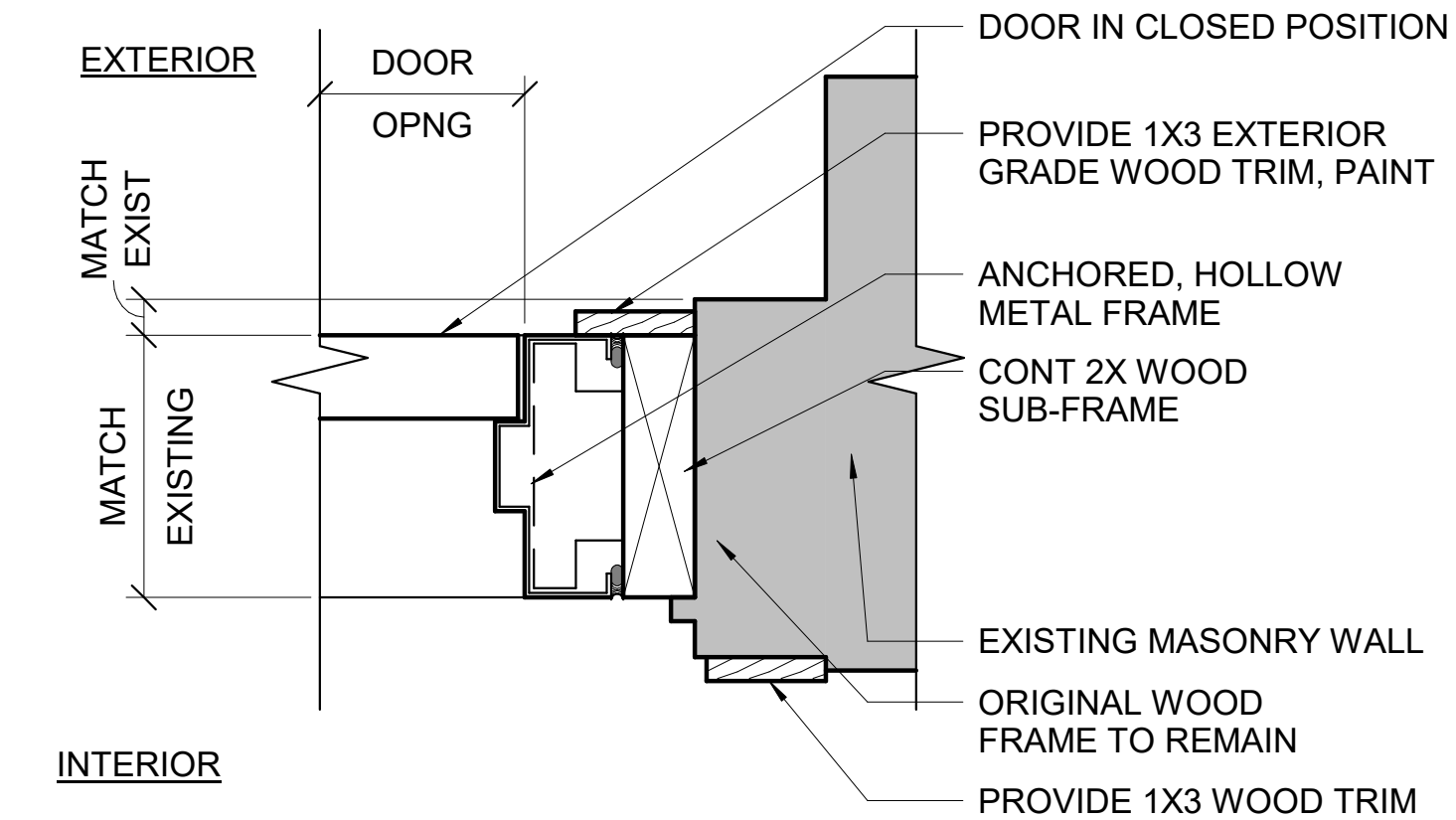

7 1/107 HM DOOR FRAME - JAMB
3" = 1'-0"

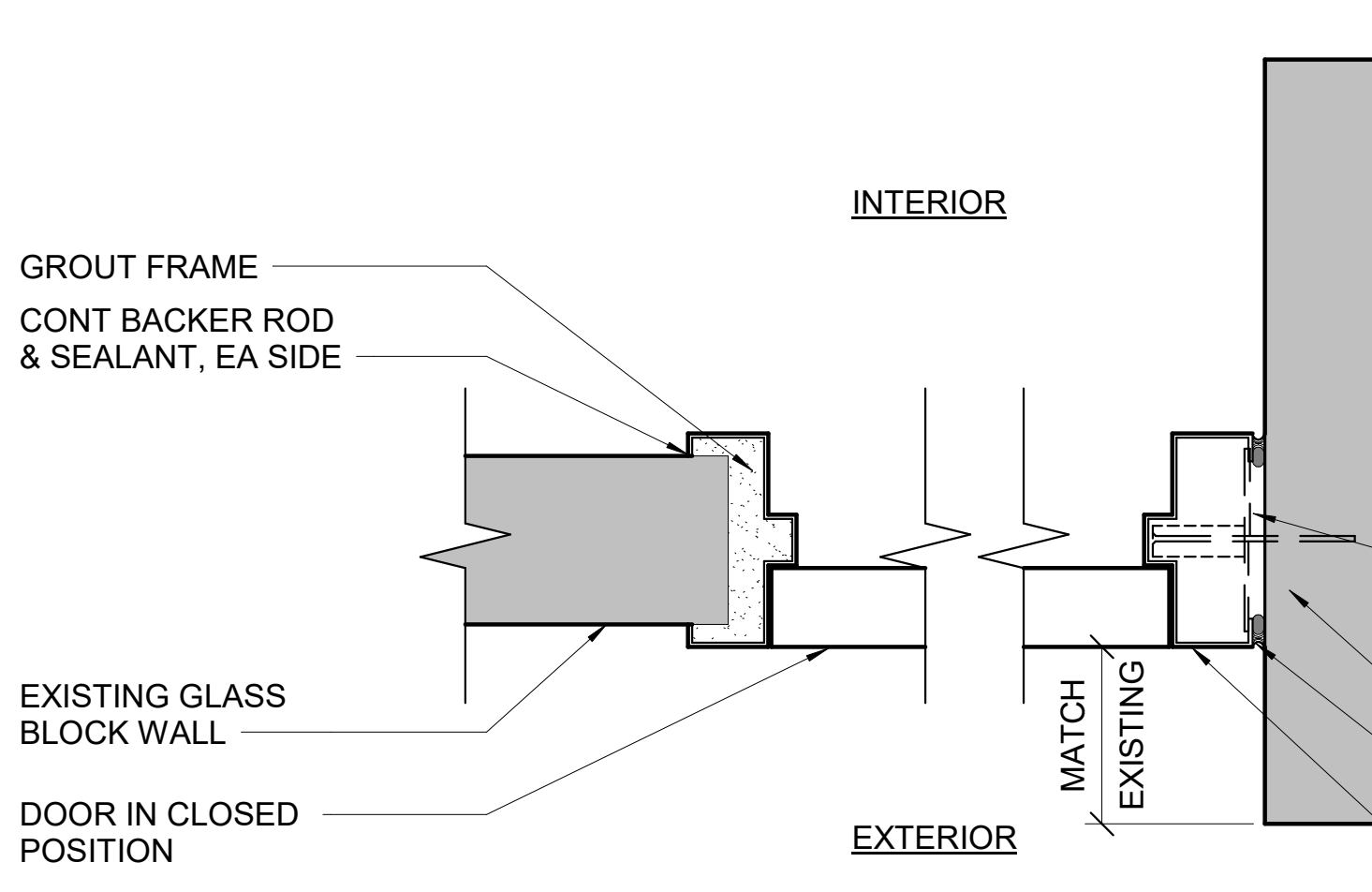

6 1/117 HM DOOR FRAME - JAMB
3" = 1'-0"

DOOR SCHEDULE																
DOOR NUMBER	LOCATION	SIZE			DOOR			FRAME			DETAILS			FIRE RATING	HARD WARE	NOTES
		W	H	T	TYPE	MAT'L	FINISH	TYPE	MAT'L	FINISH	HEAD	JAMB	SILL			
LOWER LEVEL																
100	LOBBY	6'-0"	7'-0"	1 3/4"	ETR	ALUM	ETR	ETR	ALUM	ETR	---	---	---	---	HD-1	
106	MECHANICAL	3'-0"	6'-8"	1 3/4"	B	HM	PTD	F2	HM	PTD	2/A6.1	2/A6.1	1/A6.1	---	HD-2	
107	MECHANICAL	2'-8"	6'-8"	1 3/4"	B	HM	PTD	F2	HM	PTD	8/A6.1	7/A6.1	1/A6.1	---	HD-3	1
117	POOL ROOM	2'-8"	6'-1"	1 3/4"	B	HM	PTD	F2	HM	PTD	3/A6.1	6/A6.1	1/A6.1	---	HD-2	
UPPER LEVEL																
200A	LOBBY	4'-4"	6'-10"	1 1/2"	ETR	WD	ETR	ETR	WD	ETR	---	---	---	---	-	3 & 4
200B	LOBBY	4'-4"	6'-10"	1 1/2"	A	WD	PTD	ETR	WD	PTD	---	---	---	---	HD-6	2
200C	LOBBY	4'-4"	6'-10"	1 1/2"	ETR	WD	ETR	ETR	WD	ETR	---	---	---	---	-	3 & 4
202	MEN'S WEIGHT / POOL ROOM	3'-0"	7'-0"	1 3/4"	B	HM	PTD	F2	HM	PTD	4/A6.1	5/A6.1	1/A6.1	---	HD-5	
220	CABINET ROOM	3'-0"	7'-0"	1 3/4"	ETR	HM	ETR	ETR	HM	ETR	---	---	---	---	HD-7	
Grand total: 9																

GENERAL NOTES
A. FIELD VERIFY ALL EXISTING OPENINGS TO RECEIVE NEW DOOR LEAFS AND/OR FRAMES.

DOOR MATERIAL LEGEND

ALUM	ALUMINUM
HM	HOLLOW METAL
WD	WOOD
PT	PAINT
ETR	EXISTING TO REMAIN

- DOOR REMARKS**
- REMOVE EXISTING ADDED WOOD FRAMING/TRIM, LEAVING ORIGINAL WOOD FRAME/TRIM IN PLACE. PACK AROUND THE ORIGINAL WITH NEW WOOD SUBFRAMING TO CREATE NEW FLUSH OPENING FOR NEW HM FRAME TO SIT WITHIN.
 - PREP AND REPAINT EXISTING FRAME WHERE DOOR LEAFS TO BE REPLACED.
 - REMOVE INTERIOR DOOR PULLS. INSTALL VERTICAL 2X FRAMING AGAINST DOOR LEAFS AT INTERIOR MEETING STILE TO COVER GAP BETWEEN LEAFS. CONTINUOUS SEALANT AT EDGES OF 2X AND DOOR FACE.
 - PIN DOOR IN PLACE USING FIXED SCREWS BETWEEN DOOR LEAF AND FRAME AT INTERIOR JAMBS. MINIMUM THREE LOCATIONS AT EACH SIDE. DO NOT SCREW THROUGH INTERIOR STOP OR TRIM.

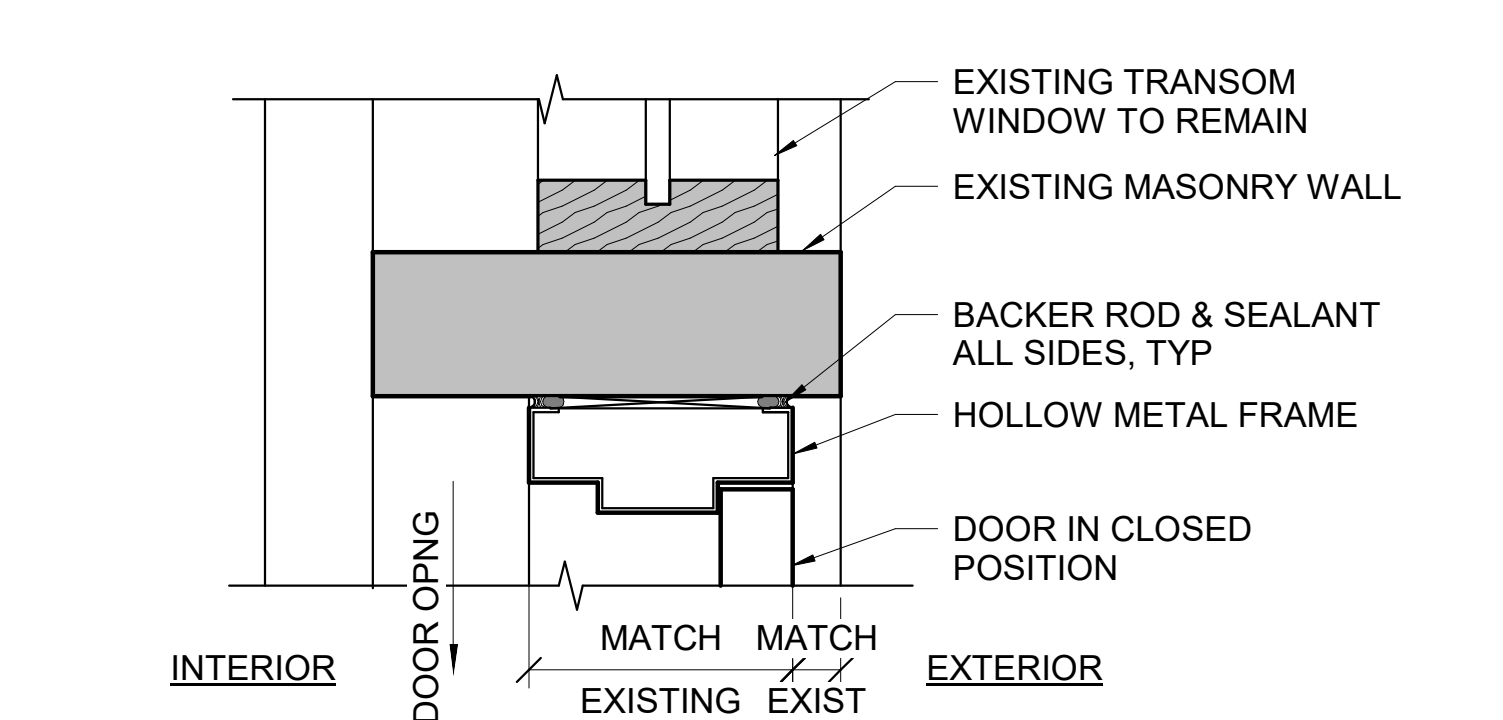

4 1/202 HM DOOR FRAME - HEAD AT EXISTING TRANSOM
3" = 1'-0"

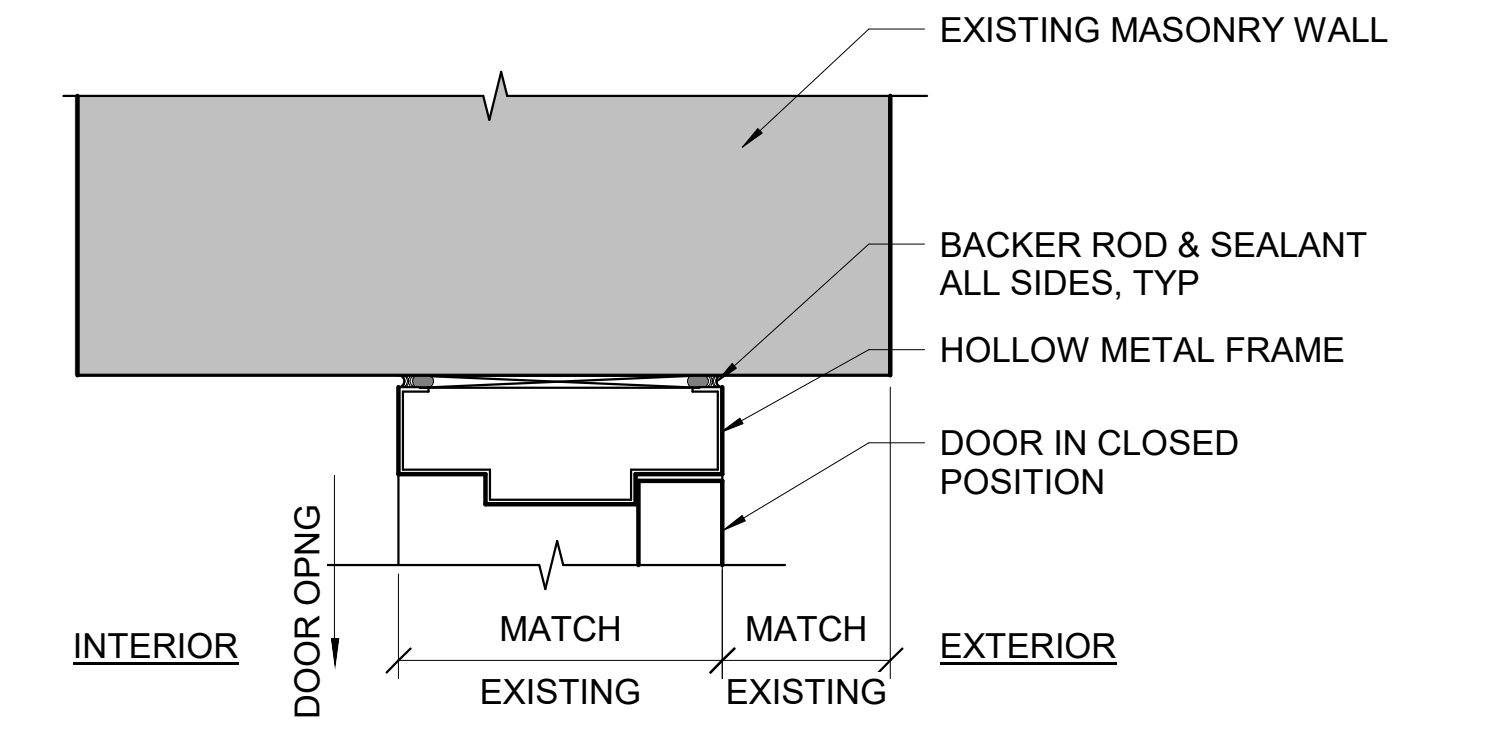

3 HM DOOR FRAME AT EXISTING - HEAD
3" = 1'-0"

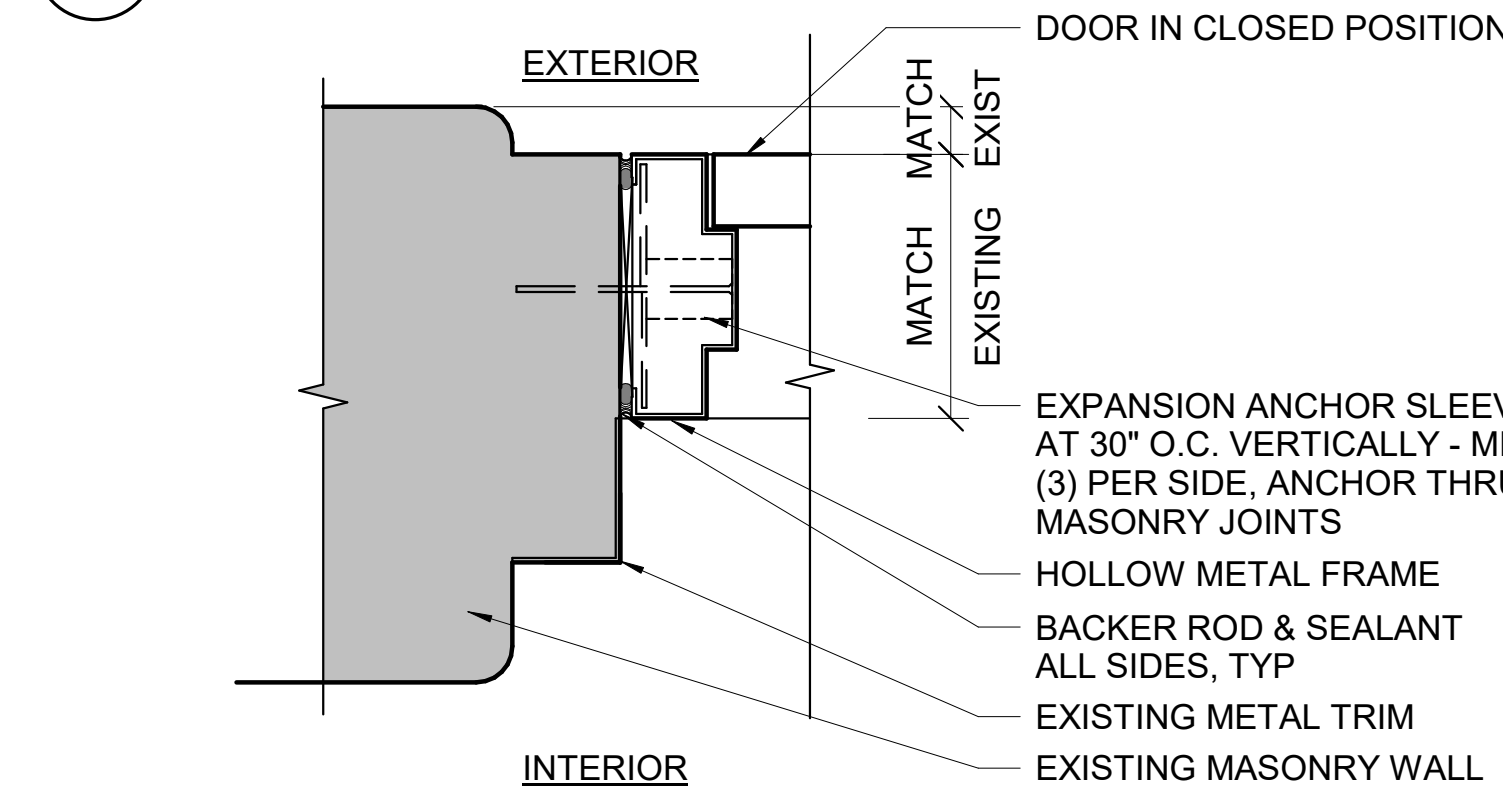

5 1/202 HM DOOR FRAME - JAMB
3" = 1'-0"

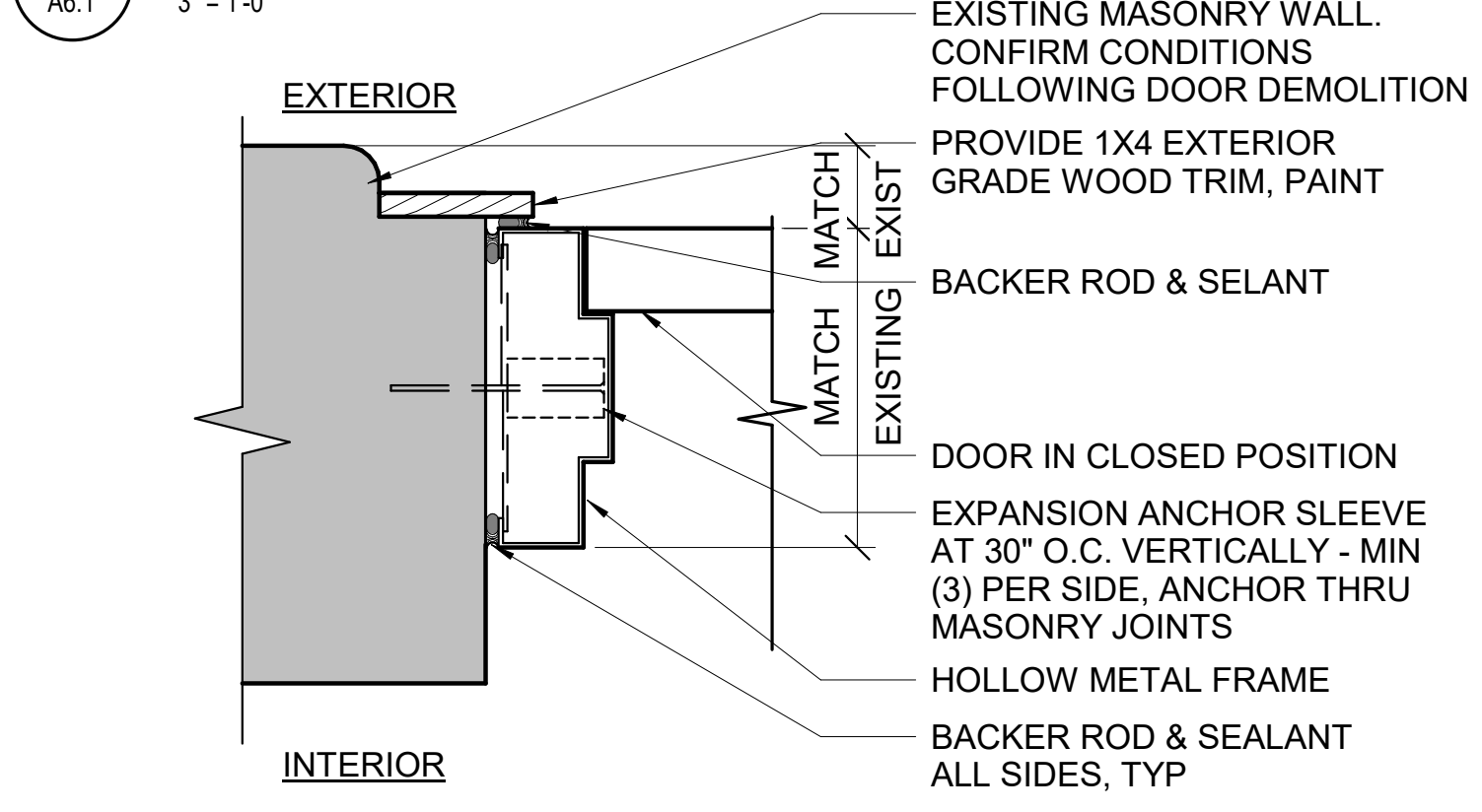

2 HM DOOR FRAME AT EXISTING - JAMB (HEAD SIM)
3" = 1'-0"

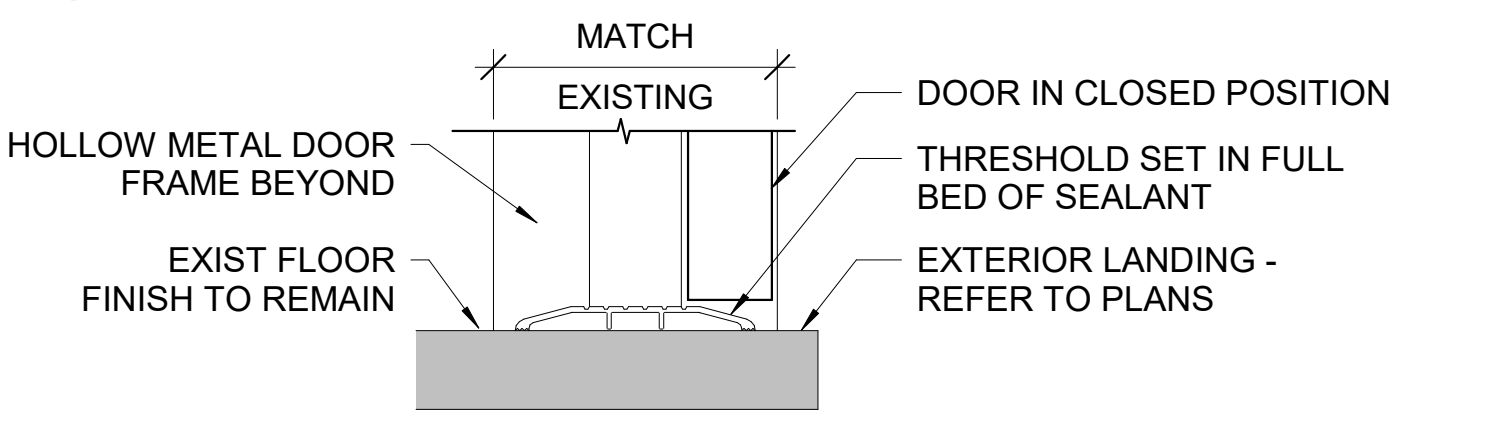

1 HM DOOR AT EXISTING - SILL
3" = 1'-0"

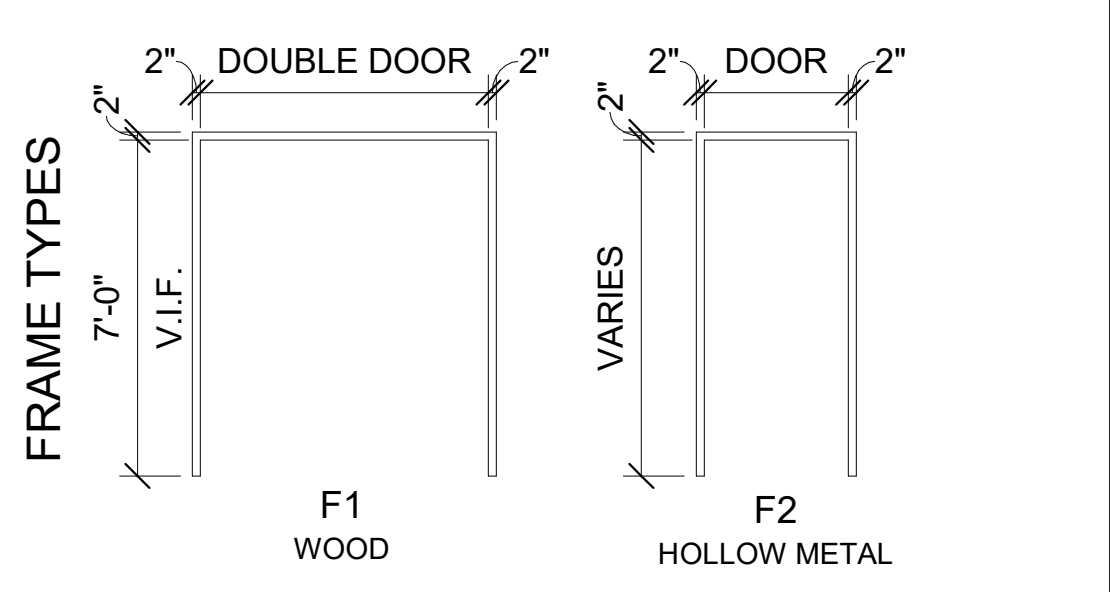
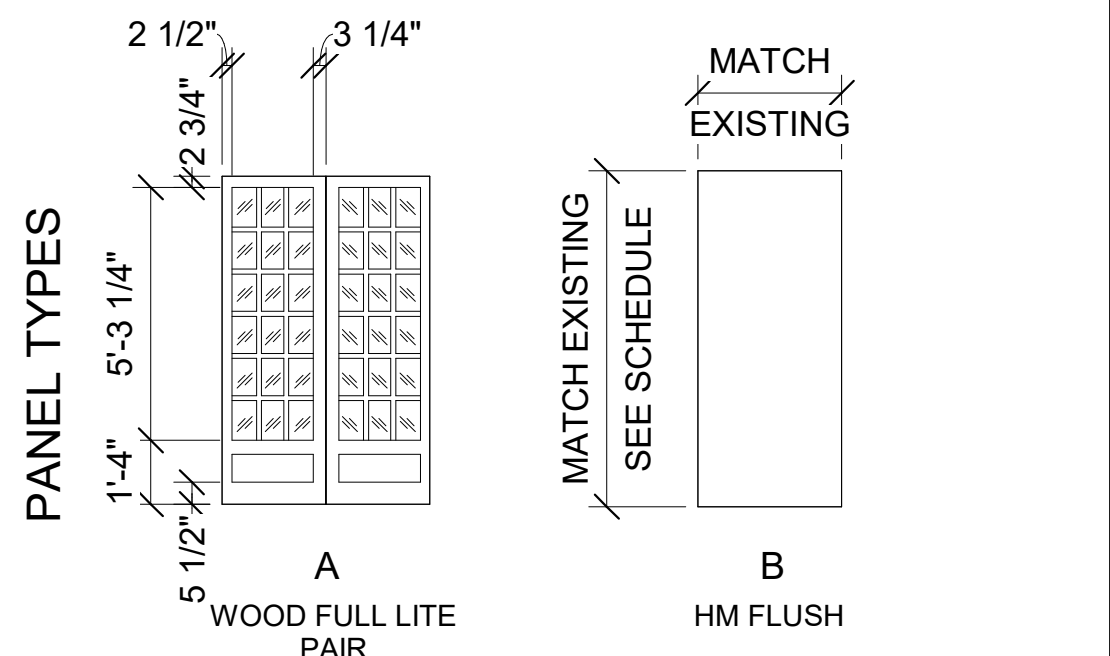

DOOR TYPES LEGEND
1/4" = 1'-0"

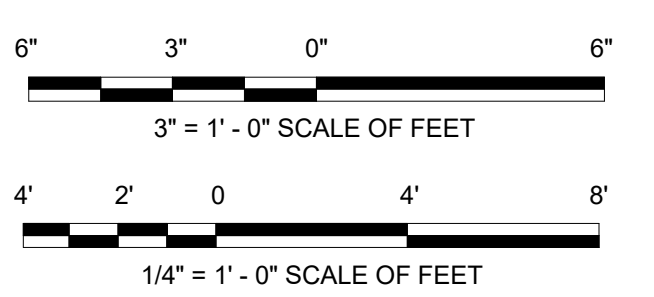

A/E FIRMS	DESIGNED: GK	SUB SHEET NO.	TITLE OF SHEET	DRAWING NO.
ARCH: QUINN EVANS 219 1/2 N. MAIN STREET ANN ARBOR, MI T: 734.663.5888	CADD: GK	02 A6.1	LIBBEY BATHHOUSE DOOR SCHEDULE AND DETAILS REHABILITATE BATHHOUSES HOT SPRINGS NATIONAL PARK	128 182951
TECH. REVIEW: KG	PMIS/PKG NO.			
DATE: 10.27.2023	318915			
				SHEET 212 OF 286

11/20/2023 8:06:03 PM