

EROSION CONTROL NOTES

1. CONTRACTOR SHALL BE RESPONSIBLE FOR IMPLEMENTING, MAINTAINING AND COMPLYING WITH THE STORMWATER POLLUTION PREVENTION PLAN (SWPPP) DATED OCTOBER 2023 AND PREPARED BY CRAFTON, TULL & ASSOCIATES.
2. A CITY OF HOT SPRINGS STORMWATER PERMIT WILL NOT BE REQUIRED.
3. SITE INSPECTIONS MUST BE MADE AT LEAST ONCE EVERY 7 DAYS AND WITHIN 24 HOURS OF THE END OF A STORM EVENT 0.25" OR GREATER.
4. THE SWPPP MAILBOX IS LOCATED AT THE RESERVE STREET ENTRANCE TO THE LIBBEY BATHHOUSE.
5. CONTRACTOR TO COORDINATE WITH OWNER FOR TEMPORARY CONCRETE WASHOUT LOCATION.

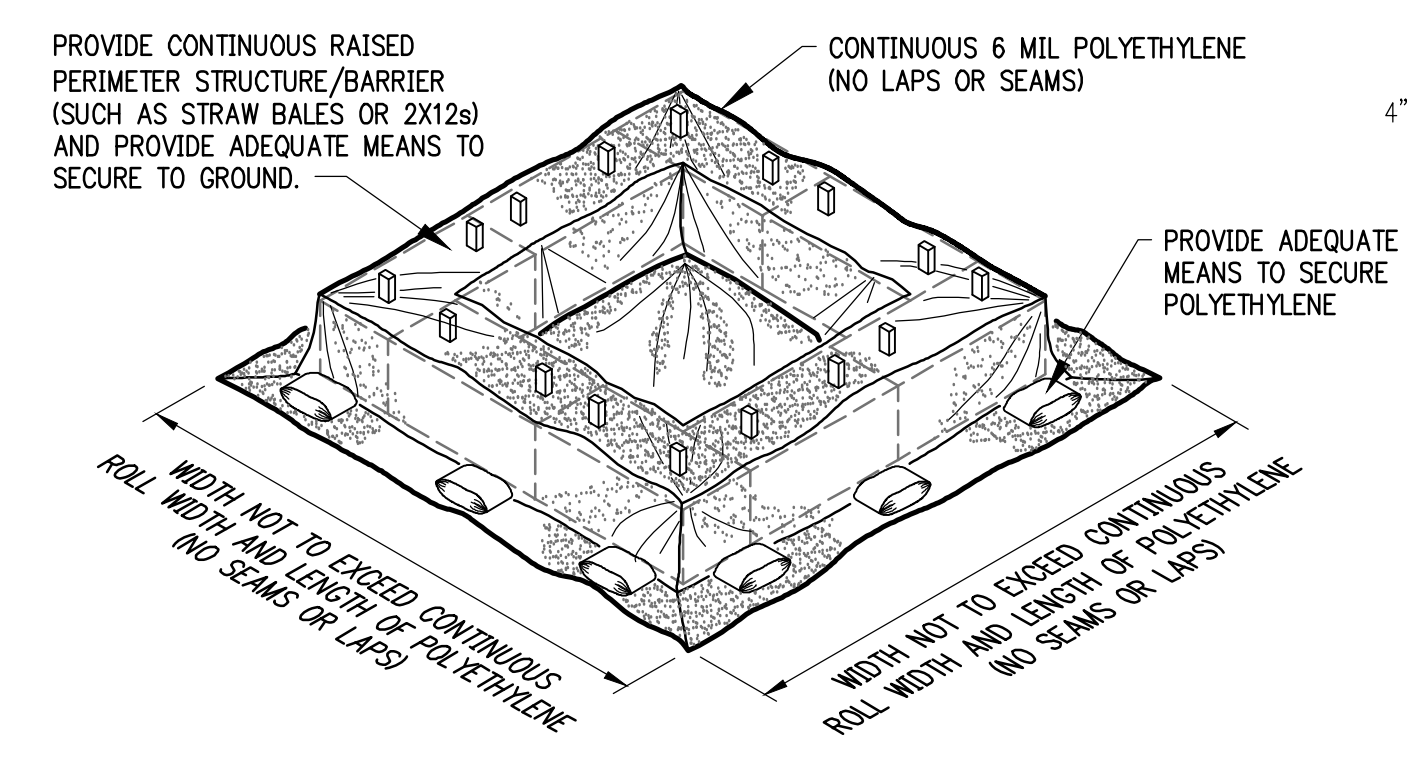

CONCRETE WASH-OUT BASIN
NTS

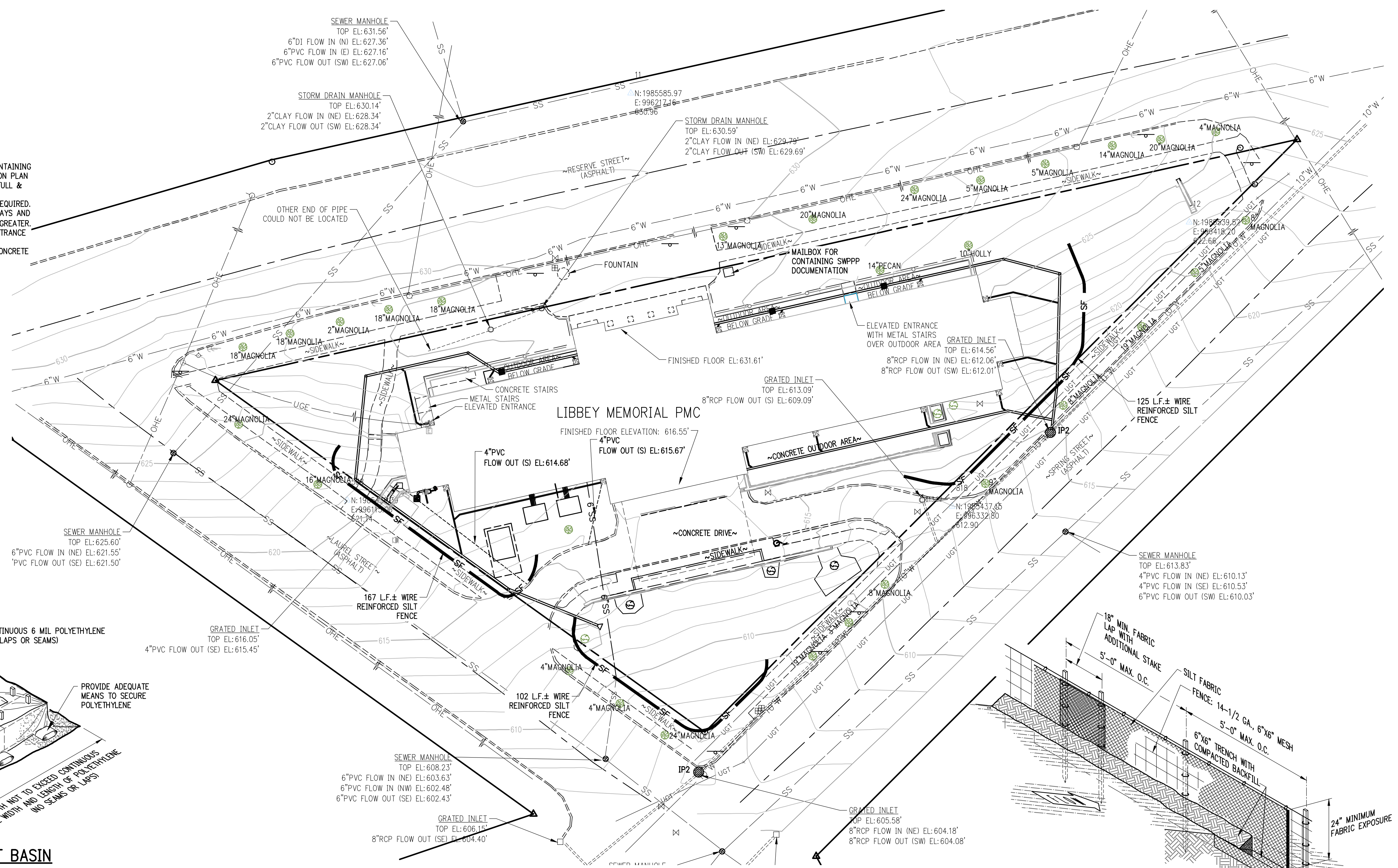
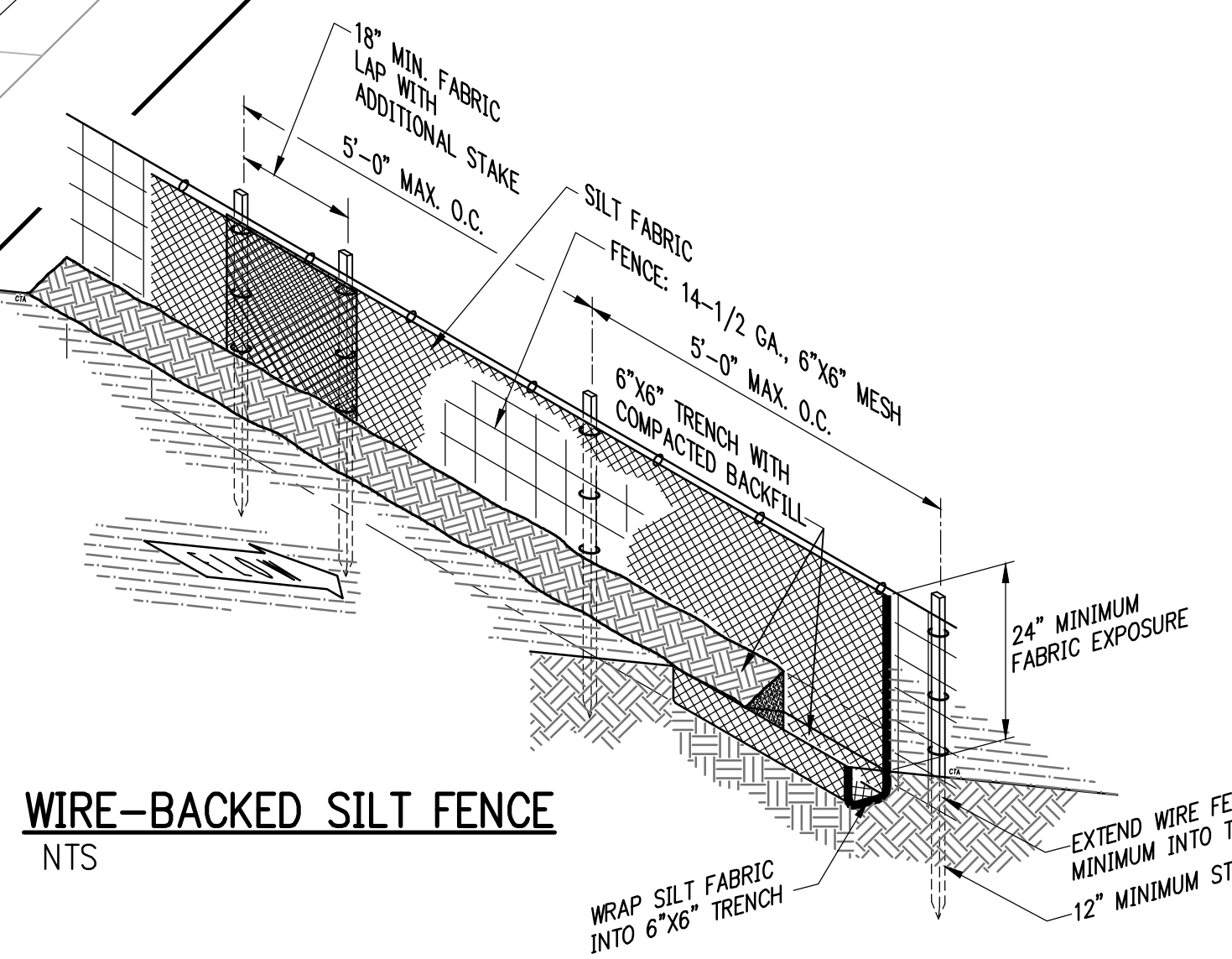

WIRE-BACKED SILT FENCE
NTS

EROSION CONTROL LEGEND					
	PS	PERMANENT SEEDING		CD	ROCK CHECK DAM
	TPS	TEMPORARY PARKING AND STORAGE		CE	STABILIZED CONSTRUCTION EXIT (ENTRANCE)
		BOUNDARY LINE		DD	CHANNELED DIVERSIONS
		RIGHT OF WAY LINE		DS	DEWATERING SYSTEM / STRUCTURE
		LIMITS OF DISTURBANCE		SF	SILT FENCE
		GRADE BREAK		ST	SEDIMENT BASIN WITH STONE OUTLET
		CONTOUR ELEVATIONS		IP1	BLOCK AND AGGREGATE INLET SEDIMENT DEVICE
		STORM DRAIN		IP2	CURB INLET FILTER SOCK
	XX.X%	DIRECTION OF OVERLAND FLOW W/ GRADE		IP3	GRADED INLET GRAVEL SEDIMENT FILTER
		LIMITS OF DRAINAGE SUB-BASIN		IP4	SILT FENCE INLET PROTECTION
	OP1	RIP RAP SLOPE PROTECTION (SEE SIZE THIS SHEET)		ECL	PERMANENT EROSION CONTROL LINING
	SB	TEMPORARY SEDIMENT BASIN		FFT	FIBER FLOCCULENT TUBE

NOTE: SEE SITE PLAN FOR EXISTING LEGEND SYMBOLS



A/E FIRMS PRIME/ARCH: STRATA ARCHITECTURE 1919 ONE STREET SUITE 100 KANSAS CITY, MO 64104-1400	DESIGNED: MB	SUB SHEET NO. 02 C1.2	TITLE OF SHEET LIBBEY BATHHOUSE EROSION CONTROL PLAN	DRAWING NO. 128 182951
CIVIL/SURVEY: CRAFTON TULL 1514 AIRPORT ROAD HOT SPRINGS, AR 71913 P. 501.747.2266	CADD: RU	DATE: 10.27.2023	REHABILITATE BATHHOUSES HOT SPRINGS NATIONAL PARK	PMIS/PKG NO. 318915
	TECH. REVIEW: MB			SHEET 199 OF 286

