

6 BASE TERMINATION & FLASHING TIE-IN @ STANDING SEAM ROOF
A5.11 3" = 1'-0" REFERRED FROM: A1.2

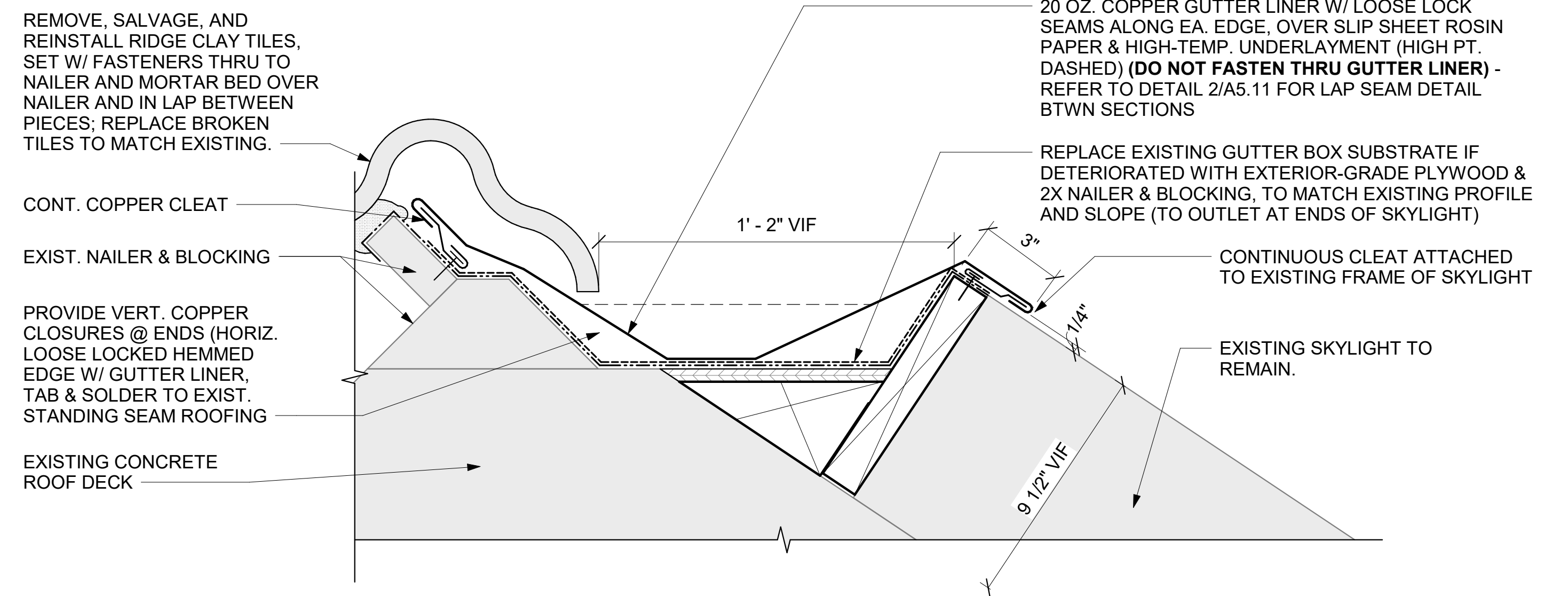

5 BUILT-IN GUTTER DETAIL OVER SKYLIGHT (SHOWN @ LOW PT.)
A5.11 3" = 1'-0" REFERRED FROM: A1.2

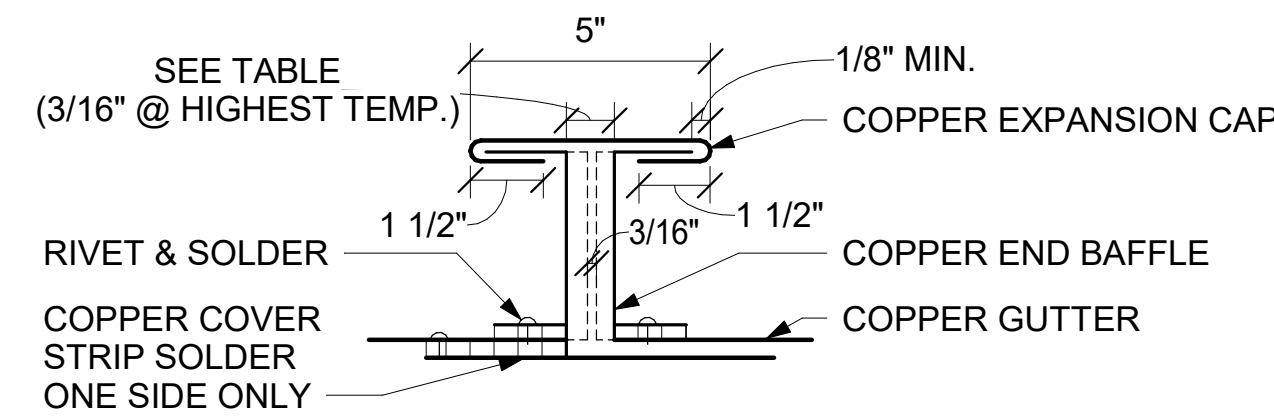

3 GUTTER EXPANSION JOINT - EJ-2
A5.11 3" = 1'-0"

Temp. °F, (C)	Copper or Stainless Steel		Aluminum	
	10 ft. (3 m)	50 ft. (15 m)	10 ft. (3 m)	50 ft. (15 m)
E@170 (77)	1/16" 2 mm	3/16" 5 mm	1/16" 2 mm	3/16" 5 mm
120 (49)	1/8" 3 mm	1/2" 13 mm	3/16" 5 mm	5/8" 16 mm
100 (38)	3/16" 5 mm	5/8" 16 mm	3/16" 5 mm	13/16" 21 mm
75 (24)	3/16" 5 mm	3/4" 19 mm	1/4" 6 mm	1 1/16" 27 mm
35 (1.7)	1/4" 6 mm	15/16" 24 mm	5/16" 8 mm	1 3/8" 35 mm
0 (-17)	1/4" 6 mm	1 1/8" 29 mm	3/8" 10 mm	1 1/2" 43 mm

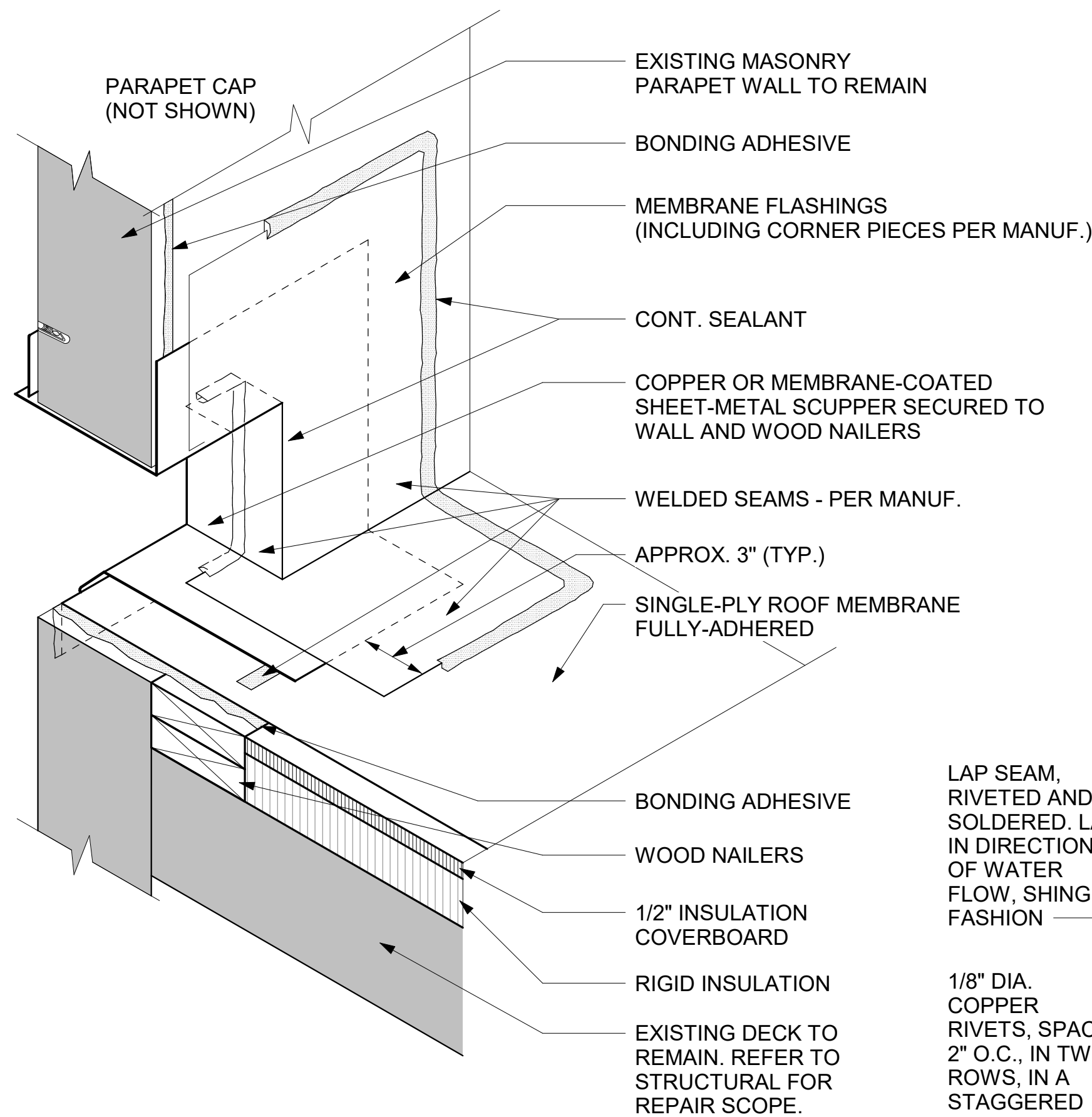

4 THROUGH-WALL SCUPPER CUTAWAY AXON DETAIL
A5.11 3" = 1'-0" REFERRED FROM:

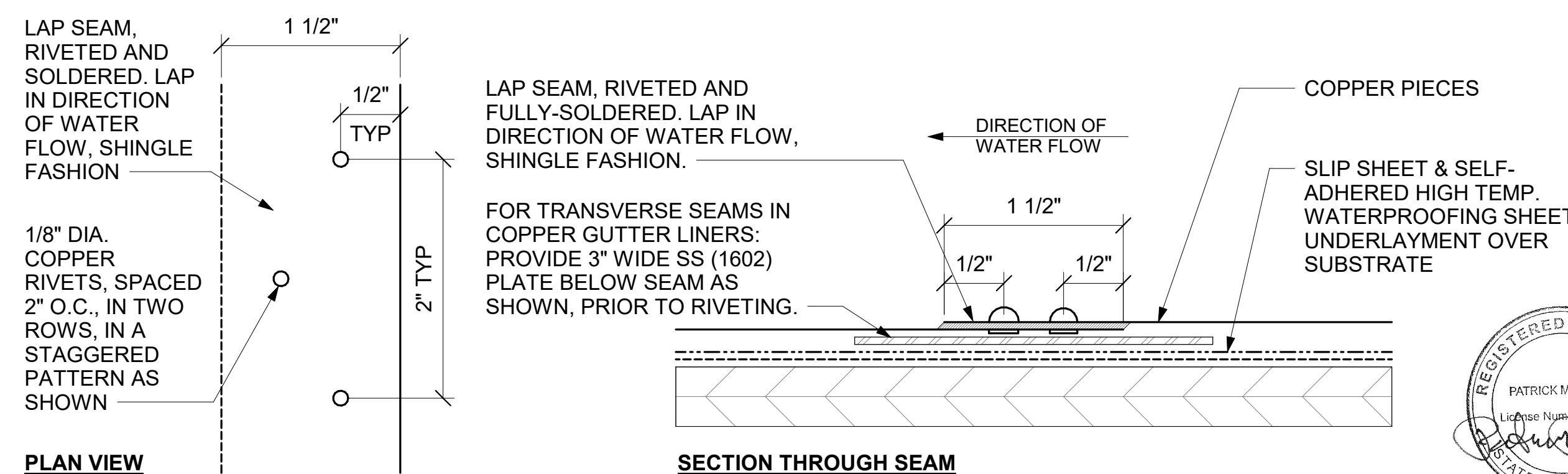

2 TYP. LAP SEAM DETAIL (INDIVIDUAL PIECES 10 FT LONG MAX.)
A5.11 12" = 1'-0"

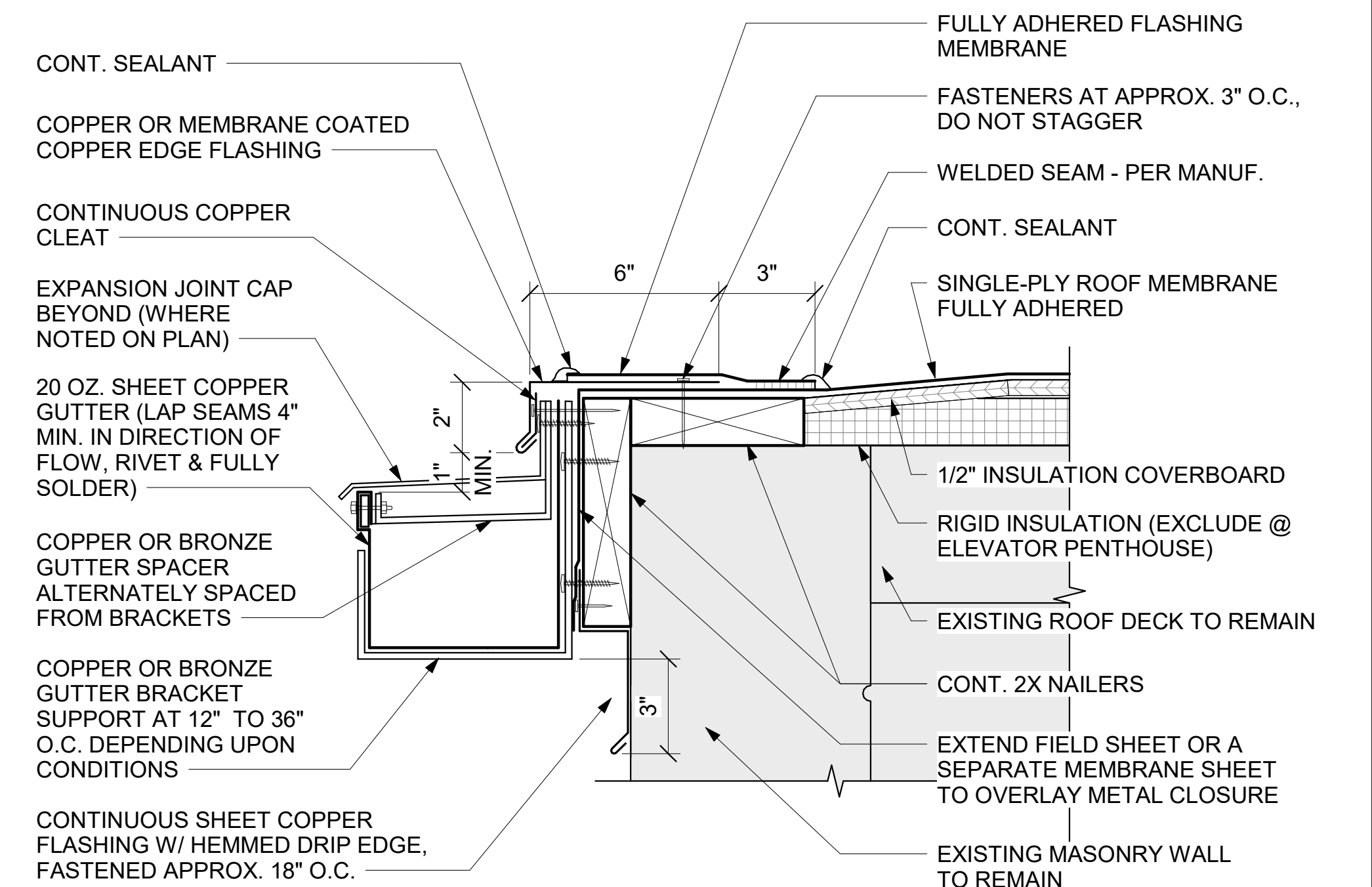

- NOTES:
- GUTTER BRACKETS TO BE AT LEAST ONE GAUGE HEAVIER THAN GUTTER STOCK.
 - ATTACH WOOD NAILER TO WALL/DECK WITH SUITABLE FASTENERS.
 - GUTTER SIZE VARIES PER LOCATION, REFER TO SPECIFICATION FOR SIZES BY TYPE, AS DESIGNATED ON PLAN.

1 EDGE & GUTTER DETAIL
A5.11 3" = 1'-0" REFERRED FROM: A1.2

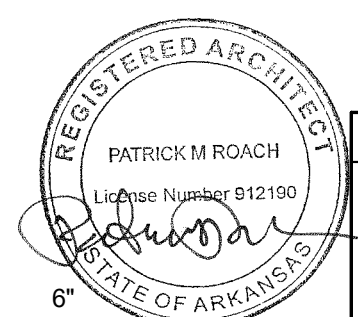

A/E FIRMS	DESIGNED:	GK
ARCH: QUINN EVANS	CADD:	REVIEW:
249 1/2 N. MAIN STREET ANN ARBOR, MI T: 734.663.5888	TECH. REVIEW:	KG
	DATE:	10.27.2023

SUB SHEET NO.
04
A5.11

TITLE OF SHEET
HOSP BUCKSTAFF + FORDYCE ROOFS
FORDYCE ROOF DETAILS
OPTION 1
REHABILITATE BATHHOUSES
HOT SPRINGS NATIONAL PARK

DRAWING NO.
128
182951
PMIS/PKG NO.
318915
SHEET
277 OF 286

11/20/2023 8:28:54 PM