

**GENERAL NOTES**

1. PATCH/REPAIR FLOOR AS REQUIRED TO MATCH ADJACENT AREA WHERE NEW FCU DOES NOT COMPLETELY COVER OLD LOCATIONS.
2. PATCH AND REPAIR FLOOR AND WALL TO MATCH ADJACENT AREA WHERE EQUIPMENT IS PERMANENTLY REMOVED.
3. CLEAN FLOOR AND WALL AT FCUs AS NEEDED AS PART OF PREP FOR NEW FCUs.

**FLOOR PLAN KEYNOTES:**

1. VERTICAL PIPE CHASE-FULL HEIGHT-PRIME AND PAINT GWB. PROVIDE BASE MATERIAL TO MATCH EXISTING. SEE 2 & 5 /A6. SEE MECHANICAL. SEE 2/A2 CHASE SIZE SCHEDULE FOR RECOMMENDED SIZE.
2. PARTIAL HEIGHT VERTICAL PIPE CHASE- HEIGHT TO MATCH FCU. INSTALL WAINSCOT AND CAP OF SOLID SURFACE MATERIAL. SEE 4 & 5 /A6. SEE MECHANICAL. SEE 2/A2 CHASE SIZE SCHEDULE FOR RECOMMENDED SIZE. ALIGN FACE OF CHASE WITH THE FACE OF THE FCU.
3. AT THE FCU INSTALLED IN FRONT OF THE WINDOW INSTALL SOLID-SURFACE MATERIAL SPACER FLATWISE AGAINST THE WALL. THE TOP OF THE FCU WILL BE AT THE SAME LEVEL AS THE LIP OF THE MARBLE SILL LEAVING A GAP BETWEEN THE FCU AND THE WALL. SIZE THE SPACER 1/4" LARGER THAN THE FCU AND NOTCH THE SPACER AT THE SILL.

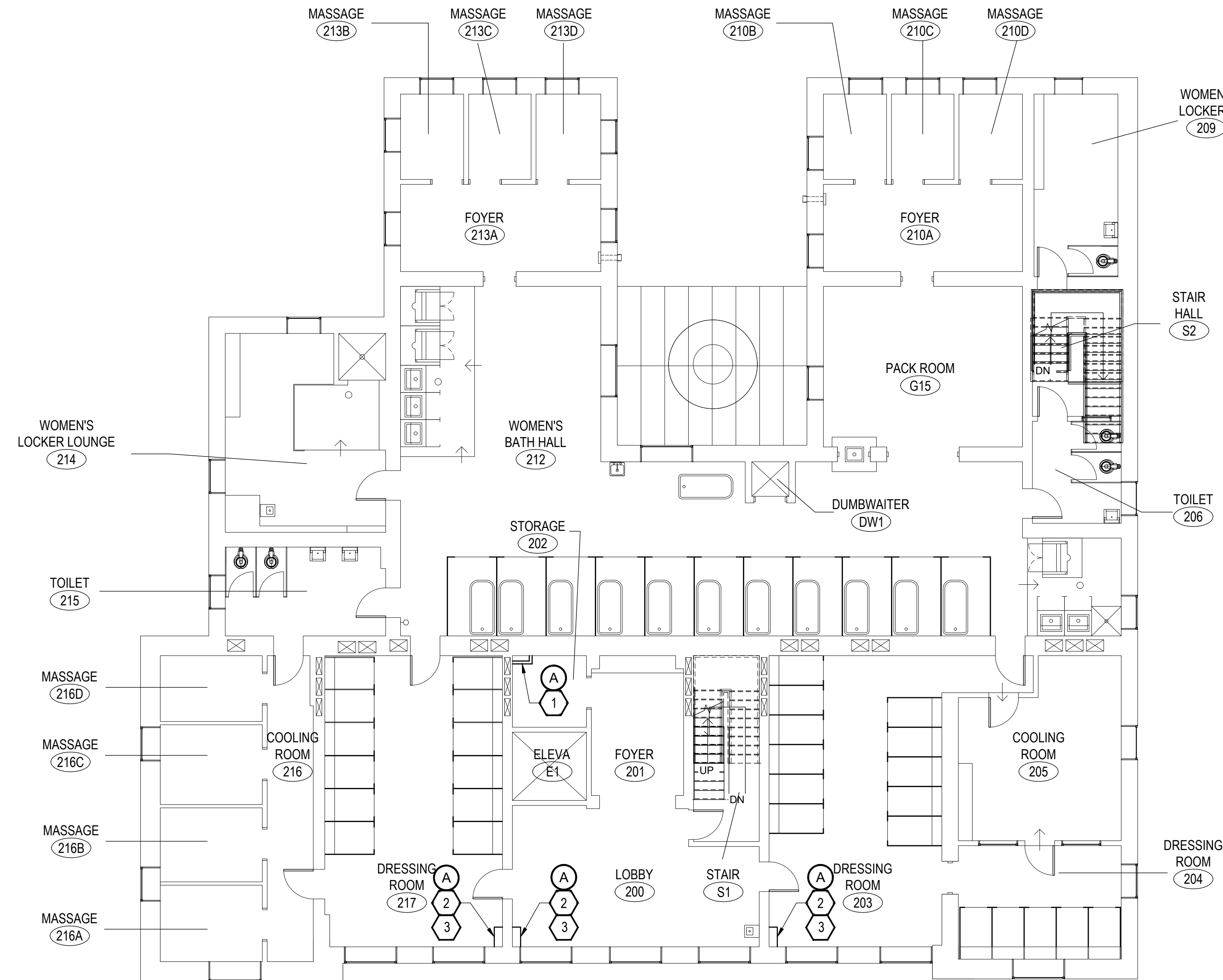

**1 2ND FLOOR PLAN**  
SCALE: 1/8" = 1'-0"



**FINAL CONSTRUCTION DOCUMENTS**

A/E FIRM PRIME: KENNETH HAHN ARCHITECTS, INC. OMAHA, NE. SUBCONTRACTOR: ALVINE ENGINEERING OMAHA, NE.	DESIGNED: KJH	SUB SHEET NO.  <b>A3</b>	TITLE OF SHEET  <b>2ND FLOOR PLAN</b>  BUCKSTAFF BATHHOUSE HVAC HOT SPRINGS NATIONAL PARK HOT SPRINGS, AK	DRAWING NO. XXX/XXXX
	DRAWN BY: TWM			PMIS NO. 177425
	TECH. REVIEW: CLZ			SHEET
	DATE: 2/15/2024			8 OF 60