

D1 PARTIAL WARD 2 - PHASE 2C  
1/8" = 1'-0"

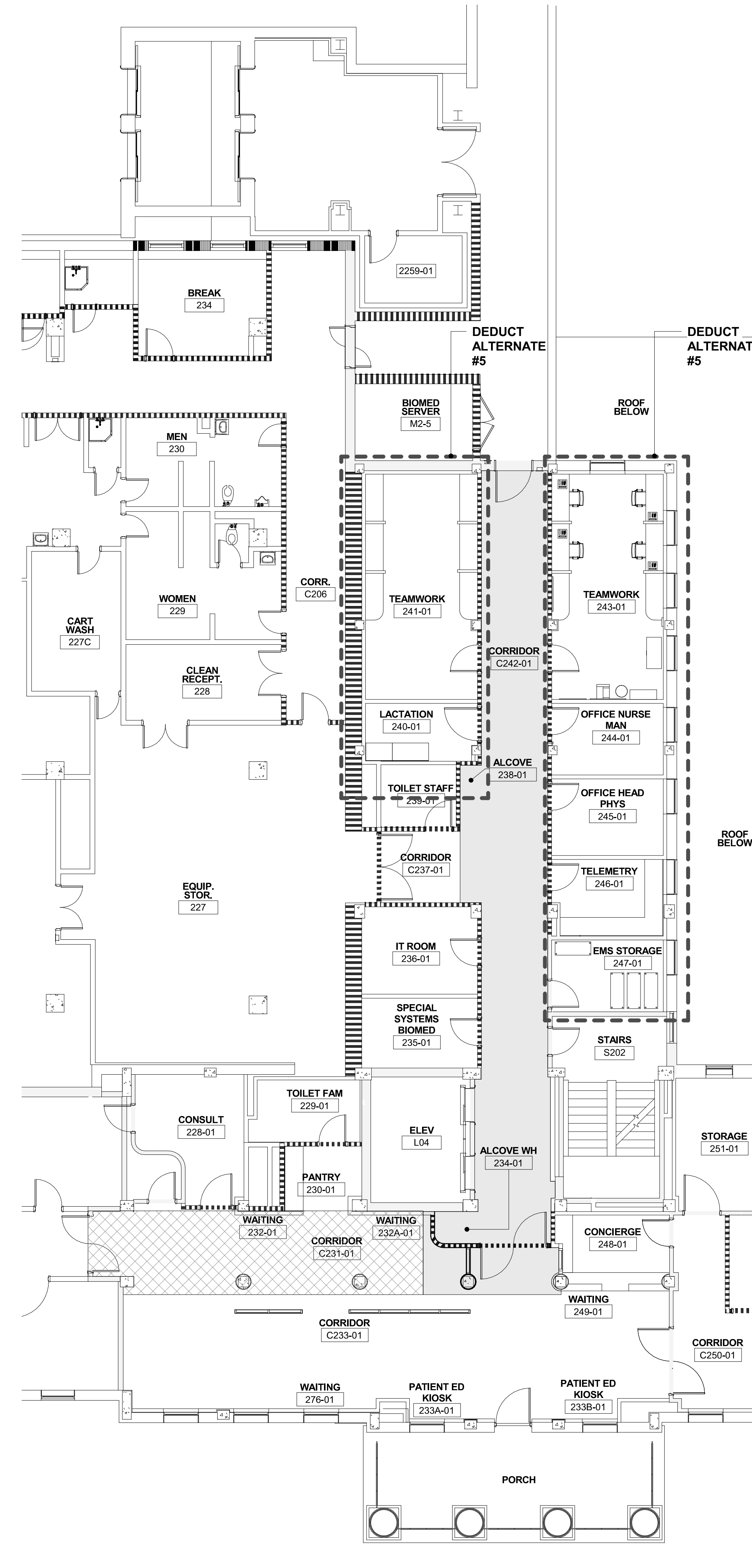

D2 PARTIAL WARD 2 - PHASE 2D  
1/8" = 1'-0"

**GENERAL SHEET NOTES**

A. REFER TO SHEET A001 FOR GENERAL PROJECT NOTES.  
B. EXISTING BUILDING CONFIGURATION DEPICTED IS BASED ON CONDITIONS OBSERVED AT TIME OF DESIGN. CONTRACTOR SHALL VERIFY ALL CONDITIONS IN FIELD AT TIME OF CONSTRUCTION.  
C. WITHIN EACH IDENTIFIED PHASE, GC WILL INSTALL UPRIGHT SPRINKLER HEADS IN AREAS OF CONSTRUCTION. SEE FX DRAWINGS FOR FURTHER INFORMATION.  
D. AT GC COMPLETION OF EACH INTERIM PHASE AND FINAL PHASE, GC TO PROVIDE 5 SEQUENTIAL BUSINESS DAYS FOR VA OBSERVATION AND PUNCH LIST REVIEW. VA WILL NOT TAKE BENEFICIAL OCCUPANCY OR TAKE FINAL ACCEPTANCE UNTIL INTERIM AND FINAL PUNCH LIST ITEMS ARE COMPLETED. IN PHASES 2, ALL TRASH IS REMOVED BY COVERED CARTS.

**PHASING SUMMARY**

GENERAL CONTRACTOR AND SUBCONTRACTORS ABOVE CEILING WORK MUST BE CAREFULLY PHASED AND COORDINATED WITH THE HOSPITAL'S ONGOING, EXISTING OPERATIONS AND APPROVED BY COR. WORK SHALL ALSO CONFORM TO NEW CONSTRUCTION PHASES ON 2B AND 2.  
AT THE BEGINNING OF EACH PHASE, COORDINATE MEP WORK PRIOR TO ANY DEMOLITION.  
**DURING ALL PHASES, GC TO PROVIDE TEMPORARY PARTITION IN CORRIDOR CONNECTING TO ELEVATOR IN WARD 2, FOR MATERIAL DELIVERY/REMOVAL. GC SHOULD MAINTAIN A CLEAR HALLWAY WIDTH OF 48" FOR PATIENT-CARE ACCESS.**

**WARD 2 PHASING:**

A. **2C. RENOVATE CORRIDOR C201.**  
a. GC TO CONSTRUCT TEMPORARY PARTITIONS TO ISOLATE CORRIDOR C201 FROM ADJACENT AREAS.  
b. GC TO COMMENCE RENOVATIONS TO THIS AREA.  
c. VA OCCUPIES WAITING AREA IN 2.  
d. ABOVE CEILING WORK ON 2 INDICATED ABOVE SHALL OCCUR AFTER HOURS, ROOM BY ROOM, AND DEPARTMENT BY DEPARTMENT.

B. **2D. RENOVATE CENTRAL CORRIDOR C200 IN 2.**  
a. ALL WORK TO OCCUR AFTER HOURS OVER WEEKENDS.  
b. CORRIDOR C200 MUST REMAIN OPERATIONAL DURING CONSTRUCTION.  
c. ABOVE CEILING WORK ON 2 INDICATED ABOVE SHALL OCCUR AFTER HOURS, ROOM BY ROOM, AND DEPARTMENT BY DEPARTMENT.

**IMPACTED AREAS UNDER 2 RENOVATION - RADIOLOGY EXAM ROOMS, PROSTHETIC STORAGE, PHARMACY, STERILE FLUIDS, IV ANTEROOM CLEAN STORAGE, & INTRAVENOUS ADMIXTURES.**

**SYMBOLS LEGEND**

DENOTES AREAS OF WORK ABOVE CEILING  
 INDICATES AREA NOT IN SCOPE OF WORK  
 PHASE 2  
 PHASE 3

**PARTITION GRAPHICS**

**PARTITION PHASING**

EXISTING ELEMENT TO REMAIN  
 EXISTING ELEMENT TO BE DEMOLISHED  
 TEMPORARY 1-HOUR RATED ELEMENT TO BE CONSTRUCTED AND DEMOLISHED IN SAME PHASE

**PARTITION RATING**

NO RATING  
 SMOKE RESISTIVE PARTITION - NON RATED  
 1 HOUR FIRE BARRIER  
 1 HOUR FIRE/SMOKE BARRIER  
 2 HOUR FIRE BARRIER  
 2 HOUR FIRE/ SMOKE BARRIER

**KEY PLAN**

THIRD FLOOR FFE: 1505.0'  
SECOND FLOOR FFE: 1493.0'  
FIRST FLOOR FFE: 1479.0'

Revisions:		
No.	Description	Date

**CONSULTANTS:**

**BRITT, PETERS AND ASSOCIATES**  
CONSULTING ENGINEERS

8701 RED OAK BLVD, SUITE 500  
CHARLOTTE, NC 28217  
PHONE: 704.522.0405  
WWW.BRITTPETERS.COM

Seal:

**ARCHITECT / ENGINEERS:**

**HARRELL DESIGN GROUP, P.C.**

8016 TOWER POINT DRIVE  
CHARLOTTE, NC 28227  
P 704.814.1320  
F 704.321.0833

HG PROJECT: 18002  
COPYRIGHT © 2023

Drawing Title:  
**SECOND FLOOR PHASING PLAN - WARD 2 - PHASE 2**

Project Phase:  
BID DOCUMENTS

**FULLY SPRINKLERED**

Project Title:  
**RENOVATE MED SURGE WARDS**

Location:  
VETERANS HEALTHCARE SYSTEM OF THE OZARKS

Date:  
MARCH 24, 2024

Checked:  
JC/LK

Drawn:  
GG/DW

Project Number:  
564-17-140

Building Number:  
**1**

Drawing Number:  
**GC123b**

Sheet **18** of **162**

**Engineering Service**

VETERANS HEALTH CARE SYSTEM OF THE OZARKS

**VA** U.S. Department of Veterans Affairs