

SYMBOLS LEGEND

- INDICATES AREA NOT IN SCOPE OF WORK
- PHASE 3

GENERAL SHEET NOTES

- A. REFER TO SHEET A1001 FOR GENERAL PROJECT NOTES.
- B. EXISTING BUILDING CONFIGURATION DEPICTED IS BASED ON CONDITIONS OBSERVED AT TIME OF DESIGN. CONTRACTOR SHALL VERIFY ALL CONDITIONS IN FIELD AT TIME OF CONSTRUCTION.
- C. WITHIN EACH IDENTIFIED PHASE, GC WILL INSTALL UPRIGHT SPRINKLER HEADS IN AREAS OF CONSTRUCTION. SEE FX DRAWINGS FOR FURTHER INFORMATION.
- D. AT GC COMPLETION OF EACH INTERIM PHASE AND FINAL PHASE, GC TO PROVIDE 5 SEQUENTIAL BUSINESS DAYS FOR VA OBSERVATION AND PUNCH LIST REVIEW. VA WILL NOT TAKE BENEFICIAL OCCUPANCY OR TAKE FINAL ACCEPTANCE UNTIL INTERIM AND FINAL PUNCH LIST ITEMS ARE COMPLETED.
- E. IN PHASES 2, ALL TRASH IS REMOVED BY COVERED CARTS.

SHEET KEYNOTES

- 02.22 DOOR MUST REMAIN OPEN TO AVOID DEADEND DURING PHASE 2.

PHASING SUMMARY

GENERAL CONTRACTOR AND SUBCONTRACTORS ABOVE CEILING WORK MUST BE CAREFULLY PHASED AND COORDINATED WITH THE HOSPITAL'S ONGOING, EXISTING OPERATIONS AND APPROVED BY COR. WORK SHALL ALSO CONFORM TO NEW CONSTRUCTION PHASES ON 2B AND 2.

AT THE BEGINNING OF EACH PHASE, COORDINATE MEP WORK PRIOR TO ANY DEMOLITION.

DURING ALL PHASES, GC TO PROVIDE TEMPORARY PARTITION IN CORRIDOR CONNECTING TO ELEVATOR IN WARD 2, FOR MATERIAL DELIVERY/REMOVAL. GC SHOULD MAINTAIN A CLEAR HALLWAY WIDTH OF 48" FOR PATIENT-CARE ACCESS.

WARD 2 PHASING:

- A. **2A. RENOVATE EAST SIDE OF CORRIDOR C200 AND SOUTH SIDE OF CORRIDOR C201.**
- a. VA TO VACATE OFFICES ON EAST SIDE OF C200 & SOUTH SIDE OF C201.
- b. GC TO CONSTRUCT TEMPORARY PARTITION PARALLEL TO EAST SIDE OF C200.
- c. GC TO USE C201 SOUTH CORRIDOR WALL AND CONSTRUCTED TEMPORARY PARTITIONS TO ISOLATE OFFICES 200, 201, AND PAT. ROOM 202 AND TOILET 202A.
- d. GC TO COMMENCE EAST SIDE AND SOUTH SIDE RENOVATIONS TO 2.
- e. VA OCCUPIES NEW OFFICES ON EAST SIDE OF 2 AND CREATES NEW CORRIDOR AT SOUTH SIDE.
- f. ABOVE CEILING WORK ON 2 INDICATED ABOVE SHALL OCCUR AFTER HOURS, ROOM BY ROOM, AND DEPARTMENT BY DEPARTMENT.
- B. **2B. RENOVATE WEST SIDE OF CORRIDOR C200 AND NORTH SIDE OF CORRIDOR C201.**
- a. VA TO VACATE OFFICES ON WEST SIDE OF C200 & NORTH SIDE OF C201.
- b. GC TO CONSTRUCT TEMPORARY PARTITION PARALLEL TO WEST SIDE OF C200.
- c. GC TO USE C201 CONSTRUCT TEMPORARY PARTITIONS TO ISOLATE WAITING 228 AND TOILET 268A.
- d. GC TO COMMENCE WEST SIDE AND NORTH SIDE RENOVATIONS TO 2.
- e. VA OCCUPIES NEW OFFICES ON WEST SIDE OF 2 AND CREATES NEW CONSULT ROOM, FAMILY TOILET AND PANTRY.
- f. ABOVE CEILING WORK ON 2 INDICATED ABOVE SHALL OCCUR AFTER HOURS, ROOM BY ROOM, AND DEPARTMENT BY DEPARTMENT.
- C. **2C. RENOVATE CORRIDOR C201.**
- a. GC TO CONSTRUCT TEMPORARY PARTITIONS TO ISOLATE CORRIDOR C201 FROM ADJACENT AREAS.
- b. GC TO COMMENCE RENOVATIONS TO THIS AREA.
- c. VA OCCUPIES WAITING AREA IN 2.
- d. ABOVE CEILING WORK ON 2 INDICATED ABOVE SHALL OCCUR AFTER HOURS, ROOM BY ROOM, AND DEPARTMENT BY DEPARTMENT.
- D. **2D. RENOVATE CENTRAL CORRIDOR C200 IN 2.**
- a. ALL WORK TO OCCUR AFTER HOURS OVER WEEKENDS.
- b. CORRIDOR C200 MUST REMAIN OPERATIONAL DURING CONSTRUCTION.
- c. ABOVE CEILING WORK ON 2 INDICATED ABOVE SHALL OCCUR AFTER HOURS, ROOM BY ROOM, AND DEPARTMENT BY DEPARTMENT.

IMPACTED AREAS UNDER 2 RENOVATION - RADIOLOGY EXAM ROOMS, PROSTHETIC STORAGE, PHARMACY, STERILE FLUIDS, IV ANTEROOM CLEAN STORAGE, & INTRAVENOUS ADMIXTURES.

PHASE 2 ACTIVATION

A. MECHANICAL CONTRACTOR SHALL REMOVE EXISTING TEMPORARY DX UNIT-B AND ALL ASSOCIATED DUCT WORK AND COMPONENTS FOR THE OPERATION OF THIS UNIT.

B. ELECTRICAL CONTRACTOR SHALL REMOVE ALL ELECTRICAL CONNECTIONS TO DX UNIT-B FROM THE TEMPORARY GENERATOR AND ALL ASSOCIATED COMPONENTS FROM THE SITE.

C. GENERAL CONTRACTOR SHALL INSTALL REPLACEMENT WINDOW AT TEMPORARY DUCT LOCATION. PATCH AND REPAIR ANY ROOFING DAMAGE AFTER REMOVAL OF TEMPORARY DX UNIT-B. RESTORE SITE AT THE LOCATION OF THE TEMPORARY EMERGENCY GENERATOR TO ORIGINAL CONDITION.

PARTITION GRAPHICS

PARTITION PHASING

- EXISTING ELEMENT TO REMAIN
- EXISTING ELEMENT TO BE DEMOLISHED
- TEMPORARY 1-HOUR RATED ELEMENT TO BE CONSTRUCTED AND DEMOLISHED IN SAME PHASE

PARTITION RATING

- NO RATING
- SMOKE RESISTIVE PARTITION - NON RATED
- 1 HOUR FIRE BARRIER
- 1 HOUR FIRE/SMOKE BARRIER
- 2 HOUR FIRE BARRIER
- 2 HOUR FIRE/ SMOKE BARRIER

KEY PLAN

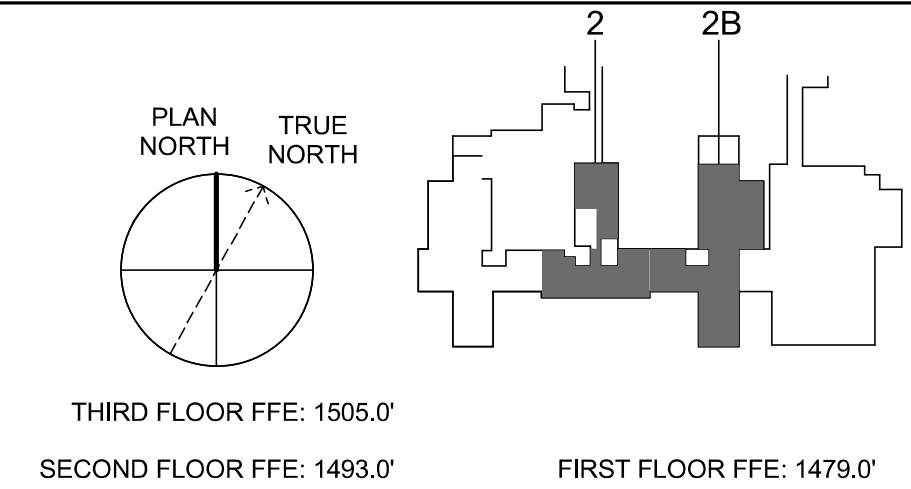

D2 SECOND FLOOR PHASING PLAN WARD 2 - PHASE 2

3/32" = 1'-0"

0 5' 10' 20'

Revisions:	No.	Description	Date

CONSULTANTS:



8701 RED OAK BLVD, SUITE 500
CHARLOTTE, NC 28217
PHONE: 704.522.0405
WWW.BRITTPETERS.COM

Seal:



ARCHITECT / ENGINEERS:



8016 TOWER POINT DRIVE
CHARLOTTE, NC 28227
P 704.814.1320
F 704.321.0833
HDG PROJECT: 18002
COPYRIGHT © 2023

Drawing Title:

SECOND FLOOR PHASING PLAN
- WARD 2 - PHASE 2

Project Phase:

BID DOCUMENTS

FULLY SPRINKLERED

Project Title:

RENOVATE MED SURGE
WARDS

Location:

VETERANS HEALTHCARE SYSTEM
OF THE OZARKS

Date:

MARCH 24, 2024

Checked:

JC/LK

Drawn:

MS

Project Number:

564-17-140

Building Number:

1

Drawing Number:

GC123

Sheet 16 of 162

Engineering
Service



U.S. Department
of Veterans Affairs