

three inches = one foot
one and one half inches = one foot
one inch = one foot
three quarters inch = one foot
one half inch = one foot
one quarter inch = one foot
one eighth inch = one foot

PHASING NOTE:
REFER TO PHASING ON SHEETS
GC119 THRU GC125 FOR PHASED
AREAS OF WORK.

GENERAL NOTES

- FIRE ALARM DEVICES ARE TO BE INSTALLED IN ACCORDANCE WITH NFPA 72.
- ACTUATION OF ANY SYSTEM INITIATING DEVICE SHALL ACTIVATE ALL INDICATING DEVICES, UNLESS NOTED OTHERWISE.
- VERIFY COMPONENT TYPES AND QUANTITIES WITH PLAN DRAWINGS.
- ALL FIRE ALARM WIRING TO BE INSTALLED IN RACEWAYS.
- PROVIDE ALL REQUIRED POWER SUPPLIES, BOOSTER PANELS, MODULES, ETC. FOR A COMPLETE SYSTEM.
- FIRE PROTECTION CONTRACTOR TO COORDINATE SPECIFIC WIRING REQUIREMENTS WITH EQUIPMENT MANUFACTURER.
- PROVIDE A NEW FACP IN THE SECOND FLOOR SPECIAL SYSTEMS ROOM. CONTRACTOR SHALL PROVIDE ALSO A FULLY COMPATIBLE REMOTE ANNUNCIATOR WHERE INDICATED.
- REFER TO THE SPECIFICATIONS FOR MOUNTING HEIGHTS FOR INITIATING DEVICES AND NOTIFICATION APPLIANCES.
- SMOKE DETECTORS IN ELEVATOR LOBBIES, AND ELEVATOR SHAFTS SHALL BE PROGRAMMED FOR ELEVATOR RECALL OPERATION. ACTIVATION OF A SMOKE DETECTOR IN THE ELEVATOR SHAFT AND SECONDARY RECALL FLOOR LOBBY SHALL RECALL THE ELEVATOR TO THE PRIMARY RECALL FIRST FLOOR LOBBY. ACTIVATION OF A SMOKE DETECTOR IN THE PRIMARY RECALL FIRST FLOOR LOBBY SHALL RECALL THE ELEVATOR TO THE SECONDARY RECALL SECOND FLOOR LOBBY.
- REVIEW THE CONSTRUCTION DOCUMENTS OF ALL TRADES FOR PHASING REQUIREMENTS.
- CONFIRM MOUNTING HEIGHTS WITH ARCHITECTURAL INTERIOR ELEVATIONS PRIOR TO ROUGH-IN.

SHEET KEYNOTES

- FIRE ALARM RELAY TO SEND SIGNAL TO OVERRIDE CARD READER AND RELEASE LOCK.
- PROVIDE NEW DUCT SMOKE DETECTOR IN AHU DUCTS. EXTEND EXISTING FIRE ALARM SYSTEM AS REQUIRED. NEW DETECTORS SHALL BE OF SIMILAR TYPE AS EXISTING AND COMPATIBLE WITH EXISTING FIRE ALARM SYSTEM. PROVIDE VISUAL INDICATOR FOR DETECTOR IN CEILING DIRECTLY BELOW DETECTOR.
- PROVIDE NEW DUCT SMOKE DETECTOR FOR TEMPORARY UNIT DUCT WORK. EXTEND EXISTING FIRE ALARM SYSTEM AS REQUIRED. NEW DETECTORS SHALL BE OF SIMILAR TYPE AS EXISTING AND COMPATIBLE WITH EXISTING FIRE ALARM SYSTEM. PROVIDE VISUAL INDICATOR FOR DETECTOR IN CEILING DIRECTLY BELOW DETECTOR.

PARTITION GRAPHICS

PARTITION PHASING

- EXISTING ELEMENT TO REMAIN
- EXISTING ELEMENT TO BE DEMOLISHED
- TEMPORARY 1-HOUR RATED ELEMENT TO BE CONSTRUCTED AND DEMOLISHED IN SAME PHASE

PARTITION RATING

- NO RATING
- SMOKE RESISTIVE PARTITION - NON RATED
- 1 HOUR FIRE BARRIER
- 1 HOUR FIRE/SMOKE BARRIER
- 2 HOUR FIRE BARRIER
- 2 HOUR FIRE/ SMOKE BARRIER

KEY PLAN

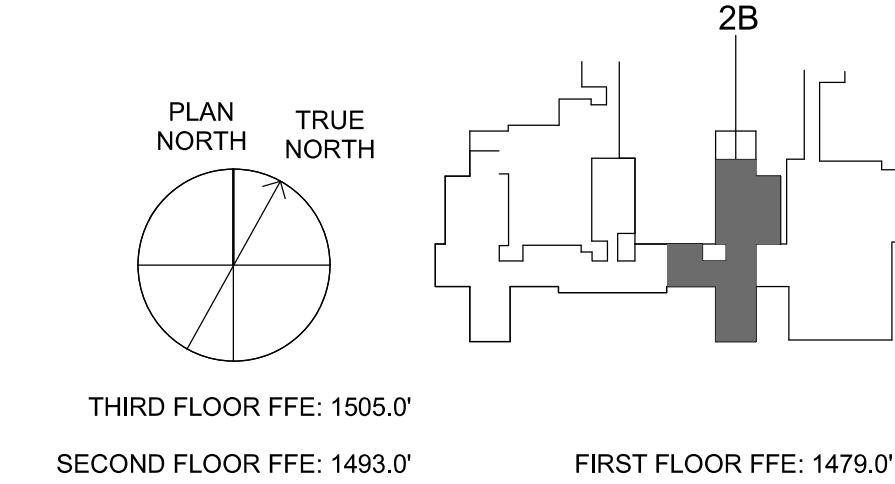

D1 PARTIAL 2 SECOND FLOOR FIRE ALARM PLAN - PHASE 1
1/4" = 1'-0"

D4 PARTIAL 2B SECOND FLOOR FIRE ALARM PLAN - PHASE 1
1/8" = 1'-0"

Revisions:		
No.	Description	Date

CONSULTANTS:



8701 RED OAK BLVD, SUITE 500
CHARLOTTE, NC 28217
PHONE: 704.522.0405
WWW.BRITTPETERS.COM

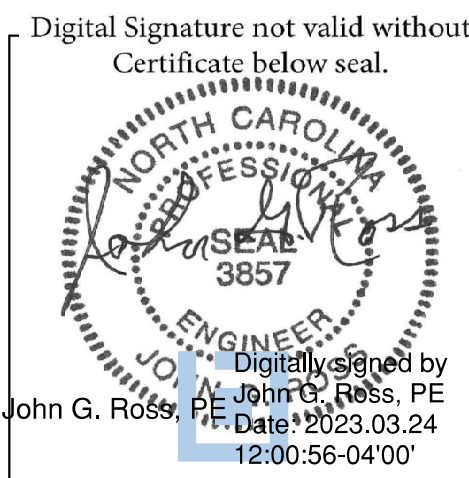

ARCHITECT / ENGINEERS:



8016 TOWER POINT DRIVE
CHARLOTTE, NC 28227
P 704.814.1320
F 704.321.0833
HDP PROJECT: 18002
COPYRIGHT © 2021

Project Title: PARTIAL 2B SECOND FLOOR FIRE ALARM PLAN - PHASE 1

Project Phase:
BID DOCUMENTS

FULLY SPRINKLERED

Project Title: RENOVATE MED SURGE WARDS

Location:
VETERANS HEALTHCARE SYSTEM
OF THE OZARKS

Date:
MARCH 24, 2024

Checked:
LEH

Drawn:
CSR

Project Number:
564-17-140

Building Number:
1

Drawing Number:
FA101

Sheet
87 of 162

Engineering Service



U.S. Department
of Veterans Affairs