

PHASING NOTE:
REFER TO PHASING ON SHEETS
GC119 THRU GC125 FOR PHASED
AREAS OF WORK.

GENERAL NOTES

- REFER TO ARCHITECTURAL REFLECTED CEILING PLAN FOR EXACT LOCATION OF ALL CEILING MOUNTED FIXTURES AND DEVICES. CONFIRM TELEPHONE/DATA OUTLET LOCATIONS AND MOUNTING HEIGHTS WITH ARCHITECTURAL INTERIOR ELEVATIONS PRIOR TO ROUGH-IN.
- CONFIRM TV OUTLET LOCATIONS AND MOUNTING HEIGHT WITH ARCHITECTURAL INTERIOR ELEVATIONS PRIOR TO ROUGH-IN.
- COORDINATE LOCATION AND MOUNTING HEIGHT OF ALL DOOR SECURITY DEVICES AND HARDWARE (CARD READERS, ETC.) WITH ARCHITECTURAL FLOOR PLANS AND INTERIOR ELEVATIONS PRIOR TO ROUGH-IN.
- REVIEW THE CONSTRUCTION DOCUMENTS OF ALL TRADES FOR PHASING REQUIREMENTS.
- NEW VOICE AND DATA CABLES PATCH INTO NEW IT ROOM 2C106 IN UNIT 2.
- PACS, VASS, CATV AND OVERHEAD PAGING SYSTEM SPEAKERS TIE-IN TO NEW SPECIAL SYSTEMS ROOM 2C105 IN UNIT 2.
- PRIOR TO SUBMISSION, VERIFY FINAL CAMERA POSITIONS WITH LOCAL CAMPUS SAFETY OFFICER. INCLUDE 3 ADDITIONAL CAMERAS AND INSTALLATION TO BE INSTALLED IN THE PHASE AREA AT LOCATIONS TO BE DETERMINED BY CCR.

PARTITION GRAPHICS

PARTITION PHASING

- EXISTING ELEMENT TO REMAIN
- EXISTING ELEMENT TO BE DEMOLISHED
- TEMPORARY 1-HOUR RATED ELEMENT TO BE CONSTRUCTED AND DEMOLISHED IN SAME PHASE

PARTITION RATING

- NO RATING
- SMOKE RESISTIVE PARTITION - NON RATED
- 1 HOUR FIRE BARRIER
- 1 HOUR FIRE/SMOKE BARRIER
- 2 HOUR FIRE BARRIER
- 2 HOUR FIRE/ SMOKE BARRIER

KEY PLAN

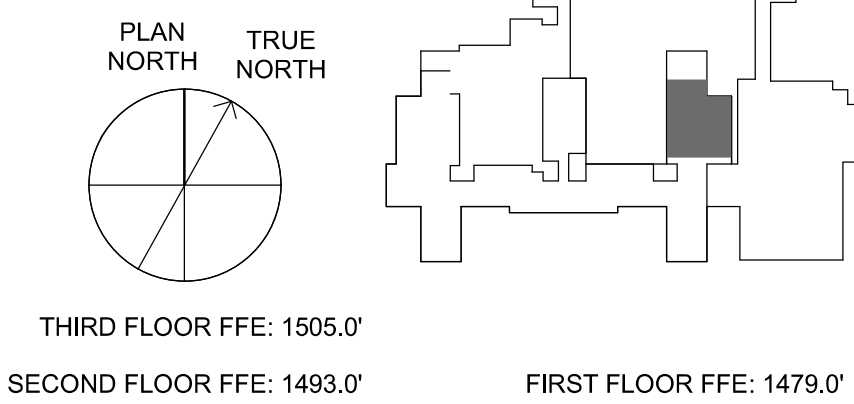

Revisions:		
No.	Description	Date

CONSULTANTS:



8701 RED OAK BLVD, SUITE 500
CHARLOTTE, NC 28217
PHONE: 704.522.0405
WWW.BRITTPETERS.COM

Digital Signature not valid without
Certificate below seal.

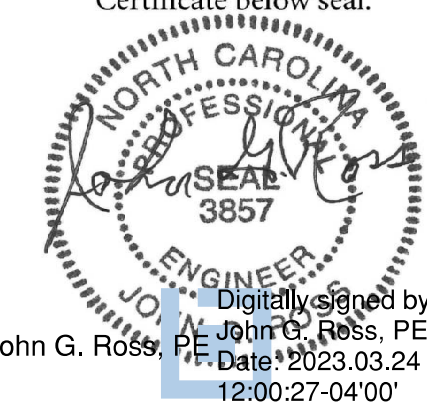

ARCHITECT / ENGINEERS:



8016 TOWER POINT DRIVE
CHARLOTTE, NC 28227
P 704.814.1320
F 704.321.0833

HDG PROJECT: 18002
COPYRIGHT © 2021

Drawing Title:

THIRD FLOOR SYSTEMS PLAN

Project Phase:

BID DOCUMENTS

FULLY SPRINKLERED

Project Title:

RENOVATE MED SURGE
WARDS

Location:

VETERANS HEALTHCARE SYSTEM
OF THE OZARKS

Date:

MARCH 24, 2024

Checked:

LEH

Drawn:

CSR

Project Number:

564-17-140

Building Number:

1

Drawing Number:

EY103

Sheet 155 of 162

Engineering
Service



VA

U.S. Department
of Veterans Affairs