

0  
8"  
three inches = one foot  
A  
0  
one and one half inches = one foot  
B  
0  
one inch = one foot  
2  
0  
one inch = one foot  
three quarters inch = one foot  
C  
0  
one half inch = one foot  
4  
0  
three eighths inch = one foot  
8  
0  
one quarter inch = one foot  
D  
0  
one eighth inch = one foot  
16

PHASING NOTE:  
REFER TO PHASING ON SHEETS  
GC119 THRU GC125 FOR PHASED  
AREAS OF WORK.

## GENERAL NOTES

- A. REFER TO DRAWING EG001 FOR TYPICAL SYMBOLS AND ABBREVIATIONS USED IN THIS DRAWING.
- B. REFER TO ARCHITECTURAL REFLECTED CEILING PLAN FOR EXACT LOCATIONS OF ALL CEILING MOUNTED FIXTURES AND DEVICES.
- C. CONNECT ALL EMERGENCY EGRESS LIGHTING AND EXIT SIGNS AHEAD OF ANY LOCAL SWITCHING.
- D. REVIEW THE CONSTRUCTION DOCUMENTS OF ALL TRADES FOR ADDITIONAL PHASING REQUIREMENTS.

## SHEET KEYNOTES

1. CONNECT TO EXISTING THIRD FLOOR LIFE SAFETY CIRCUIT.



**PARTIAL 3B THIRD FLOOR LIGHTING PLAN - PHASE 1**  
1/8" = 1'-0"

## PARTITION GRAPHICS

### PARTITION PHASING

- EXISTING ELEMENT TO REMAIN
- EXISTING ELEMENT TO BE DEMOLISHED
- TEMPORARY 1-HOUR RATED ELEMENT TO BE CONSTRUCTED AND DEMOLISHED IN SAME PHASE

### PARTITION RATING

- NO RATING
- SMOKE RESISTIVE PARTITION - NON RATED
- 1 HOUR FIRE BARRIER
- 1 HOUR FIRE/SMOKE BARRIER
- 2 HOUR FIRE BARRIER
- 2 HOUR FIRE/ SMOKE BARRIER

## KEY PLAN

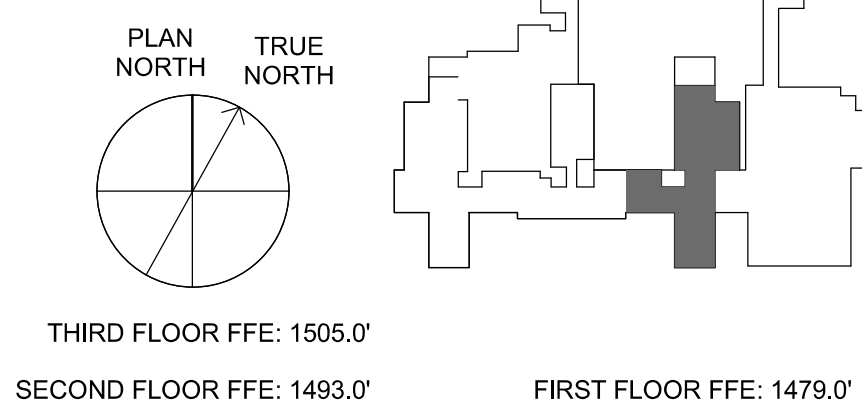

Revisions:		
No.	Description	Date

### CONSULTANTS:



BRITT, PETERS  
AND  
ASSOCIATES  
INC.  
consulting engineers

8701 RED OAK BLVD, SUITE 500  
CHARLOTTE, NC 28217  
PHONE: 704.522.0405  
WWW.BRITTPETERS.COM

Digital Signature not valid without  
Certificate below seal.

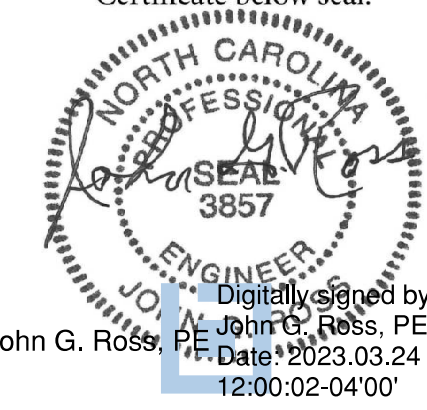

John G. Ross, PE  
No. 3857  
12:00:02-04'00'

### ARCHITECT / ENGINEERS:



8016 TOWER POINT DRIVE  
CHARLOTTE, NC 28227

P 704.814.1320  
F 704.321.0833

HDG PROJECT: 18002  
COPYRIGHT © 2021

Drawing Title:

**THIRD FLOOR LIGHTING PLAN -  
PHASE 1**

Project Phase:

BID DOCUMENTS

**FULLY SPRINKLERED**

Project Title:

**RENOVATE MED SURGE  
WARDS**

Location:

VETERANS HEALTHCARE SYSTEM  
OF THE OZARKS

Date:

MARCH 24, 2024

Checked:

LEH

Drawn:

CSR

Project Number:

564-17-140

Building Number:

1

Drawing Number:

**EL103**

Sheet **148** of **162**

**Engineering  
Service**



**VA**

U.S. Department  
of Veterans Affairs