

GENERAL SHEET NOTES

- A. RESEED FENCED AREAS UPON COMPLETION OF PHASED WORK AND REMOVAL OF FENCES. SEE SPEC SECTION 92 00 00 FOR SEEDING REQUIREMENTS.
- B. PERFORM CIVIL SITE SURVEYS PRIOR TO COMMENCING EXTERIOR WORK. SEE SPEC SECTION 01 00 00.
- C. PERFORM UTILITY LOCATING SERVICES PRIOR TO STARTING CONSTRUCTION TO DETERMINE AND FIELD VERIFY UTILITY LOCATIONS. COORDINATE ALL WORK WITH THE RESPECTIVE UTILITY COMPANY AND THE COR.
- D. ANY DISCREPANCIES OR CONFLICTS WHICH BECOME APPARENT BEFORE OR DURING CONSTRUCTION, SHALL BE BROUGHT TO THE ATTENTION OF THE ENGINEER OF RECORD OR COR. PRIOR TO CONSTRUCTION SO THAT REDESIGN OR CLARIFICATION MAY OCCUR.
- E. CONDUCT SITE ACTIVITY TO PROVIDE MINIMUM TRAFFIC DISRUPTIONS AND FOLLOW VA FACILITY GUIDELINES.
- F. CONTRACTOR TO MAINTAIN EXISTING SITE DRAINAGE IN WORK AREAS.
- G. PERFORM EXISTING CONDITIONS SURVEYS INSIDE AND OUTSIDE PRIOR TO WORK. SEE SPEC SECTION 01 00 00.
- H. UPON COMPLETION OF CONTRACT, RESTORE, REPLACE, AND/OR REINSTALL DAMAGED EXISTING WORK (LAWN, UTILITIES, ROADS, WALKS, ETC). LEAVE WORK IN SAME CONDITION AS EXISTED BEFORE COMMENCING WORK.
- I. PRIOR TO CONSTRUCTING FENCE LOCATIONS, COORDINATE WITH COR. SEE SPEC SECTION 01 00 00 FOR TEMPORARY FENCE AND STAGING REQUIREMENTS. PROVIDE COR DUPLICATE KEY OR CODE TO ALL FENCE GATE LOCKS.
- J. PROTECT EXISTING TREES, SHRUBS, AND OTHER FORMS OF VEGETATION DURING CONSTRUCTION. FOR TREES LOCATED IN FENCED WORK AREAS, INSTALL TREE PROTECTION ZONES (TPZ) PRIOR TO CONSTRUCTION WORK ACTIVITIES. TPZ IS AN EXCLUSION ZONE INCLUDING CONTINUOUS 4'-0" TALL TREE PROTECTION AND ONE (1) TEMPORARY CONSTRUCTION SAFETY SIGN PER TREE MOUNTED TO TPZ FENCE POST. 12"x24" SIGN STATES IN ENGLISH AND SPANISH "TREE PROTECTION - DO NOT ENTER". 4'-0" ROLL FENCE TO BE USED. FABRIC COLOR IS BRIGHT ORANGE. CONSTRUCTION MATERIALS AND WORK ACTIVITIES ARE PROHIBITED INSIDE TPZ. TREE PROTECTION RADIUS IS CALCULATED AS FOLLOWS:
- TPZ RADIUS AROUND THE TRUNK = TRUNK DIAMETER IN INCHES x 1.5 MULTIPLIER = TPZ RADIUS IN FEET.
- EXAMPLE:
TRUNK DIAMETER = 8 INCHES
8" TRUNK x 1.5 MULTIPLIER = 12'-0" RADIUS TPZ MEASURED FROM TRUNK.

SHEET KEYNOTES

- 1.10 FENCED DUMPSTER LOCATION DURING CONSTRUCTION OF ZB.
- 1.13 CONTRACTOR SHALL REMOVE EXISTING GRASS AND LEVEL THE PAD FOR TEMPORARY AHU. PROVIDE GEOFABRIC ON GRADE W/ 4" GRAVEL BASE FOR TEMPORARY AHU.
- 1.16 LOCATION OF TEMPORARY AHU TO SERVE 1B DURING ZB CONSTRUCTION. LOCATE ON BERM.
- 1.17 GENERATOR TO SERVICE TEMPORARY AHU. LOCATE MINIMUM 25'-0" AWAY FROM TEMPORARY AHU UNIT.
- 1.22 SEE DETAIL 04 ON SHEET AE450 FOR EXISTING SITEWORK INFORMATION RELATING TO EAST STAIR LOCATION.
- 1.24 UNFENCED CONNEX MATERIAL STORAGE AREA. COORDINATE PRECISE CONNEX LOCATIONS WITH COR. PROVIDE COR DUPLICATE KEY TO ALL CONNEXES STORED ON SITE.
- 08.20 RETROFIT EXISTING SECURED GATE WITH AN ELECTRIFIED RIM PANIC DEVICE-WEATHERIZED AT EACH LEAF (FREE EGRESS AT HOSPITAL SIDE) WEATHERPROOF CARD READER AT PUBLIC SECURE SIDE.
- 08.21 MAX. OPENING, 11'-6"H x 15'-6"W.

SYMBOLS LEGEND

- CONSTRUCTION FENCE AND GATES. COORDINATE PRECISE LOCATION WITH VA/COR. SEE SPEC SECTION 01 00 00.

KEY PLAN

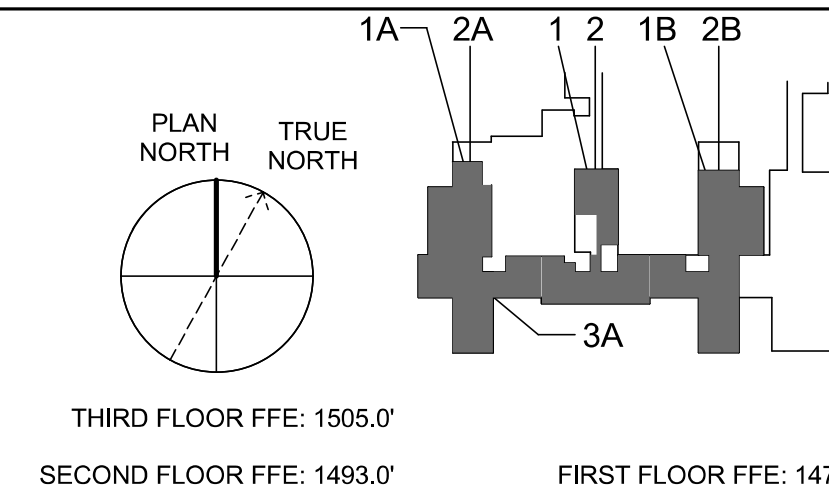

ARCHITECTURAL SITE PLAN

1" = 30'-0"

Revisions:		
No.	Description	Date

CONSULTANTS:



8701 RED OAK BLVD, SUITE 500
CHARLOTTE, NC 28217
PHONE: 704.522.0405
WWW.BRITTPETERS.COM

Seal:

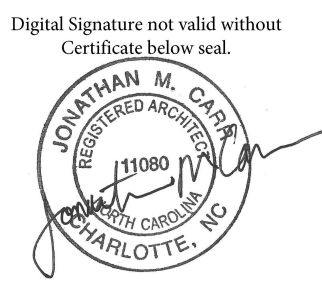

ARCHITECT / ENGINEERS:



8016 TOWER POINT DRIVE
CHARLOTTE, NC 28227

P 704.814.1320
F 704.321.0833

HG PROJECT: 18002
COPYRIGHT © 2023

Drawing Title:

ARCHITECTURAL SITE PLAN

Project Phase:

BID DOCUMENTS

FULLY SPRINKLERED

Project Title:

RENOVATE MED SURGE
WARDS

Location:

VETERANS HEALTHCARE SYSTEM
OF THE OZARKS

Date:

MARCH 24, 2024

Checked:

JC/LK

Drawn:

DW

Project Number:

564-17-140

Building Number:

1

Drawing Number:

AS001

Sheet 31 of 162

Engineering
Service



VETERANS HEALTH CARE SYSTEM
OF THE OZARKS

VA U.S. Department
of Veterans Affairs