

GENERAL SHEET NOTES

- NOTE: REFER TO ALL PHASING SHEETS. GENERAL CONTRACTOR SHALL ENSURE THAT ALL CONTRACTORS ARE RESPONSIBLE FOR COORDINATION ACROSS ENTIRE SET OF CONSTRUCTION DOCUMENTS.
- A. DEMOLITION DRAWINGS ARE DIAGRAMMATIC AND DO NOT INTEND TO SHOW THE FULL EXTENT OF ALL AREAS EFFECTED BY UTILITY DEMOLITION AND RECONSTRUCTION. DEMOLITION SHALL INCLUDE ALL ITEMS INDICATED ON THE DEMOLITION PLANS AND ALL OTHER ITEMS REQUIRED TO BE DEMOLISHED TO ACCOMPLISH NEW CONSTRUCTION. THE GENERAL CONTRACTOR SHALL BE RESPONSIBLE FOR CUTTING, PATCHING, AND REPAIR OF ALL EXISTING CONSTRUCTION AND FINISHES REQUIRED FOR THE DEMOLITION AND RECONSTRUCTION OF UTILITIES.
- B. ALL PENETRATIONS REMAINING FROM DEMOLITION SHALL BE SEALED, AND IF IN ACOUSTIC, SMOKE, AND/OR FIRE RATED CONSTRUCTION, SEALED TO MATCH THE RATING OF THE ADJACENT CONSTRUCTION, BY THE GENERAL CONTRACTOR. SEE ALL DISCIPLINES AND PHASING DRAWINGS FOR ADDITIONAL DEMOLITION, RECONSTRUCTION, AND PROTECTION INFORMATION.
- C. VERIFY ALL DIMENSIONS AND CONDITIONS AT JOB SITE. PORTIONS OF EXISTING WALLS, CEILINGS, ETC. MAY HAVE BEEN PREVIOUSLY REMOVED.
- D. UTILITY SHUTDOWN SHALL BE SCHEDULED WITH AND APPROVED BY COR WITH 2 WEEKS MINIMUM WRITTEN NOTICE.
- E. CONTRACTOR SHALL COORDINATE WITH COR THE SCHEDULING OF NOISY OR OTHERWISE INTERRUPTIVE OPERATIONS TO MINIMIZE IMPACT ON THE MEDICAL CENTER. REPAIR AND REPLACE AND/OR PATCH ADJACENT FINISHES TO PROVIDE A SMOOTH AND CONTINUOUS FINISH.
- F. DEMOLITION SHALL BE PHASED AND AFTER NORMAL BUSINESS HOURS TO ALLOW OWNER OCCUPANCY OF FLOORS ABOVE AND BELOW PROJECT AREA.
- G. PROVIDE A SECURED CONSTRUCTION AREA FOR DURATION OF PROJECT.
- H. REFER TO PHASING SHEETS FOR ADDITIONAL INFORMATION. ANY EXISTING CONSTRUCTION DISCOVERED DURING DEMOLITION THAT IS NOT NOTED TO BE DEMOLISHED, BUT IS NOT IN USE OR INTENDED TO REMAIN IN USE, SHALL BE REMOVED IN ITS ENTIRETY TO THE POINT OF CONNECTION WITH EXISTING CONSTRUCTION TO REMAIN.
- I. APPLY SELF-LEVELING COMPOUND AT ALL REMOVED WALLS. APPLY LEVELING COMPOUND AFTER FLOOR DEMO TO INFILL GOUGES, PITS, AND CRACKS. SCARIFY EXISTING SLAB.
- J. CONTRACTOR TO ENSURE BEFORE ANY DEMOLITION STARTS THAT ALL IMPACTED SIGNAGE IN PROJECT LIMITS IS CAREFULLY REMOVED AND STORED AT A SAFE LOCATION FOR REUSE, PER COR.
- K. REFER TO SHEET A001 FOR GENERAL DEMOLITION NOTES.
- L. REFER TO HA DRAWINGS FOR HAZARDOUS ABATEMENT.
- M. SEE ELECTRICAL DRAWINGS FOR REQUIRED CIRCUIT TRACE REPORT. REPORT MUST BE SUBMITTED PRIOR TO DEMOLITION ACTIVITIES.
- N. REPLACE CRACKED, CHIPPED OR FADED CEILING TILES WITH NEW MATCHING CEILING TILES. AFTER FINISHING WORK, FOR DRYWALL CEILINGS, REMOVE PORTIONS OF DRYWALL TO PERFORM ABOVE CEILING WORK. REPLACE DRYWALL AND RUNNERS. INSTALL NEW TAPE AND MUD, THEN SAND AND PAINT.
- O. GC TO PROVIDE TEMPORARY SMOKE TIGHT CONSTRUCTION PARTITIONS TO SEPARATE ALL OCCUPIED AREAS FROM DEMOLITION AND CONSTRUCTION. PARTITIONS SHALL BE 1-HOUR FIRE-RATED FULL HEIGHT, EXTENDING THROUGH SUSPENDED CEILINGS TO THE FLOOR SLAB OR ROOF DECK, UNLESS SPRINKLERS ARE OPERATIONAL ON BOTH SIDES OF THE TEMPORARY PARTITION THEN PARTITION MAY BE PERMITTED TO TERMINATE AT THE CEILING.
- P. GC TO PROVIDE ADHESIVE MAT FOR INFECTION CONTROL AT ALL ABANDONED THRU-WALL, PENETRATIONS, INFILL WITH MATCHING EXTERIOR FACE BRICK AND MORTAR. TOOTH IN BRICK TO MATCH EXISTING COURSING.
- Q. DEMO EXISTING TERRAZZO WALL BASE AND 12-INCH FLOOR PERIMETER IN PROJECT AREAS.

SHEET KEYNOTES

- 02.21 REMOVE EXISTING WINDOW AND CUT OPENING IN EXISTING WALL BELOW. TO RECEIVE NEW EXTERIOR DOOR. FILL OPENING BETWEEN EXISTING LINTEL AND NEW DOOR. AND PROVIDE NEW BRICK VENEER TO MATCH EXISTING. SEE SPEC SECTION 05500 FOR LINTEL. TOOTH NEW BRICK TO EXISTING WALL FOR INTEGRATED CONSTRUCTION.
- 08.13 GLAZING AT EXISTING WINDOW TO BE REPLACED BY NEW 60-MIN FIRE-RATED GLASS.

SYMBOLS LEGEND

- INDICATES AREA NOT IN SCOPE OF WORK

PARTITION GRAPHICS

PARTITION PHASING

- EXISTING ELEMENT TO REMAIN
- EXISTING ELEMENT TO BE DEMOLISHED
- TEMPORARY 1-HOUR RATED ELEMENT TO BE CONSTRUCTED AND DEMOLISHED IN SAME PHASE

PARTITION RATING

- NO RATING
- SMOKE RESISTIVE PARTITION - NON RATED
- 1 HOUR FIRE BARRIER
- 1 HOUR FIRE/SMOKE BARRIER
- 2 HOUR FIRE BARRIER
- 2 HOUR FIRE/ SMOKE BARRIER

KEY PLAN

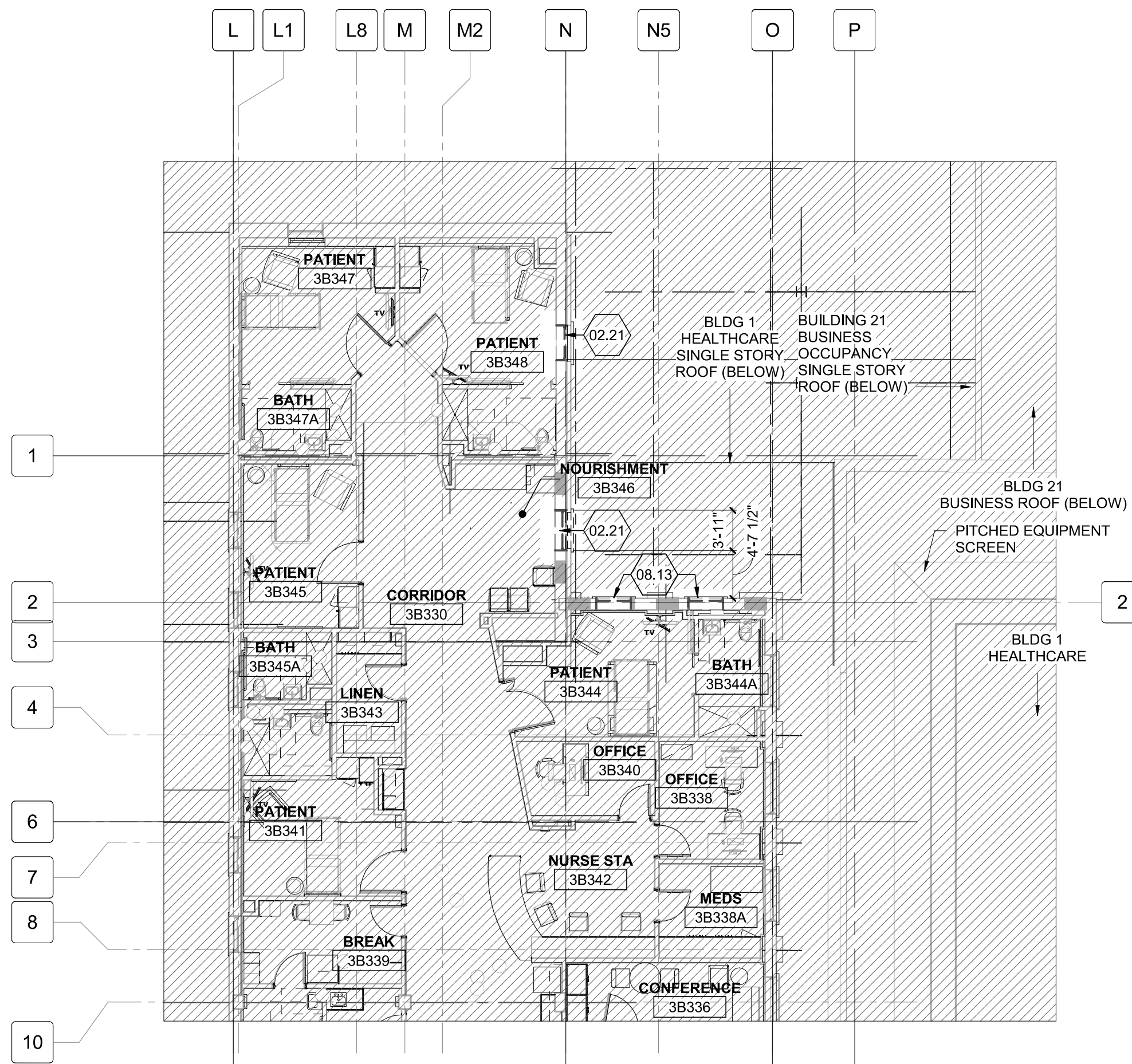
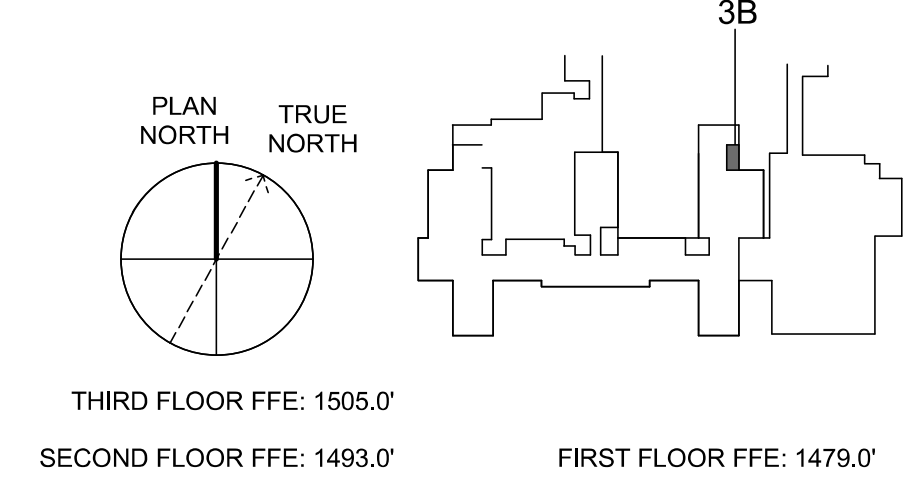

D5 THIRD FLOOR DEMOLITION PLAN - WARD 3B
3/32" = 1'-0"

| Revisions: | | |
|------------|-------------|------|
| No. | Description | Date |
| | | |

CONSULTANTS:



Seal:

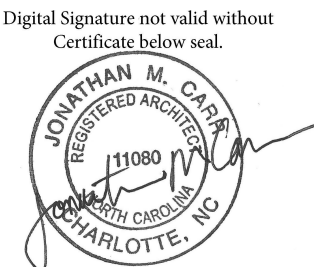

ARCHITECT / ENGINEERS:



Drawing Title:

**PARTIAL THIRD FLOOR
DEMOLITION PLAN - WARD 3B**

Project Phase:

BID DOCUMENTS

FULLY SPRINKLERED

Project Title:

**RENOVATE MED SURGE
WARDS**

Location:

VETERANS HEALTHCARE SYSTEM
OF THE OZARKS

Date:

MARCH 24, 2024

Checked:

JC/LK

Drawn:

DW

Project Number:

564-17-140

Building Number:

1

Drawing Number:

AD054

Sheet **36** of **162**

Engineering Service



VA U.S. Department
of Veterans Affairs