

A/C-3 "York" Model SA91RPV 200 w/Plenum (Plenum shall be manufactured to allow for Duct Connections to front of Unit and furnished with a variable 0-100% Outdoor Air Package [Economizer] with automatic control using damper motor. Furnish w/Temperature & Entalpy Control). Nominal 7 1/2 Ton., 3000 cfm @ 1.3 S.P. Electrical Service @ 460 V, 3#, 60 Hz. Cooling (based on 67°F w/ Air on Evaporator & 95°F Air on Condenser) Total = 91 mbh & Sensible = 75 mbh. Heating (First Step) Input = 80 mbh & Output = 60 mbh, (Both Steps Total) Input = 200 mbh & Output = 150 mbh. Provide with 1 1/2 HP Evaporator Fan Motor.

H. V. A. C. PLAN 1/8" = 1'-0" North

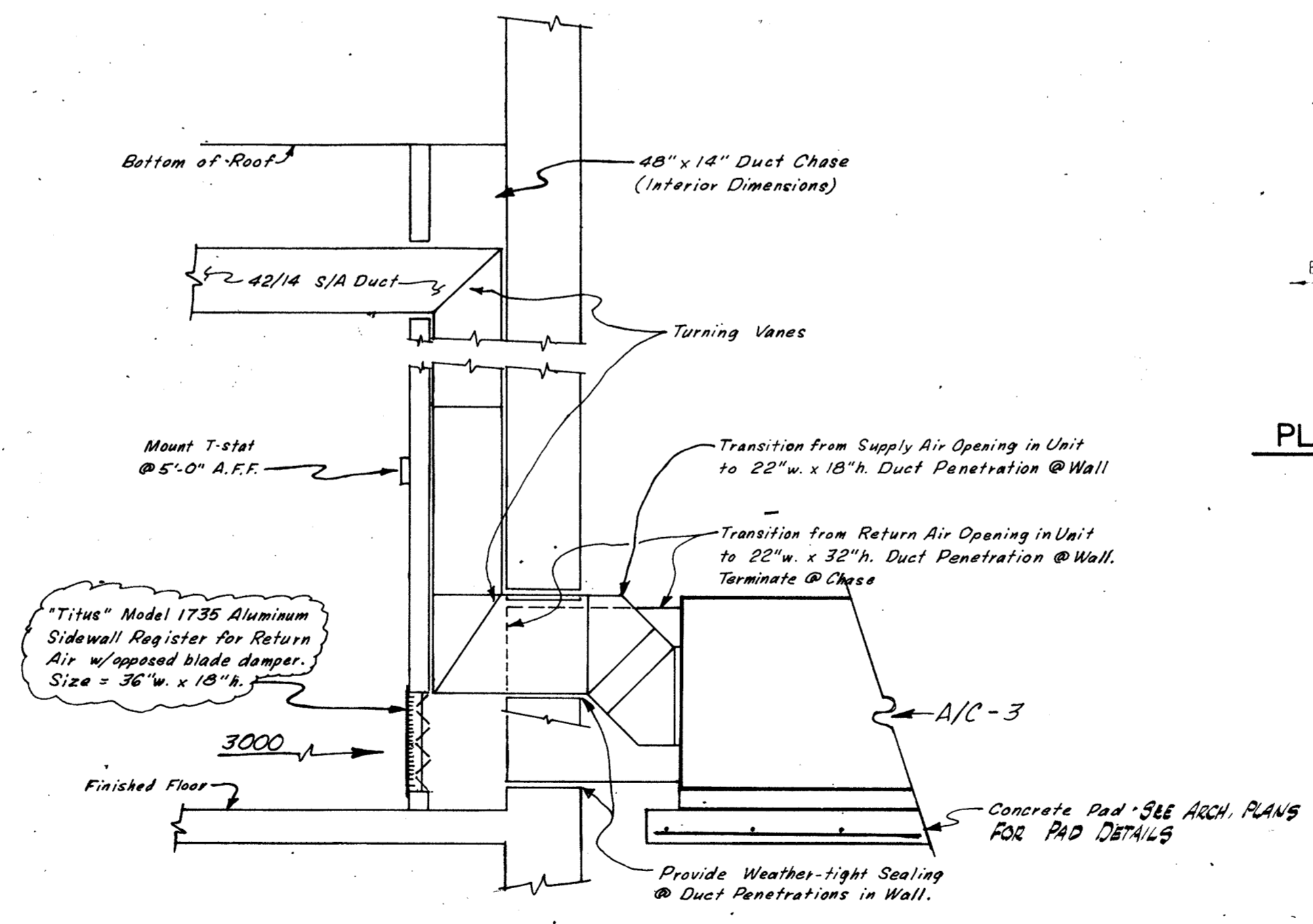

SECTION "A-A" 1/2" = 1'-0"

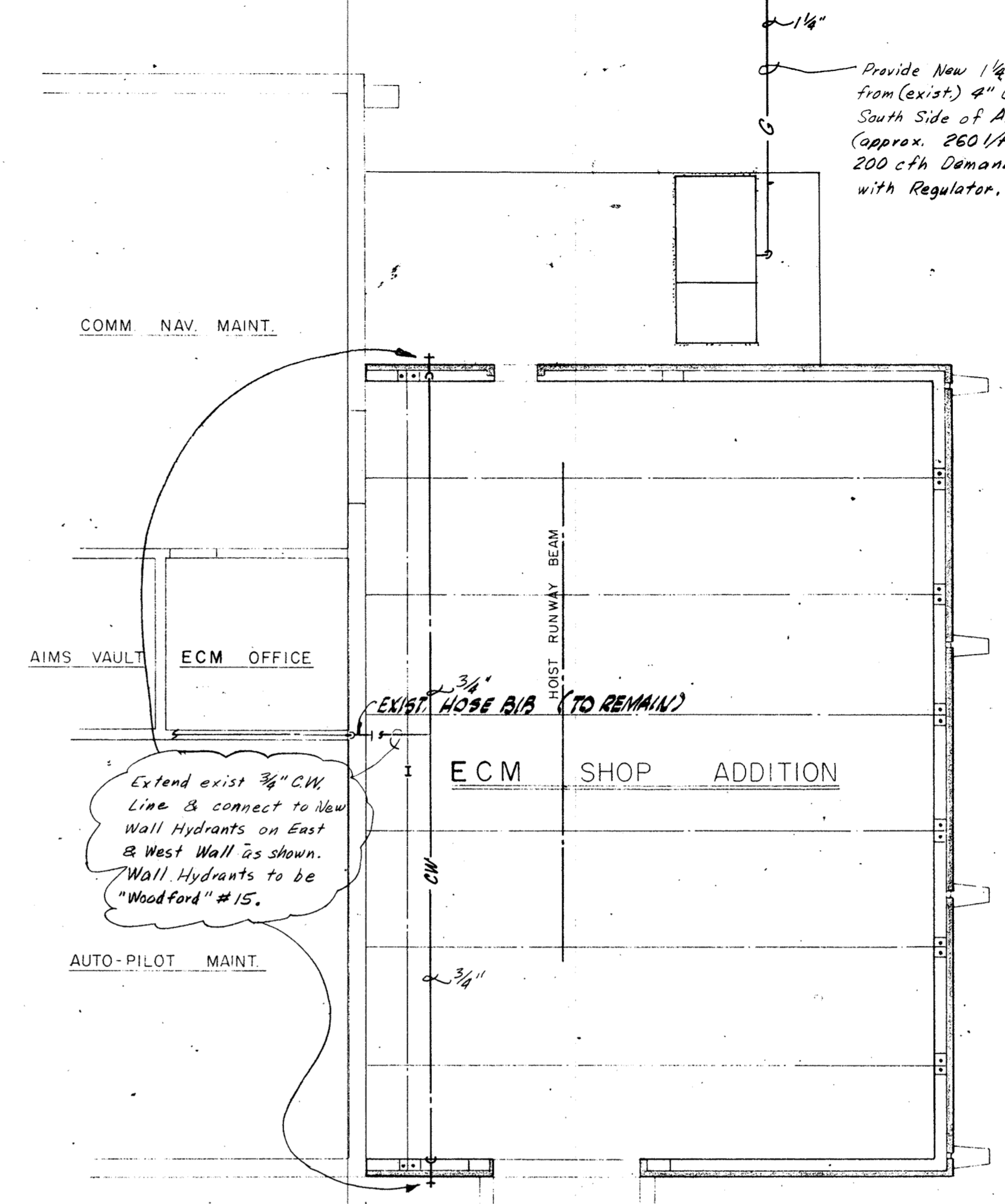

PLUMBING PLAN 1/8" = 1'-0" North

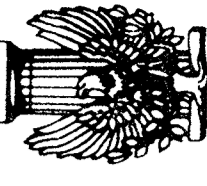

**LKHG**  
 LASER KNIGHT HATHAWAY & GUEST, P.A.  
 ARCHITECTS - ENGINEERS - HEALTH CARE PLANNERS  
 800 FIRST NATIONAL BANK • FORT SMITH, ARKANSAS

---

ALTERATIONS AND ADDITION / ECM SHOP

**AVIONICS FACILITY**

ARKANSAS AIR NATIONAL GUARD  
 FORT SMITH, ARKANSAS

---

H.V.A.C. & PLUMBING PLANS	REVISIONS
JOB NUMBER 78-39-1966.1	DATE JUN 9, 1978
SHEET <b>2</b>	CATEGORY <b>M</b>

DRAFTSCALE 250