

LIFE SAFETY PLAN LEGEND

- 1HR. FIRE-RATED WALL
- TRAVEL DISTANCE
- SMOKE DETECTOR
- CONCRETE MASONRY WALL
- GRPSUM/METAL STUD PARTITION
- WALL-MOUNTED EXIT SIGN
- SEE ELEC. DWGS.
- EMERGENCY LIGHTING-SEE ELEC. DWGS.
- VOICE EVACUATION MASS NOTIFICATION AMBER VISUAL STROBE AND SPEAKER, WALL MOUNT 8" AFF OR 6" BELOW CEILING, WHICHEVER IS LOWER, NUMBER DESIGNATES CANDELA LEVEL.
- PULL STATION
- ETREWSH
- 15 FIRE ALARM CLEAR VISUAL STROBE, WALL MOUNT 8" AFF OR 6" BELOW CEILING, WHICHEVER IS LOWER, NUMBER DESIGNATES CANDELA LEVEL.
- BRACKET-MOUNTED FIRE EXTINGUISHER, 10LB ABC, DRY-CHEMICAL TYPE
- FIRE EXTINGUISHER CABINET W/ 10LB ABC DRY-CHEMICAL FIRE EXTINGUISHER
- NOTE: FIRE EXTINGUISHERS SHALL BE INSTALLED W/ TOP AT 4'-0" MAX. HEIGHT AND PROVIDE STOCK ON ELEVATION AND DIRECTIONAL ARROWS TO IDENTIFY THE CABINET OR EXTINGUISHER'S LOCATION.

PROJECT CODE CRITERIA:

PERIMETER OF BUILDING: 804' FT
 AREA OF BUILDING INSIDE FACE OF EXTERIOR WALL: 29,087 SF
 TYPE OF CONSTRUCTION: IRI, SPRINKLERED

BUILDING HEIGHTS FOR (B) BUSINESS OCCUPANCY:

1. NUMBER OF STORES ALLOWED: 4
2. NUMBER OF STORES PROVIDED: 1
3. BUILDING HEIGHT ALLOWED (FT): 55'
4. BUILDING HEIGHT PROVIDED: 47'-0" A.F.F.
5. ALLOWABLE SQUARE FOOTAGE: UNLIMITED PER ETL 02.15

OCCUPANCY LOAD:	SQ. FT.	PER PERSON	TOTAL OCCUPANTS
BUSINESS	6,992 GROSS	100	70
HARBORNS	22,588 NET	500	46
CALCULATED OCCUPANCY LOAD:			116

CODES USED:

- 2002 ARKANSAS BUILDING CODE (IBC) 2000 WITH ARKANSAS STATE AMENDMENTS
- 2006 NFPA 101 LIFE SAFETY CODE
- ETL 02-15 FIRE PROTECTION ENGINEERING CRITERIA- NEW AIRPORT FACILITIES
- UPC 3-280-01 AIRPORT AND HELIPORT DESIGN AND PLANNING
- UPC 3-410-04 INDUSTRIAL VENTILATION
- UPC 3-600-01 DESIGN: FIRE PROTECTION ENGINEERING FOR FACILITIES
- UPC 4-010-01 DESIGN: DOB MINIMUM ANTI-TERRORISM STANDARDS FOR BUILDING
- UPC 4-010-02 DESIGN: DOB MINIMUM STANDOFF DISTANCES FOR BUILDING
- UPC 4-020-01 SECURITY ENGINEERING: PROJECT DEVELOPMENT
- UPC 4-020-02 SECURITY ENGINEERING: PROJECT DESIGN
- UPC 4-020-03 SECURITY ENGINEERING: FINISH PERSON
- STANDARD GAS CODE (INTERNATIONAL FIRE GAS CODE) - 2000 EDITION
- NFPA NATIONAL ELECTRICAL CODE 2002 EDITION
- INTERNATIONAL ENERGY CONSERVATION CODE - 2000 EDITION

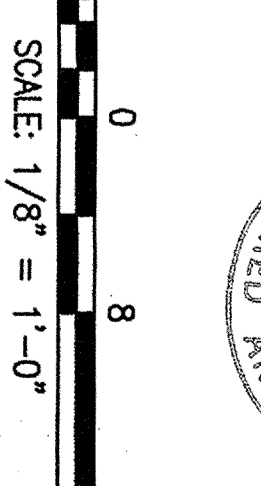
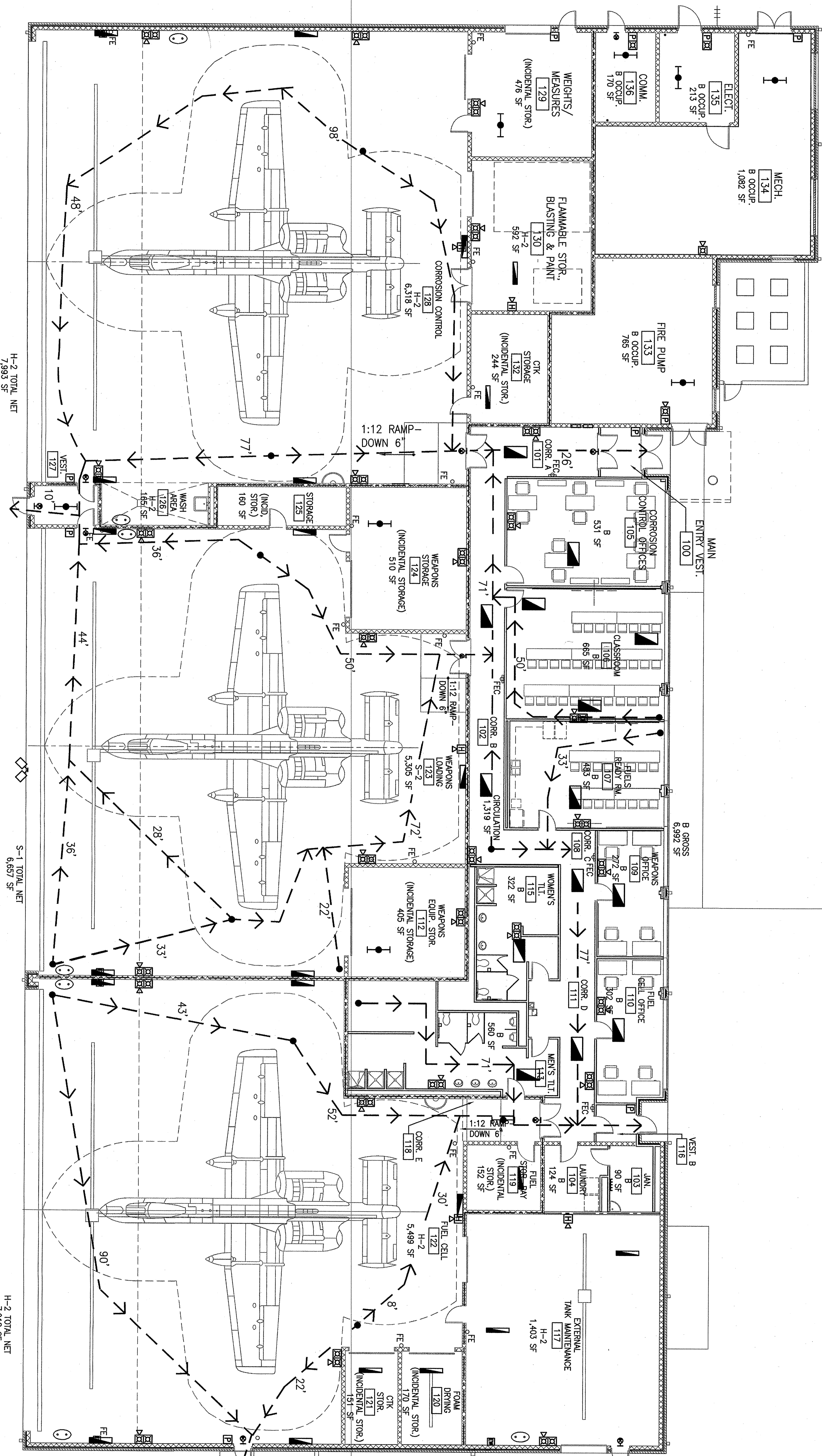

COMPOSITE A-10 AIRCRAFT MAINTENANCE FACILITY
 ARKANSAS AIR NATIONAL GUARD
 FT. SMITH, ARKANSAS

LIFE SAFETY PLAN

Sheet Reference Number: A-001
 Sheet 14 of 69

Designed by: SRG
 Dwn by: MLB
 Reviewed by: KES
 Date: 4-11-08

Mark	Description	Date	Appr.

188th Fighter Wing

Copyright 2008 by Pond & Company. All rights reserved. This document is the property of Pond & Company. It is to be used only for the specific project identified or referred to herein and is not to be used on other projects, in whole or part, except by the express written agreement of Pond & Company.

POND
 Architects • Engineers • Planners
 5500 Parkway Lane
 Newport, Va. 20092
 Phone 878-386-7740
 Fax 878-386-7740
 Web www.pondco.com

SSI
 DESIGN & BUILDERS
 CONSULTANTS

