

- PROPOSED UTILITY LEGEND**
- W WATER LINE
  - SS SANITARY SEWER LINE
  - GAS GAS LINE
  - T TELECOM LINE
  - F/O FIBER OPTIC LINE
  - ⊕ WATER METER
  - ⊕ GATE VALVE FOR WATER
  - ⊕ FIRE DEPARTMENT CONNECTION (FDC)

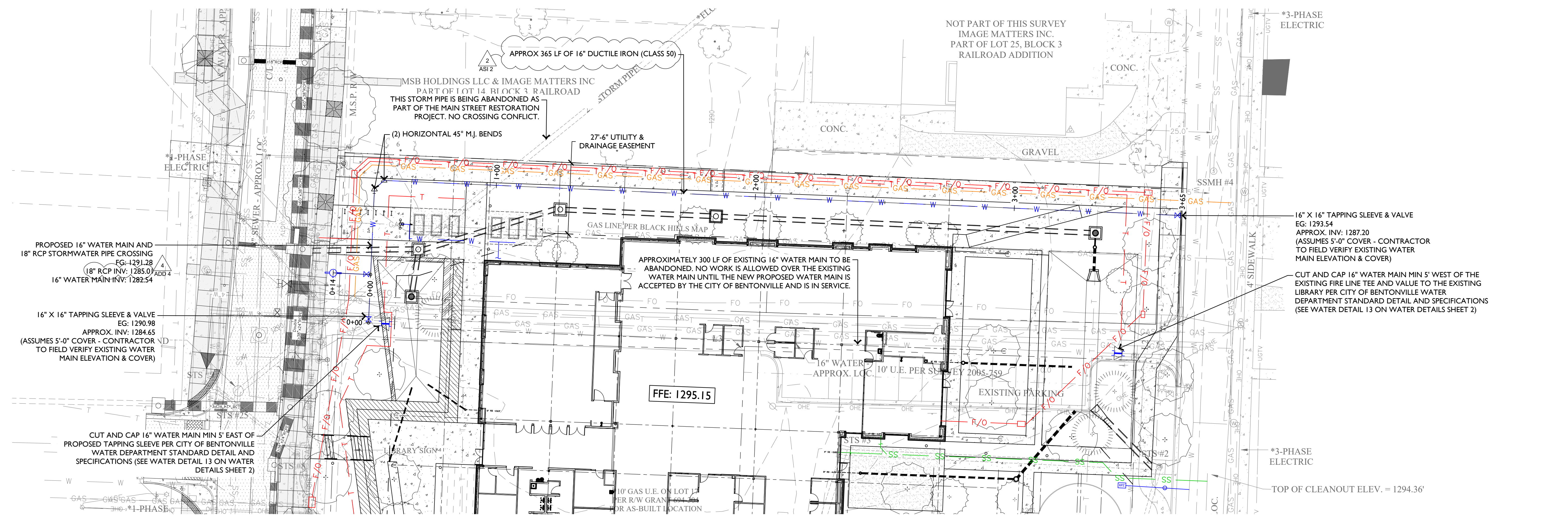

1 16 INCH WATER MAIN PLAN

SCALE: 1" = 20'-0"

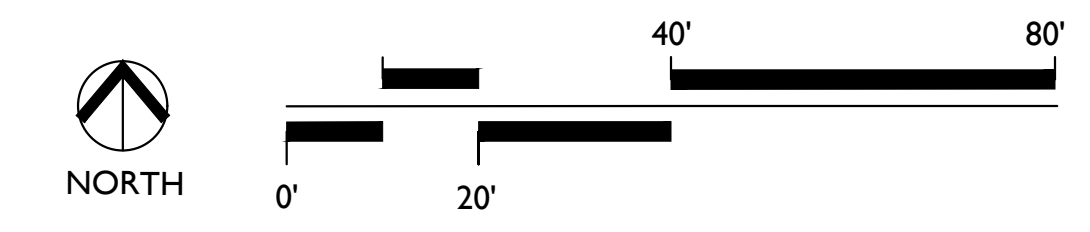

16 INCH WATER MAIN PROFILE

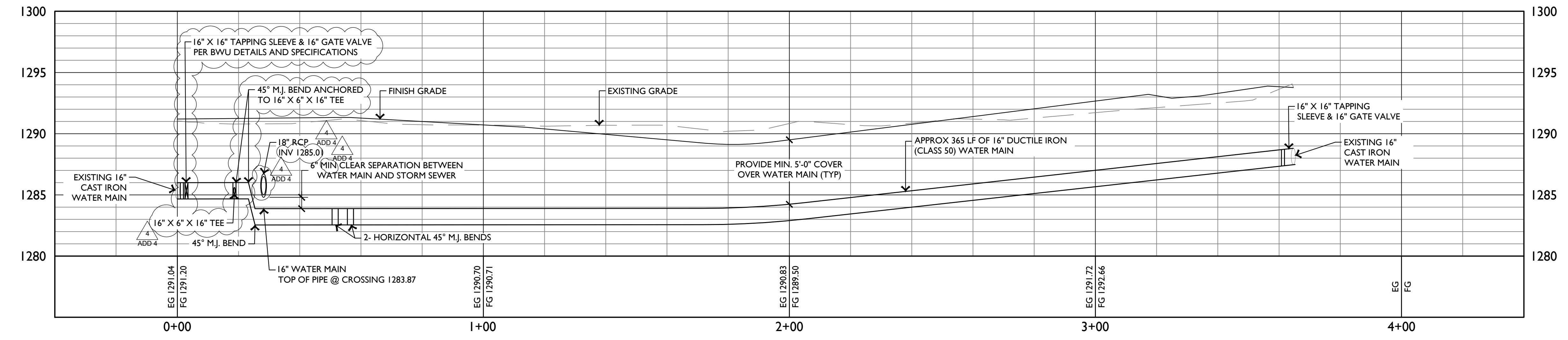

2 16 INCH WATER MAIN PROFILE

HORIZONTAL SCALE: 1" = 20'-0"  
VERTICAL SCALE: 1" = 5'-0"

- Architecture and Interiors
- MSRDesign**  
510 Marquette Avenue South, Suite 200  
Minneapolis, MN 55402 | 612.375.0396
- Associate Architect
- Hight Jackson Associates PA**  
5201 W Village Pkwy #300  
Rogers, AR 72758 | 479.464.4965
- Civil Engineer
- E | D | G**  
216 West Birch Street  
Rogers, AR 72758 | 501.378.0200
- Landscape Architect
- TEN x TEN**  
575 SE 9th St #210  
Minneapolis, MN 55414 | 612.440.8369
- Structural Engineer
- Tatum Smith Welcher Engineers, Inc.**  
3100 S Market St #202  
Rogers, AR 72758 | 479.621.6128
- MEP Engineer
- HP Engineering, Inc.**  
5214 W Village Pkwy #120  
Rogers, AR 72758 | 479.899.6370

Project No. 2021027

**Bentonville Public Library Expansion**  
405 S Main Street  
Bentonville, AR 72712

I hereby certify that this plan, specification or report was prepared by me or under my direct supervision and that I am a duly Licensed Architect under the Laws of the State of Minnesota.

Architect Seal

Signature \_\_\_\_\_  
Print Name \_\_\_\_\_  
Date \_\_\_\_\_ License No. \_\_\_\_\_

**BID SET**

**ISSUE / REVISION**

| Mark | Date       | Description                       |
|------|------------|-----------------------------------|
|      | 12/16/2021 | SCHEMATIC DESIGN PRICING          |
|      | 06/22/2022 | DESIGN DEVELOPMENT PRICING        |
|      | 8/12/2022  | DD VE OPTION B                    |
|      | 10/13/2022 | PRE APP SET                       |
|      | 10/28/2022 | LARGE SCALE DEVELOPMENT SUBMITTAL |
|      | 10/31/2022 | CD PRICING SET                    |
|      | 11/14/2022 | SECOND LSO SUBMITTAL              |
|      | 11/28/2022 | THIRD LSO SUBMITTAL               |
|      | 12/21/2022 | PERMIT SET                        |
|      | 01/06/2023 | BID SET                           |
|      | 01/18/2023 | BID SET - ADDENDUM 1              |
|      | 02/22/2023 | BID SET - ADDENDUM 3              |
|      | 03/30/2023 | ASI 2                             |
|      | 05/22/2023 | ASI 4                             |

16 INCH WATER MAIN PLAN & PROFILE

**C210**