

- TECHNOLOGY PLAN NOTES:**
- T27 PROVIDE (1) 1" CONDUIT FROM DATA ROOM #1204 IN THE MAIN BUILDING TO POLE. PROVIDE CATEGORY CABLING FROM THIS POLE LOCATION DIRECTLY TO DATA ROOM #1204. ADDITIONALLY SEE CIVIL PLANS FOR SITE ROUTING.
 - T28 PROVIDE (1) 1" CONDUIT FOR FIBER FROM PULL BOX TO PEDESTAL. TO HOUSE FIBER CONVERTER. REFER TO ELECTRICAL DRAWINGS FOR LOCATION OF PEDESTAL. SEE CIVIL PLANS FOR SITE ROUTING.
 - T37 PROPOSED LOCATION OF MINIMUM 30"x48" COMMUNICATIONS HANDHOLE IN LANDSCAPE AREA
 - T44 PROVIDE (1) 3" CONDUIT FOR FIBER FROM DATA ROOM #1538 IN THE MAIN BUILDING TO PULL BOX. SEE CIVIL PLANS FOR SITE ROUTING.
 - T45 PROVIDE (1) 3" CONDUIT FOR FIBER FROM DATA ROOM #1622 IN THE MAIN BUILDING TO PULL BOX. SEE CIVIL PLANS FOR SITE ROUTING.
 - T48 PROVIDE (1) 3" CONDUIT FOR FIBER FROM PULL BOX TO PULL BOX. SEE CIVIL PLANS FOR SITE ROUTING.
 - T49 PROVIDE (2) 1" CONDUITS FROM SECURITY GATE TO FIBER CONVERTER ENCLOSURE NEAR POLE
 - T60 ADDITIONAL CONDUITS REQUIRED BETWEEN GATES AND PEDESTALS. COORDINATE WITH ARCHITECTURAL PLANS FOR SYSTEM REQUIREMENTS.

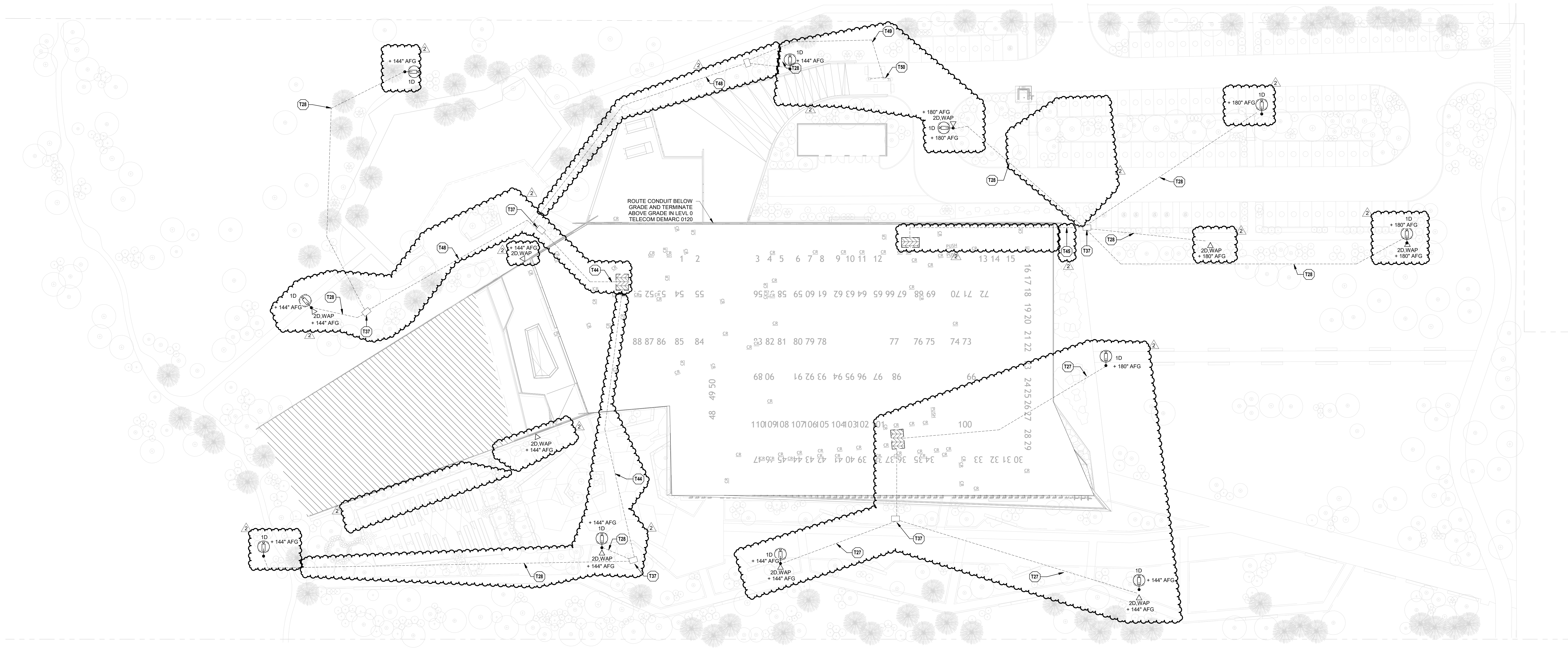

TELECOM SITE PLAN
1" = 30'-0"

PSW Job Number:
993A

Henderson Job Number:
2150002607

ARIZONA
LICENSED
PROFESSIONAL
ENGINEER
No. 12598
D. J. HALL
06/07/2023

AWSOM
Bentonville, AR

Issue Date:
02.24.2023

REVISIONS		
NUMBER	DATE	DESCRIPTION
2	06/23	Addendum 2

Contents:
TELECOM SITE PLAN

TECHNOLOGY PLAN NOTES:
 T34 DATA OUTLET FOR ELEVATOR COMMUNICATION
 COORDINATE EXACT REQUIREMENTS WITH ELEVATOR
 INSTALLER PRIOR TO ROUGH-IN

801 South Spring Street
 Little Rock, AR 72201
 501.378.0878 office
 509 W. Spring St. | Suite 100
 Fayetteville, AR 72701
 479.444.0123 office
 polkstanleywilcox.com

CIVIL
McClallan Consulting Engineers, Inc.
 1380 E STEARNS ST
 FAYETTEVILLE, AR 72703
 P: 479.443.2377

LANDSCAPE
OSD
 115 ST. JOHNS PLACE
 BROOKLYN, NY 11217
 P: 917.553.5886

STRUCTURAL
Martin Martin Consulting Engineers
 8008 SOUTH WALTON BLVD., STE 177
 BENTONVILLE, AR 72712
 P: 479.489.9946

MEFP - LOW VOLTAGE
Henderson Engineers
 8345 LENEZA DRIVE, STE 300
 LENOXA, MS 39214
 P: 913.600.8187

SUSTAINABILITY
SOM
 224 SOUTH MICHIGAN AVENUE
 CHICAGO, IL 60604
 P: 312.362.4121

SIGNAGE - WAYFINDING
TWO TWELVE
 230 W. 27th ST., SUITE 802
 NEW YORK, NY 10001
 P: 212.254.8670

FOOD SERVICE
JMC HOSPITALITY
 8506 SIX PINES DR., SUITE 8210
 THE WOODLANDS, TX 77380
 P: 689.641.2222

WATER FEATURES
OTL
 2150 S. TOWNE CENTER, SUITE 100
 ANAHEIM, CA 92806
 P: 714.637.4747

IRRIGATION
WC3 DESIGN
 11A ROBINSON MANOR BLVD.
 WICKESBURG, PA 16158
 P: 844.231.7042

PSW Job Number:
993A
 Henderson Job Number:
2150002607

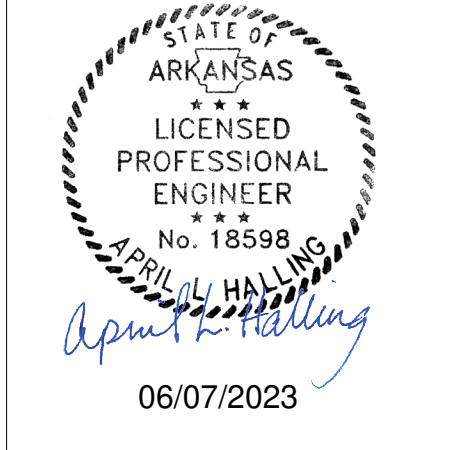

AWSOM
 Bentonville, AR

Issue Date:
02.24.2023

REVISIONS		
NUMBER	DATE	DESCRIPTION
1	03/10/23	Addendum 1
2	06/29/23	Addendum 2

Contents:
**TECHNOLOGY -
LEVEL 0 PLAN -
AREA A**

THIS PAGE IS BEST
 VIEWED IN COLOR
TN100A

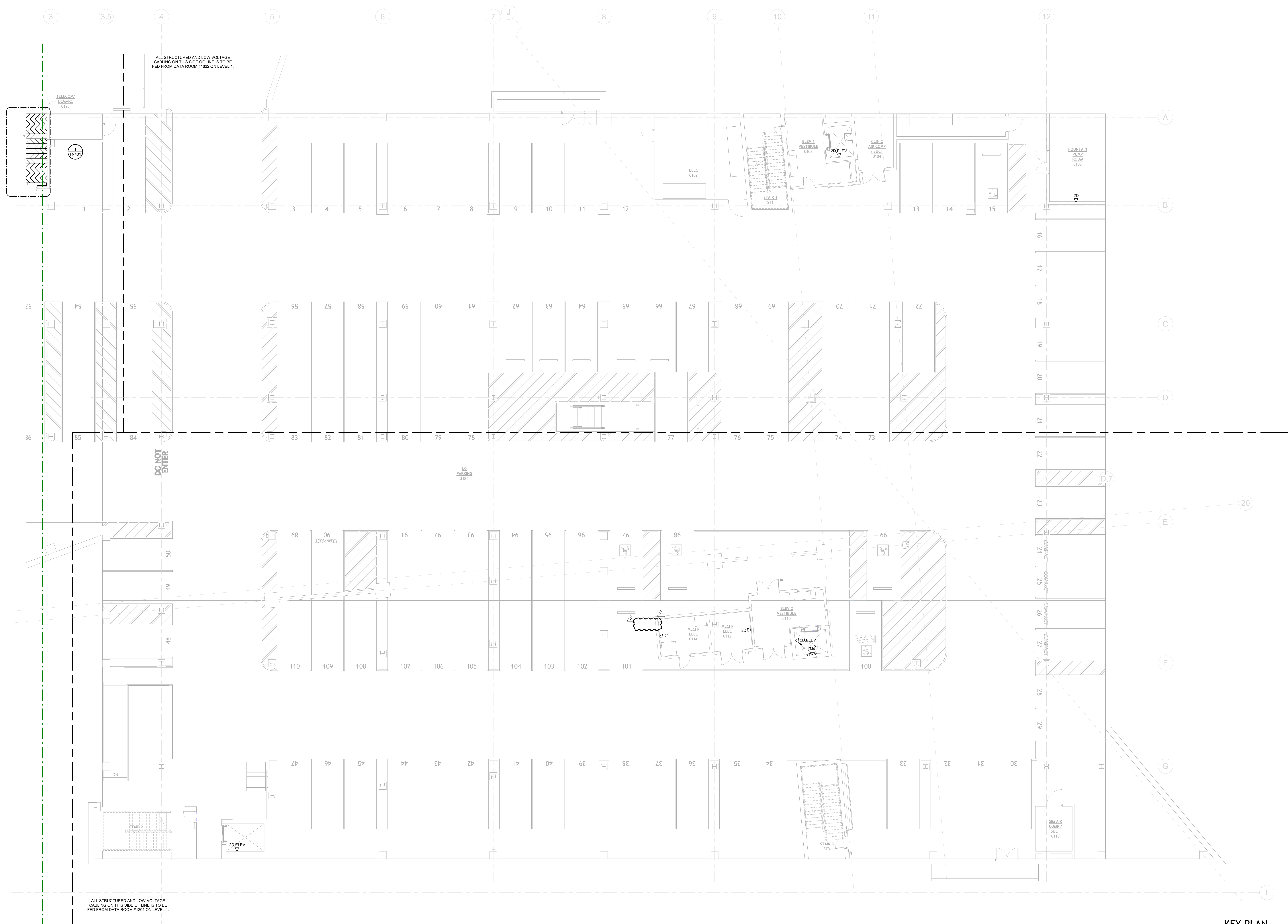

TECHNOLOGY - LEVEL 0 PLAN - AREA A
 1/8" = 1'-0"

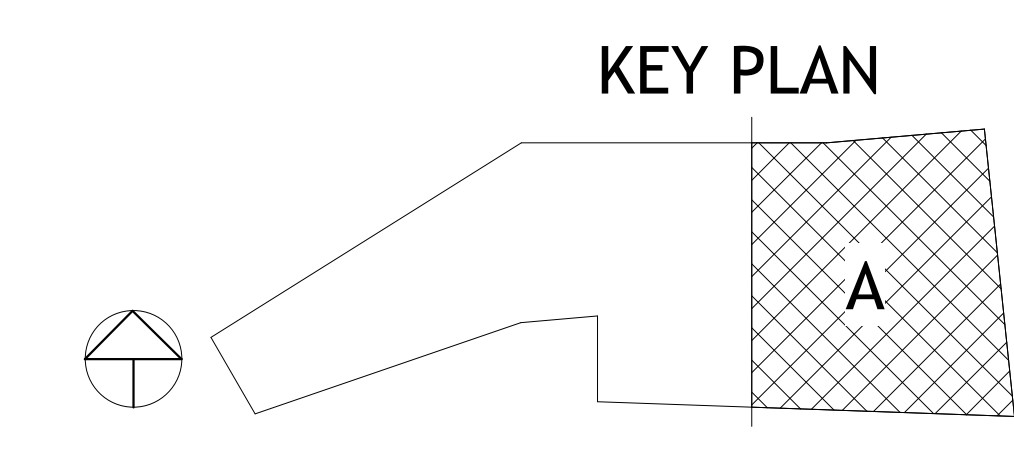

PSW Job Number:
993A

Henderson Job Number:
2150002607

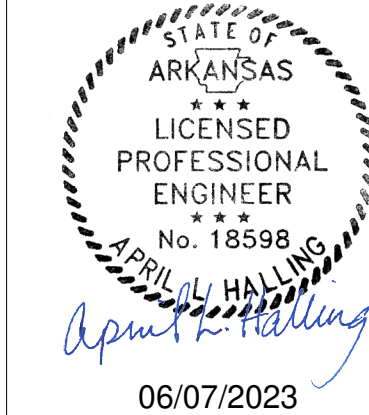

AWSOM
Bentonville, AR

Issue Date:
02.24.2023

REVISIONS		
NUMBER	DATE	DESCRIPTION
1	03/15/23	Addendum 1
2	06/29/23	Addendum 2

Contents:
TECHNOLOGY - LEVEL 3 PLAN - AREA A

THIS PAGE IS BEST VIEWED IN COLOR
TN103A

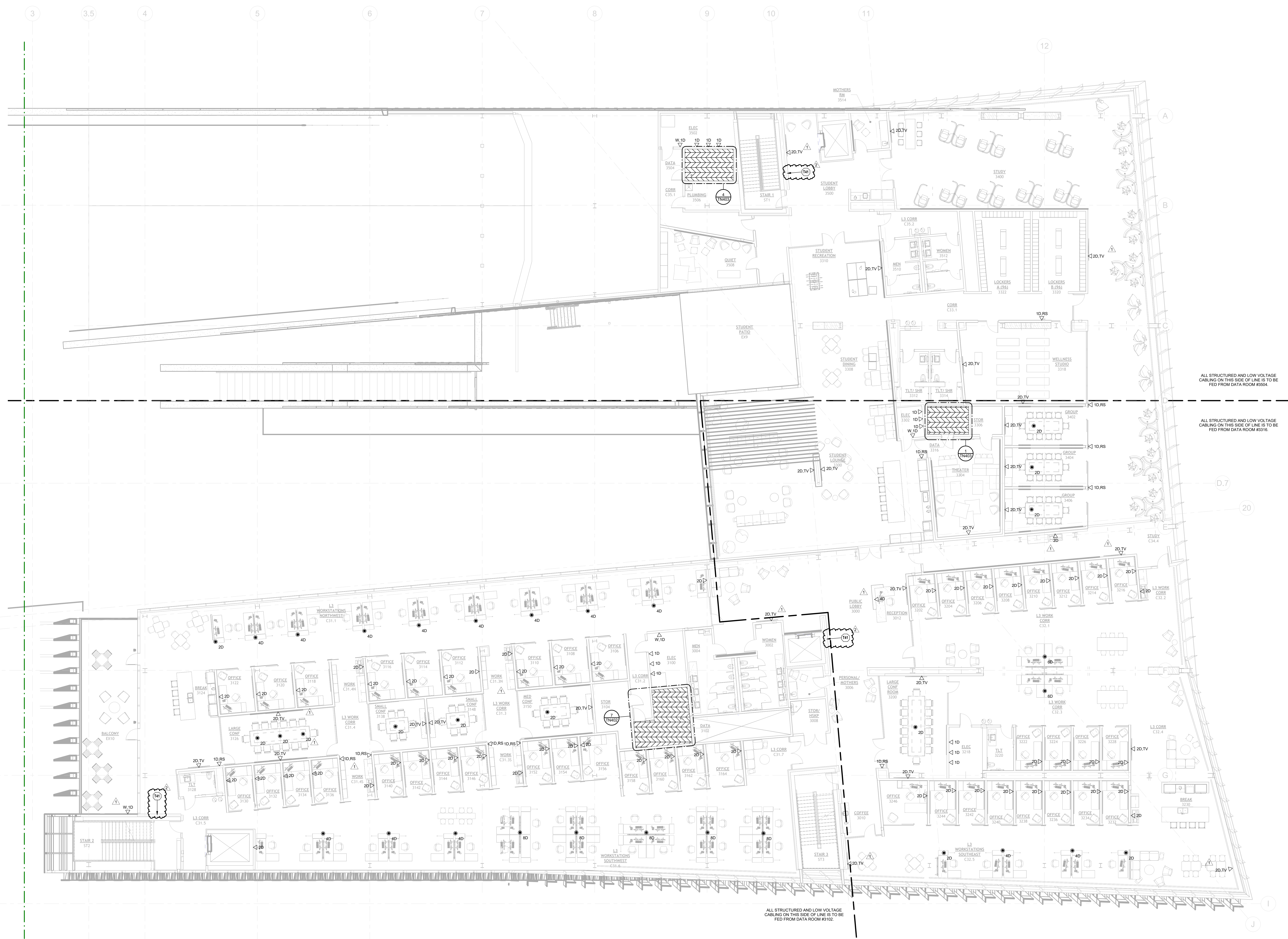

ALL STRUCTURED AND LOW VOLTAGE CABLING ON THIS SIDE OF LINE IS TO BE FED FROM DATA ROOM #3504.

ALL STRUCTURED AND LOW VOLTAGE CABLING ON THIS SIDE OF LINE IS TO BE FED FROM DATA ROOM #3116.

ALL STRUCTURED AND LOW VOLTAGE CABLING ON THIS SIDE OF LINE IS TO BE FED FROM DATA ROOM #3102.

1 TECHNOLOGY - LEVEL 3 PLAN - AREA A
1/8" = 1'-0"

KEY PLAN

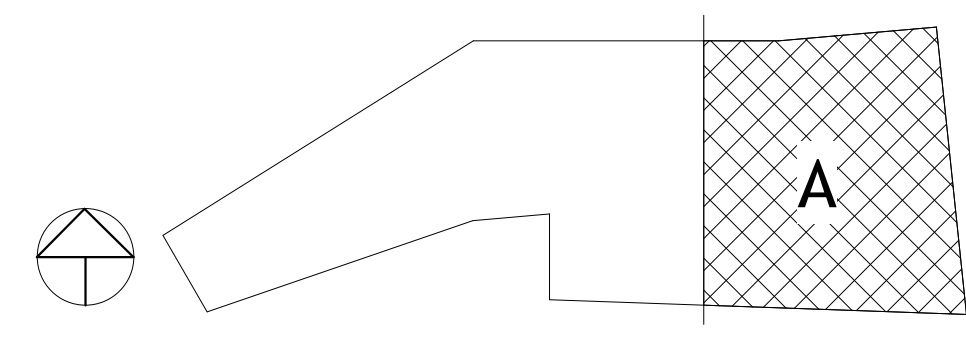

PSW Job Number:
993A

Henderson Job Number:
2150002607

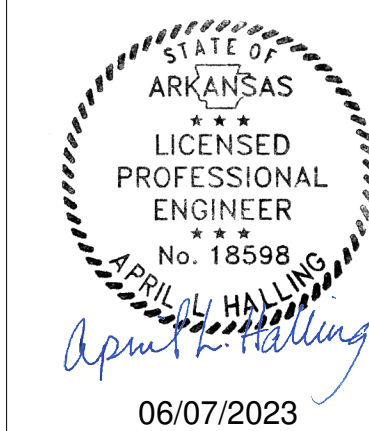

AWSOM
 Bentonville, AR

Issue Date:
02.24.2023

REVISIONS		
NUMBER	DATE	DESCRIPTION
1	03/15/23	Addendum 1
2	06/29/23	Addendum 2

Contents:
TECHNOLOGY - LEVEL 4 PLAN - AREA A

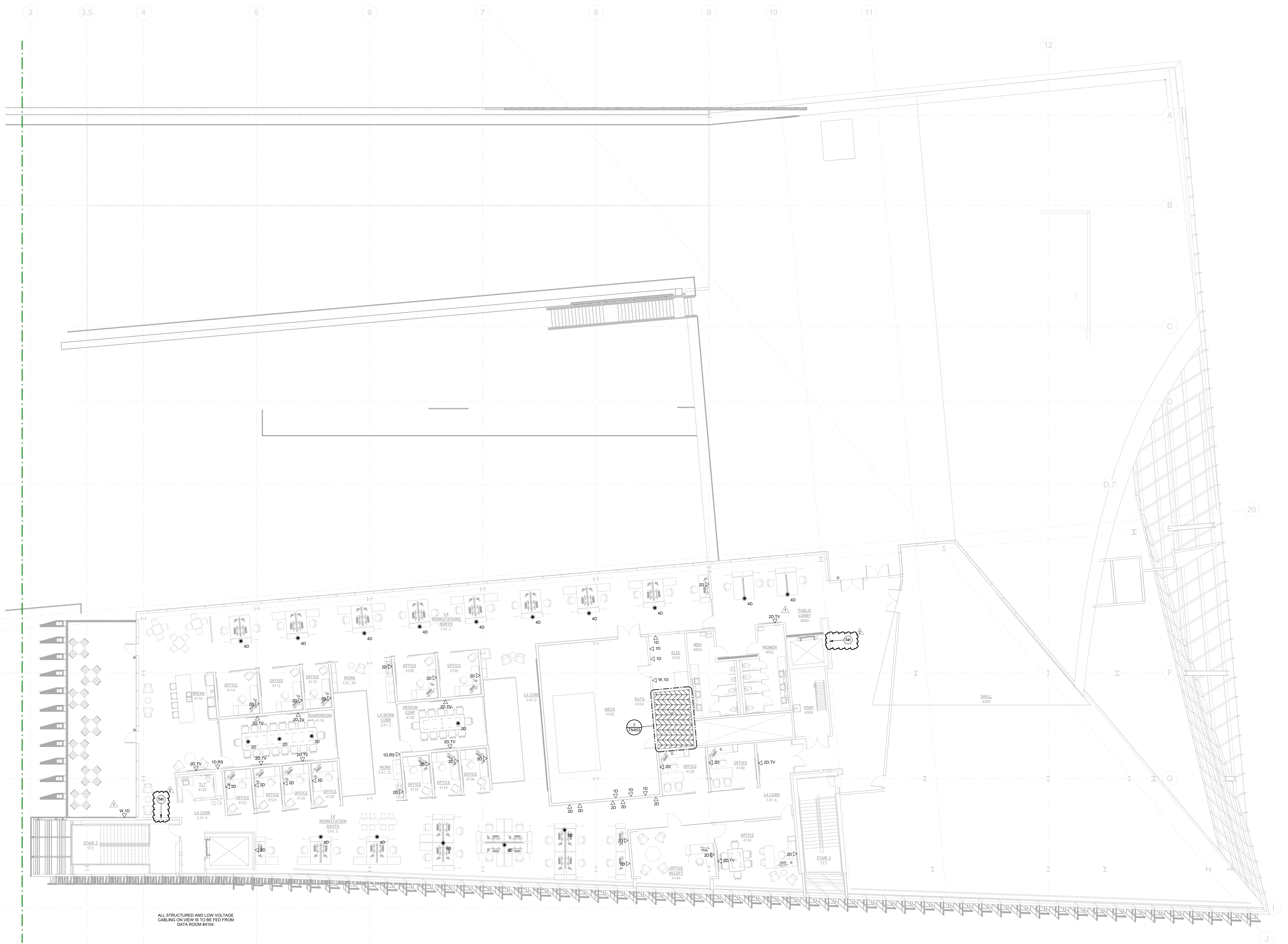

TECHNOLOGY - LEVEL 4 PLAN - AREA A
 1/8" = 1'-0"

