



# AIA<sup>®</sup> Document G709<sup>™</sup> – 2018

## Proposal Request

**PROJECT:** *(name and address)*  
AWSOM  
Bentonville, Arkansas

**CONTRACT INFORMATION:**  
Contract For: General Construction  
Date: 11.29.2021

Architect's Project Number: 993A  
Proposal Request Number: 114  
Proposal Request Date: 02.12.2025

**OWNER:** *(name and address)*  
AWSOM Lands, LLC  
PO Box 2030  
Bentonville, AR 72712

**ARCHITECT:** *(name and address)*  
Polk Stanley Wilcox  
509 W. Spring St., Ste 150  
Fayetteville, AR 72701

**CONTRACTOR:** *(name and address)*  
Crossland Construction Company  
1800 S. 52nd Street, Suite 410  
Rogers, AR 72758

The Owner requests an itemized proposal for changes to the Contract Sum and Contract Time for proposed modifications to the Contract Documents described herein. The Contractor shall submit this proposal within five (5) days or notify the Architect in writing of the anticipated date of submission.

*(Insert a detailed description of the proposed modifications to the Contract Documents and, if applicable, attach or reference specific exhibits.)*

Refer to the attached Proposal Request 114 Narrative listing revised drawings with brief description of changes.

**THIS IS NOT A CHANGE ORDER, A CONSTRUCTION CHANGE DIRECTIVE, OR A DIRECTION TO PROCEED WITH THE WORK DESCRIBED IN THE PROPOSED MODIFICATIONS.**

### REQUESTED BY THE ARCHITECT:

Mark Herrmann, AIA  
\_\_\_\_\_  
PRINTED NAME AND TITLE

# PROPOSAL REQUEST 114

## Healing Garden Revisions

**ISSUED:** February 12, 2025

**PROJECT:** AWSOM  
BENTONVILLE, AR

**FROM ARCHITECT:** POLK STANLEY WILCOX ARCHITECTS  
801 SOUTH SPRING ST.  
LITTLE ROCK AR 72201

**TO CONTRACTOR:** CROSSLAND CONSTRUCTION COMPANY, INC

---

### PROPOSAL REQUEST BRIEF

This ASI captures revisions to the path within the Healing Gardens.

### REVISED DRAWING SHEETS

#### 1. Landscape Architecture:

- 1) Refer to Revised Sheet **L000B**, with original issue date 10.21.2024 and revision date **02.12.2025**.
  - a. Updated sheet issuance for PR 114.
- 2) Refer to Revised Sheet **L103**, with original issue date 03.13.2023 and revised date **02.12.2025**.
  - a. Concrete path extents updated in southeast healing garden.
  - b. Bench extents updated along changed path.
  - c. Plant rail extents updated along changed path.
  - d. Northern path connection to fire lane removed.
- 3) Refer to Revised Sheet **L203**, with original issue date 03.13.2023 and revised date **02.12.2025**.
  - a. Updated coordinates along updated path.
- 4) Refer to Revised Sheet **L213**, with original issue date 03.13.2023 and revised date **02.12.2025**.
  - a. Updated bench coordinates along changed path.
- 5) Refer to Revised Sheet **L223**, with original issue date 03.13.2023 and revised date **02.12.2025**.
  - a. Updated bench coordinates along changed path.
- 6) Refer to Revised Sheet **L303**, with original issue date 03.13.2023 and revised date **02.07.2025**.
  - a. Updated grading in southeast healing garden.
- 7) Refer to Revised Sheet **L403**, with original issue date 03.13.2023 and revised date **02.12.2025**.
  - a. Updated soil extents conforming to changed path.
- 8) Refer to Revised Sheet **L503**, with original issue date 03.13.2023 and revised date **02.12.2025**.

- a. Updated planting extents conforming to changed path.

**End of PR 114**

1	2	3	4	5	6
Issuance	AS1 008	10.21.2024	AS1 009	12.13.2024	PR 104
AS1 008	10.21.2024	AS1 009	12.13.2024	PR 104	01.17.2025
AS1 008	10.21.2024	AS1 009	12.13.2024	PR 107	01.21.25
AS1 008	10.21.2024	AS1 009	12.13.2024	AS1 051	01.31.25
AS1 008	10.21.2024	AS1 009	12.13.2024	PR 114	02.12.25

General	Reference Plan	Site Preparation	Materials	Layout - Hardscape	Layout - Furnishings	Layout - Lighting	Layout - Wayfinding	Grading	Planting Soils	Planting
L000 Drawing list, symbols + Abbreviations	L010 Reference Plan	LSP-0 Site Preparation - Key Plan, Legend and Notes	L100 Materials - Key Plan, Legend and Notes	L200A Layout - Hardscape - Key Plan, Legend and Notes	L210 Layout - Furnishings - Key Plan, Legend and Notes	L220A Layout - Lighting - Key Plan, Legend and Notes	L231 Layout - Wayfinding - Ground Floor 1/3	L300 Grading Plan - Key Plan, Legend and Notes	L400 Planting Soils - Key Plan, Legend and Notes	L500A Planting - Key Plan, Legend and Notes
L000A Drawing List Continued	L011 LSD Site Plan	LSP-1 Site Preparation Plan 1/3	L101 Materials Plan - Ground Floor 1/3	L200B Layout - Hardscape - Data Chart	L211 Layout - Furnishings - Ground Floor 1/3	L221 Layout - Lighting - Ground Floor 1/3	L232 Layout - Wayfinding - Ground Floor 2/3	L301 Grading Plan - Ground Floor 1/3	L401 Planting Soils - Ground Floor 1/3	L500B Planting Schedule 1/4
L000B Drawing List Continued		LSP-2 Site Preparation Plan 2/3	L102 Materials Plan - Ground Floor 2/3	L201 Layout - Hardscape - Groundfloor 1/3	L212 Layout - Furnishings - Ground Floor 2/3	L222 Layout - Lighting - Ground Floor 2/3	L233 Layout - Wayfinding - Ground Floor 3/3	L302 Grading Plan - Ground Floor 2/3	L402 Planting Soils - Ground Floor 2/3	L500C Planting Schedule 2/4
L001 Symbols, Abbreviations, Legends		LSP-3 Site Preparation Plan 3/3	L103 Materials Plan - Ground Floor 3/3	L202 Layout - Hardscape - Groundfloor 2/3	L213 Layout - Furnishings - Ground Floor 3/3	L223 Layout - Lighting - Ground Floor 3/3	L234 Layout - Wayfinding - Roof 1/2	L303 Grading Plan - Ground Floor 3/3	L403 Planting Soils - Ground Floor 3/3	L500D Planting Schedule 3/4
			L104 Materials Plan - Roof 1/2	L203 Layout - Hardscape - Groundfloor 3/3	L214 Layout - Furnishings - Roof 1/2	L224 Layout - Lighting - Roof 1/2	L235 Layout - Wayfinding - Roof 2/2	L304 Grading Plan - Roof 1/2	L404 Planting Soils - Roof 1/2	L500E Planting Schedule 4/4
			L105 Materials Plan - Roof 2/2	L204 Layout - Hardscape - Roof 1/2	L215 Layout - Furnishings - Roof 2/2	L225 Layout - Lighting - Roof 2/2		L305 Grading Plan - Roof 2/2	L405 Planting Soils - Roof 2/2	L501 Planting Plan - Ground Floor 1/3
			L106 Materials Plan - Roof Level 3	L205 Layout - Hardscape - Roof 2/2				L306 Grading Plan - Roof - Level 3		L502 Planting Plan - Ground Floor 2/3
										L503 Planting Plan - Ground Floor 3/3
										L504 Planting Plan - Roof 1/2
										L505 Planting Plan - Roof 2/2
										L506 Tree Planting Plan - Ground Floor 1/3
										L507 Tree Planting Plan - Ground Floor 2/3
										L508 Tree Planting Plan - Ground Floor 3/3
										L509 Tree Planting Plan - Roof 1/2
										L510 Tree Planting Plan - Roof 2/2
										L511 Shrub Planting Plan - Ground Floor 1/3
										L512 Shrub Planting Plan - Ground Floor 2/3
										L513 Shrub Planting Plan - Ground Floor 3/3
										L514 Shrub Planting Plan - Roof 1/2
										L515 Shrub Planting Plan - Roof 2/2

4	5	6
Issuance	PR 104	01.17.2025
PR 104	01.17.2025	PR 107
PR 104	01.17.2025	AS1 051
PR 104	01.17.2025	PR 114
PR 104	01.17.2025	AS1 001

Sections	Basin & Runnel Enlargements - Plans
L600 1 - Parking + Swale	L700A Enlargements Key Plan - Woodland Amphitheater and Welcome Plaza
2 - Pond + Wetland Terrace	L700B Enlargements Key Plan - Stone Paving and Benches
L610 1 - Tail + Grotto	L701 Woodland Amphitheater Enlargement 1 - Materials
2 - Steep Roof Cross Section	L702 Woodland Amphitheater Enlargement 2 - Materials
L611 1 - L4 Terrace Section	L703 Welcome Plaza Enlargement 1 - Materials
	L704 Amphitheater Enlargement 1 - Layout
	L705 Amphitheater Enlargement 2 - Layout
	L706A Welcome Plaza Enlargement 1 - Layout - Hardscape
	L706B Welcome Plaza Enlargement 1 - Layout - Lighting
	L707 Amphitheater Enlargement 1 - Grading
	L708 Amphitheater Enlargement 2 - Grading
	L709 Welcome Plaza Enlargement 1 - Grading
	L710 Woodland Amphitheater Section
	L711 Amphitheater Seat Wall Sections and Schedule
	L712 Woodland Amphitheater Stone Stair Schedule
	L720 Basin 1 and Runnel Plans
	L720A Cascade Falls Details
	L721 Basin 2 Plans
	L722 Basin 3 Plans
	L723 Basin Sections
	L724 Basin Sections
	L725 Basin Sections
	L730 Runnel - 3d Views
	L731 Runnel and Basin Section Elevation
	L732 Runnel Stone Schedule
	L733 Runnel Stone Schedule
	L734 Runnel Stone Schedule
	L735 Runnel Stone Schedule
	L750 Roof Tail Flake Stone Enlargement
	L751 Cafe Plaza Stone Enlargement
	L752 Prospect Bluff Stone Enlargement
	L753 Healing Garden Stone Enlargement
	L754 Winter Terrace Stone Enlargement
	L755 Stone Schedules
	L761 Teaching Garden Enlargement - Layout
	L762 Teaching Garden Enlargement - Grading
	L790 Water Feature - Details
	L791 Water Feature - Details

Basin & Runnel Enlargements - Plans	Details	Irrigation Drawings	Water Feature Drawings
L707 Amphitheater Enlargement 1 - Grading	L901 Details - Paving	I101 Ground Floor Irrigation Plan 1	WF101 Water Feature Site Plan
L708 Amphitheater Enlargement 2 - Grading	L902 Details - Paving	I102 Ground Floor Irrigation Plan 2	WF102 Water Feature Piping Plan
L709 Welcome Plaza Enlargement 1 - Grading	L903 Details - Paving, Walls, Curbs	I103 Ground Floor Irrigation Plan 3	WF201 Runnel Hydraulic Schematic
L710 Woodland Amphitheater Section	L904 Details - Furnishing	I104 Irrigation Roof Plan	WF202 Basins 2 & 3 Hydraulic Schematic
L711 Amphitheater Seat Wall Sections and Schedule	L905 Details - Furnishing	I105 Irrigation Details	WF301 Water Feature Equipment
L712 Woodland Amphitheater Stone Stair Schedule	L906 Details - Stairs, Drains, Handrails	I106 Irrigation Details	WF302 Water Feature Equipment
L720 Basin 1 and Runnel Plans	L907 Details - Fencing		WF401 Water Feature Section and Details
L720A Cascade Falls Details	L908 Details - Lighting		WF501 Water Feature Fabrication and General Details
L721 Basin 2 Plans	L909 Details - Boardwalk		WF601 Water Feature Electrical Plan
L722 Basin 3 Plans	L910 Details - Boardwalk		WF602 Water Feature Electrical Details
L723 Basin Sections	L911 Details - Planting		
L724 Basin Sections	L912 Details - Soils		
L725 Basin Sections	L913 Details - Roof Drain Access		
L730 Runnel - 3d Views	L914 Details - Teaching Garden		
L731 Runnel and Basin Section Elevation	L915 Details - Teaching Garden		
L732 Runnel Stone Schedule	L916 Details		
L733 Runnel Stone Schedule			
L734 Runnel Stone Schedule			
L735 Runnel Stone Schedule			
L750 Roof Tail Flake Stone Enlargement			
L751 Cafe Plaza Stone Enlargement			
L752 Prospect Bluff Stone Enlargement			
L753 Healing Garden Stone Enlargement			
L754 Winter Terrace Stone Enlargement			
L755 Stone Schedules			
L761 Teaching Garden Enlargement - Layout			
L762 Teaching Garden Enlargement - Grading			
L790 Water Feature - Details			
L791 Water Feature - Details			

REVISIONS
NUMBER DATE DESCRIPTION
1 10.21.2024 AS1 008
2 12.12.2024 PR 009
3 12.12.2024 AS1 009
4 01.17.2025 PR 104
5 01.21.2025 PR 107
6 01.31.2025 AS1 051
7 02.12.2025 PR 114

801 South Spring Street  
Little Rock, AR 72201  
501.378.0878 office  
509 W. Spring St | Suite 150  
Fayetteville, AR 72701  
479.644.0033 office  
polkstanleywilcox.com

CIVIL  
McClendon Consulting Engineers, Inc.  
1580 E STEARNS ST  
FAYETTEVILLE, AR 72703  
P: 479.443.2377

LANDSCAPE  
OSD  
115 ST. JOHNS PLACE  
BROOKLYN, NY 11217  
P: 917.553.5586

STRUCTURAL  
Martin/Man Consulting Engineers  
8005 SOUTH WALTON BLVD, STE 212  
BENTONVILLE, AR 72712  
P: 479.407.0545

MEPE - LOW VOLTAGE  
Henderson Engineers  
6346 LENEVA DRIVE, STE 300  
LENSA, MS 38614  
P: 662.660.6167

SUSTAINABILITY  
SOM  
224 SOUTH MICHIGAN AVENUE  
CHICAGO, IL 60604  
P: 312.360.4121

SIGNAGE - WAYFINDING  
TWO TWELVE  
236 W. 27th ST., SUITE 602  
NEW YORK, NY 10001  
P: 212.254.6870

FOOD SERVICE  
JMI HOSPITALITY  
6926 SA FINEST DR., SUITE 8210  
THE WOODLANDS, TX 77380  
P: 609.841.2222

WATER FEATURES  
OTL  
2150 S. TOWNE CENTER, SUITE 100  
ANAHAIM, CA 92806  
P: 714.637.4747

IRRIGATION  
WC3 DESIGN  
11A ROBINSON MANOR BLVD  
MOORESBURG, PA 14108  
P: 844.231.7042

PSW Job Number:  
933A

Issue Date:  
10.21.2024

REVISIONS

NUMBER	DATE	DESCRIPTION
1	10.21.2024	AS1 008
2	12.12.2024	PR 009
3	12.12.2024	AS1 009
4	01.17.2025	PR 104
5	01.21.2025	PR 107
6	01.31.2025	AS1 051
7	02.12.2025	PR 114

Contents:  
Drawing List, Symbols and Abbreviations

THIS PAGE IS BEST VIEWED IN COLOR

L000B



NUMBER	DATE	DESCRIPTION
1	03.13.2023	AWSON/AMZ
2	06.16.2023	AWSON/AMZ
3	04.16.2024	AWSON
4	04.16.2024	AWSON
5	05.20.2024	AWSON
6	07.24.2024	AWSON
7	08.19.2024	AWSON
8	10.13.2024	AWSON
9	10.13.2024	AWSON
10	02.12.2025	AWSON

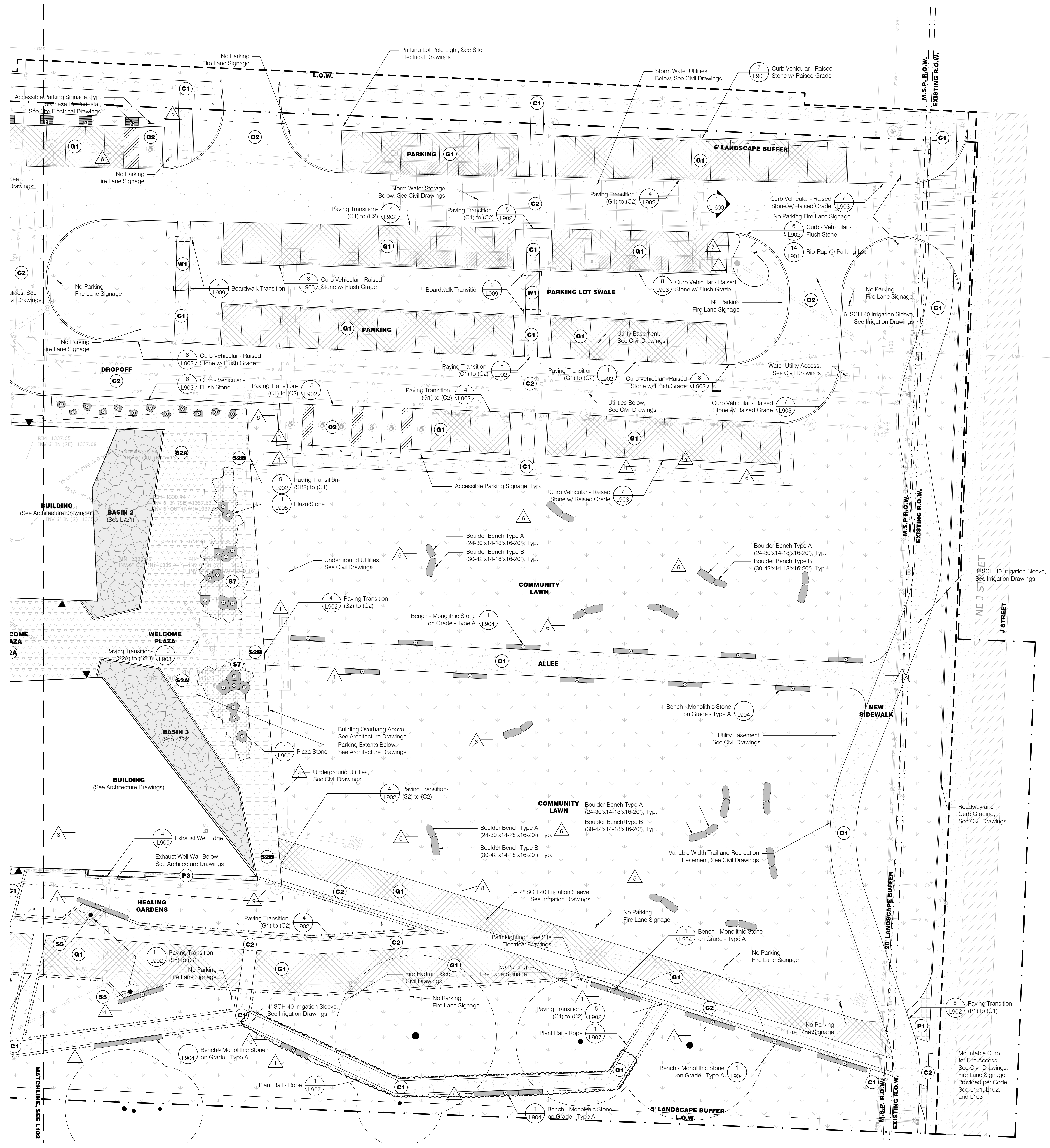

- General Legend**
- Existing Tree to Remain
  - Property Line
  - Limit of Work
  - Right of Way
  - Building Entry
  - Light Poles, See Site Electrical Drawings
  - Wall Mounted Lights, See Site Electrical Drawings
  - Bollard Lights, See Site Electrical Drawings
  - Tree Uplights, See Site Electrical Drawings
  - Charging Pedestal, See Site Electrical Drawings
  - Wireless Access Pole, See Site Electrical Drawings
  - GFCI Receptacle, See Site Electrical Drawings
  - Storm Water Catch Basin, See Civil Drawings
  - Sanitary Manhole, See Civil Drawings
  - Water Utility Access, See Civil Drawings
  - Fire Hydrant, See Civil Drawings
  - Gas Utility Access, See Civil Drawings
  - Pond Overflow Access, See Civil Drawings
  - Landscape Area Drain Inlet, See Civil Drawings
  - Landscape Underdrain, See Civil Drawings
  - Roof Drain, See Architecture Drawings

- Materials Legend**
- |  |  |  |   |
|--|--|--|---|
|  | 1 L901 Grass Pave - Vehicular (P1)                           |  | 1 L904 Bench - Monolithic Stone on Grade, Type A                        |
|  | 12 L901 Maintenance Path - Gravel Strip (P3)                 |  | 1 L904 Bench - Monolithic Stone on Grade, Type B                        |
|  | 3 L901 Gravel - Vehicular (G1)                               |  | 6 L904 Bench - Log  |
|  | 4 L901 Gravel - Pedestrian Stabilized (G2)                   |  | 7 L904 Bench - Timber   |
|  | 5 L901 Gravel - Pedestrian (G3)                              |  | 8 L904 Stump - Small Trunk  |
|  | 6 L901 Concrete Paving - Pedestrian - Exposed Aggregate (C1) |  | 10 L904 Bike Rack   |
|  | 7 L901 Concrete Paving - Vehicular - Exposed Aggregate (C2)  |  | 11 L904 Receptacle Bin  |
|  | 1 L910 Wood - Boardwalk (W1)                                 |  | Accessible Parking or Fire Lane Sign, Dimensions and Placement Per Code |
|  | 11 L901 Stone Paving - On Uninsulated Structure (S2A)        |  | 1 L907 Plaza Stone  |
|  | 13 L901 Stone Paving - Plaza - On Grade (S2B)                |  | 1 L907 Plant Rail - Rope  |
|  | 9 L901 Stone Paving - Winter Terrace - On Grade (S5)         |  | 3 L907 Fencing - Teaching Garden Deer Fence                             |
|  | 13 L901 Stone Paving - Plaza - On Grade (S7)                 |  | 4" SCH 40 Irrigation Sleeve, See Irrigation Drawings                    |
|  | 1 L916 Decomposed Granite (G4)                               |  | 6" SCH 40 Irrigation Sleeve, See Irrigation Drawings                    |
|  | Planted Area   |  | Siamese EV Pedestal, See Site Electrical Drawings                       |
|  | Water  |  | Boulder Bench Type A (24-30"x14-18"x16-20"), Typ.                       |
|  |  |  | Boulder Bench Type B (30-42"x14-18"x16-20"), Typ.                       |

1 Materials Plan - Ground Floor 3  
Scale: 1/16" = 1'-0"

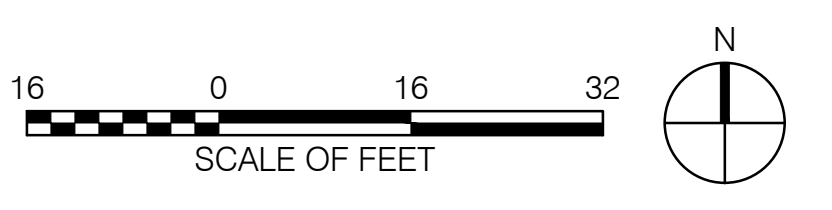

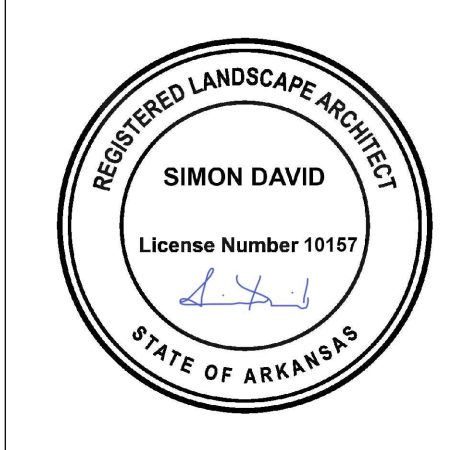

REVISIONS		
NUMBER	DATE	DESCRIPTION
1	03.13.2023	ADDITIONAL
2	06.09.2023	ADDITIONAL
3	06.30.2024	AS-BUILT
4	07.24.2024	PR 009
5	10.23.2024	PR 008
6	10.16.2024	AS-BUILT
7	10.12.2025	PR 111

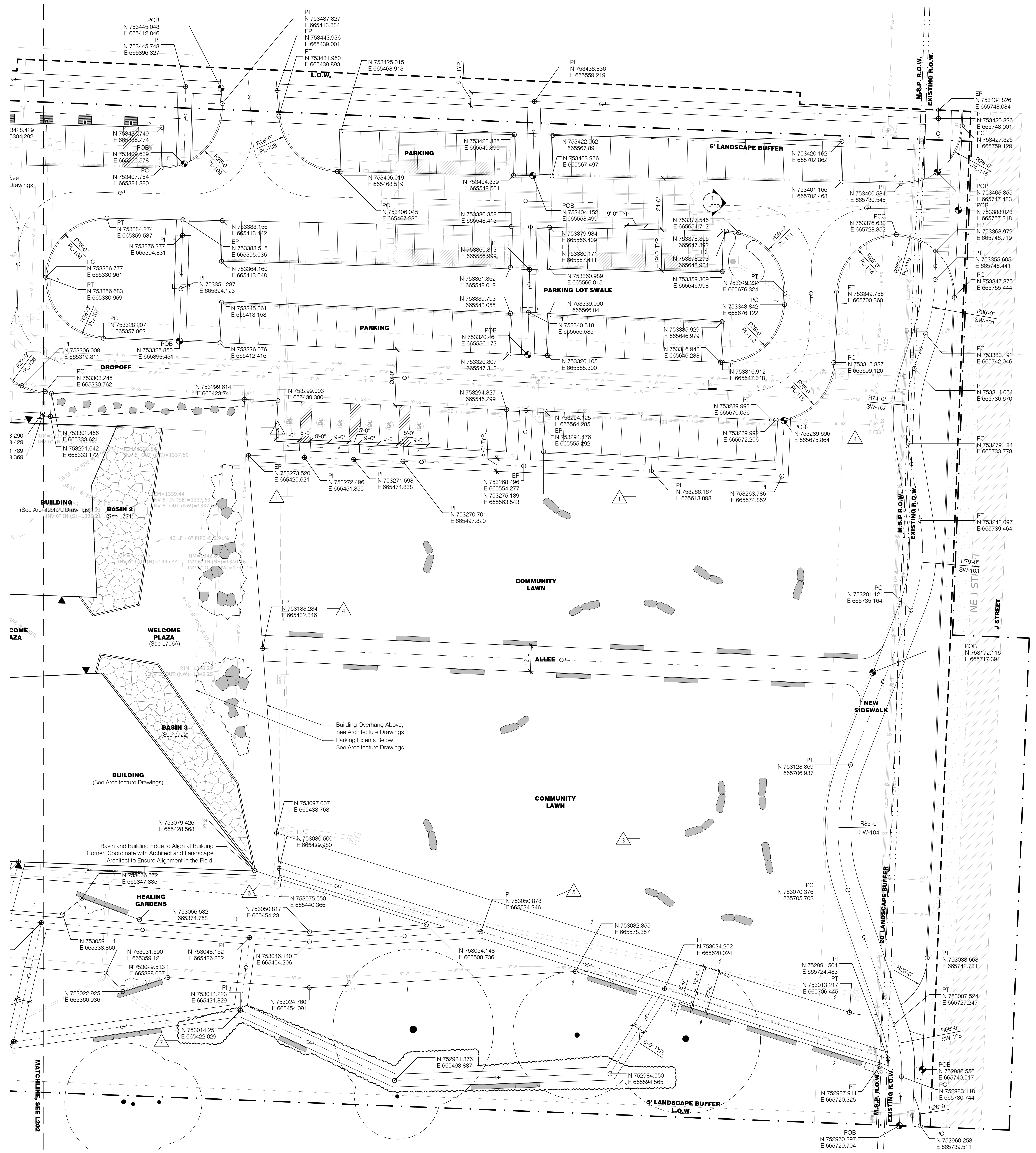

**General Legend**

- Existing Tree to Remain
- Property Line
- Limit of Work
- Point of Beginning
- End Point
- End of Curve
- Point of Intersection
- Point of Curvature
- Point of Compound Curvature
- Point of Reverse Curvature
- Point of Tangency
- Accessible Signage
- Fire Lane Signage
- Coordinate Point
- Align Element
- Set Element Parallel
- Light Poles, See Site Electrical Drawings
- Wall Mounted Lights, See Site Electrical Drawings
- Bollard Lights, See Site Electrical Drawings
- Tree Uplights, See Site Electrical Drawings
- Charging Pedestal, See Site Electrical Drawings
- Wireless Access Pole, See Site Electrical Drawings
- GFCI Receptacle, See Site Electrical Drawings
- Storm Water Catch Basin, See Civil Drawings
- Sanitary Manhole, See Civil Drawings
- Water Utility Access, See Civil Drawings
- Fire Hydrant, See Civil Drawings
- Gas Utility Access, See Civil Drawings
- Pond Overflow Access, See Civil Drawings
- Landscape Area Drain Inlet, See Civil Drawings
- Landscape Underdrain, See Civil Drawings
- Roof Drain, See Architecture Drawings

**Layout Legend**

- Centerline
- Point of Beginning
- End Point
- End of Curve
- Point of Intersection
- Point of Curvature
- Point of Compound Curvature
- Point of Reverse Curvature
- Point of Tangency
- Accessible Signage
- Fire Lane Signage
- Coordinate Point
- Align Element
- Set Element Parallel

**1** Layout - Hardscape - Ground Floor 3  
Scale: 1/16" = 1'-0"

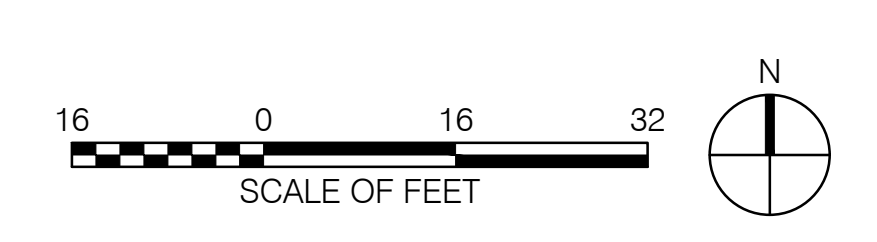



REVISIONS		
NUMBER	DATE	DESCRIPTION
1	03.13.2023	ADD/REMOVE
2	08.08.2023	ADDITIONAL
3	07.02.2024	PROG
4	10.15.2024	AS B2P
5	02.12.2025	PR R14

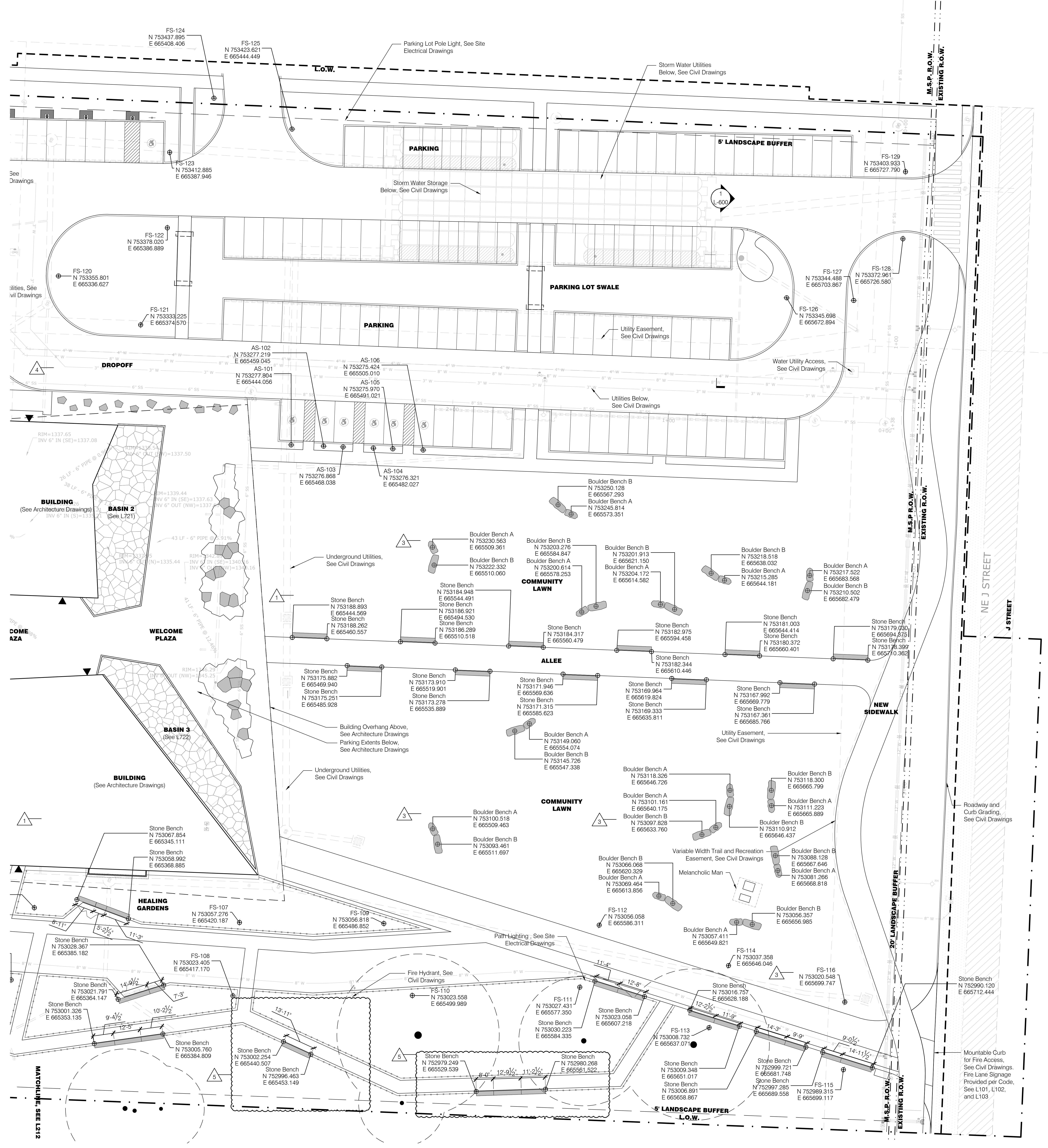

**General Legend**

- Existing Tree to Remain
- Property Line
- Limit of Work
- Right of Way
- Coordinate Point Building Entry
- Light Poles, See Site Electrical Drawings
- Wall Mounted Lights, See Site Electrical Drawings
- Bollard Lights, See Site Electrical Drawings
- Tree Uplights, See Site Electrical Drawings
- Charging Pedestal, See Site Electrical Drawings
- Wireless Access Pole, See Site Electrical Drawings
- GFCI Receptacle, See Site Electrical Drawings
- Storm Water Catch Basin, See Civil Drawings
- Sanitary Manhole, See Civil Drawings
- Water Utility Access, See Civil Drawings
- Fire Hydrant, See Civil Drawings
- Gas Utility Access, See Civil Drawings
- Pond Overflow Access, See Civil Drawings
- Landscape Area Drain Inlet, See Civil Drawings
- Landscape Underdrain, See Civil Drawings
- Roof Drain, See Architecture Drawings

**Layout Legend**

- Centerline
- Point of Beginning
- End Point
- End of Curve
- Point of Intersection
- Point of Curvature
- Point of Compound Curvature
- Point of Reverse Curvature
- Point of Tangency
- Accessible Signage
- Fire Lane Signage
- Coordinate Point
- Align Element
- Set Element Parallel

**Wayfinding Notes**

- All signs and installation bases designed by others.
- Contractor to coordinate and confirm all foundation locations with Signage Contractors shop drawings.
- Contractor is responsible for verifying all dimensions fit with landscape and green roof constraints.
- Sign bases require coordination with paving, landscape, and electrical scopes. Contractor to coordinate base and mounting installation requirements between scopes.
- Coordinate any location discrepancies with Landscape Architect and Wayfinding Designer.
- Field stake all sign locations for review and approval by Landscape Architect and Wayfinding Designer prior to installing all bases.

1 Layout - Furnishings - Ground Floor 3  
Scale: 1/16" = 1'-0"

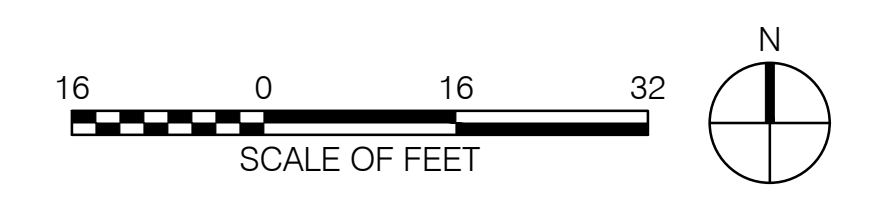

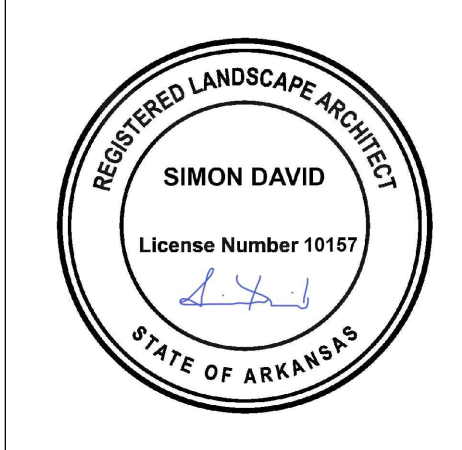

REVISIONS			
NUMBER	DATE	DESCRIPTION	BY
1	03.13.2023	AWSON/AM	
2	06.09.2023	AWSON/AM	
3	08.08.2024	PRICE	
4	02.12.2025	PR 114	

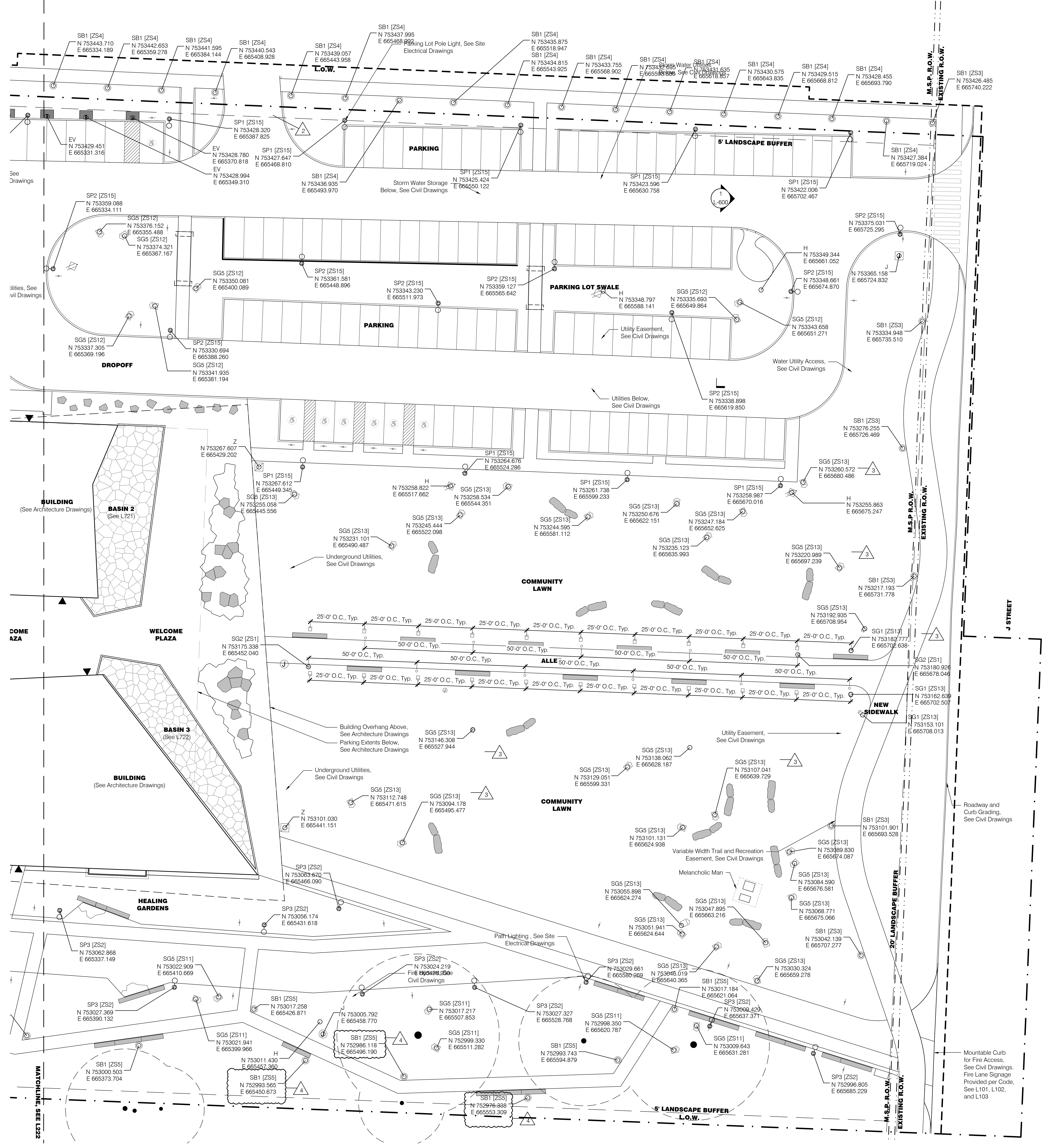

**General Legend**

- Existing Tree to Remain
- Property Line
- Limit of Work
- Right of Way
- Building Entry
- Storm Water Catch Basin, See Civil Drawings
- Sanitary Manhole, See Civil Drawings
- Water Utility Access, See Civil Drawings
- Fire Hydrant, See Civil Drawings
- Gas Utility Access, See Civil Drawings
- Pond Overflow Access, See Civil Drawings
- Landscape Area Drain Inlet, See Civil Drawings
- Trench Drain

**Lighting Layout Legend**

- SP1 - Parking Lot Pole Light, See Site Electrical Drawings
- SP2 - Parking Lot Pole Light, See Site Electrical Drawings
- SP3 - Pedestrian Pole Light, See Site Electrical Drawings
- SB1 - Bollard Light, See Site Electrical Drawings
- SB4 - Bollard Light, See Site Electrical Drawings
- SG1 - In-grade Accent Light, See Site Electrical Drawings
- SG2 - In-grade Pathway Light, See Site Electrical Drawings
- SG3 - In-grade Accent Light, See Site Electrical Drawings
- SG5 - Landscape Accent Light, See Site Electrical Drawings
- Z - Charging Pedestal, See Site Electrical Drawings
- J - Wireless Access Pole, See Site Electrical Drawings
- H - GFCI Receptacle, See Site Electrical Drawings
- SGL1 - In-grade Uplight, GC to Verify and Coordinate with Manufacturers Product Details
- Coordinate Point

1 Layout - Lighting - Ground Floor 3  
Scale: 1/16" = 1'-0"

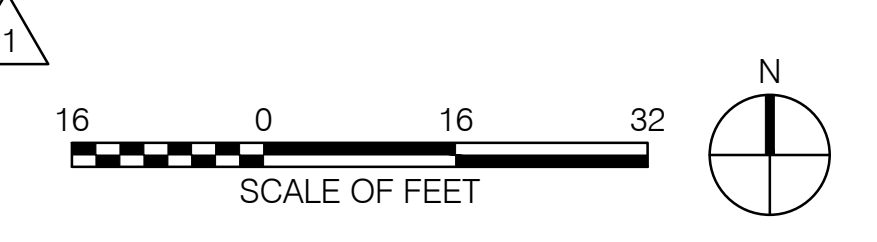





- General Legend**
- Existing Tree to Remain
  - Property Line
  - Limit of Work
  - Right of Way
  - Building Entry
  - Light Poles, See Site Electrical Drawings
  - Wall Mounted Lights, See Site Electrical Drawings
  - Bollard Lights, See Site Electrical Drawings
  - Tree Uplights, See Site Electrical Drawings
  - Charging Pedestal, See Site Electrical Drawings
  - Wireless Access Pole, See Site Electrical Drawings
  - GFCI Receptacle, See Site Electrical Drawings
  - Storm Water Catch Basin, See Civil Drawings
  - Sanitary Manhole, See Civil Drawings
  - Water Utility Access, See Civil Drawings
  - Gas Utility Access, See Civil Drawings
  - Fire Hydrant, See Civil Drawings
  - Pond Overflow Access, See Civil Drawings
  - Landscape Area Drain Inlet, See Civil Drawings
  - Landscape Underdrain, See Civil Drawings
  - Roof Drain, See Architecture Drawings

- Soils Legend**
- 1 L912 Lawn Soil
  - 2 L912 Meadow Soil
  - 3 L912 Tree Soil
  - 4 L912 Structural Soil
  - 5 L912 Emergent Wetland Soil - Perennials
  - 6A L912 Emergent Wetland Soil - Trees
  - 6B L912 Emergent Wetland Soil - Shrubs
  - 7 L912 Submergent Wetland Soil
  - 8 L912 Green Roof Tree Soil
  - 9 L912 Green Roof Shrub & Perennial Soil
  - 12 L912 Meditation Woods Soil

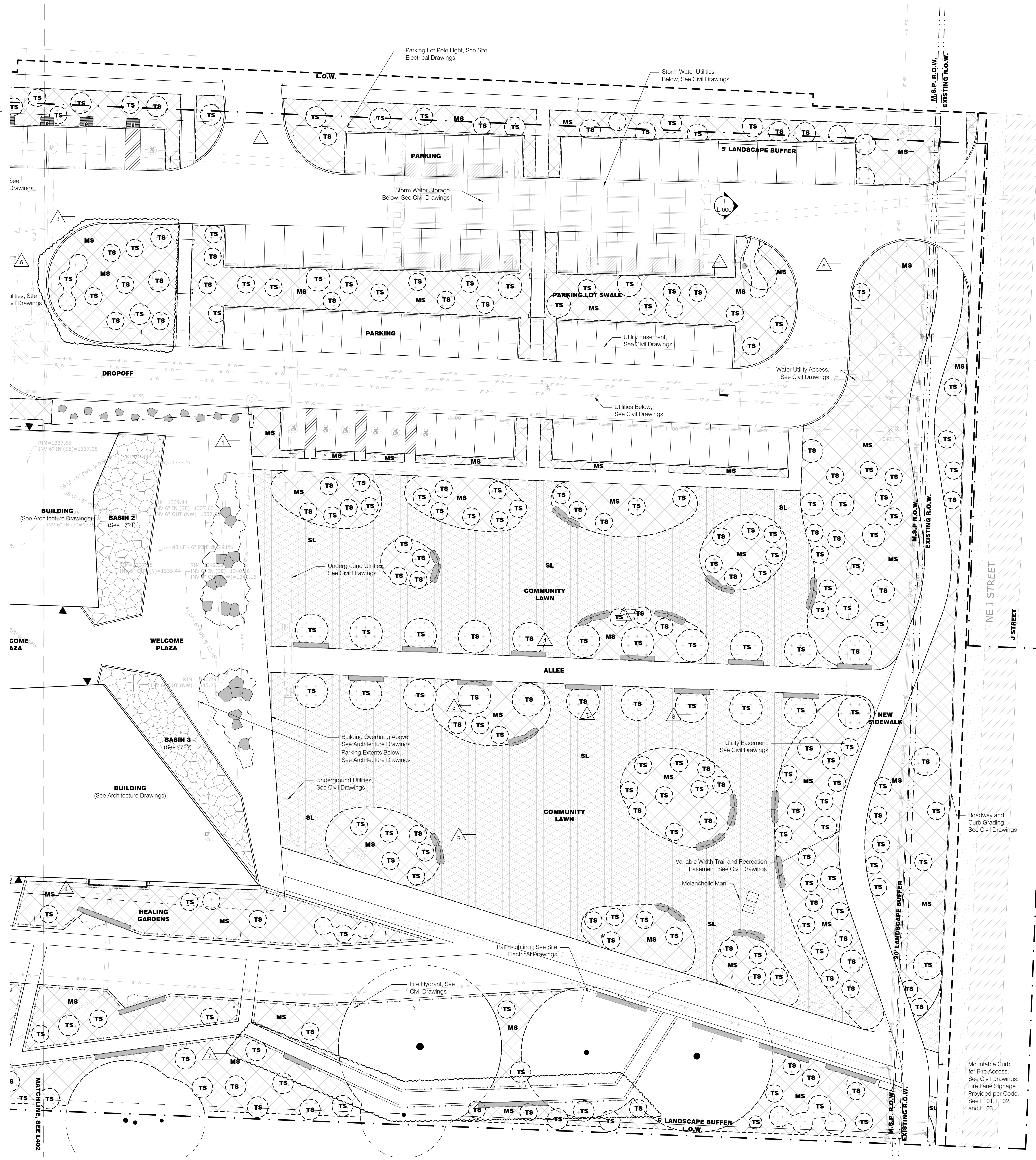

1 Ground Floor Soils Plan 3  
Scale: 1/16" = 1'-0"

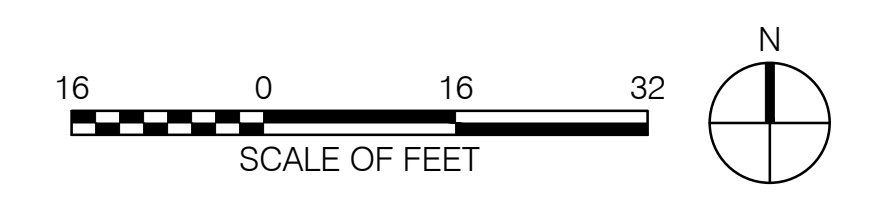

PSW Job Number:  
933A



**AWSOM**  
Bentonville, AR

Issue Date:  
03.13.2023

REVISIONS		
NUMBER	DATE	DESCRIPTION
1	03.13.2023	ADDendum
2	06.19.2023	ADDendum 2
3	06.20.2023	PR 01
4	06.24.2024	PR 02
5	06.25.2024	ADD 01
6	06.26.2024	PR 02
7	10.12.2025	PR 11

Contents:  
Ground Floor Soils  
Plan 3/3

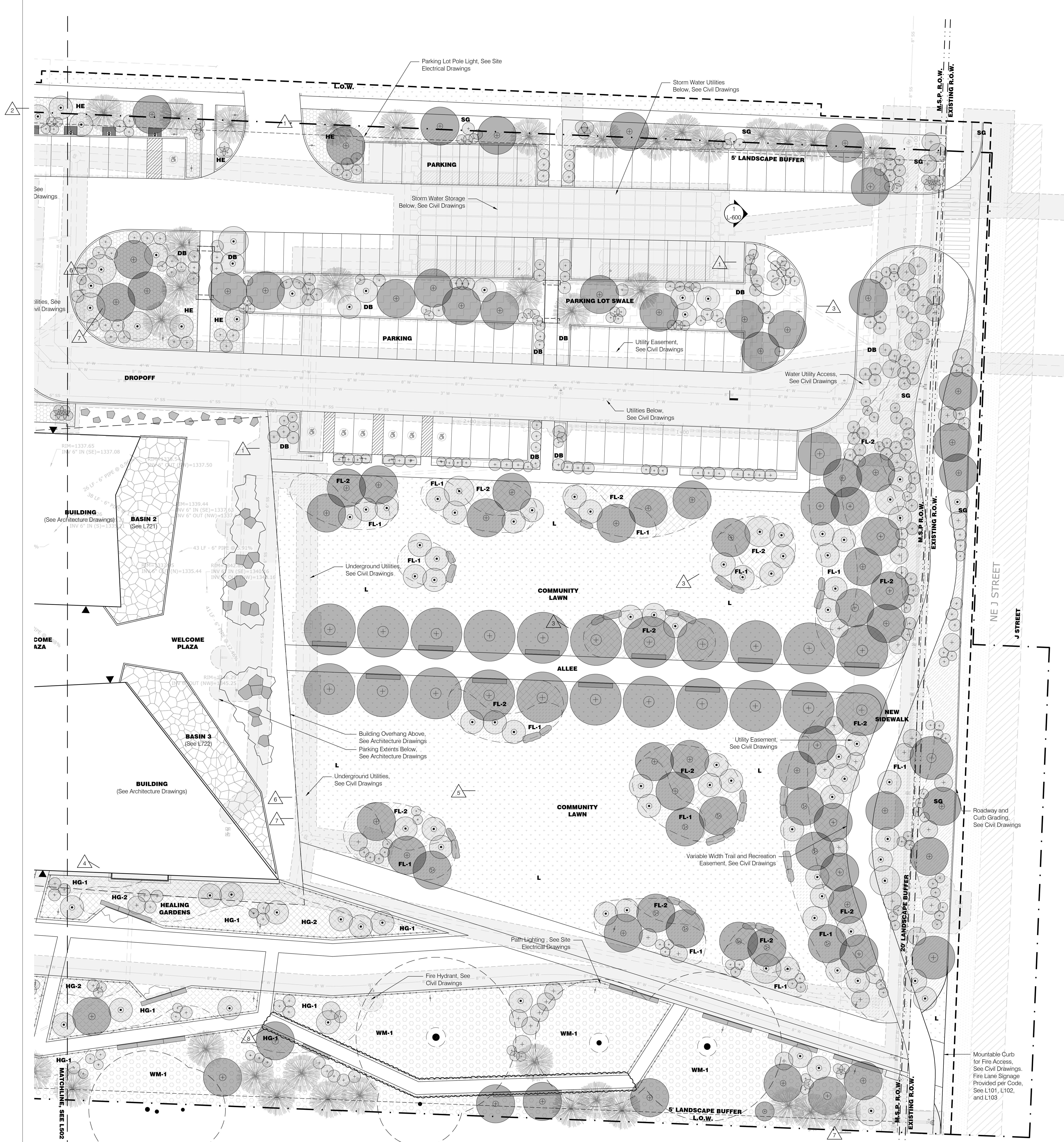

**General Legend**

- Existing Tree to Remain
- Property Line
- Limit of Work
- Right of Way
- Building Entry
- Light Poles, See Site Electrical Drawings
- Wall Mounted Lights, See Site Electrical Drawings
- Bollard Lights, See Site Electrical Drawings
- Tree Uplights, See Site Electrical Drawings
- Charging Pedestal, See Site Electrical Drawings
- Wireless Access Pole, See Site Electrical Drawings
- GFCI Receptacle, See Site Electrical Drawings
- Storm Water Catch Basin, See Civil Drawings
- Sanitary Manhole, See Civil Drawings
- Water Utility Access, See Civil Drawings
- Fire Hydrant, See Civil Drawings
- Gas Utility Access, See Civil Drawings
- Pond Overflow Access, See Civil Drawings
- Landscape Area Drain Inlet, See Civil Drawings
- Landscape Underdrain, See Civil Drawings
- Roof Drain, See Architecture Drawings

**Planting Legend**

- Deciduous Tree - 5" cal.
- Deciduous Tree - 2-4" cal.
- Coniferous Tree - 8-10' ht.
- Fruiting Tree - 6-8' ht.
- Espaliered Fruiting Tree - 6-8' ht.
- Flowering Tree - 3-4" cal. or 8-10' ht.
- Shrub - 7 gal.
- Shrub - 5 gal.
- Shrub - 3 gal.
- Amphitheater Mix
- Detention Basin Mix
- Shortgrass Meadow
- Rooftop Shortgrass Meadow
- Rooftop Gravel Terrace Mix
- Terrace Mix
- Herbaceous Entry Mix
- Emergent Wetland Mix
- Submergent Wetland Mix
- FL-1 Flowering Lawn Island Mix - Sun
- FL-2 Flowering Lawn Island Mix - Shade
- HG-1 Healing Garden Mix - Tall
- HG-2 Healing Garden Mix - Short
- WM-1 Woodland Mix - Matrix Infill & Seed
- WM-2 Woodland Mix - Fern & Sedge Glade
- WM-3 Woodland Sedge Clearing Mix
- OM Orchard Mix
- L Lawn (Sod)

**Planting Notes**

- See L500 for planting notes.

1 Ground Floor Planting Plan 3  
Scale: 1/16" = 1'-0"

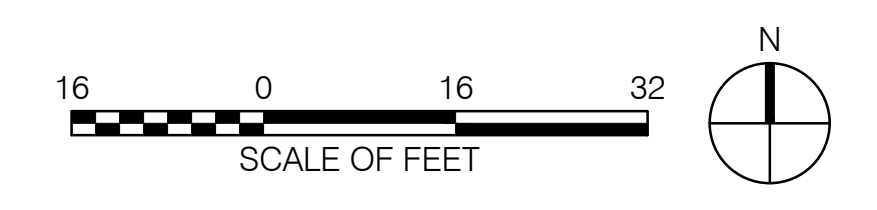

PSW Job Number:  
933A

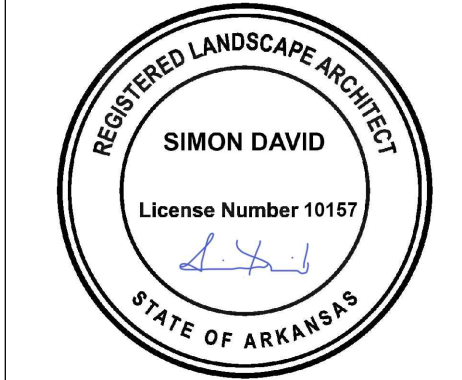

**AWSOM**  
Bentonville, AR

Issue Date:  
03.13.2023

REVISIONS		
NUMBER	DATE	DESCRIPTION
1	03.13.2023	ADDITIONAL
2	06.09.2023	ADDITIONAL
3	06.04.2024	PR 059
4	06.04.2024	PR 059
5	06.20.2024	ADD 018
6	07.24.2024	PR 069
7	08.09.2024	PR 072
8	07.20.2024	PR 114

Contents:  
Ground Floor  
Planting Plan 3/3

THIS PAGE IS BEST VIEWED IN COLOR  
**L503**  
BENTONVILLE PROJECT NUMBER LSD22-0068