



AIA[®] Document G709[™] – 2018

Proposal Request

PROJECT: *(name and address)*
AWSOM
Bentonville, Arkansas

CONTRACT INFORMATION:
Contract For: General Construction
Date: 11.29.2021

Architect's Project Number: 993A
Proposal Request Number: 097
Proposal Request Date: 11.15.2024

OWNER: *(name and address)*
AWSOM Lands, LLC
PO Box 2030
Bentonville, AR 72712

ARCHITECT: *(name and address)*
Polk Stanley Wilcox
509 W. Spring St., Ste 150
Fayetteville, AR 72701

CONTRACTOR: *(name and address)*
Crossland Construction Company
1800 S. 52nd Street, Suite 410
Rogers, AR 72758

The Owner requests an itemized proposal for changes to the Contract Sum and Contract Time for proposed modifications to the Contract Documents described herein. The Contractor shall submit this proposal within five (5) days or notify the Architect in writing of the anticipated date of submission.

(Insert a detailed description of the proposed modifications to the Contract Documents and, if applicable, attach or reference specific exhibits.)

Refer to the attached Proposal Request 097 Narrative listing revised drawings with brief description of changes.

THIS IS NOT A CHANGE ORDER, A CONSTRUCTION CHANGE DIRECTIVE, OR A DIRECTION TO PROCEED WITH THE WORK DESCRIBED IN THE PROPOSED MODIFICATIONS.

REQUESTED BY THE ARCHITECT:

Mark Herrmann, AIA

PRINTED NAME AND TITLE

PROPOSAL REQUEST 097

BBH RFIs

ISSUED: November 15, 2024

PROJECT: AWSOM
BENTONVILLE, AR

FROM ARCHITECT: POLK STANLEY WILCOX ARCHITECTS
801 SOUTH SPRING ST.
LITTLE ROCK AR 72201

TO CONTRACTOR: CROSSLAND CONSTRUCTION COMPANY, INC

PROPOSAL REQUEST 97 BRIEF

Revised drawings in PR 097 update mechanical drawings in response to RFIs 503, 505, 509, 510, 514, and 519.

REVISED DRAWING SHEETS

1) MECHANICAL

- a) Refer to Revised Sheet **M201B**, Detail 1, with original issue date 02.24.2023 and revised date 11.15.2024.
 - Revise BBH 12, 60, and 61 design in response to RFI 509.
- b) Refer to Revised Sheet **M203A**, Detail 1, with original issue date 02.24.2023 and revised date 11.15.2024.
 - Revise baseboard heater design for units 76-120 to remove blankoff units. Various units were either removed from the design or resized and made active to address RFI 505.
 - Revise baseboard heater 76 size in response to RFI 519.
 - Revise BBH sizes for 108-120 in response to RFI 514.
 - Remove piping associated with BBH 153 and 155 in response to RFI 510.
- c) Refer to Revised Sheet **M204A**, Detail 1, with original issue date 02.24.2023 and revised date 11.15.2024.
 - Revise baseboard heater design for units 121-144, 148-155 to remove blankoff units. Various units were either removed from the design or resized and made active to address RFI 505.
 - Remove BBH 153 and 155 in response to RFI 510.
- d) Refer to Revised Sheet **M603**, BASEBOARD HEATER SCHEDULE, with original issue date 02.24.2023 and revised date 11.15.2024.
 - Revise BBH 11 in response to RFI 509.
 - Add BBH 12A and 12B in response to RFI 509.
 - Revise BBH 24 in response to RFI 503.
 - Revise BBH 60-61 in response to RFI 509.
 - Revise BBH 76-90 in response to RFI 505. Several BBH were removed in response to RFI 505 including BBH 87, BBH 89, and BBH 91.
 - Revise BBH 93-152 in response to RFI 505. Several BBH were removed in response to RFI 505 including BBH 107, BBH 116, BBH 139, BBH 141, BBH 145, and BBH 150.
 - Remove BBH 153 and 155 in response to RFI 510.

End of PR 097

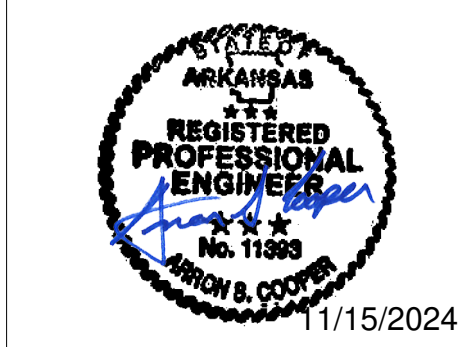

REVISIONS		
NUMBER	DATE	DESCRIPTION
1	03.10.23	ADDENDUM 1
2	06.09.23	ADDENDUM 2
3	11.15.24	REVISED

- MECHANICAL PLAN NOTES:**
- M22 MOUNT BOTTOM OF FAN COIL UNIT 9 FT AFF.
 - M31 PIPING DOWN IN WALL TO BASEBOARD HEATER.
 - M32 ROUTE PIPE MAIN BELOW BEAM
 - M76 ROUTE PIPING DOWN TO LEVEL BELOW. REFER TO LEVEL 0 PIPING PLANS FOR CONTINUATION.
 - M80 ROUTE PIPING DOWN THROUGH FLOOR. REFER TO M200A FOR PIPING CONTINUATION.
 - M100 INCLUDE SOHO TRENCH HEATER HUB AND CONTROL PANEL. LOCATE CONTROLLER IN TRENCH HOUSING TRENCH HEATERS. PROVIDES POWER TO 3 UNITS.
 - M109 ALL BASEBOARD HEATERS SHALL BE CONTINUOUS IF SERVED BY SAME PIPING. NO EXPOSED PIPING ALLOWED BETWEEN BASEBOARD HEATERS. PROVIDE BLANK BBH SECTION, IF REQUIRED (TYPICAL).
 - M113 PROVIDE CONTINUOUS TRENCH AS SHOWN.
 - M114 EXTEND PIPING THROUGH BBH-60 AND BBH-61. CV=0.46
- MECHANICAL GENERAL NOTE:**
ALL BASEBOARD HEATERS SHALL BE CONTINUOUS IF SERVED BY SAME PIPING. NO EXPOSED PIPING ALLOWED BETWEEN BASEBOARD HEATERS. PROVIDE BLANK BBH SECTION, IF REQUIRED (TYPICAL).



① PIPING - LEVEL 1 PLAN - AREA B
1/8" = 1'-0"

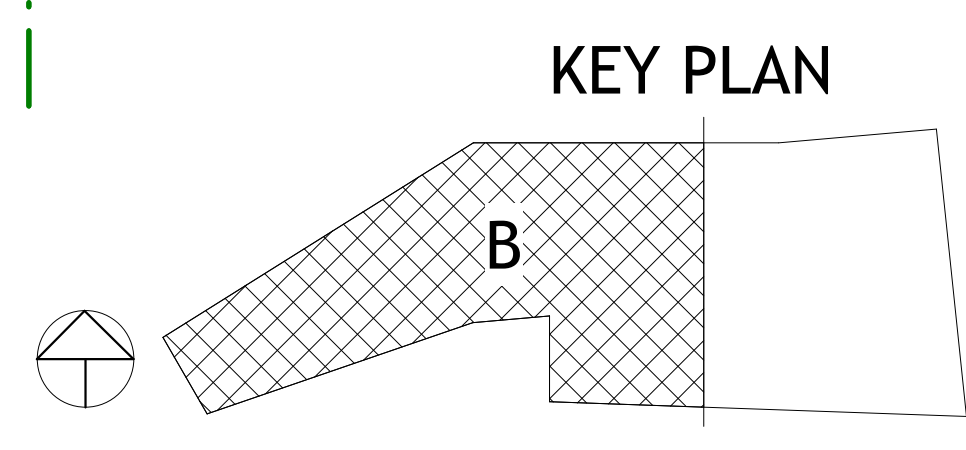

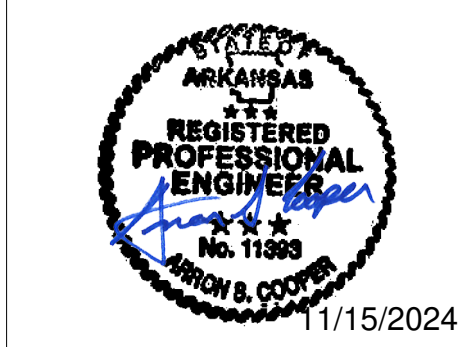

REVISIONS		
NUMBER	DATE	DESCRIPTION
1	03.19.23	ADDENDUM 1
2	06.29.23	ADDENDUM 2
3	08.24.24	REV 004
4	08.24.24	REV 014
5	11.15.24	REV 007

- MECHANICAL PLAN NOTES:**
- M17 REFER TO M202A FOR PIPING FROM BELOW TO HYDRONIC BASEBOARD HEATER.
 - M22 MOUNT BOTTOM OF FAN COIL UNIT 8 FT AFF.
 - M28 AREA OPEN TO FLOOR ABOVE. DO NOT ROUTE HVAC PIPING, DUCTWORK, OR ANY ACCESSORIES INCLUDING CONTROL WIRING ACROSS AREA.
 - M29 PIPING UP TO FLOOR ABOVE TO BASEBOARD HEATERS.
 - M109 ALL BASEBOARD HEATERS SHALL BE CONTINUOUS IF SERVED BY SAME PIPING. NO EXPOSED PIPING ALLOWED BETWEEN BASEBOARD HEATERS. PROVIDE BLANK BBH SECTION, IF REQUIRED (TYPICAL).
 - M133 EXTEND PIPING THROUGH BBH-52, BBH-53, BBH-54, AND BBH-55. CV#0.46.
 - M134 EXTEND PIPING THROUGH BBH-72, BBH-73, AND BBH-74. CV#0.93.
 - M135 EXTEND PIPING THROUGH BBH-68, BBH-69, BBH-70, BBH-71, AND BBH-72. CV#1.20.
 - M136 EXTEND PIPING THROUGH BBH-65, BBH-66, AND BBH-67. CV#0.76.

- MECHANICAL PLAN NOTES:**
- M137 EXTEND PIPING THROUGH BBH-110, BBH-118, BBH-119, BBH-120. CV#1.15.
 - M138 EXTEND PIPING THROUGH BBH-110, BBH-111, BBH-112, BBH-113, BBH-114, BBH-115. CV#1.33.
 - M139 EXTEND PIPING THROUGH BBH-108, AND BBH-109. CV#0.44.
 - M140 EXTEND PIPING THROUGH BBH-81, BBH-82, BBH-83, BBH-84, BBH-85, AND BBH-86. CV#1.33.
 - M141 EXTEND PIPING THROUGH BBH-77, BBH-78, BBH-79, AND BBH-80. CV#0.89.
 - M144 EXTEND PIPING THROUGH BBH-93, BBH-94, BBH-95, BBH-96, BBH-97, BBH-98, AND BBH-99. CV#1.55.
 - M145 EXTEND PIPING THROUGH BBH-100, BBH-101, BBH-102, BBH-103, BBH-104, BBH-105, AND BBH-106. CV#1.55.
 - M146 ROUTE 4" CHS, 4" CHS, 3" HWS, AND 3" HWS UP TO LEVEL 4. REFER TO M204A FOR CONTINUATION.

MECHANICAL GENERAL NOTE:
ALL BASEBOARD HEATERS SHALL BE CONTINUOUS IF SERVED BY SAME PIPING. NO EXPOSED PIPING ALLOWED BETWEEN BASEBOARD HEATERS. PROVIDE BLANK BBH SECTION, IF REQUIRED (TYPICAL).



1 PIPING - LEVEL 3 PLAN - AREA A
1/8" = 1'-0"

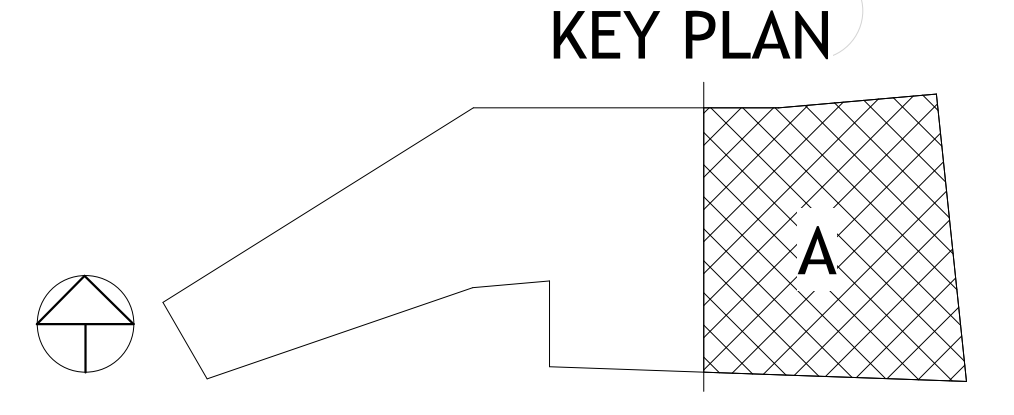

PSW Job Number:
993A
Henderson Job Number:
2150002607

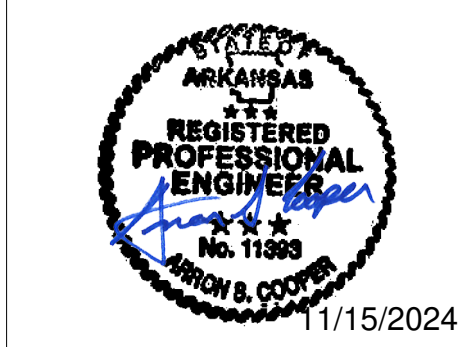

AWSOM
Bentonville, AR

Issue Date:
02.24.2023

REVISIONS		
NUMBER	DATE	DESCRIPTION
1	03/15/23	ADDENDUM 1
2	06/29/23	ADDENDUM 2
3	04/24/24	PRE-04
4	06/20/24	PRE-04
5	08/23/24	PRE-04
6	10/31/24	PRE-04
7	11/15/24	PRE-07

Contents:
PIPING - LEVEL 4 PLAN - AREA A

THIS PAGE IS BEST VIEWED IN COLOR
M204A

MECHANICAL PLAN NOTES:

- M16 REFER TO M203A FOR PIPING FROM BELOW TO HYDRONIC BASEBOARD HEATER.
- M21 AREA OPEN TO FLOOR BELOW. DO NOT ROUTE HVAC PIPING, DUCTWORK, OR ANY ACCESSORIES INCLUDING CONTROL WIRING ACROSS AREA.
- M22 MOUNT BOTTOM OF FAN COIL UNIT 9 FT AFF.
- M23 MOUNT BOTTOM OF UNIT HEATER 10 FT AFF.
- M26 CHILLED WATER BYPASS VALVE. POWER DIRECTLY TO CHILLER CONTROL PANEL. REFER TO CONTROLS FOR FURTHER INFORMATION.
- M27 HEATING WATER BYPASS VALVE. REFER TO BOILER CONTROLS FOR FURTHER INFORMATION.

MECHANICAL PLAN NOTES:

- M109 ALL BASEBOARD HEATERS SHALL BE CONTINUOUS IF SERVED BY SAME PIPING. NO EXPOSED PIPING ALLOWED BETWEEN BASEBOARD HEATERS. PROVIDE BLANK BBH SECTION, IF REQUIRED (TYPICAL).
- M146 EXTEND PIPING THROUGH BBH-161, BBH-160, AND BBH-159.
- M147 EXTEND PIPING THROUGH BBH-158, BBH-157, AND BBH-156.
- M148 EXTEND PIPING THROUGH BBH-148, BBH-146, AND BBH-150. CV=0.23
- M150 EXTEND PIPING THROUGH BBH-142, BBH-143, BBH-144. CV=0.67
- M151 EXTEND PIPING THROUGH BBH-136, BBH-137, BBH-138, BBH-140. CV=1.06.
- M152 EXTEND PIPING THROUGH BBH-121 AND BBH-122. CV=0.46
- M153 EXTEND PIPING THROUGH BBH-125, BBH-126, BBH-127, BBH-128, BBH-129, AND BBH-130. CV=1.64.

MECHANICAL PLAN NOTES:

- M154 EXTEND PIPING THROUGH BBH-131, BBH-132, BBH-133, AND BBH-134. CV=1.06.
- M155 EXTEND PIPING THROUGH BBH-151, BBH-152, BBH-154, AND BBH-154. CV=0.53.
- M210 EXTEND PIPING THRU BBH-146 AND BBH-147. CV=0.44

MECHANICAL GENERAL NOTE:
ALL BASEBOARD HEATERS SHALL BE CONTINUOUS IF SERVED BY SAME PIPING. NO EXPOSED PIPING ALLOWED BETWEEN BASEBOARD HEATERS. PROVIDE BLANK BBH SECTION, IF REQUIRED (TYPICAL).



1 PIPING - LEVEL 4 PLAN - AREA A
1/8" = 1'-0"

KEY PLAN

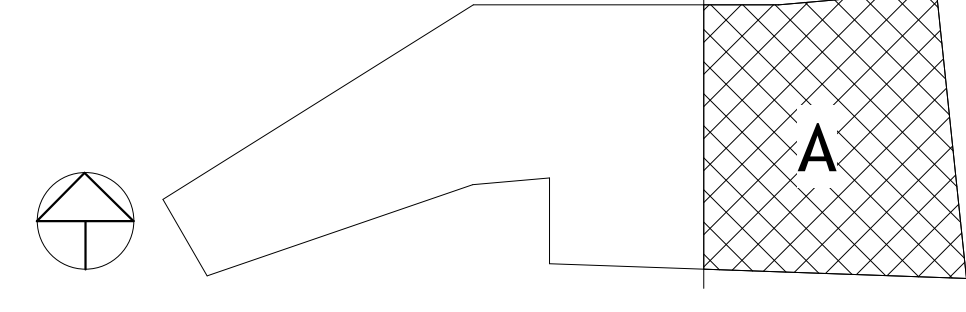

VARIABLE FREQUENCY DRIVES (VFD'S)

Table with columns: MARK, SERVING EQUIPMENT, NUMBER OF MOTORS, HP OF EACH MOTOR ON THE DRIVE, MANUFACTURER, VOLT/PHASE, ENCLOSURE, MOUNTING LOCATION, NOTES. Lists VFD 1 through VFD 29.

MODEL NUMBERS SHALL NOT BE CONSIDERED COMPLETE AND MATERIAL SHALL NOT BE ORDERED BY MANUFACTURER AND MODEL NUMBERS ONLY. REVIEW THE COMPLETE DESCRIPTION, NOTES AND SPECIFICATIONS TO DETERMINE THE EXACT MATERIAL AND ACCESSORIES TO BE ORDERED. THE MANUFACTURERS LISTED ARE THE BASIS FOR THE DESIGN.

GENERAL NOTES APPLICABLE TO ALL ITEMS. 1. DRIVE AMPS SHALL BE RATED PER NATIONAL ELECTRICAL CODE TABLE 430.250

SCHEDULE NOTES:

- A. SWITCHING OPEN PROVIDE 'EARLY BREAK' AUXILIARY CONTACTS IN MOTOR DISCONNECT THAT DEACTIVATES THE VFD WHEN MOTOR DISCONNECT. B. PROVIDE OUTPUT REACTOR. C. PROVIDE BACNET MSTP INTEGRATION CARD. D. INTERLOCK WITH SMOKE DETECTOR OR FREEZE/STAT TO SHUT DOWN FAN ON ALARM. E. PROVIDE SURGE SUPPRESSION ON THE INPUT OF THE DRIVE. F. PROVIDE ANTI-SINGLE PHASING PROTECTION. G. EQUIPMENT SIZED FOR 100°F AMBIENT TEMPERATURE. H. PROVIDE WITH LOCKABLE COVER.

FREE AREA SCHEDULE

Table with columns: MARK, SERVICE, CFM, MIN FREE AREA (SF), FPM, MAX APP (IN W.C.), NOTES. Lists LVR 1 through LVR 9.

MODEL NUMBERS SHALL NOT BE CONSIDERED COMPLETE AND MATERIAL SHALL NOT BE ORDERED BY MANUFACTURER AND MODEL NUMBERS ONLY. REVIEW THE COMPLETE DESCRIPTION, NOTES AND SPECIFICATIONS TO DETERMINE THE EXACT MATERIAL AND ACCESSORIES TO BE ORDERED. THE MANUFACTURERS LISTED ARE THE BASIS FOR THE DESIGN.

NOTES:

- A. LOUVER MARK CORRESPONDS WITH ARCHITECTURAL PLAN TAG. IF MULTIPLE PLENUMS ARE CONNECTED TO SAME LOUVER, THEY ARE DENOTED BY A LETTER AFTER THE NUMBER. B. REFERS TO ARCHITECTURAL PLANS AND SPECIFICATIONS FOR LOUVER SIZE, FINISH AND MANUFACTURER. C. SCHEDULED FREE AREA REPRESENTS REQUIRED ACTIVE SECTION OF LOUVER FOR CONNECTION TO BY MECHANICAL CONTRACTOR. MECHANICAL CONTRACTOR SHALL CONNECT PLENUM SHOWN ON DRAWINGS TO LOUVER ASSEMBLY.

DUCT SILENCER SCHEDULE

Table with columns: MARK, SERVICE, MANUFACTURER, MODEL, LENGTH (IN), CFM, MAX APP (IN), DYNAMIC INSERTION LOSS, NOTES. Lists DS 1 through DS 181.

MODEL NUMBERS SHALL NOT BE CONSIDERED COMPLETE AND MATERIAL SHALL NOT BE ORDERED BY MANUFACTURER AND MODEL NUMBERS ONLY. REVIEW THE COMPLETE DESCRIPTION, NOTES AND SPECIFICATIONS TO DETERMINE THE EXACT MATERIAL AND ACCESSORIES TO BE ORDERED. THE MANUFACTURERS LISTED ARE THE BASIS FOR THE DESIGN.

NOTES:

- A. STATIC PRESSURE DROP SHALL NOT EXCEED SCHEDULED AMOUNT AT SPECIFIED AIRFLOW.

BASEBOARD HEATER SCHEDULE (HOT WATER)

Large table with columns: MARK, MANUFACTURER, MODEL, LENGTH (IN), MIN OUTPUT (MBH), EWT (°F), LWT (°F), GPM, CV, EAT (°F), MOUNTING TYPE, NOTES. Lists BBH 1 through BBH 161.

MODEL NUMBERS SHALL NOT BE CONSIDERED COMPLETE AND MATERIAL SHALL NOT BE ORDERED BY MANUFACTURER AND MODEL NUMBERS ONLY. REVIEW THE COMPLETE DESCRIPTION, NOTES AND SPECIFICATIONS TO DETERMINE THE EXACT MATERIAL AND ACCESSORIES TO BE ORDERED. THE MANUFACTURERS LISTED ARE THE BASIS FOR THE DESIGN.

NOTES:

- A. PROVIDE NECESSARY MOUNTING BRACKETS AND ACCESSORIES (UNIT SHALL BE APPROVED FOR ZERO CLEARANCE). B. TYPICAL CONTROL BY VAV THERMOSTAT. REFER TO DRAWINGS FOR UNIT WITH INDEPENDENT THERMOSTAT. CONTROLS CONTRACTOR SHALL PROVIDE INDEPENDENT THERMOSTAT. C. ENCLOSURE SHALL BE STEEL WITH SATIN NICKEL BOND FINISH. AIR GRILLES SHALL BE EXTRUDED ALUMINUM WITH CLEAR ANODIZED ALUMINUM FINISH. D. PROVIDE 4" HIGH SUPPORT LEGS FOR FLOOR-MOUNTED UNITS. E. BLANK-OFF SECTION. F. REFER TO PIPING DRAWINGS FOR CV VALUES IN SITUATIONS WHERE PIPING IS EXTENDED THROUGH MORE THAN ONE BASEBOARD HEATER.

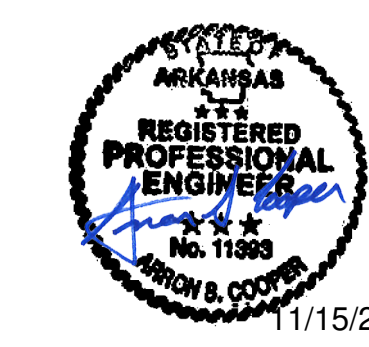

Table with columns: NUMBER, DATE, DESCRIPTION. Lists revision history from 1 to 8.