



AIA[®] Document G709[™] – 2018

Proposal Request

PROJECT: *(name and address)*
AWSOM
Bentonville, Arkansas

CONTRACT INFORMATION:
Contract For: General Construction
Date: 11.29.2021

Architect's Project Number: 993A
Proposal Request Number: 090
Proposal Request Date: 10.07.2024

OWNER: *(name and address)*
AWSOM Lands, LLC
PO Box 2030
Bentonville, AR 72712

ARCHITECT: *(name and address)*
Polk Stanley Wilcox
509 W. Spring St., Ste 150
Fayetteville, AR 72701

CONTRACTOR: *(name and address)*
Crossland Construction Company
1800 S. 52nd Street, Suite 410
Rogers, AR 72758

The Owner requests an itemized proposal for changes to the Contract Sum and Contract Time for proposed modifications to the Contract Documents described herein. The Contractor shall submit this proposal within five (5) days or notify the Architect in writing of the anticipated date of submission.

(Insert a detailed description of the proposed modifications to the Contract Documents and, if applicable, attach or reference specific exhibits.)

Refer to the attached Proposal Request 090 Narrative listing revised drawings with brief description of changes.

THIS IS NOT A CHANGE ORDER, A CONSTRUCTION CHANGE DIRECTIVE, OR A DIRECTION TO PROCEED WITH THE WORK DESCRIBED IN THE PROPOSED MODIFICATIONS.

REQUESTED BY THE ARCHITECT:

Mark Herrmann, AIA

PRINTED NAME AND TITLE

PROPOSAL REQUEST 090

Owner Requested Planting Schedule Revisions

ISSUED: 10.07.2024

PROJECT: AWSOM
BENTONVILLE, AR

FROM ARCHITECT: POLK STANLEY WILCOX ARCHITECTS
801 SOUTH SPRING ST.
LITTLE ROCK AR 72201

TO CONTRACTOR: CROSSLAND CONSTRUCTION COMPANY, INC

PROPOSAL REQUEST 090 BRIEF

This PR updates planting schedules in response to the owner's request.

REVISED DRAWING SHEETS

A. Landscape Architecture

1. Refer to Revised Sheet **L000A**, with original issue date 03.13.2023 and revised date 10.04.2024.
 - Updated sheet issuance for PR 090
2. Refer to Revised Sheet **L500B**, with original issue date 03.13.2023 and revised date 10.04.2024.
 - Updated Shrubs Schedule
 - (1) SAC - Increased qty of *Amorpha canescens*.
 - (2) SCY - Replaced *Ceanothus americanus* with *Clethra alnifolia*.
 - (3) SIC - Replaced *Ilex crenata* with *Buxus sempervirens* 'Fastigiata.'
 - (4) SPM - Replaced *Pinus mugo* 'Dwarf' for *Pinus mugo* 'Slowmound.'
 - (5) SRX - Replaced *Rosa arkansana* with *Rosa Carolina*.
 - (6) SYA - Replaced *Yucca arkansana* with *Yucca glauca*.
 - (7) Added SHP - *Hesperaloe parviflora*.
3. Refer to Revised Sheet **L500C**, with original issue date 03.13.2023 and revised date 10.04.2024.
 - Updated Amphitheater Mix (AM) schedule species, percentages, and quantities.
 - (1) Removed
 - (a) *Adiantum capillus-veneris*.
 - (b) *Adiantum capillus-veneris*.
 - (c) *Aquilegia canadensis*.
 - (d) *Astrantia major* 'White Giant'.
 - (e) *Dechampsia caespitosa*.
 - (f) *Echinacea pallida*.
 - (g) *Mazus reptans*.
 - (2) Added
 - (a) *Carex amphibola*.

- (b) *Epimedium grandiflorum* 'Lilafee'.
 - (c) *Polemonium reptans*.
 - (d) *Geranium macrorrhizum* 'Bevan's Variety'.
 - (e) *Carex appalachia*.
 - (f) *Diarrhena obovata*.
 - (g) *Sedum ternatum*.
- Updated Detention Basin Mix (DB) schedule species, percentages, and quantities
 - (1) Removed
 - (a) *Echinacea pallida*.
 - (b) *Symphyotrichum oolentangiense*.
 - (c) *Zizia aurea*.
 - (2) Added
 - (a) *Monarda fistulosa*.
 - (b) *Eutrochium dubium* 'Little Joe'.
 - (c) *Baptisia sphaerocarpa*.
- Updated Healing Garden Mix - Tall (HG-1) schedule species, percentages, and quantities
 - (1) Removed
 - (a) *Rosmarinus officinalis*.
 - (b) *Bouteloua curtipendula*.
 - (c) *Echinacea pallida*.
 - (d) *Symphorotrichum oblongifolium*.
 - (2) Added
 - (a) *Agastache* 'Blue Fortune'.
 - (b) *Bouteloua gracilis* 'Blond Ambition'.
 - (c) *Monarda fistulosa*.
 - (d) *Eutrochium dubium* 'Little Joe'.
 - (e) *Solidago petiolaris*.
- Updated Healing Garden Mix - Short (HG-2) schedule species, percentages, and quantities
 - (1) Removed
 - (a) *Rosmarinus officinalis*.
 - (b) *Bouteloua curtipendula*.
 - (c) *Echinacea pallida*.
 - (d) *Geum triflorum*.
 - (e) *Symphorotrichum oblongifolium*.
 - (2) Added
 - (a) *Agastache foeniculum*.
 - (b) *Bouteloua gracilis* 'Blond Ambition'.
 - (c) *Monarda fistulosa*.
 - (d) *Achillea millefolium* 'Peachy Seduction'.
 - (e) *Eutrochium dubium* 'Little Joe'.
 - (f) *Solidago petiolaris*.
- Updated Herbaceous Entry Mix (HE) schedule species, percentages, and quantities.
 - (1) Removed
 - (a) *Carex perdentata*.
 - (b) *Echinacea pallida*.
 - (c) *Geranium maculatum*.
 - (d) *Geum triflorum*.
 - (2) Added
 - (a) *Carex Appalachia*.
 - (b) *Monarda fistulosa*.
 - (c) *Geranium macrorrhizum* 'Bevan's Variety'.
 - (d) *Achillea millefolium* 'Peachy Seduction'.
- Updated Terrace Mix (TM) schedule species, percentages, and quantities

- (1) Removed
 - (a) *Echinacea pallida*.
 - (b) *Geranium maculatum*.
 - (c) *Schizachyrium scoparium*.
- (2) Added
 - (a) *Monarda fistulosa*.
 - (b) *Geranium macrorrhizum* 'Bevan's Variety'.
 - (c) *Achillea millefolium* 'Peachy Seduction'.
 - (d) *Schizachyrium scoparium* 'Carousel'.
 - (e) *Schizachyrium scoparium* 'Standing Ovation'.
- Updated Rooftop Gravel Terrace Mix (GT) schedule species, percentages, and quantities
 - (1) Added
 - (a) *Allium sphaerocephalon*.
 - (b) *Allium cernuum*.
 - (c) *Antennaria plantaginifolia*.
 - (2) Added
 - (a) *Carex appalachia*.
- 4. Refer to Revised Sheet **L500D**, with original issue date 03.13.2023 and revised date 10.04.2024.
 - Updated Shortgrass Meadow Mix (SG-1) schedule species, percentages, and quantities
 - (1) Removed
 - (a) *Symphotrichum oolentangiense*.
 - (b) *Echinacea pallida*.
 - (c) *Schizachyrium scoparium*.
 - (d) *Bouteloua curtipendula*.
 - (e) *Carex perdentata*.
 - (2) Added
 - (a) *Eutrochium dubium* 'Little Joe'.
 - (b) *Solidago petiolaris*.
 - (c) *Monarda fistulosa*.
 - (d) *Schizachyrium scoparium* 'Carousel'.
 - (e) *Schizachyrium scoparium* 'Standing Ovation'.
 - (f) *Bouteloua gracilis* 'Blond Ambition'.
 - (g) *Carex bicknellii*.
 - Updated Roof Top Shortgrass Meadow Mix (SG-2) schedule species, percentages, and quantities
 - (1) Removed
 - (a) *Bouteloua curtipendula*.
 - (b) *Schizachyrium scoparium*.
 - (2) Added
 - (a) *Bouteloua gracilis* 'Blond Ambition'.
 - (b) *Schizachyrium scoparium* 'Carousel'.
 - (c) *Schizachyrium scoparium* 'Standing Ovation'.
 - Updated Woodland Mix - Matrix Infill (WM-1) schedule species, percentages, and quantities
 - (1) Removed
 - (a) *Dechampsia caespitosa*.
 - (b) *Echinacea pallida*.
 - (c) *Geranium maculatum*.
 - (d) *Onoclea sensibilis*.
 - (e) *Tiarella cordifolia*.
 - (2) Added

- (a) *Diarrhena obovata*.
 - (b) *Monarda fistulosa*.
 - (c) *Geranium macrorrhizum* 'Bevan's Variety'.
 - (d) *Athyrium filix-femina* 'Lady in Red'.
 - (e) *Galium odoratum*.
 - Updated Woodland Mix - Seed (WM-1) schedule species, percentages, and quantities
 - (1) Removed
 - (a) *Aquilegia canadensis*.
 - (b) *Symphyotrichum lateriflorum*.
 - (2) Added
 - (a) *Polemonium reptans*.
 - (b) *Actea racemosa*.
 - (c) *Mertensia virginica*.
 - Updated Woodland Mix - Fern and Sedge Glade (WM-2) schedule species, percentages, and quantities
 - (1) Removed
 - (a) *Gillenia stipulata*.
 - (b) *Symphyotrichum anomalum*.
 - (c) *Onoclea sensibilis*.
 - (2) Added
 - (a) *Conoclinium coelestinum*.
 - (b) *Actea racemosa*.
 - (c) *Mertensia virginica*.
 - (d) *Athyrium filix-femina* 'Lady in Red'.
 - (e) Updated Wetland Mix schedule species, percentages, and quantities.
 - (3) Removed
 - (a) *Lobelia cardinalis*.
5. Refer to Revised Sheet **L500E**, with original issue date 03.13.2023 and revised date 10.04.2024.
- Updated Flowering Island Mix (FL-1) schedule species, percentages, and quantities
 - (1) Removed
 - (a) *Sarcococca hookeriana* v *humilis*.
 - (b) *Aquilegia canadensis*.
 - (c) *Symphyotrichum oblongifolium*.
 - (d) *Symphyotrichum oolentangiense*.
 - (e) *Tiarella cordifolia*.
 - (2) Added
 - (a) *Allium cernuum*.
 - (b) *Liatris pycnostachya*.
 - (c) *Platycodon grandiflorus*.
 - Updated Flowering Island Mix (FL-2) schedule species, percentages, and quantities
 - (1) Removed
 - (a) *Gillenia stipulata*.
 - (b) *Aquilegia canadensis*.
 - (c) *Symphyotrichum oblongifolium*.
 - (d) *Symphyotrichum oolentangiense*.
 - (e) *Tiarella cordifolia*.
 - (2) Added
 - (a) *Conoclinium coelestinum*.
 - (b) *Polemonium reptans*.
 - (c) White Trillium.
 - (d) *Eutrochium dubium* 'Little Joe'.
 - (e) *Galium odoratum*.

6. Refer to Revised Sheet **L512**, with original issue date 03.13.2023 and revised date 10.04.2024.
 - Legend Updates
 - (1) SCY - Replaced *Ceanothus americanus* with *Clethra alnifolia*.
 - (2) SIC - Replaced *Ilex crenata* with *Buxus sempervirens* 'Fastigiata'.
 - (3) SRX - Replaced for *Rosa arkansana* with *Rosa carolina*.
 - (4) SYA - Replaced *Yucca arkansana* with *Yucca glauca*.
 - Removed SRX from healing gardens, replaced with SCY and SAC.

7. Refer to Revised Sheet **L513**, with original issue date 03.13.2023 and revised date 10.04.2024.
 - Legend Updates
 - (1) SCY - Replaced *Ceanothus americanus* with *Clethra alnifolia*.
 - (2) SIC - Replaced *Ilex crenata* with *Buxus sempervirens* 'Fastigiata'.
 - (3) SRX - Replaced for *Rosa arkansana* with *Rosa Carolina*.
 - (4) SYA - Replaced *Yucca arkansana* with *Yucca glauca*.
 - (5) Removed SRX from healing gardens, replaced with SCY and SAC.

8. Refer to Revised Sheet **L514**, with original issue date 03.13.2023 and revised date 10.04.2024.
 - Legend Updates
 - (1) SPM - Replaced *Pinus mugo* 'Dwarf' for *Pinus mugo* 'Slowmound'.
 - (2) SRX - Replaced *Rosa arkansana* with *Rosa Carolina*.
 - (3) SYA - Replaced *Yucca arkansana* with *Yucca glauca*.
 - (4) Added SHP - *Hesperaloe parviflora*.
 - Replaced (12) SYA with SHP

9. Refer to Revised Sheet **L515**, with original issue date 03.13.2023 and revised date 10.04.2024.
 - Legend Updates
 - (1) SPM - Replaced *Pinus mugo* 'Dwarf' for *Pinus mugo* 'Slowmound'.
 - (2) SRX - Replaced *Rosa arkansana* with *Rosa Carolina*.
 - (3) SYA - Replaced *Yucca arkansana* with *Yucca glauca*.
 - (4) Added SHP - *Hesperaloe parviflora*.
 - Replaced (6) SYA with SHP.

End of PR 090



Sheet No. Sheet Title

Issuance	01.12.2024	PR 013	01.31.2024	PR 058	02.16.2024	ASI 006	02.26.2024	PR 037	02.26.2024	PR 040	03.15.2024	PR 032	03.21.2024	ASI 008	03.26.2024	PR 039	04.04.2024	ASI 011	04.12.2024	ASI 009	04.18.2024	PR 054	05.09.2024	ASI 016	5.30.2024	PR 048	06.06.2024	PR 055	07.05.2024	ASI 020	07.09.2024	PR 069	07.24.2024	PR 072R	09.30.2024	PR 071	08.23.2024	PR 078R	09.30.2024	ASI 025	08.29.2024	ASI 027	08.29.2024	PR 086	10.03.2024	PR 099	10.04.2024
General																																															
L000	Drawing list, symbols + Abbreviations																																														
L000A	Drawing List Continued																																														
L001	Symbols, Abbreviations, Legends																																														
Reference Plan																																															
L010	Reference Plan																																														
L011	LSD Site Plan																																														
Site Preparation																																															
LSP-0	Site Preparation - Key Plan, Legend and Notes																																														
LSP-1	Site Preparation Plan 1/3																																														
LSP-2	Site Preparation Plan 2/3																																														
LSP-3	Site Preparation Plan 3/3																																														
Materials																																															
L100	Materials - Key Plan, Legend and Notes																																														
L101	Materials Plan - Ground Floor 1/3																																														
L102	Materials Plan - Ground Floor 2/3																																														
L103	Materials Plan - Ground Floor 3/3																																														
L104	Materials Plan - Roof 1/2																																														
L105	Materials Plan - Roof 2/2																																														
L106	Materials Plan - Roof Level 3																																														
Layout - Hardscape																																															
L200A	Layout - Hardscape - Key Plan, Legend and Notes																																														
L200B	Layout - Hardscape - Data Chart																																														
L201	Layout - Hardscape - Groundfloor 1/3																																														
L202	Layout - Hardscape - Groundfloor 2/3																																														
L203	Layout - Hardscape - Groundfloor 3/3																																														
L204	Layout - Hardscape - Roof 1/2																																														
L205	Layout - Hardscape - Roof 2/2																																														
Layout - Furnishings																																															
L210	Layout - Furnishings - Key Plan, Legend and Notes																																														
L211	Layout - Furnishings - Ground Floor 1/3																																														
L212	Layout - Furnishings - Ground Floor 2/3																																														
L213	Layout - Furnishings - Ground Floor 3/3																																														
L214	Layout - Furnishings - Roof 1/2																																														
L215	Layout - Furnishings - Roof 2/2																																														
Layout - Lighting																																															
L220A	Layout - Lighting - Key Plan, Legend and Notes																																														
L221	Layout - Lighting - Ground Floor 1/3																																														
L222	Layout - Lighting - Ground Floor 2/3																																														
L223	Layout - Lighting - Ground Floor 3/3																																														
L224	Layout - Lighting - Roof 1/2																																														
L225	Layout Plan Lighting - Roof																																														
Grading																																															
L300	Grading Plan - Key Plan, Legend and Notes																																														
L301	Grading Plan - Ground Floor 1/3																																														
L302	Grading Plan - Ground Floor 2/3																																														
L303	Grading Plan - Ground Floor 3/3																																														
L304	Grading Plan - Roof 1/2																																														
L305	Grading Plan - Roof 2/2																																														
L306	Grading Plan - Roof - Level 3																																														
Planting Soils																																															
L400	Planting Soils - Key Plan, Legend and Notes																																														
L401	Planting Soils - Ground Floor 1/3																																														
L402	Planting Soils - Ground Floor 2/3																																														
L403	Planting Soils - Ground Floor 3/3																																														
L404	Planting Soils - Roof 1/2																																														
L405	Planting Soils - Roof 2/2																																														
Planting																																															
L500A	Planting - Key Plan, Legend and Notes																																														
L500B	Planting Schedule 1/4																																														
L500C	Planting Schedule 2/4																																														
L500D	Planting Schedule 3/4																																														
L500E	Planting Schedule 4/4																																														
L501	Planting Plan - Ground Floor 1/3																																														
L502	Planting Plan - Ground Floor 2/3																																														
L503	Planting Plan - Ground Floor 3/3																																														
L504	Planting Plan - Roof 1/2																																														
L505	Planting Plan - Roof 2/2																																														
L506	Tree Planting Plan - Ground Floor 1/3																																														
L507	Tree Planting Plan - Ground Floor 2/3																																														
L508	Tree Planting Plan - Ground Floor 3/3																																														
L509	Tree Planting Plan - Roof 1/2																																														
L510	Tree Planting Plan - Roof 2/2																																														
L511	Shrub Planting Plan - Ground Floor 1/3																																														
L512	Shrub Planting Plan - Ground Floor 2/3																																														
L513	Shrub Planting Plan - Ground Floor 3/3																																														
L514	Shrub Planting Plan - Roof 1/2																																														
L515	Shrub Planting Plan - Roof 2/2																																														

3 Drawing List (Continued)
Scale: N/A

Sheet No. Sheet Title

Issuance	01.12.2024	PR 013	01.31.2024	PR 058	02.16.2024	ASI 006	02.26.2024	PR 037	02.26.2024	PR 040	03.15.2024	PR 032	03.21.2024	ASI 008	03.26.2024	PR 039	04.04.2024	ASI 011	04.12.2024	ASI 009	04.18.2024	PR 054	05.09.2024	ASI 016	5.30.2024	PR 048	06.06.2024	PR 055	07.05.2024	ASI 020	07.09.2024	PR 069	07.24.2024	PR 072R	09.30.2024	PR 071	08.23.2024	PR 078R	09.30.2024	ASI 025	08.29.2024	ASI 027	08.29.2024	PR 086	10.03.2024	PR 099	10.04.2024
Sections																																															
L600	1 - Parking + Swale																																														
	2 - Pond + Wetland Terrace																																														
L610	1 - Tail + Grotto																																														
	2 - Steep Roof Cross Section																																														
L611	1 - L4 Terrace Section																																														
Basin & Runnel Enlargements - Plans																																															
L700A	Enlargements Key Plan - Woodland Amphitheater and Welcome Plaza																																														
L700B	Enlargements Key Plan - Stone Paving and Benches																																														
L701	Woodland Amphitheater Enlargement 1 - Materials																																														
L702	Woodland Amphitheater Enlargement 2 - Materials																																														
L703	Welcome Plaza Enlargement - Materials																																														
L704	Amphitheater Enlargement 1 - Layout																																														
L705	Amphitheater Enlargement 2 - Layout																																														
L706A	Welcome Plaza Enlargement 1 - Layout - Hardscape																																														
L706B	Welcome Plaza Enlargement 1 - Layout - Lighting																																														
L707	Amphitheater Enlargement 1 - Grading																																														
L708	Amphitheater Enlargement 2 - Grading																																														
L709	Welcome Plaza Enlargement 1 - Grading																																														
L710	Woodland Amphitheater Section																																														
L711	Amphitheater Seat Wall Sections and Schedule																																														
L712	Woodland Amphitheater Stone Stair Schedule																																														
L720	Basin 1 and Runnel Plans																																														
L720A	Cascade Falls Details																																														
L721	Basin 2 Plans																																														
L722	Basin 3 Plans																																														
L723	Basin Sections																																														
L724	Basin Sections																																														
L725	Basin Sections																																														
L730	Runnel - 3d Views																																														
L731	Runnel and Basin Section Elevation																																														
L732	Runnel Stone Schedule																																														
L733	Runnel Stone Schedule																																														
L734	Runnel Stone Schedule																																														
L735	Runnel Stone Schedule																																														
L750	Roof Tail Flake Stone Enlargement																																														
L751	Cafe Plaza Stone Enlargement																																														
L752	Prospect Bluff Stone Enlargement																																														
L753	Healing Garden Stone Enlargement																																														
L754	Winter Terrace Stone Enlargement																																														
L755	Stone Schedules																																														
L761	Teaching Garden Enlargement - Layout																																														
L762	Teaching Garden Enlargement - Grading																																														
L790	Water Feature - Details																																														
L791	Water Feature - Details																																														
Details																																															
L901	Details - Paving																																														
L902	Details - Paving																																														
L903	Details - Paving, Walls, Curbs																																														
L904	Details - Furnishing																																														
L905	Details - Furnishing																																														
L906	Details - Stairs, Drains, Handrails																																														
L907	Details - Fencing																																														
L908	Details - Lighting																																														
L909	Details - Boardwalk																																														
L910	Details - Boardwalk																																														
L911	Details - Planting																																														
L912	Details - Soils																																														
L913	Details - Roof Drain Access																																														
L914	Details - Teaching Garden																																														
L915	Details - Teaching Garden																																														
L916	Details																																														
Irrigation Drawings																																															
I101	Ground Floor Irrigation Plan 1																																														
I102	Ground Floor Irrigation Plan 2																																														
I103	Ground Floor Irrigation Plan 3																																														
I104	Irrigation Roof Plan																																														
I105	Irrigation Details																																														
I106	Irrigation Details																																														
Water Feature Drawings																																															
WF101	Water Feature Site Plan																																														
WF102	Water Feature Piping Plan																																														
WF201	Runnel Hydraulic Schematic																																														
WF202	Basins 2 & 3 Hydraulic Schematic																																														
WF301	Water Feature Equipment																																														
WF302	Water Feature Equipment																																														
WF401	Water Feature Section and Details																																														
WF501	Water Feature Fabrication and General Details																																														
WF601	Water Feature Electrical Plan																																														
WF602	Water Feature Electrical Details																																														



801 South Spring Street
Little Rock, AR 72201
501.378.0878 office

509 W. Spring St | Suite 150
Fayetteville, AR 72701
479.644.0133 office

polkstanleywilcox.com

CIVIL
McClendon Consulting Engineers, Inc.
1580 E STEARNS ST
FAVETTVILLE, AR 72703
P: 479.443.2377

LANDSCAPE
OSD
115 ST. JONAS PLACE
BROOKLYN, NY 11217
P: 917.553.5586

STRUCTURAL
Marti/Martin Consulting Engineers
3008 SOUTH WALTON BLVD, STE 312
BENTONVILLE, AR 72712
P: 479.407.0545

MEPE - LOW VOLTAGE
Henderson Engineers
6346 LEXENA DRIVE, STE 300
LEXENIA, MO 6454
P: 813.660.6157

SUSTAINABILITY
OTL
224 SOUTH MORGAN AVENUE
CHICAGO, IL 60604
P: 312.360.4121

SIGNAGE - WAYFINDING
TWO TWELVE
236 W. 27th ST., SUITE 602
NEW YORK, NY 10001
P: 212.254.6870

FOOD SERVICE
JMG HOSPITALITY
6906 SA FINGER DR., SUITE B210
THE WOODLANDS, TX 77380
P: 601.841.2222

WATER FEATURES
OTL
2150 S. TOWNE CENTER, SUITE 100
ANAHIM, CA 92906
P: 714.637.4747

IRRIGATION
WC3 DESIGN
11A ROBERTSON MANOR BLVD
MOORESBURG, PA 14138
P: 844.231.7042

PSW Job Number:
933A



AWSOM
Bentonville, AR

Issue Date:
03.13.2023

REVISIONS		
NUMBER	DATE	DESCRIPTION
1	04.13.2023	AS1 011
2	04.18.2023	AS1 008
3	05.09.2024	PR 034
4	05.28.2024	AS1 016
5	06.06.2024	PR 048
6	07.05.2024	PR 055
7	07.09.2024	AS1 020
8	07.24.2024	PR 069
9	08.23.2024	PR 078R
10	08.29.2024	PR 086
11	08.29.2024	PR 039R
12	08.29.2024	AS1 025
13	09.30.2024	AS1 027
14	10.03.2024	PR 099
15	10.04.2024	PR 099

Contents:
Drawing List, Symbols
and Abbreviations

THIS PAGE IS BEST
VIEWED IN COLOR

L000A

PLANTING SCHEDULE: TREES AND SHRUBS								
TREES								
KEY	TOTAL QTY	LATIN NAME	COMMON NAME	CALIPER/ HEIGHT	ROOT	MIN. ROOTBALL Ø	MATURE HEIGHT	NOTES
AA	12	<i>Amelanchier 'Autumn Brilliance'</i>	Shadblow	8-10' ht.	B+B	38" Rootball	25'	
AR	7	<i>Acer x freemanii</i>	Freeman's Maple	4" cal.	B+B	42" Rootball	65'	Fall Dig Hazard
AR-1	2	<i>Acer x freemanii</i>	Freeman's Maple	5" cal.	B+B	52" Rootball	65'	Fall Dig Hazard
AR-2	0	<i>Acer rubrum</i>	Red Maple	5" cal.	B+B	60" Rootball	65'	
CB	32	<i>Carpinus betulus 'Fastigiata'</i>	Fastigiata Hornbeam	8-10' ht.	B+B	38" Rootball	30'	Fall Dig Hazard
CC	87	<i>Cercis canadensis 'Appalachian Red'</i>	Appalachian Red Redbud	3" cal.	B+B	32" Rootball	20'	
CF	37	<i>Cornus 'Saturn'</i>	Saturn Dogwood	8-10' ht.	B+B	32" Rootball	20'	Multistem
CR	4	<i>Crataegus crus-galli</i>	Hawthorn	3" cal.	B+B	32" Rootball	25'	
CS	7	<i>Catalpa speciosa</i>	Catalpa	4" cal.	B+B	42" Rootball	40'	
DV	8	<i>Diospyros virginiana</i>	Persimmon	3" cal.	B+B	32" Rootball	35'	
GD	12	<i>Gymnocladus dioica</i>	Kentucky Coffeetree	3" cal.	B+B	32" Rootball	75'	
IO	8	<i>Ilex opaca</i>	Tree Holly	10-12' ht.	B+B	38" Rootball	25'	Fall Dig Hazard
JN	0	<i>Juglans nigra</i>	Walnut	3" cal.	B+B	32" Rootball	75'	Fall Dig Hazard
LT	20	<i>Liriodendron tulipifera</i>	Tuliptree	3" cal.	B+B	32" Rootball	60'	Fall Dig Hazard
LT-1	2	<i>Liriodendron tulipifera</i>	Tuliptree	5" cal.	B+B	52" Rootball	60'	Fall Dig Hazard
LT-2	22	<i>Liriodendron tulipifera</i>	Tuliptree	5" cal.	B+B	60" Rootball	60'	
MG	19	<i>Magnolia grandiflora</i>	Southern Magnolia	10-12' ht.	B+B	38" Rootball	60'	Fall Dig Hazard
MJ	9	<i>Magnolia 'Jane'</i>	Jane Magnolia	8-10' ht.	B+B	38" Rootball	15'	
ML	14	<i>Magnolia x loebneri</i>	Loebner Magnolia	8-10' ht.	B+B	38" Rootball	15'	
NS	25	<i>Nyssa sylvatica 'Wildfire'</i>	Wildfire Black Gum	3" cal.	B+B	32" Rootball	50'	Fall Dig Hazard
PC	3	<i>Pistachia chinensis 'Keith Davey'</i>	Keith Davey Chinese Pistache	3" cal.	B+B	32" Rootball	30'	Male Cultivar Only
PF	29	<i>Pinus flexilis</i>	Limber Pine	10-12' ht.	B+B	38" Rootball	60'	Fall Dig Hazard
PO	22	<i>Platanus occidentalis</i>	Sycamore	3" cal.	B+B	32" Rootball	100'	Fall Dig Hazard
PO-2	10	<i>Platanus occidentalis</i>	Sycamore	3" cal.	B+B	32" Rootball	100'	Fall Dig Hazard, Multistem
PE	26	<i>Pinus echinata</i>	Shortleaf Pine	10-12' ht.	B+B	38" Rootball	80'	Fall Dig Hazard
PS	34	<i>Pinus strobus</i>	Eastern White Pine	10-12' ht.	B+B	38" Rootball	80'	
PY	22	<i>Prunus mexicana</i>	Mexican Plum	3" cal.	B+B	32" Rootball	25'	
QA	3	<i>Quercus alba</i>	White Oak	4" cal.	B+B	42" Rootball	60'	
QT	6	<i>Quercus texana</i>	Nuttall Oak	4" cal.	B+B	42" Rootball	60'	
QC	5	<i>Quercus coccinea</i>	Scarlet Oak	4" cal.	B+B	42" Rootball	70'	
QX	12	<i>Quercus marilandica</i>	Blackjack Oak	4" cal.	B+B	42" Rootball	40'	
QM	10	<i>Quercus muehlenbergii</i>	Chinquapin Oak	4" cal.	B+B	42" Rootball	50'	Fall Dig Hazard
QM-1	4	<i>Quercus muehlenbergii</i>	Chinquapin Oak	5" cal.	B+B	52" Rootball	50'	Fall Dig Hazard
QS	0	<i>Quercus stellata</i>	Post Oak	4" cal.	B+B	42" Rootball	35'	Fall Dig Hazard
SA	9	<i>Sassafras albidum</i>	Sassafras	2" cal.	B+B	24" Rootball	50'	
SB	10	<i>Salix nigra</i>	Black Willow	4" cal.	B+B	42" Rootball	40'	
SB-1	3	<i>Salix nigra</i>	Black Willow	5" cal.	B+B	52" Rootball	40'	
TD	27	<i>Taxodium distichum</i>	Baldcypress	10-12' ht.	B+B	44" Rootball	50'	Fall Dig Hazard
MD	3	<i>Malus domestica 'Spurlock'</i>	Spurlock Apple	6-8' ht.	B+B	32" Rootball	15'	Semi-Dwarf
ME	2	<i>Malus domestica 'Enterprise'</i>	Enterprise Apple	6-8' ht.	B+B	32" Rootball	15'	Semi-Dwarf
MF	2	<i>Malus domestica 'William's Pride'</i>	William's Pride Apple	6-8' ht.	B+B	32" Rootball	15'	Semi-Dwarf
PL	4	<i>Prunus salicina 'Methley'</i>	Methley Plum	6-8' ht.	B+B	32" Rootball	15'	Standard
PT	2	<i>Prunus salicina 'Toka'</i>	Toka Plum	6-8' ht.	B+B	32" Rootball	15'	Standard
PX	2	<i>Pyrus communis 'Maxine'</i>	Maxine Pear	6-8' ht.	B+B	32" Rootball	18'	Semi-Dwarf
PX-1	3	<i>Pyrus communis 'Maxine'</i>	Maxine Pear	6-8' ht.	B+B	32" Rootball	18'	Espaliered, Semi-Dwarf
PD	2	<i>Pyrus communis 'D'Anjou'</i>	D'Anjou Pear	6-8' ht.	B+B	32" Rootball	18'	Semi-Dwarf
PA	4	<i>Prunus persica 'White River'</i>	White River Peach	6-8' ht.	B+B	32" Rootball	20'	Espaliered
TOTAL:	686							

SHRUBS						
KEY	TOTAL QTY	LATIN NAME	COMMON NAME	HEIGHT	CONT. SIZE	NOTES
SAP	34	<i>Aesculus pavia</i>	Red Buckeye		7 gal.	
SAC	56	<i>Amorpha canescens</i>	Lead Plant		3 gal.	
SCA	83	<i>Callicarpa americana</i>	Beautyberry		5 gal.	
SCF	53	<i>Calycanthus floridus</i>	Carolina allspice		3 gal.	
SCO	11	<i>Cephalanthus occidentalis</i>	Buttonbush		5 gal.	
SCY	19	<i>Clethra alnifolia</i>	Sweet Pepperbush		3 gal.	
SCV	9	<i>Chionanthus virginicus</i>	Fringetree		7 gal.	
SCB	16	<i>Cornus 'bailey'</i>	Red Twig Dogwood		3 gal.	
SCL	10	<i>Cotinus 'Little Lady'</i>	Little Lady Smokebush		5 gal.	
SCE	19	<i>Corylus americana</i>	American Hazelnut		3 gal.	
SHV	38	<i>Hamamelis vernalis</i>	Vernal Witchhazel		7 gal.	
SHI	33	<i>Hamamelis x intermedia 'Jelena'</i>	Jelena' Witchhazel		7 gal.	
SHQ	14	<i>Hydrangea quercifolia</i>	Oakleaf Hydrangea		5 gal.	
SIC	22	<i>Buxus sempervirens 'Fastigiata'</i>	Boxwood		5 gal.	
SIV	153	<i>Ilex vomitoria</i>	Yaupon Holly		5 gal.	
SIZ	63	<i>Itea virginica</i>	Virginia Sweetspire		3 gal.	
SLB	58	<i>Lindera benzoin</i>	Spicebush		3 gal.	
SOH	55	<i>Opuntia humifusa</i>	Prickly-Pear Cactus		3 gal.	
SPM	100	<i>Pinus mugo 'Slowmound'</i>	Slowmound Mugo Pine		3 gal.	
SPO	37	<i>Physocarpus opulifolius</i>	Common Ninebark		5 gal.	
SRA	105	<i>Rhus aromatica var. aromatica</i>	Aromatic Sumac		3 gal.	
SRC	45	<i>Rhus copallinum</i>	Shining Sumac		5 gal.	
SRX	12	<i>Rosa carolina</i>	Carolina Rose		3 gal.	
SSA	29	<i>Symphoricarpos albus</i>	Snowberry		3 gal.	
SYA	21	<i>Yucca glauca</i>	Soapweed Yucca		5 gal.	
SHP	21	<i>Hesperaloe parviflora</i>	Red Yucca		5 gal.	
TOTAL:	1116					

Planting Notes

- Layout: The plant locations shown on the Drawings are approximate. The Contractor shall layout the plantings as shown on the Drawings and receive on-site approval from the Landscape Architect prior to installation. Contractor shall make adjustments as determined by the Landscape Architect without additional cost to the Owner.
- Identifying and Exposing the Root Flare: Prior to setting the height of the rootball pedestal, the Contractor shall remove burlap and twine from the top of the rootball and inspect each plant to determine if the trunk flare is buried within the rootball. Adventitious roots and girdling roots shall be removed with sharp pruners.
- Plant Material: Contractor shall provide photographs of plants taken at the Nursery Source. Photographs shall be labeled with the plant species botanical name, nursery name, plant size, and date of photograph. Photographs shall include full range of characteristics of each plant including detailed photographs of the bark, base of the tree, leaves (if present), branching structure, form, and habit. For container plants, provide close up photographs of the rootball with the container removed. All images shall include a scale figure, such as a ruler or person. Obtain approval from Landscape Architect prior to plant procurement.
- On-Site Inspection of Plant Material: The Landscape Architect will inspect the plant materials for size and condition of rootballs and/or root systems, insects, injuries, detoliation, wind burn and latent defects. The Contractor shall remove plant material that is unsatisfactory, as determined by Landscape Architect, and replace the plants at no additional cost to the Owner.
- Substitutions: In the event that the Contractor is unable to obtain the plant material specified, either because of unavailability or the failure of the plant material to meet the quality requirements, the Contractor shall provide substitute plants of equal size, quality, character, overall form, branching habit, and value to the plant material originally specified. The substitute plants must be approved by the Landscape Architect prior to procurement.
- Contractor is responsible for providing fully operational irrigation system for all planting areas. Refer to irrigation drawings and specifications.
- All planting to conform with planting details as noted on L911
- Plant quantities are provided as a courtesy only. The contractor is responsible for verifying all quantities.



REVISIONS		
NUMBER	DATE	DESCRIPTION
1	03.13.2023	ADDendum
2	06.09.2023	ADDendum 2
3	08.04.2023	PR 09
4	07.24.2024	PR 09
5	08.26.2024	PR 09
6	08.26.2024	PR 09
7	10.04.2024	PR 09



REVISIONS		
NUMBER	DATE	DESCRIPTION
1	03/13/2023	ADDendum
2	06/08/2023	ADDendum 2
3	04/04/2024	PR 050
4	01/12/2024	ASB 024
5	04/04/2024	PR 050
6	04/12/2024	ASB 011
7	02/26/2024	ASB 016
8	02/26/2024	PR 050
9	07/05/2024	PR 050
10	07/24/2024	PR 050
11	09/26/2024	PR 050R
12	09/26/2024	PR 050R
13	10/04/2024	PR 050

LAWN - SOD (L)						TOTAL AREA (SF)
TOTAL QTY (%)	TYPE	SPACING	SIZE			39,531
100%	SOD	18" W/ 18" MIN. STAGGERED JOINTS	N/A			

AMPITHEATRE MIX (AM)						TOTAL AREA (SF)
TOTAL QTY (%)	LATIN NAME	COMMON NAME	SIZE	SPACING		2,763
CONTAINERS & PLUGS - 60%						TOTAL QTY (#)
7%	<i>Baptisia alba</i>	White Wild Indigo	2 gal.	16" o.c.		75
10%	<i>Penstemon digitalis</i>	Foxglove Beardtongue	2 gal.	16" o.c.		108
15%	<i>Carex amphibia</i>	Creek Sedge	2 gal.	16" o.c.		162
10%	<i>Epidemum grandiflorum 'Lilafée'</i>	Bishop's Hat	1 gal.	14" o.c.		141
5%	<i>Actaea simplex</i>	Snakeroot	1 gal.	14" o.c.		70
3%	<i>Polemonium reptans</i>	Jacob's Ladder	1 gal.	14" o.c.		42
4%	<i>Geranium macrorrhizum 'Bevan's Variety'</i>	Bigroot Geranium	1 gal.	14" o.c.		56
4%	<i>Carex appalachia</i>	Appalachian Sedge	1 gal.	14" o.c.		56
8%	<i>Dryopteris erythrosora</i>	Autumn Fern	1 gal.	14" o.c.		113
4%	<i>Diarrhena obovata</i>	American Beak Grass	1 gal.	14" o.c.		56
12%	<i>Osmunda cinnamomea</i>	Cinnamon Fern	1 gal.	14" o.c.		169
7%	<i>Polygonatum biflorum</i>	Solomon's Seal	1 gal.	14" o.c.		98
4%	<i>Thalictrum pubescens</i>	Meadow Rue	1 gal.	14" o.c.		56
7%	<i>Sedum ternatum</i>	Woodland Stonecrop	Quart.	12" o.c.		134
100%						1337
BULBS - 40%						TOTAL QTY (#)
20%	<i>Lilium superbum</i>	Turk's Cap Lily	Bulb	16" o.c.		150
20%	<i>Lilium canadense</i>	Canada Lily	Bulb	16" o.c.		150
30%	<i>Galanthus elwesii</i>	Snowdrops	Bulb	8" o.c.		870
30%	<i>Narcissus poeticus var. recurvus</i>	Pheasant's Eye Narcissus	Bulb	8" o.c.		870
100%						2040

DETENTION BASIN MIX (DB)						TOTAL AREA (SF)
TOTAL QTY (%)	LATIN NAME	COMMON NAME	SIZE	SPACING		9,770
CONTAINER & PLUGS - 60%						TOTAL QTY (#)
3%	<i>Asclepias viridis</i>	Green Milkweed	1 gal.	14" o.c.		149
2%	<i>Coreopsis lanceolata</i>	Lanceleaf coreopsis	1 gal.	14" o.c.		99
5%	<i>Echinacea purpurea</i>	Purple coneflower	1 gal.	14" o.c.		249
5%	<i>Monarda fistulosa</i>	Wild Bergamont	1 gal.	14" o.c.		249
3%	<i>Lytium alatum</i>	Winged Loosestrife	1 gal.	14" o.c.		149
5%	<i>Liatis pycnostachya</i>	Gayfeather	1 gal.	14" o.c.		249
5%	<i>Oligoneuron rigidum var. rigidum</i>	Stiff Goldenrod	1 gal.	14" o.c.		249
5%	<i>Physostegia virginiana</i>	Obedient Plant	1 gal.	14" o.c.		249
5%	<i>Rudbeckia triloba</i>	Brown Eyed Susan	1 gal.	14" o.c.		249
5%	<i>Eutrochium dubium 'Little Joe'</i>	Joe Pye Weed	1 gal.	14" o.c.		249
8%	<i>Carex bicknellii</i>	Copper-Shouldered Oval Sedge	Plug	14" o.c.		400
7%	<i>Carex vulpinoidea</i>	Brown Fox Sedge	Plug	14" o.c.		350
5%	<i>Elymus virginicus</i>	Virginia Wildrye	Plug	14" o.c.		250
7%	<i>Leersia oryzoides</i>	Rice Cutgrass	Plug	14" o.c.		350
14%	<i>Andropogon gerardii</i>	Big Bluestem	Plug	14" o.c.		700
14%	<i>Panicum virgatum</i>	Switchgrass	Plug	14" o.c.		700
3%	<i>Junus effusus</i>	Soft Rush	Plug	14" o.c.		150
100%						5039
SEED - 100%						TOTAL QTY (LBS)
8%	<i>Asclepias incarnata</i>	Swamp Milkweed				
4%	<i>Asclepias viridis</i>	Green Milkweed				
4%	<i>Eutrochium dubium 'Little Joe'</i>	Joe Pye Weed				
4%	<i>Eupatorium perfoliatum</i>	Boneset				
4%	<i>Chamaecrista fasciculata</i>	Partridge Pea				
4%	<i>Lobelia siphilitica</i>	Great Blue Lobelia				
9%	<i>Pycnanthemum albescens</i>	Whiteleaf Mountain Mint				
6%	<i>Rudbeckia hirta</i>	Black-Eyed Susan				
9%	<i>Baptisia sphaerocarpa</i>	Yellow Baptisia				
6%	<i>Desmanthus illinoensis</i>	Illinois Bundleflower				
6%	<i>Elymus hystrix</i>	Eastern Bottlebrush Grass				
10%	<i>Carex vulpinoidea</i>	Foxtail Sedge				
10%	<i>Elymus virginicus</i>	Virginia Wildrye				
16%	<i>Juncus interior</i>	Inland Rush				
100%						8,074

HEALING GARDEN MIX - TALL (HG-1)						TOTAL AREA (SF)
TOTAL QTY (%)	LATIN NAME	COMMON NAME	SIZE	SPACING		12,905
CONTAINERS & PLUGS - 60%						TOTAL QTY (#)
3%	<i>Ratibida pinnata</i>	Gray Headed Coneflower	2 gal.	18" o.c.		119
6%	<i>Agastache 'Blue Fortune'</i>	Giant Hyssop	2 gal.	18" o.c.		238
6%	<i>Baptisia alba</i>	White Wild Indigo	2 gal.	14" o.c.		394
10%	<i>Amsonia hubrichtii</i>	Hubricht's Bluestar	2 gal.	18" o.c.		397
6%	<i>Achillea millefolium</i>	Yarrow	1 gal.	14" o.c.		394
3%	<i>Allium cernuum</i>	Nodding Onion	1 gal.	14" o.c.		197
4%	<i>Aster azureus</i>	Sky Blue Aster	1 gal.	14" o.c.		263
10%	<i>Bouteloua gracilis 'Blond Ambition'</i>	Blue Grama	1 gal.	14" o.c.		657
5%	<i>Monarda fistulosa</i>	Wild Bergamont	1 gal.	14" o.c.		328
6%	<i>Eryngium yuccifolium</i>	Rattlesnake Master	1 gal.	14" o.c.		394
5%	<i>Monarda bradburiana</i>	Eastern Beebalm	1 gal.	14" o.c.		328
4%	<i>Monarda punctata</i>	Spotted Beebalm	1 gal.	14" o.c.		263
8%	<i>Sanguisorba canadensis</i>	American Burnet	1 gal.	14" o.c.		526
6%	<i>Sporobolus heterolepis 'Tara'</i>	Prairie Dropseed	1 gal.	14" o.c.		394
1%	<i>Eutrochium dubium 'Little Joe'</i>	Joe Pye Weed	1 gal.	14" o.c.		66
1%	<i>Solidago petiolaris</i>	Downy Goldenrod	1 gal.	14" o.c.		66
3%	<i>Thalictrum 'Elin'</i>	Elin Meadow Rue	1 gal.	14" o.c.		197
4%	<i>Thalictrum pubescens</i>	Meadow Rue	1 gal.	14" o.c.		263
3%	<i>Verbena bonariensis</i>	Vervain	1 gal.	14" o.c.		197
6%	<i>Verbena hastata</i>	Hoary Vervain	1 gal.	14" o.c.		394
100%						6076
BULBS - 40%						TOTAL QTY (#)
30%	<i>Allium sphaerocephalon</i>	Drumstick Allium	Bulb	12" o.c.		1790
30%	<i>Allium bulgaricum sicutum</i>	Sicilian onion	Bulb	12" o.c.		1790
30%	<i>Narcissus 'actaea'</i>	Pheasant's Eye Narcissus	Bulb	12" o.c.		1790
10%	<i>Fritillaria meleagris</i>	Snake's Head Fritillary	Bulb	12" o.c.		600
100%						6970

HEALING GARDEN MIX - SHORT (HG-2)						TOTAL AREA (SF)
TOTAL QTY (%)	LATIN NAME	COMMON NAME	SIZE	SPACING		6,540
CONTAINERS & PLUGS - 60%						TOTAL QTY (#)
6%	<i>Agastache foeniculum</i>	Anise Hyssop	2 gal.	18" o.c.		121
5%	<i>Baptisia alba</i>	White Wild Indigo	2 gal.	14" o.c.		166
2%	<i>Allium cernuum</i>	Nodding Onion	1 gal.	14" o.c.		67
8%	<i>Achillea millefolium</i>	Yarrow	1 gal.	14" o.c.		266
9%	<i>Aristida purpurea</i>	Purple Threeawn	1 gal.	14" o.c.		300
16%	<i>Bouteloua gracilis 'Blond Ambition'</i>	Blue Grama	1 gal.	14" o.c.		533
5%	<i>Monarda fistulosa</i>	Wild Bergamont	1 gal.	14" o.c.		166
6%	<i>Eryngium yuccifolium</i>	Rattlesnake Master	1 gal.	14" o.c.		200
4%	<i>Achillea millefolium 'Peachy Seduction'</i>	Yarrow	1 gal.	14" o.c.		133
5%	<i>Monarda bradburiana</i>	Eastern Beebalm	1 gal.	14" o.c.		166
4%	<i>Monarda punctata</i>	Spotted Beebalm	1 gal.	14" o.c.		133
8%	<i>Sesleria autumnalis</i>	Autumn Moor Grass	1 gal.	14" o.c.		266
6%	<i>Solidago caesia</i>	Woodland Goldenrod	1 gal.	14" o.c.		200
8%	<i>Sporobolus heterolepis 'Tara'</i>	Prairie Dropseed	1 gal.	14" o.c.		266
4%	<i>Eutrochium dubium 'Little Joe'</i>	Joe Pye Weed	1 gal.	14" o.c.		133
4%	<i>Solidago petiolaris</i>	Downy Goldenrod	1 gal.	14" o.c.		133
100%						3117
BULBS - 40%						TOTAL QTY (#)
30%	<i>Allium sphaerocephalon</i>	Drumstick Allium	Bulb	12" o.c.		910
40%	<i>Narcissus 'actaea'</i>	Pheasant's Eye Narcissus	Bulb	12" o.c.		1210
30%	<i>Fritillaria meleagris</i>	Snake's Head Fritillary	Bulb	12" o.c.		910
100%						3030

HERBACEOUS ENTRY MIX (HE)						TOTAL AREA (SF)
TOTAL QTY (%)	LATIN NAME	COMMON NAME	SIZE	SPACING		12,640
CONTAINERS & PLUGS - 100%						TOTAL QTY (#)
25%	<i>Symphoricarpos orbiculata</i>	Coralberry	2 gal.	24" o.c.		912
3%	<i>Amsonia hubrichtii</i>	Hubricht's Bluestar	2 gal.	18" o.c.		195
8%	<i>Achillea millefolium</i>	Yarrow	1 gal.	14" o.c.		858
5%	<i>Agastache foeniculum</i>	Hyssop	1 gal.	14" o.c.		536
5%	<i>Aster azureus</i>	Sky Blue Aster	1 gal.	14" o.c.		536
10%	<i>Carex appalachia</i>	Appalachian Sedge	1 gal.	14" o.c.		1072
10%	<i>Monarda fistulosa</i>	Wild Bergamont	1 gal.	14" o.c.		1072
5%	<i>Geranium macrorrhizum 'Bevan's Variety'</i>	Bigroot Geranium	1 gal.	14" o.c.		536
5%	<i>Achillea millefolium 'Peachy Seduction'</i>	Yarrow	1 gal.	14" o.c.		536
5%	<i>Monarda punctata</i>	Spotted Beebalm	1 gal.	14" o.c.		536
5%	<i>Solidago nemoralis</i>	Showy Goldenrod	1 gal.	14" o.c.		536
14%	<i>Sporobolus heterolepis</i>	Prairie Dropseed	1 gal.	14" o.c.		1501
100%						8828

TERRACE MIX (TM)						TOTAL AREA (SF)
TOTAL QTY (%)	LATIN NAME	COMMON NAME	SIZE	SPACING		6,402
CONTAINERS & PLUGS - 60%						TOTAL QTY (#)
3%	<i>Baptisia alba</i>	White Wild Indigo	2 gal.	14" o.c.		98
6%	<i>Amsonia hubrichtii</i>	Hubricht's Bluestar	2 gal.	18" o.c.		118
8%	<i>Achillea millefolium</i>	Yarrow	1 gal.	14" o.c.		261
5%	<i>Agastache foeniculum</i>	Hyssop	1 gal.	14" o.c.		163
5%	<i>Aster azureus</i>	Sky Blue Aster	1 gal.	14" o.c.		163
12%	<i>Monarda fistulosa</i>	Wild Bergamont	1 gal.	14" o.c.		391
10%	<i>Eryngium yuccifolium</i>	Rattlesnake Master	1 gal.	14" o.c.		326
5%	<i>Geranium macrorrhizum 'Bevan's Variety'</i>	Bigroot Geranium	1 gal.	14" o.c.		163
1%	<i>Carex triflorum</i>	Prairie Smoke	1 gal.	14" o.c.		33
4%	<i>Achillea millefolium 'Peachy Seduction'</i>	Yarrow	1 gal.	14" o.c.		130
5%	<i>Monarda bradburiana</i>	Eastern Beebalm	1 gal.	14"		

SHORTGRASS MEADOW (SG-1)					TOTAL AREA (SF)
TOTAL QTY (%)	LATIN NAME	COMMON NAME	SIZE	SPACING	22,888
CONTAINER & PLUGS - 60%					TOTAL QTY (#)
3%	<i>Oligoneuron rigidum</i> var. <i>rigidum</i>	Stiff Goldenrod	2 gal.	14" o.c.	337
3%	<i>Achillea millefolium</i>	Yarrow	1 gal.	14" o.c.	337
1%	<i>Eutrochium dubium</i> 'Little Joe'	Joe Pye Weed	1 gal.	14" o.c.	112
2%	<i>Solidago petiolaris</i>	Downy Goldenrod	1 gal.	14" o.c.	225
3%	<i>Aster oblongifolius</i>	Late Aster	1 gal.	14" o.c.	337
2%	<i>Coreopsis lanceolata</i>	Lanceleaf Coreopsis	1 gal.	14" o.c.	225
3%	<i>Monarda fistulosa</i>	Wild Bergamont	1 gal.	14" o.c.	337
7%	<i>Eryngium yuccifolium</i>	Rattlesnake Master	1 gal.	14" o.c.	787
3%	<i>Liatris pycnostachya</i>	Gayfeather	1 gal.	14" o.c.	337
2%	<i>Penstemon cobaea</i>	Prairie Penstemon	1 gal.	14" o.c.	225
3%	<i>Rudbeckia triloba</i>	Brown Eyed Susan	1 gal.	14" o.c.	337
5%	<i>Tridens flavus</i>	Purpletop	1 gal.	14" o.c.	562
6%	<i>Andropogon virginicus</i>	Broomsedge Bluestem	Plug	12" o.c.	950
3%	<i>Carex muhlenbergii</i>	Muhlenberg's Sedge	Plug	12" o.c.	500
8%	<i>Elymus virginicus</i>	Virginia Wildrye	Plug	12" o.c.	1250
3%	<i>Silphium terabanthinaceum</i>	Prairie Dock	Plug	12" o.c.	500
10%	<i>Sorghastrum nutans</i>	Indiangrass	Plug	12" o.c.	1550
12%	<i>Schizachyrium scoparium</i> 'Carouse'	Little Bluestem	Plug	14" o.c.	1350
13%	<i>Schizachyrium scoparium</i> 'Standing Ovation'	Little Bluestem	Plug	14" o.c.	1500
3%	<i>Sporobolus heterolepis</i>	Prairie Dropseed	Plug	14" o.c.	350
5%	<i>Anisida purpurea</i>	Purple Threeseam	Plug	12" o.c.	800
100%					12910
SEED - 100%					TOTAL QTY (LBS)
4%	<i>Andropogon virginicus</i>	Broomsedge Bluestem	SEEDING RATE (LBS/ACRE)		
1%	<i>Eutrochium dubium</i> 'Little Joe'	Joe Pye Weed			
1%	<i>Solidago petiolaris</i>	Downy Goldenrod			
1%	<i>Aster oblongifolius</i>	Late Aster			
2%	<i>Asclepias viridis</i>	Green Milkweed			
7%	<i>Bouteloua gracilis</i> 'Blond Ambition'	Blue Grama			
3%	<i>Callitriche ovulata</i>	Winecup			
4%	<i>Carex bicknellii</i>	Prairie Sedge			
1%	<i>Centaurea americana</i>	American Basketflower			
1%	<i>Delphinium carolinianum</i> ssp. <i>virescens</i>	Carolina Larkspur			
1%	<i>Dalea purpurea</i> var. <i>purpurea</i>	Purple Prairie Clover			
1%	<i>Careopsis lanceolata</i>	Lanceleaf Coreopsis			
3%	<i>Monarda fistulosa</i>	Wild Bergamont			
2%	<i>Echinacea purpurea</i>	Purple Coneflower			
2%	<i>Echscholzia californica</i>	California poppy			
4%	<i>Eryngium yuccifolium</i>	Rattlesnake Master			
5%	<i>Elymus virginicus</i>	Virginia Wildrye			
4%	<i>Eragrostis intermedia</i>	Plains Lovegrass			
2%	<i>Ipomopsis rubra</i>	Standing Cypress			
3%	<i>Liatris pycnostachya</i>	Gayfeather			
2%	<i>Monarda citriodora</i>	Lemon Mint			
2%	<i>Monarda fistulosa</i>	Bee Balm			
1%	<i>Melica nitens</i>	Three-Flower Melic			
1%	<i>Penstemon digitalis</i>	Foxglove Beardtongue			
2%	<i>Penstemon cobaea</i>	Prairie Beardtongue			
1%	<i>Phlox drummondii</i>	Drummond Phlox			
4%	<i>Pycnanthemum albescens</i>	White Mountain Mint			
3%	<i>Polytaenia nuttallii</i>	Prairie Parsley			
1%	<i>Salvia farinacea</i>	Mealy Blue Sage			
4%	<i>Sorghastrum nutans</i>	Indiangrass			
11%	<i>Schizachyrium scoparium</i> 'Carouse'	Little Bluestem			
12%	<i>Schizachyrium scoparium</i> 'Standing Ovation'	Little Bluestem			
1%	<i>Oligoneuron rigidum</i> var. <i>rigidum</i>	Stiff Goldenrod			
2%	<i>Tridens flavus</i>	Purpletop			
1%	<i>Verbena stricta</i>	Hoary Vervain			
100%					27.382

ROOF TOP SHORTGRASS MEADOW MIX (SG-2)					TOTAL AREA (SF)
TOTAL QTY (%)	LATIN NAME	COMMON NAME	SIZE	SPACING	29,854
CONTAINER & PLUGS - 60%					TOTAL QTY (#)
3%	<i>Amsonia hubrichtii</i>	Hubricht's Bluestar	2 gal.	18" o.c.	276
1%	<i>Yucca glauca</i>	Soap Weed Yucca	2 gal.	18" o.c.	92
3%	<i>Baptisia alba</i>	White Wild Indigo	2 gal.	14" o.c.	456
1%	<i>Muhlenbergia capitaris</i>	Pink Muhly Grass	1 gal.	14" o.c.	152
1%	<i>Kniphofia ensifolia</i>	Torch Lily	1 gal.	14" o.c.	152
1%	<i>Kniphofia caulescens</i>	Red Hot Poker	1 gal.	14" o.c.	152
1%	<i>Kniphofia uvaria</i> 'Glowstick'	Red Hot Poker 'Glowstick'	1 gal.	14" o.c.	152
1%	<i>Kniphofia hybrid</i> x <i>Pyramania</i> 'Hot and Cold'	Red Hot Poker 'Hot and Cold'	1 gal.	14" o.c.	152
3%	<i>Sanguisorba officinalis</i> 'Tanna'	Great Burnet 'Tanna'	1 gal.	14" o.c.	456
4%	<i>Achillea millefolium</i>	Yarrow	1 gal.	14" o.c.	608
2%	<i>Allium cernuum</i>	Nodding Onion	1 gal.	14" o.c.	304
3%	<i>Anisida purpurea</i>	Purple Threeseam	1 gal.	14" o.c.	456
3%	<i>Asclepias asperula</i>	Antelope Horn Milkweed	1 gal.	14" o.c.	456
3%	<i>Bouteloua gracilis</i> 'Blond Ambition'	Blue Grama	1 gal.	14" o.c.	456
2%	<i>Careopsis lanceolata</i>	Lanceleaf Coreopsis	1 gal.	14" o.c.	304
3%	<i>Symphoricarpos oolentangiense</i>	Late Aster	1 gal.	14" o.c.	456
6%	<i>Echinacea pallida</i>	Pale Coneflower	1 gal.	14" o.c.	912
5%	<i>Eryngium yuccifolium</i>	Rattlesnake Master	1 gal.	14" o.c.	760
5%	<i>Liatris pycnostachya</i>	Gayfeather	1 gal.	14" o.c.	760
4%	<i>Monarda punctata</i>	Spotted Beebalm	1 gal.	14" o.c.	608
3%	<i>Ratibida pinnata</i>	Gray-Headed Coneflower	1 gal.	14" o.c.	456
3%	<i>Solidago nemoralis</i>	Showy Goldenrod	1 gal.	14" o.c.	456
3%	<i>Thalictrum 'Elin'</i>	Elin Meadow Rue	1 gal.	14" o.c.	456
3%	<i>Verbena hastata</i>	Hoary Vervain	1 gal.	14" o.c.	456
6%	<i>Muhlenbergia capitaris</i>	Pink Muhly Grass	Plug	14" o.c.	950
5%	<i>Panicum virgatum</i> 'Shenandoah'	Switchgrass	Plug	14" o.c.	800
7%	<i>Schizachyrium scoparium</i> 'Carouse'	Little Bluestem	Plug	14" o.c.	1100
7%	<i>Schizachyrium scoparium</i> 'Standing Ovation'	Little Bluestem	Plug	14" o.c.	1100
8%	<i>Sporobolus heterolepis</i> 'Tara'	Tara Prairie Dropseed	Plug	14" o.c.	1250
100%					15142
BULBS - 50 % OF CONTAINER AND PLUG AREA					TOTAL QTY (#)
30%	<i>Eremanus robustus</i>	Foxtail Lily	Bulb	16" o.c.	1750
30%	<i>Eremanus 'Cleopatra'</i>	Cleopatra Foxtail Lily	Bulb	16" o.c.	1750
40%	<i>Allium sphaerocephalon</i>	Drumstick Allium	Bulb	16" o.c.	2330
100%					5830
SEED - 100%					TOTAL QTY (LBS)
25%	<i>Bothriochloa lagurides</i>	Silver Bluestem	SEEDING RATE (LBS/2000 SF)		
20%	<i>Bouteloua gracilis</i> 'Blond Ambition'	Blue Grama			
10%	<i>Bouteloua gracilis</i>	Blue Grama			
10%	<i>Eragrostis trichodes</i>	Sand Lovegrass			
15%	<i>Schizachyrium scoparium</i> 'Carouse'	Little Bluestem			
15%	<i>Schizachyrium scoparium</i> 'Standing Ovation'	Little Bluestem			
5%	<i>Sorghastrum nutans</i>	Indiangrass			
100%					14.927

WOODLAND MIX - MATRIX INFILL (WM-1)					TOTAL AREA (SF)
TOTAL QTY (%)	LATIN NAME	COMMON NAME	SIZE	SPACING	59,862
CONTAINER & PLUGS - 100%					TOTAL QTY (#)
4%	<i>Amsonia tabernaemontana</i>	Threadleaf Bluestar	2 gal.	18" o.c.	1229
6%	<i>Aster divaricatus</i>	White Wood Aster	1 gal.	18" o.c.	1843
3%	<i>Achillea millefolium</i>	Yarrow	1 gal.	18" o.c.	922
8%	<i>Diarrhena obovata</i>	American Beak Grass	1 gal.	18" o.c.	2458
4%	<i>Monarda fistulosa</i>	Wild Bergamont	1 gal.	18" o.c.	1229
4%	<i>Geranium macrorrhizum</i> 'Bevan's Variety'	Bigroot Geranium	1 gal.	18" o.c.	1229
4%	<i>Mertensia virginica</i>	Virginia Bluebells	1 gal.	18" o.c.	1229
12%	<i>Athyrium filix-femina</i> 'Lady In Red'	Lady In Red Fern	1 gal.	18" o.c.	3687
5%	<i>White Trillium</i>	White Trillium	1 gal.	18" o.c.	1536
5%	<i>Polystichum acrostichoides</i>	Christmas Fern	1 gal.	18" o.c.	1536
5%	<i>Thalictrum thalictroides</i>	Rue Anemone	1 gal.	18" o.c.	1536
4%	<i>Syrinchium angustifolium</i>	Blue-Eyed Grass	1 gal.	18" o.c.	1229
3%	<i>Galium odoratum</i>	Sweet Woodruff	Plug	14" o.c.	1550
4%	<i>Elymus hirtus</i>	Bottlebrush Grass	Plug	14" o.c.	2050
10%	<i>Carex bicknellii</i>	Bicknell's Sedge	Plug	14" o.c.	5100
10%	<i>Carex brevior</i>	Shortbeak Sedge	Plug	14" o.c.	5100
5%	<i>Chasmanthium latifolium</i>	Northern Sea Oat	Plug	14" o.c.	2550
4%	<i>Penstemon digitalis</i>	Foxglove Beardtongue	Plug	14" o.c.	2050
100%					38062

WOODLAND MIX - SEED (WM-1)					TOTAL AREA (SF)
TOTAL QTY (%)	LATIN NAME	COMMON NAME	SIZE	SPACING	59,862
SEED - 100%					TOTAL QTY (LBS)
2%	<i>Allium tricoccum</i>	Wild Leek	SEEDING RATE (LBS/ACRE)		
2%	<i>Anemone virginiana</i>	Tall Thimbleweed			
4%	<i>Polemonium reptans</i>	Jacob's Ladder			
4%	<i>Arisaema triphyllum</i>	Jack-in-the-Pulpit			
5%	<i>Asarum canadense</i>	Wild Ginger			
4%	<i>Asclepias exaltata</i>	Poke Milkweed			
4%	<i>Campanula americana</i>	Tall Bellflower			
4%	<i>Carex blanda</i>	Common Wood Sedge			
4%	<i>Carex grayi</i>	Common Bur Sedge			
4%	<i>Chasmanthium latifolium</i>	Inland Sea Oats			
10%	<i>Diarrhena obovata</i>	Beak Grass			
4%	<i>Elymus hirtus</i>	Bottlebrush Grass			
10%	<i>Elymus virginicus</i>	Virginia Wildrye			
3%	<i>Hydrophyllum virginianum</i>	Virginia Waterleaf			
4%	<i>Maianthemum racemosum</i>	Solomon's Plume			
4%	<i>Mitella diphylla</i>	Bishop's Cap			
4%	<i>Penstemon calycosus</i>	Calico Beardtongue			
4%	<i>Sanguinaria canadensis</i>	Bloodroot			
6%	<i>Solidago flexicaulis</i>	Zig Zag Goldenrod			
3%	<i>Actea racemosa</i>	Black Cohosh			
3%	<i>Mertensia virginica</i>	Virginia Bluebells			
4%	<i>Tenella integrifolia</i>	Yellow Pimpernel			
2%	<i>Thalictrum dioicum</i>	Early Meadow Rue			
2%	<i>Uvularia grandiflora</i>	Bellwort			
100%					41.227

WOODLAND MIX - FERN AND SEDGE GLADE (WM-2)					TOTAL AREA (SF)
TOTAL QTY (%)	LATIN NAME	COMMON NAME	SIZE	SPACING	51,210
CONTAINER & PLUGS - 100%					TOTAL QTY (#)
5%	<i>Asclepias quadrifolia</i>	Fourleaf Milkweed	1 gal.	18" o.c.	1314
20%	<i>Athyrium filix-femina</i>	Lady Fern	1 gal.	18" o.c.	5256
10%	<i>Erythronium albidum</i>	White Trout-Lily	1 gal.	18" o.c.	2628
5%	<i>Conoclinium coelestinum</i>	Blue Mistflower	1 gal.	18" o.c.	1314
3%	<i>Actea racemosa</i>	Black Cohosh	1 gal.	18" o.c.	788
2%	<i>Mertensia virginica</i>	Virginia Bluebells	1 gal.	18" o.c.	526
20%	<i>Polystichum acrostichoides</i>	Christmas Fern	1 gal.	18" o.c.	5256
20%	<i>Athyrium filix-femina</i> 'Lady in Red'	Lady In Red Fern	1 gal.	18" o.c.	5256
15%	<i>Carex bicknellii</i>	Bicknell's Sedge	Plug	14" o.c.	6550
100%					28889

WETLAND MIX					TOTAL AREA (SF)
TOTAL QTY (%)	LATIN NAME	COMMON NAME	SIZE	SPACING	13,463
WET BANK - 62% (WL-1)					TOTAL QTY (#)
8%	<i>Lobelia siphilitica</i>	Great Blue Lobelia	2 gal.	12" o.c.	784
5%	<i>Filipendula rubra</i>	Queen of the Prairie	2 gal.	16" o.c.	275
40%	<i>Andropogon gerardii</i>	Bushy Bluestem	1 gal.	12" o.c.	3918
7%	<i>Asclepias incarnata</i>	Swamp Milkweed	1 gal.	12" o.c.	686
2%	<i>Asclepias perennis</i>	Aquatic Milkweed	1 gal.	12" o.c.	196
3%	<i>Carex emoryi</i>	Emory's Sedge	1 gal.	12" o.c.	294
3%	<i>Carex stipata</i>	Awl-Fruited Sedge	1 gal.	12" o.c.	294
2%	<i>Chelone glabra</i>	White Turtlehead	1 gal.	12" o.c.	196
3%	<i>Helenium autumnale</i>	Swamp Sunflower	1 gal.	16" o.c.	294
2%	<i>Lythrum alatum</i>	Winged Lythrum	1 gal.	12" o.c.	196
10%	<i>Osmunda regalis</i>	Royal Fern	1 gal.	12" o.c.	979
3%	<i>Penstemon digitalis</i>	Foxglove Beardtongue	1 gal.	12" o.c.	294
4%	<i>Rhynchospora colorata</i>	Starrush Whitetop	1 gal.	12" o.c.	392
2%	<i>Silphium terabanthinaceum</i>	Rosinweed	1 gal.	16" o.c.	110
3%	<i>Solidago patula</i>	Roundleaf Goldenrod	1 gal.	12" o.c.	294
3%	<i>Verbena hastata</i>	Swamp Verbena	1 gal.	12" o.c.	294
100%					9494
EMERGENT-SUBMERGENT - 38% (WL-2)					TOTAL QTY (#)
7%	<i>Allisma subcordatum</i>	American Water Plantain	1 gal.	12" o.c.	403
7%	<i>Hibiscus lasiocarpus</i>	Woolly Rose Mallow	2 gal.	16" o.c.	226
7%	<i>Hibiscus moscheutos</i>	Crimson-Eyed Rose-Mallow	2 gal.	16" o.c.	226
4%	<i>Iris virginica</i>	Virginia Iris	1 gal.	12" o.c.	230
8%	<i>Scirpus cyperinus</i>	Wool-Grass Bulrush	1 gal.	12" o.c.	460
10%	<i>Justicia americana</i>	Water Willow	Quart	12" o.c.	575
4%	<i>Nelumbo lutea</i>	American Water Lily	Quart	12" o.c	

FLOWERING LAWN ISLAND MIX (FL-1)- SUN						TOTAL AREA (SF)
TOTAL QTY (%)	LATIN NAME	COMMON NAME	SIZE	SPACING		11,359
CONTAINERS & PLUGS - 100%						TOTAL QTY (#)
5%	<i>Amsonia hubrichtii</i>	Hubricht's Bluestar	3 gal.	18" o.c.		291
9%	<i>Acanthus mollis 'Rue Ledan'</i>	Acanthus Rue Ledan	3 gal.	18" o.c.		525
11%	<i>Actea racemosa</i>	Black Cohosh	2 gal.	18" o.c.		641
11%	<i>Sporobolus heterolepis 'Tara'</i>	Prairie Dropseed	2 gal.	18" o.c.		641
8%	<i>Platycodon grandiflorus</i>	Ballon Flower	1 gal.	18" o.c.		466
12%	<i>Penstemon digitalis</i>	Foxglove Beardtongue	1 gal.	18" o.c.		700
12%	<i>Aster divaricatus</i>	White Wood Aster	1 gal.	18" o.c.		700
7%	<i>Allium cernuum</i>	Nodding Onion	1 gal.	18" o.c.		408
7%	<i>Liatris pycnostachya</i>	Gayfeather	1 gal.	18" o.c.		408
7%	<i>Hebeborus x hybridus 'Honeymoon New York Night'</i>	Black Lenten Rose	1 gal.	18" o.c.		408
11%	<i>Carex albicans</i>	Whitetinged sedge	Plug	8" o.c.		3250
100%						8438
BULBS- 60% TOTAL SF						TOTAL QTY (#)
33%	<i>Fritillaria meleagris</i>	Snake's Head Fritillary	Bulb	12" o.c.		2630
17%	<i>Galanthus</i>	Snowdrop	Bulb	12" o.c.		1340
50%	<i>Narcissus 'actaea'</i>	Pheasant's Eye Narcissus	Bulb	12" o.c.		3940
100%						7910

FLOWERING LAWN ISLAND MIX (FL-2)- SHADE						TOTAL AREA (SF)
TOTAL QTY (%)	LATIN NAME	COMMON NAME	SIZE	SPACING		11,615
CONTAINERS & PLUGS - 100%						TOTAL QTY (#)
7%	<i>Acanthus mollis 'Rue Ledan'</i>	Acanthus Rue Ledan	3 gal.	18" o.c.		417
10%	<i>Amsonia hubrichtii</i>	Hubricht's Bluestar	3 gal.	18" o.c.		596
20%	<i>Sarcococca hookeriana v humilis</i>	Sweetbox	3 gal.	18" o.c.		1192
7%	<i>Actea racemosa</i>	Black Cohosh	2 gal.	18" o.c.		417
7%	<i>Athyrium filix-femina</i>	Lady Fern	1 gal.	18" o.c.		417
4%	<i>Erythronium albidum</i>	White Trout-Lily	1 gal.	18" o.c.		238
4%	<i>Thalictrum thalictroides</i>	Rue Anemone	1 gal.	18" o.c.		238
10%	<i>Polystichum acrostichoides</i>	Christmas Fern	1 gal.	18" o.c.		596
4%	<i>Conoclinium coelestinum</i>	Blue Mistflower	1 gal.	18" o.c.		238
4%	<i>Polemonium reptans</i>	Jacob's Ladder	1 gal.	18" o.c.		238
2%	<i>Aster divaricatus</i>	White Wood Aster	1 gal.	18" o.c.		119
8%	<i>Hebeborus x hybridus 'Honeymoon New York Night'</i>	Black Lenten Rose	1 gal.	18" o.c.		477
5%	<i>White Trillium</i>	White Trillium	1 gal.	18" o.c.		298
6%	<i>Eutrochium dubium 'Little Joe'</i>	Joe Pye Weed	1 gal.	18" o.c.		358
2%	<i>Galium odoratum</i>	Sweet Woodruff	Plug	8" o.c.		650
100%						6492
BULBS- 60% TOTAL SF						TOTAL QTY (#)
33%	<i>Galanthus</i>	Snowdrop	Bulb	12" o.c.		2690
33%	<i>Narcissus 'actaea'</i>	Pheasant's Eye Narcissus	Bulb	12" o.c.		2690
33%	<i>Fritillaria meleagris</i>	Snake's Head Fritillary	Bulb	12" o.c.		2690
100%						8070

L3 TERRACE PLANTING MIX (PM)						TOTAL AREA (SF)
TOTAL QTY (%)	LATIN NAME	COMMON NAME	SIZE	SPACING		106
CONTAINERS & PLUGS - 100%						TOTAL QTY (#)
10%	<i>Achillea millefolium 'Moonbeam'</i>	Moonbeam Yarrow	1 gal.	14" o.c.		9
5%	<i>Juniperus squamata 'Blue Star'</i>	Blue Star Creeping Juniper	1 gal.	24" o.c.		2
25%	<i>Geum triflorum</i>	Prairie Smoke	1 gal.	14" o.c.		22
10%	<i>Allium cernuum</i>	Nodding Onion	Quart	12" o.c.		12
15%	<i>Amsonia 'Blue Ice'</i>	Blue Ice Bluestar	Quart	14" o.c.		13
10%	<i>Aster ericoides 'Snow Flurry'</i>	Snow Flurry Heath Aster	Quart	12" o.c.		12
20%	<i>Coreopsis verticillata 'Moonbeam'</i>	Moonbeam Tickseed	Quart	12" o.c.		24
5%	<i>Dichondra argentatae</i>	Silver Ponyfoot	Quart	12" o.c.		6
100%						102
BULBS- 60% TOTAL SF						TOTAL QTY (#)
60%	<i>Allium christophii</i>	Star of Persia	Bulb	8" o.c.		100
40%	<i>Leucojum aestivum</i>	Snowflake	Bulb	8" o.c.		70
100%						170

WOODLAND SEDGE CLEARING MIX (WM-3)						TOTAL AREA (SF)
TOTAL QTY (%)	LATIN NAME	COMMON NAME	SIZE	SPACING		34,748
CONTAINERS & PLUGS - 100%						TOTAL QTY (#)
100%	<i>Carex pensylvanica</i>	Pennsylvania Sedge	Quart	12" o.c.		40124
100%						40124
SEED - 100%						TOTAL QTY (LBS)
100%	<i>Carex pensylvanica</i>	Pennsylvania Sedge	Install Seed Mix @ X 1 LB/2000 SF			17.37
100%						17.37

Planting Notes

- Plant quantities are provided as a courtesy only. The contractor is responsible for verifying all quantities.

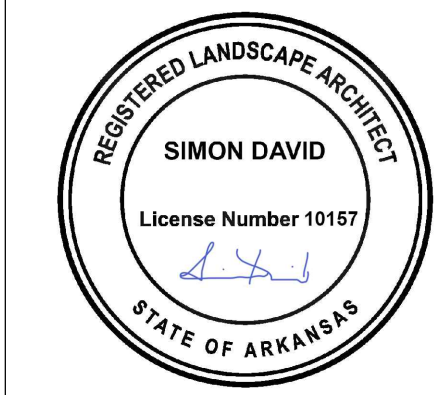

REVISIONS		
NUMBER	DATE	DESCRIPTION
1	03.13.2023	ADDendum
2	01.12.2024	ADDendum
3	06.26.2024	REVISED
4	07.24.2024	REVISED
5	08.26.2024	REVISED
6	09.26.2024	REVISED
7	10.04.2024	REVISED

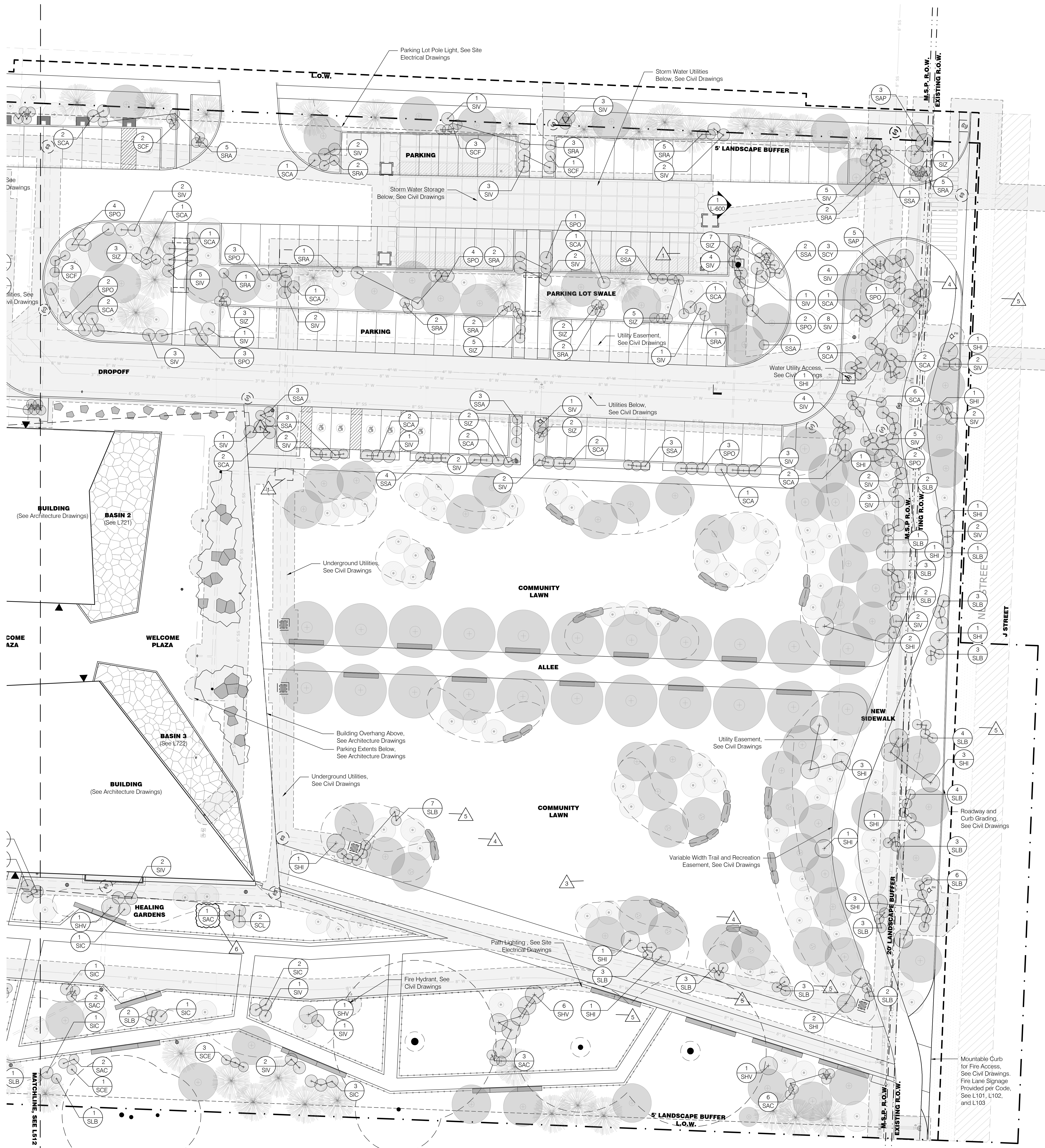

- General Legend**
- Existing Tree to Remain
 - Property Line
 - Limit of Work
 - Right of Way
 - Building Entry
 - Light Poles, See Site Electrical Drawings
 - Wall Mounted Lights, See Site Electrical Drawings
 - Bollard Lights, See Site Electrical Drawings
 - Tree Uplights, See Site Electrical Drawings
 - Charging Pedestal, See Site Electrical Drawings
 - Wireless Access Pole, See Site Electrical Drawings
 - GFCI Receptacle, See Site Electrical Drawings
 - Storm Water Catch Basin, See Civil Drawings
 - Sanitary Manhole, See Civil Drawings
 - Water Utility Access, See Civil Drawings
 - Fire Hydrant, See Civil Drawings
 - Gas Utility Access, See Civil Drawings
 - Pond Overflow Access, See Civil Drawings
 - Landscape Area Drain Inlet, See Civil Drawings
 - Landscape Underdrain, See Civil Drawings
 - Roof Drain, See Architecture Drawings
- Shrub ID Legend**
- | | | |
|--|--|--|
| # SAP <i>Aesculus pavia</i> | # SCL <i>Cotinus 'Little Lady'</i> | # SLB <i>Lindera benzoin</i> |
| # SAC <i>Amorpha canescens</i> | # SCE <i>Corylus americana</i> | # SPO <i>Physocarpus opulifolius</i> |
| # SCA <i>Callicarpa americana</i> | # SHV <i>Hamelis vernalis</i> | # SRA <i>Rhus aromatica var. aromatica</i> |
| # SCF <i>Gaylussacia floridis</i> | # SHI <i>Hamelis x intermedia 'Jelena'</i> | # SYA <i>Yucca glauca</i> |
| # SCO <i>Cephalanthus occidentalis</i> | # SHO <i>Hydrangea quercifolia</i> | # SYA <i>Yucca glauca</i> |
| # SCV <i>Chionanthus virginicus</i> | # SIV <i>Ilex vomitoria</i> | |
| # SCB <i>Cornus 'bailey'</i> | # SIZ <i>Itea virginica</i> | |

1 Shrub Planting Plan - Ground Floor 3
Scale: 1/16" = 1'-0"

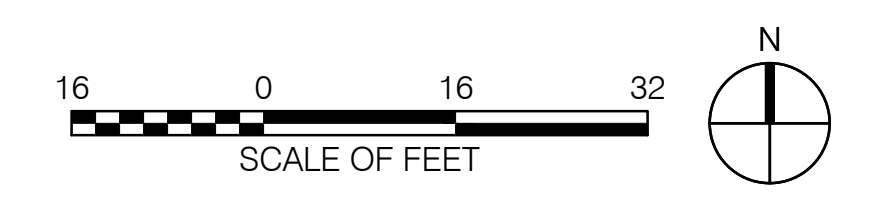

PSW Job Number:
933A



AWSOM
Bentonville, AR

Issue Date:
03.13.2023

REVISIONS		
NUMBER	DATE	DESCRIPTION
1	03.13.2023	ADDITIONAL
2	06.09.2023	ADDITIONAL
3	07.24.2024	AS BUILT
4	07.24.2024	PR 059
5	08.20.2024	PR 059
6	10.04.2024	PR 060

Contents:
Shrub Planting Plan -
Ground Floor 3/3

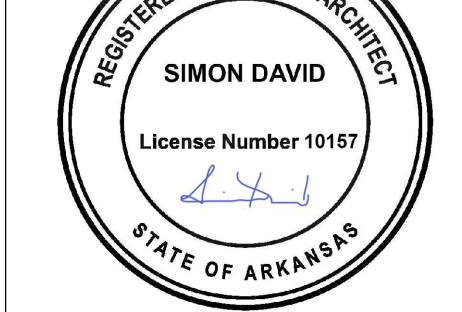

REVISIONS		
NUMBER	DATE	DESCRIPTION
1	03.13.2023	ISSUED FOR PERMIT
2	04.05.2023	ADDITIONAL 2'
3	04.20.2024	AS NOTED
4	05.06.2024	PR 008
5	05.20.2024	PR 009
6	05.24.2024	PR 009

Shrub ID Legend

# SAP	Aesculus pavia
# SIZ	Itea virginica
# SOH	Opuntia humifusa
# SPM	Pinus mugo Stowmound
# SRA	Rhus aromatica var. aromatica
# SRC	Rhus copallinum
# SFX	Rosa carolina
# SYA	Yucca glauca
# SHP	Hesperaloe parviflora

General Legend

—	Property Line
-L.O.W.	Limit of Work
-R.O.W.	Right of Way
▲	Building Entry
⊕	Landscape Area Drain Inlet. See Civil Drawings
TD	Trench Drain
SD	Slot Drain
⊖	Roof Drain. See Architecture Drawings
⊙	Light Poles. See Site Electrical Drawings
⊛	Bollard Lights. See Site Electrical Drawings
⊠	Tree Uplights. See Site Electrical Drawings
⊞	Charging Pedestal. See Site Electrical Drawings
⊟	Wireless Access Pole. See Site Electrical Drawings
⊠	GFCI Receptacle. See Site Electrical Drawings

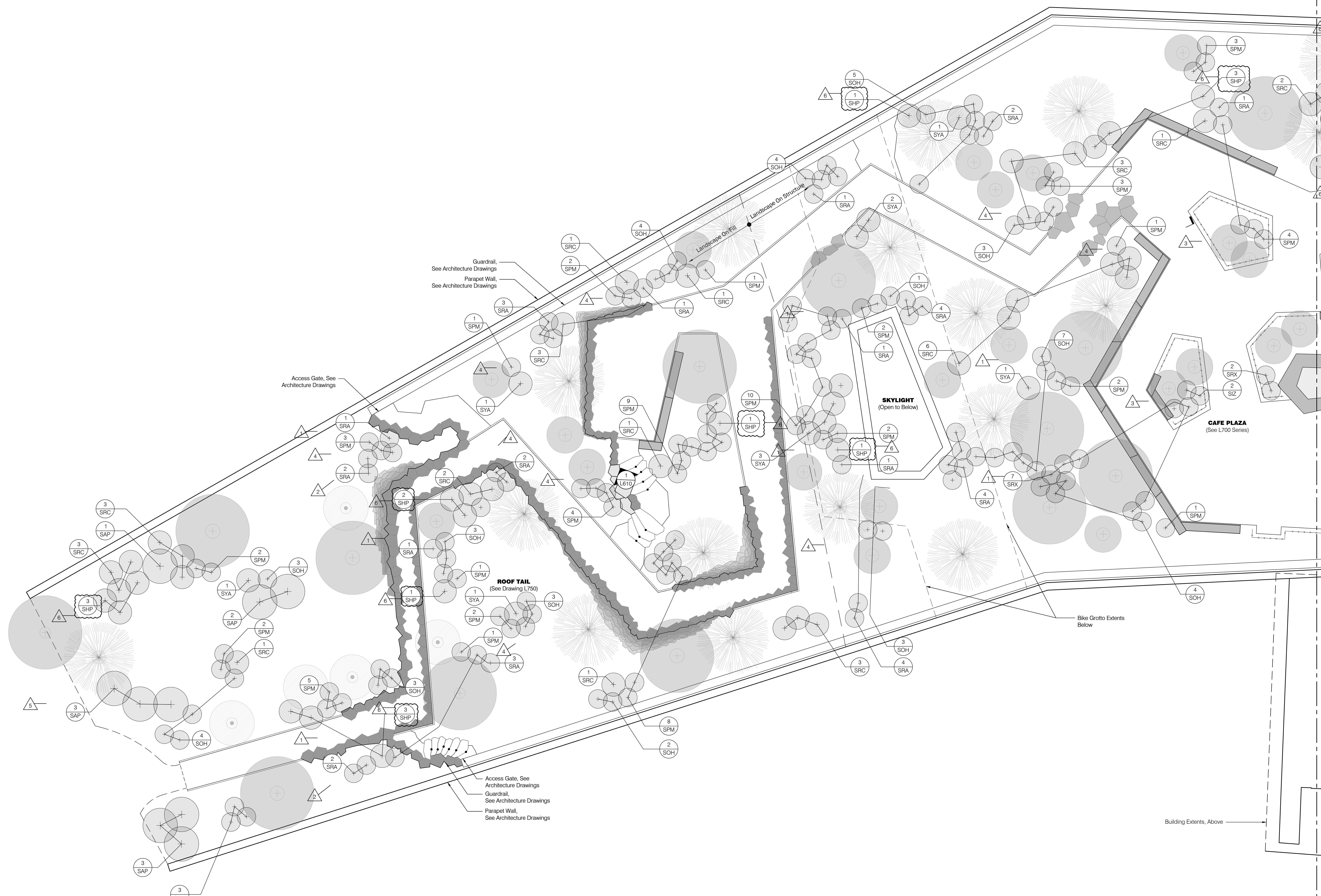

1 Shrub Planting Plan - Roof 1
Scale: 1/8"=1'-0"

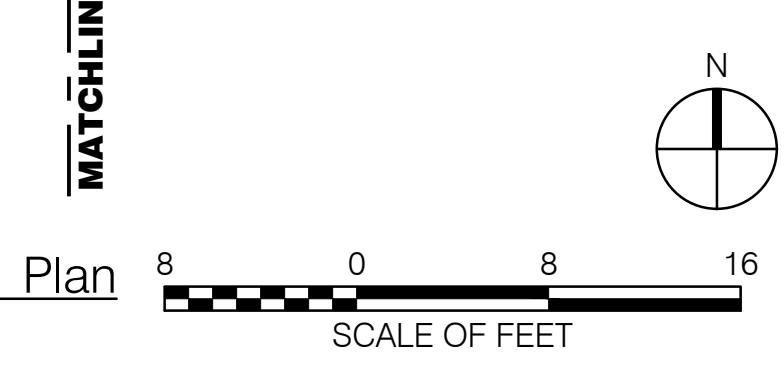



REVISIONS		
NUMBER	DATE	DESCRIPTION
1	03.13.2023	ASSEMBLY
2	06.09.2023	ADDITIONAL 2
3	06.09.2024	PR 000
4	10.04.2024	PR 000

Shrub ID Legend

- # SAP Aesculus pavia
- # SIZ Ilex virginica
- # SOH Opuntia humifusa
- # SPM Pinus mugo
Stowmound
- # SRA Rhus aromatica var.
aromatica
- # SRC Rhus copallinum
- # SRX Rosa carolina
- # SYA Yucca glauca
- # SHP Hesperaloe parviflora

General Legend

- Property Line
- L.O.W. Limit of Work
- R.O.W. Right of Way
- ▲ Building Entry
- ⊕ Landscape Area Drain Inlet, See Civil Drawings
- TD Trench Drain
- SD Slot Drain
- Roof Drain, See Architecture Drawings
- Light Poles, See Site Electrical Drawings
- Bollard Lights, See Site Electrical Drawings
- Tree Uplights, See Site Electrical Drawings
- Charging Pedestal, See Site Electrical Drawings
- Wireless Access Pole, See Site Electrical Drawings
- GFCI Receptacle, See Site Electrical Drawings

