

## RFI detail

## #335 CABLE TRAY OVER HARD LID CEILING



Status	<b>Closed</b>
Created on	Apr 8, 2024 by <b>Brady Gaudette</b> (Crossland Construction Company)
RFI type	Default RFI workflow
Ball in court	<b>Brady Gaudette</b> (Crossland Construction Company)
Answered	Apr 15, 2024 by <b>Anne Worley</b> (Polk Stanley Wilcox Architects)

### Question

The highlighted areas in the attached drawings are where there is open air cable tray above a hard lid ceiling. We are recognizing that these areas will be inaccessible without multiple access panels. There are already 2 access panels in this ceiling to access HVAC equipment. There is the opportunity to change from cable tray to (4) 4" EMT conduits at these locations, however, there is a cost impact (ROM attached). Please consider this alternative and advise Crossland if this would be desired by design team and Ownership.

### Official response

Anne Worley (Polk Stanley Wilcox Architects): Alternative is acceptable.

By **Anne Worley** (Polk Stanley Wilcox Architects) - Apr 15, 2024, 3:07 PM CDT

### References

#### Files (2)

- [ROM - CHANGE CABLE TRAY TO CONDUIT OVER HARD LID AREAS - PROPOSAL COMBINED.pdf](#)
- [#335 - CABLE TRAY OVER HARD LID CEILING\\_HEI.pdf](#)

#### Sheets (2)

- [TN203A](#)
- [TN201B](#)

### Impact

Cost impact Yes

Schedule impact -

## Other attributes

Priority Normal

Discipline -

Category -

Location -

Location details -

External id -

Co-reviewer(s)

Activities	By	At
<b>Brady Gaudette</b> changed the status from <span style="color: orange;">■</span> <b>Open</b> Answered to <span style="color: gray;">■</span> <b>Closed</b> <b>Official response:</b> Anne Worley (Polk Stanley Wilcox Architects): Alternative is acceptable.	<b>Brady Gaudette</b>	Apr 15, 2024, 3:07 PM CDT
<b>Anne Worley</b> changed the status from <span style="color: orange;">■</span> <b>Open</b> In Review to <span style="color: orange;">■</span> <b>Open</b> Answered set Ball in court to <b>Brady Gaudette</b> (Crossland Construction Company)	<b>Anne Worley</b>	Apr 15, 2024, 3:01 PM CDT
<b>Anne Worley</b> added a response: Alternative is acceptable.	<b>Anne Worley</b>	Apr 15, 2024, 3:01 PM CDT
<b>Anne Worley</b> added a reference to a file <b>#335 - CABLE TRAY OVER HARD LID CEILING_HEI.pdf</b>	<b>Anne Worley</b>	Apr 15, 2024, 3:01 PM CDT
<b>Brady Gaudette</b> added a reference to a sheet <b>TN203A</b>	<b>Brady Gaudette</b>	Apr 8, 2024, 9:31 AM CDT
<b>Brady Gaudette</b> added a reference to a sheet <b>TN201B</b>	<b>Brady Gaudette</b>	Apr 8, 2024, 9:31 AM CDT
<b>Brady Gaudette</b> added a reference to a file <b>ROM - CHANGE CABLE TRAY TO CONDUIT OVER HARD LID AREAS - PROPOSAL COMBINED.pdf</b>	<b>Brady Gaudette</b>	Apr 8, 2024, 9:31 AM CDT
<b>Brady Gaudette</b> (Crossland Construction Company) created this RFI in <span style="color: orange;">■</span> <b>Open</b> In Review status and set Ball in court to <b>Anne Worley</b> (Polk Stanley Wilcox Architects).	<b>Brady Gaudette</b>	Apr 8, 2024, 9:31 AM CDT



April 5, 2024

Cori Wilson
Crossland Construction Company
1800 S. 52nd Street
Suite 410
Rogers, AR 72758

RE: AWSOM – ROM – Change Cable Tray to Conduit Over Hard Lid Areas

Cori,

Please see the pricing breakdown for changing cable tray to conduit over hard lid areas.

Table with 6 columns: Item, Quantity, Unit, Rate, Description, Total. Rows include Material (\$6,862.00), Switchgear (\$0.00), Labor (108 @ 70 Per Hour \$7,560.00), Sub Total (\$14,422.00), Overhead (@ 5% \$721.10), Profit (@ 5% \$721.10), Total (\$15,864.20), Bond (1% \$158.64), Total (\$16,022.84).

For further details please reference the attached unit pricing.

Inclusions:

- Delete approximately 100' of cable tray and associated hardware.
Install (4) 4" raceways over hard lid areas that previously showed cable tray.

Exclusions:

- All overtime work, pricing is based off working 40 hours per week, M-F, 7AM-3PM
All finish repair/replacement, i.e. paint, sheetrock, plywood, block, concrete, ceiling tiles, etc.

If you have any questions, please do not hesitate to call @ 479-770-5300.

Sincerely,

Alex Carlson

Estimator/Project Manager

Office: 479.770.5300

Cell: 417.291.5077

scarlson@beijoplin.com

Corporate:

P.O. Box 707
1716 Falcon Street
Webb City, MO 64870
Ph. (417) 624-6660
Fax (417) 624-6966
bei@beijoplin.com

Lowell Office:

P.O. Box 1395
313 S. Lincoln Street
Lowell, AR 72745
Ph. (479) 770-5300
Fax (479) 770-5301

Springfield Office:

732 N. Miller Ave.
Springfield, MO 65802
Ph. (417) 865-2455
Fax (417) 865-2425

Claremore Office:

9554 Alawhe Drive
Claremore, OK 74019
Ph. (918) 341-4414
Fax (918) 341-1414

**NOTES**

Item				Material		Labor	
Size	Item Desc	Qty	UOM	Mat Unit	Mat Ext	Labor	Lbr Ext
	TRAPEZE FOR CABLE TRAY	-15.00			0.0000		0.0000
4"	EMT	400.00	FEET	22.4268	8,970.7200	0.3200	128.0000
4"	EMT 90 ELBOW	8.00	EACH	95.7318	765.8544	0.4800	3.8400
4"	EMT STEEL SS CONN	8.00	EACH	39.0800	312.6400	0.5000	4.0000
4"	EMT STEEL SS COUP	56.00	EACH	28.4600	1,593.7600	0.4200	23.5200
4"	PLASTIC BUSHINGS	8.00	EACH	2.6000	20.8000	0.5000	4.0000
1/4.	BEAM CLAMP-STEEL	-30.00	EACH	2.1200	-63.6000	0.3000	-9.0000
1/4X1-1/2	FENDER WASHER	-60.00	EACH		0.0000	0.0020	-0.1200
1/4-20	HEX NUTS	-60.00	EACH	0.0274	-1.6440	0.0020	-0.1200
	CHANNEL 12GA 1-5/8" GAL	-30.00	FEET	6.2400	-187.2000	0.2400	-7.2000
4"	UNISTRUT STRAP	80.00	EACH	3.7600	300.8000	0.1000	8.0000
1/4.	ALL THREAD ROD	-240.00	FEET	0.6400	-153.6000	0.0400	-9.6000
	NYLON LINE	500.00	FEET	0.0160	8.0000	0.0020	1.0000
24"	GALV CABLE TRAY	-100.00	FEET	47.0400	-4,704.0000	0.3800	-38.0000
<b>Grand Totals</b>					<b>6,862.5304</b>		<b>108.3200</b>

**TECHNOLOGY PLAN NOTES:**  
 T11 PROVIDE 4" CONDUIT SLEEVES. PROVIDE UL FIRESTOP SYSTEM ASSEMBLY AS REQUIRED. SEE DIVISION 27 SPECIFICATIONS FOR ADDITIONAL INFORMATION.  
 T14 PROVIDE 3" 4" CONDUIT SLEEVES. PROVIDE UL FIRESTOP SYSTEM ASSEMBLY AS REQUIRED. SEE DIVISION 27 SPECIFICATIONS FOR ADDITIONAL INFORMATION.

CIVIL  
**McCalland Consulting Engineers, Inc.**  
 1380 E STEARNS ST  
 FAYETTEVILLE, AR 72703  
 P: 479.443.2377

LANDSCAPE  
**OSD**  
 115 ST. JOHNS PLACE  
 BROOKLYN, NY 11217  
 P: 917.553.5886

STRUCTURAL  
**Martin Martin Consulting Engineers**  
 808 SOUTH WALTON BLVD., STE. 77  
 BENTONVILLE, AR 72712  
 P: 479.489.9945

MEP - LOW VOLTAGE  
**Henderson Engineers**  
 8345 LEXA DRIVE, STE. 300  
 LENOXA, KS 66214  
 P: 913.660.8187

SUSTAINABILITY  
**SOM**  
 224 SOUTH MICHIGAN AVENUE  
 CHICAGO, IL 60604  
 P: 312.362.4121

SIGNAGE + WAYFINDING  
**TWO TWELVE**  
 236 W. 23RD ST., SUITE 802  
 NEW YORK, NY 10001  
 P: 212.254.8670

FOOD SERVICE  
**AME HOSPITALITY**  
 895 SIX PINES DR., SUITE 8210  
 THE WOODLANDS, TX 77380  
 P: 408.641.2222

WATER FEATURES  
**OTL**  
 2150 S. TOWNE CENTER, SUITE 100  
 ANAHEIM, CA 92806  
 P: 714.637.4747

IRRIGATION  
**WC3 DESIGN**  
 11A ROBINSON MANOR BLVD.  
 ROCKERS ROCK, PA 16155  
 P: 844.231.7042



ALL STRUCTURED AND LOW VOLTAGE CABLING ON THIS VIEW IS TO BE FED FROM DATA ROOM #1538.

① TECHNOLOGY - LEVEL 1 RCP - AREA B  
 1/8" = 1'-0"

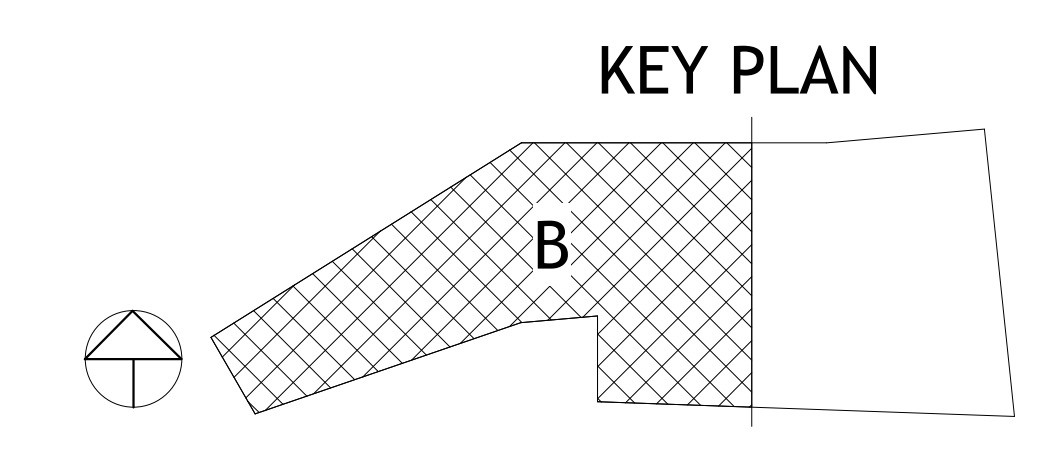

PSW Job Number:  
**993A**  
 Henderson Job Number:  
**2150002607**



03/10/2023  
**AWSOM**  
 Bentonville, AR

Issue Date:  
**02.24.2023**

REVISIONS		
NUMBER	DATE	DESCRIPTION
1	03/10/23	Issued for I

Contents:  
 TECHNOLOGY -  
 LEVEL 1 RCP -  
 AREA B

**TECHNOLOGY PLAN NOTES:**  
 T11 PROVIDE 4" CONDUIT SLEEVES. PROVIDE UL FIRESTOP SYSTEM ASSEMBLY AS REQUIRED. SEE DIVISION 27 SPECIFICATIONS FOR ADDITIONAL INFORMATION.  
 T14 PROVIDE (3) 4" CONDUIT SLEEVES. PROVIDE UL FIRESTOP SYSTEM ASSEMBLY AS REQUIRED. SEE DIVISION 27 SPECIFICATIONS FOR ADDITIONAL INFORMATION.

**POLK STANLEY WILCOX**  
 801 South Spring Street  
 Little Rock, AR 72201  
 501.378.0878 office  
 509 W. Spring St. | Suite 150  
 Fayetteville, AR 72701  
 479.444.0623 office  
 polkstanleywilcox.com

**CIVIL**  
 McCalland Consulting Engineers, Inc.  
 1586 E STEARNS ST  
 FAYETTEVILLE, AR 72703  
 P: 479.453.2377

**LANDSCAPE**  
 OSD  
 115 ST. JOHNS PLACE  
 BROOKLYN, NY 11217  
 P: 917.553.5886

**STRUCTURAL**  
 Martin Consulting Engineers  
 808 SOUTH WALTON BLVD., STE. 27  
 BENTONVILLE, AR 72712  
 P: 479.489.9945

**MEPF - LOW VOLTAGE**  
 Henderson Engineers  
 6346 LENSEA DRIVE, STE 300  
 LENOXA, MS 39214  
 P: 913.660.8187

**SUSTAINABILITY**  
 SOM  
 224 SOUTH MICHIGAN AVENUE  
 CHICAGO, IL 60604  
 P: 312.362.4121

**SIGNAGE - WAYFINDING**  
 TWO TWELVE  
 236 W. 23RD ST., SUITE 802  
 NEW YORK, NY 10001  
 P: 212.254.8670

**FOOD SERVICE**  
 JMC HOSPITALITY  
 895 SIX PINES DR., SUITE 8210  
 THE WOODLANDS, TX 77380  
 P: 684.41.2222

**WATER FEATURES**  
 OTL  
 2150 S. TOWNE CENTER, SUITE 100  
 ANAHEIM, CA 92806  
 P: 714.637.4747

**IRRIGATION**  
 WC3 DESIGN  
 11A ROBINSON MANOR BLVD.  
 MOORESBURG, PA 17042  
 P: 844.231.7042

PSW Job Number:  
**993A**  
 Henderson Job Number:  
**2150002607**

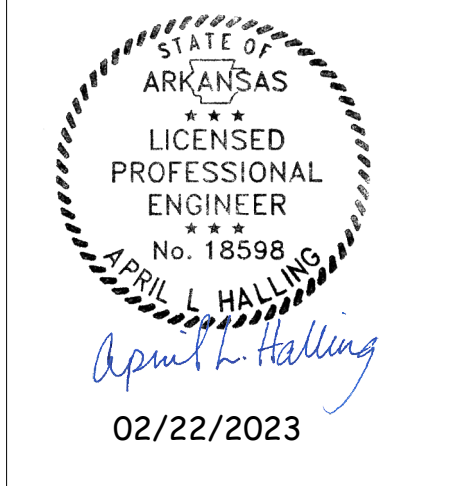

**AWSOM**  
 Bentonville, AR

Issue Date:  
**02.24.2023**

REVISIONS		
NUMBER	DATE	DESCRIPTION

Contents:  
**TECHNOLOGY - LEVEL 3 RCP - AREA A**

THIS PAGE IS BEST VIEWED IN COLOR  
**TN203A**



ALL STRUCTURED AND LOW VOLTAGE CABLING ON THIS SIDE OF LINE IS TO BE FED FROM DATA ROOM #3504.

ALL STRUCTURED AND LOW VOLTAGE CABLING ON THIS SIDE OF LINE IS TO BE FED FROM DATA ROOM #3316.

**TECHNOLOGY - LEVEL 3 RCP - AREA A**  
 1/8" = 1'-0"

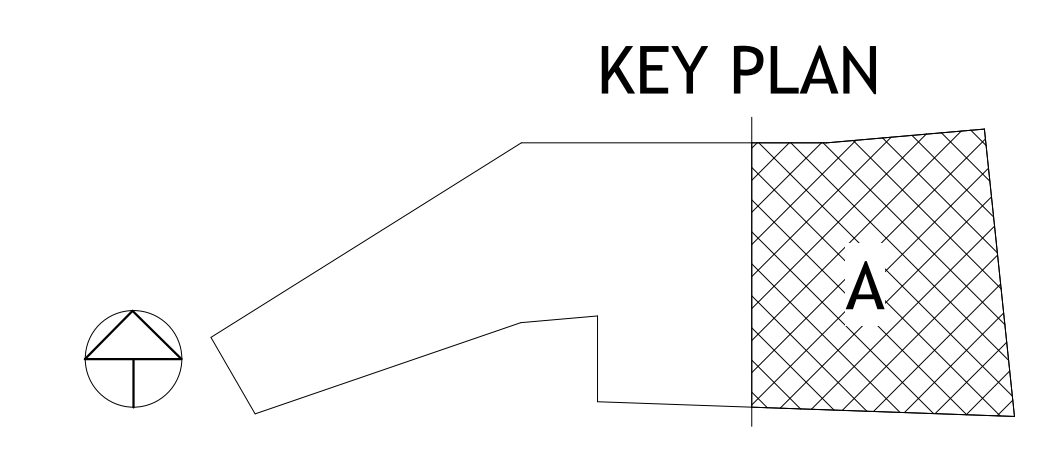

## REQUEST FOR INFORMATION RESPONSE

## RFIR NO 335

**PROJECT** 2150002607  
**PROJECT NO** AWSOM  
  
**DATE RECEIVED** 04/10/24  
**DATE RESPONDED** 04/12/2024  
  
**REVIEWER** JDC  
**ATTACHMENTS** N/A

	COMMENTS
<b>OVERVIEW</b>	<p>The highlighted areas in the attached drawings are where there is open air cable tray above a hard lid ceiling. We are recognizing that these areas will be inaccessible without multiple access panels. There are already 2 access panels in this ceiling to access HVAC equipment. There is the opportunity to change from cable tray to (4) 4" EMT conduits at these locations, however, there is a cost impact (ROM attached). Please consider this alternative and advise Crossland if this would be desired by design team and Ownership.</p>
<b>RESPONSE</b>	<p>Alternative is acceptable. Proceed with the proposed solution.</p>

## RFI detail

## #335 CABLE TRAY OVER HARD LID CEILING



Status	<span style="color: orange;"> </span> <b>Open</b> In Review
Created on	Apr 8, 2024 by <b>Brady Gaudette</b> (Crossland Construction Company)
RFI type	Default RFI workflow
Ball in court	<b>Anne Worley</b> (Polk Stanley Wilcox Architects)
Due date	Apr 15, 2024

### Question

The highlighted areas in the attached drawings are where there is open air cable tray above a hard lid ceiling. We are recognizing that these areas will be inaccessible without multiple access panels. There are already 2 access panels in this ceiling to access HVAC equipment. There is the opportunity to change from cable tray to (4) 4" EMT conduits at these locations, however, there is a cost impact (ROM attached). Please consider this alternative and advise Crossland if this would be desired by design team and Ownership.

### References

#### Files (1)

- [ROM - CHANGE CABLE TRAY TO CONDUIT OVER HARD LID AREAS - PROPOSAL COMBINED.pdf](#)

#### Sheets (2)

- TN203A
- TN201B

### Impact

Cost impact	Yes
Schedule impact	-

### Other attributes

Priority	Normal
----------	--------



<b>Discipline</b>	-
<b>Category</b>	-
<b>Location</b>	-
<b>Location details</b>	-
<b>External id</b>	-
<b>Co-reviewer(s)</b>	

<b>Activities</b>	<b>By</b>	<b>At</b>
<b>Brady Gaudette</b> added a reference to a sheet <b>TN203A</b>	<b>Brady Gaudette</b>	Apr 8, 2024, 9:31 AM CDT
<b>Brady Gaudette</b> added a reference to a sheet <b>TN201B</b>	<b>Brady Gaudette</b>	Apr 8, 2024, 9:31 AM CDT
<b>Brady Gaudette</b> added a reference to a file <b>ROM - CHANGE CABLE TRAY TO CONDUIT OVER HARD LID AREAS - PROPOSAL COMBINED.pdf</b>	<b>Brady Gaudette</b>	Apr 8, 2024, 9:31 AM CDT
<b>Brady Gaudette</b> (Crossland Construction Company) created this RFI in <b>Open</b> In Review status and set Ball in court to <b>Anne Worley</b> (Polk Stanley Wilcox Architects).	<b>Brady Gaudette</b>	Apr 8, 2024, 9:31 AM CDT



April 5, 2024

Cori Wilson
Crossland Construction Company
1800 S. 52nd Street
Suite 410
Rogers, AR 72758

RE: AWSOM – ROM – Change Cable Tray to Conduit Over Hard Lid Areas

Cori,

Please see the pricing breakdown for changing cable tray to conduit over hard lid areas.

Table with 6 columns: Item, Quantity, Unit, Rate, Description, Total. Rows include Material (\$6,862.00), Switchgear (\$0.00), Labor (108 @ 70 Per Hour \$7,560.00), Sub Total (\$14,422.00), Overhead (@ 5% \$721.10), Profit (@ 5% \$721.10), Total (\$15,864.20), Bond (1% \$158.64), Total (\$16,022.84).

For further details please reference the attached unit pricing.

Inclusions:

- Delete approximately 100' of cable tray and associated hardware.
Install (4) 4" raceways over hard lid areas that previously showed cable tray.

Exclusions:

- All overtime work, pricing is based off working 40 hours per week, M-F, 7AM-3PM
All finish repair/replacement, i.e. paint, sheetrock, plywood, block, concrete, ceiling tiles, etc.

If you have any questions, please do not hesitate to call @ 479-770-5300.

Sincerely,

Alex Carlson

Estimator/Project Manager

Office: 479.770.5300

Cell: 417.291.5077

scarlson@beijoplin.com

Corporate:

P.O. Box 707
1716 Falcon Street
Webb City, MO 64870
Ph. (417) 624-6660
Fax (417) 624-6966
bei@beijoplin.com

Lowell Office:

P.O. Box 1395
313 S. Lincoln Street
Lowell, AR 72745
Ph. (479) 770-5300
Fax (479) 770-5301

Springfield Office:

732 N. Miller Ave.
Springfield, MO 65802
Ph. (417) 865-2455
Fax (417) 865-2425

Claremore Office:

9554 Alawhe Drive
Claremore, OK 74019
Ph. (918) 341-4414
Fax (918) 341-1414

**NOTES**

Item				Material		Labor	
Size	Item Desc	Qty	UOM	Mat Unit	Mat Ext	Labor	Lbr Ext
	TRAPEZE FOR CABLE TRAY	-15.00			0.0000		0.0000
4"	EMT	400.00	FEET	22.4268	8,970.7200	0.3200	128.0000
4"	EMT 90 ELBOW	8.00	EACH	95.7318	765.8544	0.4800	3.8400
4"	EMT STEEL SS CONN	8.00	EACH	39.0800	312.6400	0.5000	4.0000
4"	EMT STEEL SS COUP	56.00	EACH	28.4600	1,593.7600	0.4200	23.5200
4"	PLASTIC BUSHINGS	8.00	EACH	2.6000	20.8000	0.5000	4.0000
1/4.	BEAM CLAMP-STEEL	-30.00	EACH	2.1200	-63.6000	0.3000	-9.0000
1/4X1-1/2	FENDER WASHER	-60.00	EACH		0.0000	0.0020	-0.1200
1/4-20	HEX NUTS	-60.00	EACH	0.0274	-1.6440	0.0020	-0.1200
	CHANNEL 12GA 1-5/8" GAL	-30.00	FEET	6.2400	-187.2000	0.2400	-7.2000
4"	UNISTRUT STRAP	80.00	EACH	3.7600	300.8000	0.1000	8.0000
1/4.	ALL THREAD ROD	-240.00	FEET	0.6400	-153.6000	0.0400	-9.6000
	NYLON LINE	500.00	FEET	0.0160	8.0000	0.0020	1.0000
24"	GALV CABLE TRAY	-100.00	FEET	47.0400	-4,704.0000	0.3800	-38.0000
<b>Grand Totals</b>					<b>6,862.5304</b>		<b>108.3200</b>

**TECHNOLOGY PLAN NOTES:**  
 T11 PROVIDE 4" CONDUIT SLEEVES. PROVIDE UL FIRESTOP SYSTEM ASSEMBLY AS REQUIRED. SEE DIVISION 27 SPECIFICATIONS FOR ADDITIONAL INFORMATION.  
 T14 PROVIDE 3" 4" CONDUIT SLEEVES. PROVIDE UL FIRESTOP SYSTEM ASSEMBLY AS REQUIRED. SEE DIVISION 27 SPECIFICATIONS FOR ADDITIONAL INFORMATION.

CIVIL  
**McCalland Consulting Engineers, Inc.**  
 1380 E STEARNS ST  
 FAYETTEVILLE, AR 72703  
 P: 479.443.2377

LANDSCAPE  
**OSD**  
 115 ST. JOHNS PLACE  
 BROOKLYN, NY 11217  
 P: 917.553.5886

STRUCTURAL  
**Martin Martin Consulting Engineers**  
 808 SOUTH WALTON BLVD., STE. 77  
 BENTONVILLE, AR 72712  
 P: 479.493.9945

MEP - LOW VOLTAGE  
**Henderson Engineers**  
 8345 LENEVA DRIVE, STE. 300  
 LENOXA, KS 66214  
 P: 913.660.8187

SUSTAINABILITY  
**SOM**  
 224 SOUTH MICHIGAN AVENUE  
 CHICAGO, IL 60604  
 P: 312.362.4121

SIGNAGE + WAYFINDING  
**TWO TWELVE**  
 236 W. 23RD ST., SUITE 802  
 NEW YORK, NY 10001  
 P: 212.254.8670

FOOD SERVICE  
**AME HOSPITALITY**  
 8956 SIX PINES DR., SUITE 8210  
 THE WOODLANDS, TX 77380  
 P: 408.641.2222

WATER FEATURES  
**OTL**  
 2150 S. TOWNE CENTER, SUITE 100  
 ANAHEIM, CA 92806  
 P: 714.637.4747

IRRIGATION  
**WC3 DESIGN**  
 11A ROBINSON MANOR BLVD.  
 ROCKERS ROCK, PA 16155  
 P: 844.231.7042



ALL STRUCTURED AND LOW VOLTAGE  
 CABLING ON THIS VIEW IS TO BE FED  
 FROM DATA ROOM #1530.

① TECHNOLOGY - LEVEL 1 RCP - AREA B  
 1/8" = 1'-0"

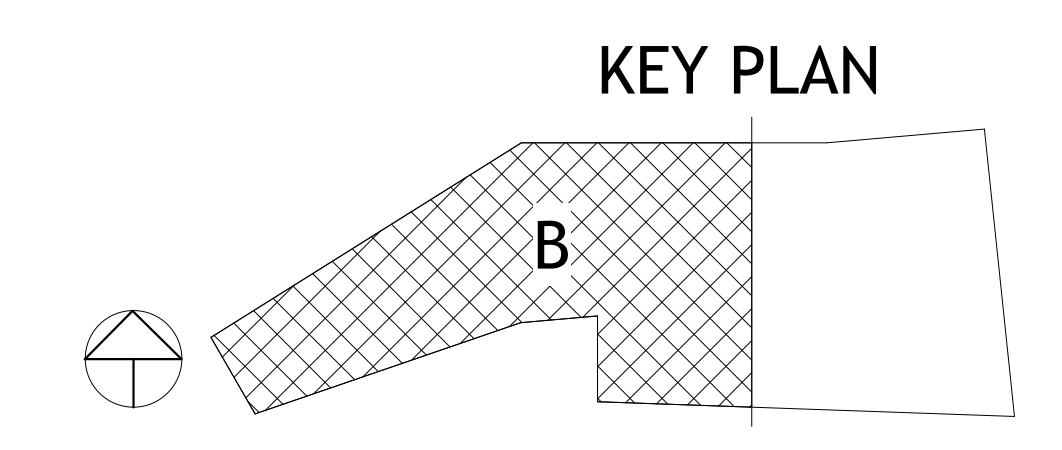

PSW Job Number:  
**993A**  
 Henderson Job Number:  
**2150002607**



03/10/2023  
**AWSOM**  
 Bentonville, AR

Issue Date:  
**02.24.2023**

REVISIONS		
NUMBER	DATE	DESCRIPTION
1	03/10/23	Issued for I

Contents:  
 TECHNOLOGY -  
 LEVEL 1 RCP -  
 AREA B

**TECHNOLOGY PLAN NOTES:**  
T11 PROVIDE 1/2" CONDUIT SLEEVES. PROVIDE UL FIRESTOP SYSTEM ASSEMBLY AS REQUIRED. SEE DIVISION 27 SPECIFICATIONS FOR ADDITIONAL INFORMATION.  
T14 PROVIDE 3/4" CONDUIT SLEEVES. PROVIDE UL FIRESTOP SYSTEM ASSEMBLY AS REQUIRED. SEE DIVISION 27 SPECIFICATIONS FOR ADDITIONAL INFORMATION.



ALL STRUCTURED AND LOW VOLTAGE CABLING ON THIS SIDE OF LINE IS TO BE FED FROM DATA ROOM #3504.

ALL STRUCTURED AND LOW VOLTAGE CABLING ON THIS SIDE OF LINE IS TO BE FED FROM DATA ROOM #3316.

**TECHNOLOGY - LEVEL 3 RCP - AREA A**  
1/8" = 1'-0"

PSW Job Number:  
**993A**

Henderson Job Number:  
**2150002607**

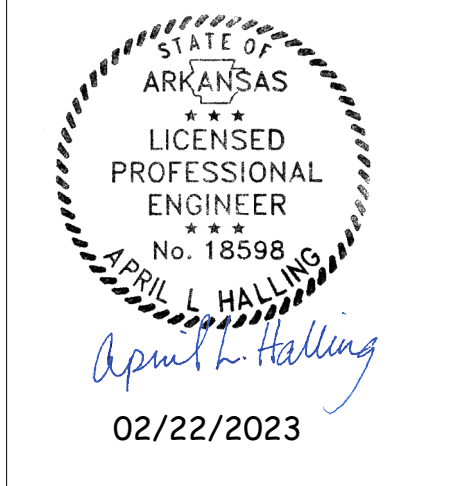

**AWSOM**  
Bentonville, AR

Issue Date:  
**02.24.2023**

REVISIONS		
NUMBER	DATE	DESCRIPTION

Contents:  
**TECHNOLOGY - LEVEL 3 RCP - AREA A**

