

9/18/2024 9:43:34 AM AE151
Autodesk Docs/US_D3754502_FED_Aerojet Rocketdyne/D3754500_CMDN_OSD_TestStand_ARCH-INT.rvt

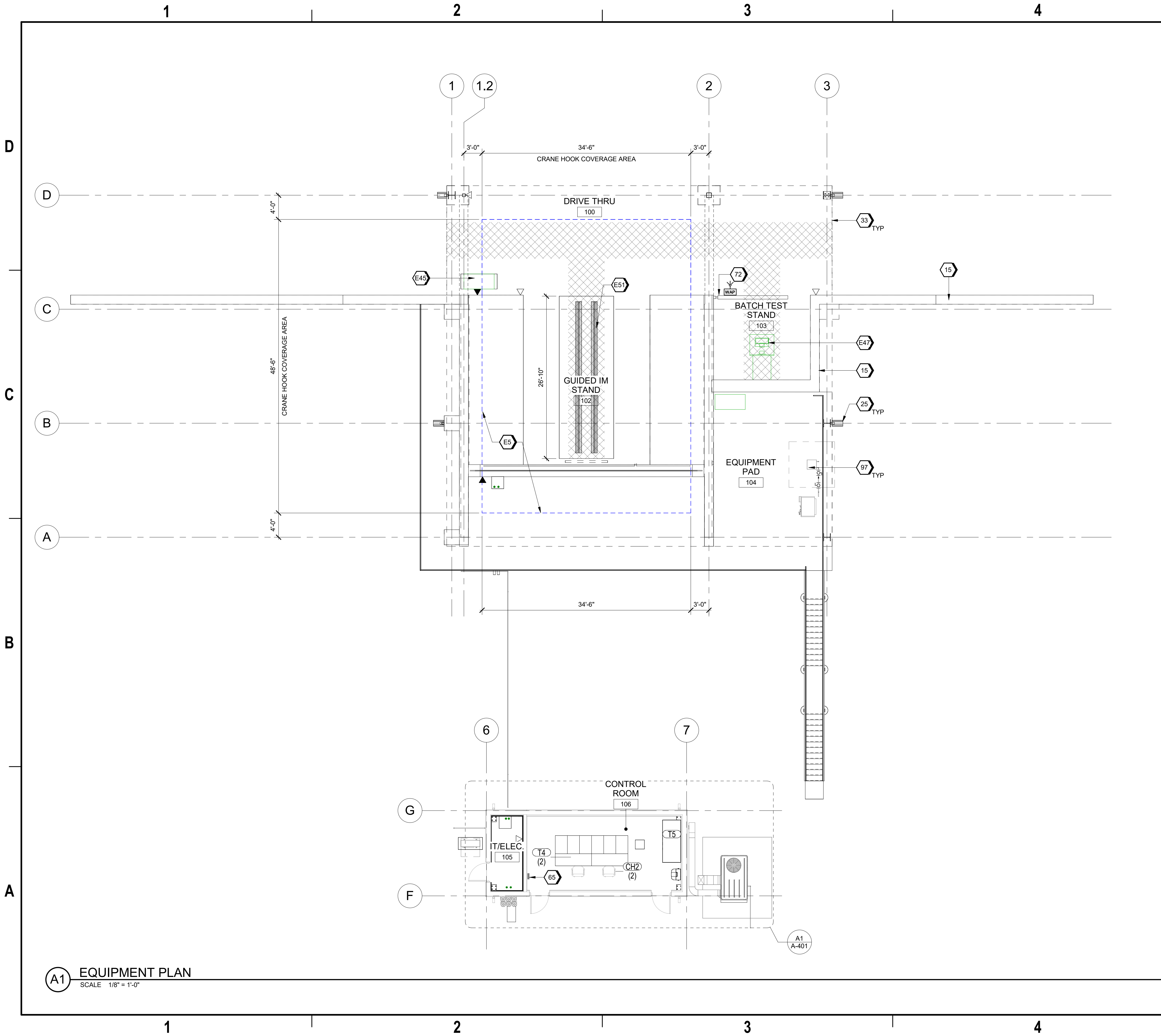

GENERAL SHEET NOTES

- A. FINISHED FLOOR ELEVATION 0'-0" IS A REFERENCE ELEVATION FOR COORDINATION WITH BUILDING ELEMENTS. ACTUAL ELEVATION IS INDICATED ON CIVIL DRAWINGS.
- B. FOR ARCHITECTURAL GENERAL NOTES, SYMBOLS, AND LEGEND, REFER TO SHEET G-003.
- C. FOR CAMPUS WIDE DETAILS, INCLUDING EXTERIOR ASSEMBLIES, REFER TO A-500 SERIES SHEETS.
- D. FOR BUILDING CODE DATA AND LIFE SAFETY PLAN, REFER TO DRAWING G-101.
- E. FOR FURNITURE AND EQUIPMENT, REFER TO EQUIPMENT PLANS SHEET A-151, A-401.
- F. SAT BUILDING IS CO-LOCATED ON SITE WITH TEST STAND. REFER TO A-401 THROUGH A-403 FOR SAT BUILDING, REFER TO CIVIL DRAWINGS FOR ADDITIONAL INFORMATION.
- G. FOR ARCHITECTURAL ROOF AND WALL ASSEMBLY, REFER TO SHEET A-800

#SHEET KEYNOTES

- 15 RETAINING WALL
- 25 PRECAST CONCRETE RAINWATER SPLASH BLOCK AT EACH DOWNSPOUT DISCHARGE; PLACE ON FINISH GRADE; SLOPE DOWN AWAY FROM BUILDING-TYPICAL
- 33 PEMB ROOF OVERHANG ABOVE
- 65 FIRST AID KIT
- 72 1-TON JIB CRANE WITH 10'-0" MIN. HOOK HEIGHT ABOVE
- 97 MECHANICAL EQUIPMENT - TYPICAL
- E5 1-TON BRIDGE CRANE ABOVE
- E45 LARGE WHEELED LOCKABLE TOOL CABINET; GRAINGER MODEL # JSTV5539RD13BK; 55"W X 22 3/8"D X 38 1/2"H; GLOSS BLACK
- E47 BATCH TEST STAND
- E51 TEST STAND TRACKS; REFER STRUCTURAL FOR DETAILS (CFCI)

LEGEND

- PRIMARY MATERIAL FLOW
- OWNER FURNISHED EQUIPMENT
- * NOTE: FOR USER REFERENCE, NOT IN SCOPE OF CONSTRUCTION

FF&E - CFCI	
MARK	DESCRIPTION
CH2	CHAIR, TASK
ST5	STORAGE, 30" INDUSTRIAL
T4	TABLE, 24" X 72"
T5	TABLE, WORKBENCH

GRAPHIC SCALE(S)

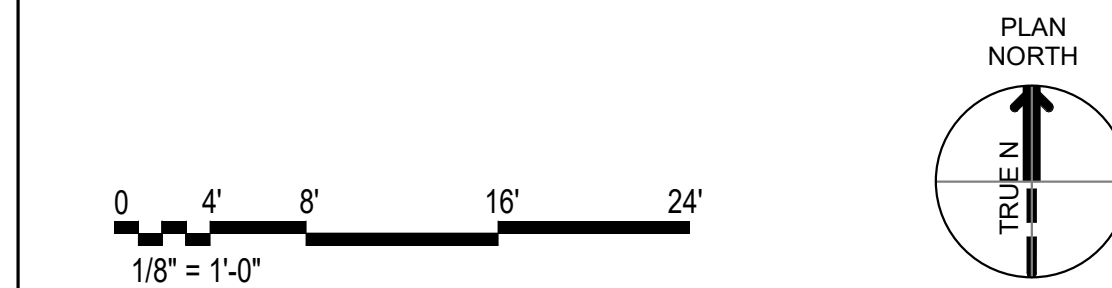

NO.	DATE	REVISION	CHK	BY	APVD	TM
0	09/18/2024	100% ISSUED FOR CONSTRUCTION - EXPANSION	IE	TM	APVD	TM

Jacobs

1889 Bryan Street Suite 3500, Dallas, TX 75201
Tel: 214-638-0145 Fax: 214-638-0447
Entity: Jacobs Consultants Inc.
License: Professional Engineer
Exp. Date: 01/31/2025

REGISTERED ARCHITECT
CHRIS ALFSTAD
912327
STATE OF ARKANSAS
09/18/2024

Test Stand and SAT Building
Camden OSD
Calhoun County, Arkansas
Aerojet Rocketdyne

Jacobs **ARCHITECTURE**
EQUIPMENT PLAN

SHEET NO	
AE151	
SCALE	As indicated
DATE	09/18/2024
PROJ	D3754502
DWG	CMDN_OSD_TestStand_AE151

PLOT DATE/TIME: 9/18/2024 9:43:34 AM