

9/18/2024 9:13:04 AM IN101 Autodesk Docs/US\_D3754500\_FED\_Aerojet Rocketdyne/D3754500\_CMEN\_OSD\_Grinder\_ARCH-INT.rvt

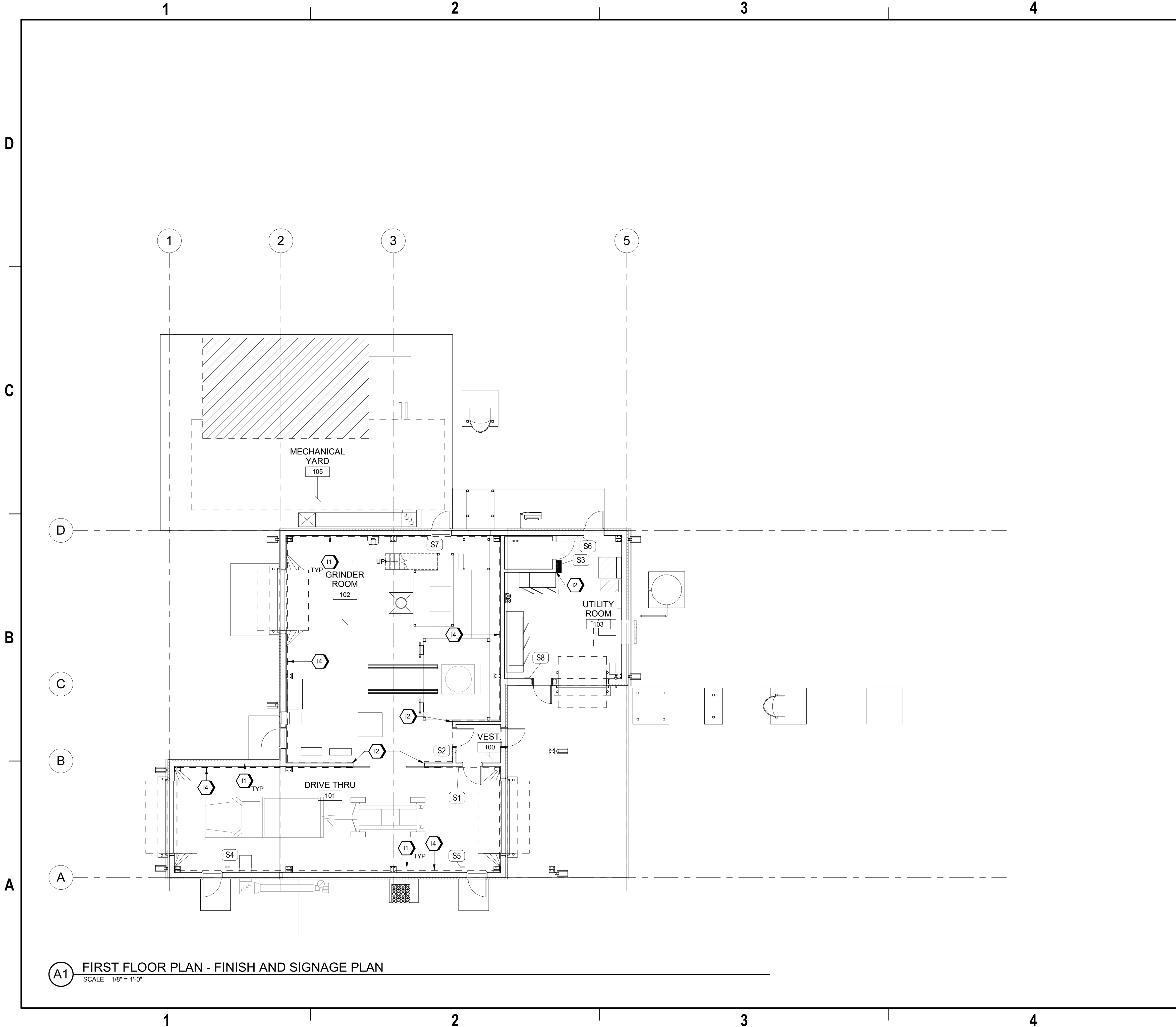

**A1** FIRST FLOOR PLAN - FINISH AND SIGNAGE PLAN  
SCALE 1/8" = 1'-0"

## GENERAL SHEET NOTES

- A. FIELD VERIFY ALL DIMENSIONS PRIOR TO ORDERING MATERIALS & FINISHES.
- B. ALL TRANSITIONS MUST OCCUR AT THE CENTERLINE OF THE DOOR, DOORWAY OR CEILING LINE, UNLESS OTHERWISE INDICATED.
- C. REFER TO REFLECTED CEILING PLANS ON SHEET AE-101 FOR MORE INFORMATION.
- D. APPLY BASE AS SPECIFIED ON GYPSUM BOARD WALL FINISHES ONLY, DO NOT APPLY BASE TO CMU WALLS.
- E. PAINT ALL WALLS PT-1 UNLESS OTHERWISE NOTED.
- F. REFER TO SHEET I-601 FOR FINISH LEGEND AND ROOM FINISH SCHEDULE.
- G. REFER TO SHEET I-602 FOR SIGNAGE SCHEDULE AND DETAILS.

## #SHEET KEYNOTES

- I1 PRE-ENGINEERED METAL PANEL; FINISH TO BE FROM STANDARD COLORS
- I2 CORNER GUARD; CG-1; REFER TO FINISH LEGEND ON I-601
- I4 DARK DASHED LINE INDICATES EXTENTS OF ENERGETIC SPACES

## GRAPHIC SCALE(S)

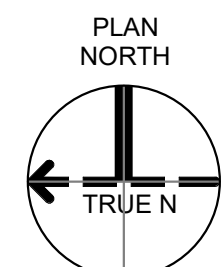

JACOBS		REGISTERED ARCHITECT		Grinder Camden OSD Calhoun County, Arkansas Aerojet Rocketdyne		INTERIOR FIRST FLOOR FINISH PLAN		SHEET NO IN101		SCALE As indicated		DATE 09/18/2024		PROJ D3754502		DWG CMEN-OSD_Grinder_IN101	
1899 Bryan Street Suite 3500 Dallas, TX 75201 Tel: 214-638-0145 Fax: 214-638-0447 Entity: Jacobs Consultants Inc. License: Professional Architecture Exp. Date: 01/31/2025		812327 CHRIS ALFSTAD STATE OF ARKANSAS 09/18/2024															
APVD		CHK		JMW		DR		LTV		APVD		APVD		IE		TM	
NO.		DATE		09/18/2024		100% ISSUED FOR CONSTRUCTION - EXPANSION		REVISION		BY		APVD		APVD		TM	
DSGN																	

REUSE OF DOCUMENT: THIS DOCUMENT IS THE PROPERTY OF JACOBS CONSULTANTS INC. AND IS NOT TO BE USED, IN WHOLE OR IN PART, FOR ANY OTHER PROJECT WITHOUT THE WRITTEN AUTHORIZATION OF JACOBS.

© Jacobs Consultants 2024. ALL RIGHTS RESERVED.