

**A1** GROUND FLOOR TELECOMMUNICATIONS PLAN - AREA D  
SCALE 1/8" = 1'-0"

**#SHEET KEYNOTES**

1. PROVIDE 12" X 12" X 6" EXPLOSION PROOF EX JUNCTION BOX, RATED FOR THE AREA OCCUPIED. NOTE THAT THE HAZARDOUS RATINGS MAY BE EITHER CLASS II DIV 1 OR CLASS I DIV 2 BASED ON EXACT LOCATION OF THE JUNCTION BOX.
2. PROVIDE RGS CONDUIT WITH SEALED RECEPTACLE BOX BEHIND EACH DEVICE. PROVIDE 2" RGS CONDUIT BETWEEN EX JUNCTION BOXES. PROVIDE 1" RGS CONDUIT TO DEVICE OUTLET. MAINTAIN SEALED CONDUIT THROUGHOUT THE HAZARDOUS CLASSIFIED AREA AT THE RATING OF THE AREA OCCUPIED. NOTE THAT THE HAZARDOUS RATINGS MAY BE EITHER CLASS II DIV 1 OR CLASS I DIV 2 BASED ON EXACT LOCATION OF THE RECEPTACLE BOX.
3. PROVIDE TWO (2) PROPERLY TERMINATED CATEGORY 6A CABLES TO WIRELESS ACCESS POINTS (WAP). CABLES WILL BE ENCASED IN A MINIMUM 1" CONDUIT ORIGINATING FROM AN ASSOCIATED EX JUNCTION BOX. BOTH CONDUIT AND WAP SHALL HAVE A MINIMUM HEIGHTS OF 25' AFF. STRUCTURAL SUPPORT FOR THE WAP AND CONDUIT SHOULD COME FROM ATTACHMENT TO MAIN BEAMS IN BEAM GRID. NOTE THAT THE HAZARDOUS RATING FOR THE WAP UNITS IS CLASS I DIV 2 BASED ON THE LOCATION OF THE UNITS.
4. 2" RGS CONDUIT EXTENSION BETWEEN EX BOXES ACROSS BAY WILL BE NO LOWER THAN 25' AFF, AND WILL BE SECURED TO STRUCTURAL BEAM.
5. PROVIDE OUTLET OF DESIGNATED TYPE WITH SEALED RECEPTACLE BOX BEHIND EACH DEVICE. PROVIDE 1" RGS CONDUIT TO DEVICE OUTLET. MAINTAIN SEALED CONDUIT THROUGHOUT THE HAZARDOUS CLASSIFIED AREA AT THE RATING OF CLASS II DIV 1.

**KEY PLAN**

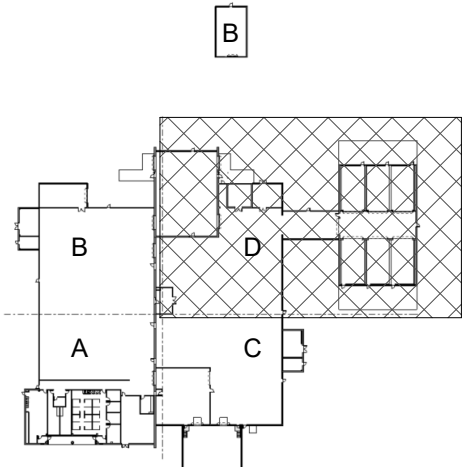

**GRAPHIC SCALE(S)**



SHEET NO		T-106
SCALE	1/8" = 1'-0"	
DATE	09/18/2024	
PROJ	D3754502	
DWG		

NO	DATE	DR	CHK	APVD	BY	MT
0	09/18/2024				BP	MT
100% ISSUED FOR CONSTRUCTION - EXPANSION						

GMLRS  
Camden OSD  
Calhoun County, Arkansas  
Aerojet Rocketdyne

TELECOMMUNICATIONS  
GROUND FLOOR PLAN  
AREA D

