

A1 GROUND FLOOR TELECOMMUNICATIONS PLAN - AREA C
SCALE 1/8" = 1'-0"

#SHEET KEYNOTES

1. PROVIDE TWO (2) 4-INCH CONDUIT EXTENSIONS FROM DATA ROOM 130 TO THE 3' X 3' BUILDING SERVING HANDHOLE LOCATED 10' FROM THE BUILDING FOR INTERCONNECTION TO FIBER HUT #2. HDPE LATERAL CONDUITS MUST TRANSITION TO RGS BELOW GRADE PRIOR TO 90 DEGREE TURN UP THROUGH THE SLAB INTO DATA ROOM 130.
2. PROVIDE OUTLET FOR WALL PHONE. TOP OF PHONE AT 48" AFF.
3. PROVIDE DEDICATED DATA OUTLET FOR THE ACS CONTROLLER.
4. PROVIDE 1-INCH RGS CONDUIT ON THE EXTERIOR OF THE WALL FOR AN EXTERIOR WEATHERPROOF WALL PHONE. PROVIDE OUTDOOR RATED WALL PHONE OUTLET. TOP OF PHONE SHOULD BE 48" AFF.
5. PROVIDE ONE (1) 4-INCH SLEEVE WALL PENETRATION WITH BUSHINGS ON BOTH SIDES. PENETRATIONS INTO ENERGETIC AREAS MUST HAVE SEALED FITTINGS.
6. PROVIDE 12" X 12" X 6" EXPLOSION PROOF EX JUNCTION BOX, RATED FOR CLASS II DIV 1.
7. PROVIDE RGS CONDUIT WITH SEALED RECEPTACLE BOX BEHIND EACH DEVICE. PROVIDE 2" RGS CONDUIT BETWEEN EX JUNCTION BOXES. PROVIDE 1" RGS CONDUIT TO DEVICE OUTLET. MAINTAIN SEALED CONDUIT THROUGHOUT THE HAZARDOUS CLASSIFIED AREA AT THE RATING OF CLASS II DIV 1.
8. PROVIDE TWO (2) PROPERLY TERMINATED CATEGORY 6A CABLES TO WIRELESS ACCESS POINTS (WAP). CABLES WILL BE ENCASED IN A MINIMUM 1" CONDUIT ORIGINATING FROM AN ASSOCIATED EX JUNCTION BOX. BOTH CONDUIT AND WAP SHALL HAVE A MINIMUM HEIGHT OF 26" AFF. STRUCTURAL SUPPORT FOR THE WAP AND CONDUIT SHOULD COME FROM ATTACHMENT TO MAIN BEAMS IN BEAM GRID.
9. NOT USED.
10. 2" RGS CONDUIT EXTENSION BETWEEN EX BOXES ACROSS BAY WILL BE NO LOWER THAN 26" AFF, AND WILL BE SECURED TO STRUCTURAL BEAM.
11. PROVIDE OUTLET OF DESIGNATED TYPE WITH SEALED RECEPTACLE BOX BEHIND EACH DEVICE. PROVIDE 1" RGS CONDUIT TO DEVICE OUTLET. MAINTAIN SEALED CONDUIT THROUGHOUT THE HAZARDOUS CLASSIFIED AREA AT THE RATING OF CLASS II DIV 1.
12. PROVIDE A 24"W X 36"L X 24"D FIBER OPTIC PULL BOX. BOX TO PROVIDE AN ADDITIONAL PULL POINT TO ADDRESS LONG CONDUIT RUNS AND DEGREES OF BEND. BOX MAY ALSO BE USED FOR SLACK STORAGE BASED ON CABLE TYPE. BOX TO BE MOUNTED TO STRUCTURAL STEEL BEAMS AS SHOWN.

KEY PLAN

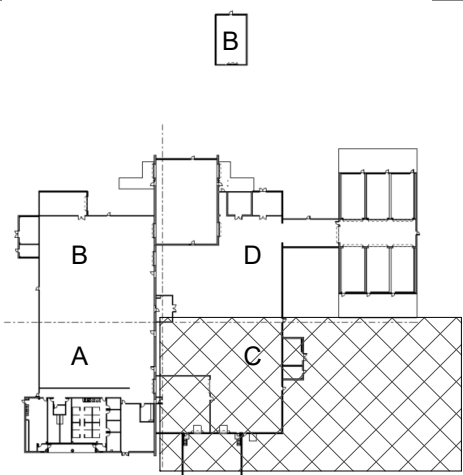

GRAPHIC SCALE(S)

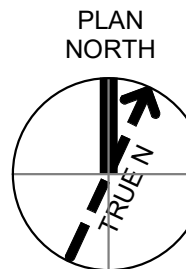

100% ISSUED FOR CONSTRUCTION - EXPANSION

NO	DATE	DESIGN	DR	BP	CHK	CR	APVD	BY	MT
0	09/18/2024								

TELECOMMUNICATIONS
GROUND FLOOR PLAN
AREA C

GMLRS
Camden OSD
Calhoun County, Arkansas
Aerojet Rocketdyne

SHEET NO
T-105

SCALE	1/8" = 1'-0"
DATE	09/18/2024
PROJ	D3754502
DWG	

Autodesk Docs://US_D3754500_FED_Aerojet Rocketdyne/D37545N0_CMDN_OSD_GMLRS_TCOM-SEC.rvt

9/18/2024 12:22:20 PM