

**A1 ENLARGED PIPING PLAN - CASTING BAY**  
SCALE 1/4" = 1'-0"

**GENERAL SHEET NOTES**

1. HEAT TRACE ALL EXTERIOR HYDRONICS AND STEAM CONDENSATE PIPING

**#)SHEET KEYNOTES**

KEYNOTES	
1	TERMINATE WITH SILENCERS. SEE VACUUM DIAGRAM ON SHEET MH608.
2	ISOLATION VALVES. FIELD ROUTE HYDRONICS TO/FROM CASTING BOWL REQUIRED CONNECTION POINTS. TRANSITION TO HOSE FOR FLOOR LEVEL BOWL CONNECTIONS. SEE DETAIL ON SHEET MH501.
3	ISOLATION VALVE. FIELD ROUTE NITROGEN TO MIX BOWL REQUIRED CONNECTION POINT. TRANSITION TO HOSE FOR STAND LEVEL BOWL CONNECTIONS.
4	ISOLATION VALVES. FIELD ROUTE HYDRONICS TO/FROM CASTING BOWL REQUIRED CONNECTION POINTS. TRANSITION TO HOSE FOR STAND LEVEL BOWL CONNECTIONS. SEE DETAIL ON SHEET MH501.
5	ISOLATION VALVES. FIELD ROUTE HYDRAULICS TO/FROM LIFT TABLE, CART LOCATOR, CAST CHAMBER DOOR AND TERMINATE EACH WITH AUTOMATIC CONTROL VALVE. HYDRAULIC PIPING SHALL BE WELDED BLACK STEEL PIPE.
6	ISOLATION VALVES. FIELD ROUTE HYDRAULICS TO/FROM BOWL PLUG PULLER AND TERMINATE WITH AUTOMATIC CONTROL VALVE. HYDRAULIC PIPING SHALL BE WELDED BLACK STEEL PIPE.
7	ISOLATION VALVE. FIELD ROUTE VACUUM TO CAST CHAMBER REQUIRED CONNECTION POINTS.
8	FIELD ROUTE COMPRESSED AIR TO PNEUMATIC CONTROL PANEL REQUIRED CONNECTION POINT.
9	2" COMPRESSED AIR CONNECTIONS FOR OVERHEAD CRANE.

**LEGEND**

**KEY PLAN**

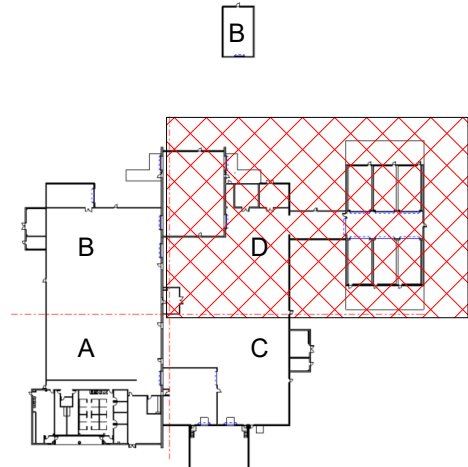

**GRAPHIC SCALE(S)**

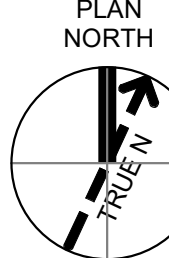

1995 Bryant Street, Suite 300  
Ft. Smith, AR 72534  
Phone: 479.783.1100  
Fax: 479.783.1101  
Email: Jacobs.Engineering@jacobs.com  
License Type: Engineering  
License No.: 123123456  
License Exp. Date: 12/31/2024

NO.	DATE	DR	CHK	ASM	DESIGN	BY	APPROVED	DATE	REVISION	DESCRIPTION
1	10/03/2024					JWG				ADDITION OF - EXPANSION
0	09/18/2024					JWG				100% ISSUED FOR CONSTRUCTION - EXPANSION

GMLRS  
Camden OSD  
Calhoun County, Arkansas  
Aerojet Rocketdyne

MECHANICAL  
ENLARGED HVAC PIPING PLAN  
CASTING BAY

SHEET NO  
**MH403**

SCALE 1/4" = 1'-0"  
DATE 09/18/2024  
PROJ D3754502  
DWG