

(A1) HVAC PIPING FLOOR PLAN-AREA 'D' EAST
SCALE 1/8" = 1'-0"

GENERAL SHEET NOTES

1. HEAT TRACE ALL EXTERIOR HYDRONICS AND STEAM CONDENSATE PIPING
2. STEAM PIPING SHALL BE INSTALLED TO DRAIN TO BOILER OR THE STEAM TRAP. STEAM SYSTEMS SHALL NOT HAVE DRIP POCKETS THAT REDUCE THE CAPACITY OF THE STEAM PIPING.
3. STEAM PIPE SHOULD BE INSTALLED WITH A MINIMUM SLOPE OF 1/8" PER FOOT OF PIPE (1:100) IN THE DIRECTION NECESSARY TO MOVE LIQUIDS TOWARDS STEAM TRAPS.
4. INSTALL STEAM TRAPS WITH APPROPRIATELY SIZED TRAP POCKETS AT INTERVALS OF 100 TO 150 FT. AS WELL AS NATURAL LOW POINTS SUCH AS THE BOTTOM OF RISING PIPEWORK.

(#) SHEET KEYNOTES

LEGEND

KEY PLAN

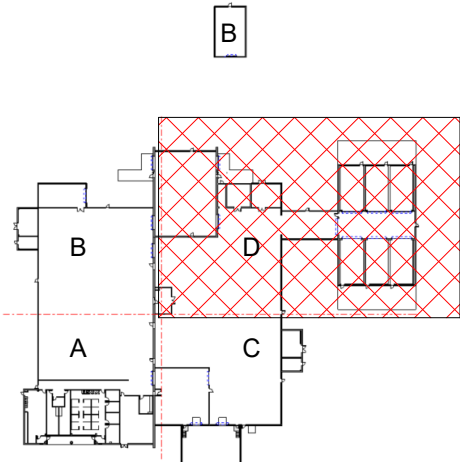

GRAPHIC SCALE(S)

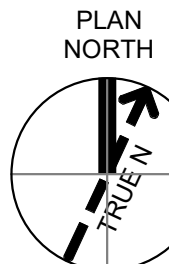

10000 Bryson Road, Suite 3000
Dallas, TX 75224
Phone: 972.714.2000
Fax: 972.714.2001
Email: Jacobs.Engineering@jacobs.com
License No. 178
License Exp. Date: 12/31/2024

REVISION		DATE	BY	CHK	ASM	DR	APVD	SIG
1	10/03/2024	10/03/2024	JWG	BY	APVD			
0	09/18/2024	09/18/2024	JWG	BY	APVD			

GMLRS
Camden OSD
Calhoun County, Arkansas
Aerojet Rocketdyne

MECHANICAL
HVAC PIPING FLOOR PLAN
AREA 'D' EAST

SHEET NO
MH115A

SCALE 1/8" = 1'-0"
DATE 09/18/2024
PROJ D3754502
DWG